

Fender® FUSE™ 2.0

G-DEC®  MUSTANG™
GUITAR DIGITAL ENTERTAINMENT CENTER



EXP-1
EXPRESSION
PEDAL

OWNER'S MANUAL

Using EXP-1 with Mustang™ III-IV-V

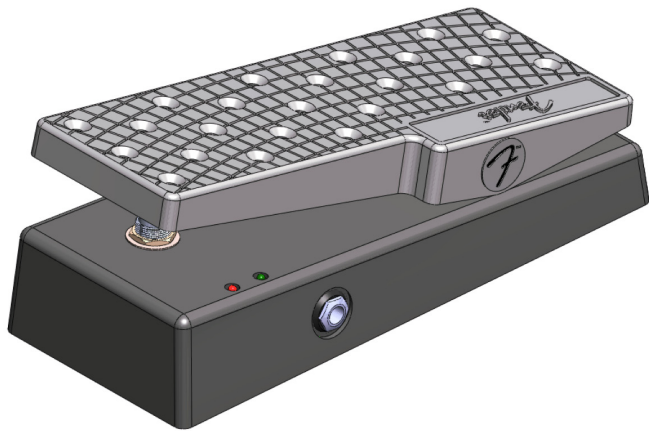

The EXP-1 expression pedal (P/N 2301050000) is compatible with Fender® Mustang™ III-IV-V amplifiers and Mustang Floor.

 *Mustang Floor users: EXP-1 functions differently with this product. Please see page 14 for instructions on using the EXP-1 with the Mustang Floor...*

The EXP-1 operates in two modes, Volume behavior mode and Expression behavior mode. You switch between modes by pressing down hard on the toe end of the expression pedal. Red and green LEDs on the EXP-1 indicate the current pedal mode:

- **Volume** behavior mode is used to control master volume (or the expression pedal can be set to OFF in Volume mode).
- **Expression** behavior mode can be used to control most effect and amp parameters on your Mustang amplifier. Some common uses are to control the frequency parameter of a Wah effect or the rate/time parameter of a modulation or delay effect.

 *Expression mode is also useful for experimenting with those "mystery" parameters that you're not quite sure what they do—you can adjust the parameter with your foot and continue playing uninterrupted while listening to the parameter changes!*

Before you can use the EXP-1 you need to:

1. Download and install the latest version of Fender® FUSE™ software and download the current Fender FUSE owner's manual, both available free of charge at: fuse.fender.com.
-  *SYSTEM REQUIREMENTS: Fender FUSE software is compatible with PC computers running Windows 7, Vista, or XP and with Mac computers with Intel® processors running OSX 10.5 (Leopard) or above.*
2. Update the Firmware on your Mustang III/IV/V amplifier. See page 2 for simple step-by-step instructions.
3. Calibrate the EXP-1 (see below).
4. Configure EXP-1 Settings (see below).

EXP-1 Pedal Calibration

The first time you connect the EXP-1 to your Mustang amplifier, you should calibrate it so that the expression pedal range of movement is synchronized with the parameter ranges. Calibration takes only a few seconds:

To calibrate the EXP-1:

1. Plug the EXP-1 pedal into the "4 BUTTON" FOOTSWITCH jack on the back of your Mustang amplifier using the included cable.
2. Turn the amplifier OFF.
3. Press and hold the UTIL button on the amplifier, then turn the amplifier ON. Continue holding the UTIL button down until it is no longer illuminated.
4. The EXP-1 expression pedal has been calibrated!

 *Repeat the calibration procedure each time you change EXP-1 pedals or plug the EXP-1 into a different amplifier.*

(continued on next page...)

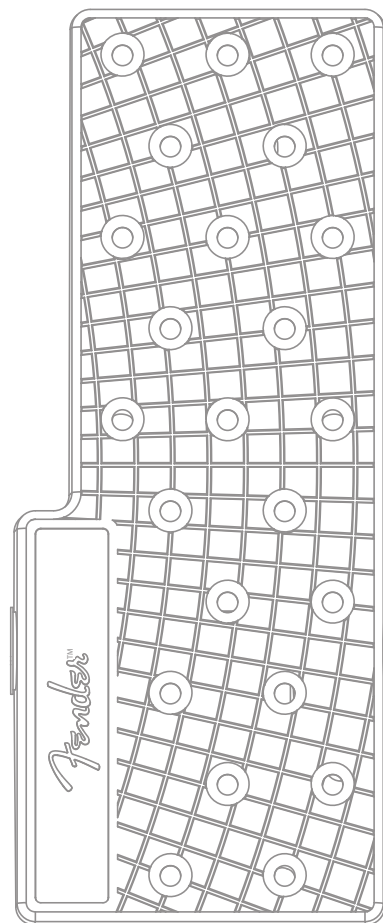

Using EXP-1 with Mustang™ III-IV-V

EXP-1 Pedal Settings

Now the fun part, selecting expression pedal parameters and deciding how you want the EXP-1 to behave!

To configure EXP-1 settings:

1. Plug the EXP-1 pedal into the "4 BUTTON" FOOTSWITCH jack on the back of your Mustang amplifier using the included cable.
2. Connect the amplifier to your computer via USB cable, then open the Fender FUSE application.
3. In Fender FUSE, open the EXP-1 menu: Main Menu > Utilities > Expression Pedal...
4. Select the parameter and behavior characteristics for the Volume and Expression modes:

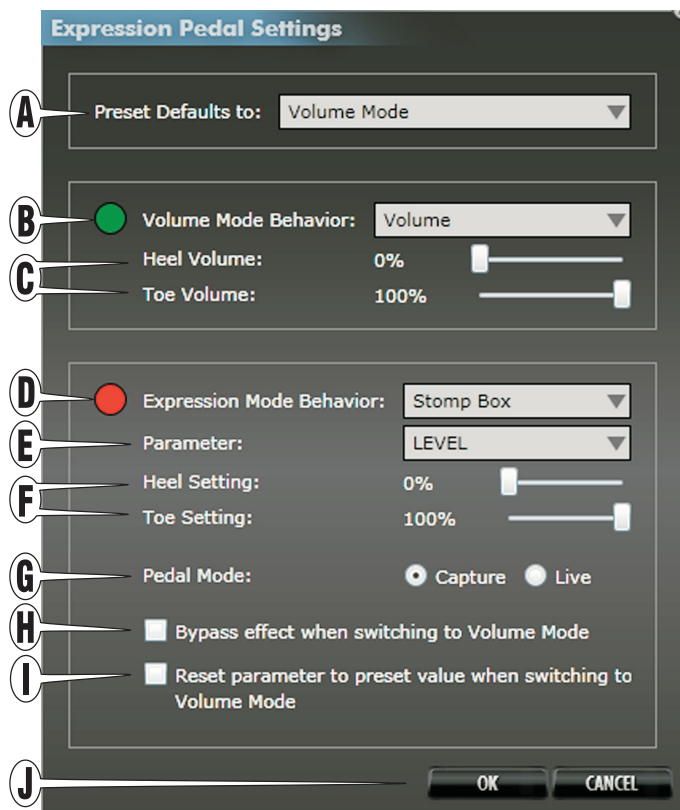

A small expression pedal icon will appear in Fender FUSE next to the amp or effect that is currently selected in the Expression Mode Behavior menu. You can drag this icon and drop it on different effect modules, or click on it to open the Expression Pedal Settings window!

- A. Preset Defaults to:** — (Volume Mode/Expression Mode) Select the mode that you want the pedal to switch to each time you select the current preset.

- B. Volume Mode Behavior** — (Volume/Off) Select "Volume" if you want the pedal to control the master volume in Volume mode or select "Off" if you want the pedal to be OFF when switched to Volume mode.

- C. Heel/Toe Volume** — (0–100%) Use these menus to set the master volume level with the heel of the pedal in the fully down position (Heel Volume) and with the toe of the pedal in the fully down position (Toe Volume).



The Heel and Toe Volume settings for Volume mode are stored globally and affect all Presets. Every other parameter is stored locally within each preset.

- D. Expression Mode Behavior** — (Off, Amp, Stomp, Mod, Delay, Reverb, Volume) Select the category that you want to control with the expression pedal in Expression mode or select "Off" if you want the pedal to be OFF in Expression mode.



You must have an effect selected for the current preset on the amplifier (or in Fender FUSE) to make that category of effect become available for selection in this menu.

- E. Parameter** — (Variable) Select the parameter that you want to control with the pedal in Expression mode. Your options will change depending on the category you selected in the Expression Mode Behavior menu above, and the effect module that is selected in the current preset.

- F. Heel/Toe Setting** — (Variable) Use this menu to set the level of the active parameter with the heel of the pedal in the fully down position (Heel Setting) and with the toe of the pedal in the fully down position (Toe Setting). Your options will change depending on the category you selected in the Expression Mode Behavior menu, above.

- G. Expression Mode** — (Capture, Live) If "Live" is selected the current pedal position will override the stored preset setting for the assigned expression pedal parameter when a preset is first selected. If "Capture" is selected the pedal is disabled until you move the pedal after a preset is first selected.

- H. Bypass Effect** — (On/Off) Check the box (On) to bypass the effect currently selected in the Expression Mode Behavior menu when switching the pedal to Volume mode or uncheck the box (Off) to leave the effect active.

- I. Reset Parameter to Preset Value when Switching to Volume Mode** — (On/Off) Check the box (On) to return the Expression Mode Parameter to the stored preset value when switching to Volume mode. Uncheck the box (Off) if you want the parameter be left set to the position of the pedal when switching to Volume mode.

- J. OK/Cancel** — Select "CANCEL" to undo all changes and select "OK" to confirm changes to the EXP-1 settings. Save the current preset to save the EXP-1 settings with the preset.

Supply of this product does not convey a license nor imply any right to distribute MPEG Layer-3 compliant content created with this product in revenue-generating broadcast systems (terrestrial, satellite, cable and/or other distribution channels), streaming applications (via Internet, intranets and/or other networks), other content distribution systems (pay-audio, or audio-on-demand-applications and the like) or on physical media (compact discs, digital versatile discs, semiconductor chips, hard drives, memory cards and the like) independent license for such use is required. For details, please visit <http://mp3licensing.com>

A PRODUCT OF:
FENDER MUSICAL INSTRUMENTS CORPORATION
CORONA, CALIFORNIA, USA

Fender®, G-DEC® 3, Mustang™ and Fender® FUSE™ are trademarks of FMIC.

Other trademarks are property of their respective owners.

Copyright © 2011 FMIC. All rights reserved.

P/N 0081847000 REV D (ENGLISH)