

Fisher-Price®

Model Number 72753

Little People®

Motorized Big Top Train™



www.fisher-price.com

(Track not included. Product features may vary from picture shown above.)

Please save these instructions for future reference.

Adult assembly is required.

Tool needed to install batteries: Phillips screwdriver.

This product requires three, size "AA" batteries for operation. (Batteries included.)

Battery Replacement

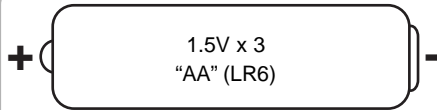

SHOWN ACTUAL SIZE

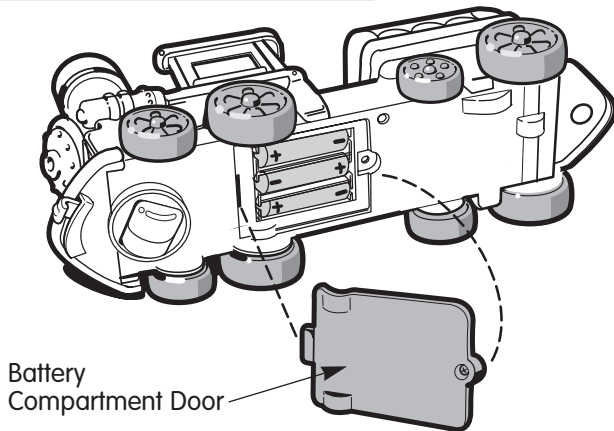

Battery
Compartment Door

For best performance, we recommend you replace the batteries that came with this toy with three, new alkaline batteries upon purchase.

- Loosen the screw in the battery compartment door with a Phillips screwdriver.
- Lift to open the battery compartment door.
- Insert three size "AA" (LR6) alkaline batteries as indicated inside the battery compartment.

Helpful Hint: For longer battery life, we recommend use of alkaline batteries.

- Replace the battery compartment door and tighten the screw with a Phillips screwdriver. Do not over-tighten.

Battery Tips

- Do not mix old and new batteries.
- Do not mix different types of batteries: alkaline, standard (carbon-zinc) or rechargeable (nickel-cadmium).
- Remove the batteries during long periods of non-use. Always remove exhausted batteries from this toy. Battery leakage and corrosion can cause damage. Dispose of batteries safely.
- Never short circuit the battery terminals.
- Non-rechargeable batteries are not to be recharged.
- Only batteries of the same or equivalent type as recommended in the "Battery Replacement" instructions are to be used.
- If removable rechargeable batteries are used, they are only to be charged under adult supervision.
- Rechargeable batteries are to be removed from this toy before they are charged.
- If you use a battery charger, it should be examined regularly for damage to the cord, plug, enclosure and other parts. Do not use a damaged battery charger until it has been properly repaired.

Setup

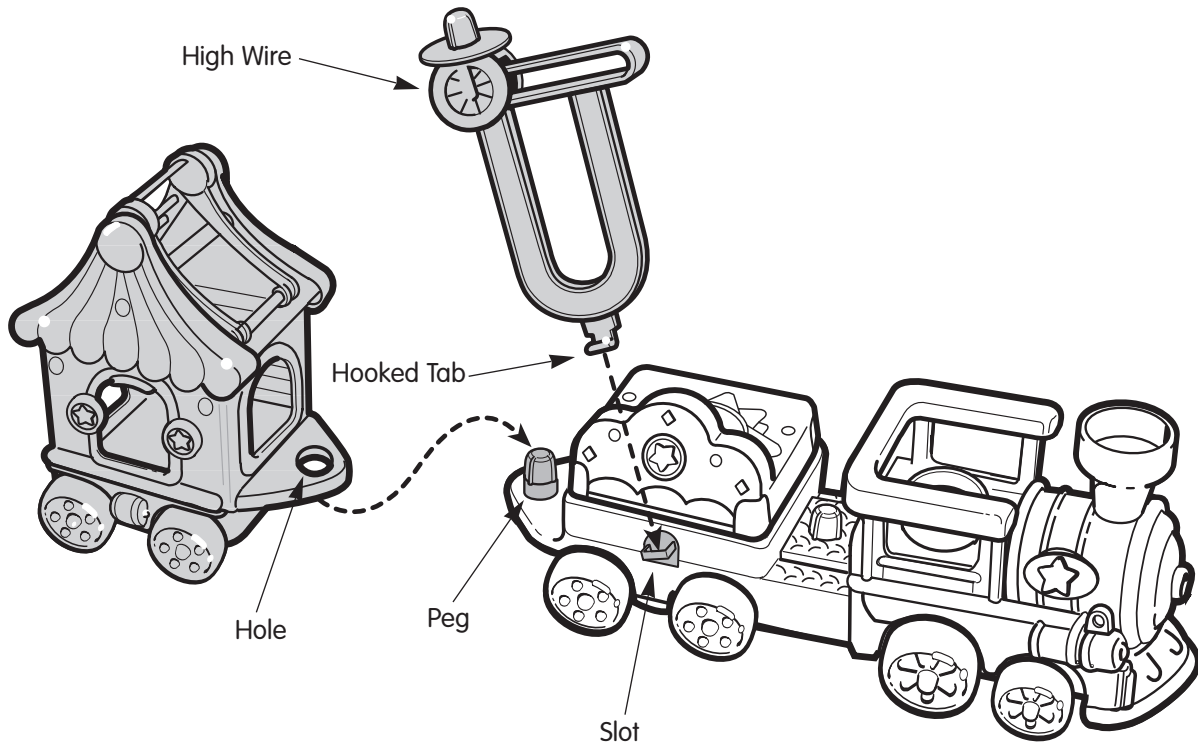

- Fit the hole on the end train car to the peg on the middle train car to form a train.
- Position the high wire so that the hooked tab is outward. Insert and snap the high wire hooked tab into the slot in the middle train car.

Hint: The high wire is designed to easily remove from the middle train car. To re-assemble, simply insert and snap the high wire hooked tab into the slot.



All Aboard!

The train travels in a straight line or in a circle.

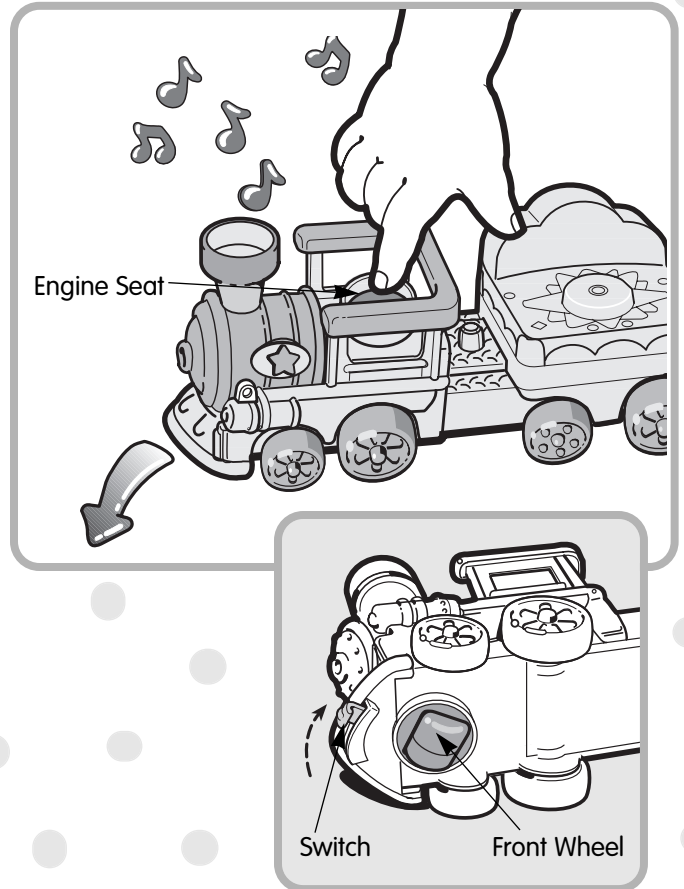
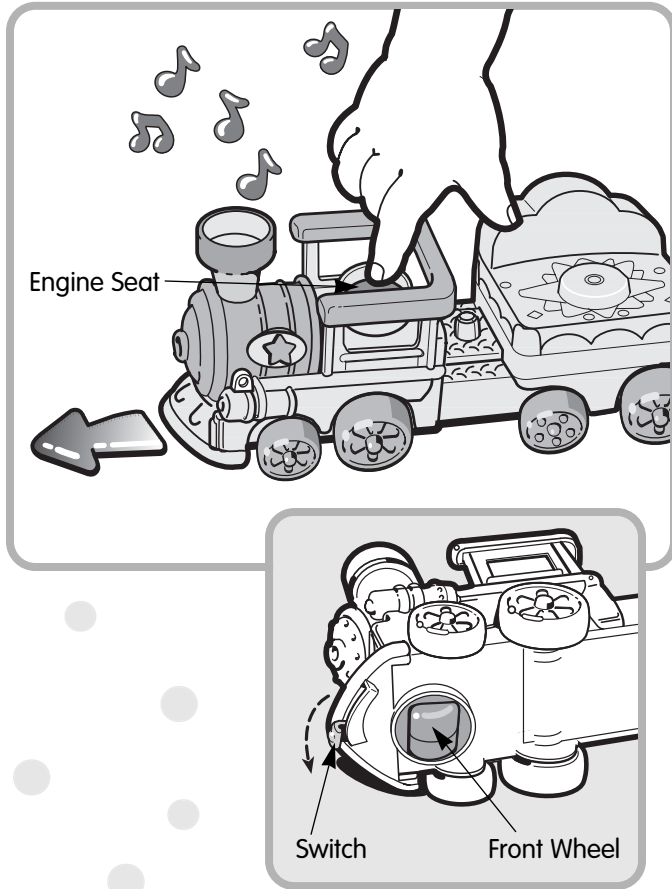

- Tip the engine car on its side. Slide the switch to turn the front wheel.
- Fit a Little People® character in the engine seat and press down. (Or, push down on the seat with your finger.) The train moves in a straight line, the high wire moves back and forth – all while playing a circus tune!

- Tip the engine car on its side. Slide the switch to turn the front wheel.
- Fit a Little People® character in the engine seat and press down. (Or, push down on the seat with your finger.) The train moves in a circle, the high wire moves back and forth – all while playing a circus tune!

Ladies and Gentlemen...

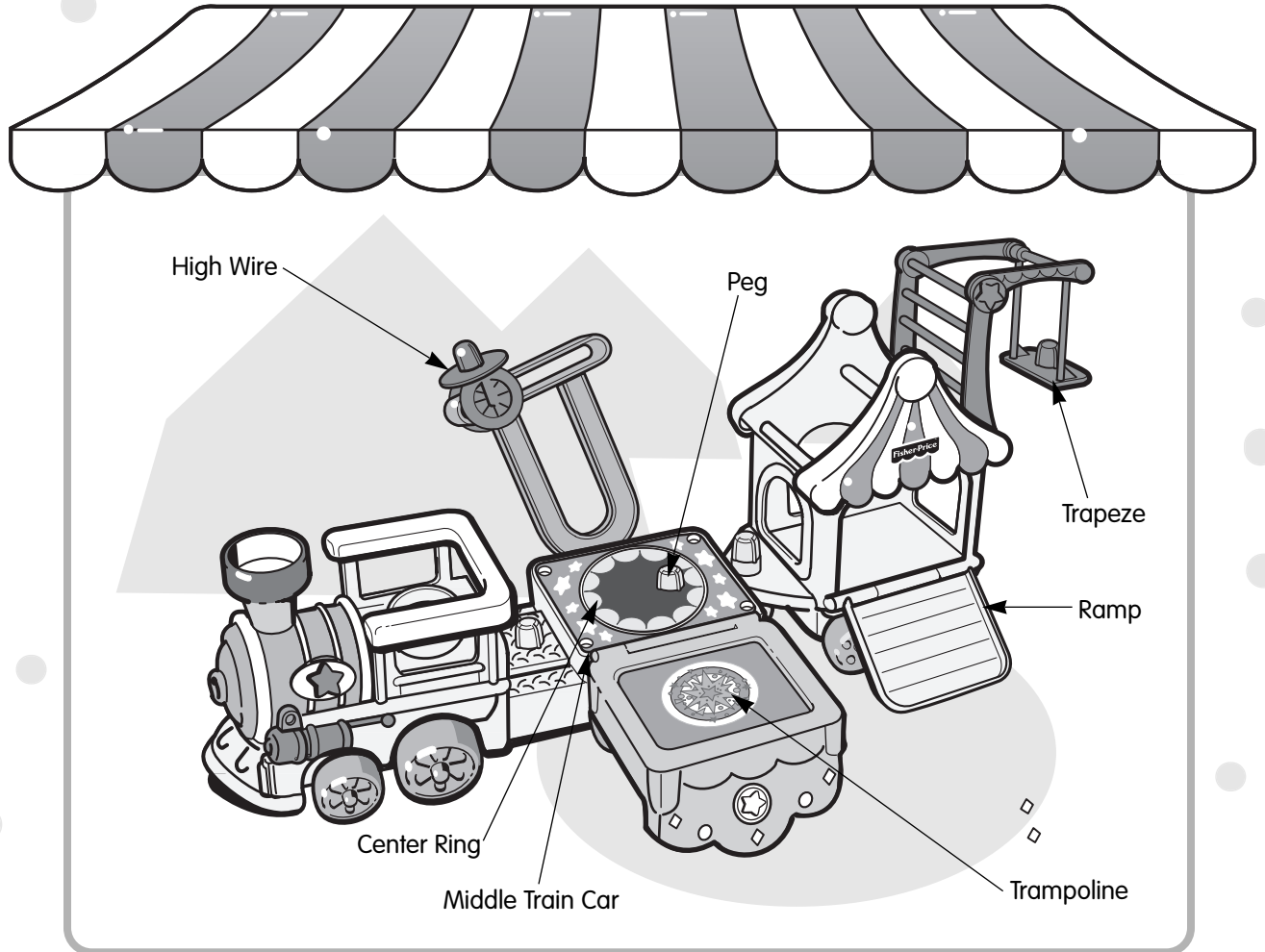

- Flip open the top of the middle train car.
- Place a Little People® character on the peg in the center ring or on the trampoline. Fit a Little People® character in the engine seat and press down. The center ring turns, the high wire moves back and forth and music plays!
- Open the ramp and unfold the trapeze on the end train car.

Fire the Cannon!



CAUTION

- Only use the projectiles (Little People® characters) supplied with this toy.
- Do not fire at people or animals.

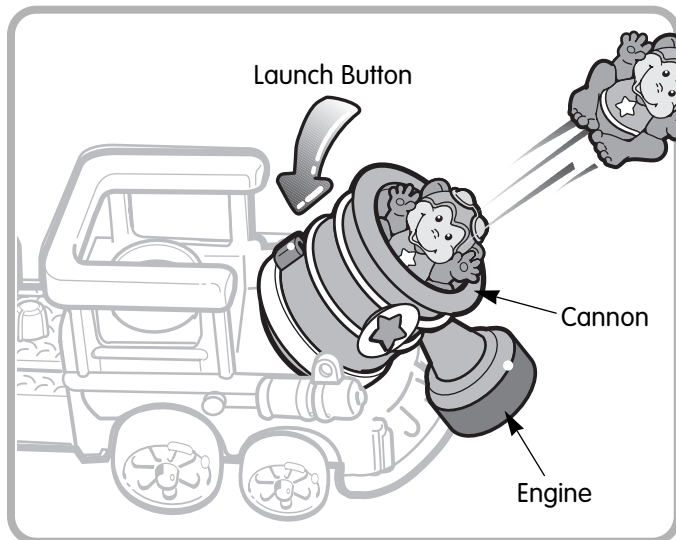

- Tip the engine forward.
- Fit a Little People® character onto the peg inside the cannon and push down until you hear a “click”.
- Press the launch button and watch the daredevil fly through the air!

Care

- To clean, wipe the surface of this toy with a damp cloth. Do not immerse this toy.
- If sound from this toy becomes faint, or if there is no sound, remove the batteries and dispose of them properly. Replace the batteries with three “AA” (LR6) alkaline batteries.
- This toy has no consumer serviceable parts. Please do not take this toy apart.

FCC Note (In United States Only)

Note: This equipment has been tested and found to comply with the limits for a Class B digital device, pursuant to Part 15 of the FCC Rules. These limits are designed to provide reasonable protection against harmful interference in a installation. This equipment generates, uses and can radiate radio frequency energy and, if not installed and used in accordance with the instructions, may cause harmful interference to radio communications. However, there is no guarantee that interference will not occur in a particular installation. If this equipment does cause harmful interference to radio or television reception, which can be determined by turning the equipment off and on, the user is encouraged to try to correct the interference by one or more of the following measures:

- Reorient or relocate the receiving antenna.
- Increase the separation between the equipment and receiver.
- Consult the dealer or an experienced radio/TV technician for help.

Consumer Information

Questions? We'd like to hear from you!

Call Fisher-Price® Consumer Affairs, toll-free at **1-800-432-KIDS**, 8 AM - 5 PM EST Monday through Friday. Hearing-impaired consumers using TTY/TDD equipment, please call 1-800-382-7470. Or, write to:

Fisher-Price® Consumer Affairs
636 Girard Avenue
East Aurora, New York 14052

If you have any questions about this product:

In Canada, call 1-800-567-7724, or write to: Mattel Canada Inc., 6155 Freemont Blvd., Mississauga, Ontario L5R 3W2.

In Great Britain, telephone 01628 500303.

In Australia, call the Consumer Advisory Service at 1-800-800-812 (valid only in Australia), or write to: Mattel Australia Pty., Ltd., 658 Church Street, Locked Bag #870, Richmond Victoria 3121 Australia.