





**IMPORTANT!**  
Supplemental instructions to your Owner's Manual. Please read this important information carefully.  
For 12 Volt Vehicles.

**⚠ WARNING**

**PREVENT FIRE**

- Do not bypass Power Wheels® fuses. They are safety devices.
- Use only **RED** Power Wheels® thermal fuses.
- Never modify the electrical system.

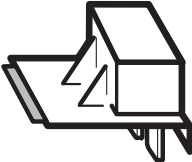
---

 **CORRECT FUSE** |  **INCORRECT FUSE**

### We've Made a Change!

To enhance the safety and performance of Power Wheels® vehicles, we've improved the design of our motor harness, battery and charger connectors, and fuses. Your vehicle, batteries and charger are equipped with newly designed Power Wheels® A-style connectors in place of the Type H connector pictured in the enclosed Owner's Manual. Your batteries require new-style, self resetting thermal fuses (included) for operation instead of the 30 amp fuses pictured in the enclosed Owners Manual. Read these instructions carefully for important information about the new A-style connectors and self resetting thermal fuses **before beginning assembly** of your new vehicle. Please disregard the "Battery Charging" instructions in your Owner's Manual and refer to the Battery Charging instructions on this sheet for battery charging information.

### About Thermal Fuses

Power Wheels® thermal fuses are self-resetting safety devices which automatically "trip" and shut down operation of the vehicle if the vehicle is overloaded or the driving conditions too severe. Once a fuse has "tripped", it will automatically reset itself after approximately 25 seconds and allow the vehicle to resume normal operation. To avoid repeated automatic shutdowns, do not overload the vehicle by exceeding the maximum weight capacity as listed in your Owner's Manual or by towing anything behind the vehicle. Avoid severe driving conditions, such as driving up very steep hills or running into fixed objects, which can cause the wheels to stop spinning while power is still being supplied to the motors.

If a new thermal fuse continually trips, please contact your local Power Wheels® Authorized Service Center. For the location of the Authorized Service Center nearest to you, consult the listing in your Owner's Manual or call Power Wheels® Consumer Affairs.

### Charging the Battery

**⚠ CAUTION**

Use the charger indoors only.

#### Important Notes:

- Your new batteries must be charged for at least **18 hours before you use them in your vehicle for the first time.**
- We recommend that you start charging your batteries before beginning assembly of your vehicle.
- The batteries must be upright while charging.
- The charger is not a toy.
- Do not short circuit the batteries.
- You do not need to remove the batteries from the vehicle to recharge them.
- Before charging the batteries, examine the battery cases for cracks and other damage which may cause sulfuric acid (electrolyte) to leak during the charging process. If damage is detected, do not charge the batteries or use them in your vehicle. Battery acid is very corrosive and can cause severe damage to surfaces it contacts. Take precautions to protect the surface on which you charge the batteries.
- Use only a Power Wheels 12 Volt charger with an A-style connector (120 VAC 60 Hz 28W with an output of 12VDC 1200mA) to charge your 6 volt batteries.

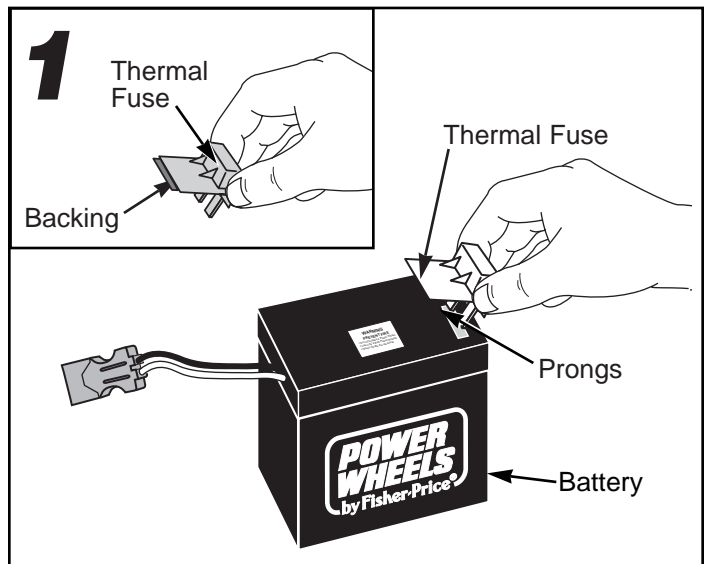

- Install a thermal fuse in each battery:
  - Peel the backing from the underside of the red plastic thermal fuse casing and discard the backing.
  - Insert the thermal fuse, prong side down, into the battery. Make sure the prongs are fully inserted into the battery.
  - Press on the red plastic casing to be sure it is adhered to the battery.

**Note:** The thermal fuses are properly installed in the batteries when the red plastic casings rest squarely on top of the batteries.

# 2

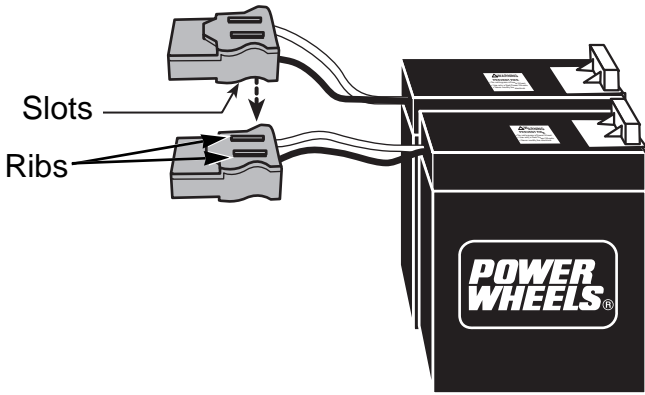

- Align the ribs on the top of one of the battery connectors with the slots on the bottom of the other battery connector.
- Stack the two battery connectors and press to join.

**Note:** Make sure that the two connectors on the charger are also stacked and joined.

# 4

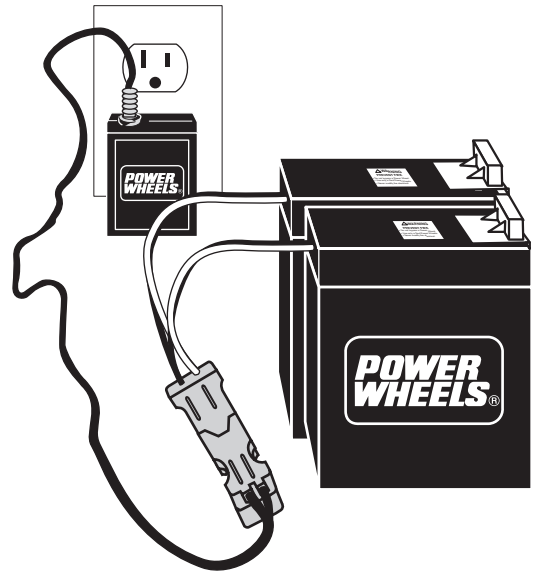

- Plug the charger into a standard 120 volt wall outlet.  
**Note:** If power flow to the wall outlet is controlled by a switch, make sure the switch is "ON".
- **Before first time use, charge the batteries for at least 18 hours.** Never charge the batteries longer than 30 hours.
- **Recharge the batteries for at least 14 hours** after each use of your vehicle. Do not charge the batteries longer than 30 hours.
- Once the batteries are charged, disconnect the charger connector from the battery connector. Unplug the charger from the wall outlet. The batteries are now charged and are ready to be installed in your vehicle. Once your vehicle is assembled and ready for use, plug the battery connector to the A-style motor harness connector the same way you joined the charger and battery connectors to charge the batteries.

**Please read and follow the assembly and use instructions in your Owner's Manual. If you have any questions about the safety, service or assembly of your Power Wheels® vehicle, please consult your Owner's Manual or call Power Wheels® Consumer Affairs toll-free at 1-800-348-0751. Please refer to the "Battery Installation" and "Battery Care and Disposal" instructions in your Owner's Manual for additional information regarding the use and care of your vehicle's batteries.**

# 3

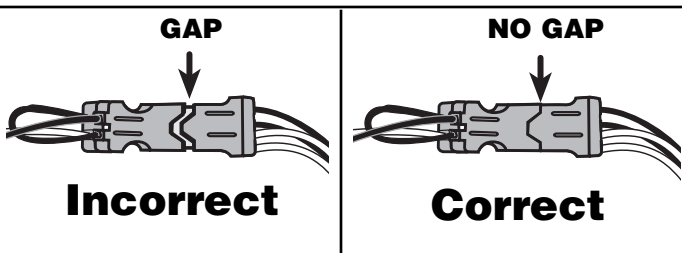
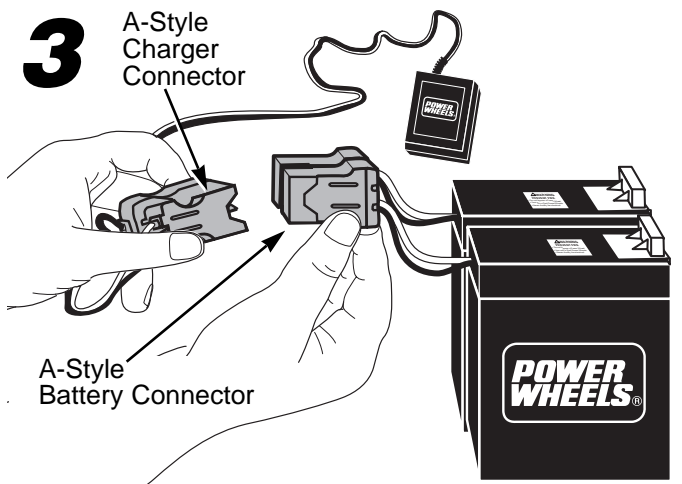

- Plug the charger and battery connectors together. Push firmly to make sure the two connectors are completely joined.

