

**Assembly** **Note:** The toys on the mobile shown on this instruction sheet may be different from those on your product.

**IMPORTANT!** Before each use or assembly, inspect this product for damaged hardware, loose joints, missing parts or sharp edges. **DO NOT** use if any parts are missing or broken. Contact Fisher-Price® for replacement parts and instructions if needed. Never substitute parts.

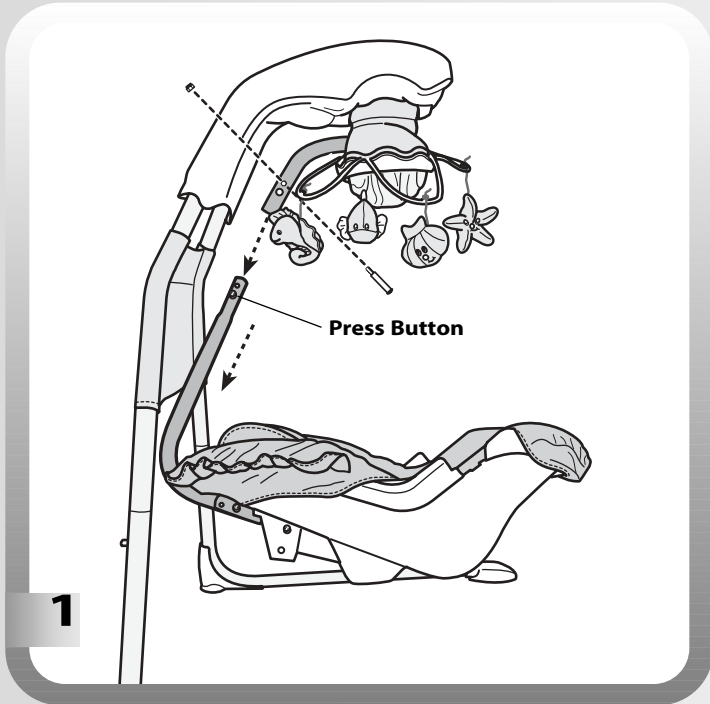

- Loosen and remove the screw and lock nut from the motorized frame tube. Throw away the screw and lock nut.
- Press the button on the motorized frame tube and remove the seat.

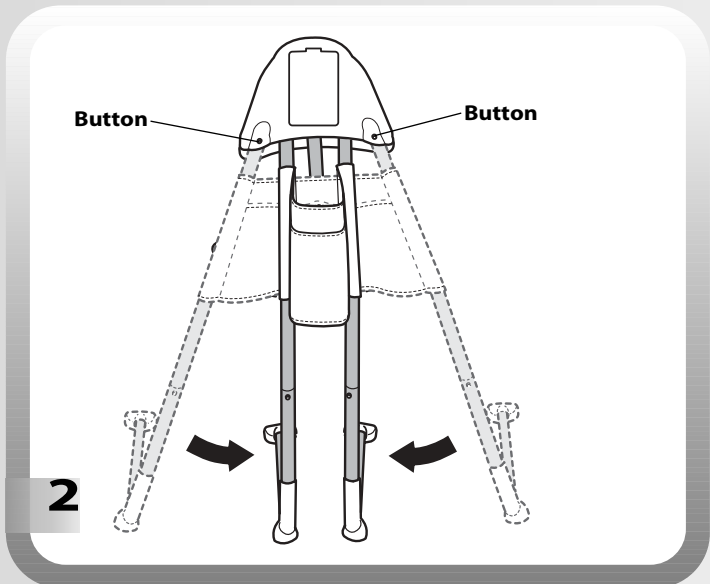

- Press the buttons on the back of the motorized frame while pushing the legs inward.

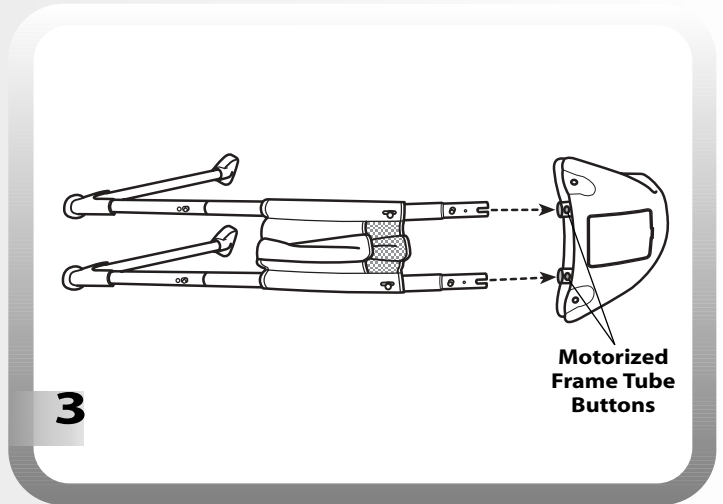

- Lay the swing on it's side.
- Press the buttons in the motorized frame tubes.
- Remove the motorized frame. Throw away the motorized frame.

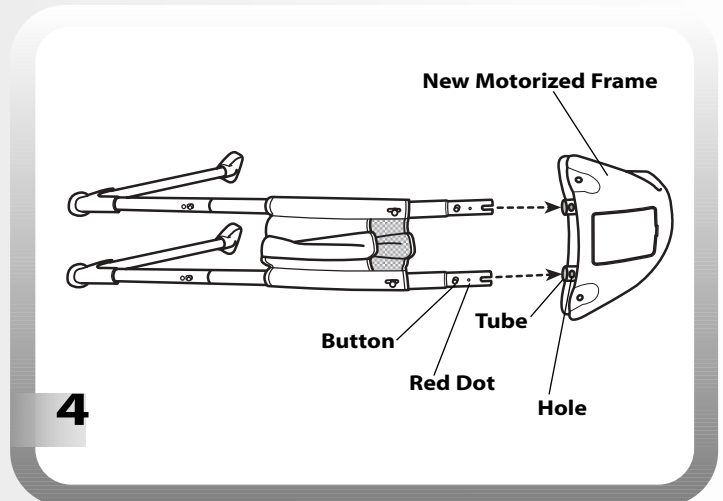

- While pressing the upper button on the right leg, fit it into the tube in the new motorized frame. Make sure the upper button on the right leg **"snaps"** into the hole in the tube.
- Repeat this procedure to assemble the left leg to the new motorized frame.
- When the legs are assembled correctly to the tubes in the motorized frame, you should **not** see the red dots.

# Assembly

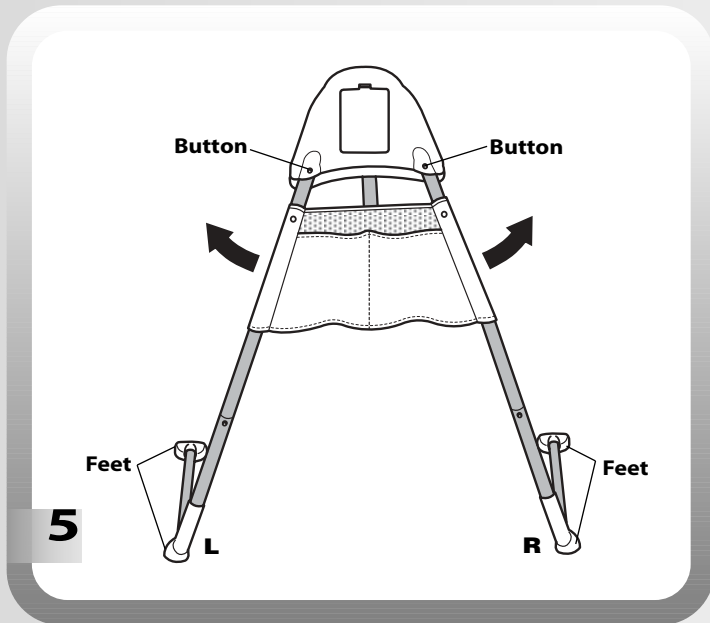

- 5**
- Stand the assembly upright.
  - Pull the legs out so that the buttons “snap” into the holes in the motorized frame.
  - When standing behind the product, all four feet should be **flat** upon the floor. And, check for an **L** marking on the left foot and an **R** marking on the right foot.
  - If the feet are not flat upon the floor, or the left and right feet have been reversed, remove both lower legs from the upper legs. Replace them onto the opposite upper leg.

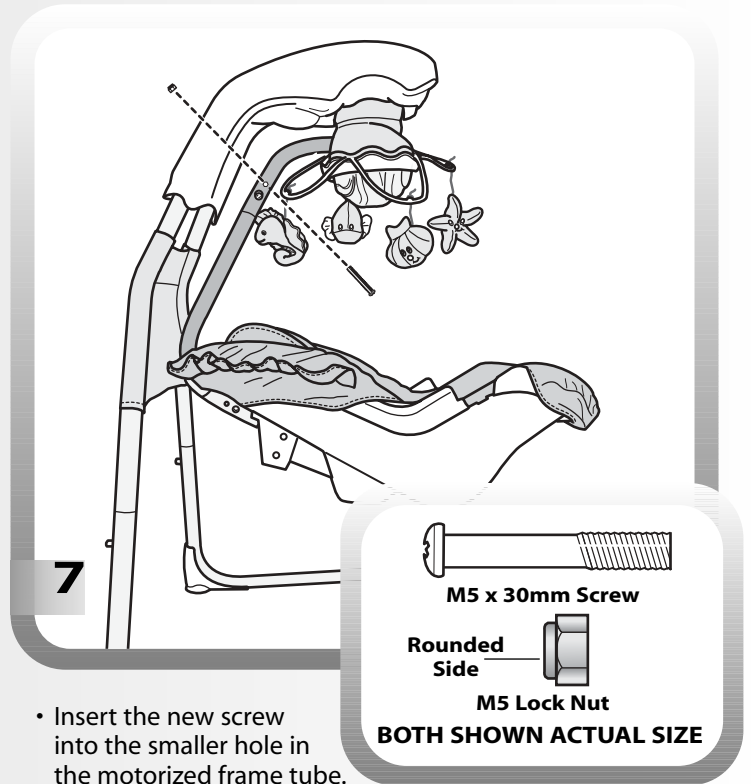

- 7**
- Insert the new screw into the smaller hole in the motorized frame tube.
- Hint:** You may need to tap the screw with a hammer or twist the screw to completely insert it through the hole.
- Attach the lock nut, **rounded side facing out**, to the screw.
  - Tighten the screw with a Phillips screwdriver.

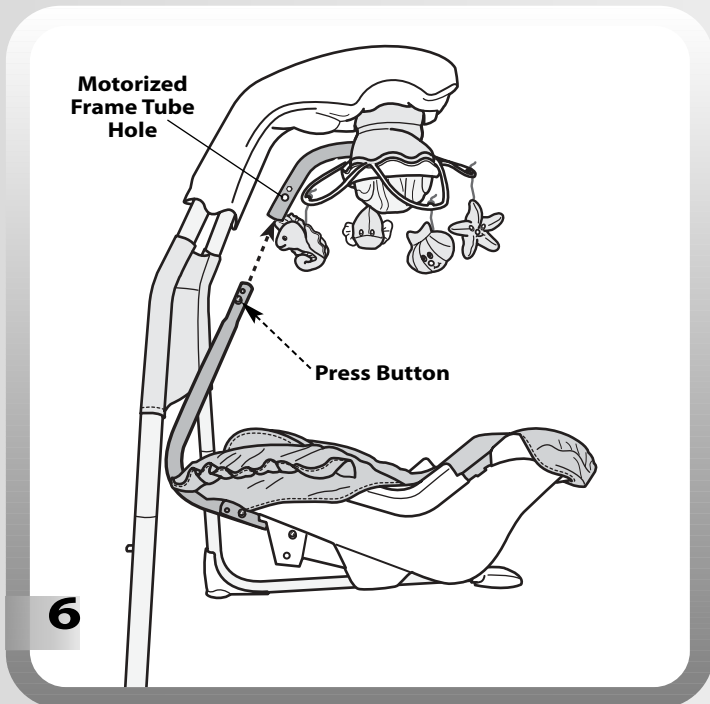

- 6**
- Press the button on the seat tube and slide the seat tube into the motorized frame tube. Make sure the button on the seat tube “snaps” into the larger hole in the motorized frame tube.