

Fisher-Price®

N5962

- Please keep this instruction sheet for future reference, as it contains important information.
- Requires two 9V (6LR61) **alkaline** batteries (not included) for operation.
- Adult assembly is required for battery installation.
- Tool required for battery installation: Phillips screwdriver (not included).
- Transmission carrier frequency is 27.145 MHz.
- Walkie talkie range is up to 200 feet (61 meters).
- Field strength: 74.8dBu V/m at 3m.



**Kid:
Tough®**
Walkie Talkies

www.fisher-price.com

Battery Installation

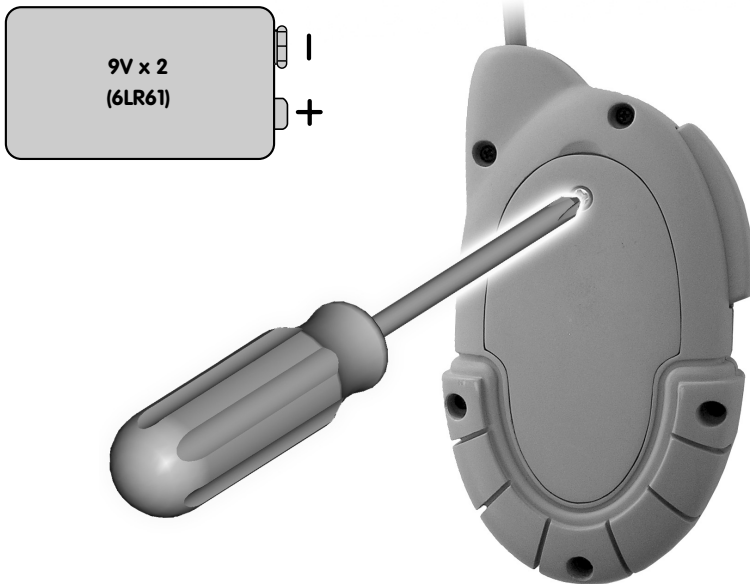

- Locate the battery compartment on the back of each walkie talkie.
- Loosen the screw in each battery compartment door. Remove each battery compartment door.
- Snap one 9V (6LR61) **alkaline** battery into each walkie talkie.

Hint: We recommend using **alkaline** batteries for longer battery life.

- Replace each battery compartment door and tighten each screw.
- If the toy begins to operate erratically, you may need to reset the electronics. Turn the power/volume dial off and then back on.
- When sounds from this toy become faint or stop, it's time for an adult to change the batteries.



Protect the environment by not disposing of this product with household waste (2002/96/EC). Check your local authority for recycling advice and facilities (Europe only).

Battery Safety Information

In exceptional circumstances, batteries may leak fluids that can cause a chemical burn injury or ruin your product. To avoid battery leakage:

- Do not mix old and new batteries or batteries of different types: alkaline, standard (carbon-zinc) or rechargeable (nickel-cadmium).
- Insert batteries as indicated inside the battery compartment.
- Remove batteries during long periods of non-use. Always remove exhausted batteries from the product. Dispose of batteries safely. Do not dispose of product in a fire. The batteries inside may explode or leak.
- Never short-circuit the battery terminals.
- Use only batteries of the same or equivalent type as recommended.
- Do not charge non-rechargeable batteries.
- Remove rechargeable batteries from the product before charging.
- If removeable, rechargeable batteries are used, they are only to be charged under adult supervision.

Features

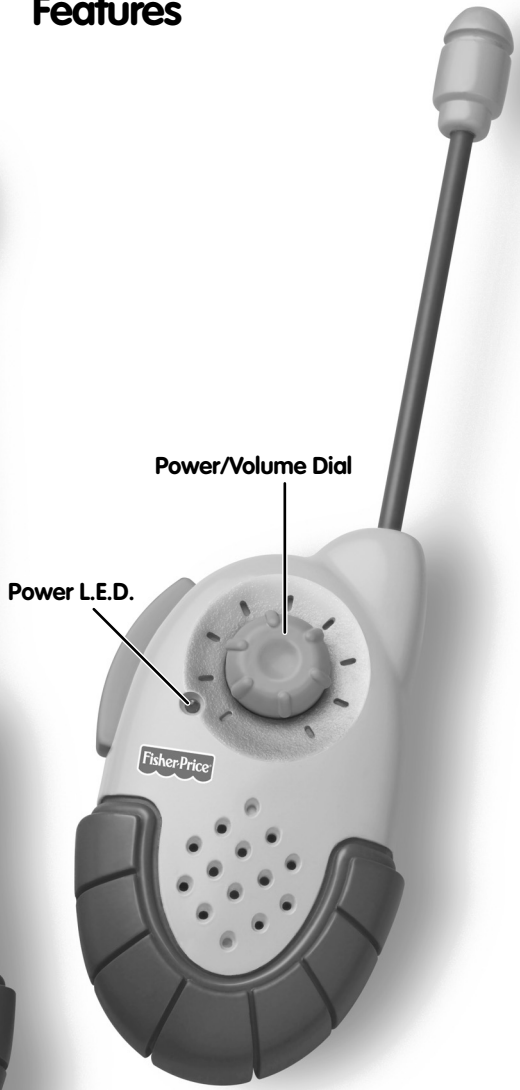
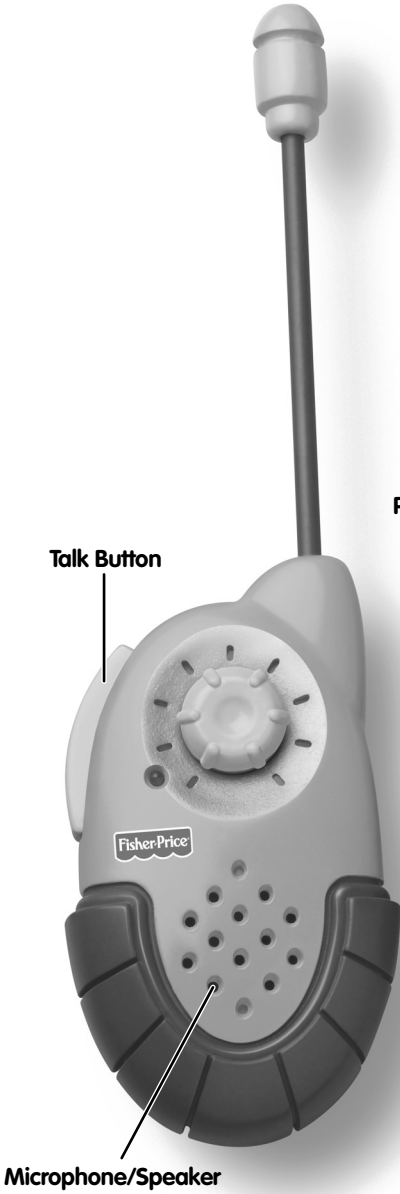

- **Power/Volume Dial** – Turn the dial to turn power ON and adjust the volume level.
- **Power L.E.D.** – Indicates that power is ON.
- **Talk Button** – Press and hold while talking into the microphone.



CONSUMER ASSISTANCE

Call toll free: 1-800-432-5437 (US & Canada only)
M-F 9AM to 7PM / SAT 11AM to 5PM (EST)

 service.fisher-price.com

Write to us at: Fisher-Price® Consumer Relations,
636 Girard Avenue, East Aurora, New York 14052.

Hearing-impaired consumers using TTY/TDD equipment,
please call 1-800-382-7470.

For countries outside the United States:

Canada: Mattel Canada Inc., 6155 Freemont Blvd.,
Mississauga, Ontario L5R 3W2; www.service.mattel.com.

Great Britain: Mattel UK Ltd, Vanwall Business Park,
Maidenhead SL6 4UB. Helpline: 01628 500303,
www.service.mattel.com/uk

Australia: Mattel Australia Pty. Ltd., 658 Church Street,
Locked Bag #870, Richmond, Victoria 3121 Australia.
Consumer Advisory Service 1300 135 312.

New Zealand: 16-18 William Pickering Drive,
Albany 1331, Auckland.

Asia: Mattel East Asia Ltd, Room 1106, South Tower,
World Finance Centre, Harbour City, Tsimshatsui, HK, China.

Care

- Wipe the toy with a clean cloth dampened with a mild soap and water solution.
- Do not immerse the toy.
- This product has no consumer serviceable parts. Do not take this product apart.

ICES-003

This Class B digital apparatus complies with Canadian ICES-003. Operation is subject to the following two conditions: (1) this device may not cause harmful interference and (2) this device must accept any interference received, including interference that may cause undesired operation.

This Category II radiocommunication device complies with Industry Canada Standard RSS-310.

NMB-003

Cet appareil numérique de la classe B est conforme à la norme NMB-003 du Canada. L'utilisation de ce dispositif est autorisée seulement aux conditions suivantes: (1) il ne doit pas produire de brouillage et (2) l'utilisateur du dispositif doit être prêt à accepter tout brouillage radioélectrique reçu, même si ce brouillage est susceptible de compromettre le fonctionnement du dispositif.

Ce dispositif de radiocommunication de catégorie II respecte la norme CNR-310 d'Industrie Canada.

Fisher-Price, Inc., a subsidiary of Mattel, Inc.,
East Aurora, NY 14052 U.S.A.

©2008 Mattel, Inc. All Rights Reserved.

© and ™ designate U.S. trademarks of Mattel, Inc.

Tough for Talking



- Turn the power/volume dial on the front of each walkie talkie to turn them on. The power L.E.D. lights to indicate that power is ON.
- Press and hold the talk button on the side of the walkie talkie and talk into the microphone.
- Release the talk button to listen to a response from the other walkie talkie!
- Walkie talkie range is dependant on environmental conditions. The range of the walkie talkies will be shorter when used indoors than it will when used outdoors.
- After five minutes of inactivity, the walkie talkies will go into sleep mode. Press the talk button to turn it back on.

IMPORTANT! Always remember that you are using public frequencies when using these walkie talkies. You may find that this product will occasionally pick up transmissions from other transmitting devices using the same frequency.

FCC Statement (United States Only)

This equipment has been tested and found to comply with the limits for a Class B digital device, pursuant to Part 15 of the FCC Rules. These limits are designed to provide reasonable protection against harmful interference in a residential installation. This equipment generates, uses and can radiate radio frequency energy and, if not installed and used in accordance with the instructions, may cause harmful interference to radio communications. However, there is no guarantee that interference will not occur in a particular installation. If this equipment does cause harmful interference to radio or television reception, which can be determined by turning the equipment off and on, the user is encouraged to try to correct the interference by one or more of the following measures:

- Reorient or relocate the receiving antenna.
- Increase the separation between the equipment and receiver.
- Consult the dealer or an experienced radio/TV technician for help.

Note: Changes or modifications not expressly approved by the manufacturer responsible for compliance could void the user's authority to operate the equipment.

This device complies with Part 15 of the FCC Rules. Operation is subject to the following two conditions: (1) this device may not cause harmful interference and (2) this device must accept any interference received, including interference that may cause undesired operation.

Troubleshooting Guide

Problem	Cause	Solution
Excessive static	Interference from vehicles, power lines, fluorescent lights, electric motors or dimmer switches	Change your location.
		Point the antenna in a different direction.
Can hear other people talking	Transmissions on the same frequency as this product	This product operates on a public frequency and may occasionally pick up transmissions from other transmitting devices on the same frequency.
Walkie talkie does not work	Walkie talkie power is off	Make sure both walkie talkies' power is on
	Battery power is low	Replace the exhausted battery in each walkie talkie. See Battery Installation section on this sheet.
	Walkie talkies are out of range	The walkie talkies can transmit up to 200 feet. Decrease the distance between the units.
Walkie talkie range decreases	Units do not transmit well through large objects	Indoor range may be lower because of walls or large objects between the walkie talkies. Make sure there is a clear path between the units.
	Battery power is low	Replace the exhausted battery in each walkie talkie. See Battery Installation section on this sheet.
Power L.E.D. is off	Power is OFF	Turn the power/volume dial to the ON position.
	Walkie talkie is in sleep mode	The walkie talkie goes into sleep mode after 5 minutes of inactivity. Press the talk button to "wake it up".
	Battery power is low	Replace the exhausted battery in the walkie talkie. See Battery Installation section on this sheet.