

Fisher-Price®

T4837

IMPORTANT!

DANGER

To prevent electric shock, do not immerse in water; wipe clean with damp cloth.

WARNING

To prevent strangulation with power cord, never place transmitter within reach of child.

CAUTION

This product cannot replace responsible adult supervision.



www.fisher-price.com

Consumer Information

- For proper setup and use, please read these instructions.
- Please keep this instruction sheet for future reference, as it contains important information.
- Transmitter operates on AC current (use enclosed AC adaptor).
- Receiver operates on AC current (use enclosed AC adaptors) or DC current (three "AAA" LR03 alkaline batteries, not included).
- Adult assembly is required.
- Tool needed for receiver battery installation: Phillips screwdriver (not included).
- This product is not intended to be used as a medical monitor and its use should not replace adult supervision.
- Test sound reception of receiver before first-time use and whenever you change location of the transmitter.
- To prevent entanglement:
 - Never place transmitter in a crib or playpen. Keep transmitter and receiver out of baby's reach.
 - Never use extension cords with the AC adaptors.
- **Adults Note:** Periodically examine the AC adaptors for damage to the cord, housing or other parts that may result in the risk of fire, electric shock or injury. If an AC adaptor is damaged, do not use it.
- Never use transmitter or receiver near water (i.e. bathtub, sink, wet basement, etc.).
- Always use the transmitter and receiver where there is adequate ventilation. To prevent overheating, keep the transmitter and receiver away from heat sources such as radiators, heat registers, direct sunlight, stoves, amplifiers, or other appliances which produce heat.
- Do not connect the transmitter or the receiver (if AC adaptor is used) to more than the recommended number of power supplies.
- The AC adaptor is not a toy.
- Disconnect the AC adaptor from the receiver before cleaning.
- Fisher-Price® does not recommend the use of two monitors in one house.
- Always remember that you are using public airwaves when using your monitor. Conversations, even from rooms near your transmitter, may broadcast to other nursery monitors, radios, cordless telephones or scanners outside your home. To protect the privacy of your home, always turn off the transmitter when not in use.
- Carrier Frequency - 49.8 MHz
- Product features and decoration may vary from photos.



 **CONSUMER ASSISTANCE**
AYUDA AL CONSUMIDOR
SERVICE À LA CLIENTÈLE
1-800-432-5437 (US & Canada)

 **service.fisher-price.com**

Fisher-Price, Inc., 636 Girard Avenue, East Aurora, NY 14052.
Hearing-impaired consumers/Clients con problemas auditivos/
Pour les malentendants : 1-800-382-7470.
En México: 59-05-51-00 Ext. 5205 ó 01-800-463-59-89

Features

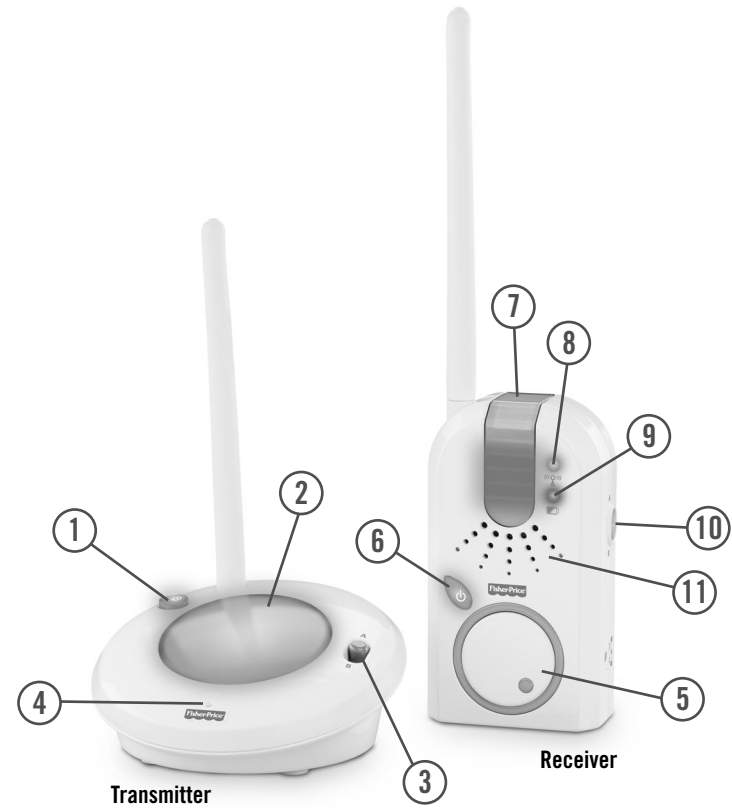

Transmitter

Receiver



Back View

Features

- ① Power Button
- ② Nightlight – press to turn on a soft glow.
- ③ Channel Switch
- ④ Microphone
- ⑤ Power/Volume Dial
- ⑥ Power L.E.D.
- ⑦ Sound Lights (on front and back of receiver) – watch the light to see baby’s sounds.
- ⑧ Range Indicator – lights when power is on and receiver is in range of the transmitter. Flashing light indicates the receiver is out of range.
- ⑨ Low Battery Indicator – flashing light indicates batteries need to be replaced or use the AC adaptor.
- ⑩ Channel Switch
- ⑪ Speaker
- ⑫ Night Light Timer Switch - use timer to automatically shut off the night light after 30 minutes.
- ⑬ Clip (backside of receiver) - Fasten to your clothes to stay in touch with baby around the house or yard.

Assembly

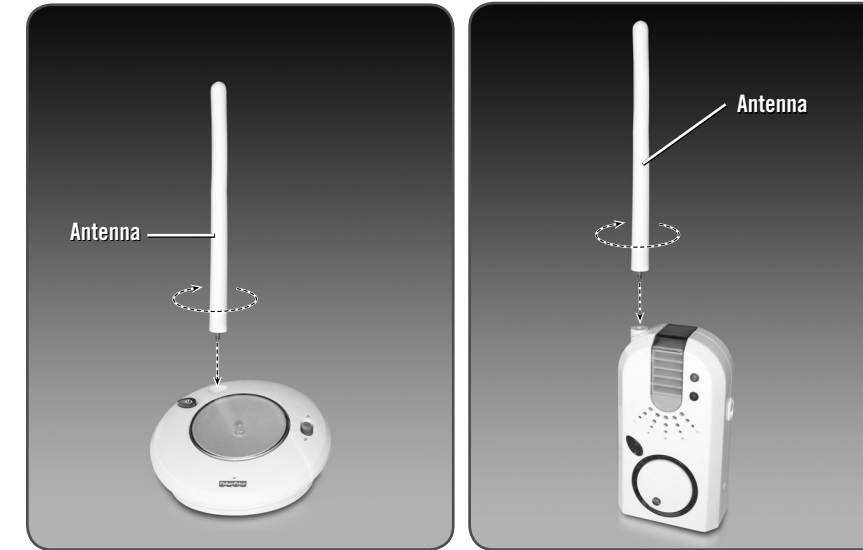

- Fit each antenna into the socket in the receiver and the transmitter. Turn the antennas to secure in place.

IMPORTANT! This product is designed to operate properly with the antennas provided. To reduce the chance of potential radio interference to other users, assemble and use only the antennas provided.

Receiver Battery Installation (Optional)

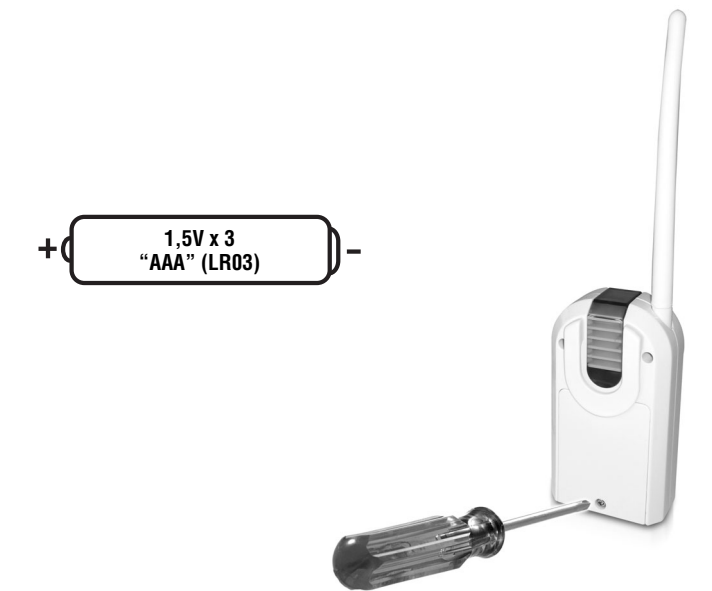

- Locate the battery compartment door on the back of the receiver.
- Loosen the screw in the battery compartment door with a Phillips screwdriver. Remove the battery compartment door.
- Insert three “AAA” (LR03) **alkaline** batteries into the battery compartment.
- Hint: We recommend using **alkaline** batteries for longer battery life.*
- Replace the battery compartment door. Tighten the screw with a Phillips screwdriver. Do not over-tighten.

Battery Safety Information

In exceptional circumstances, batteries may leak fluids that can cause a chemical burn injury or ruin your product. To avoid battery leakage:

- Do not mix old and new batteries or batteries of different types: alkaline, standard (carbon-zinc) or rechargeable (nickel-cadmium).
- Insert batteries as indicated inside the battery compartment.
- Remove batteries during long periods of non-use. Always remove exhausted batteries from the product. Dispose of batteries safely. Do not dispose of this product in a fire. The batteries inside may explode or leak.
- Never short-circuit the battery terminals.
- Use only batteries of the same or equivalent type, as recommended.
- Do not charge non-rechargeable batteries.
- Remove rechargeable batteries from the product before charging.
- If removable, rechargeable batteries are used, they are only to be charged under adult supervision.

Care

- Excess dirt in the transmitter microphone will hamper transmission of sound. Clean the outer surface of the transmitter and the receiver with a cloth lightly dampened with a mild cleaning solution.
- Never immerse the transmitter, receiver or AC adaptor.



- Protect the environment by not disposing of this product with household waste (2002/96/EC). Check your local authority for recycling advice and facilities (Europe only).

Setup

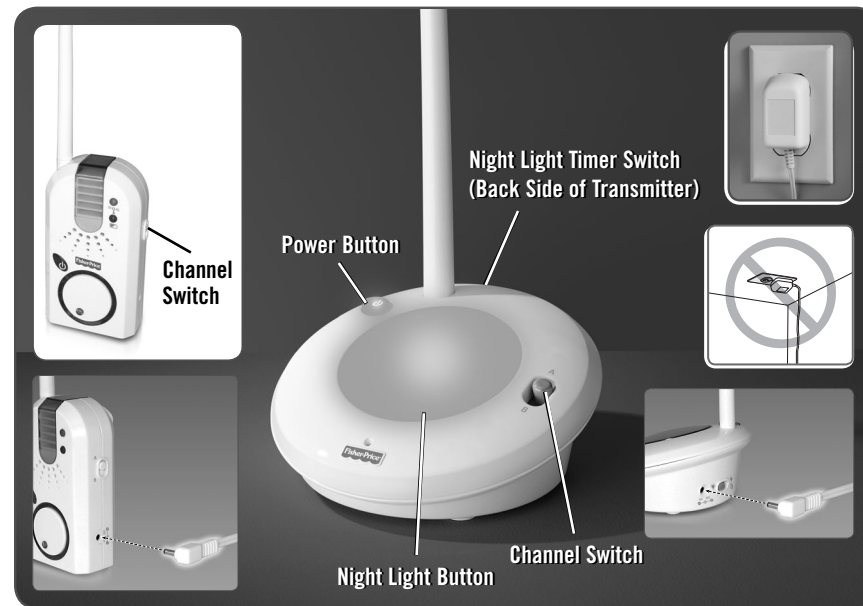

- Set the transmitter channel switch to the same channel as the receiver(s).
- Place the transmitter in the same room with child. Point the microphone towards the crib or play area.
- Unwrap and fully extend the AC adaptor for best transmission. Insert the AC adaptor pin into the DC input jack on the transmitter and plug the power cord into a standard wall outlet. Use the power cord only in a wall outlet. Do not plug into a ceiling outlet.
- Press the transmitter power button to turn the power ON (the button lights up).
- Press the night light button for a soft, glowing light. (Press again to turn off the night light.)
- Slide the night light timer switch to turn the timer on. When the timer is on the night light will automatically shut off after 30 minutes.

Testing Sound Reception

Test transmitter and receiver reception each time you change location of use.



- Place the transmitter in the room where you intend to use it.
- Press the transmitter power button to turn the power ON (the button lights up).
- Set the transmitter channel switch to the **same** channel as the receiver. Turn on a radio.

Testing Sound Reception



- Place the receiver in the room where you intend to use it.
- Rotate the power/volume dial to turn the power ON. Wait a few seconds to see if you have a good signal. If the range indicator light turns on, you are out of range. First try switching to a different channel on both the receiver and transmitter. If the range indicator stays on, move the receiver closer to the transmitter.

Setup



- Place the receiver where you can see and hear it.
- Unwrap and fully extend the AC adaptor cord for best reception. Insert the AC adaptor pin into the DC input jack on the receiver and plug into a standard wall outlet.
Note: To use battery power, refer to the Receiver Battery Installation section.
- Turn the power/volume dial up to turn the power ON. The power light will light up. Adjust the volume as needed.
Hint: If you are using battery power and the battery power is low, the low battery indicator will flash. Replace the batteries with three, new **alkaline** "AAA" (LR03) batteries or use the AC adaptor as a power source.
- When sound is picked up by the receiver, the sound lights turn on.
 - One or two lights indicate quieter sounds.
 - Three or more lights indicate louder sounds.
- Clip the receiver onto your clothes to stay in touch with baby around your house or yard.
Hint: The receiver's range is up to 500 feet (152 m) away from the transmitter. The range indicator will turn on and you will hear a tone when the receiver is out of range.

Problems & Solutions

Problem	Solution
Transmitter range indicator light flashes	Receiver is out of range of transmitter. Move receiver closer to transmitter. Note: Range varies depending on surrounding conditions such as noise levels, physical obstructions and signal interference.
	Transmitter power is off. Turn transmitter power on.
	Channel switches are on different channels. Make sure channel switches on both transmitter and receiver are set to same channel.
	Loose power cord connection and transmitter power is off. Check transmitter power cord plug-to-outlet connection.
	No power to wall outlet and transmitter power is off. Make sure light switch that controls power flow to wall outlet is on.
Receiver power indicator does not light	Power is off because circuit breaker for room is off. Make sure house fuses and circuit breakers are on.
	Receiver power is off. Turn receiver power on.
	Batteries in receiver are weak or dead. Replace all batteries with three "AAA" (LR03) alkaline batteries or use the AC adaptor as a power source.
	Power is off because circuit breaker for room is off. Make sure house fuses and circuit breakers are on.
Receiver low battery indicator light flashes	No power to wall outlet and power is off. Make sure light switch that controls power flow to wall outlet is on.
	Batteries in receiver are weak or dead. Replace all batteries with three "AAA" (LR03) alkaline batteries or use the AC adaptor as a power source.
Transmitter power L.E.D. does not light at all	Transmitter power is off. Turn transmitter power on.
	Loose power cord connection and transmitter power is off. Check transmitter power cord plug-to-outlet connection.
	No power to wall outlet and transmitter power is off. Make sure light switch that controls power flow to wall outlet is on.
You can hear conversations or sounds from other homes	Power is off because circuit breaker for baby's room is off. Make sure house fuses and circuit breakers are on.
	There is signal interference due to other nursery monitors on same channel or cordless telephone use. Change channel switches on both transmitter and receiver to eliminate source of interference.

Hint: If, after checking all of these solutions, you believe that your transmitter power cord or AC adaptor are damaged, please contact Fisher-Price®.

FCC Statement (United States Only)

This equipment has been tested and found to comply with the limits for a Class B digital device, pursuant to part 15 of the FCC rules. These limits are designed to provide reasonable protection against harmful interference in a residential installation. This equipment generates, uses and can radiate radio frequency energy and, if not installed and used in accordance with the instructions, may cause harmful interference to radio communications. However, there is no guarantee that interference will not occur in a particular installation. If this equipment does cause harmful interference to radio or television reception, which can be determined by turning the equipment off and on, the user is encouraged to try to correct the interference by one or more of the following measures:
Reorient or relocate the receiving antenna.
Increase the separation between the equipment and receiver.
Connect the equipment into an outlet on a circuit different from that to which the receiver is connected.
Consult the dealer or an experienced radio/TV technician for help.
Note: Changes or modifications not expressly approved by the manufacturer responsible for compliance could void the user's authority to operate the equipment.

Monitor
Model Number: T4837
This device complies with Part 15 of the FCC Rules. Operation is subject to the following two conditions:
(1) This device may not cause harmful interference and (2) this device must accept any interference received, including interference that may cause undesired operation.

Monitor
Consumer Relations Department
636 Girard Avenue
East Aurora, New York 14052, U.S.A.

Énoncé de la FCC (États-Unis seulement)

Cet équipement a été testé et jugé conforme aux limites de Classe B pour un appareil numérique, en vertu de l'article 15 de la réglementation de la FCC. Ces limites ont été instaurées pour fournir une protection raisonnable contre toute interférence nuisible dans une installation résidentielle. Cet équipement génère, utilise et peut émettre de l'énergie radiofréquence. S'il n'est pas installé et utilisé conformément aux instructions, il peut provoquer des interférences sur les communications radio. Cependant, il n'est pas garanti que des interférences ne se produiront pas dans certaines installations. Si cet équipement cause des interférences à la réception radio ou télévisée (ce qui peut être vérifié en éteignant l'appareil puis en le remettant sous tension), l'utilisateur peut tenter de les résoudre en suivant une ou plusieurs des mesures ci-après :
Réorienter ou déplacer l'antenne réceptrice.
Augmenter l'espace entre l'appareil et le récepteur.
Brancher l'appareil à une prise de courant différente de celle sur laquelle le récepteur est branché.
Pour obtenir de l'aide, contacter le vendeur ou un technicien radio/télévision expérimenté.
REMARQUE : Toute modification non autorisée expressément par le fabricant responsable de la conformité peut annuler le droit de l'utilisateur à faire fonctionner le produit.

Moniteur
Numéro de produit : T4837
Cet appareil est conforme à l'article 15 de la réglementation de la FCC. L'utilisation de ce dispositif est autorisée seulement aux deux conditions suivantes : (1) il ne doit pas produire de brouillage nuisible, et (2) l'utilisateur du dispositif doit être prêt à accepter tout brouillage radioélectrique reçu, même si ce brouillage est susceptible de compromettre le fonctionnement du dispositif.

Moniteur
Service à la clientèle
636 Girard Avenue
East Aurora, New York 14052, États-Unis

RSS-310

This Category II radio communication device complies with Industry Canada Standard RSS-310. Operation is subject to the following two conditions: (1) this device may not cause harmful interference and (2) this device must accept any interference received, including interference that may cause undesired operation.

ICES-003

This Class B digital apparatus complies with Canadian ICES-003. Operation is subject to the following two conditions: (1) this device may not cause harmful interference and (2) this device must accept any interference received, including interference that may cause undesired operation.

CNR-310

Ce dispositif de radiocommunication de catégorie II respecte la norme CNR-310 d'Industrie Canada. L'utilisation de ce dispositif est autorisée seulement aux conditions suivantes : (1) il ne doit pas produire de brouillage et (2) l'utilisateur du dispositif doit être prêt à accepter tout brouillage radioélectrique reçu, même si ce brouillage est susceptible de compromettre le fonctionnement du dispositif.

NMB-003

Cet appareil numérique de la classe B est conforme à la norme NMB-003 du Canada. L'utilisation de ce dispositif est autorisée seulement aux conditions suivantes : (1) il ne doit pas produire de brouillage et (2) l'utilisateur du dispositif doit être prêt à accepter tout brouillage radioélectrique reçu, même si ce brouillage est susceptible de compromettre le fonctionnement du dispositif.