



T4841



IMPORTANT!



DANGER

To prevent electric shock, do not immerse in water; wipe clean with damp cloth.



WARNING

To prevent strangulation with power cord, never place transmitter within reach of child.



CAUTION

This product cannot replace responsible adult supervision.

IMPORTANT!

IMPORTANT! Fully charge the receiver (with battery pack inside) for **five hours before first-time use.**

- For proper setup and use, please read these instructions.
- Please keep this instruction sheet for future reference, as it contains important information.
- Transmitter operates on AC current. Receiver operates on AC current (use enclosed AC adaptor/charger) or 3.6V NiMH rechargeable battery pack (inside receiver).
- Adult setup is required.
- This product is not intended to be used as a medical monitor and its use should not replace adult supervision.
- Test sound reception of receiver before first-time use and whenever you change location of the transmitter.
- To prevent entanglement:
 - Never place transmitter in a crib or playpen. Keep transmitter and receiver out of baby's reach.
 - Never use extension cords with the AC adaptor/charger.
- **Adults Note:** Periodically examine the transmitter and the AC adaptor/charger for damage to the cord, housing or other parts that may result in the risk of fire, electric shock or injury. If the transmitter or AC adaptor/charger is damaged, do not use monitor (if transmitter is damaged) or AC adaptor/charger. Use battery power as the power source in the receiver.
- Never use transmitter or receiver near water (i.e. bathtub, sink, wet basement, etc.).
- Always use the transmitter and receiver where there is adequate ventilation. To prevent overheating, keep the transmitter and receiver away from heat sources such as radiators, heat registers, direct sunlight, fire, stoves amplifiers, or other appliances which produce heat.
- Do not connect the transmitter or the receiver (if AC adaptor/charger is used) to more than the recommended number of power supplies.
- An AC adaptor/charger is not a toy.
- Disconnect the AC adaptor/charger from the receiver before cleaning.
- Fisher-Price® does not recommend the use of two monitors in one house.
- Always remember that you are using public airwaves when using your monitor. Conversations, even from rooms near your transmitter, may broadcast to other nursery monitors, radios, cordless telephones or scanners outside your home. To protect the privacy of your home, always turn off the transmitter when not in use.
- Carrier Frequency - 2,4 Ghz
- Product features and decoration may vary from photographs.



CONSUMER ASSISTANCE
AYUDA AL CONSUMIDOR
SERVICE À LA CLIENTÈLE
 1-800-432-5437 (US & Canada)

service.fisher-price.com

Fisher-Price, Inc., 636 Girard Avenue, East Aurora, NY 14052.
 Hearing-impaired consumers/Clients con problemas auditivos/
 Pour les malentendants : 1-800-382-7470.
 En México: 59-05-51-00 Ext. 5205 ó 01-800-463-59-89

Features



Transmitter

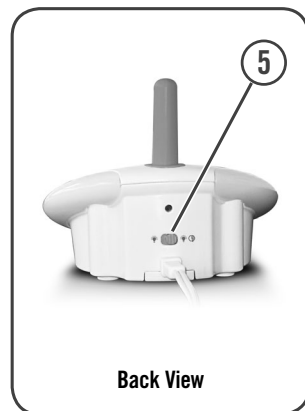

Back View



Receiver



Back View

Features

- ① Nightlight Button – press to turn on a soft glow.
- ② Nightlights
- ③ Power Button and L.E.D.
- ④ Microphone
- ⑤ Nightlight Timer Switch - Turn on for 30 minutes of light.
- ⑥ Volume Buttons - press to turn speaker volume up or down.
- ⑦ Speaker
- ⑧ Power Button and L.E.D.
- ⑨ Reset/Pair Button - Press on the transmitter and receiver if you have signal interference.
- ⑩ Speaker
- ⑪ Sound Lights – watch these lights to see baby's sounds.
- ⑫ Volume Buttons - press to turn transmitter volume up or down.
- ⑬ Range Indicator – lights when the receiver is out of range of transmitter or transmitter power is off.
- ⑭ Nap Timer/Clock Button - Press the bottom of the switch to start, stop and restart the nap timer; press and hold the top of the switch to clear the nap timer. Press and hold the bottom of the switch to set the time; press the top and bottom of the switch to make selections.
- ⑮ LCD Screen
- ⑯ Nightlight Button - press to turn on the transmitter nightlight.
- ⑰ Talk Button - press and hold to talk to baby.
- ⑱ Microphone - Use to talk to baby (after pressing the talk button).
- ⑲ Clip - (backside of receiver) - Fasten to your clothes to stay in touch with baby around the house or yard.



Charging the Battery (Inside the Receiver)



IMPORTANT! Fully charge each receiver (with battery pack inside) for **five hours before first-time use.**

- Use only the included AC adaptor/charger! Do not use any other adaptor charger.
- Fit the AC adaptor/charger pin into the DC input jack on a receiver.
- Plug the AC adaptor/charger into a standard wall outlet.

Notes: If power flow to the wall outlet is controlled by a switch, make sure the switch is "ON". Use the AC adaptor charger only in a wall outlet. Do not plug the AC adaptor/charger into a ceiling outlet. To connect to a supply that is not in the United States, use an adaptor (not included and sold separately) with the proper configuration for the power outlet.

- If you are monitoring baby while charging the battery pack, you will see the charging icon  on the LCD screen. The charge complete icon  will indicate when the battery is fully charged.

Battery Safety Information

In exceptional circumstances, batteries may leak fluids that can cause a chemical burn injury or ruin your product. To avoid battery leakage:

- If replacing the battery pack, insert it as indicated inside the battery compartment.
- Always remove an exhausted battery pack from the product. Dispose of the battery pack safely. Do not dispose of this product in a fire. The battery pack inside may explode or leak. Contact Fisher-Price® Consumer Relations at www.service.fisher-price.com or call 1-800-432-5437 to purchase a battery pack.
- Never short-circuit the battery pack terminals.
- Use only batteries of the same type, as recommended.



- To remove the battery pack, loosen both screws in the battery compartment door. Remove the door.
- Pull the battery wire connector from the socket in the receiver. Contact Fisher-Price® Consumer Relations at www.service.fisher-price.com or call 1-800-432-5437 to purchase a battery pack.

Testing Sound Reception

Test transmitter and receiver reception each time you change location of use.



- Place the transmitter in the room where you intend to use it.
- Press the transmitter power button to turn the power ON. The power L.E.D. lights.

Setup and Use

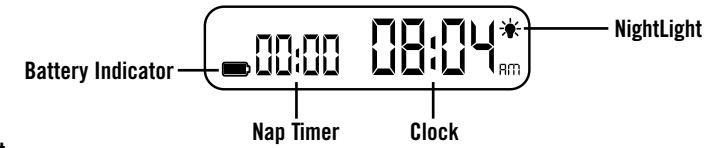

Clock Set

- Turn receiver power ON.
- Press and hold the bottom of the nap timer/clock button **NAP** to choose 12-hour or 24-hour clock format. Press the top of the nap timer/clock button to make a choice.
- Press the bottom of the nap timer/clock button **NAP**. The hour number on the clock will flash. Press the top of the nap timer/clock button to scroll through hour choices.
- Press the bottom of the nap timer/clock button **NAP**. The minute numbers on the clock will flash. Press the top of the nap timer/clock button to scroll through minute choices.
- Press the bottom of the nap timer/clock button **NAP** to confirm your selections and complete the clock setup.

Nap Timer

- Press the bottom of the nap timer/clock button **NAP** to start the nap timer. Press again to stop the time.
- Press and hold the top of the nap timer/clock button **NAP** to clear the timer.

Nightlight

- Press the nightlight button on the receiver to remotely turn on the transmitter nightlight. Press again to turn the nightlight off.
 - The nightlight indicator will display on the LCD screen when the nightlight is on.
- Note:** The nightlight will stay on until you turn it off. If you'd like to use the nightlight timer, slide the switch on the transmitter to the ON position and press the nightlight button again.

Battery Indicator(s)

- Displays the battery charge level of the receiver.



Testing Sound Reception

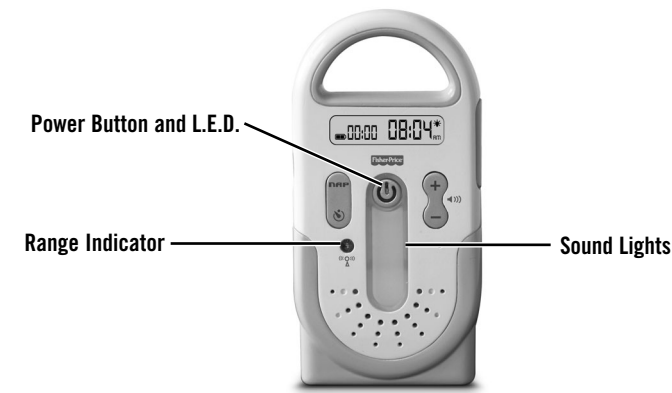

- Place a receiver in the room where you intend to use it.
- Press the power button to turn the power ON. Wait a few seconds to see if you have a good signal. If the range indicator light blinks along with beeping, you are out of range. Move the receiver closer to the transmitter.

Hint: If you'd like to use AC power, use the AC adaptor/charger.

- When sound is picked up by a receiver, the sound lights turn on.
 - One or two lights indicate quieter sounds.
 - Three or more lights indicate louder sounds.

Setup and Use

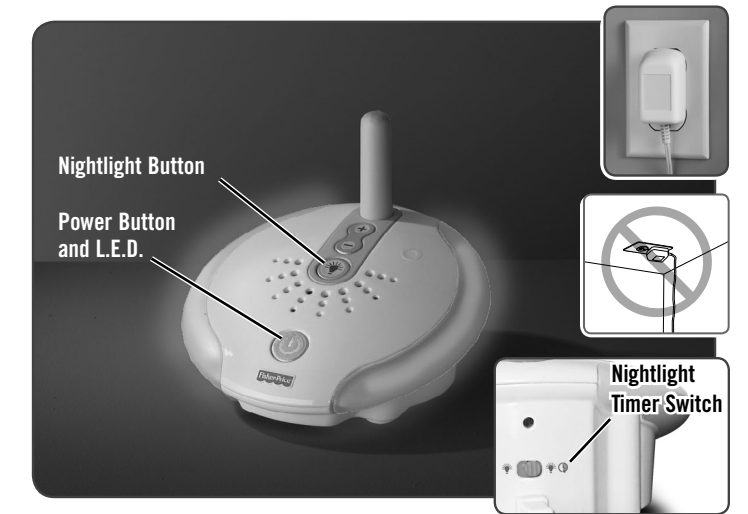

- Place the transmitter in the same room with child. Point the microphone towards the crib or play area.
- Unwrap and fully extend the power cord for best transmission. Plug the power cord into a standard wall outlet. Use the power cord only in a wall outlet. Do not plug into a ceiling outlet.
- Press the transmitter power button to turn the power ON. The power L.E.D. will light.
- Press the nightlight button for a soft, glowing light. Press again to turn the nightlight off.
- Slide the nightlight timer switch to turn the timer on. When the timer is on the nightlight will automatically shut off after 30 minutes. To turn the nightlight back on for another 30 minutes, simply press the nightlight button again.

Setup and Use



- Place a receiver where you can see and hear it.
- To use AC power, unwrap and fully extend the AC adaptor/charger cord for best reception. Insert the AC adaptor/charger pin into the DC input jack on the receiver and plug into a standard wall outlet.
- Press the power button to turn the power ON. Press the up and down volume buttons to adjust the volume as needed.
- Clip the receiver onto your clothes to stay in touch with baby around your house or yard.
Hint: The receiver's range is up to 700 feet (213 m) away from the transmitter. The range indicator will flash and you will hear beeping when the receiver is out of range.
- Press and hold the talk button **TALK** on the receiver. Talk into the microphone on the receiver to talk to baby.
Hint: If you'd like to increase or decrease the volume of your voice to baby, simply use the volume buttons on the receiver.

Problems & Solutions

Problem	Solution
Receiver range indicator light flashes and you hear beeping	Receiver is out of range of transmitter. Move receiver closer to transmitter. Note: Range varies depending on surrounding conditions such as noise levels, physical obstructions and signal interference.
	Transmitter power is off. Turn transmitter power on.
	Loose power cord connection and transmitter power is off. Check transmitter power cord plug-to-outlet connection.
	No power to wall outlet and transmitter power is off. Make sure light switch that controls power flow to wall outlet is on.
Receiver power L.E.D.	Power is off because circuit breaker for room is off. Make sure house fuses and circuit breakers are on.
	Receiver power is off. Turn receiver power on.
	The 3.6V NiMH battery pack (inside the receiver) is weak. Use the AC adaptor/charger as a power source as well as charge the battery.
Receiver low battery indicator appears on the screen	Power is off because circuit breaker for room is off. Make sure house fuses and circuit breakers are on.
	No power to wall outlet and power is off. Make sure light switch that controls power flow to wall outlet is on.
	The 3.6V NiMH battery pack (inside the receiver) is weak. Use the AC adaptor/charger as a power source and to charge the battery.
Transmitter power L.E.D. does not light at all	Transmitter power is off. Turn transmitter power on.
	Check transmitter power cord plug-to-outlet connection.
	No power to wall outlet and transmitter power is off. Make sure light switch that controls power flow to wall outlet is on.
You can hear conversations or sounds from other homes	Power is off because circuit breaker for baby's room is off. Make sure house fuses and circuit breakers are on.
	There is signal interference due to other nursery monitors on same channel or cordless telephone use. You may need to pair the receiver and transmitter. Press the pairing button on the side of the receiver with a paperclip until the power button L.E.D. blinks and the range indicator turns on. Then, press the pairing button on the back of the transmitter with a paperclip until the receiver range indicator turns off.
Clock/nap timer screen is not working or is functioning erratically	Reset the receiver by removing the battery and replacing it in the receiver.
My voice does not seem to be projecting from the transmitter in baby's room	Make sure you are pressing and holding the Talk button on the receiver
	Turn the volume up on the receiver.
	Make sure receiver power is ON.
	Release, press and hold the talk button and talk again.

Hint: If, after checking all of these solutions, you believe that your transmitter power cord or AC adaptor/charger are damaged, please contact Fisher-Price®.

FCC Statement (United States Only)

This equipment has been tested and found to comply with the limits for a Class B digital device, pursuant to part 15 of the FCC rules. These limits are designed to provide reasonable protection against harmful interference in a residential installation. This equipment generates, uses and can radiate radio frequency energy and, if not installed and used in accordance with the instructions, may cause harmful interference to radio communications. However, there is no guarantee that interference will not occur in a particular installation. If this equipment does cause harmful interference to radio or television reception, which can be determined by turning the equipment off and on, the user is encouraged to try to correct the interference by one or more of the following measures:

Reorient or relocate the receiving antenna.

Increase the separation between the equipment and receiver.

Connect the equipment into an outlet on a circuit different from that to which the receiver is connected.

Consult the dealer or an experienced radio/TV technician for help.

Note: Changes or modifications not expressly approved by the manufacturer responsible for compliance could void the user's authority to operate the equipment.

Monitor

Model Number: T4841

This device complies with Part 15 of the FCC Rules. Operation is subject to the following two conditions: (1) This device may not cause harmful interference and (2) this device must accept any interference received, including interference that may cause undesired operation.

Monitor

Consumer Relations Department

636 Girard Avenue

East Aurora, New York 14052, U.S.A.

To maintain compliance with the FCC's RF exposure guidelines, place the transmitter at least 20 cm from users.

ICES-003 NMB-003

- This Class B digital apparatus complies with Canadian ICES-003.
- Operation is subject to the following two conditions: (1) this device may not cause harmful interference and (2) this device must accept any interference received, including interference that may cause undesired operation.
- Cet appareil numérique de la classe B est conforme à la norme NMB-003 du Canada.
- L'utilisation de ce dispositif est autorisée seulement aux conditions suivantes : (1) il ne doit pas produire de brouillage et (2) l'utilisateur du dispositif doit être prêt à accepter tout brouillage radioélectrique reçu, même si ce brouillage est susceptible de compromettre le fonctionnement du dispositif.

Care

- Excess dirt in the transmitter microphone will hamper transmission of sound. Clean the outer surface of the transmitter and the receiver with a cloth lightly dampened with a mild cleaning solution.
- Never immerse the transmitter, receiver or AC adaptor/charger.
- Protect the environment by not disposing of this product with household waste (2002/96/EC). Check your local authority for recycling advice and facilities (Europe only).

