

6.Re-pairing: To touch the PAIR button on the control panel for re-pairing, meanwhile the indicator will flash, and there is voice prompt" Waiting for the pairing". then you can pair the MD2 with your Mobile, the voice prompt 【pairing completed】 after paired.

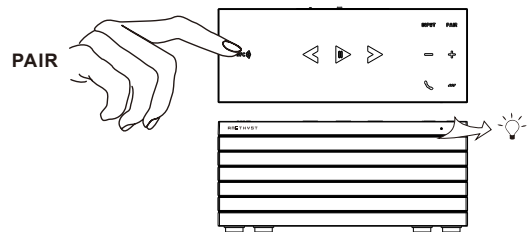

7. TF card: Insert the TF card when MD2 is on, the MD2 will play music from TF card automatically, or you can press input to select TF card, the front indicator will be orange, follow the step 4 to control the music playing.

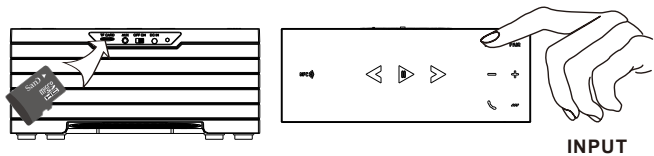

8.AUX input play: touch the INPUT button on the control panel till the indicator turn red and the unit will be connected to the AUX channel play. You can play music via 3.5mm from Mobile, MP3, and PC.

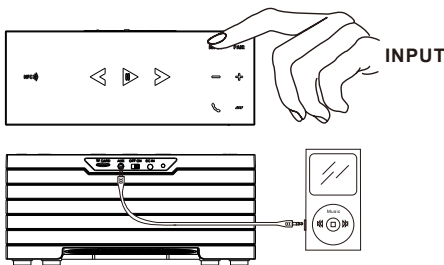

9.Built-in battery use: when using the built-in battery to play music, the unit will manage the battery use automatically, when the power is low, the unit will decrease the volume to ensure the sound quality and longer play time, and voice prompt(the battery is low please recharge) once in 1 minutes, the front indicator will be red and flash, When battery cannot support normal used unit will be power off after red indicator flash for 5 times

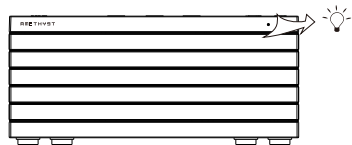

10.Charging: please use the supplied USB cable to connect USB port on PC (USB 2.0 ↑) or adaptor (output 1A), the red indicator on the back of the unit will flash when charging. When the battery is fully-charged, the green indicator will stop flash.

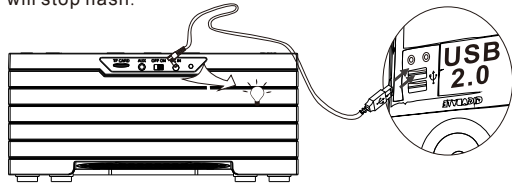

* NOTE

- 1.The Bluetooth device can't find the speaker, the speaker may still connect with last Blue tooth device or another device are searching and connecting with speaker at same time. Now you need to operate as Step 6 to re-connect it
2. If you hear intermittent sound or no sound from speaker after connection Please check if the distance from you and speakers are in communication range (8-10M without barrier)
- 3.Don't let Opposite close to speaker when you use speaker phone function to avoid Echo
- 4.Please use default music player with your blue tooth device system like, iPod, Samsung player, Windows media player. As lots of third party music player does not support smooth song change function, to avoid "pu"sound.
- 5.Not work with NFC: please make sure the mobile has NFC function and turn it on.
- 6.The phone case may influence the NFC function, please remove if you cannot connect NFC as well.

- 7.Please recharge on time when battery is low, for the device can work as well
- 8.Please recharge the batter in every three months if long times no use.
- 9.The speaker has high capacity batter inside please avoid the heat, wet, do not disassemble the battery or put in into water or fire.
- 10.If you have problem with NFC, please check:
 - 1)Make sure the mobile has NFC function,
 - 2)Make sure the NFC and Bluetooth is ON
 - 3)Make sure the NFC can activate the Bluetooth and audio in you mobile
 - 4)Make sure the mobile is unlocked
 - 5)Remove the phone case
 - 6)Use the right part of NFC on your mobile
 - 7)If the NFC found AMETHYST MD2 but can't connect, make sure MD2 is on and under Bluetooth mode
- 11.if you can not connect with speaker as well, please power it off for 3s then turn it on.
12. The USB port only used for supplying electrical voltage for operational power or recharging the internal batteries, not any data transfer between the PC

SPECIFICATIONS

Amplifier output power: 4W(RMS)X2
 Amplifier input sensitivity: ≤400mV
 Distortion: ≤1%
 Amplifier SNR: ≥ 75dB
 Frequency response: 70Hz~20KHz
 DC input: DC5V 0.5-1A
 Battery: 3.7V 2200mAh
 Battery time 6-10hours
 Battery charging time: 4-6hours
 Blue tooth range: 7-10M
 Bluetooth version: 2.1+EDR Support A2DP

Manufacturer:Foshan LANCHIYA Digital Technology Co., Ltd China
 Address : hongtu RD, Songxia Industry Park, Songgang Nanhai District, Foshan, Guangdong Province, China
 MADE IN CHINA

AMETHYST

MD2

USER MANUAL

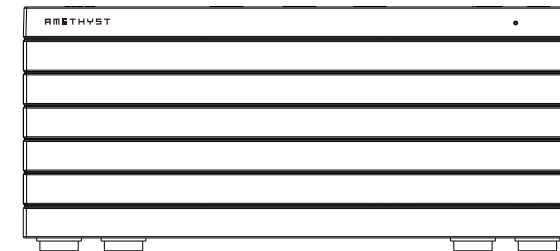

Please read this guide carefully before use

PROPERTY RIGHTS INFORMATION:

The trademark amethyst[®]lanchiya[®]and all the developed products with this label are registered patents, and belong to Foshan LANCHIYA digital Technology Co., Ltd. Our company reserves all rights, and not allow reprinting. Other concerned trademarks all belong to their proprietors. As to the constant update and development of the products, our company reserves the right to change and rework our products without notice.

WARNING: To prevent any fire or electrical hazards, do not remove or disassemble any parts from this unit. Please ensure that you use a qualified technician to service it.

- Do not expose the unit to rain, water or moisture
- Do not place liquid on or close to unit
- Do not place unit on or near an open fire such as candles or light
- Keep away from heat and dust
- Place unit on a stable and level platform
- Do not place any items on top of unit
- Do not use excessive force when pushing the unit buttons
- Do not attempt to pull the power cord from a distance to shut the power
- The unit with Lithium Battery in please don't burn, bite, Keep away from Children and dispose in appointed place for battery
- Secure all cords and connections and do not use pinched or defective one
- Unplug the power cable if the unit is left unused for extended periods
- Clean with a damp cloth only
- Blue tooth device can't be found: probably, the Speaker has been connected by other Blue tooth device. Press Pair button to search it again. If you still cannot find the speaker, please Turn Off the speaker for 5second then turn it on.
- Blue tooth signal intermittently: the effective distance between speaker and Device is 10M, the signal will be intermittent if the distance more than 10M.
- If there are more than 1 Speaker are switch on, the Bluetooth device will find more than 1 speaker, if you want to connect one of them please turn off the others
- If your Bluetooth device on searching and find many other Bluetooth device, please wait for the searching finished and select Speaker to pair.

COMPLIANCE WITH FCC REGULATIONS

This device complies with Part 15 of the FCC Rules. Operation is subject to the following two conditions:

- (1) this device may not cause harmful interference, and
- (2) this device must accept any interference received, including interference that may cause undesired operation.

The user manual for an intentional or unintentional radiator shall caution the user that changes or modifications not expressly approved by the party responsible for compliance could void the user's authority to operate the equipment.

Caution: The user is cautioned that changes or modifications not expressly approved by the party responsible for compliance could void the user's authority to operate the equipment.

NOTE: This equipment has been tested and found to comply with the limits for a Class B digital device, pursuant to Part 15 of the FCC Rules. These limits are designed to provide reasonable protection against harmful interference in a residential installation. This equipment generates, uses and can radiate radio frequency energy and, if not installed and used in accordance with the instructions, may cause harmful interference to radio communications. However, there is no guarantee that interference will not occur in a particular installation. If this equipment does cause harmful interference to radio or television reception, which can be determined by turning the equipment off and on, the user is encouraged to try to correct the interference by one or more of the following measures:

- Reorient or relocate the receiving antenna.
- Increase the separation between the equipment and receiver.
- Connect the equipment into an outlet on a circuit different from that to which the receiver is connected.
- Consult the dealer or an experienced radio/TV technician for help.

This equipment complies with FCC's RF radiation exposure limits set forth for an uncontrolled environment. The antenna(s) used for this transmitter must be installed and operated to provide a separation distance of at least 20 cm from all persons and must not be collocated or operating in conjunction with any other antenna or transmitter. Installers must ensure that 20cm separation distance will be maintained between the device (excluding its handset) and users.

"batteries shall not be exposed to excessive heat such as sunshine, fire or the like." "the apparatus shall not be exposed to dripping or splashing and that no objects filled with liquids, such as vases, shall be placed on the apparatus."

"CAUTION

Danger of explosion if battery is incorrectly replaced.

Replace only with the same or equivalent type."

where the MAINS plug or an appliance coupler is used as the disconnect device, the disconnect device shall remain readily operable

This equipment complies with FCC radiation exposure limits set forth for an uncontrolled environment.

This transmitter must not be co-located or operating in conjunction with any other antenna or transmitter.

PACKAGE CONTENTS

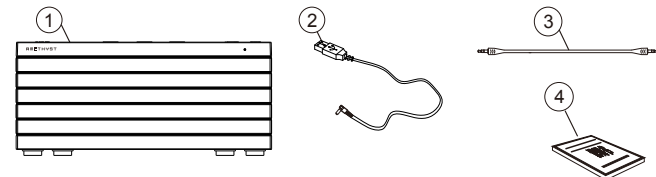

1.MD2 machine 2. Power adapter 3.Audio cable 4.User manual

Brief Operation Introduction

- 1.Power-on Operation:** After switching MD2 on, the Music and voice prompt (The Blue tooth mode is on) the indicate light on the front panel is flashing between blue and red, MD2 starts to search the device that connected last time. If the searching is successful, MD2 will connect automatically with the device, and voices *prompt "paired"*. MD2 will play the music through the device. If the MD2 can't find the last paired device in 5s, MD2 will be in the status of being searched by other devices, and the indicator will be blue

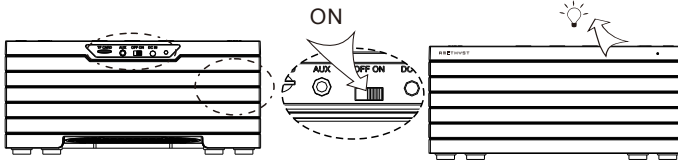

2.Connecting by NFC:

- 1). Make sure the MD2 is On and in Bluetooth channel.
- 2). Make sure the Cell phone have NFC communication which can activate the Bluetooth to pair and audio connection.
- 3) Make sure the screen of cell phone is unlocked.
- 4) Make sure the NFC and Bluetooth in your cell phone is on
- 5) Make the NFC parts of cell phone and MD2 touch each other for 2second (if you can't make sure where is NFC part of your cell phone please google it, or move your cell phone on MD2 NFC part until it connected) the cell phone will show connect it or not on screen, press yes then you can move the cell phone and wait 5-8s, the cell phone will connect it with speaker and voice prompt Paired, then you can play music from your cell phone, (Note: of the cell phone has paired with MD2, it won't show connect it or not but connected or disconnected)

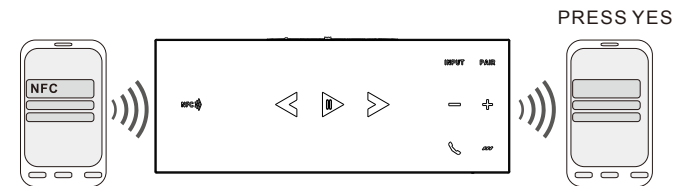

- 3.Connecting by Bluetooth:** Search and find 【AMETHYST MD2】 with your Bluetooth device after turn it on connect it The voice Prompt "paired" .Then you can play music from your Bluetooth device . If your device can not find the MD2, Press "Pair" on the top of MD2, voice prompt "Waiting for the pair" , then you can try to pair it.

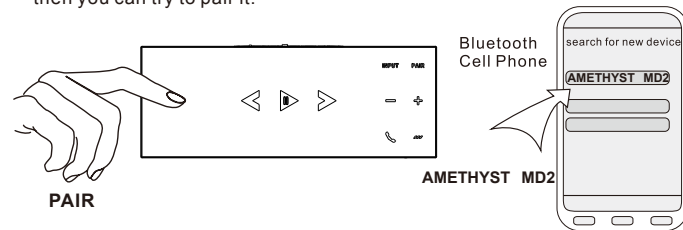

- 4. Music-playing operation:** When MD2 has successfully connected to the Bluetooth device properly, you can control the music-playing of the mobiles through touching the VOL+, VOL- PREV,NEXT,PLAY/PAUSE button on the touching panel



- 5.Incoming-call operation:** When the call comes in during playing music, answer the call by touching the button 【PHONE】 on the touching panel and talk facing the top panel; or dial the receiver button on the mobile and choose to use mobile to answer the call

