

5. Speaker Phone operation: When the call comes in during playing music, answer the call by touching the button [PHONE] on the touching panel and talk facing the top panel; or dial the receiver button on the mobile to use mobile to answer the call. Press and hold on [PHONE] for 2 seconds to hang up the phone during calling.

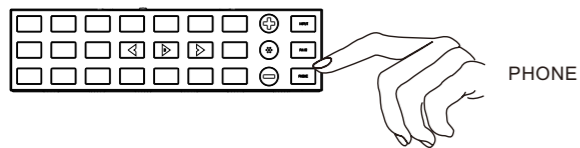

PHONE

6. Re-pairing: To touch the PAIR button on the control panel for re-pairing, meanwhile the indicator will flash, and there is voice prompt that the unit is ready to be paired. Please follow step 3 to do pairing.

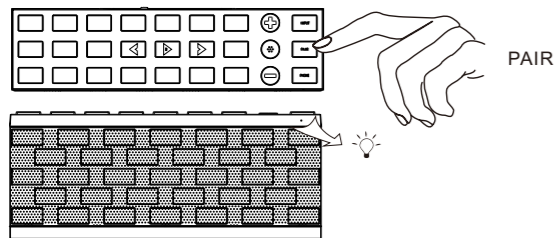

PAIR

7. AUX input play: Switch the M1 on, touch the INPUT button on the control panel, the indicator will flash once, and the unit will be connected to the AUX channel play. The music in mobiles, MP3, PC, etc can be played through 3.5mm audio cable. Press input again will turn to bluetooth channel and reconnect automatic.

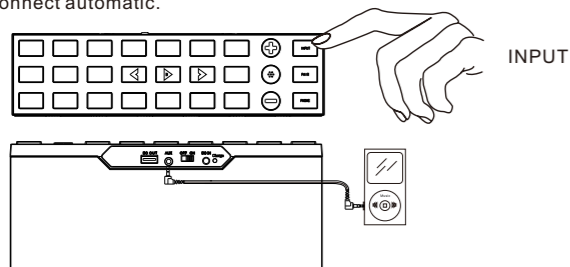

INPUT

8. DC5V Charging output: the unit provide standard USB port charging, with DC5V 1A charging current, which can charge mobiles, MP3, etc through USB cable.

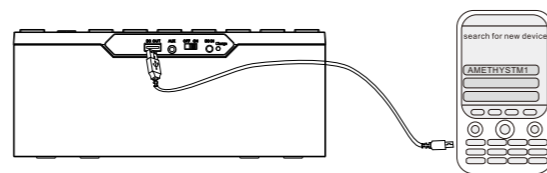

9. Built-in battery : when using the built-in battery to play music, the unit will manage the battery use automatically, when the power is low, the unit will decrease the volume to ensure the sound quality and longer play time; when the power is not enough to support normal play, the indicator will flash and the unit will be switch to standby, please use the proper power adaptor to charge the unit for normal use.

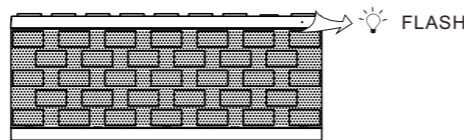

FLASH

10. Charging:, please use the supplied power adaptor to charging, the green indicator on the back of the unit will be flashing during charging. When the battery is fully-charged, the green indicator will stop flashing.

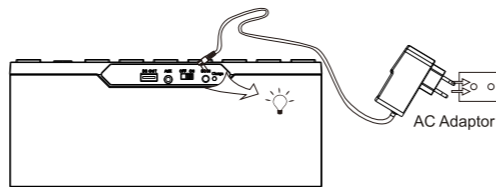

AC Adaptor

**\* NOTE**

1. The Bluetooth device can't find the speaker, the speaker may still connect with last Blue tooth device or another device are searching and connecting with speaker at same time. Now you need to operate as Step 3 to re-connect it.
2. If you hear intermittent sound or no sound from speaker after connection. Please check if the distance from you and speaker are over 10M (33FT)
3. To avoid echo when using the speaker phone function, do not place your phone near or in front of the M1 speaker.
4. For best results it is recommended that Bluetooth enabled music player that supports Apple iPod, iPhone, Samsung players, and Window media players be used. Other, third party supported media players may not support smooth song change functions, which may cause sound distortion or interruption between song tracks.
5. Please use power adaptor which provide from Lanchiya to avoid damage your speaker.
6. Please connect and disconnect adaptor when the switch is in OFF position
7. if your mobile doesn't support mobile ring transfer, you can only hear the M1 Built in ring voice " incoming call", when calling come in.

**SPECIFICATIONS**

Amplifier output power: left/right 1.5Wx2, subwoofer 3.5Wx1  
 Amplifier input sensitivity: <math>\leq 400\text{mV}</math>  
 Amplifier SNR:  $\geq 70\text{dB}$   
 Frequency response: 70Hz~20KHz  
 Power voltage: AC100-240V, 50/60Hz  
 Battery: 7.4V 1800mHA  
 Battery time 10hours  
 Battery charging time: 4-6hours  
 Blue tooth range: 7-10M(23-33FT)  
 Bluetooth version: 3.0 2.4G Support A2DP



AMETHYST INNOVATIONS CORPORATION  
 14731-J Franklin Avenue Tustin, CA. 92780  
 Phone: 714-731-2921  
 Website: [www.amethystinnovationscorp.com](http://www.amethystinnovationscorp.com)

**AMETHYST**

**M1**

**USER MANUAL**

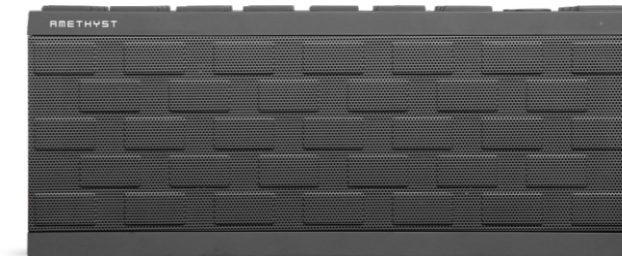

**Please read this guide carefully before use**

### PROPERTY RIGHTS INFORMATION:

The trademark amethyst<sup>®</sup>lanchiya<sup>®</sup> and all the developed products with this label are registered patents, and belong to Foshan LANCHIYA digital Technology Co., Ltd. Our company reserves all rights, and not allow reprinting. Other concerned trademarks all belong to their proprietors. As to the constant update and development of the products, our company reserves the right to change and rework our products without notice.

### SAFETY INSTRUCTIONS:

To ensure your safety and enjoyment, read and follow the safety instructions and use in the directed manner. Keep this manual for future reference.

**WARNING: To prevent any fire or electrical hazards, do not remove or disassemble any parts from this unit. Please ensure that you use a qualified technician to service it.**

- Do not expose the unit to rain, water or moisture
- Do not place liquid on or close to unit
- Do not place unit on or near an open fire such as candles or light
- Keep away from heat and dust
- Place unit on a stable and level platform
- Do not place any items on top of unit
- Do not use excessive force when pushing the unit buttons
- Do not attempt to pull the power cord from a distance to shut the power
- The unit with Lithium Battery in please don't burn, bite, Keep away from Children and dispose in appointed place for battery
- Secure all cords and connections and do not use pinched or defective one
- Unplug the power cord if the unit is left unused for extended periods
- Clean with a damp cloth only
- Operating temperature 0°C-55°C (32°F~131°F)
- Blue tooth device can't be found: probably, the Speaker has been connected by other Blue tooth device. Press Pair button to search it again. If you still cannot find the speaker, please Turn Off the speaker for 5second then turn it on.
- Blue tooth signal intermittently: the effective distance between speaker and Device is 10M, the signal will be intermittent if the distance more than 10M (33FT).
- If there are more than 1 Speaker are switch on, the Bluetooth device will find more than 1 speaker, if you want to connect one of them please turn off the others
- If your Bluetooth device on searching and find many other Bluetooth device, please wait for the searching finished and select Speaker to pair.

### COMPLIANCE WITH FCC REGULATIONS

This device complies with Part 15 of the FCC Rules. Operation is subject to the following two conditions:

- (1) this device may not cause harmful interference, and
- (2) this device must accept any interference received, including interference that may cause undesired operation.

**Caution:** The user is cautioned that changes or modifications not expressly approved by the party responsible for compliance could void the user's authority to operate the equipment.

**NOTE:** This equipment has been tested and found to comply with the limits for a Class B digital device, pursuant to Part 15 of the FCC Rules. These limits are designed to provide reasonable protection against harmful interference in a residential installation. This equipment generates, uses and can radiate radio frequency energy and, if not installed and used in accordance with the instructions, may cause harmful interference to radio communications. However, there is no guarantee that interference will not occur in a particular installation. If this equipment does cause harmful interference to radio or television reception, which can be determined by turning the equipment off and on, the user is encouraged to try to correct the interference by one or more of the following measures:

- Reorient or relocate the receiving antenna.
- Increase the separation between the equipment and receiver.
- Connect the equipment into an outlet on a circuit different from that to which the receiver is connected.
- Consult the dealer or an experienced radio/TV technician for help.

This equipment complies with FCC's RF radiation exposure limits set forth for an uncontrolled environment. The antenna(s) used for this transmitter must be installed and operated to provide a separation distance of at least 20 cm from all persons and must not be collocated or operating in conjunction with any other antenna or transmitter. Installers must ensure that 20cm separation distance will be maintained between the device (excluding its handset) and users.

### PACKAGE CONTENTS

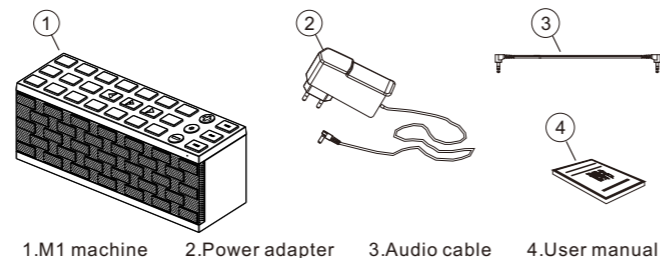

1. LED indicator
2. Preview
3. Play/pause
4. Next
5. Volume+
6. Input
7. Microphone
8. Pair,
9. Handsfree phone
10. Volume-
11. Charging indicator
12. DC in
13. Switch
14. AUX,
15. Charging out port (DC 5V 1A)

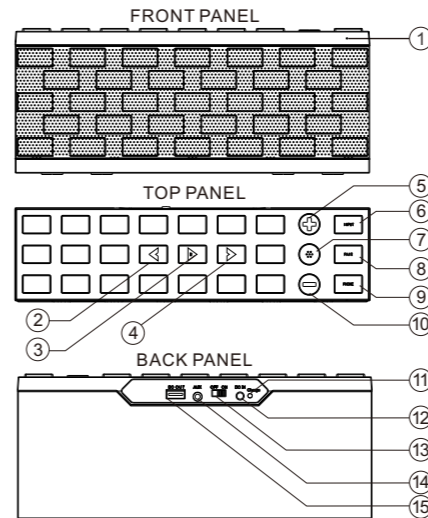

### Brief Operation Introduction

1. Connection: Using built in battery or Plug M1 into an outlet using the include AC adaptor then switch it On Please make sure the switch is on off position when you plug M1 with AC adaptor.

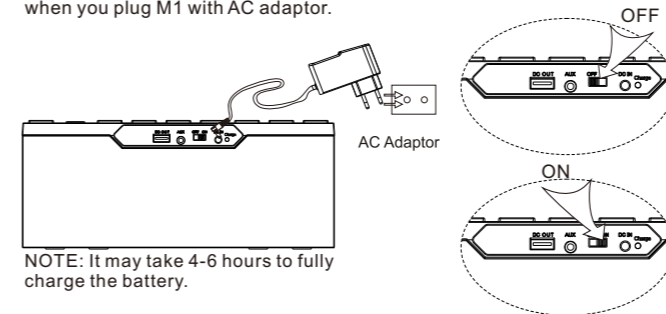

2. Power-on Operation: After switching M1 on, the indicator on the front panel is on, and Voice remind [Power ON] then the Bluetooth channel; then starts to search the device that connected last time. If the searching is successful, M1 will connect automatically with the device, and voices [pair completed.] then the Vocie remind "DU DU Du" for connect ready. M1 will play the music through the device. If the searching is failed, M1 will be in the status of Ready to pair.

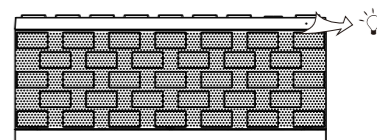

3. Connecting to the Bluetooth device : Search and connect [AMETHYST M1] with your Bluetooth device. The Invoice remind "Pair completed". Then you can play music from your Bluetooth device.

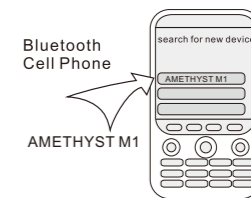

4. Music-playing operation: When M1 has successfully connected to the Bluetooth device properly, you can control the music-playing of the mobiles through touching the PRE,NEXT,PLAY/PAUSE button on the touching panel.

