

英文(iPhone+蓝牙)版说明书 X1B-G01-0

| | | |
|-----|--|--|
| 编制： | | 技术要求： 1、尺寸：230X135mm 2、印刷色：黑色 3、材质：封面105g铜版纸， 其它80g书写纸 |
| 审核： | | |
| 批准： | | |

www.lanchiya.com



Manufacturer: Foshan LANCHIYA Digital Technology Co.,Ltd
Address:Hongtu Road,Songxia Industry Zone, Songgang,Nanhai District,
Foshan City of Guangdong Province,China

AMETHYST

Digital Active Loudspeaker

User Guide

X1B

Please read this guide carefully before use

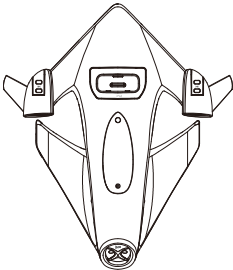

PROPERTY RIGHTS INFORMATION:

The trademark amethyst® and all the developed products with this label are registered patents, and belong to Foshan LANCHIYA digitai Technology Co., Ltd. Our company reserves all rights, and not allow reprinting. Other concerned trademarks all belong to their proprietors. As to the constant update and development of the products, our company reserves the right to change and rework our products without notice.

SAFETY INSTRUCTIONS

To ensure your safety and enjoyment, read and follow the safety instructions and use in the directed manner. Keep this manual for future reference.

WARNING: To prevent any fire or electrical hazards, do not remove or disassemble any parts from this unit. There are no user serviceable parts inside the unit. Please use qualified service personnel or qualified service shops.

- Do not expose the unit to rain, water or moisture
- Do not place liquid on or close to unit
- Do not place unit on or near fire or sources of fire such as candles or naked flames
- Keep away from heat, dust and vibrations
- Place unit on a stable and level platform
- Do not place any items on top of unit
- Refrain from using excessive force when using the unit buttons
- Secure and Protect the power cord
- Do not attempt to pull the power cord from a distance to shut the power
- Secure all cords and connections and do not use pinched or defected ones
- Unplug the power cord if the unit is left unused for extended periods
- If cleaning is required, use dry soft cloth or a damp cloth without solvents
- Operating temperature 0°C~55°C(32°F~131°F)
- Non-professional maintenances are strict to open the unit
- Please do not put anything nearby IR sense-panel of unit in 30cm.
- In order to play unit well and not affect IR sense function, please do not use it under Hardlight.
- Note: The unit can only be connected with the adaptor that comes with the package. Using any other adaptor will destroy the unit.
- Please use the power adaptor only provided in package.
- If the Bluetooth device can't find the speaker, the speaker may still connect with last Bluetooth device or another device is searching and connecting with speaker at same time. Now you need to follow Step 3 to re-connect it.
- If you hear intermittent sound or no sound from speaker after connection, please check if the distance between you and the speaker is greater than 10 meters.

12. MUTE Function: When in emergency or make phone call, press the MUTE button on the controller to make device muting; re-press the button to cancel mute.



ADDITIONAL REMARKS

CHARGE IPOD/IPHONE AUTOMATICALLY WHILE PLUG IN.

THIS UNIT IS COMPATIBLE WITH iPod/iPhone classic, iPod nano, iPod 5th gen, iPod 4th gen, iPod mini.

*EXTERNAL LIGHT SENSOR WINDOW: IT IS USED FOR DETECTING THE AMBIENT LIGHT INTENSITY.

IF THE AMBIENT LIGHT IS TOO STRONG OR WEAK, IT WILL CONTROL THE STRENGTH OF IR TO ENSURE THE RIGHT OPERATION AUTOMATICALLY.

FCC ID:P4L00X1HB01

This device complies with Part 15 of the FCC Rules. Operation is subject to the following two conditions: (1) this device may not cause harmful interference, and (2) this device must accept any interference received, including interference that may cause undesired operation.

SPECIFICATIONS:

Product code: X1-BT02

Product model: X1B

Output Power: Amplifier 3.5W × 2, Subwoofer 12W × 1

Amplifier Distortion: 1%

Amplifier Input Sensitivity: ≤400mV

Amplifier SNR: ≥75dB

Frequency response: 80Hz – 20 KHz

Input Voltage: DC 14V 2A

Power Voltage: AC100-240V 50/60Hz

Bluetooth Version: Bluetooth Version: 2.1 + EDR

Bluetooth connection range: horizon distance at 8-10m without obstruction

Playing format supported by Bluetooth: A2DP stereo playing.

9. Menu: If you want to navigate the menu on the iPod/iPhone, please press the "MENU" button on the remote control to activate, press "UP"/ "DOWN" to select then press "ENTER" to confirm.

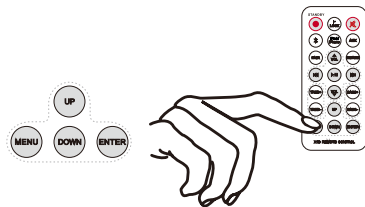

10. AUX Playing: Connect the input port of X1-BT02 and output port of Multi-media player by 3.5mm stereo audio cable and switch on the power; put your hand to the front induction area at a distance of 30-50mm for 2 seconds or press STANDBY button on the controller to power on; during the whole process the indicator light turns flashing to uninterrupted lighting. Now turn on the music on the devices and playing music from X1-BT02; you can control the playing both by infrared induction area and controller.

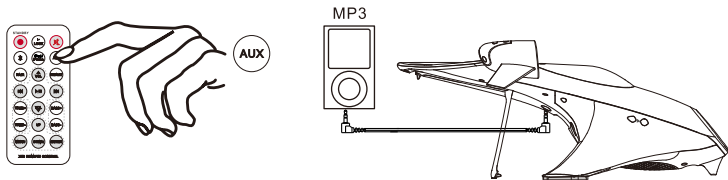

11. Treble and Bass Controlling: Press the TREB+, TREB- button on the controller to adjust treble on the speakers, and Press BASS+, BASS- button on the controller to adjust subwoofer.

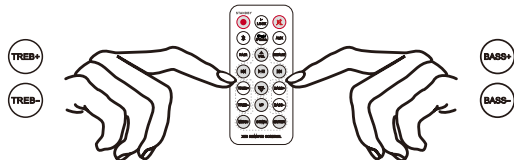

- Don't let Opposite item close to speaker when you use speaker phone function to avoid Echo. Please use default music player with your blue tooth device system such as, iPod, Samsung player, Windows media player as lots of third party music players do not support smooth song change function to avoid "pu" sound.
- Please use power adaptor which is provided by Amethyst to avoid damage to your speaker.
- Please connect and disconnect adaptor when the switch is in OFF position if your mobile doesn't support mobile ring transfer, you can only hear the X1-BT 02 Built in ring voice " incoming call" when the call comes in.

COMPLIANCE WITH FCC REGULATIONS

This device complies with Part 15 of the FCC Rules. Operation is subject to the following two conditions:

- (1) this device may not cause harmful interference, and
- (2) this device must accept any interference received, including interference that may cause undesired operation.

Caution: The user is cautioned that changes or modifications not expressly approved by the party responsible for compliance could void the user's authority to operate the equipment.

NOTE: This equipment has been tested and found to comply with the limits for a Class B digital device, pursuant to Part 15 of the FCC Rules. These limits are designed to provide reasonable protection against harmful interference in a residential installation. This equipment generates, uses and can radiate radio frequency energy and, if not installed and used in accordance with the instructions, may cause harmful interference to radio communications. However, there is no guarantee that interference will not occur in a particular installation. If this equipment does cause harmful interference to radio or television reception, which can be determined by turning the equipment off and on, the user is encouraged to try to correct the interference by one or more of the following measures:

- Reorient or relocate the receiving antenna.
- Increase the separation between the equipment and receiver.
- Connect the equipment into an outlet on a circuit different from that to which the receiver is connected.
- Consult the dealer or an experienced radio/TV technician for help.

This equipment complies with FCC's RF radiation exposure limits set forth for an uncontrolled environment. The antenna(s) used for this transmitter must be installed and operated to provide a separation distance of at least 20cm from all persons and must not be collocated or operating in conjunction with any other antenna or transmitter. Installers must ensure that 20cm separation distance will be maintained between the device (excluding its handset) and users.

PACKAGE CONTENTS

- ①. X1-BT02 with upper docking station ②. AC/DC Adaptor ③. Remote Control
④. iPod/iPhone cradle ⑤. Audio connection cable ⑥. User guide

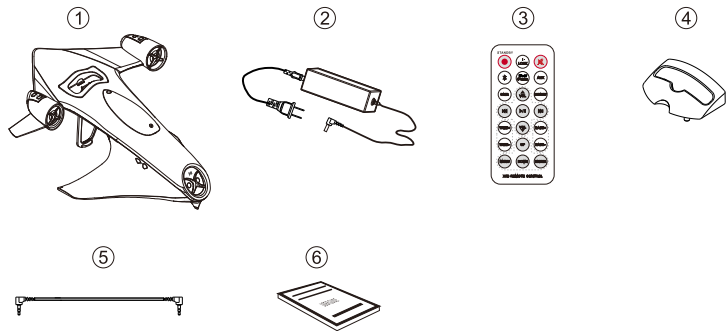

CONTROL PANEL INSTRUCTION

- 1.iPod/iPhone docking
2.Back
3.External Light Sensor window
4.Volume-
5.Play/Pause
6.Next
7.Indicator light
8.Volume +
9.AUX Connection
10.Leg
11.DC in
12.power switch

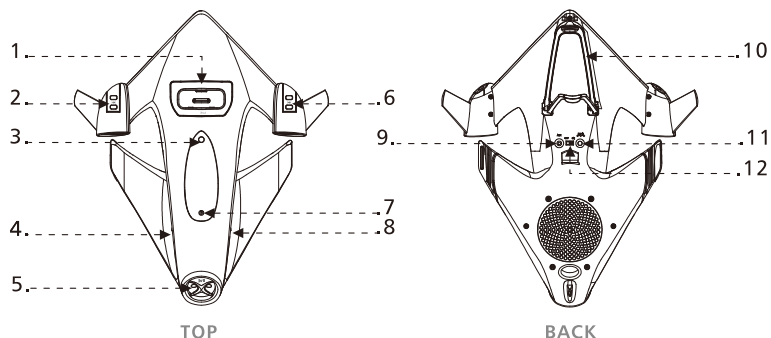

PLAYING APPLE DEVICES

6.Connecting power supply: Please make sure that the unit is completely closed before you properly connect both the adaptor and the power supply to the unit.

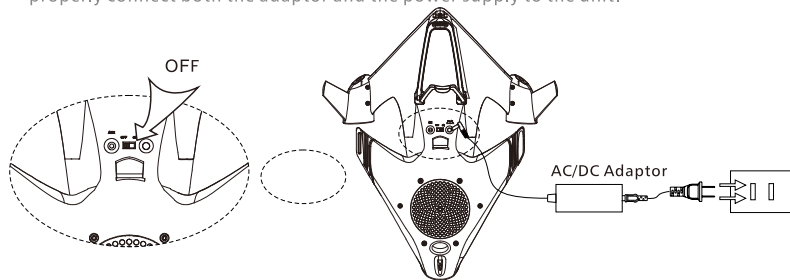

7.Playing APPLE Devices: Plug the APPLE devices in the docking connector. The channel will be automatically changed like iPhone. You may control the device by the remote control or use IR technology in the infrared induction area. Please adjust the cradle by your hands while insert or pull out iPod/iPhone

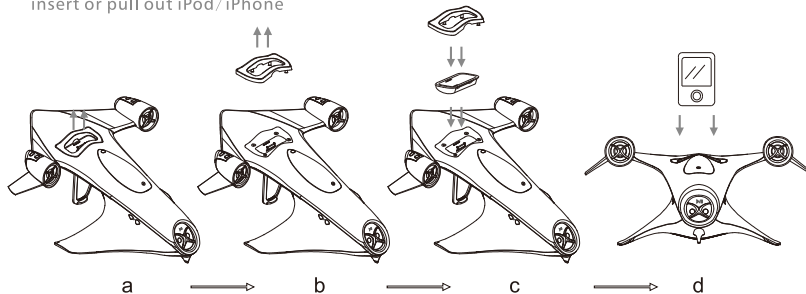

8.Fast forward/Fast backward: Please press "⏮"/"⏭" button on remote long to control Fast forward/Fast backward.

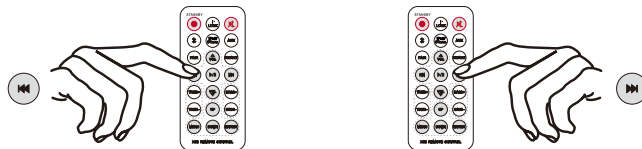

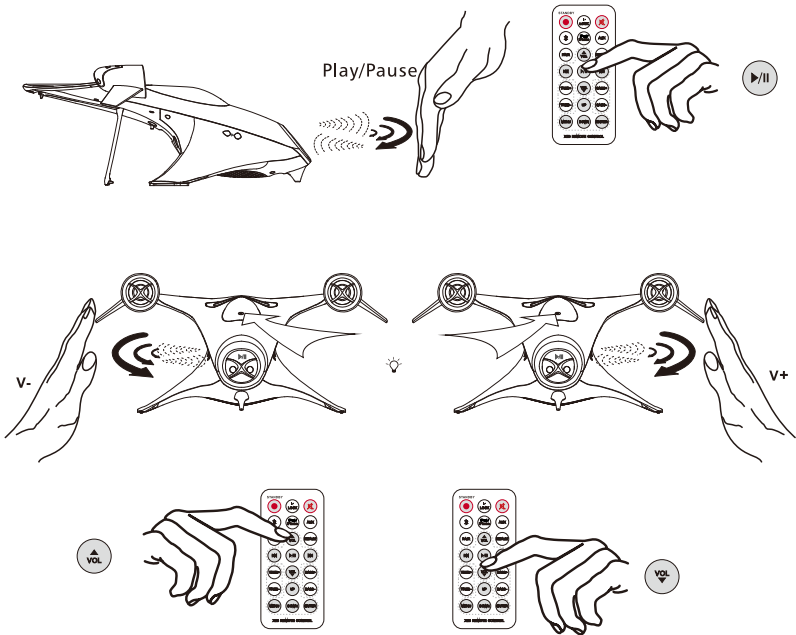

5.Re-pairing Devices: If you need to end the current connection and start a new connection by other Bluetooth devices, you could press the PAIR button on the remote controller to make a new connection.

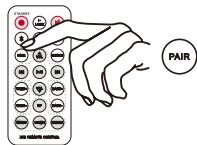

REMOTE CONTROL MANUAL & FUNCTIONS

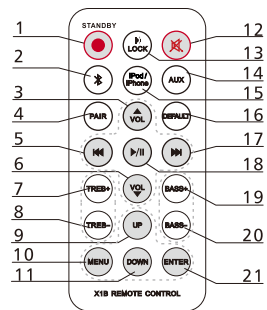

- 1-STANDBY: When unit is connecting power and switch is on, press this button to turn on or off unit.
- 2-Bluetooth Input: Press this button to select Bluetooth as audio source.
- 3-Volume Up: Press this button to increase volume.
- 4-PAIR: To start connect and disconnect with Bluetooth device.
- 5-Back/ Fast Backward: When unit is playing iPod/iPhone , press this button to go back or fast backward.
- 6-Volume Down: Press this button to decrease volume.
- 7-TREB+: Press this button to increase TREB.
- 8-TREB-: Press this button to decrease TREB.
- 9-UP: When unit is playing iPod/iPhone&Bluetooth , press this button to control menu up.
- 10-MENU: This button is only useful when playing iPod/iPhone&Bluetooth, press this button to enter Menu.
- 11-DOWN: When unit is playing iPod/iPhone&Bluetooth , press this button to control menu down.
- 12-Mute: When unit is working under AUX or iPod/iPhone&Bluetooth , press this button to mute
- 13-LOCK: Press this button to lock or unlock IR sensor.
 - (A).When unit is AUX&Bluetooth situation, press LOCK button can lock the unit for turning on/ standby/Volume up/down.
 - (B).When unit is playing iPod/iPhone&Bluetooth , press LOCK button on remote will lock playing.
- 14-AUX: Pressing this button to select AUX for audio source.
- 15-iPod/iPhone : Pressing this button to select iPod/iPhone playing for audio source.
- 16- DEFAULT: Press this button to restore factory settings.
- 17-Next/ Fast Forward: When unit is playing iPod/iPhone&Bluetooth , press this button to go next or fast forward.
- 18-Play/Pause: When unit is playing iPod/iPhone&Bluetooth, press this button to play or pause.
- 19-BASS+: Press this button to increase BASS.
- 20-BASS-: Press this button to decrease BASS.
- 21-Enter: This button is only useful when playing iPod/iPhone&Bluetooth , press this button to execute your choices from the menu.

OPERATING INSTRUCTIONS:

1. Device Connection: Put the X1-BT02 to the place where is free of obstructions or glare, and ensure the power switch is off. Then use the original adaptor to connect the X1-BT02 to the rear DCIN port and socket and turn on the switch.

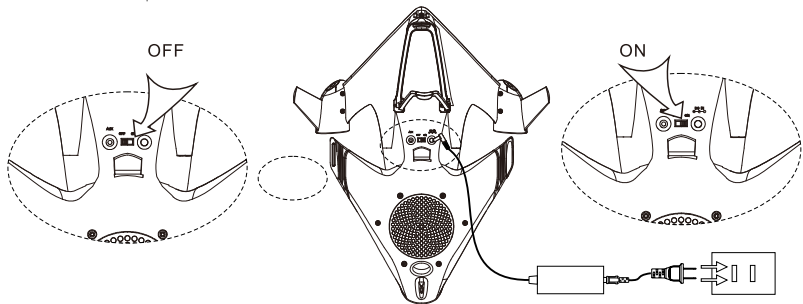

Ps: X1-BT02 has infrared controlling system. Please ensure that there are no obstructions or glare close to controlling keys within 30 cm.

2. Turning-on Operation: Turn on the switch from the back. The blue indicator light on the top will start flashing; now the X1-BT02 is in the default Standby mode; then use your hand blocking the infrared induction about 2 seconds to power on the machine. At the same time the flashing light becomes uninterrupted lighting; the default channel is AUX.

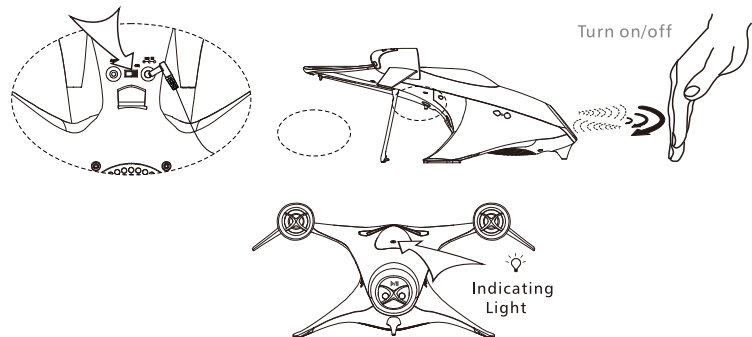

3. Connecting Bluetooth Devices: Press the Bluetooth button on the controller to change channel to Bluetooth, then press the PAIR button entering pairing status. Now search for the X1-BT02 by the name "X1-BT02" from your Bluetooth device to complete the connection. You can now enjoy the music from X1-BT02.

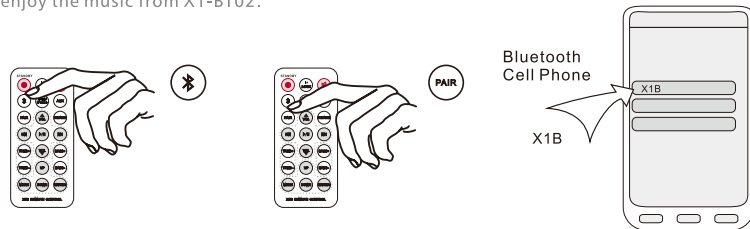

4. Playing Music Operation: When connection has completed and X1-BT02 is playing music, you can use your hand to block different induction areas from the top of X1-BT02 at a distance of 30-50 mm. The infrared operations include previous/next, pause/play and volume up/down. You can also press the buttons on the remote control to operate.

