

FUGOO GO

GO ANYWHERE SPEAKER

FUGOO is ready to help you!

If you need help troubleshooting or with setting up your FUGOO speaker, we're here to help. Please contact us first before returning the speaker to a retail store.

Phone - (877) 435-7596 (Toll-free, M-F, 9-5 PST) Email - support@fugoo.com

FAQs & Video Walkthroughs at www.fugoo.com/product-support/ You can chat live or leave us a message by clicking on the gray "Need Help?" or "Leave a Message?" tags on fugoo.com

START UP

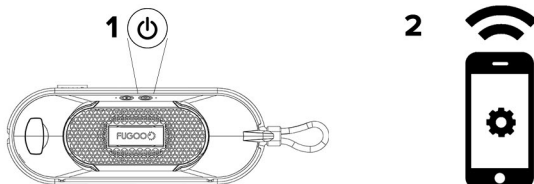

CONTROL / FEATURES

1. Mounting Cord
2. Volume Down Button
3. Action Button
4. Volume Up Button
5. Logo / Cover Removal Tab

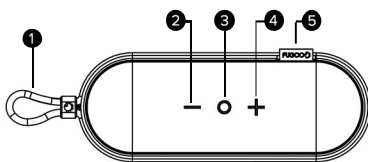

6. Waterproof/Dustproof Port Door
7. Charge Port (Micro USB)
8. Line-In Audio Jack
9. Bluetooth Pairing Button
10. Accessory Mounting Socket
11. Power Button
12. Mounting Cord Hook

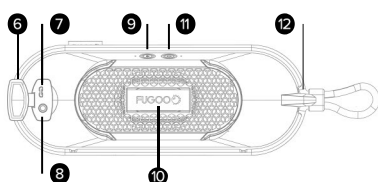

POWER CONTROL

- Power On / Off Push 1second
 Battery status Click
 Power Save On/Off..... Hold at Power on

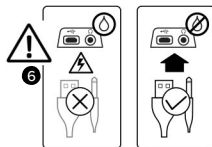

AUDIO CONTROL

- Volume Up Push or Hold
 Volume Down Push or Hold
 Play / Pause Audio Click
 Next Track Click &
 Previous Track Click &
 Voice prompt level Hold & at power on
 EQ Change Hold 3 seconds

CONNECTING / PAIRING

- Pair a new device Hold 3 seconds
 Connect / Disconnect a paired device Click
 Clear all paired devices Hold 8 seconds

CONNECT TWO SPEAKERS TOGETHER

- Place Each Speaker in Pairing Mode..... Hold & for 1 second
 Toggle Pairing Double / Stereo Hold & for 3 seconds

CHARGING THE SPEAKER

- 1) Open Port Door
- 2) Plug Micro USB Cable into USB Power Source and into Speaker's Micro USB Port

- POWER LIGHT STATUS**
 Off = No Power, Unit off
 On = Power Applied, Unit Off, Fully Charged or Unit On, No Power Applied
 Blinking = Power Applied, Unit Off, Unit charging

BATTERY STATUS CHECK:

- Blink 4 times = Full Battery
 Blink 3 times = Battery about 3/4 full
 Blink 2 times = Battery about 1/2 full
 Blink 1 time = Battery low

CONNECTIVITY

- BLUETOOTH LIGHT STATUS**
 Light Off = Not Connected
 Light Blinking Blue = Pairing/Connecting
 Light On Blue = Connected
 Light Blinking Green = Pair Two Speakers - Pairing Mode
 Light On Green = Pair Two Speakers - Connected

IMPORTANT SAFETY INSTRUCTIONS

1. Read these instructions
2. Keep these instructions
3. Heed all warnings
4. Follow all instructions
5. Do not use this apparatus near water
6. Clean only with dry cloth.
7. Do not block any ventilation openings. Install in accordance with the manufacture's instructions.
8. Do not install near any heat sources such as radiators, heat registers, stoves, or other apparatus (including amplifiers) that produce heat.
9. Only use attachments/accessories specified by the manufacturer.
10. Use only with the cart, stand, tripod, bracket, or table specified by the manufacturer, or sold with the apparatus. When a cart or rack is used, use caution when moving the cart/apparatus combination to avoid injury from tip-over.



11. Unplug the apparatus during lightning storms or when unused for long periods of time.
12. Refer all servicing to qualified personnel. Servicing is required when the apparatus has been damaged in any way, such as power supply cord or plug is damaged, liquid has been spilled or objects have fallen into the apparatus has been exposed to rain or moisture, does not operate normally, or has been dropped.
13. **WARNING:** The battery (battery or batteries or battery pack) shall not be exposed to excessive heat such as sunshine, fire or the like.
14. **CAUTION:** Danger of explosion if battery is incorrectly replaced. Replace only with the same or equivalent type.

FCC Statement

This device complies with Part 15 of the FCC Rules. Operation is subject to the following two conditions:

- (1) This device may not cause harmful interference.
- (2) This device must accept any interference received, including interference that may cause undesired operation.

CAUTION: Any changes or modifications not expressly approved by the grantee of this device could void the user's authority to operate the equipment.

Federal Communications Commission Interference Statement

This equipment has been tested and found to comply with the limits for a Class B digital device, pursuant to part 15 of the FCC Rules. These limits are designed to provide reasonable protection against harmful interference in a residential installation. This equipment generates, uses and can radiate radio frequency energy and, if not installed and used in accordance with the instructions, may cause harmful interference to radio communications. However, there is no guarantee that interference will not occur in a particular installation. If this equipment does cause harmful interference to radio or television reception, which can be determined by turning the equipment off and on, the user is encouraged to try to correct the interference by one or more of the following measures:

- (1) Reorient or relocate the receiving antenna.
- (2) Increase the separation between the equipment and receiver.
- (3) Connect the equipment into an outlet on a circuit different from that to which the receiver is connected.
- (4) Consult the dealer or an experienced radio/TV technician for help.

RF Exposure Warning

The device has been evaluated to meet general RF exposure requirement.
The device can be used in portable exposure condition without restriction.

IC Warning

This device complies with Industry Canada License-exempt RSS standard(s). Operation is subject to the following two conditions:

- (1) This device may not cause harmful interference, and
- (2) This device must accept any interference, including interference that may cause undesired operation of the device.

Changes or modifications not expressly approved by the party responsible for compliance could void the user's authority to operate the equipment.

Avertissement d'Industrie Canada

Cet appareil est conforme à(aux) norme(s) RSS d'exemption de licence d'Industrie Canada. L'opération est sujette aux deux conditions suivantes :

- (1) cet appareil ne doit pas causer d'interférence nuisible, et
- (2) cet appareil doit accepter toute interférence, incluant les interférences qui causent une opération non voulue de cet l'appareil.

Des changements ou des modifications non expressément approuvés par la partie responsable de la conformité pourraient annuler l'autorisation de l'utilisateur d'opérer cet équipement.