

3. For more detailed information, contact "General Inquiries" using the phone number on the back of this manual.

### FeliCa reader/writer

- **FeliCa reader/writer function of FOMA terminal uses weak waves requiring no licenses for radio stations.**
- **It uses 13.56 MHz frequency band. When using other reader/writers in your surroundings, keep FOMA terminal away sufficiently from them. Before using the FeliCa reader/writer, confirm that there are no radio stations using the same frequency band nearby.**

### CAUTION

- **Do not use a remodeled FOMA terminal. Using a remodeled terminal violates the Radio Law.**  
FOMA terminal is certified according to technical standard conformance of specified wireless equipment based on the Radio Law, and as a proof of it, the "Technical Compliance Mark" is depicted on the engraved sticker of FOMA terminal.  
If you remodel FOMA terminal by removing its screws, your certification of technical standard conformance becomes invalid.  
Do not use FOMA terminal with its certification of technical standard conformance invalid as it violates the Radio Law.
- **Be careful when you use FOMA terminal while driving a car etc.**  
Using a mobile phone while driving is subject to penal regulations.  
If you inevitably receive a call, tell the caller that you will "call back" by handsfree, then park in a safe place and call back.
- **Use the Bluetooth function only in Japan.**  
The Bluetooth function of the FOMA terminal is compliant with wireless standards and is authorized for use only in Japan.  
If you use this function overseas, you may be punished.
- **Use FeliCa reader/writer function only in Japan.**

FeliCa reader/writer function of FOMA terminal conforms to Japanese radio standards.

If you use this function overseas, you may be punished.

## Waterproofness/Dustproofness

**F-01Bis provided with the following waterproofness by firmly closing the external connection jack cap, installing the back cover and locking the cover.**

- **IPX5 (Former JIS protection code 5)\*<sup>1</sup>**
- **IPX8\*<sup>3</sup> that is a higher standard than IPX7 (former JIS protection code 7)\*<sup>2</sup>**

**Also, F-01B is dustproof to IP5X (former JIS protection code 5)\*<sup>4</sup> if the external connection jack cap is strictly closed as well as the back cover is mounted and locked.**

- \*1 Code IPX5 means that a phone keeps functioning after directly applying a jet flow of 12.5 L/min. for at least 3 minutes from a distance of 2.5-3 m on a rotating turntable.
- \*2 Code IPX7 means that a phone keeps functioning after it is slowly submerged to depth of 1 m in static tap water at room temperature, left there for 30 minutes and then taken out.
- \*3 Code IPX8 means that it provides waterproofness of which exceeds of IPX7 standard.
- \*4 Code IP5X means that a device is protected against the ingress of dust specific to dustproof test (25 μm or smaller in diameter), so that the ingress will not interfere with predefined operation and safety of the device.



F-01B provides the following waterproof performances of IPX8.

- F-01B keeps functioning after it is slowly submerged to depth of 1.5 m in static tap water at room temperature, left there for 30 minutes and then taken out.
- The mobile phone keeps shooting still images or moving pictures in 30 minutes in static tap water at room temperature.

### ❖ What you can do with waterproofness and dustproofness of F-01B

- **You can talk or watch 1Seg programs without using an umbrella in the rain (for rainfall of 20 mm or less per hour).**
  - When your hands or FOMA terminal are wet, avoid installing/removing the back cover or opening/closing the external connection jack cap.

### • You can wash mud or dirt away.

- Do not apply water flow stronger than allowed (e.g., such water flow that gives you pain when applied to your skin directly from a faucet or shower).
- Wash it using room-temperature tap water with your hand, with FOMA terminal locked, the back cover installed and the external connection jack cap held in position.
- Do not use any brush, sponge, soap, cleaning material, etc.
- After flushing away, wipe off water with a dry cloth, drain, and dry naturally.

### • You can touch the terminal with your hand that is wet with salt water or seawater.

- Do not operate the terminal.
- If you touch the terminal with your wet hand, flush away immediately as predefined.

### • You can also shoot still images and moving pictures in the pool depth of 1.5 m.

- Do not perform other operations underwater than shooting still images and moving pictures.
- If you put the terminal in water of swimming pool, be sure to have it within 30 minutes.
- If FOMA terminal gets wet with water from the swimming pool, wash it as predefined.

### • You can use FOMA terminal in a bathroom.

- Do not put the terminal in the bathtub. Do not use the terminal in hot water. Doing so may cause malfunction.
- Never put FOMA terminal in hot spring water or water containing soap, detergent or bath powder.

## To ensure waterproofness/dustproofness

**To keep the FOMA terminal waterproof/dustproof, be sure to observe the points below.**

- If FOMA terminal should get wet with salt water, sea water or soft drink, you can flush away. However, do not let the terminal get wet with liquids other than tap water at room temperature.

- Open/close the external connection jack cap as described below.

**<Opening the external connection jack cap>**

Place your finger at groove on the hinge side to open the cap.

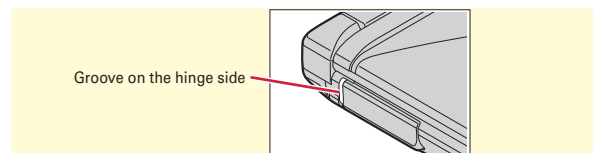

**<Closing the external connection jack cap>**

Close with the tab for the back cover at the rear side of the cap fitted into the concave of this terminal. Make sure that the cap is completely closed without slack.

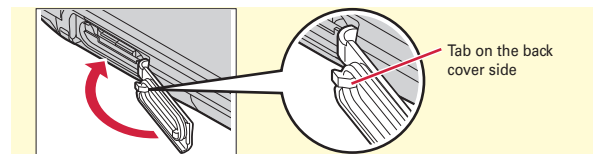

- Install the back cover as described below.

**<Installing the back cover>**

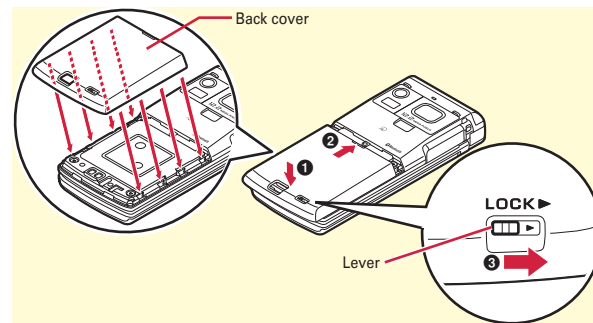

Align 8 tabs of the back cover with concaves of FOMA terminal. While pressing the back cover in the direction of ① so that there is no gap between FOMA terminal and back cover, slide the back cover in the direction of ② to install, then slide the back cover lever in the direction of ③ to lock.

- \* Make sure that the back cover is completely closed without slack. Slide the back cover in the direction of the arrow shown on the lever, and then make sure the cover is securely locked before using.
- Securely lock the back cover and firmly close the external connection jack cap. Even a fine obstacle (one hair, one grain of sand, tiny fiber, etc.) put between contact surfaces may allow water to enter.
- Do not poke the microphone, earpiece or speaker with a swab or sharp object.
- Do not let FOMA terminal fall. It may become scratched causing the waterproof/dustproof performance to degrade.
- The external connection jack cap and the rubber packing of the inner lid play an important role for keeping waterproof/dustproof performance. Do not remove or scratch it. Also, prevent dust from adhering to it.

- To keep the FOMA terminal waterproof/dustproof, replacement of parts is required every 2 years regardless of whether FOMA terminal appears normal or abnormal. DOCOMO replaces the parts as a chargeable service. Bring FOMA terminal to a sales outlet such as a DOCOMO-specified repair office.

## Important precautions

Do not perform actions shown in the illustrations below.

<Example>



Using Soap/Detergent/  
Bath powder



Washing with  
brush/sponge



Washing by  
laundry machine



Applying strong  
water flow



Using in  
hot spring



Soaking in  
ocean water

Observe the following precautions to use FOMA terminal properly.

- Accessories and optional devices are not waterproof/dustproof. When watching 1Seg etc. with FOMA terminal installed in the desktop holder, do not use it in a bath room, shower room, kitchen or lavatory even if it is not connected to the AC adapter.
- Do not apply water flow stronger than allowed (e.g., such water flow that gives you pain when applied to your skin directly from a faucet or shower). F-01B provides the following waterproof performances of IPX5. However, it causes malfunction.
- If FOMA terminal gets wet with salt water, seawater, water from the swimming pool or soft drink, or with mud or soil, flush away immediately. When it dries out, it becomes harder to get rid of, causing malfunction.
- Do not use FOMA terminal before flushing mud or soil away. This damages FOMA terminal.
- Do not put FOMA terminal in hot water, use it in a sauna or apply hot airflow (from a hair dryer etc.) to it.
- Do not move in water or slam the terminal against the surface of water with FOMA terminal opened.
- If you put the terminal in tap water or in water of swimming pool, be sure to have it within 30 minutes.
- When you use the terminal in swimming pool, obey rules of the facility.
- FOMA terminal does not float on water.
- Do not leave water on FOMA terminal. May short-circuit the power jacks, or in a cold region, water may freeze causing malfunction.
- Do not leave water on the microphone, earpiece or speaker. Such water may interfere with talking.
- If the back cover is damaged, replace it. Water may enter inside from a damaged section causing troubles such as electric shocks or corrosion of the battery.
- If FOMA terminal gets wet with water or other liquids with the external connection jack cap or back cover open, the liquid may get inside the terminal causing electric shocks or malfunction. Stop using FOMA terminal, turn the power OFF, remove the battery pack and contact a DOCOMO-specified repair office.
- If rubber gasket on the external connection jack cap or inner lid is damaged or deformed, replace it at DOCOMO-specified repair office.

DOCOMO does not guarantee actual operations under all states. Malfunctions deemed to be caused by inappropriate operation by the customer are not covered by the warranty.

## Washing FOMA terminal

Wash the terminal with tap water while holding the external connection cap. Do not rub the terminal.

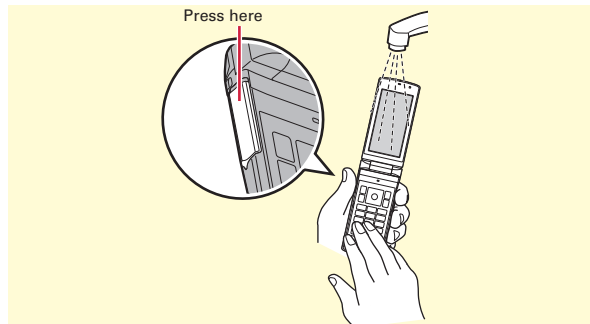

\* After washing FOMA terminal, drain in the following steps, and dry naturally.

## Draining water when the FOMA terminal gets wet

When FOMA terminal is wet, water may flow out after wiping it off; drain the water in the following steps.

① Wipe FOMA terminal surface with dry, clean cloth etc.

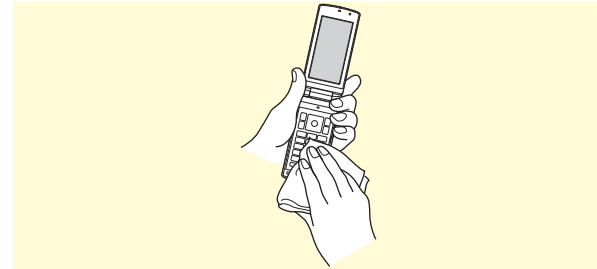

② Shake FOMA terminal approximately 20 times, firmly holding its hinge section, until there is no more water splattering.

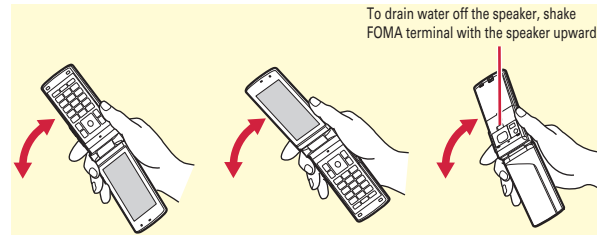

③ Softly press dry, clean cloth etc., against FOMA terminal to wipe off water remaining in the microphone, earpiece, speaker, keys or hinges.

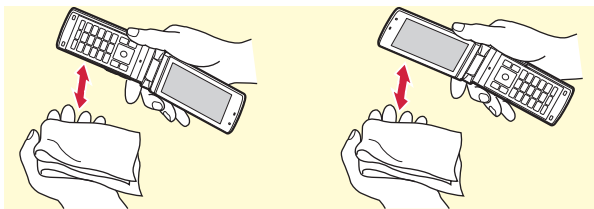

- ④ **Remove the back cover and wipe off any drops of water around the inner lid and the rear side of the back cover. Never open the inner lid. After wiping off the water, install and lock the back cover.**

Removing back cover⇒P25

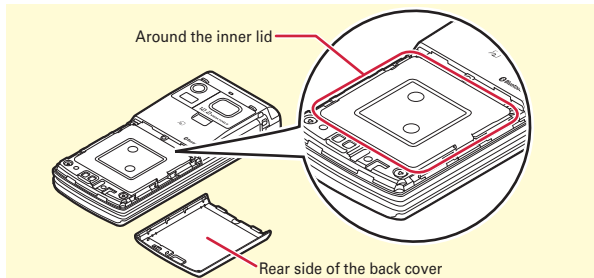

- ⑤ **Wipe off water drained from FOMA terminal with dry, clean cloth etc.**

- Water, if any, remaining in FOMA terminal may ooze up after wiping off.
- Do not wipe off water remaining in concaves directly with a cotton swab etc.
- After wiping off water, dry naturally.

## Charging

Check the following before and after charging.

- Check that FOMA terminal is not wet. Never try to charge the battery pack when FOMA terminal is wet.
- Accessories and optional devices are not waterproof/dustproof.
- When charging the battery when or after FOMA terminal is wet, adequately drain it and wipe off water with a dry, clean cloth etc., before connecting a desktop holder or opening the external connection jack cap.
- When the external connection jack cap is opened for charging, close the cap firmly after charging. It is recommended that the desktop holder be used for charging to prevent water from seeping inside from the external connection jack.
- Do not use the AC adapter or desktop holder in a bathroom, shower room, kitchen, lavatory or other highly humid area. May cause fire or electric shock.
- Do not touch the AC adapter or desktop holder with wet hands. May cause electric shock.

## Before Using

# Attaching UIM (FOMA card)/battery pack

After turning power OFF, close FOMA terminal and hold it in your hand so that you can properly attach the card/pack.

### ✦ Removing the Back Cover

Slide the back cover lever in the direction of ① to unlock, and then slide the cover in the direction of ② by 2 mm with a thumb to remove it. Pinch the tab of the inner cover and open the cover in the direction of ③ until it stops.

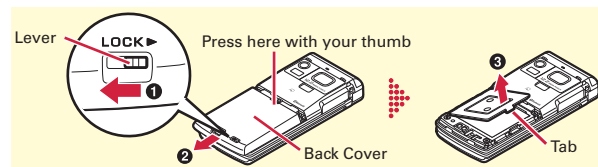

### ✦ Installing UIM

Pull the tab with your nail and pull out the tray until it clicks. (①). Hold UIM with the IC side down, align the beveled corner with the tray and push into the tray until it stops (②).

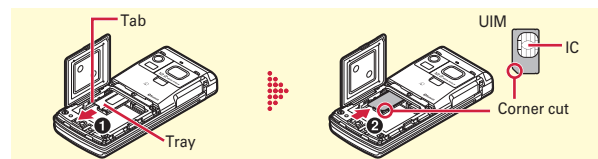

### ✦ Installing battery pack

With the label side of the battery pack upward, align convex parts of the battery pack with concave parts of FOMA terminal and slide the

battery pack in the direction of ①, press the battery pack in the direction of ② to set it in, and then close the inner cover.

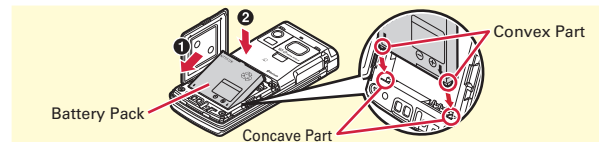

### ✦ Installing back cover

Place the 8 tabs of back cover to the notches, press back cover in the direction of ① to avoid forming any clearance between FOMA terminal and back cover, then slide it in the direction of ② to install it. Finally, slide the lever in the direction of ③ to lock.

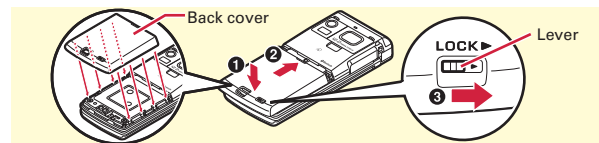

#### Point

- The inner cover can be solidly closed for maintaining water-/dust-proof performance. Opening the cover forcibly may injure your nails or fingers.
- To prevent damage due to excessive force, the hinge of the inner cover (the section where FOMA terminal makes contacts) is designed to be removed. If it is detached, align metal pins on the inner cover with the slots on FOMA terminal, and then press the cover until it clicks.

## Before Using Charging

The battery pack does not have a full charge at time of purchase. Use AC adapter for FOMA terminal to charge the battery before using FOMA terminal.

### Using desktop holder and AC adapter in combination for charging

- 1 Insert the AC adapter to the desktop holder, with the arrow on the AC adapters connector upward.
  - 2 Unfold the AC adapters power plug and insert it into a 100V AC outlet.
  - 3 With FOMA terminal closed, insert it into the desktop holder.
- \* Check that the light turns on.
- 4 After charging is completed, remove FOMA terminal from the desktop holder.

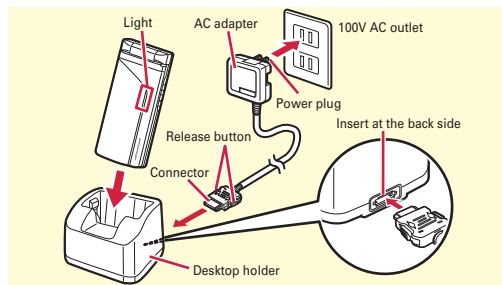

### Charging using AC adapter

- 1 Open jack cap (①) of FOMA terminal, hold the connector horizontally with the arrow side upward and insert it to the jack. (②)
- 2 Unfold the power plug and insert it into a 100V AC outlet.
- 3 When charging is over, pull out the power plug from the outlet, and pull out from FOMA terminal horizontally while pressing the release buttons on both sides of the connector.

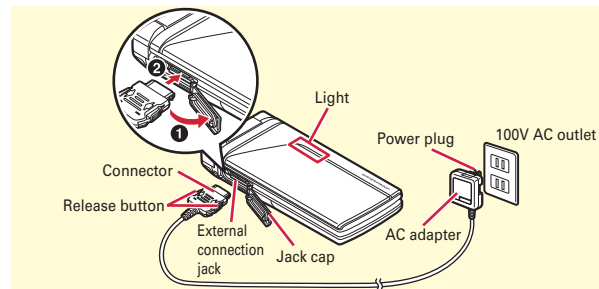

### ⚡ Operations for charging



When charging starts, a charge start alert sounds. While charging, the light turns on and the battery icons on the display and the sub-display blink. When charging is over, a charge completion alert sounds.



## Before Using

### Turning power ON - Initial Setting

Perform the following operations after turning the power ON for the first time.

- 1  (2 sec. or more)
- 2 "Yes" or "No" on a confirmation screen of enlarged menu setting
- 3 Set required items on Initial setting screen ▶  [Quit]

Always set Password and Request permit/deny. If you exit without setting, Initial setting screen reappears when the power is turned ON the next time.

- 4  on a confirmation screen of software update function

The stand-by display appears.

#### Point

**Turning power off :**  (2 sec. or more)

**Changing the initial setting :**  8 7 4 7

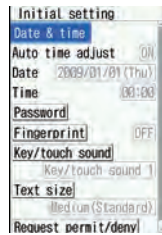

<Initial setting screen>

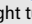

#### Information

- If no operation is performed, the display light is turned off automatically according to the settings in  [Light time-out] or  [Power saving mode]. The display light turns on again if there is any operation or incoming call.

## Before Using

### User information

Check your own phone number.

For details of checking/changing a mail address, refer to "Mobile Phone User's Guide [i-mode] FOMA version".

- 1  0 **User information**

The screen shown to the right appears.

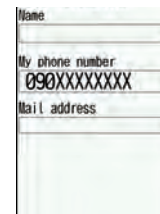

<User information screen>

#### Point

**Editing user information :** On User information edit screen,

 ▶ Authenticate ▶ Edit ▶ 

**Checking a phone number during a call :**  0

## Screens

# Viewing display

The current state can be checked by the icon appearing on the screen. Below are major icons.

### ✦ Top of the display



Battery level



Signal strength

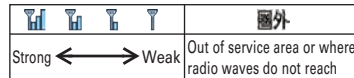

- : Self mode ON
- : In data transfer mode
- : Connecting to i-mode
- : Infrared communication in operation
- : Bluetooth power ON
- : The total calls cost exceeds the limit
- : Bluetooth connection being established
- : Communication using a handsfree device in progress
- : Handsfree ON
- : Power saving mode activated

- : Positioning with GPS
- : Security lock ON
- : A phonebook entry or schedule has secret attribute
- : High-pitched alarm ON
- : Unread Area Mail exists
- : Unread i-mode mail exists
- : Arrival i-concier information exists
- : Unreceived i-mode mail exists in the i-mode Center
- : Displaying SSL/TLS page etc.
- : Auto-send mail exists
- : Music&Video Channel program obtaining reservation exists
- : During i-appli operation
- : i-appli call exists
- : Alarm clock ON
- : Schedule reminder ON
- : Inside OFFICEED area

### ✦ Bottom of the display



- Arrival information (missed call, recorded message, voice mail service, unread message, unread ToruCa, i-appli call)
- : Silent mode ON
- : Call alert volume OFF
- : Vibrator for voice call ON
- : In Public mode (Drive mode)
- : Record message ON
- : Keypad dial lock ON
- : GPS Request failed
- : Personal data lock ON
- : Music&Video Channel program obtaining failure
- : Reading UIM
- : IC card lock ON
- : Available multi-cursor key
- : Performing 1Seg recording reservation
- : i-appli Auto start failed
- : microSD card installed during Communication mode
- : Connected to external device using USB cable
- : Pedometer/ACT monitor is set
- : Software update notice
- : Auto-update of latest pattern definition failure

## Task Area

The icon indicating the function (task) in progress appears in the task area.

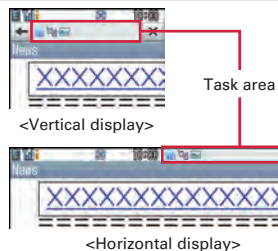

## Guide Area and Key Operation

Operations that can be performed by pressing **MENU**, **☎**, **📷** and **✉** are displayed in the guide area. To perform an operation in the guide area, press the corresponding key. The guide display for **MENU**, **☎**, **📷**, **✉** and the functions assigned to **☎** are automatically switched according to the tilt of FOMA terminal.

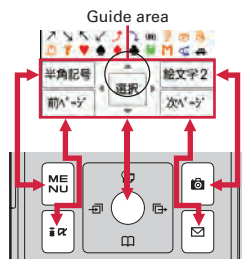

## Sub-display

Even when FOMA terminal is closed, the icons and messages in the sub-display provide a lot of information.

When no operation is performed for approximately 8 seconds, the sub-display light is turned off, but it turns on again when you press either side key.

### ❖ Switching views

Each time you press **📷**, the view switches in the order of Clock (Digital 1) ⇒ Clock (Digital 2) ⇒ Analog. When "Use" is set to Set Pedometer/Activity monitor, or "Yes" is set to Show ticker of i-Channel setting, each time you press **☎**, the view switches in the order of Activity⇒i-Channel ticker⇒Clock.

### ❖ Arrival Information

When a missed call, recorded message, unread message, unread message R/F, voice message of Voice Mail service or i-concier information exists, pressing **☎** with Clock displayed displays the number of missed calls, and then pressing **☎** scrolls reception date/time and information about the senders.

### ❖ Call light and mail light

Call light (●) blinks when an unchecked missed call exists, and Mail light (●) blinks when an unread message or unread SMS exists.

### 📞 Information

- The light turns on just by tilting FOMA handset. [🔆Auto light on]

## Screens

## Menu operation

On the stand-by display, press **MENU** and then perform the functions from the menu. You can select a menu item with shortcut operations, which use the keypad, **[<=>]** and **[#]**, or with multi-cursor operation, which uses the multi-cursor key to move the cursor.

(Example) **Selecting "Calculator"**

## Shortcut operations

1 **MENU** ▶ **[7]** ▶ **[4]**



## Multi-cursor key operations

1 **MENU** ▶ Move the cursor to "**[7] Accessory**" ▶ **[Select]** ▶ Move the cursor to "**[4] Calculator**" ▶ **[Select]**

## Point

- Even when a function is running, you can perform the same operation if "MENU" is displayed on the guide area.
- To return to the previous menu, press **[CLR]**. To return to the stand-by display, press **[<=>]**.
- On the stand-by display with Info/calendar layout, Shortcut icons set, or with arrival information icon or i-concier information displayed, press **[#]**

to change the display to Focus mode that allows you to quickly display the related information.

## Switching menu screens

You can switch among "Kisekai Menu", the design of which can be changed using Kisekai Tool (⇒P44), "Basic Menu", which has the fixed menu numbers, and "Select Menu", to which menu items can be saved freely.

A Kisekai menu matched with the color of FOMA terminal is set by default.

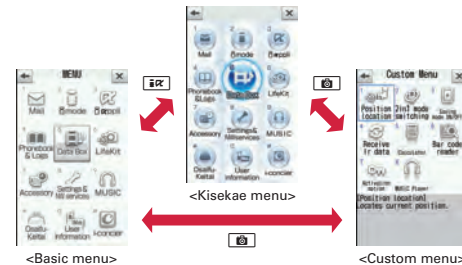

## Point

- In some types of Kisekai menus, the menu structure is changed according to usage frequency, or the number assigned to menu item (item number) may not be applicable.

## Information

- The menu that appears when **MENU** is pressed on the stand-by display can be changed from Start start menu.⇒P40

## Screens

# Using touch panel

You can use the display as touch panel. You can perform the same operation by touch operation as on the screen to move the cursor with key operation.

### Types of touch operations

<b>Touch</b>	Touch the display lightly once and release the finger. The operation becomes effective when you release your finger from the display. This operation is mainly for selecting menus, items, etc.
<b>Double-touch</b>	Touch the display lightly twice and release the finger. The operation becomes effective when you release your finger from the display. This operation is mainly for zooming in/out or switching the display.
<b>Slide</b>	Keep touching the display, move your finger up, down, right or left. This operation is for scrolling a screen, rewinding/fast-forwarding a video, etc.
<b>Slide quickly</b>	Touch the display lightly and flick your finger up, down, right or left. This operation is for switching pages or images, or moving to a different chapter or tune, etc.

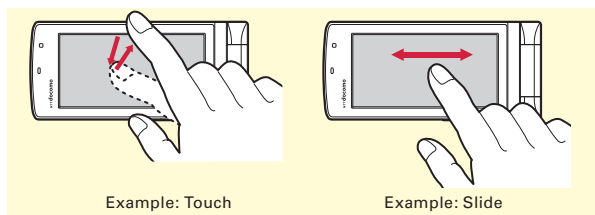

### Touch-specific operations

The followings are major touch operations.

#### Touch-specific operations

Perform touch-specific operation to select a function from the stand-by display. To display the stand-by launcher (shown to the lower right), touch other than the stand-by touch button.

#### Guidance button

You can touch guidance buttons to return to the previous screen ((1)), exit a function ((2)), or operate a function displayed in the guide area ((3)).

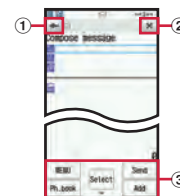

### Menu buttons for touch operation

Buttons that correspond to a function are displayed.

Menu button for touch operation



e.g.: Outgoing call screen

e.g.: My document

### Moving focus and selecting menu/item

To select a menu or item, touch a menu or item to select, move the focus for touch operation, then touch the menu or item again.



Slide on the list

Touch an item directly

### Direction/Determination button

When using i-mode browser in Viewer style, you can operate menus or items on the displayed screen using the direction/determination button.

### Channel switch panel/Volume adjust panel/Slider

While playing 1Seg or a moving picture, slide vertically or horizontally to display a panel, and then touch or slide.

Touch or slide the slider to adjust a value.

### Link items or confirmation screens

Directly touch an item.



### Numeric value setting roller

When you select an item to set numeric values such as date and time, you can rotate the roller by slide operation to set it.



### Making a voice call

To make a voice call, press  on the stand-by touch display.

### Answer a call

To answer a call, touch the display while receiving a call to display a button.

## Screens

## 使いかたガイド (Guide)

Guide provides overviews and operations of functions , and troubleshooting. (In Japanese only)

1 [MENU] ▶ 6 LifeKit ▶ 0 Guide ▶ Select a search method

**目次 (Contents)** : Search from a list of functions.

**索引 (Index)** : Search from a list of words sorted according to Japanese syllabary.

**フリーワード検索 (Free word search)** : Enter a keyword to search for.

**ブックマーク (Bookmark)** : Search from a list of registered bookmarks.

**困ったときには (Troubleshooting)** : Search from lists of troubles or error messages.

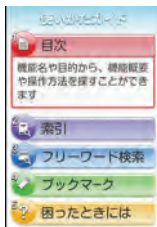

〈使いかたガイド (Guide)〉

**Point**

- On a description screen, select "この機能を使う (Use this function)" to perform a function. Selecting a link item in "関連機能 (related functions)", or "→コチラ (See more)" displays a corresponding description screen.

**Information**

- You can also access Free word search from Quick search. ⇒P114

**Caller ID notification (Default : Inform)**

You can notify your phone number (caller ID) to the other party's terminal when making a voice call.

- 1 [MENU] ▶ 8 Settings & NW services ▶ 8 NW Services ▶ 4 Caller ID ▶ 1 Caller ID notification ▶ 1 Activate/Deactivate ▶ 1 Inform
- Select "[2] Not inform" if you do not want to inform.

**Point**

- Caller ID is your important personal information. Carefully consider whether you want to include caller ID information when making a call.
- If an announcement of requesting caller ID is heard when making a call, make a call again after setting your caller ID to "Inform".

## Index

# Specific absorption rate (SAR) of mobile phone

This model phone FOMA F-01B meets the MIC's<sup>\*1</sup> technical regulation governing exposure to radio waves. The technical regulation established permitted levels of radio frequency energy, based on standards that were developed by independent scientific organizations through periodic and thorough evaluation of scientific studies. The regulation employs a unit of measurement known as the Specific Absorption Rate, or SAR. The SAR limit is 2 watts/kilogram (W/kg)<sup>\*2</sup> averaged over 10 grams of tissue. The limit includes a substantial safety margin designed to assure the safety of all persons, regardless of age and health. The value of the limit is equal to the international guidelines recommended by ICNIRP.<sup>\*3</sup>

All phone models should be confirmed to comply with the regulation, before they are available for sale to the public. The highest SAR value for this FOMA F-01B is 0.641 W/kg. It was taken by the Telecom Engineering Center (TELEC). The test for SAR was conducted according to the MIC testing procedure using standard operating positions with the phone transmitting at its highest permitted power level in all tested frequency bands. While there may be differences between the SAR levels of various phones and at various positions, they all meet the MIC's technical regulation. Although the SAR is determined at the highest certified power level, the actual SAR of the phone during operation can be well below the maximum value.

For further information about SAR, please see the websites below.

- ● ●  
World Health Organization (WHO) :  
<http://www.who.int/peh-emf/>
- ICNIRP :  
<http://www.icnirp.de/>
- MIC :  
<http://www.tele.soumu.go.jp/e/sys/ele/body/index.htm>
- TELEC :  
[http://www.telec.or.jp/ENG/Index\\_e.htm](http://www.telec.or.jp/ENG/Index_e.htm)
- NTT DOCOMO :  
<http://www.nttdocomo.co.jp/english/product/>
- FUJITSU LIMITED :  
<http://www.fmworld.net/product/phone/sar/>

- \*1 Ministry of Internal Affairs and Communications.
- \*2 The technical regulation is provided in Article 14-2 of the Ministry Ordinance Regulating Radio Equipment.
- \*3 International Commission on Non-Ionizing Radiation Protection.

## Declaration of Conformity

- ● ●  
The product "F-01B" is declared to conform with the essential requirements of European Union Directive 1999/5/EC Radio and Telecommunications Terminal Equipment Directive 3.1(a), 3.1(b) and 3.2. The Declaration of Conformity can be found at <http://www.fmworld.net/product/phone/doc/>.

This mobile phone complies with the EU requirements for exposure to radio waves.

Your mobile phone is a radio transceiver, designed and manufactured not to exceed the SAR\* limits\*\* for exposure to radio-frequency(RF) energy, which SAR\* value, when tested for compliance against the standard was 0.551W/Kg. While there may be differences between the SAR\* levels of various phones and at various positions, they all meet\*\*\* the EU requirements for RF exposure.

- \* The exposure standard for mobile phones employs a unit of measurement known as the Specific Absorption Rate, or SAR.
- \*\* The SAR limit for mobile phones used by the public is 2.0 watts/kilogram (W/Kg) averaged over ten grams of tissue, recommended by The Council of the European Union. The limit incorporates a substantial margin of safety to give additional protection for the public and to account for any variations in measurements.
- \*\*\* Tests for SAR have been conducted using standard operation positions with the phone transmitting at its highest certified power level in all tested frequency bands. Although the SAR is determined at the highest certified power level, the actual SAR level of the phone while operating can be well below the maximum value. This is because the phone is designed to operate at multiple power levels so as to use only the power required to reach the



network. In general, the closer you are to a base station antenna, the lower the power output.

### Federal Communications Commission (FCC) Notice

- This device complies with part 15 of the FCC rules. Operation is subject to the following two conditions :
  - ① this device may not cause harmful interference, and
  - ② this device must accept any interference received, including interference that may cause undesired operation.
- Changes or modifications made in or to the radio phone, not expressly approved by the manufacturer, will void the user's authority to operate the equipment.

### FCC RF Exposure Information

This model phone meets the U.S. Government's requirements for exposure to radio waves.

This model phone contains a radio transmitter and receiver. This model phone is designed and manufactured not to exceed the emission limits for exposure to radio frequency (RF) energy as set by the FCC of the U.S. Government. These limits are part of comprehensive guidelines and establish permitted levels of RF energy for the general population. The guidelines are based on standards that were developed by independent scientific organizations through periodic and thorough evaluation of scientific studies.

The exposure standard for wireless mobile phones employs a unit of measurement known as the Specific Absorption Rate (SAR). The SAR limit set by the FCC is 1.6 W/kg. Tests for SAR are conducted using standard operating positions as accepted by the FCC with the phone transmitting at its highest certified power level in all tested frequency bands. Although the SAR is determined at the highest certified power level, the actual SAR level of the phone while operating can be well below the maximum value. This is because the phone is designed to operate at multiple power levels so as to use only the power required to reach the network. In general, the closer you are to a wireless base station antenna, the lower the power output level of the phone.

Before a phone model is available for sale to the public, it must be tested and certified to prove to the FCC that it does not exceed the limit established by the U.S. government-adopted requirement for safe exposure. The tests are performed on position and locations (for example, at the ear and worn on the body) as required by FCC for each model. The highest SAR value for this model phone as reported to the FCC, when tested for use at the ear, is 0.462W/kg, and when worn on the body, is 0.521W/kg. (Body-worn measurements differ among phone models, depending upon available accessories and FCC requirements).

While there may be differences between the SAR levels of various phones and at various positions, they all meet the U.S. government requirements.

The FCC has granted an Equipment Authorization for this model phone with all reported SAR levels evaluated as in compliance with the FCC RF exposure guidelines. SAR information on this model phone is on file with the FCC and can be found under the Equipment Authorization Search section at <http://www.fcc.gov/oet/ea/fccid/> (please search on FCC ID VQK-F01B).

For body worn operation, this phone has been tested and meets the FCC RF exposure guidelines when used with an accessory designated for this product or when used with an accessory that contains no metal and which positions the handset at a minimum distance of 1.5 cm from the body.

\* In the United States and Canada, the SAR limit for wireless mobile phones used by the general public is 1.6 Watts/kg (W/kg), averaged over one gram of tissue. SAR values may vary depending upon national reporting requirements and the network band.

This equipment has been tested and found to comply with the limits for a Class B digital device, pursuant to part 15 of the FCC Rules.

These limits are designed to provide reasonable protection against harmful interference in a residential installation. This equipment generates, uses and can radiate radio frequency energy and, if not installed and used in accordance with the instructions, may cause harmful interference to radio communications. However, there is no guarantee that interference will not occur in a particular installation.

If this equipment does cause harmful interference to radio or television reception, which can be determined by turning the equipment off and on, the user is encouraged to try to correct the interference by one or more of the following measures:

- Reorient or relocate the receiving antenna.
- Increase the separation between the equipment and receiver.
- Connect the equipment into an outlet on a circuit different from that to which the receiver is connected.
- Consult the dealer or an experienced radio/TV technician for help.

## Important Safety Information

### AIRCRAFT

Switch off your wireless device when boarding an aircraft or whenever you are instructed to do so by airline staff. If your device offers flight mode or similar feature consult airline staff as to whether it can be used on board.

### DRIVING

Full attention should be given to driving at all times and local laws and regulations restricting the use of wireless devices while driving must be observed.

### HOSPITALS

Mobile phones should be switched off wherever you are requested to do so in hospitals, clinics or health care facilities. These requests are designed to prevent possible interference with sensitive medical equipment.

### PETROL STATIONS

Obey all posted signs with respect to the use of wireless devices or other radio equipment in locations with flammable material and chemicals. Switch off your wireless device whenever you are instructed to do so by authorized staff.

### INTERFERENCE

Care must be taken when using the phone in close proximity to personal medical devices, such as pacemakers and hearing aids.

### Pacemakers

Pacemaker manufacturers recommend that a minimum separation of 15 cm be maintained between a mobile phone and a pace maker to avoid potential interference with the pacemaker. To achieve this use the phone on the opposite ear to your pacemaker and does not carry it in a breast pocket.

### Hearing Aids

Some digital wireless phones may interfere with some hearing aids. In the event of such interference, you may want to consult your hearing aid manufacturer to discuss alternatives.

### For other Medical Devices :

Please consult your physician and the device manufacturer to determine if operation of your phone may interfere with the operation of your medical device.

## Index

# Export Administration Regulations

**This product and its accessories may be under coverage of the Export Administration Regulations of Japan ("Foreign Exchange and Foreign Trade Control Laws" and the related laws and regulations). And, they are also under coverage of Export Administration Regulations of the U.S. When exporting and reexporting this product and its accessories, take necessary procedures on your responsibility and expense. For details, contact Ministry of Economy, Trade and Industry of Japan or US Department of Commerce.**

## Index

# Intellectual Property Right

## Copyrights and portrait rights

Except for the case protected by copyright laws such as personal use, use of FOMA terminal to reproduce, alter, or publicly transmit recorded pictures or sounds, or copyrighted text, images, music or software downloaded from websites without the copyright holder's authorization is prohibited.







Note that taking photos or recordings at some demonstrations, performances or exhibitions may be prohibited even when only for personal use.

Avoid taking pictures of others with FOMA terminal without their consent or disclosing recorded pictures of others without their consent to general public through Internet websites etc., because they may infringe on portrait rights.

## Trademarks

Company and product names mentioned in this manual are trademarks or registered trademarks of their respective holders.

- "FOMA", "mova", "i-motion", "i-mode", "i-appli", "i-motion mail", "i-shot", "DoPa", "mopera", "mopera U", "WORLD CALL", "WORLD WING", "Chakumotion", "Deco-mail", "visualnet", "V-live", "i-area", "Chara-den", "i-appliDX", "i-Channel", "Dual Network", "FirstPass", "Security Scan", "Public mode", "ToruCa", "iD", "2in1", "DCMX", "OFFICEED", "IMCS", "Chokkan Game", "docomo PRIME series" and logos of "FOMA", "i-mode", "i-appli", "Music&Video Channel", "DCMX", "iD" and "HIGH-SPEED" are trademarks or registered trademarks of NTT DOCOMO.
- Microsoft<sup>®</sup>, Windows<sup>®</sup>, Windows Vista<sup>®</sup>, Windows Media<sup>®</sup> and PowerPoint<sup>®</sup> are trademarks or registered trademarks of "Microsoft Corporation" in the US and other countries.
- Microsoft Excel and Microsoft Word are product names of Microsoft Corporation in the U.S.A. In this manual, they may be described as Excel and Word.
- "Multitask" is a registered trademark of NEC Corporation.
- "Catch Phone (Call Waiting Service)" is a registered trademark of Nippon Telegraph and Telephone Corporation.
- Free Dial logo mark is a registered trademark of NTT Communications Corporation.

- Java and all Java-related trademarks and logos are trademarks or registered trademarks of Sun Microsystems, Inc. in the US and other countries.
- This product contains NetFront Browser, NetFront Sync Client of ACCESS CO., LTD.  ACCESS and NetFront are trademarks or registered trademarks of ACCESS CO., LTD. in Japan, US and other countries. Copyright © 2009 ACCESS CO., LTD. All rights reserved.
- Powered by JBlend® Copyright 2002-2009 Aplix Corporation. All rights reserved.  JBlend and JBlend-related trademarks are trademarks or registered trademarks of Aplix Corporation in Japan and other countries.
- This product contains Adobe® Flash® Lite® and Adobe Reader® Mobile technology of Adobe Systems Incorporated. Adobe Flash Lite Copyright © 2003-2009 Adobe Systems Incorporated. All rights reserved. Adobe Reader Mobile Copyright © 1993-2009 Adobe Systems Incorporated. All rights reserved. Adobe, Adobe Reader, Flash and Flash Lite are either registered trademarks or trademarks of Adobe Systems Incorporated in the United States and/or other countries.
- QR code is a registered trademark of Denso Wave Inc.
- microSDHC Logo is a trademark. 
- FeliCa is a registered trademark of Sony Corporation.  Powered by ADOBE FLASH®
- "CROSS YOU" is a trademark of Sony Corporation.
-  is a registered trademark of FeliCa Networks, Inc.
- Word, Excel and PowerPoint file display technologies are powered by Picsel Technologies.  Picsel, Picsel File Viewer and the Picsel cube logo are trademarks or registered trademarks of Picsel Technologies.
- McAfee® is registered trademarks or trademarks of McAfee, Inc. and/or its affiliates in the US and/or other countries.
- G-GUIDE, G-GUIDE MOBILE and their logos are registered trademarks in Japan of U.S. Gemstar-TV Guide International, Inc.  and/or its affiliates.

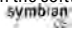
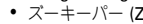
- QuickTime is a registered trademark of Apple Inc. in the US and other countries.
- ATOK + APOT of Justsystem Corporation is installed in this product as Japanese character conversion function.
- "ATOK" "APOT (Advanced Prediction Optimization Technology)" are registered trademarks of Justsystem Corporation.
- T9® is a trademark or registered trademark of Nuance Communications, Inc. in US and of Nuance corporations in other countries. 
- This equipment is provided with the software licensed by Symbian Software Ltd. or the licensor" 1998-2009.  and Symbian OS are trademarks of Symbian Ltd. or the licensor.
- "Privacy mode" is a registered trademark of FUJITSU LIMITED.
- Bluetooth® and its logo are registered trademarks of Bluetooth SIG, Inc., and NTT DOCOMO uses them under license. Other trademarks and names inhere to their respective owners.
- Napster is a registered trademark of Napster, LLC. and/or its affiliates in the US and/or other countries.
- Manufactured under license from Dolby Laboratories. Dolby and the double-D symbol are trademarks of Dolby Laboratories.
- FrameSolid is the registered trademark of Morpho, Inc. in Japan and other countries.
- The automatic guiding technology utilized is TrackSolid, a product of Morpho, Inc. TrackSolid is a trademark of Morpho, Inc.
- Google is registered trademark of Google Inc.
-  (Zookeeper) is a trademark or registered trademark of KITERETSU Inc.
- "日英版しゃべって翻訳 for F (J-E Speech Translation for F)" is trademark of ATR-Trek.
- Other company and product names mentioned in this manual are trademarks or registered trademarks of their respective holders.
- The abbreviations of operating systems (Japanese versions) below are used in this manual.
  - Windows Vista stands for Windows Vista® (Home Basic, Home Premium, Business, Enterprise and Ultimate).

- Windows XP indicates the Microsoft® Windows® XP Professional operating system or Microsoft® Windows® XP Home Edition operating system.
- Windows 2000 indicates the Microsoft® Windows® 2000 Professional operating system.

## Others

- FeliCa is a contactless IC card technology developed by Sony Corporation.
- This product contains a module developed by the Independent JPEG Group.
- The image interpolation technology utilized is FrameSolid, a product of Morpho, Inc.
- This product is equipped with the technologies of GestureTek, Inc. Copyright© 2006-2009, GestureTek, Inc. All Rights Reserved.
- "学研モバイル国語辞典 (Gakken Mobile JpnDic)", "学研モバイル和英辞典 (Gakken Mobile JE Dic)", "学研モバイル英和辞典 (Gakken Mobile EJ Dic)", "今日は何の日 (Today's trivia)" and "今日の歴史 (Today in history)" are copyrighted by GAKKEN CO., LTD.
- This product is licensed based on MPEG-4 Visual Patent Portfolio License. The use of MPEG-4 Video Codec function is allowed for personal and nonprofit use only in the cases below.
  - Recording moving pictures and i-motion that conform to MPEG-4 Visual Standard (hereinafter referred to as MPEG-4 Video)
  - Playing MPEG-4 Videos recorded personally by consumers not engaged in profit activities
- Playing MPEG-4 Video supplied from the provider licensed from MPEG-LA For further utilizing such as promotion, in-house use or profit-making business, please contact MPEG LA, LLC in U.S.
- Content owners use Windows Media digital rights management technology (WMDRM) to protect their intellectual property, including copyrights. This device uses WMDRM software to access WMDRM-protected content. If the WMDRM software fails to protect the content, content owners may ask Microsoft to revoke the software's ability to use WMDRM to play or copy protected content. Revocation does not affect unprotected content. When downloading licenses for protected content, you agree that Microsoft may include a "Revocation List" with the licenses. Content owners may require you to upgrade WMDRM to access their content. If you decline an upgrade, you cannot access a content that requires the upgrade.

## General Inquiries <docomo Information Center>

### 0120-005-250 (toll free)

\* Service available in: English, Portuguese, Chinese, Spanish, Korean.

\* Available from mobile phones and PHSs.

■ From DOCOMO mobile phones  
(In Japanese only)

■ From land-line phones  
(In Japanese only)

 (No prefix) 151 (toll free)

 0120-800-000 (toll free)

\* Unavailable from land-line phones, etc.

\* Available from mobile phones and PHSs.

● Please confirm the phone number before you dial.

● For Applications or Repairs and After-Sales Service, please contact the above-mentioned information center or the docomo shop etc. near you on the NTT DOCOMO website or the i-mode site.

▶ NTT DOCOMO website <http://www.nttdocomo.co.jp/english/> ▶ i-mode site iMenu⇒お客様サポート (user support)⇒ドコモショップ (docomo Shop) \* In Japanese only

## Loss or theft of FOMA terminal or payment of cumulative cost overseas <docomo Information Center>

(available 24 hours a day)

■ From DOCOMO mobile phones

International call access code for  
the country you stay (table 1)

-81-3-5366-3114\* (toll free)

\* You are charged a call fee to Japan when calling from a land-line phone, etc.

※If you use F-01B, you should dial the number +81-3-5366-3114 (to enter '+', press and hold the '0' key for at least one second).

■ From land-line phones <Universal number>

International prefix number for  
the universal number (table 2)

-800-0120-0151\*

\* You might be charged a domestic call fee according to the call rate for the country you stay.

※See page XXX for international call access codes for major countries (table 1) and international prefix numbers for the universal number (table 2).

● If you lose your FOMA terminal or have it stolen, immediately take the steps necessary for suspending the use of the FOMA terminal.

● If the FOMA terminal you purchased is damaged, bring your FOMA terminal to a repair counter specified by DOCOMO after returning to Japan.



Li-ion 00

To prevent damage to the environment, bring used battery packs to a docomo service counter, a docomo agent or a recycle center.



This manual is printed using an ink based on soy bean oil.



Don't forget your mobile phone ... or your manners!

When using your mobile phone in a public place, don't forget to show common courtesy and consideration for others around you.

## Repairs

■ From DOCOMO mobile phones  
(In Japanese only)

■ From land-line phones  
(In Japanese only)

 (No prefix) 113 (toll free)

 0120-800-000 (toll free)

\* Unavailable from land-line phones, etc.

\* Available from mobile phones and PHSs.

## Failures encountered overseas <Network Operation Center>

(available 24 hours a day)

■ From DOCOMO mobile phones

International call access code for  
the country you stay (table 1)

-81-3-6718-1414\* (toll free)

\* You are charged a call fee to Japan when calling from a land-line phone, etc.

※If you use F-01B, you should dial the number +81-3-6718-1414 (to enter '+', press and hold the '0' key for at least one second).

■ From land-line phones <Universal number>

International prefix number for  
the universal number (table 2)

-800-5931-8600\*

\* You might be charged a domestic call fee according to the call rate for the country you stay.

※See page XXX for international call access codes for major countries (table 1) and international prefix numbers for the universal number (table 2).

Sales: NTT DOCOMO, INC.  
Manufacturer: FUJITSU LIMITED