

Part names and functions

Part names of F-02B and major functions assigned to each part are as follows.

Introduction

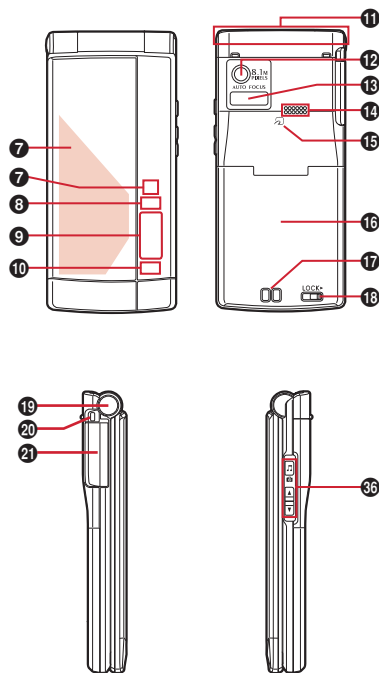
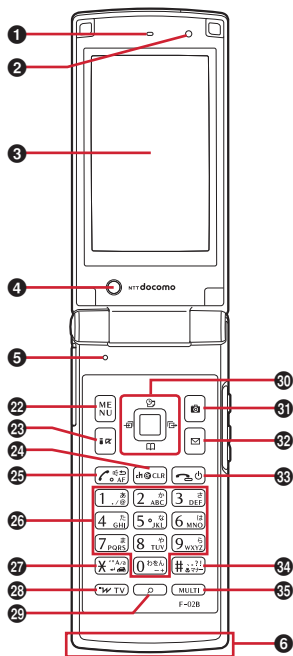

- 1 Earpiece**
Hear other party's voice from here.
- 2 Light sensor**
Sense the ambient luminance to automatically adjust the brightness of the display. Do not cover the sensor with your hand.
- 3 Display**⇒P28, 31
- 4 In-camera**
Shoot your own image, or send your image via videophone.
- 5 Microphone**
Send your voice from here. Do not cover the microphone during a call or sound recording.
- 6 1Seg antenna (built into FOMA terminal)**
For better signal reception, do not cover the antenna with your hand.
- 7 Light**
* ● area turns on or blinks when operating MUSIC Player with FOMA terminal closed, when receiving mails/voice calls, making a voice call, or closing FOMA terminal.
- 8 Call light**
- 9 Sub-display**⇒P29
- 10 Mail light**

11 FOMA antenna (built into FOMA terminal)

For a call in better conditions, do not cover the antenna with your hand.

12 Out-camera

Shoot still images or moving pictures, or send image via videophone.

13 Infrared data port

Use this port for infrared communication or infrared remote control function.

14 Speaker

Hear ring alert or voice of the caller using the handsfree function.

15 Mark

Use Osaifu-Keitai or send/receive data by iC transmission.

16 Back cover

* To access the microSD card slot, remove the back cover, open the inner cover, and then remove the battery pack.

17 Charging jack

18 Back cover lever

19 Open assist button

20 Strap opening

21 External connection jack

Available to connect an optional AC adapter, DC adapter, FOMA USB Cable with Charge Function, Earphone Plug Adapter for External connector terminal etc.

22 MENU key

Display a menu, perform the operation displayed at upper left of the guide area, or activate/deactivate HOLD.

23 i-mode/i-appli/Character/▲ (Scroll) key

Switch i-mode views, i-appli folder views, character entry modes, scroll the mail screen up, or perform the operation displayed at lower left of the guide area.

24 CLR Ch/α/Clear key

Display i-Channel, switch displaying the i-appli standby screen or starting i-appli, return to the previous screen, or clear an entered character.

25 Start a voice call/Handsfree/AF key

Make/answer a voice call, return to the previous character when entering characters, activate the handsfree function, activate/deactivate auto focus.

26 Keypads

1 - 9

Enter phone number or characters, select an item, perform a function registered to My shortcut

0

Enter phone number or characters, select an item, use Auto switch of Int'l call assist when making international calls.

27 */A/a/Line feed/Public mode (Drive mode) key

Enter "*", voiced/semi-voiced sound, switch upper or lower case, start/cancel Public mode (Drive mode).

28 TV i-Widget/TV key

Start/Exit i-Widget or start 1Seg.

29 Search key

Start Quick search.

30 Multi-cursor key

Move the cursor, or operate a menu.

 : Perform an operation.

 : Display Scheduler, or adjust the volume.







 : Display Phonebook, or adjust the volume.

 : Display Received calls.

 : Display Redial.

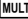
31 Camera key

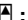
Shoot still images or moving pictures, or perform the operation displayed at upper right of the guide area.

- 32  **Mail key/▼(Scroll) key**
Display a menu, perform the operation displayed at lower right of the guide area, scroll the main screen down, move to the next page on Browser screen, or check new message (by pressing the key twice)
- 33  **Power/End key**
Put a call on hold, exit a function, display/hide Info/calendar layout, or turn on/off FOMA terminal (by holding the key for 2 sec. or more)
- 34  **#/Macro shooting/Silent mode key**
Enter "#" or punctuation, switch Macro mode on/off, or start/cancel Silent mode.
- 35  **MULTI Multitask key**
Perform a different function when making a call or operating the terminal, or activate/deactivate Privacy view.
- 36 **Side keys**
-  : Use for operating MUSIC Player or Music&Video Channel.
 -  : Stop the ring tone, alarm sound, vibration, or adjust the volume.
 -  : Adjust the volume, turn on the light on the sub-display or switch the views.

Example of connecting Flat-Plug Earphone/Microphone with Switch (optional)

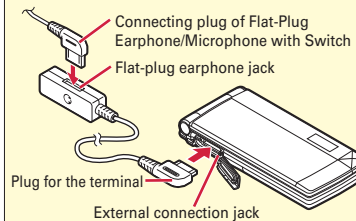



About FOMA Terminal



- Because your FOMA terminal uses wireless transmission, it may not function in locations where it is difficult for radio waves to penetrate, such as tunnels, underground passages and some buildings, in areas where radio waves are weak, or out of service area. Even when you are high up in a tall building or condominium and nothing blocks your view outside, your FOMA terminal may not be able to receive or transmit signals. Also, communication may be interrupted even when the signal meter on your FOMA terminal indicates there are strong radio waves and you are not moving (traveling).
- Use your FOMA terminal in a way that does not disturb others in public spaces, crowded locations or quiet places.
- Because your FOMA terminal uses radio waves to communicate, it is possible that a third party may attempt to tap your calls. However, the W-CDMA, GSM/GPRS system automatically applies a confidential communication function to all calls, so even if a third party could somehow tap a call, they only hear noise.
- Your FOMA terminal encodes voice communication as digital data. When you are operating your FOMA terminal while moving to a location subject to weaker radio wave conditions, the transmitted digital data may not be correctly decoded and as a result the decoded voice may differ somewhat from the actual voice.
- Maintain a separate record of the data (Phonebook, Schedule, Notepad, Recorded messages, Voice memos, Moving picture memos, etc.) you registered in your FOMA terminal. Note that DOCOMO assumes no responsibility for any loss of saved contents of data resulting from malfunction, repair, changing of the model or other handling of FOMA terminal.
- You are recommended to save important data to microSD card. Using DOCOMO keitai datalink, you can transfer and save phonebook, mail, schedule and other data to a PC.
- The user hereby agrees that the user shall be solely responsible for the result of the use of SSL/TLS. Neither DOCOMO nor the certifier as listed herein makes any representation and warranty as for the security in the use of SSL/TLS. If the data should be erased, DOCOMO assumes no responsibility for the loss of any data.
Certifier : VeriSign Japan K.K., Cybertrust Japan Co., Ltd., GlobalSign K.K., RSA Security Japan Ltd., SECOM Trust Systems Co., Ltd., Comodo CA Ltd.
- This FOMA terminal supports FOMA Plus-Area and FOMA HIGH-SPEED Area.
- FOMA terminal can be used only via the FOMA network provided by DOCOMO and DOCOMO's roaming area.
The FOMA terminal can be used only via the FOMA network provided by DOCOMO and DOCOMO's roaming area.





Precautions (ALWAYS FOLLOW THESE DIRECTIONS)

- Before using your FOMA terminal, or when necessary, read the precautions below to ensure safe use and handling. After reading this manual, keep it carefully.
- These precautions are intended to protect you and others around you. Read and follow them carefully to avoid injury, damage to the product or damage to property.
- The signs below differentiate between the levels of danger that can occur if the product is not used within the specified guidelines.

 DANGER	This sign denotes that death or serious injury may directly result from improper use.
 WARNING	This sign denotes that death or serious injury may result from improper use.
 CAUTION	This sign denotes that bodily injury or damage to property may result from improper use.

- The symbols below show specific directions.

 Don't	This symbol denotes that the action is prohibited.
 No disassembly	This symbol denotes that disassembling the phone or its components is not allowed.

 No wet hands	This symbol denotes that using the phone or its components with wet hands is not allowed.
 No liquids	This symbol denotes that using the phone or its components in a bathroom or other highly humid area is not allowed.
 Do	This symbol denotes that an instruction must be obeyed at all times.
 Unplug	This symbol denotes that the equipment should be unplugged.

■ Precautions contain the description below.

Handling FOMA terminal, battery pack, adapter and UIM (common)	9
.....	9
Handling FOMA terminal	10
Handling battery pack	12
Handling adapter	13
Handling UIM	14
Handling mobile phones near electronic medical equipment.....	14

Handling FOMA terminal, battery pack, adapter and UIM (common)

DANGER



Don't

Do not use, store, or leave the equipment in hot areas such as near flames or in areas under strong direct sunlight such as inside a vehicle.

May cause the equipment to be deformed or malfunction, and battery pack to leak, heat, burst or ignite, and the capability or life to be reduced or shortened. Overheating on parts of the case may cause burns or injuries.



No disassembly

Do not disassemble or remodel the equipment. Do not solder items onto the equipment.

May cause fire, injuries, electric shock, or malfunction. It may also cause the battery pack to leak, heat, burst or ignite.



No liquids

Do not let the equipment get wet.

Contact with water or other liquids can cause heating, electric shock, fire, malfunctions or injuries. Take care of the place for use and treatment of the equipment.



Do

Use the battery pack and adapter specified by NTT DOCOMO for your FOMA terminal.

Use of equipment not specified by DOCOMO can cause FOMA terminal, battery pack and other parts to leak, heat, burst, catch fire or malfunction.

WARNING



Don't

Do not put the battery pack, FOMA terminal, adapter or UIM in microwave ovens or other heating appliances or high-pressure containers.

It may cause the battery pack to leak, heat, burst or ignite, may cause FOMA terminal or adapter to heat, smoke, ignite, or may damage circuits.



Don't

Do not throw the equipment or give hard shock to it.

May cause the battery pack to leak, heat, burst or ignite, and the equipment to malfunction or catch fire.



Don't

Keep conductive materials (metal pieces, pencil lead, etc.) from coming in contact with the charging jack or external connection jack. Do not put those materials inside the terminal.

May be subject to electrical short and could cause fire or malfunction.



Do

Turn FOMA terminal OFF before entering a place such as a gas

station where flammable gases are generated.

Do not charge the battery. The gas may catch fire.

When using Osaifu-Keitai in a place as a gas station, turn OFF the terminal before using it. (When IC card lock is activated, deactivate it before turning OFF the terminal.)



Do

If the equipment starts giving off a strange smell, overheats, becomes discolored or deformed during use, charging or in storage, immediately perform the following operations.

1. Remove the power plug from the wall outlet or cigarette lighter socket.
2. Turn FOMA terminal OFF.
3. Remove the battery pack from FOMA terminal.

May cause the equipment to heat, burst or ignite or the battery pack to leak if you keep using the equipment.

CAUTION



Don't

Do not leave the equipment on unstable or sloping surfaces.

May cause malfunction or injuries.



Don't

Do not store the equipment in extremely humid, dusty or hot areas.

Doing so may cause malfunction.



Do

Children using the equipment should be instructed in proper operation by an adult. Do not allow them to use the equipment without adult supervision.

May cause injuries.



Do

Store the equipment out of reach of small children.

May be accidentally swallowed or cause injuries.



Do

Be careful especially when using FOMA terminal connected to the adapter continuously for a long time.

If you use i-appli, a videophone call or 1Seg watching while charging the battery for a long time, FOMA terminal, battery pack and adapter may be heated.

Directly touching a hot part for a long time, you may have redness, itching or rash on your skin, or it may result in low-temperature burns depending on your constitution and/or health condition.

Handling FOMA terminal

WARNING



Don't

Do not direct the infrared data port toward your eye and transmit signals.

May affect your eyes. Faulty operation could result from directing the infrared data port toward other infrared equipment and transmitting signals.



Don't

Do not put FOMA terminal in the place such as the dashboard near the air-bag, where the influence of air-bag explosion is expected.

When the air-bag explodes, FOMA terminal may hit yourself or others and could cause injury, equipment malfunction or damage.



Don't

When you use electronic medical equipment, do not keep the terminal in your chest pocket or inside pocket.

Using your FOMA terminal near medical electronic equipment could cause equipment failure.



Don't

Do not put foreign objects such as liquid like water, metal pieces or burnable things into UIM or microSD card slot.

May cause fire, electric shock or malfunction.



Do

Turn FOMA terminal OFF in areas where use is prohibited, such as in airplanes and hospitals.

May cause electronic equipment or electronic medical equipment to fail or malfunction. If the function which automatically turns the power ON is set, cancel the setting before turning the power OFF.

When using the phone in a medical facility, be sure to observe the regulations of the facility. If you do prohibited act such as using the phone in an airplane, you may be punished according to law.



Do

When you talk by setting handsfree, always keep FOMA terminal away from your ear. And, when connecting the earphone/microphone to FOMA terminal and play a game or music, adjust the volume moderately.

Too loud volume may cause a hearing loss. And, if you cannot hear the sound around you clearly, it may cause an accident.



Do

If you have weak heart, be careful when setting the Vibrate alert (vibration) or alert volume setting.

Could affect heart function.



Do

If it starts thunder while using the terminal outdoors, turn the power OFF immediately, and move to a safe location.

May be subject to lightning strike and could cause electric shock.



Do

Turn FOMA terminal OFF near high-precision electronic control equipment or electronic equipment using low-power signals.

May cause the equipment to fail or malfunction.

* Examples of electronic equipment to avoid.

Hearing aids, implanted pacemakers or defibrillators, other electronic medical equipment, fire alarms, automatic doors and other automatic control equipment. Users wearing implanted pacemakers or defibrillators or other electronic medical equipment should check with the manufacturer or sales outlet about the effect of radio frequencies on the equipment.



Do

When the display or camera lens is accidentally broken, be careful of broken glass or exposed internal parts of FOMA terminal.

Surfaces of display and camera lens are made of plastic panels and they are structured for the glass not to scatter, however, if you mistakenly touch broken or exposed parts, you may be injured.

CAUTION



Don't

Do not swing FOMA terminal by its strap.

May cause the terminal damage or failure, or injury to yourself or others.



Don't

When using the motion tracking or motion sensor, check the safety around you, hold FOMA terminal

firmly, and do not shake it unnecessarily.

The motion tracking and motion sensor are functions to operate by tilting or shaking FOMA terminal. There is a risk that FOMA terminal hits people or objects around you by shaking it too much, causing a serious accident or damage.



Don't

If you put a metal strap or the like to FOMA terminal, be careful not to let the strap hit people or objects around you when performing motion tracking or using motion sensor.

Accidents such as injury, malfunction or damage may result.



Don't

If the display part is accidentally broken and liquid crystal leaks out, do not put the liquid in your mouth, inhale, or make contact with your skin.

If the liquid gets into your eyes or mouth, rinse it with clean water and see a doctor immediately.

And, if the liquid adheres to skin or clothing, use alcohol etc. to wipe it off, then wash with soap.

May cause loss of sight or skin problems.



Don't

Do not bring the speaker close to your ear when the ring alert is

sounding or you are playing a melody with FOMA terminal.

May cause hearing loss.



Do

In rare cases, using the phone in some vehicle models can cause the vehicle's electronic equipment to malfunction or fail.

In this case, do not use the phone because it may hamper safe driving.



Do

Mobile phones can give some users skin problems such as itching, allergic reactions or rashes. If you develop skin problems, stop using the phone immediately, and see a doctor. FOMA terminal contains metal in the parts below.

Part	Material	Surface treatment
Back cover plate	SUS	None
Rear side of back cover	SUS	None
Screw	SUS	None
Charging jack	SUS	Gold plating
External connection jack	SUS	Gold plating
Nameplate attach place	PC board	Gold plating

Part	Material	Surface treatment
Battery pack connector jack	Beryllium copper	Gold plating



Do

When opening or closing FOMA terminal, take care not to have your fingers or strap caught by the terminal.

May cause injuries or damages.



Do

When watching 1Seg, take a certain distance from the display in a fully bright place.

May cause your eyesight to be impaired.

Handling battery pack

- **Check that the battery type matches the type displayed on the battery pack label.**

Display	Battery type
Li-ion 00	Li-ion battery

DANGER



Don't

Do not connect a wire or other metal objects to the jack. And, do not carry or store FOMA terminal with objects like a metal necklace.

May cause the battery pack to leak, heat, burst or ignite.



Don't

Do not try to force the battery pack onto FOMA terminal if you are having trouble installing it. Always install it after checking that it is correctly oriented.

May cause the battery pack to leak, heat, burst or ignite.



Don't

Do not throw the battery pack into the fire.

May cause the battery pack to leak, heat, burst or ignite.



Don't

Do not nail the battery pack, hit with a hammer or step on it.

May cause the battery pack to leak, heat, burst or ignite.



Do

If the battery pack's fluid contacts eyes, immediately flush the eyes with clean water and see a doctor right away. Do not rub the eyes.

May cause loss of sight.

WARNING



Don't

If the battery pack seems to have abnormalities such as deformation or scratches due to an external impact or falling, stop using it immediately.

May cause the battery pack to leak, heat, burst or ignite, and the equipment to malfunction or catch fire.



Do

If the battery pack does not have a full charge after being charged for the specified time, stop charging it.

May cause the battery pack to leak, heat, burst or ignite.



Do

If the battery pack leaks or gives off a strange smell, immediately remove it from the vicinity of open flames.

The vapors from leaking battery pack fluid may ignite or explode.



Do

Be careful not to let your pet bite the battery pack.

May cause the battery pack to leak, heat, burst or ignite, and the equipment to malfunction or catch fire.

CAUTION



Don't

Do not discard old battery packs together with other garbage.

May cause igniting or environmental destruction. Tape the terminals of old battery packs to insulate them, and then bring them into a sales outlet such as docomo Shop. If your local municipality has a battery recycling program, dispose of them as provided for.



Don't

Do not charge a wet battery pack.

May cause heat generation, ignition or rupture of the battery pack.



If the battery pack's fluid contacts skin or clothes, immediately flush the contacted area thoroughly with clean water.

May hurt the skin.

Do

Handling adapter

WARNING



Do not use the adapter cord or power cord if it gets damaged.

Don't

May cause electric shock, heat or fire.



Do not use the AC adapter or desktop holder in a bathroom or other highly humid area.

Don't

May cause electric shock.



Always use the DC adapter with a negative-ground vehicle. Do not plug it into a positive-ground vehicle.

Don't

May cause fire.



When it starts to thunder, do not touch FOMA terminal and adapter.

Don't

May be subject to lightning strike and could cause electric shock.



Do not short the charging jack while it is connected to the outlet or cigarette lighter socket. Do not touch the charging jack with a part of your body such as your hand or finger.

Don't

May cause fire, malfunction, electric shock or injuries.



Place the adapter and desktop holder in a stable location while charging. Do not cover or wrap the adapter and desktop holder with a cloth or blanket.

Don't

May cause FOMA terminal to be removed or the optional devices to be heated, resulting in fire or troubles.



Do not place heavy objects on the adapter cord or power cord.

Don't

May cause electric shock or fire.



Do not touch the adapter cord or outlet with wet hands.

No wet hands

May cause electric shock.



Only use with the specified power source and voltage.

Do

If incorrect voltage is used, this may cause fire or failure. When using FOMA terminal overseas, use AC Adapter for global use.
AC adapter : AC100V
DC adapter : 12 or 24V DC (specific for negative ground vehicle)
AC adapter for global use : Between 100V and 240V AC (Connect to the AC outlet for internal household use)



If the DC adapter's fuse blows, replace it only with the specified fuse.

Do

Using other fuses may cause fire or equipment failure. For the specified fuse, see the instructions that come with the DC adapter.



Wipe off any dust that accumulates on the power plug.

Do

May cause fire.



When you connect the AC adapter to an outlet, make sure not to touch with metal such as metal straps and firmly connect to the outlet.

Do

May cause electric shock, electrical short or fire.



Do

When you disconnect the adapter from the outlet or cigarette lighter socket, do not pull the adapter cord or power cord with excessive force. Instead, hold the power plug to disconnect.

Pulling the cord could damage it, possibly leading to electric shock or fire.



Unplug

Always remove the power plug from the outlet when not using the adapter for an extended period.

May cause electric shock, fire or malfunction.



Unplug

Immediately remove the power plug from the outlet or cigarette lighter socket if water or other fluids get into the adapter.

May cause electric shock, smoke or fire.



Unplug

Always remove the power plug from the cigarette lighter socket when cleaning the equipment.

May cause electric shock.

Handling UIM

CAUTION



Do

Be careful of the cut surface when removing UIM (ICs).

May hurt hands or fingers.

Handling mobile phones near electronic medical equipment

- **These precautions are based on the guidelines produced at the Electromagnetic Compatibility Conference Japan, regarding the protection of electronic medical equipment from radio waves emitted by mobile phone units.**

WARNING



Do

Obey the following rules inside medical facilities.

- Do not bring FOMA terminal into operating rooms (ORs), intensive care units (ICUs) or coronary care units (CCUs).
- Turn FOMA terminal OFF in hospital wards.
- Turn FOMA terminal OFF in hospital lobbies and corridors if electronic medical equipment could be nearby.
- If the medical facility has specified zones where use or possession of mobile devices is prohibited, obey those instructions.
- If the function to automatically turn ON the power is set, cancel the setting before turning the power OFF.



Do

Turn FOMA terminal OFF in crowded trains or other public places where pacemaker or defibrillator wearers could be nearby.

FOMA terminal's signals may affect the operation of implanted pacemakers or defibrillators, and other devices.



Do

Wearers of implanted pacemakers or defibrillators must carry and use FOMA terminal at least 22 cm away from the implanted device.

FOMA terminal's signals may affect the operation of implanted pacemakers or defibrillators, and other devices.



Do

When electronic medical equipment other than implanted pacemakers or defibrillators are in use outside of medical facilities (such as in home care settings), check with the device manufacturer to determine how the device is affected by electrical signals.

FOMA terminal's signals may affect the performance of electronic medical equipment.

Handling precautions

General

- **F-02B is waterproof/dustproof, however, do not allow water or dust to seep into FOMA terminal and do not allow accessories or optional devices to get wet or let dust attach.**
 - FOMA terminal is provided with waterproofness/dustproofness of IPX5 and IPX8 (which exceeds IPX7) by firmly closing the external connection jack cap and installing the back cover in a locked state, however, it is not complete waterproofness/dustproofness. Do not install/remove the battery pack or do not open/close the external connection jack cap and back cover in the rain or with waterdrop adhered to them. Water may seep inside and cause corrosion or malfunction. Also, accessories and optional devices are not waterproof/dustproof. Malfunctions, which are determined to be caused by water or dust as result of inspections, are not covered by the warranty. Since these conditions are outside the scope of the warranty, a repair, if at all possible, is charged.
- **Clean FOMA terminal with a dry soft cloth (such as a cloth for eyeglasses).**
 - The display of FOMA terminal may have been applied special coating to improve clearness of the color LCD. When cleaning FOMA terminal, rubbing it roughly with a dry cloth can scratch the display. Take care when handling the unit, and clean it with a dry soft cloth (such as a cloth for eyeglasses). Drops of water or dirt left on the display can cause stains or remove the coating.
 - If FOMA terminal is wiped with alcohol, paint thinner, benzine or detergent, the printing may disappear or color may fade.
- **Clean the jack occasionally with a dry cotton swab etc.**
 - If the jack is soiled, connection gets worse and it may cause power to be turned off or insufficient battery charge, so clean the jack with a dry cotton swab etc. Also, be careful never to damage the jack when cleaning it.
- **Do not place FOMA terminal near an air-conditioner outlet.**
 - The rapid change in temperature may cause condensation, causing internal corrosion and malfunction.

- **When using, be careful not to subject excessive force to FOMA terminal or the battery.**

- If FOMA terminal is crammed into a brimming bag or placed in a pocket and sat on, display, internal PCBs or battery pack may be damaged or malfunction. And, if external devices are plugged into the external connection jack (earphone/microphone jack), the breakage of the connector or malfunction may result.

- **Carefully read the separate instructions that come with FOMA terminal, adapter and desktop holder.**

- **Do not rub or scrape the display with a metal piece etc.**

- It may scratch the display, causing malfunction or damage.

FOMA terminal

- **Avoid extreme temperature.**

- Use FOMA terminal where the temperature ranges between 5 and 40°C (limited to the temporary use in a bathroom etc. when temperature is above 36°C) and humidity ranges between 45 and 85%.

- **FOMA terminal may affect land-line phones, TVs or radios in use nearby, so use it as far as possible from these appliances.**

- **Maintain a separate record of the data you saved in your FOMA terminal.**

- If the data is deleted, DOCOMO assumes no responsibility for the loss of any data.

- **Do not drop FOMA terminal or subject it to shocks.**

- May cause malfunction or damage.

- **Do not plug external devices into the external connection jack (earphone/microphone jack) at a slant, or do not pull it forcibly while it is plugged.**

- May cause malfunction or damage.

- **Do not close FOMA terminal with the strap etc. held inside.**

- May cause malfunction or damage.

- **It is normal for FOMA terminal to become warm during use or charging. Continue to use it.**

- **Do not leave FOMA terminal with the camera in areas under strong direct sunlight.**

- May cause discoloring or burn-in of materials.
- **FOMA terminal should normally be used with the external connection jack cap closed.**
 - Dust and/or water brought into FOMA terminal cause troubles.
- **Do not use FOMA terminal with the back cover removed.**
 - It may cause the battery to come off, or may cause a malfunction or damage.
- **Do not put extremely thick stickers on the display or the key side.**
 - Doing so may cause malfunction.
- **While microSD card is being used, do not take the card out and do not turn off FOMA terminal.**
 - May cause data loss or malfunction.
- **Do not bring magnetic cards etc. close to FOMA terminal.**
 - Magnetic data in cash cards, credit cards, telephone cards, floppy disks, etc. may be erased.
- **Do not bring magnetized objects close to FOMA terminal.**
 - Bringing strong magnetism close may cause a malfunction.

Battery pack

- **The battery pack is a consumable part.**
 - Replace the battery pack if FOMA terminal has extremely short operation time on a full charge, though it may vary by operating conditions. Purchase a new battery pack of the specified type.
- **Charge the battery in an area within the proper ambient temperature range (5-35°C).**
- **Always charge before using it for the first time or after extended disuse.**
- **The operation time provided by the battery pack varies by the operating environment and battery pack's deterioration.**
- **The battery pack may swell out as it comes to near the end of its lifetime depending on the usage conditions, but it is not a problem.**
- **Be careful especially about the following points when preserving or leaving the battery pack for a long time.**
 - Keeping under the state of the full charge (right after charging ends)

- Keeping under the state of the empty charge (too exhausted to turn on FOMA terminal)
- They may cause the battery pack performance to be degraded or its lifetime to be shortened.
- For necessary battery level to keep for a long time, the display of battery icon is a state of approximately 2 or 3 cells.

Adapter

- **Charge the battery in an area within the proper ambient temperature range (5-35°C).**
- **Do not charge the battery in the areas below.**
 - In areas of excessive humidity, dust or vibrations
 - Near land-line phones or TVs/radios
- **It is normal for the adapter to become hot while charging. Continue to use it.**
- **When using the DC adapter for charging, keep the vehicle engine running.**
 - The vehicle's battery could become flat.
- **When using an outlet with a mechanism preventing unplugging, follow the handling instructions for that outlet.**
- **Do not give strong shock. Do not deform the charging jack.**
 - Doing so may cause malfunction.

UIM

- **Do not use excessive force to install/remove UIM.**
- **It is normal for UIM to become warm during use. Continue to use it.**
- **Note that DOCOMO assumes no responsibility for malfunctions occurring as the result of inserting and using a UIM with another IC card reader/writer.**
- **Always keep UIM ICs clean.**
- **Clean UIM with a soft, dry cloth (such as a cloth for eyeglasses).**
- **Maintain a separate record of the data you saved in UIM.**

- If the data is deleted, DOCOMO assumes no responsibility for the loss of any data.
- **To preserve the environment, bring the old UIM to a sales outlet such as docomo Shop.**
- **Avoid extreme temperature.**
- **Take care not to scratch, touch accidentally or short IC.**
 - May cause data loss or malfunction.
- **Do not drop UIM or subject it to shocks.**
 - Doing so may cause malfunction.
- **Do not bend UIM or place heavy objects on it.**
 - Doing so may cause malfunction.
- **Do not install UIM into FOMA terminal with a label or sticker put on UIM.**
 - Doing so may cause malfunction.

FeliCa reader/writer

- **FeliCa reader/writer function of FOMA terminal uses weak waves requiring no licenses for radio stations.**
- **It uses 13.56 MHz frequency band. When using other reader/writers in your surroundings, keep FOMA terminal away sufficiently from them. Before using the FeliCa reader/writer, confirm that there are no radio stations using the same frequency band nearby.**

CAUTION

- **Do not use a remodeled FOMA terminal. Using a remodeled terminal violates the Radio Law.**

FOMA terminal is certified according to technical standard conformance of specified wireless equipment based on the Radio Law, and as a proof of it, the "Technical Compliance Mark (TCM)" is depicted on the engraved sticker of FOMA terminal.

If you remodel FOMA terminal by removing its screws, your certification of technical standard conformance becomes invalid.

Do not use FOMA terminal with its certification of technical standard conformance invalid as it violates the Radio Law.

- **Be careful when you use FOMA terminal while driving a car etc.**
Using a mobile phone while driving is subject to penal regulations. If you inevitably receive a call, tell the caller that you will "call back" by handsfree, then park in a safe place and call back.
- **Use FeliCa reader/writer function only in Japan.**
FeliCa reader/writer function of FOMA terminal conforms to Japanese radio standards. If you use this function overseas, you may be punished.

Waterproofness/Dustproofness

F-02B is provided with the following waterproofness by firmly closing the external connection jack cap, installing the back cover and locking the cover.

- **IPX5 (Former JIS protection code 5)*¹**
- **IPX8*³ that is a higher standard than IPX7 (former JIS protection code 7)*²**

Also, F-02B is dustproof to IP5X (former JIS protection code 5)*⁴ if the external connection jack cap is strictly closed as well as the back cover is mounted and locked.

- *1 Code IPX5 means that a phone keeps functioning after directly applying a jet flow of 12.5 L/min. for at least 3 minutes from a distance of 2.5-3 m on a rotating turntable.
- *2 Code IPX7 means that a phone keeps functioning after it is slowly submerged to depth of 1 m in static tap water at room temperature, left there for 30 minutes and then taken out.
- *3 Code IPX8 means that it provides waterproofness of which exceeds of IPX7 standard.
- *4 Code IP5X means that a device is protected against the ingress of dust specific to dustproof test (25 μ m or smaller in diameter), so that the ingress will not interfere with predefined operation and safety of the device.



F-02B provides the following waterproof performances of IPX8.

- F-02B keeps functioning after it is slowly submerged to depth of 1.5 m in static tap water at room temperature, left there for 30 minutes and then taken out.
- The mobile phone keeps shooting still images or moving pictures in 30 minutes in static tap water at room temperature.

❖ What you can do with waterproofness and dustproofness of F-02B

- **You can talk or watch 1Seg programs without using an umbrella in the rain (for rainfall of 20 mm or less per hour).**
 - When your hands or FOMA terminal are wet, avoid installing/removing the back cover or opening/closing the external connection jack cap.

• You can wash mud or dirt away.

- Do not apply water flow stronger than allowed (e.g., such water flow that gives you pain when applied to your skin directly from a faucet or shower).
- Wash it using room-temperature tap water with your hand, with FOMA terminal locked, the back cover installed and the external connection jack cap held in position.
- Do not use any brush, sponge, soap, cleaning material, etc.
- After flushing away, wipe off water with a dry cloth, drain, and dry naturally.

• You can touch the terminal with your hand that is wet with salt water or seawater.

- Do not operate the terminal.
- If you touch the terminal with your wet hand, flush away immediately as predefined.

• You can also shoot still images and moving pictures in the pool depth of 1.5 m.

- Do not perform other operations underwater than shooting still images and moving pictures.
- If you put the terminal in water of swimming pool, be sure to have it within 30 minutes.
- If FOMA terminal gets wet with water from the swimming pool, wash it as predefined.

• You can use FOMA terminal in a bathroom.

- Do not put the terminal in the bathtub. Do not use the terminal in hot water. Doing so may cause malfunction.
- Never put FOMA terminal in hot spring water or water containing soap, detergent or bath powder.

To ensure waterproofness/dustproofness

To keep the FOMA terminal waterproof/dustproof, be sure to observe the points below.

- If FOMA terminal should get wet with salt water, sea water or soft drink, you can flush away. However, do not let the terminal get wet with liquids other than tap water at room temperature.

- Open/close the external connection jack cap as described below.

<Opening the external connection jack cap>

Place your finger at groove on the hinge side to open the cap.

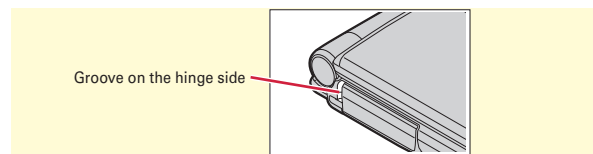

<Closing the external connection jack cap>

Close with the tab for the back cover at the rear side of the cap fitted into the concave of this terminal. Make sure that the cap is completely closed without slack.

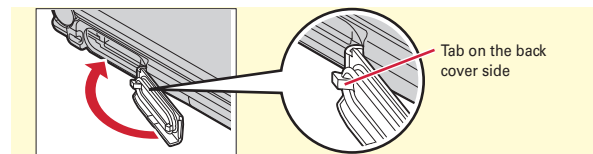

- Install the back cover as described below.

<Installing the back cover>

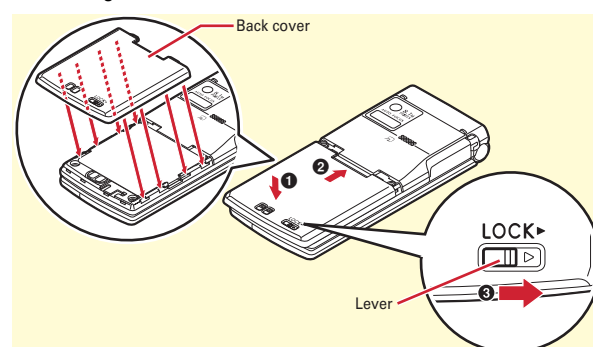

Align 8 tabs of the back cover with concaves of FOMA terminal. While pressing the back cover in the direction of ① so that there is no gap between FOMA terminal and back cover, slide the back cover in the direction of ② to install, then slide the back cover lever in the direction of ③ to lock.

- * Make sure that the back cover is completely closed without slack. Slide the back cover in the direction of the arrow shown on the lever, and then make sure the cover is securely locked before using.
- Securely lock the back cover and firmly close the external connection jack cap. Even a fine obstacle (one hair, one grain of sand, tiny fiber, etc.) put between contact surfaces may allow water to enter.
- Do not poke the microphone, earpiece or speaker with a swab or sharp object.
- Do not let FOMA terminal fall. It may become scratched causing the waterproof/dustproof performance to degrade.
- The external connection jack cap and the rubber packing of the inner lid play an important role for keeping waterproof/dustproof performance. Do not remove or scratch it. Also, prevent dust from adhering to it.

- To keep the FOMA terminal waterproof/dustproof, replacement of parts is required every 2 years regardless of whether FOMA terminal appears normal or abnormal. DOCOMO replaces the parts as a chargeable service. Bring FOMA terminal to a sales outlet such as a DOCOMO-specified repair office.

Important precautions

Do not perform actions shown in the illustrations below.

<Example>



Using Soap/Detergent/
Bath powder



Washing with
brush/sponge



Washing by
laundry machine



Applying strong
water flow



Using in
hot spring



Soaking in
ocean water

Observe the following precautions to use FOMA terminal properly.

- Accessories and optional devices are not waterproof/dustproof. When watching 1Seg etc. with FOMA terminal installed in the desktop holder, do not use it in a bath room, shower room, kitchen or lavatory even if it is not connected to the AC adapter.
- Do not apply water flow stronger than allowed (e.g., such water flow that gives you pain when applied to your skin directly from a faucet or shower). F-02B provides the following waterproof performances of IPX5. However, it causes malfunction.
- If FOMA terminal gets wet with salt water, seawater, water from the swimming pool or soft drink, or with mud or soil, flush away immediately. When it dries out, it becomes harder to get rid of, causing malfunction.
- Do not use FOMA terminal before flushing mud or soil away. This damages FOMA terminal.
- Do not put FOMA terminal in hot water, use it in a sauna or apply hot airflow (from a hair dryer etc.) to it.
- Do not move in water or slam the terminal against the surface of water with FOMA terminal opened.
- If you put the terminal in tap water or in water of swimming pool, be sure to have it within 30 minutes.
- When you use the terminal in swimming pool, obey rules of the facility.
- FOMA terminal does not float on water.
- Do not leave water on FOMA terminal. May short-circuit the power jacks, or in a cold region, water may freeze causing malfunction.
- Do not leave water on the microphone, earpiece or speaker. Such water may interfere with talking.
- If the back cover is damaged, replace it. Water may enter inside from a damaged section causing troubles such as electric shocks or corrosion of the battery.
- If FOMA terminal gets wet with water or other liquids with the external connection jack cap or back cover open, the liquid may get inside the terminal causing electric shocks or malfunction. Stop using FOMA terminal, turn the power OFF, remove the battery pack and contact a DOCOMO-specified repair office.
- If rubber gasket on the external connection jack cap or inner lid is damaged or deformed, replace it at DOCOMO-specified repair office.

DOCOMO does not guarantee actual operations under all states. Malfunctions deemed to be caused by inappropriate operation by the customer are not covered by the warranty.

Washing FOMA terminal

Wash the terminal with tap water while holding the external connection cap. Do not rub the terminal.

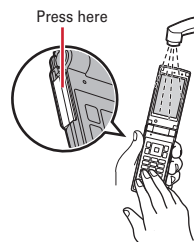

* After washing FOMA terminal, drain in the following steps, and dry naturally.

Draining water when the FOMA terminal gets wet

When FOMA terminal is wet, water may flow out after wiping it off; drain the water in the following steps.

- ① Wipe FOMA terminal surface with dry, clean cloth etc.



- ② Shake FOMA terminal approximately 20 times, firmly holding its hinge section, until there is no more water splattering.

To drain water off the speaker, shake FOMA terminal with the speaker upward

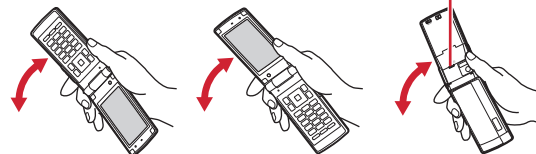

- ③ Softly press dry, clean cloth etc., against FOMA terminal to wipe off water remaining in the microphone, earpiece, speaker, keys or hinges.

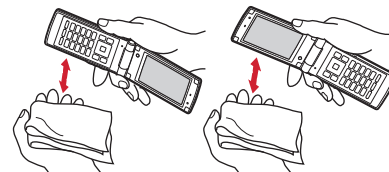

- ④ Remove the back cover and wipe off any drops of water around the inner lid and the rear side of the back cover. Never open the inner lid. After wiping off the water, install and lock the back cover.
Removing back cover → P25

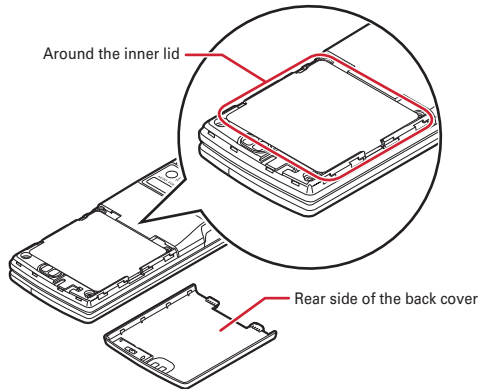

⑤ **Wipe off water drained from FOMA terminal with dry, clean cloth etc.**

- Water, if any, remaining in FOMA terminal may ooze up after wiping off.
- Do not wipe off water remaining in concaves directly with a cotton swab etc.
- After wiping off water, dry naturally.

Charging

Check the following before and after charging.

- Check that FOMA terminal is not wet. Never try to charge the battery pack when FOMA terminal is wet.
- Accessories and optional devices are not waterproof/dustproof.
- When charging the battery when or after FOMA terminal is wet, adequately drain it and wipe off water with a dry, clean cloth etc., before connecting a desktop holder or opening the external connection jack cap.
- When the external connection jack cap is opened for charging, close the cap firmly after charging. It is recommended that the desktop holder be used for charging to prevent water from seeping inside from the external connection jack.
- Do not use the AC adapter or desktop holder in a bathroom, shower room, kitchen, lavatory or other highly humid area. May cause fire or electric shock.
- Do not touch the AC adapter or desktop holder with wet hands. May cause electric shock.

Before Using

Attaching UIM (FOMA card)/battery pack

After turning power OFF, close FOMA terminal and hold it in your hand so that you can properly attach the card/pack.

✦ Removing the Back Cover

Slide the back cover lever in the direction of **①** to unlock, and then slide the cover in the direction of **②** by 2 mm with a thumb to remove it. Pinch the tab of the inner cover and open the cover in the direction of **③** until it stops.

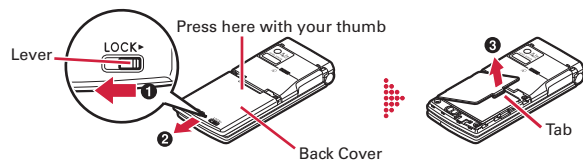

✦ Installing UIM

Pull the tab with your nail and pull out the tray until it clicks. **①**. Hold UIM with the IC side down, align the beveled corner with the tray and push into the tray until it stops. **②**.



✦ Installing battery pack

With the label side of the battery pack upward, align convex parts of the battery pack with concave parts of FOMA terminal and slide the battery pack in the direction of **①**, press the battery pack in the direction of **②** to set it in, and then close the inner cover.

