

■ Removing

- ① Holding the tab, pull out the tray until it clicks and carefully remove UIM.

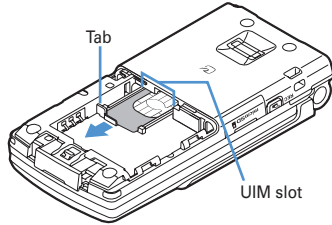

✓ INFORMATION

- Forcing the UIM into or out of the terminal may damage UIM or the tray.
- If the tray is removed, press it straight along the guide rail inside the UIM slot with the UIM left detached.

◆ Security code of UIM

Two security codes, "PIN code" and "PIN2 code", are set for the UIM.

You can change the security codes by yourself. →P108

◆ UIM operation restriction

This terminal is provided with the UIM operation restriction for protecting your or copyright data or files.

- When files or data are downloaded from websites or data attached to mails are obtained to your terminal with the UIM card equipped, the UIM operation restriction is automatically set to these data or files.
 - With UIM replaced or no UIM inserted, data or files with the UIM operation restriction set cannot be displayed or played. For i-oppli with the UIM operation restriction set, no functions except deletion are available.
 - Data or files with the UIM operation restriction set cannot be transferred over infrared communication or copied/moved to microSD memory card.
 - Restricted data types are as follows :
 - Videophone call message, Movie memo
 - i-mode mail attachment files, images inserted to Deco-mail or signature, mail template containing data subject to operation restriction
 - Screen memo
 - i-oppli (including i-oppli stand-by display)
 - Images (including GIF animations and Flash graphics), i-motion, data compatible with contents transfer, melodies, Chara-den, Word/Excel/PowerPoint files
 - Kisekae Tool
 - Chaku-uta[®] Full Track Music
- * "Chaku-uta" is a registered trademark of Sony Music Entertainment (Japan) Inc.

Attaching/removing battery pack

- After turning the power OFF, fold the terminal and hold it with your hand.
- When the date and time is set with Auto time adjust set to "OFF" in Date & time, removing the battery pack may delete the date and time.

■ Attaching

- ① Remove the back cover by sliding it about 2 mm in the direction of the arrow while pressing it with your thumb.

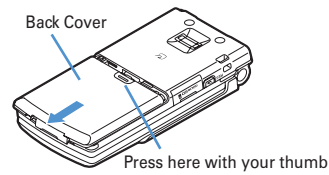

- ② With the label side of the battery pack face up, align the convex part of the battery pack with the concave part of FOMA terminal, insert the battery pack in the direction of ① and press it in the direction of ② until it fits.

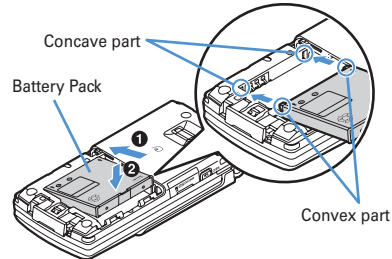

- ③ Bring the 5 tabs of the back cover to meet the cuts in FOMA terminal. Slide in the direction of ④ to fit in while pressing in the direction of ③ so that no gap is generated between FOMA terminal and the back cover.

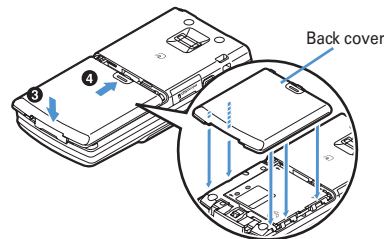

■ Removing

- ① Perform Step ① in Attaching battery pack.
- ② Hold and raise the battery pack tab in the direction shown by the arrow to remove the battery pack.

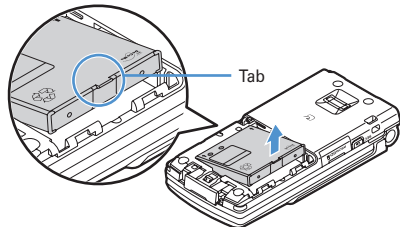

Charging the terminal

The battery pack does not have a full charge at time of purchase. Use AC adapter for the terminal to charge the battery before using the terminal.

- To get the maximum performance from F905i, use battery pack F10.
- For handling the battery pack F10, see the battery pack manual.

❖ Charging times (approximate)

The times below are the times for charging an empty battery pack with F905i's power switched OFF. Charging with the terminal ON or under low temperature requires longer time.

AC adapter	Approx. 150 min.
------------	---------------------

❖ Operation times on full charge (approximate)

The times below vary by the charging method and operating environment.

Continuous stand-by time	3G	Stationary (Auto) : Approx. 505 H Moving (Auto) : Approx. 330 H Moving (3G static) : Approx. 360 H
	GSM	Stationary (Auto) : Approx. 300 H
	3G	Voice call : Approx. 190 min. Videophone call : Approx. 110 min.
Continuous call time	GSM	Approx. 200 min

- Continuous call time indicates the approximate time that the phone can send or receive radio waves normally.
- Continuous stand-by time indicates the approximate time that the phone can receive radio waves normally with F905i closed. Call, communication or stand-by times may be about half depending on factors such as the battery pack charging condition, function settings, operating environment such as ambient temperature, and signal condition in the area of use (whether the signal is weak or absent). Call, communication or stand-by times are reduced by performing i-mode communication. And, even with no voice calls or i-mode communications made, the continuous call and continuous stand-by times are reduced

by creating i-mode mail, activating downloaded i-oppli, using i-oppli stand-by display, performing data communication or multiaccess, using camera, playing movie/i-motion, obtaining or playing music with Music player, or doing other operations.

❖ Battery charge

- Use only the dedicated F905i AC adapter.

◆ Charging

When using optional AC Adapter, read the related operation manuals beforehand.

- The battery pack cannot be charged without an adapter.
When charging the battery pack, attach it to the terminal.

■ Charging with AC adapter

- ① Open terminal cap (❶) of the terminal, hold the connector horizontally with the arrow facing upward and insert it to terminal. (❷)
- ② Unfold the AC adapter's power plug and insert it into a 110V AC outlet.
- ③ After charging has completed, disconnect the AC adapter from the outlet and press the release buttons on both sides of the connector and remove the connector horizontally from the terminal.

<AC adapter>

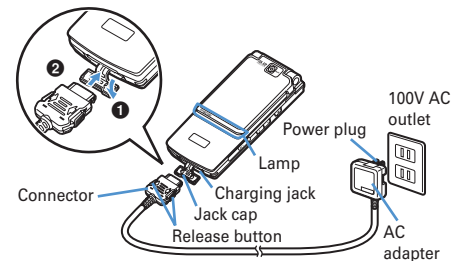

❖ Operations and precautions for charging

When charging starts, a charge start alert sounds, light turns ON and the battery icon on the display or sub-display blinks. When charging is over, a charge completion alert sounds, the light turns off and the battery icon stops blinking.

- When resuming the battery charging, the light turns on in red. In some environments, the light may not light immediately when charging starts; this is normal and not a malfunction. However, if the light fails to light after a while, disconnect the terminal from the AC adapter, and then connect it again to start charging. Contact the sales outlet such as FET Service Center if the light fails to light for a while after charging starts.
- If the light is used for mail reception, camera shooting, etc. during charging, the light turns to a different color, but it is lit in red soon.

When the light blinks while charging in cases except these reasons→P431 "Troubleshooting"

- When attaching the fully charged battery pack to the terminal and connecting it to the AC adapter, the light may turn on for a moment and turn off. This is normal and not a malfunction.
- During a call or a communication, in Silent mode or with Charge alert "OFF", the charge alert does not sound at start or completion of charge.

Remaining battery level

Checking remaining battery level

A battery icon appearing on the top of the display shows an approximate remaining battery level.

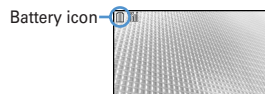

- (Battery level 3) : Ample charge
- (Battery level 2) : Low charge.
- (Battery level 1) : Battery level very low. Charging required

When battery is almost exhausted

A message indicating low battery appears on the display. Pressing any one of **[M]**, **[*]**, **[END]** keys deletes the message temporarily. After a period of time, a battery alarm sounds from the speaker and all icons on the top of the display start blinking. The power is turned off after approximately 1 minute. These operations stop when charging starts; press **[END]** to immediately stop the battery alarm.

- During a call, the message remains displayed and the battery alarm keeps sounding from the earpiece. After approximately 20 seconds, the call is terminated, the battery alarm sounds from the speaker and all icons on the top of the display blink.

Checking remaining battery level by sound and display <Battery level>

1 **[M]** ▶ **[8]** **[7]** **[6]** **[3]**

The battery level appears and the keypad sound (→P90) is emitted depending on the battery level. After a while, the screen returns to the menu list.

Power ON/OFF

Turning power ON/OFF

Turning power ON

1 **[END]** (2 sec. or more)



Stand-by display

Icon		圏外
Received signal level	Strong ↔ Weak	Outside the service area and where radio waves are hard to reach

Turning power OFF

1 **[END]** (2 sec. or more)

Operations to perform after turning the power ON for the first time

When turning the power ON for the first time, operate in the order of "AdvancedMode setting" → "Initial setting". The settings made can be changed later.

Default setting

MENU [Settings & NW services] 779

- Always set Password. When **[M]** or **[*]**, **[END]** is pressed before setting terminal security code, a confirmation screen appears asking you to exit. If you exit by selecting "Yes", this confirmation screen reappears when the power is turned ON the next time.

1 Set the required items on the initial setting screen ▶ **[M]**

Date & time : Set the date and time.→P40

Password : Change the terminal security code, after performing authentication.→P107

Fingerprint : After performing authentication, register a fingerprint to be used for authentication.→P109

Keypad sound : Set a confirmation sound to be generated when a key is pressed.→P90

Text size : Specify size of characters for Phonebook or mail.→P103

Select language

Switching to English



1 **[M]** ▶ [Settings & NW services] ▶ **[2]** **[7]** **[2]** ▶ **[1]** or **[2]**

✓INFORMATION

- The setting of Select language are saved to UIM. When a UIM is replaced, the setting switches to that saved in the inserted UIM.
- Even if this setting is set to "English", the displayed menu may not be switched to English depending on the Kisekæ Tool. Note that, when a Kisekæ Tool in "Preinstalled" folder is set, a menu dedicated to "English" appears.

Date & time

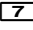
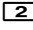
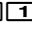
Setting date and time

- 1  [Settings & NW services] ▶    ▶ Set the required items ▶ 

Information

When you are setting the time and date, change the network to GSM to set up the time automatically.

The following shows how to change the NW.

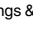
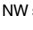
-  [Settings & NW services] ▶   ▶ Select GSM

If network is not GSM, change the Automatic Time/Time-Difference Correction to "OFF" and set up manually.

✓INFORMATION



After setting the date and time with Auto time adjust set to "OFF", removing the battery pack or leaving it exhausted for a long time may cause the date and time to be deleted. In this case, set the date and time again after charging the battery.

User information

Checking your own phone number

MENU [Phonebook & Logs] 9

You can check your phone number (My phone number), Name, Mail address, etc.

- 1  [User information]
Check during a call, etc. :  

Voice/Videophone Calls

Videophone

The videophone function is available between terminals that support DoCoMo's videophone. Phone conversations can be made between the terminals while looking at the other party's image using videophone. It is also possible to send still images, substitute images, Chara-den, etc. instead of camera image.

- Videophone calls are only available at 64 kbps.
- DoCoMo videophone specifications are conforming to "3G-324M"², an international standard prepared by 3GPP^{*1}. The connection with the videophones of different specifications cannot be established.

*1 3GPP (3rd Generation Partnership Project) is an area standardization organization established to develop standard technology specifications for third generation mobile communications system (IMT-2000).

*2 3G-324M: An international standard for 3rd generation mobile videophone

◆ Reading screen during a videophone call



- Main screen**
Display other party's image
- Videophone icon**
- Speakerphone function**
🔊: ON No icon: OFF
- Sub screen**
Display your own image
- Zooming**
📏: Standard-📏: 2x (in-camera)
📏: Standard-📏: 16x (out-camera)
- Status**
📷: Sending camera image 📷: Sending Camera-Off image 📷: Using Chara-den 📷: Sending frame 📷: Sending still image 📞: On hold 📞: Respond and Hold 📞: Recording message 📞: Recording movie memo
- Action mode**
📏: Action 📏: Action of Parts
- Shooting mode**
📷: Standard 📷: Backlight 📷: Monotone 📷: Sepia
- Light**
No icon: OFF 📷: ON (out-camera)

⑨ Sending image quality

No icon: Normal 📷: Prefer motion speed HQ: Prefer image quality

⑩ Sending/receiving status of audio/video

📷: Sending/receiving audio 📷: Sending/receiving video 📷: Sending/receiving audio/video

Speakerphone volume/listen volume

🔊: Adjusting speakerphone volume/listen volume

⑪ Macro shooting

No icon: OFF 📷: ON (out-camera)

⑫ Call duration

Displayed in the HH:MM:SS format

Making voice/videophone calls

1 Enter a phone number.

- Always enter the area code even when calling from the same city when calling to a general subscriber phone.
- Up to 80 digits can be entered.
🗑️: Delete 1 digit
🗑️ (1 sec. or more): Delete all digits

2 Select a call type.

Making a voice call: 📞

Making videophone calls: 📷

Your own image is displayed while the videophone call is connected.



- The charging begins when "Connected to videophone." appears on the screen.

3 When ending the call, 📞.

✓INFORMATION

<For videophone calls only>







- The charges are based on the rate for digital communication not for voice calls even when substitute image is sent instead of the camera image.
- Any videophone call from the terminal to emergency call (112) with Auto redial as voice set to "ON" is automatically switched to a voice call.

◆ Putting calls on hold <On hold>

Putting the call on hold during a call lets you talk to someone without the caller hearing your voice.



- The caller is charged for time spent on hold.



1 During a call, .

- To clear voice call on hold, press  or .
- To clear videophone call on hold, perform any of the operations below :
 -  : Redisplay the image sent before the call is put on hold
 -  /  : Camera image is sent
 -  : Substitute image is sent

◆ Using speakerphone function

To make/receive videophone calls without using Speakerphone, change the setting of Speakerphone in Operation (Videophone settings).

1 Enter a phone number  (1 sec. or more) or .

-  appears at the top of the display.
- The procedure is the same when operating from the phonebook, Redial, Received calls, Recorded messages or Voice memos.
- Press and hold  for 1 second or more to make a videophone call using speakerphone function with Speakerphone in Operation (Videophone settings) set to "OFF".
- While making a call, ringing or talking on the phone, you can switch the speakerphone function ON/OFF by each pressing .

◆ Adjust Listen volume during a call <Listen volume>

- The Listen volume adjusted during a call is reflected to "Listen volume" of Adjust volume.

1  or side keys [/▼] during a voice call

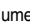

- Volume can be adjusted only by side keys [/▼] during a videophone call.

◆ Using Voice clear/Voice slowing

❖ Switching Voice clear

Measure the noise level during a voice call, and if the noise increases above the specified level, the other party's voice is automatically emphasized to be heard clearly. And, the volume is automatically increased also when your or other party's voice is low.

- This item is set to "ON" by default.
- This function does not operate while using Speakerphone function or in GSM/GPRS network.
- The settings are retained after a call.

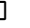
1 During a voice call,   

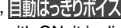
If you set Voice clear to ON,  appears. When this does not operate with ON, it is displayed in gray.

❖ Switching Voice slowing

During a voice call, adjust the other party's voice to be heard slowly by using the silence at intervals, to make it easier to be heard. When the other party speaks without intervals, the voice is heard at the normal speed.

- This item is set to "OFF" by default.
- If you set Voice slowing to ON, the quality of the other party's voice, music or time tone may change. In such a case, set Voice slowing to OFF.
- This function does not operate in overseas GSM/GPRS network.
- The settings are canceled after a call.

1 During a call, .

If you set Voice slowing to ON,  appears. When this does not operate with ON, it is displayed in gray.



Redial/Received calls

Making a call using Redial/Received calls

MENU [Phonebook & Logs] 6
MENU [Phonebook & Logs] 5

This function records call log (Redial) and Received calls of voice/videophone calls.

- Up to 30 calls are recorded in each of Redial and Received calls. If the maximum number of saved items is exceeded, record is overwritten chronologically.



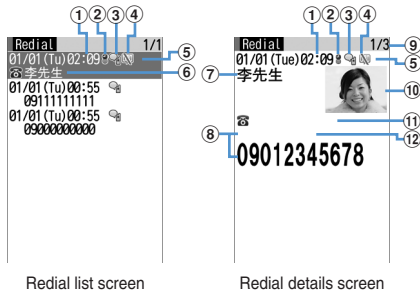

- When calls are made to the same phone number, the latest call is recorded in the redial list for each of "Unspecified", "Notify", "Not notify" of Caller ID.
- 1**  (Redial) or  (Received calls) ▶ Place the cursor on a party to redial
- The details screen appears when placing the cursor on a number to redial.



Reading Redial screen



Redial list screen

Redial details screen

- 1 Calling date/time (local date/time when staying overseas)
- 2 Calling from overseas (except GMT+08:00)^{*1}
- 3 Types of outgoing call
 -  : Voice call  : International voice call
 -  : Videophone call  : International videophone call

- 4 Notify/Not notify for a caller ID
 -  : When Notify is set in Call option or Caller ID settings for phonebook entry
 -  : When Not notify is set in Call option or Caller ID settings for phonebook entry
- 5 Phone number^{*2}/icon and name in the phonebook (if saved in the phonebook)^{*3}
- 6 Name (if saved in the phonebook)
- 7 Phone number icon in the phonebook (if saved in the phonebook), phone number^{*2}
- 8 Redial number/number of calls^{*4}
- 9 Image (if saved in the phonebook)^{*5}
- 10 Group icon





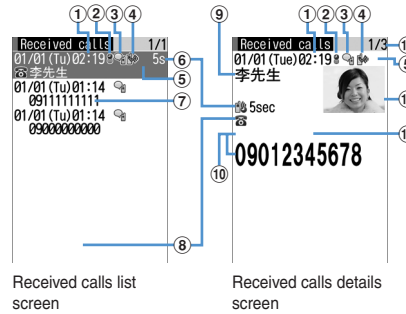



*1 This may not appear, for example, when calling date/time is not recorded.
 *2 For an international call, a plus sign "+" appears at the beginning of the phone number.
 *3 Displayed according to the settings of View preference.

Reading Received calls screen



Received calls list screen

Received calls details screen

- 1 Receiving date/time (local date/time when staying overseas)
- 2 Receiving call in overseas (except GMT+08:00)^{*1}
- 3 Types of incoming call
 -  : Voice call  : International voice call
 -  : Videophone call  : International videophone call
 -  : 64K data communication
 -  : International 64K data communication
- 4 Status icon
 - : Missed call (unchecked)
 - : Missed call (checked)
 -  : Recorded messages (unchecked)^{*2}
 -  : Recorded messages (checked)^{*2}
- 5 Ring time icon for missed call (details screen only)^{*3}, ring time for missed call (On a list screen, "99" appears for 100 or more seconds.)^{*3}
- 6 Phone number^{*4}/phone number icon and name in phonebook (if saved in the phonebook)/reason for hiding caller ID
- 7 Name (if saved in the phonebook)/Reason for hiding caller ID
- 8 Phone number icon in the phonebook (if saved in the phonebook), phone number^{*4}
- 9 Received call number/number of calls^{*5}

⑩ Image (if saved in the phonebook)*6

- *1 This may not appear when, for example, the call reception date/time is not recorded.
- *2 If a recorded message is deleted, it changes to the icon of missed calls.
- *3 For an international call, a plus sign "+" appears at the beginning of the phone number.
- *4 Displayed according to the settings of View preference.

2  or 

- Pressing  on the details screen makes a call in the same way as the call type of the selected redial/received calls.

❖ Using Redial/Received calls

Adding to phonebook :

- ① **Place the cursor on a party to add and**
 ▶ **2** ▶ **1** or **2** ▶ **1** or **2**
- ② **Save the name or mail address, etc.**
 Phonebook new entry → P75, 76

Creating an i-mode mail : Place the cursor on a destination party and 

Creating SMS : Place the cursor on the party and  (1 sec. or more).

Switching Redial/Received calls :  ▶ **4**

Displaying Sent msg log/Received msg log : 

❖ Switching details screen display <View preference>

- 1** On the details screen,  ▶ **6** ▶ **1** - **3**
 Setting items → P79 "Switching details screen display"

❖ When you missed calls <Missed calls>



 **2** (the digit indicates the number of missed calls) appears in the stand-by display. The incoming calls are recorded as missed calls in Received calls.

◆ Deleting redial/received call logs <Delete redial/received call log>

<Example> Deleting one entry

- 1**  (Redial) or  (Received calls) ▶ Place the cursor on an entry to delete and
 ▶ **3** **1**

Deleting selected entries :  (Redial) or  (Received calls) ▶  ▶ **3** **2** ▶ Select the entries to delete ▶ 

Deleting all entries :  (Redial) or  (Received calls) ▶  ▶ **3** **3** ▶ Authenticate

2 "Yes"

186/184

Setting to either Notify/Not notify caller ID for each call

- Caller ID is your important information. Carefully consider whether you want to include caller ID information when making a call.

- The caller ID is displayed only when the phone of the other party is a digital mobile phone, etc. enabled to display the caller ID.
- Priority of the method to notify a caller ID → P41

Notify your caller ID : Enter a phone number ▶ or

Not notify your caller ID : ▶ Enter a phone number ▶ or

Sending tone signal (DTMF)

Tone signals (DTMF) can be sent from the terminal to operate the Voice Mail service or use various push-button phone services at your home. By entering pause ("P") or timed pause ("T") when making a voice call, tone signals (DTMF) can be sent with digits in the phone number separated.

- Pause and timed pause are enabled only for voice calls.

❖ Entering pause "P"

Use for operating the answering system at home, reserving tickets, etc. Tone signals are sent with the phone number separated at the point where pause ("P") is entered.

- 1 Enter a phone number ▶ (1 sec. or more) ▶ Enter digits to send ▶

When pressing after the call is connected, the digits after the pause ("P") are sent.

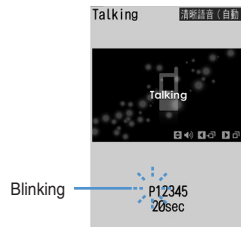

❖ Entering timed pause "T"

Timed pause ("T") is used to dial outside line number followed by an extension. When timed pause ("T") is entered between the phone and extension numbers, the extension number is dialed with a pause of the predetermined seconds after the phone number is dialed.

- 1 Enter a phone number ▶ (1 sec. or more) ▶ Enter an extension number ▶
 - Timed pauses ("T") can be entered in succession.
 - Each timed pause ("T") is followed by an interval of approximately 1 second.

❖ Sending tone signal (DTMF) during a videophone call

- The tone signal can be entered only while sending camera image, while sending Camera-Off image or while Chara-den is displayed.

- 1 During a call, ▶ ▶ Enter digit to send

The number you pressed is displayed and the tone signal is transmitted.

: Cancel sending

- While sending camera image or Camera-Off image, a tone signal can be sent only by pressing the keypad without pressing .
- A frame set on a camera image or a still image set as a substitute image is canceled.
- Because a tone signal is sent using keypads, actions with pressing keypads are disabled while sending Chara-den.

Call option

Making a call under set conditions

You can set calling conditions each time you make a voice or videophone call.

- Priority of the method to notify a caller ID → P41

- 1 Enter a phone number ▶ ▶ ▶ Set the required items

Call type : Select any of "Voice call", "V.phone" or "SMS".

Caller ID : Set Notify/Not notify for a caller ID. When "Unspecified" is set, the settings in Caller ID notification are used.

Prefix : Select Prefix to be added before phone number.

- 2

A call is made in the specified settings.

- If "V.phone" is selected for "Call type", Chara-den to display during a call can be set by pressing .

Sub address

Making a call specifying a sub address

You can set if you call a specific phone or communication device by specifying a sub address.

- A sub address is a number used to call a specific device out of multiple telephone sets and/or communication devices assigned the same phone number (e.g. when multiple devices with sub addresses are connected to an ISDN line). It is also used to select contents in a movie delivery service "V live".

1 [Settings & NW services] ▶ ▶ or

◆ **Making a call specifying a sub address**

1 Enter a phone number ▶ ▶ Enter a sub address ▶ or

Noise reduction

Suppressing ambient noise to improve call quality

By setting the noise canceller function that suppresses the ambient noise, your voice and the other party's voice can be made clearer.

- It is recommended that this function be used set to "ON" normally.

1 [Settings & NW services] ▶ ▶ or

Receiving voice/videophone calls

1 A call is received.
 : Ring alert volume
 Side key : Stop the ring tone and the vibrator operation

When the other party does not notify caller ID

Reason for hiding caller ID is displayed.

User unset : When the caller selected not to send caller ID

Payphone : When the call was made from a payphone, etc.

Unavailable : The call was made under the situation that does not allow sending the caller ID; e.g. a call from overseas or a general subscriber phone via forwarding services (caller ID may be sent by connecting phone companies).

2 Select call reception type.

Receiving a voice call :

- Voice calls can be answered also by pressing or a keypad (Any key answer).

Receiving videophone calls : or

Your own image is displayed while the videophone call is connected.



- Any key answer is unavailable.
- A switching confirmation screen to speaker appears during Silent mode.
- You can answer a videophone call using a substitute image set in Image setting (Videophone image) by pressing instead of or . The substitute image is sent to the other party when the videophone call is connected.

3 When ending the call, .

◆ **Operations from submenu during receiving call**

When there is an incoming voice or videophone call, the operations listed below can be performed from submenu. When Arrival call act is "Answer", the same operations are enabled also when there is another incoming voice call during a voice session.

Submenu item	Operation
Call Rejection	Disconnect without receiving a call

◆ **When you hear beeps (call waiting ring tone) while talking over a voice call**

If you are a subscriber to Voice Mail service, Call waiting or Call forwarding service, you hear beeps (the call waiting ring tone) when receiving another incoming voice call while talking over a voice call. You can perform any of the operations below :

Service	Operation
Catch Phone (Call waiting service)	Put current voice call on hold and answers second voice call

* Selection from the submenu is enabled only when Arrival call act is "Answer".

Any key answer**Enabling use of keypad to answer call**

You can set if you answer a call by pressing **0-9**, *****, **#** or **☎** in addition to **☎**.

- The any key answer function is effective for a voice call. It is unavailable to an incoming call during talking.

- ☎** ▶ [Settings & NW services] ▶ **5** **3** ▶ **1** or **2**

Close settings**Ending/putting on hold/continuing a call by folding the terminal**

- This function does not operate during 64K data communication, packet communication.

- ☎** ▶ [Settings & NW services] ▶ **5** **7** **2** ▶ **1** **3**

End the call : Terminate the call.

On-hold : Put the call on hold.

Continue(mute) : Mute the sound without terminating the call. However, when the speakerphone function is active, your voice is not heard by the other party but you hear the other party's voice from the speaker.

Respond and Hold**Putting calls on hold when you cannot answer immediately**

- The caller is charged for the time spent on hold.

- While receiving a call, **☎**.
The call is put on hold, and the other party hears a status message.
For a videophone call, Response hold image for videophone is displayed to you and the other party.

- When you are ready to answer the call, **☎**.
 - You can also answer a videophone call by pressing **☎**. A substitute image is sent to the other party by pressing **☎**.
 - If the caller presses **☎** or hangs up while on hold, the call ends.

Status message**Setting status message**

You can record a status message in your own voice.

- 1 message approximately 10 seconds long can be recorded.
- As default On-hold tone, "對不起現在不能接電話・請稍後或稍後在撥。" is saved.

- ☎** ▶ [Settings & NW services] ▶ **1** **1** **6** **1** ▶ Select the On-hold tone field ▶ **2**

- Press **1** and go to Step 3 to restore preinstalled guidance.

- "Record" in the Edit message field ▶ Record the status message after the beep

Recording starts after a message appears.



- An end tone (beep) sounds approximately 10 seconds after the start of recording.
- Press **☎** to stop recording halfway.
- When a recorded status message is deleted, the preinstalled message is reset.
- Select "Play" to check the recorded status message.

- ☎**

Answer machine

Allowing the caller to record message when you cannot answer call

By activating Answer machine, a greeting message is played and the caller can record a message when you cannot answer the call.

- You can record up to 4 voice and videophone calls in total, approximately 30 seconds for each call.

Activating Answer machine

MENU [Phonebook & Logs] 71

You can set if you activate Answer machine.

- Operate the terminal in open state.

- Side key [▲] (1 sec. or more) ▶ [1] ▶ [1] or [2]

 appears on the stand-by display when Answer machine is activated.

Responding with Quick answer machine <Quick answer machine>

When Answer machine is not active, you can activate it once by pressing and holding side key [▲] for 1 second or more while receiving a call. This operation does not set Answer machine to active.

Setting the response time before the greeting starts <Greeting msg resp time>

MENU [Phonebook & Logs] 713

- The default is "13 seconds".

- Side key [▲] (1 sec. or more) ▶ [1] [3] ▶ Enter the response time
 - Set duration from 0 to 120 seconds.

Setting the greeting message <Set greeting message>

MENU [Phonebook & Logs] 714

You can record your own voice as greeting message.

- 1 message approximately 10 seconds long can be recorded.
- As default Greeting message, "對不起現在不能接電話，請聽到P聲響後在30秒鐘內留言。" is saved.

- Side key [▲] (1 sec. or more) ▶ [1] [4] ▶ Select the Greeting message field ▶ [2]
 - Press [1] to restore preinstalled guidance and go to Step 3.

- "Record" in the Edit message field ▶ Record the greeting message after the beep
Recording starts after a message appears.

Supplementary description of recording message→P57
Step 2 in "Setting status message"

3 

Playing/deleting recorded messages



MENU [Phonebook & Logs] 72

Playing recorded messages

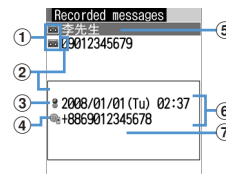
- Side key [▲] (1 sec. or more) ▶ [2]

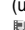

1 Status icon

-  : Recorded message of voice call (unplayed)
-  : Recorded message of voice call (played)
-  : Recorded message of videophone call (unplayed)
-  : Recorded message of videophone call (played)

2 Receiving call in overseas (except GMT+08:00)*1

3 Receiving international call

4 Phone number²/name (if saved in the phonebook)/reason for hiding caller ID

5 Date/time of recording (local time when in overseas) and phone number of party²/reason for hiding caller ID at cursor position

*1 This may not appear when, for example, the call reception date/time is not recorded.

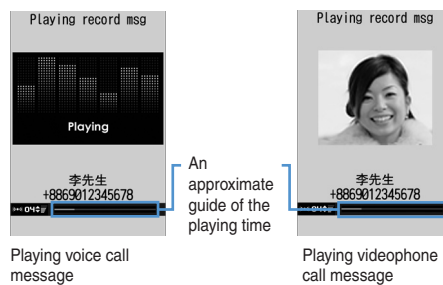

*2 For an international call, a plus sign "+" appears at the beginning of the phone number.

2 Select a recorded message.



Playing voice call message

Playing videophone call message

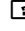
- During playing, the operations below are available :
 - /Side keys [▲▼] : Adjust volume
 -  : Stop
 -  : Switch the speakerphone function ON/OFF (only when playing voice call message).

- When videophone call message is being played, the speakerphone function is set to ON. Switching the speakerphone function is not available.
- When videophone call message is played in Silent mode, a sound playing confirmation screen appears. Select "No" to play the message without sound.

Making a call : Place the cursor on the party and

or

- To make a call specifying conditions, press **3** .→P51

Adding to phonebook :

① **Place the cursor on the party and** **4** or **5** **1** or **2**

- When adding data to existing phonebook entry, select the phonebook entry to add.

② **Save the name or mail address, etc.**

Phonebook new entry→P75, 76

3 Select if you delete the recorded message.

Deleting recorded messages

1 Side key (1 sec. or more) **2** Place the cursor on the recorded messages **2** **1** or **2** "Yes"

Using Chara-den

During a videophone call, a character can be sent instead of camera image.

- Displaying Chara-den→P289

1 During a call, **4** **2** **1** Select a folder **2** Select a Chara-den

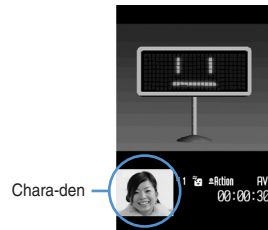

- The operations below are available during a videophone call :

1 - **9** , ****** : Action

: List actions

0 : Stop the action

Setting images to send to the other party during a call

1 Perform necessary operation during a call.

Switching your image and substitute image :

- When Chara-den is set as the substitute image, the Chara-den may not be displayed and the Default image may be sent.

Switching in-camera/out-camera¹ :

- This item is set to "In-camera" by default.
- Even when the camera is switched, settings of Frames, Shooting mode, Brightness/Flicker adjustment, etc. are kept.

Turn on/off the light² : (1 sec. or more)

If the light is turned on, the light turns on in white.

- Rotating the display weakens the effect of the light.
- Light may be temporarily turned off by setting operations, etc. during a call.

Switching display magnifications of camera image

<Zoom>¹

- Each time you press , the zoom scale switches in the order below, and each time you press , it switches in the opposite order.

In-camera : Standard → ×2

Out-camera : Standard → 2× → 4× → 6× → 8× → 10× → 12× → 16×

- Switching in-camera and out-camera cancels the zoom.

Applying special effects to image <Scene mode/ effect>¹ **2** **1** - **4**

Standard : Standard image

Backlight : Shooting subjects against the light

Monotone : Shooting in monochrome mode

Sepia : Shoot in sepia mode

Adjusting brightness of image^{1, 3} :

3 **1** **Adjust with**

- This item is set to "Level 3" by default.
- You can adjust at 5 levels.

Adjusting flicker^{1, 3} **3** **2** **1** - **3**

The flicker may be reduced by selecting the settings that match the power supply frequency of your area.

- This item is set to "Auto" by default.
- Reflected to the flicker adjustment settings of Camera and Barcode reader.

Adding frame on image^{*1} **[MENU]** ▶ **[4]** **[1]** ▶ **Select frame**

- Only the frames of 176×144 or smaller can be selected.
- While In-camera is used, a mirror image (flip horizontal) is displayed and a normal image (real orientation) is sent to the other party. While Out-camera is used, the image same as on the display is sent to the other party.
- Press **[OK]** to cancel.

Sending Camera-Off images **[MENU]** ▶ **[4]** **[3]**

The substitute image set in Substitute image is sent.

- When Chara-den is set as the substitute image, the Default image is sent.

Sending still image **[MENU]** ▶ **[4]** **[4]** ▶ **Select a folder** ▶ **Select a still image**

- Only still images that are 176×144 or smaller for Image size and permitted to output from the terminal can be set.

Images that inhibited to output from the terminal →P304 "File restriction" in "List of display items and changeability"

- Press **[OK]** to cancel.

Switching to Macro shooting^{*2} **[MENU]** ▶ **[6]**

You can adjust the focus when sending images of very close objects approximately 8-10 cm away.

- Press **[MENU]** **[6]** to cancel.

Setting the quality of sending/receiving images

[MENU] ▶ **[8]** ▶ **[1]** or **[2]** ▶ **[1]** - **[3]**

Normal : Standard quality

Prefer motion spd : Motions become smoother in a little lower-definition image.

Prefer img qual : Motions become a little slower in a higher-definition image.

- You can also press **[OK]** to switch the Sending image quality .

*1 This item can be set only while sending camera image.

*2 This item can be set only when using Out-camera.

*3 The settings are retained after a call.

Operation

Changing videophone settings

You can set the operation to be performed when videophone calls fail to get through and the screen to appear during videophone calls.

- [MENU]** ▶ [Settings & NW services] ▶ **[6]** **[3]** ▶ Set the required items ▶ **[OK]**

Auto redial as voice : Set whether to redial a voice call for unsuccessful videophone attempt.

Display setting : Set one of the images ("My side" or "Other side") or both of images ("Both sides") to appear while a videophone call.

- If you set "My side" or "Other side", Sub screen cannot be set.

Sub screen : Set one of the images ("My side" or "Other side") to appear in the sub screen during a videophone call.

Screen size : Set the main screen view size.

Visual preference : Set quality of an image to be received from the other party.

Display light : Set lighting of the display during videophone calls.

- If you set "Terminal settings", it depends on settings of Display light of Display.

Speakerphone : Set whether to use the speakerphone function at the same time as the videophone call is connected.

Image setting

Setting substitute and hold images for videophone calls

MENU [Settings & NW services] 234

You can change the substitute image to be sent during videophone calls, Answer machine image, Response hold image, On-hold image or Movie memo image.

◆ Setting substitute image

<Example> **Setting standard Chara-den**

- [MENU]** ▶ [Settings & NW services] ▶ **[6]** **[5]** ▶ **[1]** ▶ **Select the Image field**

- [1]**
Setting standard image : **[2]**

Setting other Chara-den : **[3]** ▶ **Select the List images field** ▶ **Select a folder** ▶ **Select a Chara-den**

Setting other still image : **[4]** ▶ **Select the List images field** ▶ **Select a folder** ▶ **Select a still image**

- [OK]**

◆ Changing image for recording msg/response hold/On-hold/recording movie memo

- [MENU]** ▶ [Settings & NW services] ▶ **[6]** **[5]** ▶ **[2]** - **[5]**

- Select the Image field ▶ **[1]** or **[2]** ▶ **[OK]**

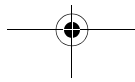
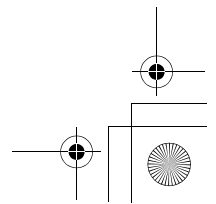
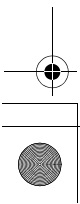
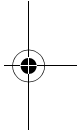
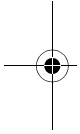
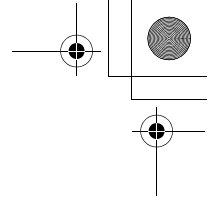
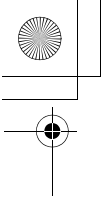

Phonebook

Phonebooks supported by the terminal

F905i supports Terminal phonebook and UIM phonebook. You can make voice/videophone call and send mail or SMS from these phonebooks.

- Items to be saved in Terminal phonebook and UIM phonebook are as follows :

OK: Allowed X : Not allowed

Item	Terminal phonebook	SIM card (USIM) phonebook	SIM card (SIM) phonebook
Number of entries in the phonebook	Maximum 1000 entries *1	Maximum 200 entries	Maximum 140 entries
Phone book No.	OK	X	X
Name	16 two-byte (32 one-byte) characters	5 two-byte (12 one-byte) characters	5 two-byte (12 one-byte) characters
Zhuyin	16 Zhuyin (32 one-byte) characters	5 Zhuyin (12 one-byte) characters	X
Image, Movie	One per person	X	X
Group	"No group" or 30 groups	"No group" or 10 groups	X
Phone number	Five numbers per person, maximum of 3005 numbers in the entire phonebook *1	One number per person	One number per person
Phone number icon	OK	X	X
Mail address	Five addresses per person, maximum of 3005 addresses in the entire phonebook *1	One address per person	X
Mail address icon	OK	X	X
Other settings *2	OK	X	X

*1 The entries you can actually add may be less depending on the content of each phonebook entry

*2 The items you can set are: birthday, note, postal code/address, location information, company name, job title and URL.

- Phonebook data saved in your UIM is available even when it is inserted to another terminal.

Phonebook new entry

Adding entries into Terminal phonebook

You can add phone numbers and mail addresses to the Terminal phonebook.

- Priority of the incoming/outgoing operation→P96
- Maximum number of recorded items→P74

1 [ME] ▶ [Phonebook & Logs] ▶ [2]

2 Enter a name.

- Up to 16 two-byte (32 one-byte) characters can be entered.

3 Set the required items ▶ [☐]



Alert by contact

Setting receiving actions for each phonebook entry

- Priority of incoming operation→P88, 89, 102

- 1 ▶ Search the phonebook ▶ Place the cursor on a phonebook entry to set and ▶ **3** **2** ▶ Set the required items ▶
- : Switching Call and Mail screens.

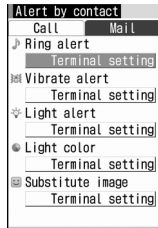

Phone alert settings screen

Phonebook(UIM) new entry

Adding to SIM card phonebook

- Maximum number of recorded items→P74

- 1 ▶ [Phonebook & Logs] ▶ **3**
- 2 Enter a name.
 - Up to 5 two-byte (12 one-byte) characters can be entered.
- 3 Set the required items ▶



Group setting

Making group settings

<Example> Adding groups

- 1 ▶ [Phonebook & Logs] ▶ **1** **2**
- 2 ▶ **2**

Deleting a group : Place the cursor on the group and ▶ **3** ▶ **Authenticate** ▶ "Yes"

- Even in Privacy mode (when Phonebook & Logs is "Hide set contact"), the phonebook entries with secrecy are deleted.
- For No group, only the phonebook entry in the group is deleted.

Changing a group name : Place the cursor on the group and ▶ **4**

- For UIM phonebook, press , place the cursor on the group and press ▶ **2**.

Changing the order of the groups : Place the cursor on the group and ▶ **6** or **7**

- 3 Enter the group name ▶

Phonebook search

Making calls using phonebook

- In Privacy mode (when Phonebook & Logs is "Hide set contact"), the phonebook entries or groups with secrecy cannot be searched. The same applies to Quick dial, Quick mail, Headset quick-dial and Search message.

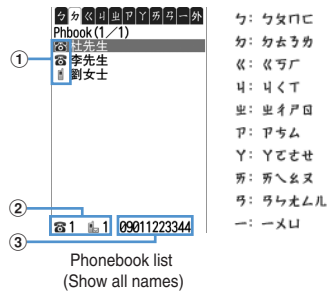
1  Search the phonebook

- Icon set for first entry
- Number of phone numbers and mail addresses saved in entry at the cursor position
- The first phone number of the party at the cursor position

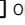

For example, if...

Name) Fujitsu
Zhuyin) ㄉㄨˋ ㄌㄧˋ ㄉㄨˋ ㄌㄨˋ
Then it will be allocated to the "ㄉ" tab.

2 Place the cursor on the party and  or 



❖ Using phonebook entries

Creating an i-mode mail : Place the cursor on the party to send a mail to and 

- When operating from the details screen, display a mail address and press  or .

Creating and sending i-mode mail→P170

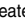
Creating SMS : Place the cursor on the party and  (1 sec. or more)

- When only the phone number is saved in the phonebook entry of selected person, pressing  can also create SMS.
- When operating from the details screen, display a phone number and press .

Creating and sending SMS →P205

Displaying sites : Place the cursor on the party and

 ► **1** **5** ► "Yes"

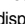
- Press  on the site connection confirmation screen to display using Full Browser.



Attaching phonebook data to mail : Place the cursor on the party and  ► **1** **3**

Creating and sending i-mode mail→P170

Searching a received mail : Place the cursor on the party and m ► **1** **6** ► **1** or **2**

- For UIM phonebook, place the cursor on the party and press  **1** **5**, and press **1** or **2**.

❖ Searching by specifying the search method

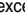
- In search method available for UIM phonebook, pressing  on a phonebook list switches the Terminal phonebook list and UIM phonebook list.
-  is displayed on the left of each entry name in the UIM phonebook list.
- When a phonebook list extends to multiple pages, you can switch pages using side keys [**▲**▼]. In a search method except Show all names,  may also be used to switch pages.

1  ► [Phonebook & Logs] ► **1**

2 Specify the search method.

Showing all names (Chinese syllabary) :

1 ► Select the line to display by 

- It will be displayed in the order of Zhuyin (ㄉ → ㄊ → ... → ㄩ) Others (alphabets, numbers, Zhuyin beginning with a blank, symbols and no Zhuyin).
- Each time you enter one Zhuyin character, an address that has the closest Zhuyin will be searched for in the address book.

Searching by group : [2] ▶ Select a group

- The entries in the specified group are displayed in the order of the reading below :
Japanese syllabary order→Alphabetical order→Number →Entries starting with blanks→Symbol→No reading
- If one of the keypads of [0], [9], [##], [X] is pressed, the line to which the keypad is assigned is displayed.

Searching by group : [2] ▶ Select a group

- The address book data within the same group will be displayed in the following Zhuyin order.
- The Zhuyin order → Alphabetical order→ Number→Beginning with a blank→Symbols→ No Zhuyin

Searching by frequency* : [3] ▶ [1] or [2]

Displayed in the order of number of calls or number of mails.

- The total numbers of calls and mails are counted up to 9,999.
- PushTalk communications are not counted.
- When resetting total number of calls/mails, place the cursor on the party, press [ME] [9] [3] and select "Yes".

Searching by phonebook number* : [4] ▶ Enter phonebook number ▶ [□]

- Zeros before single- or double-digit phonebook numbers can be omitted.
- You can display the phonebook list in phonebook No. order by pressing [□] with no input.

Searching by phone number : [5] ▶ Enter part of a phone number ▶ [□]

Search the phone numbers containing the entered numbers, and phonebook data list of the Terminal phonebook is displayed in the order of the phonebook number, and the phonebook data list of the UIM phonebook is displayed in the order of reading.

- You can display the phonebook data list in the order of phonebook No. or reading by pressing [□] with no input.

Searching by secret attribute* : [6]

The phonebook entries with secrecy appears in the order of phonebook No.

* This search method is unavailable for UIM phonebook.

◆ Setting preferred search method <Default search setting>

Set the search method displayed when pressing [□] on the stand-by display.

- [ME] ▶ [Phonebook & Logs] ▶ [1] ▶ Place the cursor on the search method and [ME]

- Check mark ✓ appears after the specified search method.

◆ Checking phonebook details

- [□] ▶ Search the phonebook ▶ Select a phonebook entry

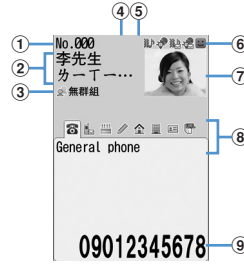

FOMA terminal phonebook details screen (Phone number)

- Phonebook No.**
- Name and reading**
- Group icon, Group name**
- Icons set in Ph.book 2in1 setting (with 2in1 ON in Dual mode) :**
 [A] : Phonebook entries in A mode
 [B] : Phonebook entries in B mode
 [AB] : Phonebook entries in both A and B modes
- Set any of Accept/Reject call, Caller ID settings or secret code**
- Icons indicating settings such as ring alert (call/mail)*1**
 [Musical notes] : Ring alert
 [Vibrate] : Vibrate alert
 [Musical notes + Vibrate] : Ring alert and Vibrate alert
 [Light bulb] : Light alert
 [Light bulb + Color] : Light color
 [Light bulb + Color + Image] : Light alert and Light color
 [Image] : Substitute image (call only)
- Image**2**
- Saved icon, Icon type**

⑨ Saved items

*1 Settings from Alert by contact are indicated with colored icons.

*2 The display follows the settings of View preference.

 : Display details screen of the previous/next phonebook entry.

 : Display the other items set.

- Even when multiple phone numbers and/or mail addresses are saved, the items can be displayed by pressing .

Viewing history information : On the phone number or mail address detail screen, .

The cumulative number and the date and time of last call appear.

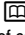
- If you press  on the history information screen, cumulation of calls and mails can be reset collectively.

Viewing User information :   



The image, phonebook No. (Terminal phonebook only), name, readings, group name, first phone number (with icon type) and first mail address (with icon type) registered in the phonebook appear.

The name and readings fully appear without cutting down.

Edit phonebook

Editing phonebook entries

◆ Editing saved data

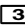
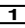
1  ▶ Search the phonebook ▶ Place the cursor on a phonebook entry and  ▶  





2 Edit the phonebook entry.

3 



◆ Copying saved data

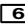

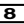
Copied item can be pasted into screen input areas such as in the mail creation screen or the phonebook data entry screen.

- Copied items are recorded until the power is turned OFF, and they can be pasted any number of times.

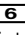
1  ▶ Search the phonebook ▶ Place the cursor on a phonebook entry to copy and  ▶  ▶  

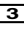
The data of appropriate items is recorded temporarily.

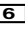
- When operating from the UIM phonebook, press   and  .
- The first saved phone number and mail address are copied.

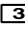
- To copy the second or subsequent phone number or mail address, display the phone number or mail address to be copied on the details screen, press   and press  or .

2 Display the character entry screen to paste ▶ Paste the characters

Pasting characters→P367

Copying phonebook entries

Entries in Terminal phonebook are copied to UIM phonebook and from UIM phonebook to Terminal phonebook.

- The Terminal phonebook also can be copied into microSD memory card. →P294
- If the entries of the phonebook contain the same group name as that in a copy destination phonebook, the data is copied to that group.
- The phonebook data item to be copied and the contents are as follows :

Item	Terminal phonebook→SIM card phonebook	SIM card phonebook→Terminal phonebook
Name	5 two-byte (12 one-byte) characters or less.	The entry content is copied as it is
Zhuyin	5 Zhuyin (12 one-byte) characters or less.	The entry content is copied as it is
Phone number	The first phonebook entry (26 digits or less). If the timer ("T") is registered only the timer ("T") is deleted. The icon will be replaced with ☎	The icon is set as All ☎.
Mail address	The first mail address (38 one-byte characters or less). The icon will be replaced with ✉ All	The icon is set as All ✉.

- If the number of characters exceeds the limit that can be saved in UIM phonebook, the exceeding part is deleted.

◆ Copying data between Terminal phonebook and UIM phonebook

<Example> Copying from Terminal phonebook to UIM phonebook

- 1 ▶ Search the phonebook ▶ ▶ **7** **1** ▶ Select a phonebook entry ▶

- When copying from the UIM phonebook to Terminal phonebook, press **7** to select a phonebook entry, and press .

Delete phonebook

Deleting phonebook entries

- When deleting all, all of the created groups are deleted.
- The identical phonebook entries in PushTalk phonebook are also deleted.
- All entries in the UIM phonebook cannot be deleted at a time.

<Example> Deleting a phonebook entry in the Terminal phonebook

- 1 ▶ Search the phonebook
- 2 Place the cursor on a phonebook entry and ▶ **4** ▶ **1** or **2** ▶ "Yes"

- When "All contacts" is selected, perform authentication.

Deleting from UIM phonebook : Place the cursor on a party and ▶ **4** ▶ "Yes"

Setting functions for phonebook entries

◆ Setting Show/Hide caller ID to each phone number <Caller ID settings>

- This item is set to "No setting" by default.
- Priority of the method to notify a caller ID→P41

- 1 ▶ Search the phonebook ▶ Place the cursor on a phonebook entry and ▶ **3** **4** **2** ▶ Authenticate ▶ Select a phone number ▶ **1** - **3**

◆ Setting secret code to mail address <Secret code>

When the other party saves a secret code for its mail address (mobile phone number@imode.net.tw) and you set that secret code for the mail address in your phonebook, the secret code is automatically added to i-mode mail created by searching the phonebook for that phone number.

- 1 Search the phonebook ▶ Place the cursor on a phonebook entry ▶ **3** **4** **4** ▶ Authenticate ▶ Select the mail address

- 2 Enter the secret code of 4 digits.

Canceling : Delete the secret code ▶

Secret attribute

Making phonebook entries secret

You can set secrecy to phonebook entries or groups. In Privacy mode (when Phonebook & Logs is "Hide set contact"), the phonebook entries or groups with secrecy are not displayed.

- These functions cannot be set for phonebook entries or groups in UIM phonebook.
- If you change secrecy, a confirmation screen appears for performing Apply secret attribute when you end the phonebook and return to the stand-by display.
- Setting Privacy mode → P114

◆ Setting secret attribute for phonebook entries

- 1 Search the phonebook ▶ Place the cursor on a phonebook entry and ▶ **3** **4** **1**

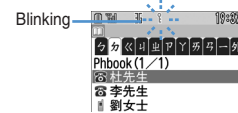

- flashes when the secret attribute is set for the entry at the cursor position.

Canceling : Search the phonebook ▶ Place the cursor on a phonebook entry and ▶ **3** **4** **1**

✓INFORMATION

- When operating from the Terminal phonebook details screen, press and select "Edit/Settings" → "Advanced settings" → "Secrecy ON".

◆ Setting secret attribute for group

- Secret attribute is not set for phonebook entries in a group with secret attribute. However, they function similarly to those with secret attribute.
- Secret attribute cannot be set for (No group).

- 1 ▶ [Phonebook & Logs] ▶ **1** **2** ▶ Place the cursor on the group and ▶ **8**

- When secret attribute is set for the group at the cursor position, blinks.

Canceling : ▶ [Phonebook & Logs] ▶ **1** **2** ▶ Place the cursor on the group and ▶ **8**

Quick dial

Using simple dial to make calls

You can make calls by a simple operation to parties with phonebook numbers 0-99 in the terminal's Phonebook.

- When there are multiple phone numbers saved in a phonebook entry, a call is made to the first phone number.

<Example> Making a voice call to the phone number registered in phonebook number 2

- 1 Enter a phonebook number (**2**) ▶ or

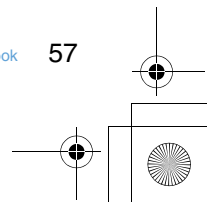
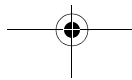
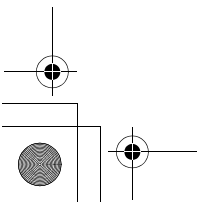
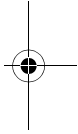
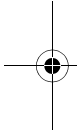
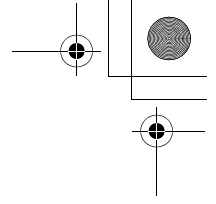
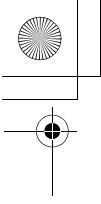

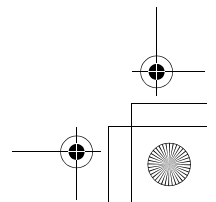
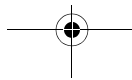
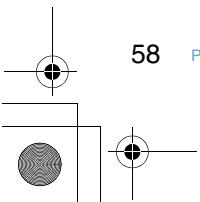
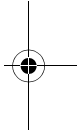
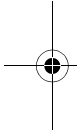
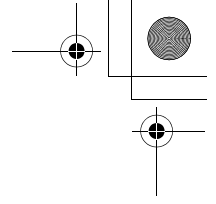
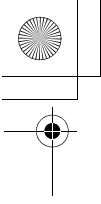

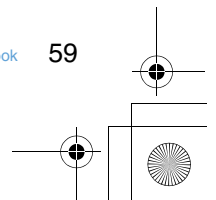
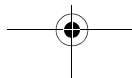
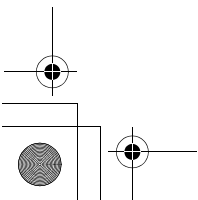
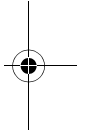
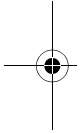
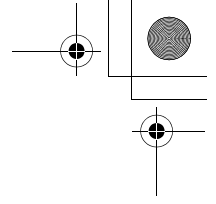
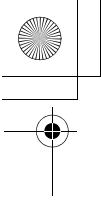

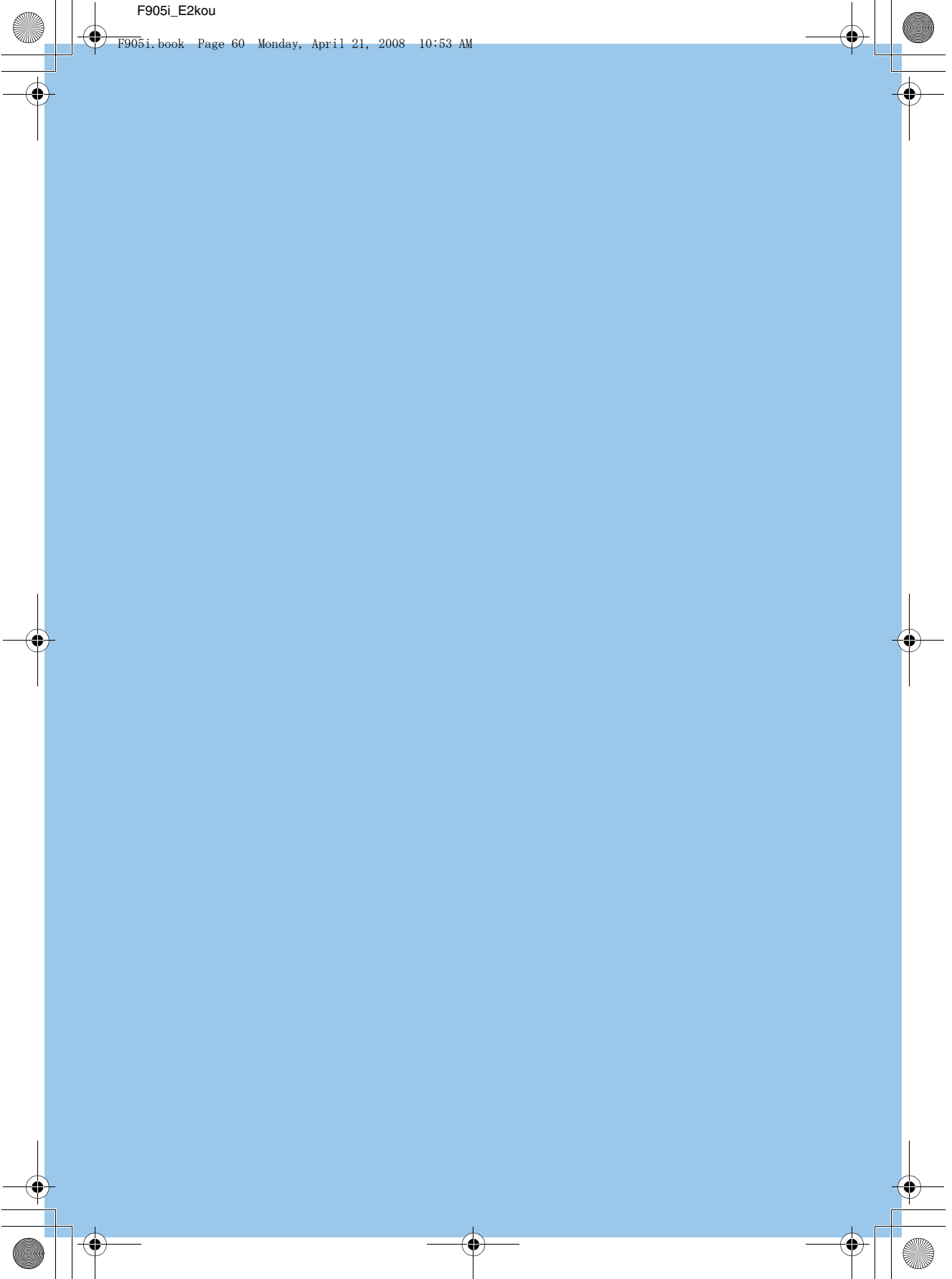

Sound/Screen/Light Settings

Setting operations for incoming calls and mail/messages

- This setting is reflected to Call ring alert, Mail/Msg ring alert, Incoming call/Videophone receiving of Call image, Vibrate alert/effect or Light alert.

◆ Changing operations for incoming call <Call alert/Videophone alert>

<Example> **Setting operations for incoming calls**

- 1 [MENU] ▶ [Settings & NW services] ▶ [5] [1] [2] ▶ Set the required items ▶ [OK]

Changing operations for incoming videophone calls

- 1 [MENU] ▶ [Settings & NW services] ▶ [6] [1] [2] ▶ Set the required items ▶ [OK]

◆ Changing operations for incoming mail <Mail alert>

MENU [Mail] 011

- 1 [MENU] ▶ [Mail] [1] ▶ Set the required items ▶ [OK]

Call ring alert/Mail ring alert

Changing ring alert for calls and mails, etc.

- When a movie/i-motion is set as a ring tone, a movie and/or sound is played for incoming phone call or mail (Movie ringtone).
- This setting is reflected to ring alert in Call alert, Videophone alert, Mail alert, and Chat mail alert.

<Example> **Setting ring alert for incoming mail**

- 1 [MENU] ▶ [Settings & NW services] ▶ [1] [1]

- 2 [2]

Setting ring alert for incoming voice/videophone call : [1] ▶ [1]-[3]

- 3 Set the required items ▶ [OK]

◆ Setting Music

Music (Full Track Music) can be set as a ring alert in two ways : "Full song ring tone" for setting whole music and "Point ring tone" for setting a section previously selected.

<Example> **Setting Full song ring tone**

- 1 Select "Music" at each setting ▶ Select a folder

- 2 Select a music to set.

- When music in microSD memory card is selected, a confirmation screen appears. Select "Yes" to move the music to the terminal and set to a ring alert.

Setting Point ring tone : Place the cursor on the data to set and [OK] ▶ Select the item

- When Full Track Music in microSD memory card available to nonmember is selected, a confirmation screen for cutting out the portion to set as the ring alert and saving it in the i-motion folder appears. Select "Yes", enter a display name and press [OK]. The cut out music is saved to "i-mode" folder of i-motion as i-motion compatible with contents transfer. When the maximum number of saved items/area is reached → P306

❖ Ring alert priority

When setting ring alerts for multiple functions, they sound in order of the priority below.

- ① Alert by contact of the Terminal phonebook
 - ② Alert/image by group of the Terminal phonebook
 - ③ Call ring alert/V.phone ring alert/Mail ring alert/Call alert (Incoming call)/Videophone alert (Videophone receiving)/Mail alert
- When the other party does not notify the caller ID, the ring alert for voice call depends on Anonymous caller. A ring alert for videophone call depends on the settings of V.phone ring alert/Videophone alert.
 - When the sound or image data used in Anonymous caller is deleted, the settings are changed. The sound actually heard or the image actually displayed may differ from the settings.
 - When movie/i-motion containing sound and image is set in "Movie ringtone" for ring alert, ring alert and incoming image set for "Movie ringtone" have precedence over images or movie/i-motion set in phonebook. When setting "Movie ringtone" of ring alert for music or movie/i-motion containing only sound (i-motion without image such as the one containing only voice of a singer), ring alert becomes "Music" or "Movie ringtone", and receiving call image becomes phonebook image.

Stereo sound effect

Setting Stereo/3D sound or Surround

- This setting is also reflected to Surround of Settings for movie/i-motion and Music player, and Stereo/3D sound of Settings for Melody.

- 1  [Settings & NW services] ▶ **1** **6** ▶ **1**-**3** ▶ **1** or **2**

✓INFORMATION

- The 3D sound function creates sound that is 3-dimensional or moves around in space, using stereo speakers (or stereo earphone set). Using the 3D sound function, very realistic i-ϕpli games and ring alerts and i-motion can be enjoyed. The most realistic 3D sound can be enjoyed when the terminal is held in front of the listener's face 20-30 cm away (varying between individuals). 3D sound becomes less realistic when the terminal is positioned off the center rightward or leftward or at a distance more or less than 20-30 cm from the face.
- There are differences in how the 3D sound effect is felt among individuals.

Alarm sound

Setting alarm sound for Alarm clock and Schedule reminder

<Example> Setting Alarm clock sound

- 1  [Settings & NW services] ▶ **1** **1** **3**
- 2 **1** ▶ Select the Alarm clock field ▶ **1**-**4**

Setting Music→P87

Setting sound for Schedule reminder :

- 2 ▶ Select the Alarm on time field or Alarm in advance field ▶ **1**-**3**

3

Adjust volume

Setting volume of various sounds such as ring alert and alarm sound

- 1  [Settings & NW services] ▶ **1** **2** ▶ **1**-**7**
 - When Alarm volume is selected, select **1** or **2**.

- 2 Side keys[▲▼] or  ▶ 

Vibrate alert/effect

Using vibrator to signal incoming calls and alarms

- The operation of Vibrator for receiving 64K data communication depends on the setting of incoming voice call.
- This setting is also reflected to settings for Vibrate alert or Vibrate effect in Call alert, Videophone alert, Mail alert, Chat mail alert and i-ϕpli settings.
- If the terminal is on the desk, etc. when the vibrator operates, it may fall off because of the vibration.

<Example> When setting the vibrator for incoming voice, videophone and PushTalk calls

- 1  [Settings & NW services] ▶ **1** **3**
- 2 **1** ▶ **1**-**2**
 - Setting the vibrator for incoming mail: **2**
 - Setting the vibrator used together with Alarm clock or Schedule reminder sounding : **3** ▶ **1** or **2**
 - Setting the vibrator used for i-ϕpli : Press **4**.

3 **1**-**5**

❖ Vibrate alert priority

When setting Vibrator in multiple functions, it operates in order of the priority below.

- ① Alert by contact of the Terminal phonebook
- ② Alert/image by group of the Terminal phonebook
- ③ Vibrate alert/effect/Call alert/Videophone alert/Mail alert

Operation sound

Setting operation sound

You can change the sound to be emitted when a key is pressed (except side keys [▲▼], [M] or [C]) or the terminal is opened or folded. Emission of the sound can also be inhibited.

- 1 [M] ▶ [Settings & NW services] ▶ [1][1][4][1] ▶ [1]-[4]

Display turn sound

Setting sound to be emitted when turning display

- 1 [M] ▶ [Settings & NW services] ▶ [1][1][4][2] ▶ Select the Turn sound field ▶ [1] or [2]

2 [M]

Shutter sound/Movie camera sound

Setting shutter sound

- 1 [M] ▶ [Settings & NW services] ▶ [1][1][4] ▶ [3] or [4] ▶ [1]-[5]

Charge alert

Setting alert sound for charging

- 1 [M] ▶ [Settings & NW services] ▶ [1][1][5] ▶ [1] or [2]

On-hold tone

Setting on-hold tone

- 1 [M] ▶ [Settings & NW services] ▶ [1][1][6][2] ▶ [1]-[3]

Quality alarm

Alarm announcing that call is about to be interrupted

- If the signal quality deteriorates rapidly, the call may be disconnected without sounding the alarm.

- 1 [M] ▶ [Settings & NW services] ▶ [1][1][6][3] ▶ [1]-[3]

✓INFORMATION

- To make settings during a voice call, press [M] and select "Quality alarm".

Reconnect alarm

Setting alarm for reconnecting interrupted call

- 1 [M] ▶ [Settings & NW services] ▶ [1][1][6][4] ▶ [1]-[3]

Low Battery alert

Setting Low Battery alert

You can set if you activate the alert when the battery is low.

- 1 [M] ▶ [Settings & NW services] ▶ [1][1][6][5] ▶ [1] or [2]

Silent mode

Making the terminal silent

Sounds from the terminal can be disabled in order to prevent disturbance to the people around you by enabling the vibrator for incoming calls or muting the keypad sound.

◆ Starting Silent mode

1 (1 sec. or more)

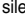
After Silent mode specified in Silent mode is activated,  (in General silent mode) or  (in Personalized silent mode) is displayed on the stand-by display.

- By default, you can also start/cancel Silent mode by pressing and holding Side key [>] for 1 second or more with the terminal folded. When Silent mode starts, the light goes lit once in red and the vibrator operates once. When Silent mode is canceled, the light flashes twice in blue and the vibrator operates twice.
- When the terminal is folded, Silent mode can be activated/deactivated from a menu on the sub-display. →P33

Canceling :  (1 sec. or more)

❖ When General silent mode is activated

An incoming call is notified with vibration, muting all sounds to be emitted from the terminal such as ring tone, keypad sound, terminal open/close sound, Display turn sound or Alarm. Microphone is sensitized so that a call can be made in a small voice.

- In the cases below, the operation of vibrate alert is "Pattern A".
 - When receiving voice call, videophone call, mail or 64K data communication
 - When the time specified in Countdown timer elapses
 - When the date and time specified in schedule comes
- When the time specified in Alarm clock comes, vibrate operates according to the setting of Alarm clock.
- Melody is not played automatically even when sent/received mail is displayed with "Auto play" set for Attachment auto-play.
- When playing a movie/i-motion with sound in Silent mode, the sound playing confirmation screen appears. Select "Yes" to play the sound and image. When "No" is selected for a movie/ i-motion with image, only image is played.
- When playing Music or Melody in Silent mode, the playing confirmation screen appears. Select "Yes" to play.

✓INFORMATION

- Shutter sound is emitted even in Silent mode.

◆ Setting Personalized Silent mode <Silent mode>

1 ▶ [Settings & NW services] ▶

2

Setting General silent mode : 

3 Set the required items ▶

Timed theme

Changing stand-by display, Silent mode, etc. according to lifestyles

MENU [Settings & NW services] 726

This function allows you to change the stand-by display or activate Silent or Privacy mode at the specified time.

You can select the alarm to sound once only, repeat everyday or sound on the same day every week.

- Up to 18 codes can be registered.

1 ▶ [Settings & NW services] ▶ ▶ Select the title

 is displayed at the left of the title for Timed theme set to ON.

Setting/canceling the timed theme : Place the cursor on the title and 

2 Set the required items ▶

Stand-by display

Changing stand-by display

An image, movie/i-motion, Chara-den or i-oppli can be set on the stand-by display or images in a folder can be set to appear at random on the stand-by display. The screen can be customized to display the newly arrived information, calendar, schedule, etc. Displaying clock (→P104), battery and signal level icon (→P101) can also be set.

- Stand-by display for some of images, movies/i-motion, Chara-den or i-oppli are disabled if you do not insert the same UIM as used in downloading the data (UIM operation restriction).
- If a data in "Preinstalled" folder is set, the set stand-by display is displayed even in Personal data lock.

◆ Setting image/movie/i-motion/Chara-den as stand-by display

Image, movie/i-motion or Chara-den downloaded from an i-mode site or still image or movie shot with the terminal can be