



# Gg-Mini

- Bluetooth V2.0 EDR
- Firmware Upgradable
- Extremely lightweight, 9 grams
- Winner of prestigious iF Product Design Award
- Incorporates 'i-Voice' Technology for loud calls even in noisy environment



Tel : + 886-2-87510222  
 Fax : + 886-2-87510668  
 Website : www.gg2002.com  
 Email : sales@ggtelecom2002.com

GG The GG Way



## Headset overview

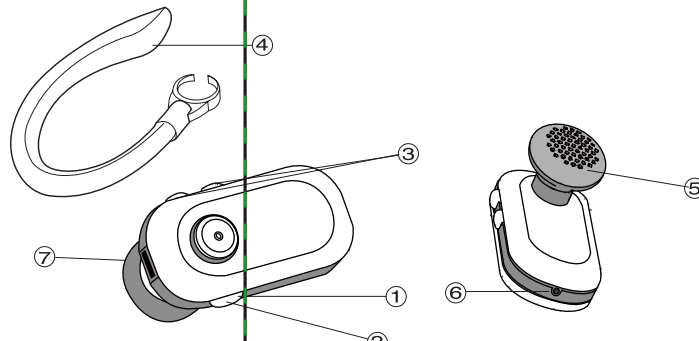

- 1. Indicator LED**  
There are 3 colors(blue/red/purple) to show the status of your headset.
- 2. Multifunction button**  
To answer, end, reject a call and control advance functions by constituting with volume control button (please refer to the Function/Button matrix).
- 3. Volume control button**  
To increase or decrease the volume of speaker and control advance functions by constituting with MFB (please refer to the Function/Button matrix).
- 4. Ear-hook**  
To wear the headset on your ear, you can switch the direction as your habit.
- 5. Speaker**  
Plays the sound you receive on the call or the audio indicators
- 6. Microphone**  
Voice input for outgoing voice.
- 7. Charging Port**  
Plug in the USB charging cable to charge the battery of your headset.

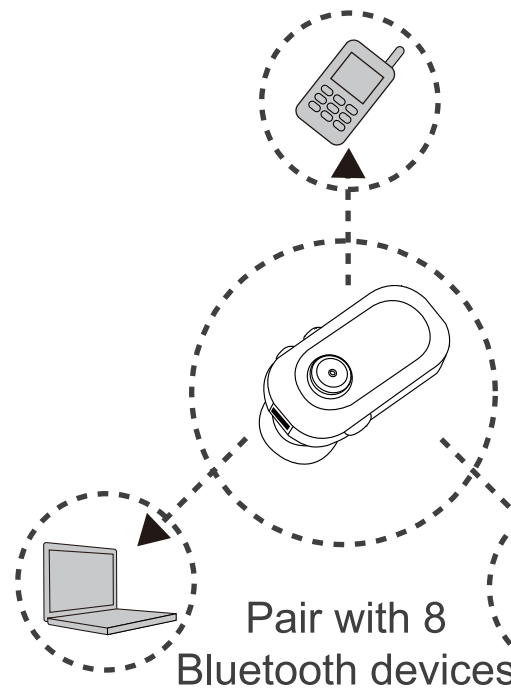

Pair with 8 Bluetooth devices

## Getting started

### Introduction

#### Headset Features

1. MFB(Answer/End/Reject/Setup a handsfree connection)
2. Volume Up Button
3. Volume Down Button

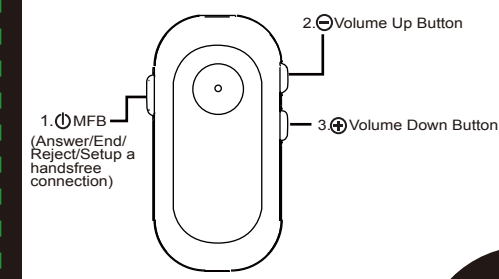

### Charging your Headset

Charging of your headset will take about 1.5 hours. Follow the procedure as follows:

1. Insert the headset Wall Charger into a DC power source and switch ON.
2. Insert the plug on the end of the headset charging cable into your headset as shown below.
3. The Red LED indicators will light up showing that the headset is being charged.
4. When charging is complete the Red LED indicators will turn off.
5. Remove the charger plug from the headset then switch off the charger.

### Pairing with your Bluetooth device

Before you can use your headset, you must pair it with the device you wish to use.

#### Step A: Put your headset in Pairing Mode

Method1  
When your headset is , not turn on, long press the MFB button until the red and blue light alternate.

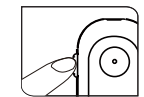

Method2  
When your headset in standby mode, (blue light blinking 1 time every 4 seconds), long press the Volume Up button until the red and blue light alternate.

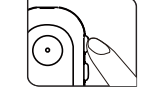

#### Step B: Pairing your headset to your phone/device

1. Turn on the Bluetooth function of your phone/device
2. Perform a "Bluetooth device discovery" from your phone or device.



#### Step C: Initial Test

1. On your phones keypad, dial a contact you wish to call.
2. Press Send on your phone to initiate the call. The call will be heard on the headset.

Your headset and your phone should now be paired and connected, ready to make and receive calls. To confirm they are successfully paired and operating properly please try the following:

### Quick Tips

1. To power on your headset, press and hold the MFB (about 3 seconds) until the blue indicator flashes 2 times. After power on, your headset will connect to your last used phone automatically.
2. To power off your headset, press and hold the MFB (about 3 seconds) until the red indicator flashes 2 times.
3. To setup the handsfree connection to your last used phone, press the MFB when there is no handsfree connection between your headset and your phone (please refer to the LED indicator chart).
4. To voice dial, press the MFB when there is a handsfree connection between your headset and your phone (please refer to the LED indicator chart).
5. To answer or end a call, press the MFB when there is a call or during a call.
6. To reject a call, press and hold the MFB (about 2 seconds) when there is a call.(8)
7. To redial the last call, press and hold the Volume Down Button (about 2 seconds) when there is a handsfree connection between your headset and your phone. (8)
8. To adjust the volume, press the Volume UP/Down Button when during a call.
9. To mute/unmute the microphone, press the Volume Up Button and Volume Down Button at the same time when during a call.

10. To disable/enable the LED indicator, double press the Volume Up/Down Button when your headset is in standby mode.
11. To reset your headset to factory settings, press the MFB and Volume Up Button and Volume Down Button at the same time when your headset is in standby mode. (8); Your Bluetooth phone must support handsfree profile.

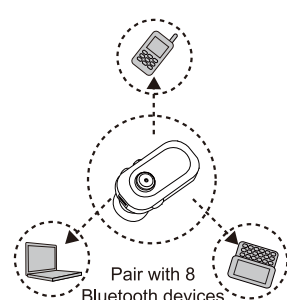

Pair with 8 Bluetooth devices

### LED Indicator Chart

Headset State	LED Indication
Power on	Blue indicator blinks twice
Power off	Red indicator blinks twice
Pairing mode	Red & Blue indicators blinks by turns
Reset	Purple indicator blinks twice
Standby mode	Blue indicator blinks once every 4 seconds
Sniff mode	Blue indicator rapidly blinks twice every 4 seconds
Incoming call	Purple indicator rapidly blinks once per second
Talking	Blue indicator rapidly blinks 3 times every 4 seconds
Charging	Red indicator light steady on
Charging complete	Red indicator off
Low battery	All Blue indication will change to Red

Note: Sniff mode means your headset has a handsfree connection with your phone.

This manual is published by G.G. Telecom, without any warranty. The information contained in this document is subject to change without notice. All rights reserved.

The Bluetooth word mark and logos are owned by the Bluetooth SIG, Inc. and any use of such marks by G.G. Telecom is under license. Other trademarks and trade names are those of their respective owners.

### Function / Button matrix

Function	Operation
Pair	long press for 2 seconds
•Voice dial using the current connected phone when connected	short press 1 time
•Cancel voice dialing	
•Cancel last call redial	
•Answer a call	
•End a call	
•Last call redial using the current connected phone when connected	long press for 2 seconds
•Last call redial using the last used phone when not connected	long press for 2 seconds
Reject a call	short press 1 time
Volume up	long press for 2 seconds
Volume down	short press 1 time
Release the Bluetooth connection	short press at the same time
Reset	short press at the same time

### Potentially explosive atmospheres

For safety reason, turn off your electronic device when surrounded by possible explosive atmosphere. It is rare, but your electronic device could generate sparks which can cause an explosion or fire. Areas with a potentially explosive atmosphere are often, but not always, clearly marked. Explosive atmosphere may include gas stations, fuel or chemical storage facilities, and in environment where metal powders, grain are contained in the air.

**Power supply**

- Do not wear your headset when charging.
- Power supply must be connected to designated power sources as marked on the product.
- The reduce risk of damage to the electronic cord, only remove it by grasping onto the AC adapter rather than the cord itself from the outlet.
- Make sure the cord is well positioned to avoid potential damage.
- Before attempting to clean the AC power adapter, please unplug the unit from any power source to reduce risk of electric shock.
- The AC power adapter is designed for indoor use only, and must not be used outdoors.
- If the plug will not fit into the outlet, asking help from a qualified electrician. Improper connection can result in risk of electric shock.

**Emergency calls**

You should never rely solely upon any electronic device for essential communications (e.g. 911 emergency calls). Keep in mind that when making or receiving a call, your headset and the electronic device connected to must be switched on and in a service area with adequate cellular signal strength. Emergency calls can sometimes be disrupted on certain cellular phone networks or when certain network services and/or phone features are in use. Check with your local cellular service provider for more details.

**Battery information**

- The rechargeable battery of your headset is not fully charged when it is new.
- Before your initial use, please charge your headset for 4 hours first.
- When the rechargeable battery of your headset is low, there will be a battery low tone and the red indicator will rapidly flash twice every 2 seconds to alert the user.

The rechargeable battery of your headset has a long service life if treated properly.

- One new battery, or one that has not been used for a long period of time, could have reduced capacity the first few times it is used.
- Use your headset in room temperature for maximum battery capacity.
- Do not expose your headset to an environment temperature above +35 °C (+131 °F). If your headset is operated in cold temperatures, the battery capacity will be reduced.
- The battery can only be charged in temperatures between +10 °C (+55 °F) and +45 °C (+113 °F).

**FCC Statement**  
 The device complies with Part 15 of the FCC rules. Operation is subject to the following two conditions:  
 1. This device must accept any interference received, including interference that may cause undesired operation.  
 2. This device may not cause harmful interference.

Federal Communications Commission (FCC) statement

**15.21**  
 You are cautioned that changes or modifications not expressly approved by the party responsible for compliance could void the user's authority to operate the equipment.

**15.108(b)**  
 This equipment has been tested and found to comply with the limits for a class B digital device, pursuant to part 15 of the FCC rules. These limits are designed to provide reasonable protection against harmful interference in a residential installation. This equipment generates, uses and can radiate radio frequency energy and, if not installed and used in accordance with the instructions, may cause harmful interference to radio communications. However, there is no guarantee that interference will not occur in a particular installation. If this equipment does cause harmful interference to radio or television reception, which can be determined by turning the equipment off and on, the user is encouraged to try to correct the interference by one, or more of the following:

- Reorient or relocate the receiving antenna.
- Increase the separation between the equipment and receiver.
- Connect the equipment into an outlet on a circuit different from that to which the receiver is connected.
- Consult the dealer or an experienced radio/TV technician for help.

You are cautioned that changes or modifications not expressly approved by the party responsible for compliance could void your authority to operate the equipment.

**FCC RF radiation exposure statement:**  
 This transmitter must not be co-located or operating in conjunction with any other antenna or transmitter.

**Regulatory information**

Any modification or changes (e.g. antennas) made to this headset that is not expressly approved by G.G. Telecom may void the user's authority to operate this headset. G.G. Telecom is not responsible for any radio or television interference caused by unauthorized modification of this headset. It is the responsibility of the user to encourage any interference caused by such unauthorized modification. G.G. Telecom and its authorized resellers or distributors will assume no liability for any damage or violation of government regulations arising from failing to comply with these guidelines.

This user manual is published by G.G. Telecom, without any guarantee. The information contained in this document is subject to change without notice.

### GG Telecom Warranty Process

1. Should you be having difficulties in the operation of your headset please refer to the online FAQ and support documents.
  2. Check our website for more information, updated manuals and troubleshooting.
- www.gg2002.com
3. Return the unit directly to GG Telecom for testing and replacement of faulty items - Please call or email to arrange a Return Merchandise Authorization(RMA) number.
- Warranty Terms and Conditions**
1. GG Telecom Warrant the original purchaser of this product only.
  2. GG Telecom will replace or repair any faulty product provided it has not been misused or abused in any way.
  3. There are no user serviceable parts inside this product. Using a nonauthorized repairer will void the warranty.
  4. The Baby-a Warranty is valid for 2 years(24 months) from the date of purchase.
    - Proof of purchase must be supplied to obtain warranty.
    - Headset must be in original packaging with serial number for warranty to be valid.
  5. Warranties are effective from the proof of purchase date and not from the date of any subsequent repair of replacement.

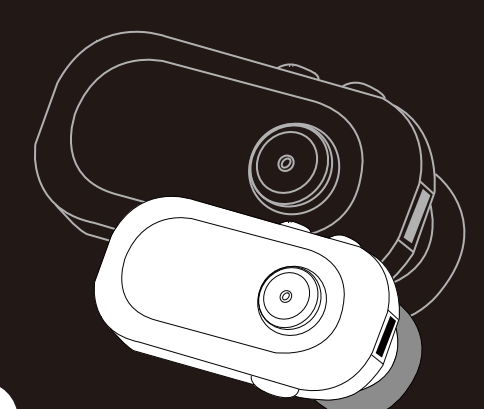

### Warranty Card

The product which produced by G.G. Telecom(2002) Inc. has been fully exam and pass quality control. Sincere guarantees to Guaranty Certificate by this product to be suitable for the following conditions:

- G.G. Telecom provides 2 year limited warranty for this product commencing from the date of purchase.
- Customers must present the original Warranty Card within product serial number together with original purchase invoice to retailer for verification when warranty service is rendered.
- Within the warranty period, G.G. Telecom will repair or replace the parts that are damaged under normal circumstances (re-value by G.G. Telecom) at no additional charge.
- Any cost of transportation is on the account of purchaser.
- Free guarantee service will not be provided to the said equipment if:
  - (a) Any unauthorized repair or modification has been carried out on the unit, or
  - (b) It has been damaged through misuse, negligence, accident, insects or natural calamities, or
  - (c) It has been installed, maintained or operated otherwise than in accordance with the instructions.
- Warranty service is valid worldwide.
- The warranty card is only valid through authorised retailer only.

Model No: \_\_\_\_\_

Product Serial Number: \_\_\_\_\_

Purchase Date: (YY) (MM) (DD)

GG Telecom

**CAUTION**  
 Protect your hearing!  
 Do not use your headset at loud volumes or for long periods.  
 Read user manual.