



REPUBLIC OF GAMERS

ROG KERIS II ACE

WIRELESS OPTICAL GAMING MOUSE P714

Quick Start Guide
快速使用指南 (繁體中文)
快速使用指南 (简体中文)
クイックスタートガイド (J)
간단사용설명서 (KO)
Guide de démarrage rapide (FR)
Schnellstartanleitung (DE)
Guida rapida (IT)
Guia de Inicio Rápido (PT:BR)
Краткое руководство (RU)
Guia de inicio rápido (ES)
Beknopte handleiding (NL)
Hızlı Başlangıç Kılavuzu (TR)

Список керівництво для початку експлуатації (UA)
Przewodnik szybkiego startu (PL)
Rychlý průvodce (CS)
Ghid de pornire rapidă (RO)
Gyors üzembemhelyezési útmutató (HU)
Schnellstarthandbok (SV)
Pikaopas (FI)
Hurtigstartveiledning (NO)
Краткое руководство (RU)
Guia de inicio rápido (ES)
Beknopte handleiding (NL)
Hızlı Başlangıç Kılavuzu (TR)

(AR) دليل التشغيل السريع
(HB) מדריך להתחלה מהירה



Package Contents

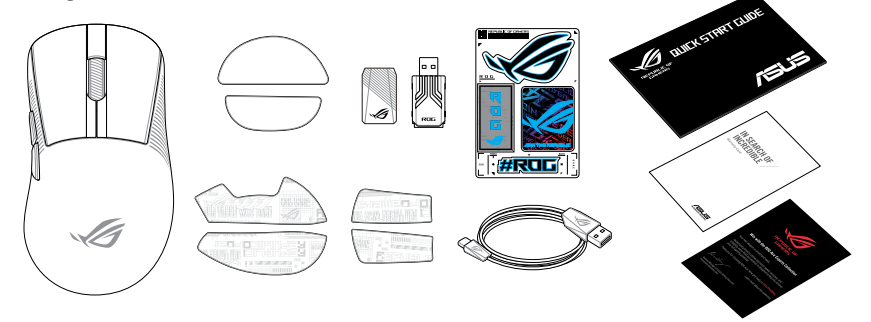

- * We recommend using the wireless dongle extender when using the mouse in 2.4GHz mode. 我們建議當您在2.4GHz無線模式下時，使用無線接收器延長器。
- ** Only use the wireless dongle extender for the wireless dongle. 無線接收器延長器僅可用於無線接收器。
- *** Remove the pre-installed mouse feet before installing the bundled mouse feet. Remove the pre-installed mouse feet before installing the bundled mouse feet.

Mouse features / 滑鼠功能 / 鼠标功能

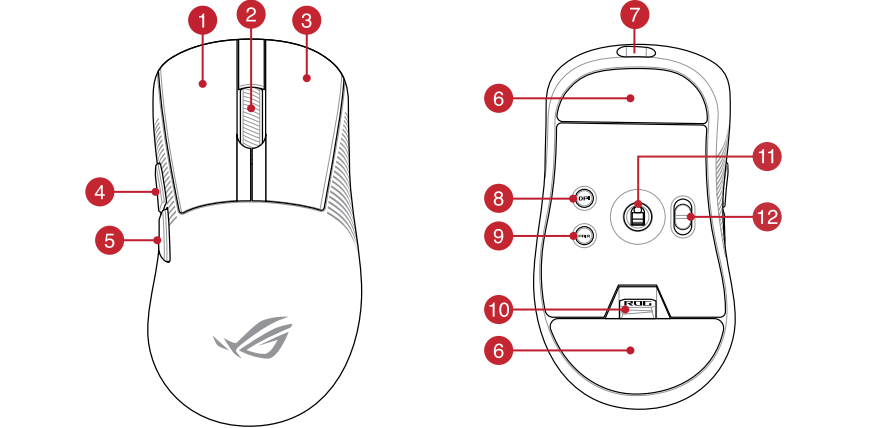

- 1

Left-click button / 左鍵 / 左键
- 2

Scroll wheel / 滾輪 / 滚轮
- 3

Right-click button / 右鍵 / 右键
- 4

Forward button / 向前按鈕 / 向前按钮
- 5

Backward button / 向後按鈕 / 向后按钮
- 6

Mouse feet / 滑鼠腳墊 / 鼠标脚垫
- 7

USB Type-C* connector / USB Type-C* 連接埠 / USB Type-C* 接口
- 8

DPI button / DPI 按鈕 / DPI 按钮
- 9

Pairing button / 配對按鈕 / 配对按钮
- 10

USB dongle / USB 無線訊號接收器 / USB 无线信号接收器
- 11

Optical sensor / 光學感測器 / 光学感应器
- 12

Connection mode switch / 連線模式切換開關 / 连接模式切换开关

Profile switching

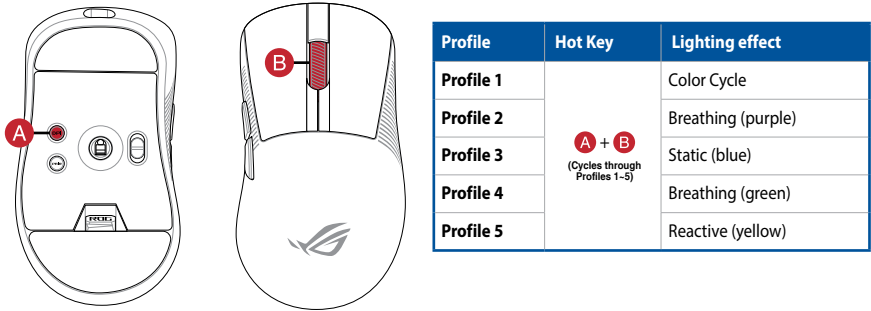

Profile	Hot Key	Lighting effect
Profile 1	<div>A + B</div> <div>(Cycles through Profiles 1-5)</div>	Color Cycle
Profile 2		Breathing (purple)
Profile 3		Static (blue)
Profile 4		Breathing (green)
Profile 5		Reactive (yellow)

Onboard settings adjustment

Description	Key Combination	Lighting effect
Hardware Reset	Hold Left-click button + Right-click button + Scroll wheel + DPI button for 3 seconds	The Scroll LED will blink red once the key combination is held down until the reset is complete. The scroll LED will blink green once the reset is complete.
Polling rate level switch	Pairing button + Backward button	Cycles through the following polling rates: 125 (red) / 250 (purple) / 500 (blue, BT not supported) / 1000 Hz (green, BT not supported) / 2000 Hz (yellow, with polling booster, BT not supported) / 4000 Hz (blue-green, with polling booster, BT not supported) / 8000 Hz (white, with polling booster, BT not supported)
Sensor Lift-off-distance level switch	Pairing button + Forward button	Cycles through the following lift-off-distances: Low (red, default) / High (purple)

Specifications*

Resolution	DPI 1	DPI 2	DPI 3 (Default)	DPI 4
100 DPI to 42000 DPI	400 DPI	800 DPI	1600 DPI	3200 DPI

* You may customize the DPI settings for DPI 1-4 through Armoury Crate or the DPI On-The-Scroll tuning function.

Connecting your gaming mouse

Setting up your gaming mouse as a wired mouse

Connect the bundled USB Type-C* to Type-A cable to your gaming mouse and a USB port on your computer

Setting up your gaming mouse as a RF wireless mouse

1. Connect the USB dongle to a USB port on your computer.
2. Set the connection switch to the **RF 2.4G Wireless mode**.

Setting up your gaming mouse as a Bluetooth* wireless mouse

Set the connection switch to the **Bluetooth* mode**.

Pairing Bluetooth* mode to additional host devices (max. 3)

1. Set the connection switch to the **Bluetooth* mode**.
2. Press and hold the **Pairing** button for 3 seconds until the LED on your gaming mouse start to blink blue. Once your gaming mouse has been successfully paired, the LED indicator on your gaming mouse will light up blue for 3 seconds.

Updating the firmware and customization

1. Connect your gaming mouse to your computer using the bundled cable, then connect the USB dongle to a USB port.
2. Download and install the Armoury Crate software from <https://rog.asus.com>
3. Follow the software instructions to update your gaming mouse and dongle's firmware.
4. Customize your gaming mouse using Armoury Crate.

Using the DPI On-The-Scroll tuning function

The DPI On-The-Scroll tuning function allows you to customize the DPI of your gaming mouse without using Armoury Crate.

1. Press and hold the DPI button for 3 seconds until the LED on your gaming mouse light up.
2. Scroll the scroll wheel forwards or backwards to adjust the DPI. The LED color hue on your mouse will differ depending on the DPI adjustment.
3. Press the DPI button once you have finished customizing the DPI value to save the changes made.

Connecting your gaming mouse

Setting up your gaming mouse as a wired mouse

Connect the bundled USB Type-C* to Type-A cable to your gaming mouse and a USB port on your computer

Setting up your gaming mouse as a RF wireless mouse

1. Connect the USB dongle to a USB port on your computer.
2. Set the connection switch to the **RF 2.4G Wireless mode**.

Setting up your gaming mouse as a Bluetooth* wireless mouse

Set the connection switch to the **Bluetooth* mode**.

Pairing Bluetooth* mode to additional host devices (max. 3)

1. Set the connection switch to the **Bluetooth* mode**.
2. Press and hold the **Pairing** button for 3 seconds until the LED on your gaming mouse start to blink blue. Once your gaming mouse has been successfully paired, the LED indicator on your gaming mouse will light up blue for 3 seconds.

Connecting your gaming mouse

Setting up your gaming mouse as a wired mouse

Connect the bundled USB Type-C* to Type-A cable to your gaming mouse and a USB port on your computer

Setting up your gaming mouse as a RF wireless mouse

1. Connect the USB dongle to a USB port on your computer.
2. Set the connection switch to the **RF 2.4G Wireless mode**.

Setting up your gaming mouse as a Bluetooth* wireless mouse

Set the connection switch to the **Bluetooth* mode**.

Pairing Bluetooth* mode to additional host devices (max. 3)

1. Set the connection switch to the **Bluetooth* mode**.
2. Press and hold the **Pairing** button for 3 seconds until the LED on your gaming mouse start to blink blue. Once your gaming mouse has been successfully paired, the LED indicator on your gaming mouse will light up blue for 3 seconds.

Updating the firmware and customization

1. Connect your gaming mouse to your computer using the bundled cable, then connect the USB dongle to a USB port.
2. Download and install the Armoury Crate software from <https://rog.asus.com>
3. Follow the software instructions to update your gaming mouse and dongle's firmware.
4. Customize your gaming mouse using Armoury Crate.

Using the DPI On-The-Scroll tuning function

The DPI On-The-Scroll tuning function allows you to customize the DPI of your gaming mouse without using Armoury Crate.

1. Press and hold the DPI button for 3 seconds until the LED on your gaming mouse light up.
2. Scroll the scroll wheel forwards or backwards to adjust the DPI. The LED color hue on your mouse will differ depending on the DPI adjustment.
3. Press the DPI button once you have finished customizing the DPI value to save the changes made.

Connecting your gaming mouse

Setting up your gaming mouse as a wired mouse

Connect the bundled USB Type-C* to Type-A cable to your gaming mouse and a USB port on your computer

Setting up your gaming mouse as a RF wireless mouse

1. Connect the USB dongle to a USB port on your computer.
2. Set the connection switch to the **RF 2.4G Wireless mode**.

Setting up your gaming mouse as a Bluetooth* wireless mouse

Set the connection switch to the **Bluetooth* mode**.

Pairing Bluetooth* mode to additional host devices (max. 3)

1. Set the connection switch to the **Bluetooth* mode**.
2. Press and hold the **Pairing** button for 3 seconds until the LED on your gaming mouse start to blink blue. Once your gaming mouse has been successfully paired, the LED indicator on your gaming mouse will light up blue for 3 seconds.

Updating the firmware and customization

1. Connect your gaming mouse to your computer using the bundled cable, then connect the USB dongle to a USB port.
2. Download and install the Armoury Crate software from <https://rog.asus.com>
3. Follow the software instructions to update your gaming mouse and dongle's firmware.
4. Customize your gaming mouse using Armoury Crate.

Using the DPI On-The-Scroll tuning function

The DPI On-The-Scroll tuning function allows you to customize the DPI of your gaming mouse without using Armoury Crate.

1. Press and hold the DPI button for 3 seconds until the LED on your gaming mouse light up.
2. Scroll the scroll wheel forwards or backwards to adjust the DPI. The LED color hue on your mouse will differ depending on the DPI adjustment.
3. Press the DPI button once you have finished customizing the DPI value to save the changes made.

Connecting your gaming mouse

Setting up your gaming mouse as a wired mouse

Connect the bundled USB Type-C* to Type-A cable to your gaming mouse and a USB port on your computer

Setting up your gaming mouse as a RF wireless mouse

1. Connect the USB dongle to a USB port on your computer.
2. Set the connection switch to the **RF 2.4G Wireless mode**.

Setting up your gaming mouse as a Bluetooth* wireless mouse

Set the connection switch to the **Bluetooth* mode**.

Pairing Bluetooth* mode to additional host devices (max. 3)

1. Set the connection switch to the **Bluetooth* mode**.
2. Press and hold the **Pairing** button for 3 seconds until the LED on your gaming mouse start to blink blue. Once your gaming mouse has been successfully paired, the LED indicator on your gaming mouse will light up blue for 3 seconds.

Connecting your gaming mouse

Setting up your gaming mouse as a wired mouse

Connect the bundled USB Type-C* to Type-A cable to your gaming mouse and a USB port on your computer

Setting up your gaming mouse as a RF wireless mouse

1. Connect the USB dongle to a USB port on your computer.
2. Set the connection switch to the **RF 2.4G Wireless mode**.

Setting up your gaming mouse as a Bluetooth* wireless mouse

Set the connection switch to the **Bluetooth* mode**.

Pairing Bluetooth* mode to additional host devices (max. 3)

1. Set the connection switch to the **Bluetooth* mode**.
2. Press and hold the **Pairing** button for 3 seconds until the LED on your gaming mouse start to blink blue. Once your gaming mouse has been successfully paired, the LED indicator on your gaming mouse will light up blue for 3 seconds.

Connecting your gaming mouse

Setting up your gaming mouse as a wired mouse

Connect the bundled USB Type-C* to Type-A cable to your gaming mouse and a USB port on your computer

Setting up your gaming mouse as a RF wireless mouse

1. Connect the USB dongle to a USB port on your computer.
2. Set the connection switch to the **RF 2.4G Wireless mode**.

Setting up your gaming mouse as a Bluetooth* wireless mouse

Set the connection switch to the **Bluetooth* mode**.

Pairing Bluetooth* mode to additional host devices (max. 3)

1. Set the connection switch to the **Bluetooth* mode**.
2. Press and hold the **Pairing** button for 3 seconds until the LED on your gaming mouse start to blink blue. Once your gaming mouse has been successfully paired, the LED indicator on your gaming mouse will light up blue for 3 seconds.

Connecting your gaming mouse

Setting up your gaming mouse as a wired mouse

Connect the bundled USB Type-C* to Type-A cable to your gaming mouse and a USB port on your computer

Setting up your gaming mouse as a RF wireless mouse

1. Connect the USB dongle to a USB port on your computer.
2. Set the connection switch to the **RF 2.4G Wireless mode**.

Setting up your gaming mouse as a Bluetooth* wireless mouse

Set the connection switch to the **Bluetooth* mode**.

Pairing Bluetooth* mode to additional host devices (max. 3)

1. Set the connection switch to the **Bluetooth* mode**.
2. Press and hold the **Pairing** button for 3 seconds until the LED on your gaming mouse start to blink blue. Once your gaming mouse has been successfully paired, the LED indicator on your gaming mouse will light up blue for 3 seconds.

Updating the firmware and customization

1. Connect your gaming mouse to your computer using the bundled cable, then connect the USB dongle to a USB port.
2. Download and install the Armoury Crate software from <https://rog.asus.com>
3. Follow the software instructions to update your gaming mouse and dongle's firmware.
4. Customize your gaming mouse using Armoury Crate.

Using the DPI On-The-Scroll tuning function

The DPI On-The-Scroll tuning function allows you to customize the DPI of your gaming mouse without using Armoury Crate.

1. Press and hold the DPI button for 3 seconds until the LED on your gaming mouse light up.
2. Scroll the scroll wheel forwards or backwards to adjust the DPI. The LED color hue on your mouse will differ depending on the DPI adjustment.
3. Press the DPI button once you have finished customizing the DPI value to save the changes made.

Connecting your gaming mouse

Setting up your gaming mouse as a wired mouse

Connect the bundled USB Type-C* to Type-A cable to your gaming mouse and a USB port on your computer

Setting up your gaming mouse as a RF wireless mouse

1. Connect the USB dongle to a USB port on your computer.
2. Set the connection switch to the **RF 2.4G Wireless mode**.

Setting up your gaming mouse as a Bluetooth* wireless mouse

Set the connection switch to the **Bluetooth* mode**.

Pairing Bluetooth* mode to additional host devices (max. 3)

1. Set the connection switch to the **Bluetooth* mode**.
2. Press and hold the **Pairing** button for 3 seconds until the LED on your gaming mouse start to blink blue. Once your gaming mouse has been successfully paired, the LED indicator on your gaming mouse will light up blue for 3 seconds.

Connecting your gaming mouse

Setting up your gaming mouse as a wired mouse

Connect the bundled USB Type-C* to Type-A cable to your gaming mouse and a USB port on your computer

Setting up your gaming mouse as a RF wireless mouse

1. Connect the USB dongle to a USB port on your computer.
2. Set the connection switch to the **RF 2.4G Wireless mode**.

Setting up your gaming mouse as a Bluetooth* wireless mouse

Set the connection switch to the **Bluetooth* mode**.

Pairing Bluetooth* mode to additional host devices (max. 3)

1. Set the connection switch to the **Bluetooth* mode**.
2. Press and hold the **Pairing** button for 3 seconds until the LED on your gaming mouse start to blink blue. Once your gaming mouse has been successfully paired, the LED indicator on your gaming mouse will light up blue for 3 seconds.

Updating the firmware and customization

1. Connect your gaming mouse to your computer using the bundled cable, then connect the USB dongle to a USB port.
2. Download and install the Armoury Crate software from <https://rog.asus.com>
3. Follow the software instructions to update your gaming mouse and dongle's firmware.
4. Customize your gaming mouse using Armoury Crate.

Using the DPI On-The-Scroll tuning function

The DPI On-The-Scroll tuning function allows you to customize the DPI of your gaming mouse without using Armoury Crate.

1. Press and hold the DPI button for 3 seconds until the LED on your gaming mouse light up.
2. Scroll the scroll wheel forwards or backwards to adjust the DPI. The LED color hue on your mouse will differ depending on the DPI adjustment.
3. Press the DPI button once you have finished customizing the DPI value to save the changes made.

Updating the firmware and customization

1. Connect your gaming mouse to your computer using the bundled cable, then connect the USB dongle to a USB port.
2. Download and install the Armoury Crate software from <https://rog.asus.com>
3. Follow the software instructions to update your gaming mouse and dongle's firmware.
4. Customize your gaming mouse using Armoury Crate.

Using the DPI On-The-Scroll tuning function

The DPI On-The-Scroll tuning function allows you to customize the DPI of your gaming mouse without using Armoury Crate.

1. Press and hold the DPI button for 3 seconds until the LED on your gaming mouse light up.
2. Scroll the scroll wheel forwards or backwards to adjust the DPI. The LED color hue on your mouse will differ depending on the DPI adjustment.
3. Press the DPI button once you have finished customizing the DPI value to save the changes made.

Connecting your gaming mouse

Setting up your gaming mouse as a wired mouse

Connect the bundled USB Type-C* to Type-A cable to your gaming mouse and a USB port on your computer

Setting up your gaming mouse as a RF wireless mouse

1. Connect the USB dongle to a USB port on your computer.
2. Set the connection switch to the **RF 2.4G Wireless mode**.

Setting up your gaming mouse as a Bluetooth* wireless mouse

Set the connection switch to the **Bluetooth* mode**.

Pairing Bluetooth* mode to additional host devices (max. 3)

1. Set the connection switch to the **Bluetooth* mode**.
2. Press and hold the **Pairing** button for 3 seconds until the LED on your gaming mouse start to blink blue. Once your gaming mouse has been successfully paired, the LED indicator on your gaming mouse will light up blue for 3 seconds.

Updating the firmware and customization

1. Connect your gaming mouse to your computer using the bundled cable, then connect the USB dongle to a USB port.
2. Download and install the Armoury Crate software from <https://rog.asus.com>
3. Follow the software instructions to update your gaming mouse and dongle's firmware.
4. Customize your gaming mouse using Armoury Crate.

Using the DPI On-The-Scroll tuning function

The DPI On-The-Scroll tuning function allows you to customize the DPI of your gaming mouse without using Armoury Crate.

1. Press and hold the DPI button for 3 seconds until the LED on your gaming mouse light up.
2. Scroll the scroll wheel forwards or backwards to adjust the DPI. The LED color hue on your mouse will differ depending on the DPI adjustment.
3. Press the DPI button once you have finished customizing the DPI value to save the changes made.

Connecting your gaming mouse

Setting up your gaming mouse as a wired mouse

Connect the bundled USB Type-C* to Type-A cable to your gaming mouse and a USB port on your computer

Setting up your gaming mouse as a RF wireless mouse

1. Connect the USB dongle to a USB port on your computer.
2. Set the connection switch to the **RF 2.4G Wireless mode**.

Setting up your gaming mouse as a Bluetooth* wireless mouse

Set the connection switch to the **Bluetooth* mode**.

Pairing Bluetooth* mode to additional host devices (max. 3)

1. Set the connection switch to the **Bluetooth* mode**.
2. Press and hold the **Pairing** button for 3 seconds until the LED on your gaming mouse start to blink blue. Once your gaming mouse has been successfully paired, the LED indicator on your gaming mouse will light up blue for 3 seconds.

Updating the firmware and customization

1. Connect your gaming mouse to your computer using the bundled cable, then connect the USB dongle to a USB port.
2. Download and install the Armoury Crate software from <https://rog.asus.com>
3. Follow the software instructions to update your gaming mouse and dongle's firmware.
4. Customize your gaming mouse using Armoury Crate.

Using the DPI On-The-Scroll tuning function

The DPI On-The-Scroll tuning function allows you to customize the DPI of your gaming mouse without using Armoury Crate.

1. Press and hold the DPI button for 3 seconds until the LED on your gaming mouse light up.
2. Scroll the scroll wheel forwards or backwards to adjust the DPI. The LED color hue on your mouse will differ depending on the DPI adjustment.
3. Press the DPI button once you have finished customizing the DPI value to save the changes made.

