

macsra C4+ 110V User Manual

Product Description

1. Main Switch
2. Sub Switch
3. Power Cable
4. Set Button
5. Status LED
6. Outlet
7. Wireless Remote Controller

1 Feature

- macsra is a smart type energy saving surge protector. This makes not to waste your electricity by checking stand by power of each appliance accurately.
- When power of electric appliance is turned off, macsra would automatically censor the status, after that macsra will perfectly isolate the electric appliance from consent. Users do not have to manually plug out.
- Users may easily turn it on by wireless remote controller

2. Installation Guide

Chapter 1. Product / Components check

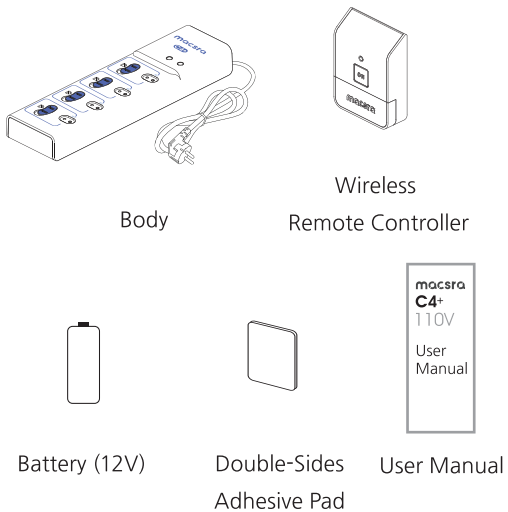

- When you lost or got damaged any of compo- nents, please contact Customer service.

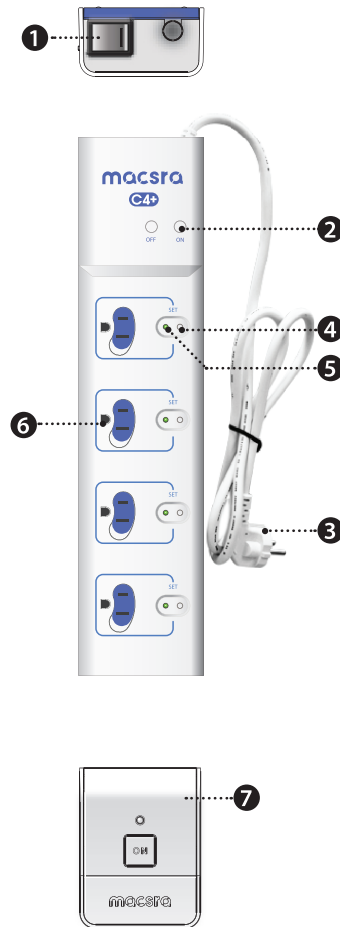

Chapter 2. Installation

- 1) Start macsra
 - Please connect macsra plug with consent then turn main switch to the "reset" side.

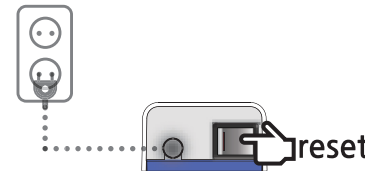

- 2) Connection with appliance
 - Put plugs you wish to use into outlet of macsra.

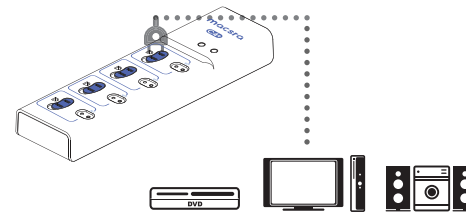

- Please make sure turning off of the appliances you wish to connect.

- 3) Standby Power Setting
 - Please push SET button for a second to memorize standby power of each appliance

LED will be flashed with beep sound. That means standby power setting is complete. Pleas proceed second, third and fourth outlet as same way.

When you would like to replace existing appliance into one outlet, please push SET button for two seconds to initialize before you set standby power of new one.

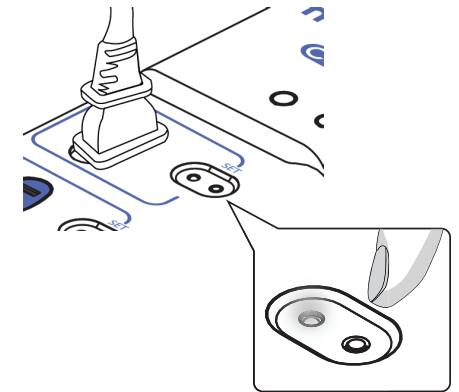

- Default setting of stand by power LED will be flashed with beep sound. That means standby power setting is complete. Pleas proceed second, third and fourth outlet as same way

- * When you would like to replace existing appliance into one outlet, please push SET button for two seconds to initialize before you set standby power of new one.

4) Fulltime Power Setting

- Full time power setting is available per user's choice. Please push SET button for more than three seconds. Make sure appliance

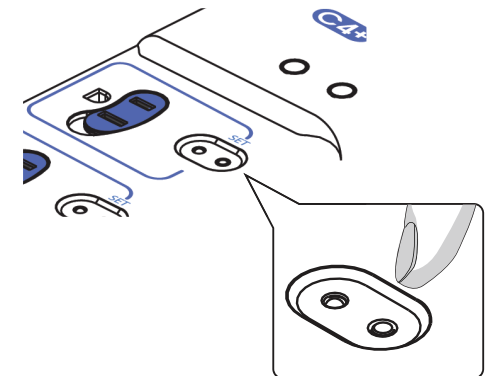

Chapter 3. Operation

- Users may free turn on macsra by wireless remote controller. (Radius 33ft.))

scene 1>

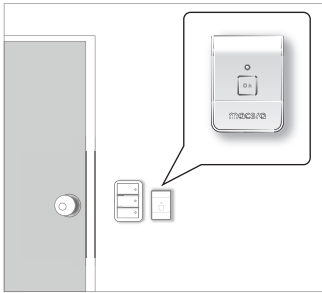

scene 2>

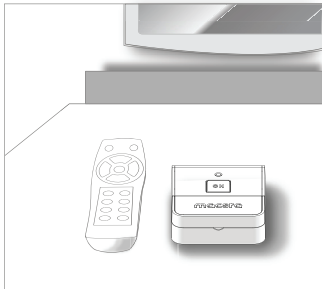

In case users lost their wireless remote controllers or the remote controller is out of order: There is a sub switch button on the product. Please push SW ON button to activate macsra. Also, please contact customer service to ask for wireless remote controller. (Customers shall take care of shipping cost and remote controller cost, unless the reason for delivery is due to defectiveness.

FCC Licensing Information

Part 15 Compliance

This equipment has been tested and found to comply with the limits for a Class B digital device, pursuant to part 15 of the FCC Rules. These limits are designed to provide reasonable protection against harmful interference in a residential installation.

This equipment generates, uses and can radiate radio frequency energy and, if not installed and used in accordance with the instructions, may cause harmful interference to radio communications. However, there is no guarantee that interference will not occur in a particular installation.

If this equipment does cause harmful interference to radio or television reception, which can be determined by turning the equipment off and on, the user is encouraged to try to correct the interference by one or more of the following measures:

- Reorient or relocate the receiving antenna.
- Increase the separation between the equipment and receiver.
- Connect the equipment into an outlet on a circuit different from that to which the receiver is connected.
- Consult the dealer or an experienced radio/TV technician for help.

FCC Licensing Requirements

A license from Federal Communications Commission is required prior to use. Your dealer will program each radio with your authorized frequencies, signaling codes, etc., and will be there to meet your communications needs as your system expands. Contact your dealer for more information.

Chapter 4. Specification

Product Name	Smart Grid Surge Protector Outlet
Origin	KOREA
Size	377*87*48mm(L*W*H)
Material	PC + ABS
Outlet	4 Outlets(Individual Outlet setting)
Power Rate	110V / 10A @60Hz
Maximum Standby Power SET Range	5mA ~ 1A
Outlet Power Consumption	0.4W
Remote Controller	Operational Range of Wireless Remote Controller: Radius 16ft Type of Battery : 12V
Cable Cord Length	5ft

3 Caution for Security

- Please do not drop the product into water or get wet.
- Please do not place the product at following location.
 - Location with a lot of moisture.
 - Nearby electric heat, which is more than 122 F
 - Parked car, which is exposed for a long time hot temperature.
- Please do not put sharp metals into outlet.
- Please do not give physical damage to the product. do not put heavy things on the outlet.
- Plugs should be out before cleaning. It's recommended to clean up by dried cotton. Do not apply benzene or thinner at the cotton.
- Please do not disassembly or assembly of the product by yourself. Maintenance fee will be invoiced during warranty period if the product got damaged by user's voluntary disassembly.
- When you verified any defective e components, please contact your customer service. Do not replace other cable line.
- Please grab plug, not cable, when you would like to plug out of outlet. Cable should be fully released. Please do not bundle or bind when in use.
- Should you need any technical assistance, Please contact customer service in below.

4 Customer Center

Address) 6900, College Blvd, STE850, Overland Park, KS66211
 Tel.) 913-469-6699, 1-913-6GSTUSA (Toll Free)
 Online) www.macsra.com
 Warranty: One year from the date purchased.

- Precaution for security: This document contains important contents to protect your security and preservation of your property. Please read this manual carefully before usage.
- All pictures in this document are for user's reference only. It might be slightly different from actual product.

Copyright@2009, GSInstruments, All rights reserved.

This is global
GSI

macsra G4 110V User Manual

Product Description

1. Main Switch
2. Sub Switch
3. Power Cable
4. Set Button
5. Status LED
6. Master Outlet
7. Slave Outlet
8. Remote Controller Connector
9. IR Sensor Wired Remote Controller

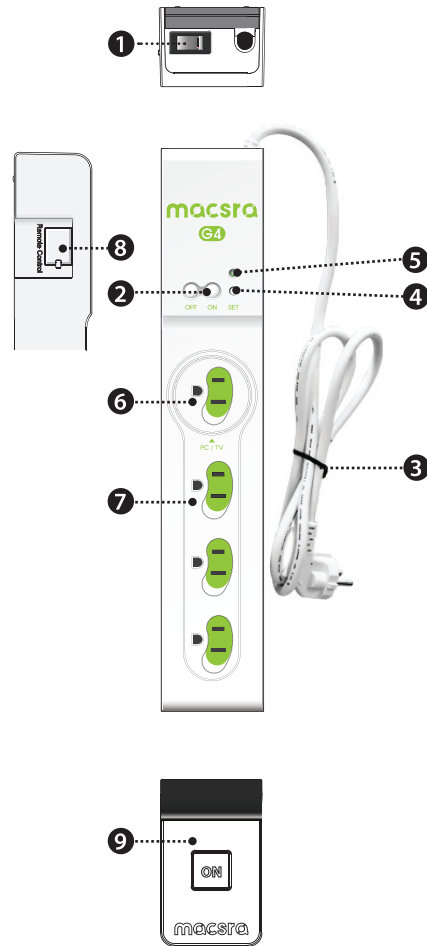

Chapter 2. Installation

- 1) Start macsra
 - Please connect macsra plug with consent then turn main switch to the "reset" side.

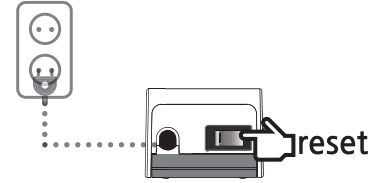

- 2) Connection with Appliance

- Put plugs you wish to use into outlet of macsra.

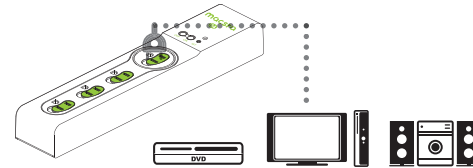

- Please make sure turning off of the appliances you wish to connect, before plugging in.

- 3) Standby Power Setting

- Please push SET button for a second to memorize power of each appliance.

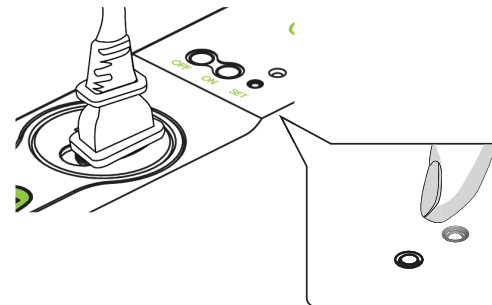

- LED will be flashed with beep sound. That means standby power setting is complete. At Master outlet port, only TV and PC body are interfaced. There is no limitation at Slave outlets.

- * At Master outlet port, only TV and PC body are interfaced. There is no limitation at Slave outlets.

Chapter 3. Operation

- Users may freely turn on macsra by wired remote controller. (Radius 33ft.) There is an IR censor, which is interfaced with various kinds of common remote controller, such as TV, DVD, Audio, etc., in remote controller, therefore you are able to turn on with common remote controllers.

scene 1>

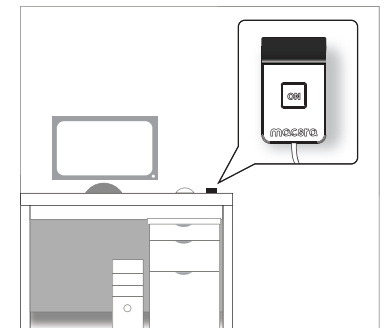

- When you lost or got damaged any of components, please contact Customer service.

1 Feature

- macsra is a smart type energy saving surge protector. This makes not to waste your electricity by checking stand by power of each appliance accurately.
- When power of electric appliance is turned off, macsra would automatically censor the status, after that macsra will perfectly isolate the electric appliance from consent. Users do not have to manually plug out.
- Users may easily turn it on by wireless remote controller

2 Product Description

Chapter 1. Product / Components Check

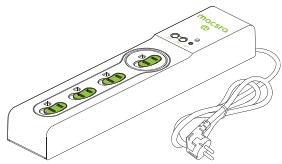

Body



IR SENSOR

Wired Remote controller



User Manual

scene 2>

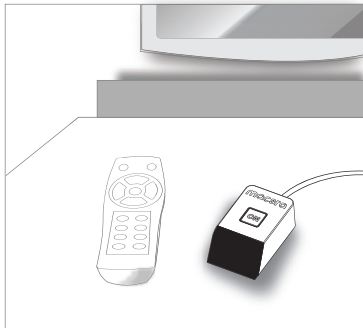

In case the remote controller is out of order:
 There is a sub switch button on the product.
 Please push SW ON button to activate macsra.
 Also, please contact customer service to ask for wireless remote controller. (Customers shall take care of shipping cost and remote controller cost, unless the reason for delivery is due to defectiveness.

Chapter 4. Specification

Product Name	Smart Grid Surge Protector Outlet
Origin	KOREA
Size	377*87*48mm(L*W*H)
Material	PC + ABS
Outlet	4 Outlets (1 Master / 3 Slaves Outlet setting)
Power Rate	110V / 10A @60Hz
Maximum Standby Power SET Range	5mA ~ 10A
Outlet Power Consumption (Outlet ON/OFF)	0.3W
Remote Controller	Operational Range of IR SENSOR Wired Remote Controller : 10ft
Cable Cord Length	5ft

- Please do not drop the product into water or get wet.
- Please do not place the product at following location.
 - Location with a lot of moisture.
 - Nearby electric heat, which is more than 122 F
 - Parked car, which is exposed for a long time hot temperature.
- Please do not put sharp metals into outlet.
- Please do not give physical damage to the product. do not put heavy things on the outlet.
- Plugs should be out before cleaning. It's recommended to clean up by dried cotton. Do not apply benzene or thinner at the cotton.
- Please do not disassembly or assembly of the product by yourself. Maintenance fee will be invoiced during warranty period if the product got damaged by user's voluntary disassembly.
- When you verified any defective e components, please contact your customer service. Do not replace other cable line.
- Please grab plug, not cable, when you would like to plug out of outlet. Cable should be fully released. Please do not bundle or bind when in use.
- Should you need any technical assistance, Please contact customer service in below.

Address) 6900, College Blvd, STE850, Overland Park, KS66211
 Tel.) 913-469-6699, 1-913-6GSTUSA (Toll Free)
 Online) www.macsra.com
 Warranty: One year from the date purchased.

- Precaution for security: This document contains important contents to protect your security and preservation of your property. Please read this manual carefully before usage.
- All pictures in this document are for user's reference only. It might be slightly different from actual product.

Copyright@2009, GSInstruments, All rights reserved.