

Home Screen                      Network

Step 12: Depend on how your files are stored in the memory card, you may need to go through several sub folder until you see your files.

Step 13: Once you see the list of your files, you can only select the and view still picture only.

**Note:** For Android device it will not play back avi video format.

**Using your desktop or laptop computer to connect**

If you don't have access to a portable device, you can use your desktop or laptop computer to connect to the WiFi unit to view your files.

1. From your computer's WiFi setting, search for your WiFi combo unit and enter pass code to connect.
2. Once connected, enter <http://192.168.168.1> on address bar of your browser and you will see below window.

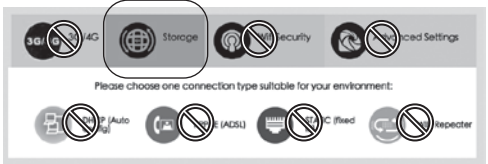

3. Use Storage Browse button to view your files on the memory card.
4. You may need to go through several folders until you see the list of your files.
5. For still image, you will see the image display right on your screen.
6. Depend on your computer configuration for video files you may or may not be able to view the files right on your screen. You may need to download the file.

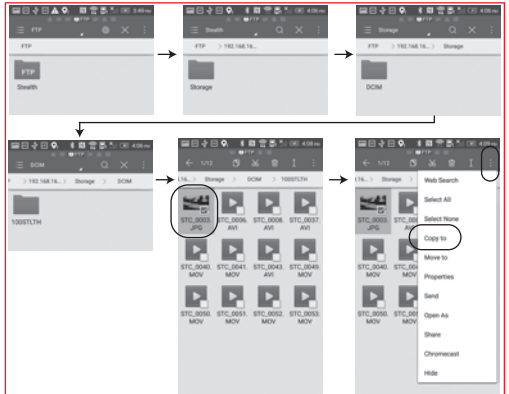

**Copy files to your local device**

1. From your file list, press and hold the file you want to copy. You'll see a small square on the bottom right hand corner of the file.
2. You can copy one file at a time or you can select multiple files to copy at the same time.
3. Once you made your selections, press menu on upper right corner then choose Copy To. Depend on the Android phone model, the location to copy the files to may vary.

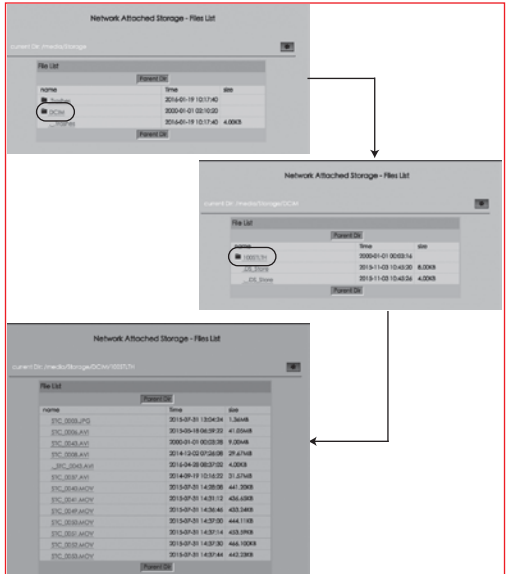

**Advance Function**

User can change the WiFi network name as well as the pass code to personalize the unit. This only works for iOS device.

1. Connect your WiFi unit to your portable device.
2. From Cloud Hub main page, select Router Settings.
3. Select WiFi Setting on the next screen.
4. Enter new SSID (network name).
5. Enter new Pass code (must consist combination of 8 letters or numbers)
6. Press Done.
7. Press Save on upper right hand corner of the screen.

Once everything is saved, power off the WiFi unit. Wait for 5 seconds and power on the WiFi unit back on. Follow step 4 above to reconnect your WiFi Unit to the new network name and enter the new pass code. Re-launch Cloud Hub App.

If you see this icon  next to the Router Settings or WiFi Disk that means the change in network name and/or pass code was not done correctly. Repeat from step 1 in this section.

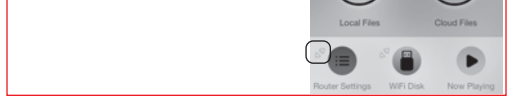

**FCC Statement**

This equipment has been tested and found to comply with the limits for a Class B digital device, pursuant to part 15 of the FCC rules. These limits are designed to provide reasonable protection against harmful interference in a residential installation. This equipment generates uses and can radiate radio frequency energy and, if not installed and used in accordance with the instructions, may cause harmful interference to radio communications. However, there is no guarantee that interference will not occur in a particular installation. If this equipment does cause harmful interference to radio or television reception, which can be determined by turning the equipment off and on, the user is encouraged to try to correct the interference by one or more of the following measures:

- Reorient or relocate the receiving antenna.
  - Increase the separation between the equipment and receiver.
  - Connect the equipment into an outlet on a circuit different from that to which the receiver is connected.
  - Consult the dealer or an experienced radio/TV technician for help.
- To assure continued compliance, any changes or modifications not expressly approved by the party. Responsible for compliance could void the user's authority to operate this equipment. (Example - use only shielded interface cables when connecting to computer or peripheral devices).

This equipment complies with Part 15 of the FCC Rules. Operation is subject to the following two conditions:

- (1) This device may not cause harmful interference, and
- (2) This device must accept any interference received, including interference that may cause undesired operation.

RF warning statement:  
The device has been evaluated to meet general RF exposure requirement. The device can be used in portable exposure condition without restriction.

**Use your WiFi unit as a power bank**

Your WiFi unit is equipped with a 3,000mAh Lithium battery that can be used as a power bank to charge your cell phone in emergency situation. Switch on the unit to Power Bank function. Connect one end of your charging cable to the USB port. Connect the other end to your mobile device. Your mobile device will start to charge immediately.

**Restore factory settings**

If for any reason, such as forgetting the password of the WiFi network, you can reset the unit back to original factory setting. "RESET" can only be done when your WiFi unit is powered ON

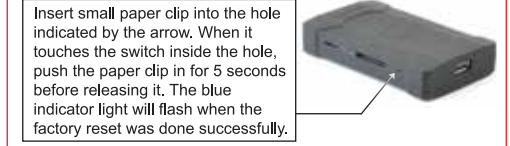

**Use your WiFi unit as a Card Reader**

To use as a standard card reader on PC via USB connection, the unit must be powered OFF.