

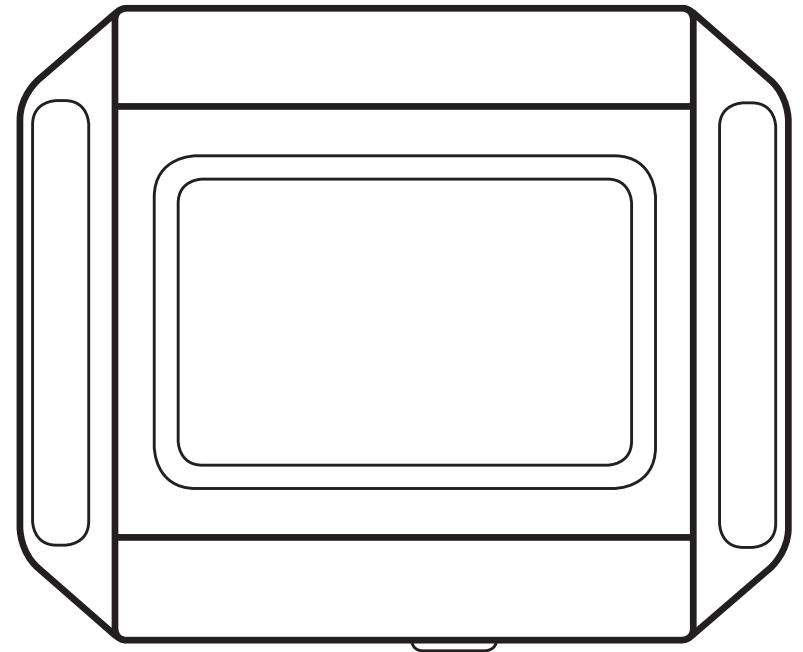

# PRODUCT MANUAL

2211-U

[beamLabs.io](https://beamLabs.io)



# TABLE OF CONTENTS

Congratulations on purchasing your beamUP garage door opener. It will provide you with many years of security, safety and convenience. This installation and owner's manual contains complete instructions for installing and operating your garage door opener.

For warranty registration  
**[beamLabs.io/warranty](https://beamLabs.io/warranty)**

Carton Contents.....	1	Enabling/Disabling Motion Sensing	
Before You Begin.....	2	Security Lighting .....	17
Preparation + Tools Needed .....	3	Connecting Standard Door Control .....	18
Rail Assembly .....	4	Travel Limit Adjustment – UP Limit .....	19
Rail and Power Head Assembly .....	5	Travel Limit Adjustment – DOWN Limit .....	20
Trolley and Pulley Assembly.....	6	Setting the Force .....	21
Installing Chain and Cable .....	7	Final Adjustments and Testing .....	22
Attaching Sprocket Cover .....	8	Handheld Remote Control .....	23
Mounting Header Bracket.....	9	Wireless Keypad .....	24
Attaching Rail and Mounting Door Bracket .....	10	beamUP Smart Garage Door Controller .....	25
Mounting Power Head to Ceiling .....	11	Using your Garage Door Opener .....	26
Attaching Door Arms .....	12	Troubleshooting.....	30
Emergency Release Handle .....	13	Maintenance .....	32
Connecting Photo Eye Safety System .....	14	Warranty .....	33
Connecting Power and Aligning Photo Eye Safety System .....	15	Spare Parts .....	37
Connecting Deluxe Door Control .....	16	Opener Assembly Parts .....	38

## CARTON CONTENTS



Garage Door Opener 2211-U



Clevis Pin



Hitch Pin



Flange Nut



Self-Threading  
Screw - 1/4" x 5/8"



Lag Screw  
5/16"-1/1/2"



Bolt  
5/16" - 18x1"



Anchors

## BEFORE YOU BEGIN

Measure door height.

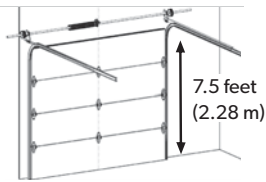

If over 7.5 feet (2.28 m),  
rail extension kit will be  
needed.

Check mounting  
locations.  
Are additional  
reinforcement material  
needed?



See page 3

Check your toolbox. Do  
you have all the tools  
needed?

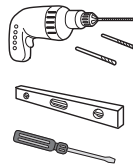

See page 3

**WARNING**



Child can be pinned under automatic garage door.  
**Death or serious injury can result.**

- Never let child walk or run under moving door.
- Never let child use door opener controls.
- Always keep moving door in sight.
- If person is pinned, push control button or use emergency release.
- Test door opener monthly:  
Refer to your owner's manual.  
Place a 1 1/2" object (or 2 x 4 laid flat) on floor.  
If door fails to reverse on contact, adjust opener.  
If opener still fails to reverse door, repair or replace opener.

Do not remove or paint over this label.  
Mount wall control out of child's reach  
(at least 5 feet above floor).

Place next to wall control.

QUS701A-1

## SAFETY INSTRUCTIONS



**WARNING**

To reduce the risk of severe injury or death:

1. READ AND FOLLOW ALL INSTALLATION INSTRUCTIONS.
2. Install only on a properly balanced garage door. An improperly balanced door has the potential to inflict severe injury. Have a qualified service person make repairs to cables, spring assemblies, and other hardware before installing the opener.
3. Remove all ropes and remove or make inoperative all locks connected to the garage door before installing opener.
4. Where possible, install the door opener 7 feet (2.13 m) or more above the floor. For products having an emergency release, mount the emergency release within reach, but at least 6 feet above the floor and avoiding contact with vehicles to avoid accidental release.
5. Do not connect the opener to source of power until instructed to do so.
6. Locate the control button: (a) within sight of door, (b) at a minimum height of 5 feet so small children are not able to reach it, and (c) away from all moving parts of the door.
7. Install the Entrapment Warning Label next to the wall-mount control button in a prominent location. In case the adhesive not adhere on the surface, the label should be attached to the by mechanicals means.
8. After installing the opener, the door must reverse when it contacts a 1-1/2 inch (3.8 cm) high object (or a 2x4 board) laid flat on the floor.

## PREPARE GARAGE DOOR FOR INSTALLATION TOOLS NEEDED

**DO NOT REUSE PARTS AND WIRING FROM AN OLD OPENER!!!**

### **BEFORE beginning installation:**

1. Disable locks and disengage trolley from current opener.
2. Perform the following door test to ensure your door is balanced and in good working condition.

Make sure garage door is fully closed before you start the installation

### **To test your garage door:**

1. Raise and lower the door to check if there is any sticking or binding.
2. Check for loose hinges, damaged rollers, frayed cables and damaged or broken springs.
3. Lift the door approximately halfway and release. The door should stay at that point under proper spring tension.

Call a qualified garage door service technician if your door binds, sticks or is unbalanced.

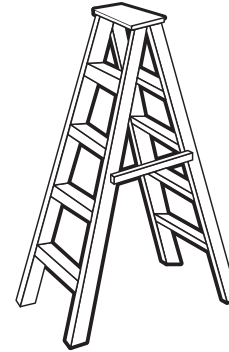
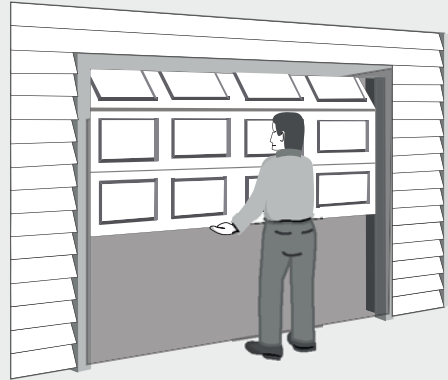

Step Ladder

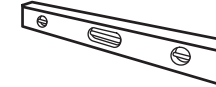

Level



Pencil

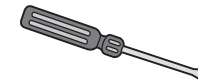

Screwdriver



Adjustable Wrench



Tape Measure



Pliers

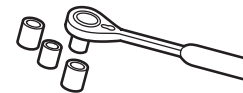

Ratchet with  
5/16", 7/16" and  
1/2" sockets

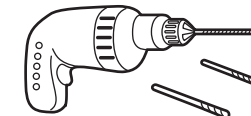

Drill 3/16" and  
5/16" Drill Bits

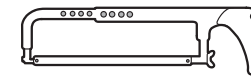

Hack Saw

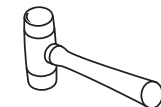

Rubber Mallet

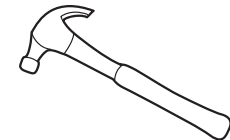

Hammer

## RAIL ASSEMBLY

### Look in the box for:

Rail – Header Segment



Rail – Middle Segments x3

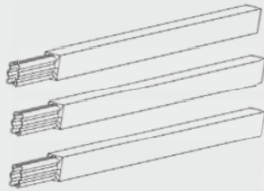

Rail – End Segments



### Tools needed:

Rubber Mallet

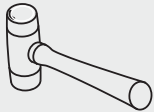

Connect rails starting with the rail header segment. To apply additional force tap gently on the end of the rail with a rubber mallet or on padded flooring.

1

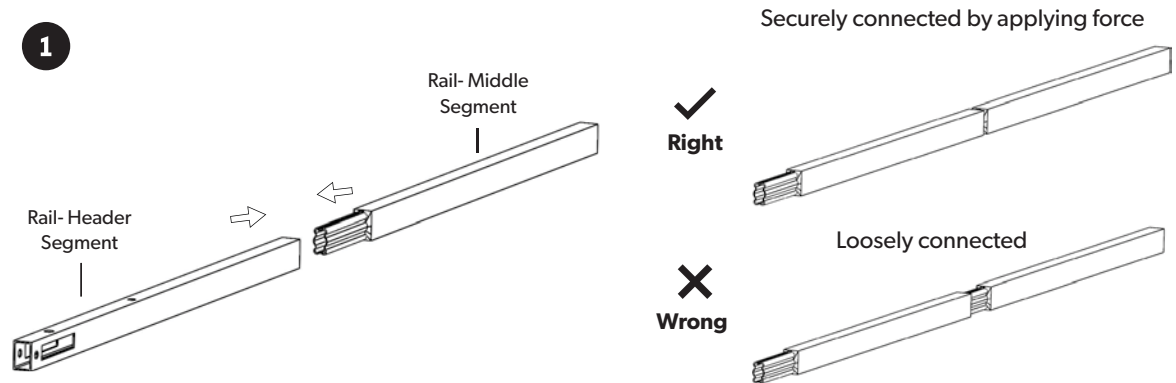

2

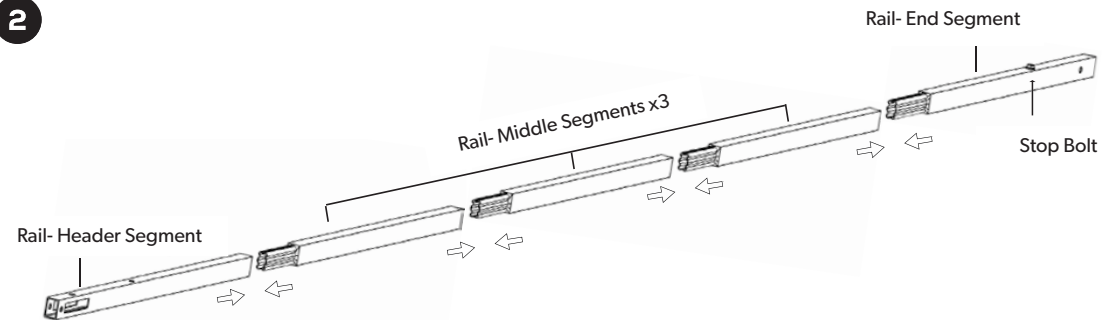

## RAIL AND POWER HEAD ASSEMBLY

### Look in the box for:

Garage Door Opener 2211-U

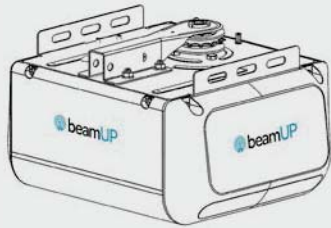

Opener Carton

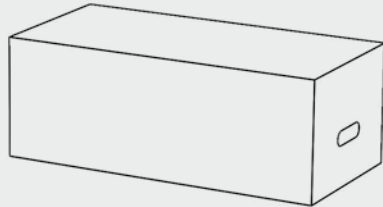

Clevis Pin  
3/8" x 1-3/4"



Hitch Pin



Use garage door opener carton to assemble rail to power head. Use packing material as protective base for power head.

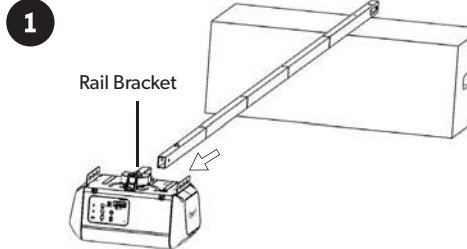

Align and slide rail into rail bracket as shown.

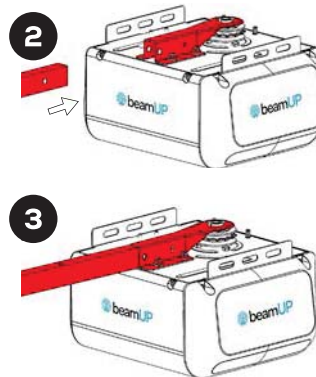

Insert clevis pin into rail bracket as shown.

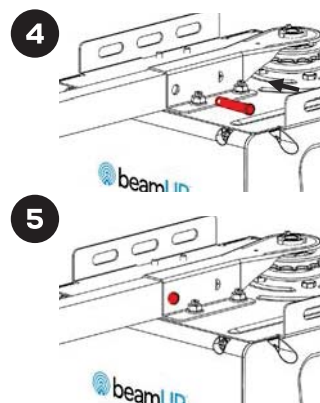

Insert hitch pin into clevis pin as shown.

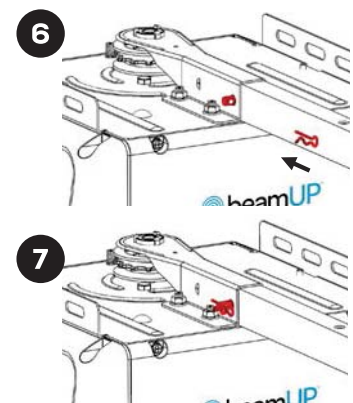

## TROLLEY AND PULLEY ASSEMBLY

Look in the box for:

Trolley

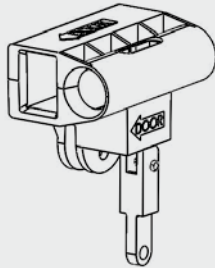

Pulley

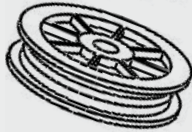

Clevis Pin  
3/8" x 1-3/4"



Hitch Pin



Slide Trolley onto the rail. Make sure the arrow on the trolley points toward the door.

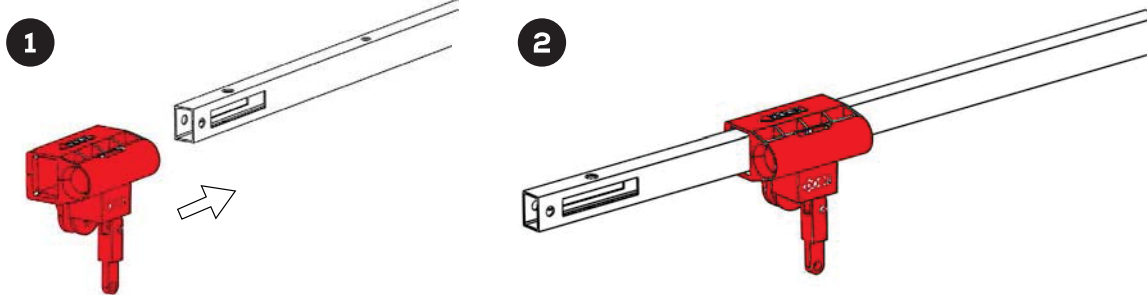

Insert pulley into the rail slot.

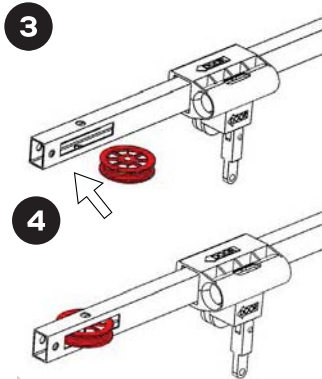

Insert clevis pin through rail hole and pulley.

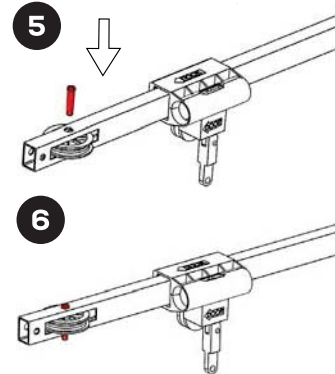

Insert hitch pin into clevis pin.

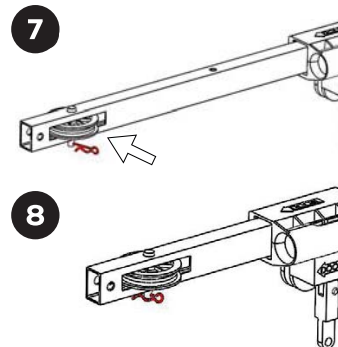



# INSTALLING CABLE AND CHAIN

## Look in the box for:

Chain/Cable Assembly

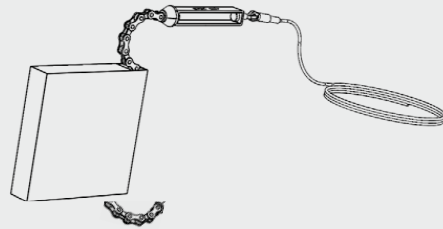

Master Link

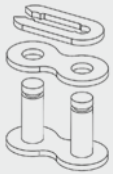

## ⚠ WARNING

To prevent SERIOUS INJURY:

- DO NOT connect power until instructed.
- Keep hands and fingers clear from sprocket during operation.
- Wear gloves when installing chain and cable.
- Keep hands and fingers away from joints and possible sharp edges.



Align end of chain around sprocket and extend chain past chassis. Pull chain with box along the rail towards trolley and then remove box.

1

Chassis

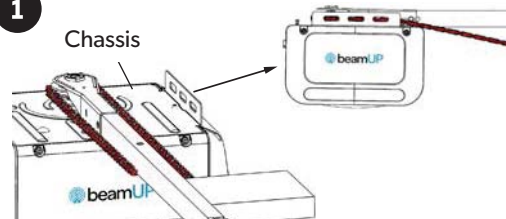

2



Insert cable through circular hole in trolley. Pull cable through pulley slot and toward power head.

3

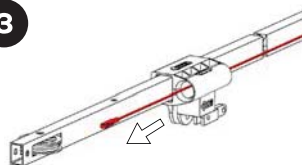

4

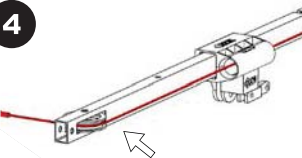

Pull trolley lock lever down to unlock. Insert trolley shaft into trolley. Lock trolley shaft in trolley by pulling lever back up.

5

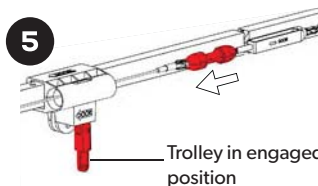

Trolley in engaged position

6

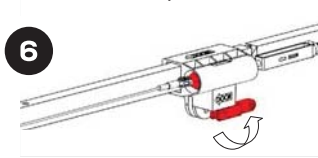

Bring cable and chain together and connect cable and chain with master link.

7

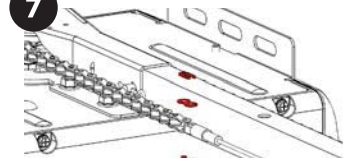

8

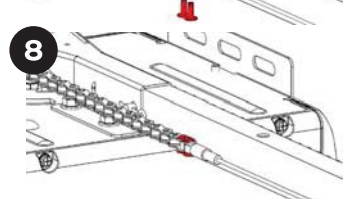

## INSTALLING CABLE AND CHAIN/ATTACHING SPROCKET COVER

Look in the box for:

Sprocket Cover

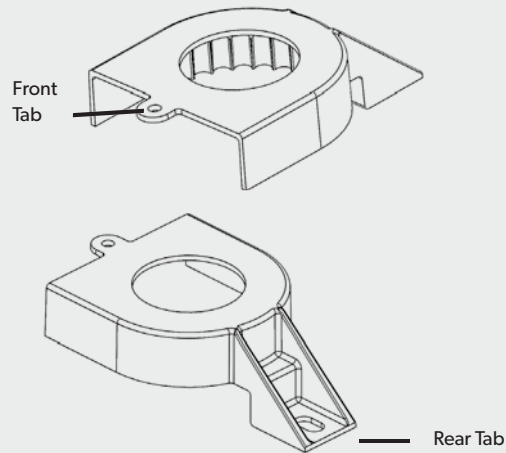

Self-Threading  
Screw - 1/4" x 5/8"

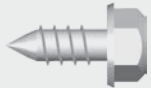

Flange Nut



Turn chain-to-cable connector on trolley shaft until chain is about 1/4 inch (.64 cm) above the base of rail.

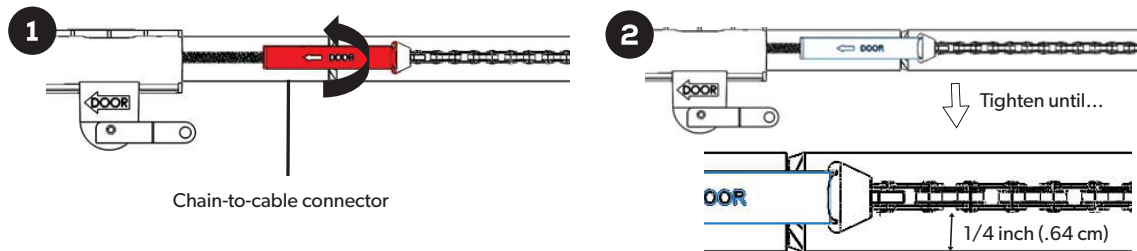

Attach sprocket cover to power head.

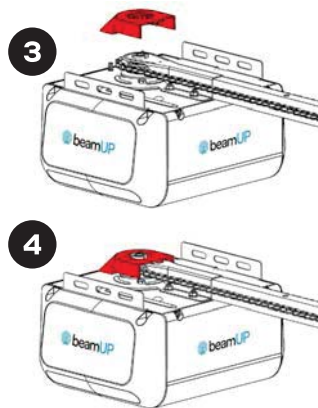

Fasten rear tab with flange nut on top of steel chassis.

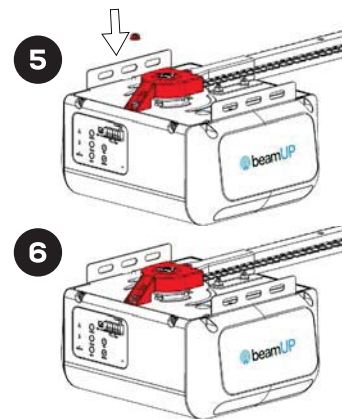

Fasten front tab with self-threading screws to hole on top of steel chassis.

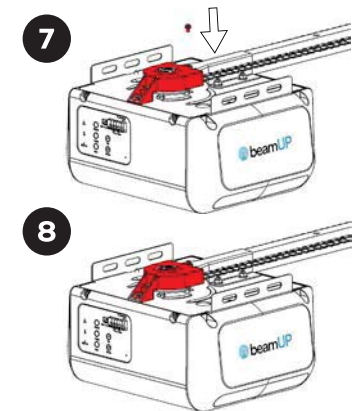

# MOUNTING HEADER BRACKET

## Look in the box for:

Header Bracket

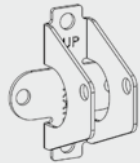

2 x Lag Screw  
5/16" x 1-1/2"



## ⚠ WARNING



To prevent **SERIOUS INJURY**:

- DO NOT connect power until instructed.
- The header bracket **MUST** be **SECURELY** fastened to the structural support on the mounting wall or ceiling, otherwise other door may not reverse when required. DO NOT install the header bracket over drywall.
- Concrete anchors **MUST** be used when mounting the header bracket into masonry.
- NEVER try to loosen, move or adjust garage door springs, cables, pulleys, brackets, or hardware.
- Contact a qualified garage door service technician if your door binds, sticks or is unbalanced. An unbalanced door might not reverse when required.

Above door, mark the center line of the door with a pencil, through wall. Open door to the highest point of travel.

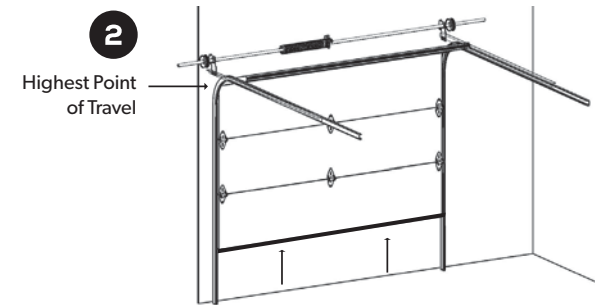
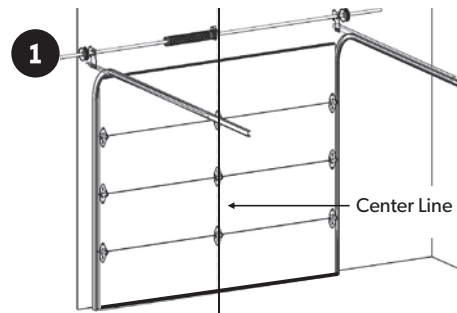

Take a level, measure and mark highest point of the door on the wall. Raise level to clear torsion bar if required, then mark highest point.

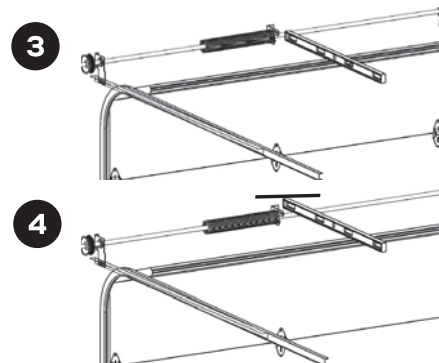

Measure 2-1/4 inch (5.7 cm), mark two holes of header bracket. Drill two holes and fasten header bracket using screws.

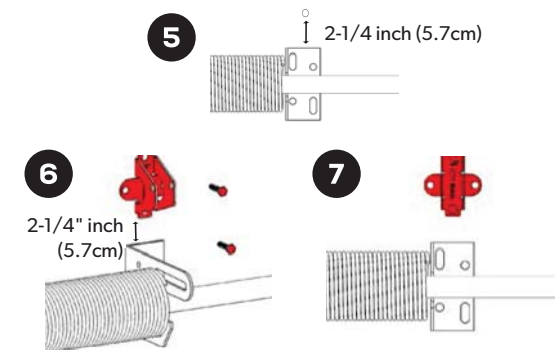

# ATTACHING RAIL AND MOUNTING DOOR BRACKET

## Look in the box for:

Hitch Pin



Clevis Pin  
3/8" x 1-3/4"



Door Bracket

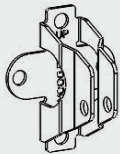

2 x Self-Threading  
Screw - 1/4" x 5/8"



## CAUTION!

To prevent **SERIOUS INJURY**:

- DO NOT connect power until instructed.
- REINFORCEMENT is recommended for fiberglass, aluminum or lightweight steel garage doors BEFORE installing the door bracket. Contact your door manufacturer for reinforcement options.



Use garage door opener carton to support power head. Rail return pulley end should be pointing to header bracket.

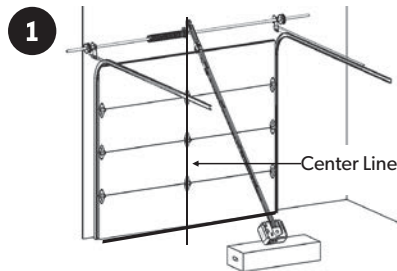

Align header rail hole to header bracket hole.

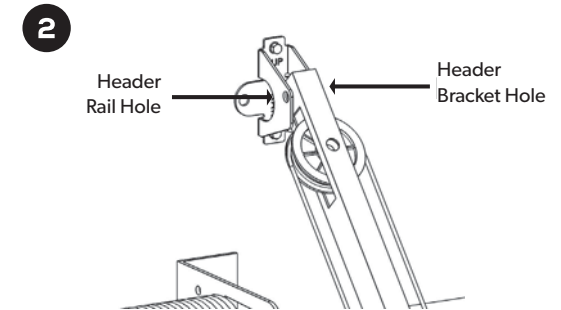

Connect header rail and header bracket with clevis pin and secure with hitch pin.

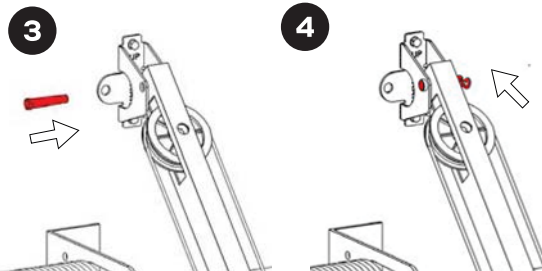

Position door bracket on centerline of the top garage door panel. Door bracket should be 2-4 inches (5-10 cm) below the top edge of door panel.

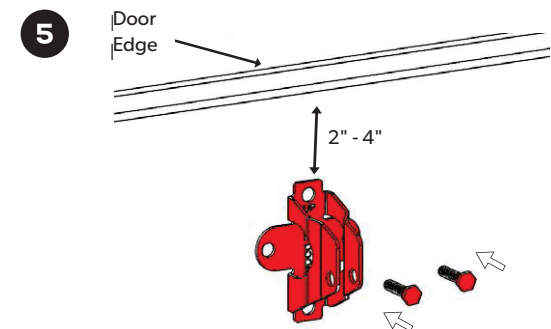

# MOUNTING POWER HEAD TO CEILING

Need rewritten text

## Look in the box for:

4 x Lag Screw  
5/16" x 1-1/2"



4 x Bolt  
5/16" - 18 x 1"

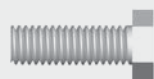

4 x Flange Nut



Hanging Brackets  
(not supplied)



## WARNING

To prevent SERIOUS INJURY:

- DO NOT connect power until instructed.
- Install the opener at least 7 feet (2.13m) above the floor.
- Fasten the opener SECURELY to STRUCTURAL SUPPORT of the garage to prevent falling.
- If installing brackets to masonry, concrete anchors (not provided) MUST be used.



Raise power head and place it on top of step ladder. Position and align power head with rail assembly to centerline.

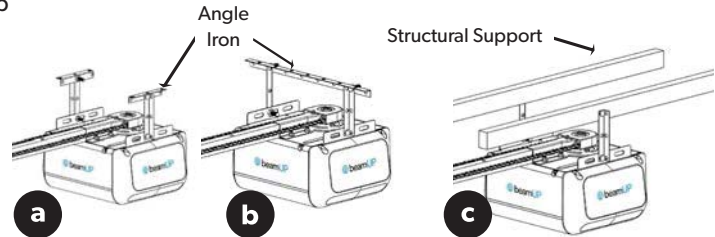

Three most common installation options. Determine the mounting option that works best for you.

Fasten angle iron to stud under a finished ceiling. Raise power head to measure distance from each side, rail must be horizontal.

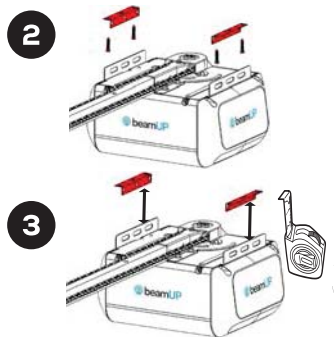

Cut both hanging brackets to appropriate length. Secure opener from each side to hanging brackets with 5/16" x 1 bolt.

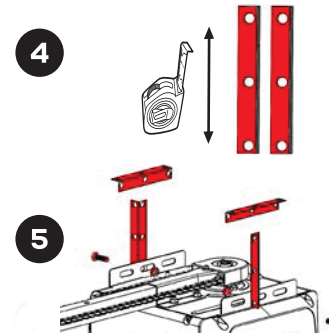

Raise power head and secure one end of each hanging bracket to angle iron with 5/16" x 1 bolt. Open door manually to check clearance between highest point of travel of door and rail.

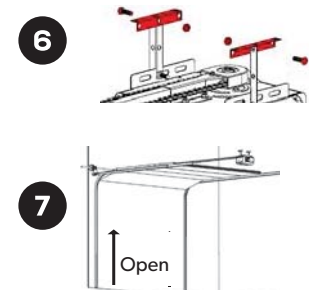

# ATTACHING DOOR ARMS

## Look in the box for:

Curved Door Arm



Straight Door Arm



2 x Hitch Pin



2 x Clevis Pin  
3/8" x 1"



2 x Bolt  
5/16" - 18 x 1"

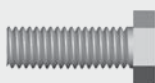

2 x Flange Nut



## WARNING

To prevent **SERIOUS INJURY**:

- DO NOT connect power until instructed.
- Keep hands and fingers away from the sprocket during operation.
- Wear gloves when installing chain/belt and cable.
- Keep hands and fingers away from joints and possible sharp edges.



Close your garage door and disengage trolley. Fasten curved door arm to the door bracket with 5/16" x 1" clevis pin and secure with hitch pin.

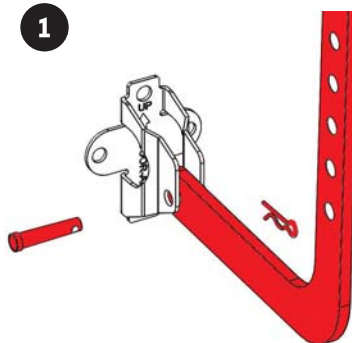

Fasten straight door arm to trolley with a 5/16" x 1" clevis pin and secure with hitch pin.

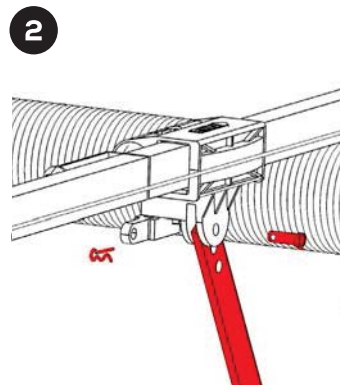

Attached door arms fasten with two 5/16" bolts and flange nuts. Bring straight and curved door arm together. Find two pairs of holes that line up and join sections with two 5/16" bolts and flange nuts. Select holes as far apart as possible to increase door arm rigidity.

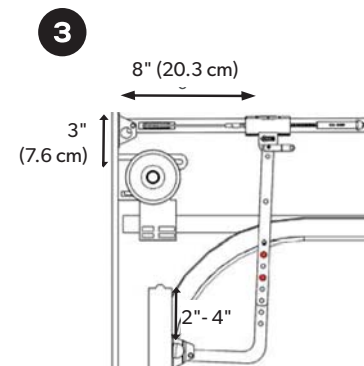



# INSTALLING EMERGENCY RELEASE HANDLE

## Look in the box for:

Emergency Release Handle



## **WARNING**

To prevent SERIOUS INJURY:

- In case of power outage or door obstruction, **PULL EMERGENCY HANDLE** to release door from opener.
- When trolley is disengaged, (trolley level pointing down) door can be operated manually.
- To engage, flip the trolley lever up so it is horizontal. Trolley will automatically re-engage when garage door opener is activated.
- **DO NOT** use emergency handle to pull the door open or close.



## \* **VERY IMPORTANT!** \*

Emergency release handle must clear all vehicles. An Emergency release handle set too low may get caught by the vehicle and cause damage to the opener. Measure from the floor to the top of your vehicle and set the emergency release handle above this measurement.

Thread end of rope through handle and secure with an over hand knot. Thread end of the rope through hole in trolley lever.

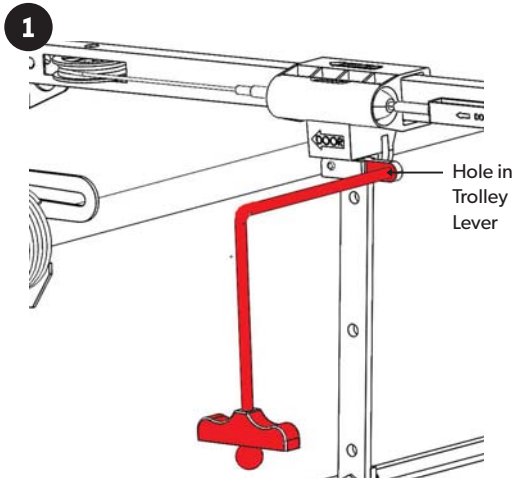

Measure rope length so the handle is 6 feet (183 cm) above the floor and is clear from the top of your vehicle. Secure with a overhand knot.

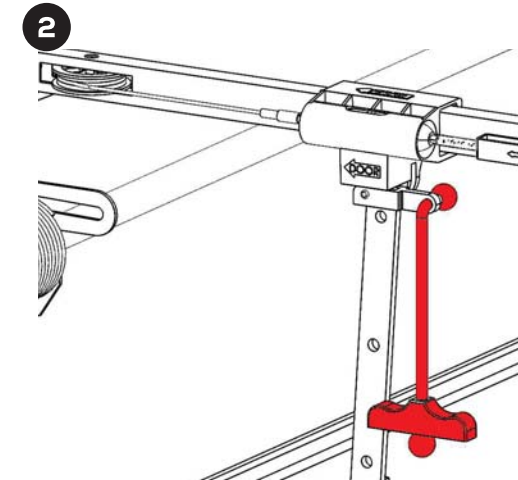

# CONNECTING PHOTO EYE SAFETY SYSTEM

## Look in the box for:

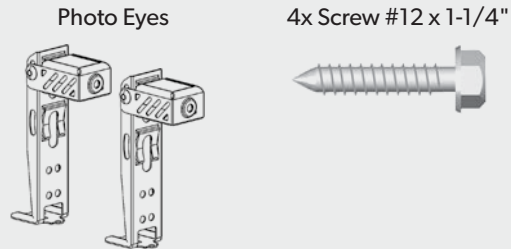

## ⚠ WARNING

To prevent **SERIOUS INJURY** or **DEATH** from electrocution:

- Power **MUST NOT** be connected until instructed.
- The garage door opener will not operate until the photo eye safety system is properly connected and aligned.
- Install the photo eye safety system **NO** higher than 6" (15 cm) above the floor.
- No part of garage door or other objects should obstruct the photo eye safety system during door-closing.

## Mount photo eyes.

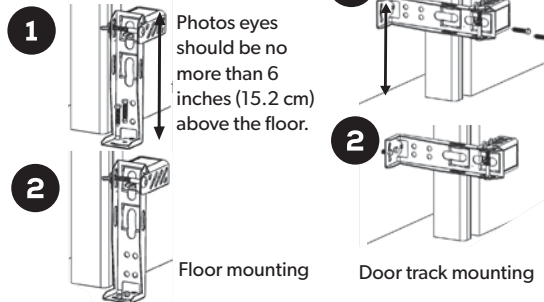

Run wire to head. Use insulated staples to secure photo eyes' wire to wall or ceiling. Be careful not to damage the wires while securing staples.

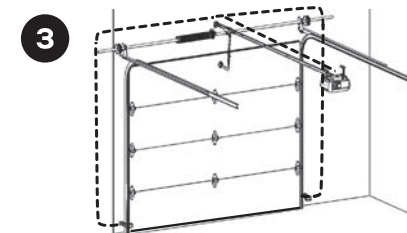

## \* VERY IMPORTANT! \*

Strip 7/16 inch (1 cm) of insulation from the end of the wire.

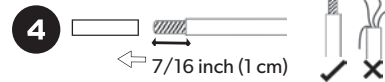

Each pair of terminals **MUST** be connected with one white wire and one striped wire (non-polarized) from the **SAME** accessory.

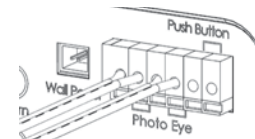

Cut and discard excess wire. Use small flat head screwdriver to push in orange tab on the wire terminal, insert 1/2 inch (1.2 cm) of the wire into the terminal while pushing in the tab. Connect wires to power head.

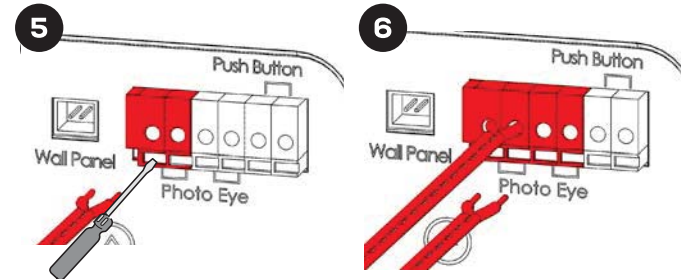



# CONNECTING POWER AND ALIGNING PHOTO EYE SAFETY SYSTEM

## **WARNING**



To prevent **SERIOUS INJURY** or **DEATH** from electrocution or fire:

- Power **MUST** be **DISCONNECTED BEFORE** proceeding with permanent wiring procedures.
- Garage door opener installation and wiring **MUST** be in compliance with all local electrical and building codes. Make sure the opener is **ALWAYS** grounded.
- **NEVER** use an extension cord, 2-wire adapter or modify the power plug in any way to make it fit the outlet.

To prevent **SERIOUS INJURY** or **DEATH** from a closing garage door:

- The photo eye safety system **MUST** be installed **BEFORE** connecting power.
- The photo eye safety system **MUST** be properly connected and aligned **BEFORE** operating the opener.

## **\* DO NOT OPERATE OPENER AT THIS TIME \***

Plug power head into a grounded outlet **ONLY**. If there is no grounded outlet present, call a qualified electrician to replace the outlet. Use of a surge protector is highly recommended.



## **For Permanent Wiring ONLY**

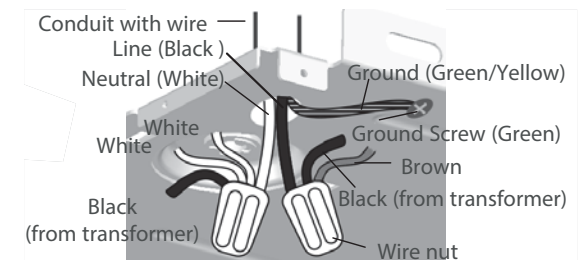

When the photo eye safety system is properly aligned green LED (emitter) will emit a steady green light and the red LED (sensor) will emit a steady red light. The path of the invisible light beam **MUST NOT** be obstructed. No part of the garage door or any hardware should interfere or block either sensor.

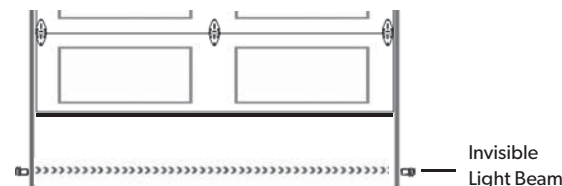

Green LED (emitter) will flash until it is aligned with red LED (sensor). Red LED will not illuminate until it is aligned with Green LED.

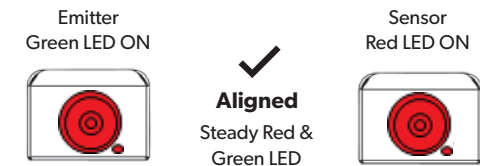

The emitter generates the invisible light beam, and the sensor receives the invisible light beam.

## CONNECTING DELUXE DOOR CONTROL (BU400, BU800)

### Look in the box for:

Deluxe Door Control\*



2x Screw #6 x 1-3/8"



2x Drywall Anchors

[New Image]

### **WARNING**

To prevent **SERIOUS INJURY**:

- DO NOT connect power until instructed.
- install the garage door opener at least 7 feet (2.13 m) above the floor.
- Fasten the power head **SECURELY** to **STRUCTURAL SUPPORTS** of the garage to prevent falling.
- If installing brackets to masonry, concrete anchors (not provided) **MUST** be used.



Wire deluxe door control to power head as shown.

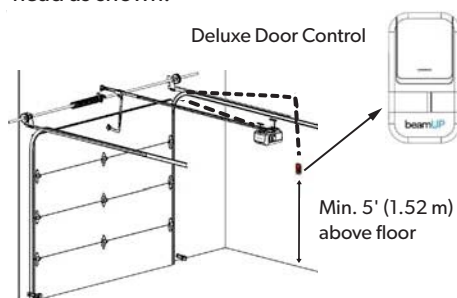

1. Strip 7/16 inch (11 mm) of insulation from wire and separate wires.
2. Connect one wire to each of the two screws on the back of the door control. **\*\*DO NOT USE PRE-EXISTING WIRE\*\***
3. Mark the location of bottom mounting hole and drill 5/32 inch hole.
4. Install the bottom screw and allow 1/8 inch (3 mm) to protrude from wall. Note: Use anchors if mounting to drywall.

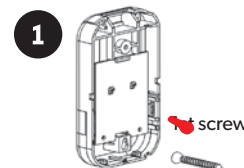

Connect plug from deluxe door control to wall panel outlet on the back panel of the power head.

**\*\*If using pre-existing wire you may cut off plug and splice to existing wire\*\***

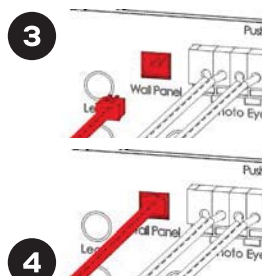

Using the deluxe door control (ONLY after programming has been completed).



Door – Press and release to open/close the door



Light – Press and hold to activate/deactivate motion sensing security lighting



Vacation Lock

Unlock – Slide lock button to the right to enable all remotes, door control, and accessories.



Lock – Slide lock button to the left to disable all remotes, door control, and accessories.

## MOTION ACTIVATED SECURITY LIGHTING (BU400, BU800)

Need images

Security lighting is activated and remains on for 4.5 minutes when garage door opener is operated.

Motion sensing is turned on by default and will activate security lighting when motion is detected within the garage. Security lighting will remain illuminated for 4.5 minutes or for as long as there is motion in the garage.

To deactivate motion sensing: Press and hold "LIGHT" button for 2 seconds. The power head will beep once to indicate motion sensing has been deactivated.

To active motion sensing: Press and hold "LIGHT" button for 2 seconds. The power head will beep 3x to indicate motion sensing has been activated.

## CONNECTING STANDARD DOOR CONTROL (BU100)

### Look in the box for:

Standard Door Control\*

2x Screw #6 x 1-3/8"



2x Drywall Anchors

[New Image]



### WARNING

To prevent SERIOUS INJURY:

- DO NOT connect power until instructed.
- Install the opener at least 7 feet (2.13m) above the floor.
- Fasten the power head SECURELY to STRUCTURAL SUPPORTS of the garage to prevent falling.
- If installing brackets to masonry, concrete anchors (not provided) MUST be used.



Wire standard door control to opener as shown.

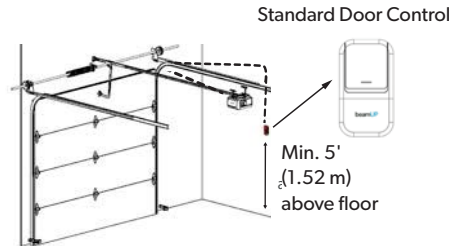

1. Strip 7/16 inch (11 mm) of insulation from wire and separate wires.
2. Connect one wire to each of the two screws on the back of the door control. **\*\*DO NOT USE PRE-EXISTING WIRE\*\***
3. Mark the location of bottom mounting hole and drill 5/32 inch hole.
4. Install the bottom screw and allow 1/8 inch (3 mm) to protrude from wall. Note: Use anchors if mounting to drywall.

1

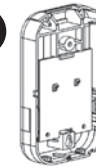

1st screw

2



Connect the wire from the standard door control to the push button terminal on the rear panel of the power head.

**\*\*If using pre-existing wire you may cut off plug and splice to existing wire\*\***

3

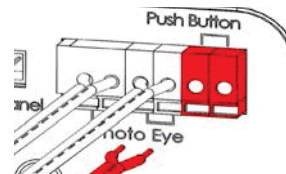

4

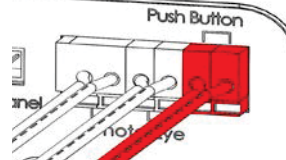

## TRAVEL LIMIT ADJUSTMENT - UP LIMIT

Need text from up down limit 110518 PDF

### **WARNING**

To prevent **SERIOUS INJURY** or **DEATH** from improper Force Adjustment:



- YOU CANNOT adjust force manually to compensate for binding or sticking of the garage door. Call a qualified garage door service person to make necessary adjustments in case of binding.
- YOU CANNOT manually increase the force required for closing the door.
- After ANY adjustments, Safety Reverse Test **MUST** be performed to ensure the door reverses on contact with a 1.5 inch (3.8 cm) high object (2x4 laid flat).

Press and Release LIMIT button once, green light (UP) will turn on. With green light on, press and hold UP button, the door will go UP to the desired UP limit position.

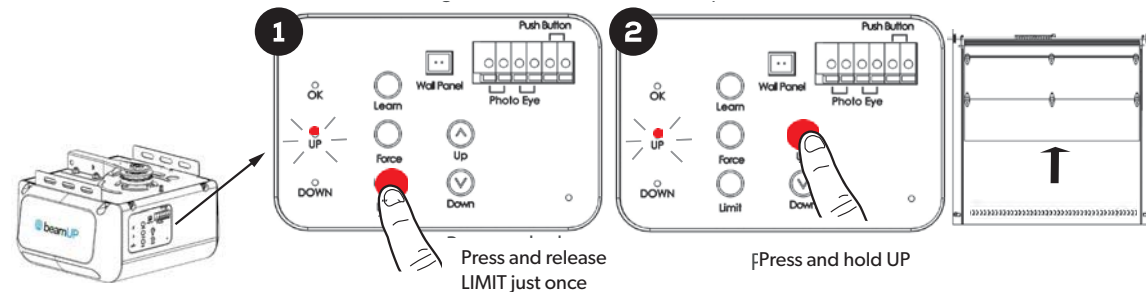

### **\* DO NOT HIT STOP BOLT \***

There should be a minimum 2 inch (5 cm) gap between trolley and stop bolt.

Minimum 2 inch (5 cm) gap

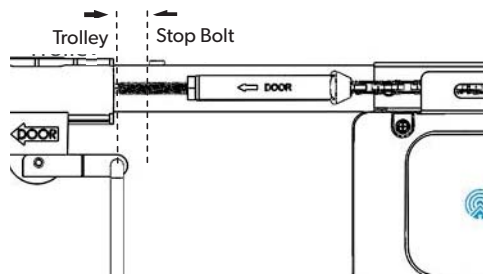

Once the door is at the desired UP limit position, press and release "LIMIT" button once, "OK" indicator (orange) flashes and turns off. The UP limit is set.

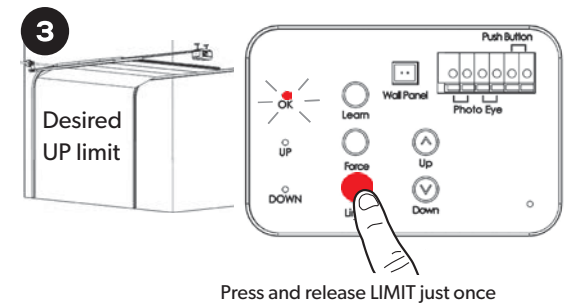

## TRAVEL LIMIT ADJUSTMENT - DOWN LIMIT

Need text from up down limit 110518 PDF

### WARNING

To prevent SERIOUS INJURY or DEATH from improper Force Adjustment:

- YOU CANNOT adjust force manually to compensate for binding or sticking of the garage door. Call a qualified garage door service person to make necessary adjustments in case of binding.
- YOU CANNOT manually increase the force required for closing the door.
- After ANY adjustments, Safety Reverse Test MUST be performed to ensure the door reverses on contact with a 1.5 inch (3.8 cm) high object (2x4 laid flat).



Press and Release LIMIT button TWICE, red light (DOWN) will turn on. With red light on, press and hold DOWN button, the door will travel down, to the desired DOWN limit position

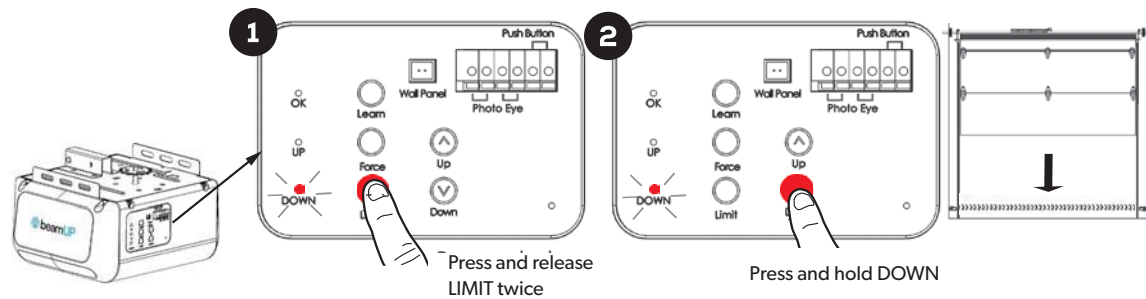

Once the door is at the desired DOWN limit position, press and release "LIMIT" button once, "OK" indicator (orange) flashes and turns off. The DOWN limit is set.

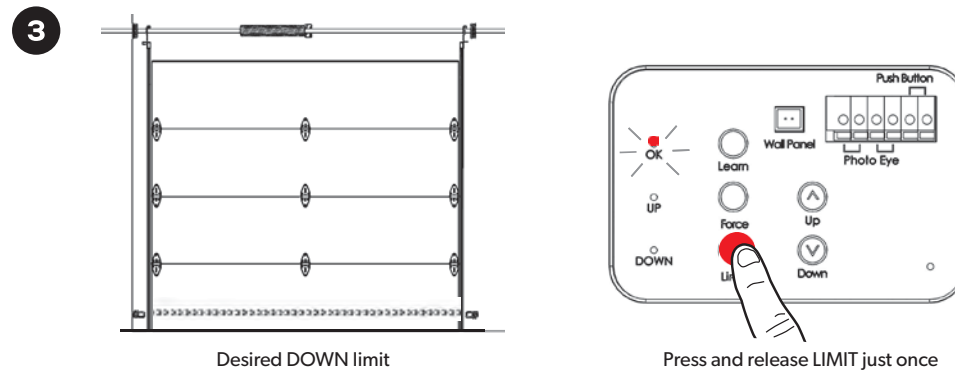

## SETTING THE FORCE

### **WARNING**

To prevent **SERIOUS INJURY** or **DEATH** from improper Force Adjustment:

- YOU CANNOT adjust force manually to compensate for binding or sticking of the garage door. Call a qualified garage door service person to make necessary adjustments in case of binding.
- YOU CANNOT manually increase the force required for closing the door.
- After ANY adjustments, Safety Reverse Test **MUST** be performed to ensure the door reverses on contact with a 1.5" (3.8 cm) high object (2x4 laid flat).



With both UP and DOWN lights on, press and release the **FORCE** button once to enter Auto Force Setting.

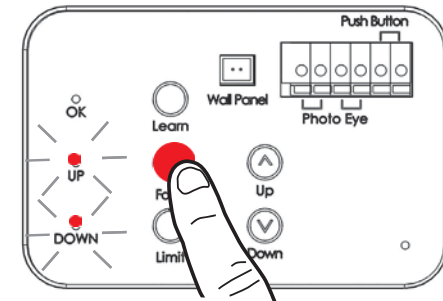

The door will travel **UP** automatically.

**1**

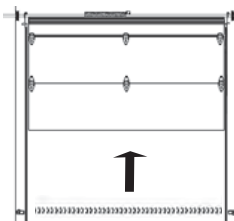

Stop at UP limit for 2 seconds.

**2**

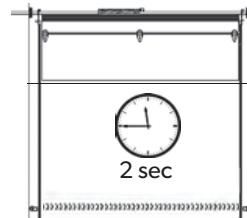

Door will then travel **DOWN** automatically.

**3**

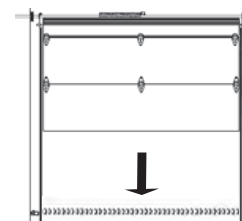

And stop at down limit. **OK** indicator (orange) will flash with beeps, Auto Force Setting is completed.

**4**

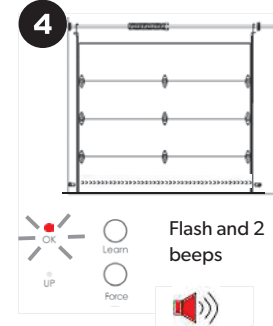

## FINAL ADJUSTMENTS AND TESTING

### **WARNING**



To prevent **SERIOUS INJURY** or **DEATH** from a closing garage door:

- The Safety Reversal Test **MUST** be conducted **ONCE A MONTH**.
- **NO ONE** should cross the path of moving door during operation and/or testing.
- After **ANY** adjustments to the door system, the Safety Reverse Test **MUST** be performed to ensure the door reverses on contact with a 1-1/2 inch (3.8 cm) thick (2x4 laid flat) object.
- The Photo Eye Safety System **MUST** be properly aligned, and tested regularly.

Open door using door control.

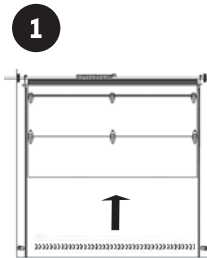

Place a 1-1/2 inch (3.8cm) flat solid object on the floor, centered under the garage door.

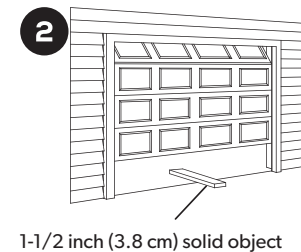

Use Door Control to close door. Door **MUST REVERSE** and beep within 1.5 seconds upon striking the object, and stop at the fully open position. Use door control or remote to close door. Door **MUST reverse\*** upon making contact with the object.

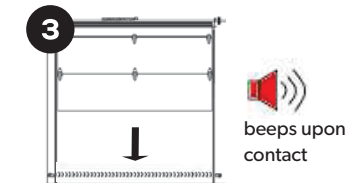

1. Open the door by using the door control.
2. Make sure photo eye safety system are aligned with both the red and green LEDs illuminated. If not, refer back to page 14. Place the garage door opener carton in the path of the door.
3. Keeping the door in sight press the door control or remote control to close the door  
Door should **NOT** move more than 1 inch (2.5 cm) and the garage door opener will beep and flash 20 times.

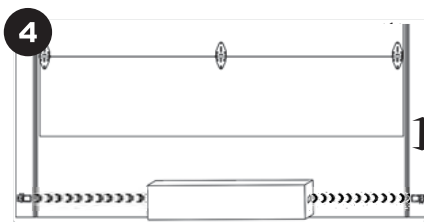

Emitter



Green LED  
Flashes

Sensor



Red LED  
OFF

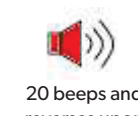

20 beeps and  
reverses upon  
obstruction



## SPARE PARTS

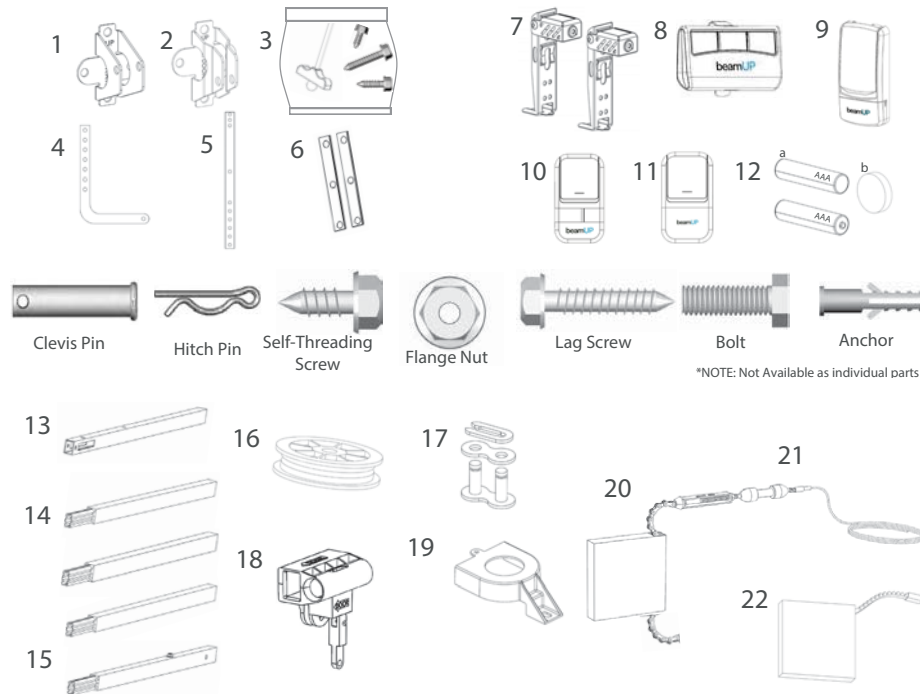

		BU100	BU400	BU800	
#	Name/Description	Part # No. de	Part # No. de	Part # No. de	Nombre/Descripción
	INSTALLATION PARTS				PARTES DE INSTALACION
1	Header Bracket	RP-007	RP-007	RP-007	Soporte Cabecero
2	Door Bracket	GUAT-022	GUAT-022	GUAT-022	Soporte de la Puerta
	Hardware Bag/Emergency				Bolsa de Instalación/Manija de
3	Release Handle	RP-008	RP-008	RP-008	Desconexión de Emergencia &
4	Curved Door Arm	GUAT-024	GUAT-024	GUAT-024	Cuerda
5	Straight Door Arm	GUAT-025	GUAT-025	GUAT-025	Brazo curvo de la Puerta
6	Hanging Bracket	RP-009	RP-009	RP-009	Brazo recto de la Puerta
	ACCESSORIES				Soportes Estructurales
					ACCESORIOS
7	Photo Eye Safety System	GUAT-201	GUAT-201	GUAT-201	Sistema de Seguridad de
8	Handheld Transmitter	R1BU	R3BU	R3MBU	Sensor óptico
9	Wireless Keypad			KPDBU	Transmisor Manual
10	Deluxe Door Control		3FBU	3FBU	Teclado Inalámbrico
11	Standard Door Control	1FBU			Control de Puerta de Lujo
12	a. Wireless Keypad Battery			AAA	Control de Puerta Estándar
	b. Remote Control Battery	CR2032 3V	CR2032 3V	CR2032 3V	a. Batería Teclado Inalámbrico
	RAIL ASSEMBLY PARTS				b. Batería del Control Remoto
					ENSAMBLE DEL RIEL
13	Rail-Header Segment	RP-001	RP-001	RP-001	Riel-Segmento de Cabecera
14	Rail-Middle Segment	RP-002	RP-002	RP-002	Riel-Segmento del Medio
15	Rail-End Segment	RP-003	RP-003	RP-003	Riel-Segmento Final
16	Pulley	GUT-840	GUT-840	GUT-840	Polea
17	Master Link Set	GUT-410	GUT-410	GUT-410	Conjunto de Enlace Principal
18	Trolley	RP-004	RP-004	RP-004	Carro
19	Sprocket Cover	RP-013	RP-013	RP-013	Cubierta de la Rueda Dentada
20	Chain	RP-006	RP-006		Cadena/Conector
21	Trolley Shaft/Cable	RP-005	RP-005	RP-021	Eje del Carro/Cable
22	Belt			RP-014	Correa

## OPENER ASSEMBLY PARTS

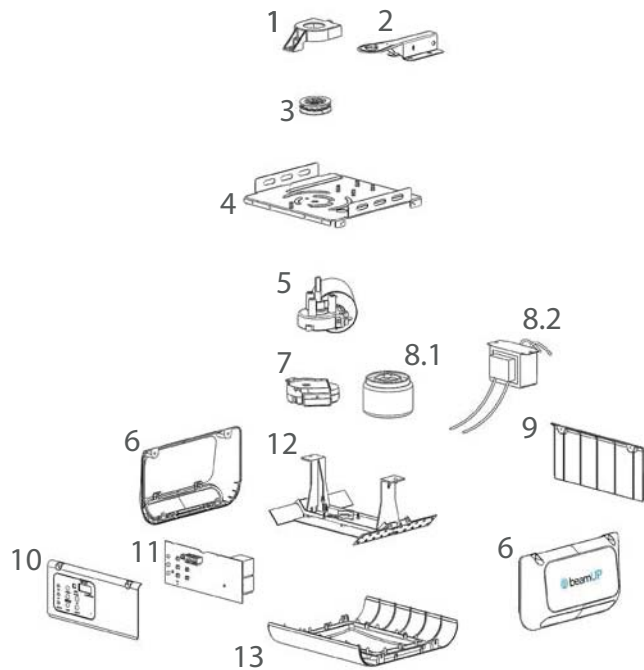

#	Name/Description	BU100	BU400	BU800	Nombre/Descripción
		Part # No. de parte	Part # No. de parte	Part # No. de parte	
	INSTALLATION PARTS				PARTES DE INSTALACION
1	Sprocket/Belt Pulley Cover	RP-013	RP-013	RP-013	Cubierta de la Rueda Dentada
2	Rail Bracket	RP-018	RP-018	RP-018	Soporte del Riel
3	Sprocket/Pulley	RP-024	RP-024	RP-019	Rueda Dentada
4	Chassis	N/A	N/A	N/A	Chasis
5	Motor	GU DT-313	GU DT-313	GU DT-305	Motor
6	Side Panels	RP-346	RP-347	RP-347	Paneles Laterales
7	Position Encoder	GU DT-314	GU DT-314	GU DT-314	Codificador de Posición
8	Transformers (8.1/8.2)	GU DT-315	GU DT-315	GU DT-302	Transformadores (8.1/8.2)
9	Cover Plate - Front	RP-341	RP-341	RP-341	Placa de Cubierta - Frente
10	Cover Plate - Back	RP-342	RP-342	RP-342	Placa de Cubierta - Trasero
11	Logic Board	RP-343	RP-343	RP-343	Receptor/Tablero Lógico
12	LED Cluster				LED
12.1	LED Cluster, Center	RP-344	RP-344	RP-344	LED, Central
12.1	LED Cluster, Side (2)		RP-348	RP-348	LED, Lateral (2)
13	Lamp Dome	RP-345	RP-345	RP-345	Cupula de Lámpara

### FCC Statement:

Any Changes or modifications not expressly approved by the party responsible for compliance could void the user's authority to operate the equipment.

This device complies with part 15 of the FCC Rules. Operation is subject to the following two conditions: (1) This device may not cause harmful interference, and (2) this device must accept any interference received, including interference that may cause undesired operation.