

Programming Wireless Keyless Entry Pad

WARNING

To Prevent SERIOUS INJURY or DEATH:

- Keep transmitter and battery out of reach of children.
- NEVER permit children to access the Wall Panel, Push Button nor remote transmitters.
- Operate door ONLY when it is adjusted properly with no obstructions to door travel and is in clear sight.
- ALWAYS keep a moving door in sight until completely closed. NO ONE should cross the path of a mov-

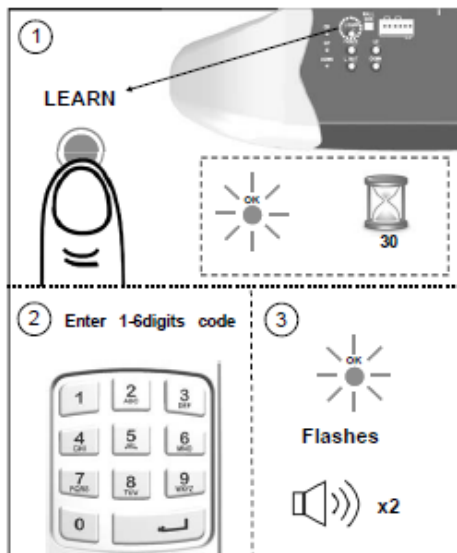

Fig.1



Fig.2

To Add Personal Codes:

1. Press the "LEARN" button on the rear control panel, "OK" LED will glow and beep. The unit is ready to accept a transmitter in the next 30 seconds as shown in Fig.1.
2. Enter 1 - 6 digit(s) personal code on the Keyless Entry within 30 seconds and press/release "ENTER" button. "OK" LED will flash and beep twice indicating personal code is stored in memory.

Up to 20 personal codes (including 1-button transmitters) can be added to the unit by repeating the above procedures.

If more than 20 personal codes are stored, the previously stored one from the very beginning will be replaced, i.e. the 21st transmitter replaces the 1st stored one.

Operation:

To access the door, enter a pre-stored personal code and press "ENTER" to transmit code, and within 20s, "ENTER" button can be used to stop or reverse the door.

If the code is entered incorrectly, correction can be made by pressing "ENTER" to reset and re-enter code.

When dark, "ENTER" may be pressed in advance to turn on back light.

Removing ALL Personal Code(s):

To remove ALL personal code(s) and/or transmitters from memory, press and hold the "LEARN" button for 5 seconds. "OK" LED will flash and beep, indicating ALL codes/transmitters have been removed from memory.

Replacing Keyless Entry Battery:

When the battery of Keyless Entry is low, dimmed illumination is observed. To replace battery, remove the battery cover, replace the battery with 2 AAA batteries.

This device complies FCC Rules for HOME OR OFFICE USE. Operation is subject to the following two conditions: (1) this device may not cause harmful interference, and (2) this device must accept any interference received, including interference that may cause undesired operation.

This equipment has been tested and found to comply with the limits for a Class B digital device, pursuant to part 15 of the FCC Rules. These limits are designed to provide reasonable protection against harmful interference in a residential installation. This equipment generates, uses and can radiate radio frequency energy and, if not installed and used in accordance with the instructions, may cause harmful interference to radio communications. However, there is no guarantee that interference will not occur in a particular installation. If this equipment does cause harmful interference to radio or television reception, which can be determined by turning the equipment off and on, the user is encouraged to try to correct the interference by one or more of the following measures:

- Reorient or relocate the receiving antenna.
- Increase the separation between the equipment and receiver.
- Connect the equipment into an outlet on a circuit different from that to which the receiver is connected.
- Consult the dealer or an experienced radio/TV technician for help.

Caution: Any changes or modifications to this device not explicitly approved by manufacturer could void your authority to operate this equipment.

This device complies with part 15 of the FCC Rules. Operation is subject to the following two conditions: (1) This device may not cause harmful interference, and (2) this device must accept any interference received, including interference that may cause undesired operation.