

GALAXY **WHDI**TM
WIRELESS HOME DIGITAL INTERFACE

WHDI Stick
HD Video Wireless Kit

WIRELESSLY STREAM CONTENT FROM YOUR NOTEBOOK AND HDMI DEVICE TO FULL HD TV

User Manual

GALAXY | **WHDI**TM
WIRELESS HOME DIGITAL INTERFACE

www.galaxytech.com

Galaxy Microsystems Ltd.

Room 1101-1103, 11/F, Enterprise Square Two, 3 Sheung Yuet Road, Kowloon Bay,
Kowloon, Hong Kong

555100-0283-000

Model: GSKU

555100-0283-000

尺寸 : 11.5cm*15cm

材料: 内页用普通书纸80克, 封面封底 用157g铜版纸 (打起码钉装订)
封面封底彩色四色印刷, 内页黑白单色印刷 (封二封三直接印内页内容)

content

Introduction	02
Product Specification	02
What is included	04
WHDI Stick	04
WHDI Receiver	05
Installation	07
Installing the WHDI Stick	07
Installing the WHDI Receiver	08
Paring Extra Devices	09
Troubleshooting	10
FCC Statement	11

Introduction

Congratulations on your purchase of Galaxy WHDI Stick HD Video Wireless Kit - The ultimate solution to connect your HD devices WIRELESSLY to your TV. This device enables wireless connectivity of any uncompressed HD video and Audio. It can be wireless connected from an HD source device, such as Desktop PCs, Laptops, Blu-Ray players, STBs, and game consoles etc, to an HD display device such as LCD/Plasma TVs and Projectors etc. Share High Definition content among all devices in full coverage, no line of sight required.

Product Specification

- Main Features:
 - Supports HDMI 1.3 standard in 720p and Full HD 1080p resolution
 - Less than 1ms latency - No video delays and no lip-sync problems
 - Support all popular audio formats including PCM stereo, DTS & Dolby Digital
 - Uses the 5Ghz unlicensed band
 - Range: Non-line-of-Sight, in-room communication, up to 10 meters
 - Co-exists with Wi-Fi 802.11a/n in the 5GHz band
 - Encrypted wireless link, no eavesdropping by neighbors
 - Easy device switching: pair multiple WHDI sticks to multiple WHDI receiver for easy device switching
 - Comply with WHDI 1.0 standard works with any WHDI Complied TV or Receiver Adaptor
 - Comply with HDCP 2.0 allows sending Blue Ray movies and other protected content.

- Galaxy WHDI Transmitter Stick
Dimensions: 107mm x44mm x16mm
Maximum 12dBm transmission power
Power consumption: up to 2.5Watt for Full HD resolution
USB Powered [5V 0.5A]
Interface: HDMI in x1, Mini USB x1
- Galaxy WHDI Receiver
Bundled with IR receiver for deviceairing/switching
Dimensions: 148mm x96mm x20mm
Receiver Sensitivity ≤ -65 dBm
Input Voltage: 5V/2A DC (AC adaptor included)
Interface: HDMI out x1, DC in x1, IR in x1, Mini USB x1
(Reserved)

What is included

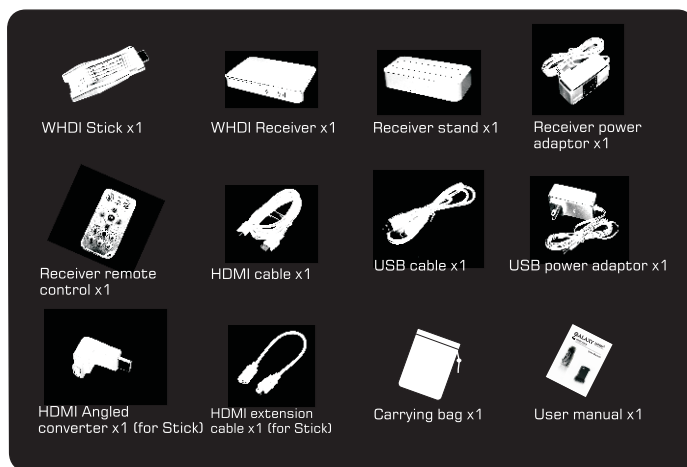

TV and notebook not included

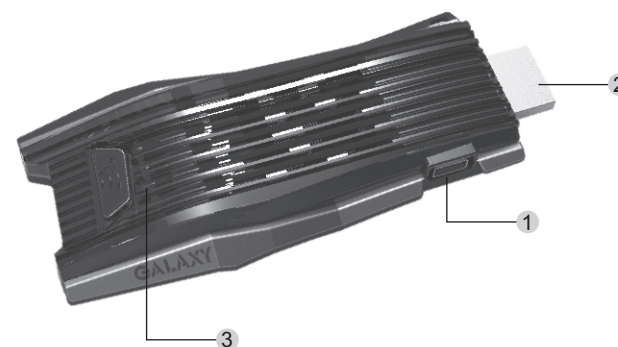

WHDI Stick

- 1 USB port
The stick uses standard USB port as input power. When you are using devices without USB port, you can use the bundled USB power adaptor.
 - 2 HDMI Video Input
 - 3 Status Indicator
-LED on: connection established
-LED flashing: pairing mode
-LED off: connection failed
- Pairing key
Use this key to put the stick into “pairing” mode. Please check the steps provided in this manual for more details

WHDI Receiver

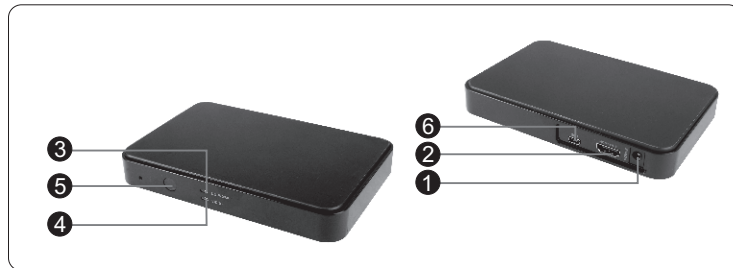

❶ Power input

The receiver requires 5V/2A DC power. Use the power adaptor included in this package.

❷ HDMI Video output

❸ Network status indicator

- LED on: network connection established
- LED flashing: pairing mode
- LED off: connection failed or power failure

❹ Video status indicator

- LED on: receiver has connected to display device successfully
- LED off: video connection failed

❺ IR receiver

❻ USB port (reserved)

Installation

Installation for the WHDI stick and receiver is easy. For best signal reception, it is recommended to place BOTH the WHDI Stick and receiver vertically. You can use the bundled stand for the receiver, and the bundled angled HDMI converter for the WHDI stick respectively.

Installing the WHDI Stick

1) It is recommended to turn off your device before installing the WHDI stick.

2) Connect the HDMI video input of the stick to the HDMI output port of your HD video device. Use the angled HDMI converter or the extension cable if necessary.

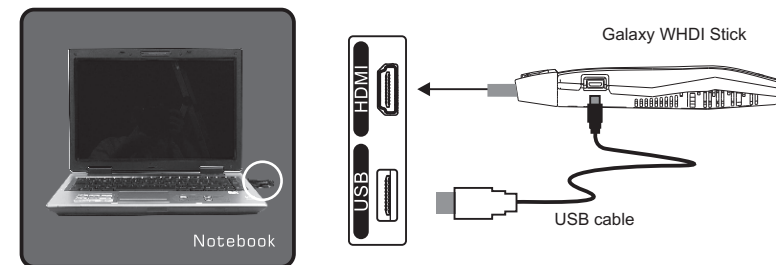

3) Connect the USB port of the stick to the USB port of your HD video device. Use the bundled USB power adaptor if your HD video device does not equip with a USB port.

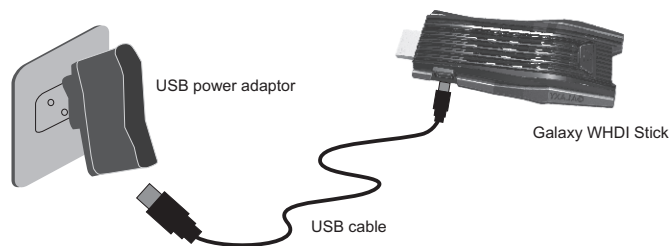

4) The LED status indicator will turn on when the WHDI Stick has successfully connected with the WHDI Receiver.

Installing the WHDI Receiver

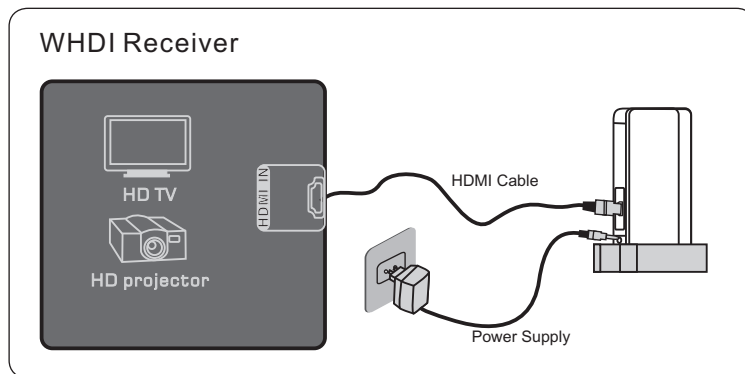

1) It is recommended to turn off your device before installing the WHDI Stick.

07

2) Connect the HDMI video output of the receiver to the HDMI input port of your HD display device. An HDMI cable is included in the package for your convenience. It is recommended to use the bundled stand to hold the receiver vertically. Notice the direction of the receiver to make sure the antenna is facing upwards

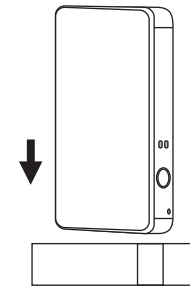

3) Connect the bundled power adaptor to the power input of the WHDI Receiver.

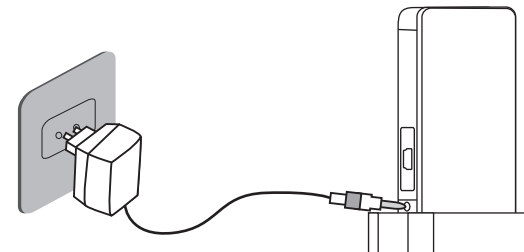

4) The Video status indicator will turn on when the Receiver has connected successfully with the HD display device. However the Network status indicator will only be turned on when the WHDI Receiver has connected with the WHDI Stick successfully.

08

Pairing Extra Devices

Galaxy WHDI Stick HD Video Wireless Kit allows multiple pairing – you can pair multiple WHDI Sticks to a single receiver for easy switching between devices. The WHDI Stick and WHDI Receiver included with this kit is already factory paired by default, and does not require manual pairing for operation. Use the below procedure only when you wish to pair extra devices, or the receiver has trouble in pairing with the WHDI Stick.

Step 1

Connect the WHDI Stick and WHDI Receiver to your input device and HDTV using the procedure described in this manual.

Step 2

Power on both WHDI Stick and WHDI Receiver

Step 3

The WHDI Stick and WHDI Receiver is already factory paired by default. Even if you have not turned on your input device, they will automatically connect with each other. The following will be shown on the screen:

Connected to StickXXXX. Please Check Video Source.

Step 4

To pair extra WHDI Stick to the WHDI Receiver, press the MENU button located at the top left hand corner of the remote control



Receiver remote control

Step 5

The following will be shown on the screen, select “Add, Remove or Rename Video source” and press OK to continue.

Select Video Source

⇒ StickXXXX

Disconnect Wireless Link

Add, Remove or Rename Video Source

Step 6

Next, select “Add new Video Source”

Add, Remove or Rename
Video Source

⇒ Add new Video Source

⇒ Rename Video Source

⇒ Modify Video Source
Name

Step 7

The following will be shown on screen:

Press Connect Button on New Source for 3 sec

Operation may take up to 20 seconds after
Connect Button is pressed.

Step 8

Press the Pairing key on the WHDI Stick for 3 seconds, and wait for about 20 seconds for the WHDI Receiver to identify and pair the WHDI Stick.

Step 9

Pairing is complete. You can now switch between different WHDI Sticks connected to a single WHDI Receiver using the remote control. You can also rename different WHDI Sticks using the setup menu.

*NOTE: The WHDI Stick can only be connected to ONE WHDI Receiver at a time. To connect the WHDI Stick to another WHDI Receiver, you must first select "Disconnect Wireless Link" from the WHDI Receiver setup menu. This will disconnect the current connection and allows the WHDI Stick to connect with a different WHDI Receiver.

Troubleshooting

Q: Why are there no images displayed on TV after the transmitter and receiver have been powered on?

A: It may take 15-30 seconds for initiation and connection after the transmitter and receiver are powered on. Please wait patiently. If no images appear after 1 minute, check whether the connection between the transmitter and the player as well as the connection between the receiver and the TV are made properly.

Q: How come the network connection status indicators on both the transmitter and receiver are OFF even after both devices have been powered on?

A: Possibly the transmitter and receiver are too far away or there are too many obstacles interfering with the transmission signal. Please adjust the position of one or both devices.

Q: Why is not my display device receiving any signals?

A: Please check whether the receiver is properly connected to the TV. In addition, check to make sure the input source of the TV is set to HDMI.

Q: I can not hear any sound on the TV

A: Please confirm whether the player is muted or whether the audio output is configured correctly. Galaxy WHDI Stick supports 2 channel PCM as well as DTS/AC3 audio pass through. Please refer to user manual of your TV set for supported audio format of your TV.

Q: Why aren't any images output when the transmitter is connected to a Blu-Ray disc player and the receiver is connected to a PC display or projector?

A: The playback requirements for Blu-Ray disc players comply with the HDCP protocol specifications. Please confirm whether your display device supports HDCP. The Galaxy WHDI Stick fully complies with HDCP 2.0.

Q: Why is there noise and interference on the image displayed on TV?

A: Possibly the transmitter and receiver are too far away from each other, or there are many obstacles interfering with the transmission signal. Please adjust the position of both devices.

Both the WHDI Stick and WHDI Receiver works best when they are placed vertically.

Q: When I connect the USB port of the WHDI Stick to my PC, Windows detected a unknown hardware, is that normal?

A: The WHDI Stick only uses the USB port for power, and does not require any driver installation on the PC for such purpose. Driver installation is only needed for firmware update and maintenance.

FCC Statement

This equipment has been tested and found to comply with the limits for a Class B digital device, pursuant to part 15 of the FCC rules. These limits are designed to provide reasonable protection against harmful interference in a residential installation. This equipment generates, uses and can radiate radio frequency energy and, if not installed and used in accordance with the instructions, may cause harmful interference to radio communications. However, there is no guarantee that interference will not occur in a particular installation. If this equipment does cause harmful interference

to radio or television reception, which can be determined by turning the equipment off and on, the user is encouraged to try to correct the interference by one or more of the following measures:

- Reorient or relocate the receiving antenna.

- Increase the separation between the equipment and receiver.

- Connect the equipment into an outlet on a circuit different from that to which the receiver is connected.

- Consult the dealer or an experienced radio/TV technician for help.

To assure continued compliance, any changes or modifications not expressly approved by the party responsible for compliance could void the user's authority to operate this equipment. (Example- use only shielded interface cables when connecting to computer or peripheral devices).

FCC Radiation Exposure Statement

This equipment complies with FCC RF radiation exposure limits set forth for an uncontrolled environment. This transmitter must not be co-located or operating in conjunction with any other antenna or transmitter.

This equipment complies with Part 15 of the FCC Rules. Operation is subject to the following two conditions:

- (1) This device may not cause harmful interference, and

- (2) This device must accept any interference received, including interference that may cause undesired operation.

Caution!

The manufacturer is not responsible for any radio or TV interference caused by unauthorized modifications to this equipment. Such modifications could void the user authority to operate the equipment.