



HALOGEN LINKABLE LIGHT BAR

Your GE Halogen Light Bar is the perfect under cabinet lighting solution for kitchens, bathrooms, bookcases, entertainment centers, and study areas. We recommend you read through the instructions entirely before starting your installation in order to help you understand all the steps and options regarding your particular installation. If you are unfamiliar with the electrical codes in your region, or do not feel capable of safely installing this product, we recommend you call a qualified electrician for assistance with your installation.

The Halogen Linkable Light Bar comes with a line cord, and the necessary hardware to install the fixture. The package also includes a link cable for linking with other GE Halogen Linkable Bars. Each bar has an integral 3-position switch (LO, OFF, HI) which controls only its own bulbs. Additional bars can be purchased separately and added to your lighting system at any time.

The maximum number of Light Bars in your chain must not exceed 8.

The Halogen bar is intended for under cabinet, or under shelf installations ONLY. DO NOT install these bars INSIDE cabinets. DO NOT attempt to install while plugged in. These bars are for indoor use only and can be mounted to cabinets and surfaces having a material thickness of at least 1/4". NOT for use with plastic cabinets. DO NOT mount over sinks or stoves. Mount with lamp facing down.

Your GE Halogen fixture is linkable, allowing you to "daisychain" multiple Light Bars under your cabinets, but still only use one outlet to power all your GE Halogen Light Bars.

The Halogen bulb used in your fixture is a 120V/20 Watt bulb with G8 Base. The bulb will get quite hot during normal operation. The materials used in the construction of the Halogen Light Bar have been tested to withstand these high temperatures. However, you should pay particular attention to the mounting recommendations as follows:

1. Your Light Bar comes with a 5 foot cord. Make sure your line cord can reach a nearby electrical outlet.
2. Make sure that flammable, or objects that can melt are at least 12" or more away from the fixture.

Lamp Replacement Instructions

Relamp only with a 120V, 20W MAX or less halogen bulb with G8 base.

1. Turn the light fixture off, and allow sufficient time for the unit and bulb (lamp) to cool properly before handling.

2. Remove the glass lens by turning the outer ring counter clockwise. When the lens lock is undone, the glass lens and ring will drop into your hand. Be careful not to drop the lens—it can break!

3. Using a cloth or paper towel, grasp the bulb firmly and pull bulb out of the socket. Re-insert a new bulb using a paper towel or cloth to hold the bulb.

4. Position the glass lens so the catches line up with the corresponding openings in the light fixture, and re-attach the lens by twisting on in a clock-wise motion.

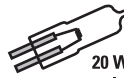

20 Watt MAX
or less
Halogen Bulb
with G8 Base

IMPORTANT SAFETY INSTRUCTIONS

This unit has a polarized plug (one blade is wider than the other) as a safety feature. This plug will fit in a polarized outlet only one way. If the plug does not fit fully into the outlet, reverse the plug. If it still does not fit, contact a qualified electrician. Never use with an extension cord unless plug can be fully inserted. DO NOT attempt to defeat this feature.

WARNINGS TO REDUCE THE RISK OF FIRE, ELECTRIC SHOCK, EXPOSURE TO EXCESSIVE UV RADIATION, OR INJURY TO PERSONS:

! WARNING

Risk of electric shock

- Use only insulated staples or plastic wire guides to secure the cords.
- Route and secure the cords so that they will not be pinched or damaged

Risk of fire

- Keep away from materials that may burn.
- Use only with a 120V 20W MAX or less Halogen Bulb with G8 Base
- Not intended for installation in plastic cabinets.
- Keep cord or combustibles such as plastic, paper goods, and the like away from glass lens and hot lamp.
- Position under cabinet light with respect to cabinet/shelf to permit reading of the lamp replacement markings during relamping. Mount Light Bar facing down.
- Not intended for illumination of aquariums.
- Not intended for recessed installation in ceilings or soffits.
- Not intended for surface installation inside built-in furnishings such as kitchen cabinets, china cabinets, or trophy cases.
- Do not conceal power supply cord inside a wall, ceiling, soffit, kitchen cabinet, or similar permanent structure.
- Do not run the power supply cord through holes in walls, ceilings, or floors.

Risk of personal injury

- Turn off/unplug and allow to cool before replacing the bulb
- Bulb and glass lens gets HOT quickly!
- Lighted lamp and lens are HOT!
- Do not touch hot lens or enclosure.
- Do not remain in light if skin feels warm.
- Do not look directly at lighted bulb.
- Do not operate the unit with a missing or damaged glass lens.
- Do not install on walls or vertical surfaces.

SAVE THESE INSTRUCTIONS IN A LOCATION CLOSE TO YOUR CABINET SO YOU CAN REFER TO THEM AT A LATER TIME.

Cleaning Instructions

Your fixture is made from quality materials that will last for many, many years with a minimum of care. When cleaning, make sure you have unplugged your fixture, and have allowed sufficient time for the unit to cool to room temperature. You should clean the housing and lens using a mild non-abrasive cleaner, and soft cloth. Do not spray liquid cleaner directly on the fixture, or lens. Also, do not spray cleaner onto the switch, fused line cord, or lamp. You should plug your fixture back in only after the fixture has thoroughly dried.

CAUTION: Do not plug the line cord into an electrical outlet at this time. Do not attach the individual Halogen bars to an electrically live cord.

Mounting Instructions

Carefully plan out your installation prior to actually securing your Halogen Light Bar to the mounting surface making sure that your 5 ft. line cord will reach the nearest electrical outlet. The line cord is capable of handling up to 8 Halogen Light Bars (FIG. 1).

For kitchen installations, the recommended mounting for the Light Bars near the front lip of your kitchen under cabinets as shown in the illustration (FIG. 2) This provides the best light distribution across a countertop.

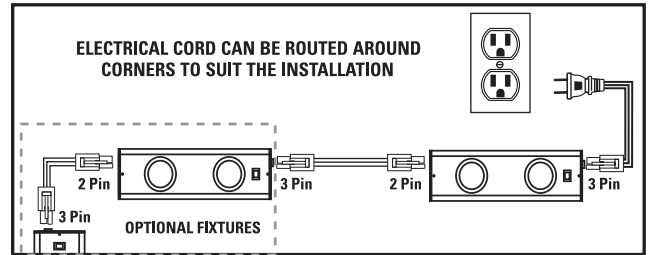

FIG. 1

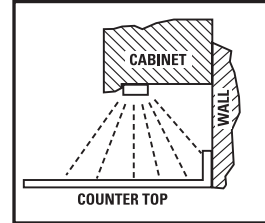

FIG. 2

1. Locate positions where Halogen bars should be mounted, keeping in mind that the linking cords can handle a maximum of 18" between bars (FIG. 1).
2. Use the enclosed template to mark the appropriate screw hole locations. Pre-drill holes in the mounting surface with a 3/32" drill bit for hardwood, use a 5/64" drill bit for softwood. NOTE: The screw locations must be exact for the light bar to mount properly.
3. Place the two small rubber grommets over the mounting screws. Screw in the two #8 mounting screws until the rubber grommets contact the bottom surface of the cabinet. Then turn the screws another 1/4 turn. The screws must be driven in straight for the light bar to mount properly. (FIG. 3).

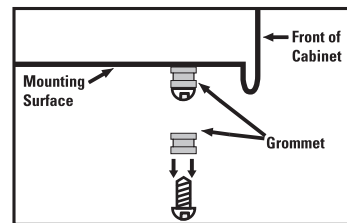

FIG. 3

4. Align the cross hole openings in the bottom plate of the light bar over the mounting screws, and firmly slide the light bar over in one direction to lock it into place. The light bar can slide toward the front, rear, or from side to side depending on the spacing in your particular installation. The light bar should fit snugly up against the mounting surface. If not, then your screws need to be tightened a little more for an improved fit (FIG. 4).

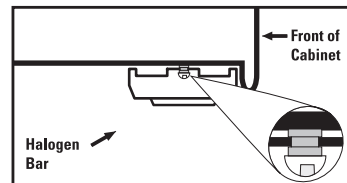

FIG. 4

5. Your line cord has a molded plastic cap on one end, and a link connector at the other end. The link connector plugs into your halogen bar. The second cord provided is a linking cord with link connectors on both ends. This is used to connect your halogen bar to the next bar in your chain. Link adjacent only. See FIG 1 to see how 2 pin and 3 pin plugs are intended to be used.

Attaching Additional Bars at a Later Date

If you desire additional bars for your system after the initial installation, you may attach them as needed (sold separately) by following these instructions. Keep in mind the maximum linking distance between bars is 18". In addition, make sure not to exceed the 8 bars per line cord limit for your total installation.

CAUTION: DO NOT ATTEMPT TO ATTACH ADDITIONAL BARS TO YOUR EXISTING SYSTEM WITHOUT UNPLUGGING THE LINE CORD FROM THE ELECTRICAL OUTLET OR DISCONNECTING THE ELECTRICITY AT THE ELECTRICAL POWER PANEL.

1. Install the additional Halogen Light Bar following steps 1-5 of the mounting instructions.
2. Once installed, attach the linking cord between the last Light Bar (previously installed) and the new one. See FIG. 1 below to see how the 2 pin and 3 pin plugs are intended to be used.
3. When adding a Light Bar to an existing system of linked bars, the line cord (with the power plug) is not needed. Only the first Light Bar in the chain needs to be connected to power with the line cord.

is a trademark of the General Electric Company and is used under license to Jasco Products Company LLC, 10 E. Memorial Road Oklahoma City, OK 73114. Or visit us at www.jascoproducts.com.

LINKABLE Halogen LIGHT BARS

10231-5
10233-5

UCH 2B 120
UCH 3B 120