

GE
Lighting Solutions

Roadway Lighting

High Mast (HMAA & HMAB)



imagination at work

Product Features

From HID to LED, GE continues to push Roadway Lighting to new heights. Recognized for the highest quality and reliability in street, highway, parkway, and commercial applications, GE offers a wide selection of styles to meet the lighting needs of municipalities, utilities, DOT customers and more.

Applications

- For large interchanges or parking lots and an asymmetrical optical assembly for lighting straight sections of roadways

Housing

- Cast aluminum ballast housing
- All noncorrosive hardware
- Stainless steel clampband

Finish

- Polyester powder gray paint finish

Rating

- /c 1598 Listed Suitable for Wet Locations

Mounting

- Universal 4-bolt slipfitter

Reflectors

- ALGLAS™ finish on aluminum faceted reflector

Unique Features

- Dead Back Terminal Board
- Mogul base socket -E39 standard
- ANSI C136 3G rating on all units
- Enclosed and Filtered Optical
- Heat and shock resistant tempered convex glass lens
- Optional flat glass lens for spillight and glare control
- IP-65 construction on all enclosed opticals

Ordering Number Logic

High Mast (HMAA & HMAB)



PROD. ID	WATTAGE	LIGHT SOURCE	VOLTAGE	BALLAST TYPE SELECTION	PE FUNCTION	LENS TYPE (PRISMATIC) REFRACTOR	IES DISTRIBUTION TYPE	OPTIONS
HMAA = High Mast	40 = 400 75 = 750 01 = 1000	E = Energy Act Compliant Pulse MH (EPMH) S = HPS M = MH P = PMH Standard: Lamp not included.	60Hz 1 = 120 2 = 208 3 = 240 4 = 277 5 = 480 D = 347 T = 220 50Hz 6 = 220 R = 230 Y = 240 NOTE: For over 8 luminaires per pole, use only 480V	See Ballast Selection Table A = Autoreg D = Bilevel System 3. Contact Manufacturer for availability. (Not available with HMAB) G = Mag-Reg with Grounded Socket Shell M = Mag-Reg P = CWI with Grounded Socket Shell	1 =None 2 =PE Receptacle	See Ballast and Photometric Selection Table C = Sag glass lens assembly "shield ready" F = Flat glass * G = Glass - Sag lens (Enclosed) N = None (Open) * = Previously IESNA Full Cutoff Optics NOTE: N is not available for 1000 watt HPS.	See Ballast and Photometric Selection Table S = Short M = Medium C = Cutoff « N = Non-cutoff S = Semi-cutoff 1 = Type I 2 = Type II 3 = Type III 4 = Type IV 5 = Type V * = Previously IESNA Full Cutoff Optics	F = Fusing C/F = ISO Ignitor option C/F = Ballast Tray option

Ballast Selection Table

Wattage	Light Source	Ballast Type/Voltage 60Hz			50Hz		
		Multivolt	347	220	220	230	240
400	HPS	A,D,G,K,M	A,D,G,M	N/A	N/A	N/A	N/A
750	HPS	A	A	N/A	N/A	N/A	N/A
1000	HPS	A	A	A	A	A	A
1000	MH	A,P	A,P	A	A	N/A	N/A
400	EPMH	A	N/A	N/A	N/A	N/A	N/A

NOTE: N/A = Not available. *Not available in 120 X 347V

HighMast Shielding

Highmast Shielding - ordered separately and must use "C" as lens type in catalog logic for fixture.

Door Glass Assembly (for retrofits)	HMAA-22EGELS
15" Curved Shield	ELS-HMAA060
(2)15" Curved Shields	ELS-HMAA061
9" Squared Shield	ELS-HMAA062
(2) 9" Squared Shields	ELS-HMAA063
Nuisance 360 Shield	ELS-HMAA360BL

Photometric Selection Table

Wattage	Light Source	IES Distribution Type Photometric Curve Number 35-															
		Open = N			Sag lens = G									Flat Glass = F			
		SC5(V)	MC5(V)	MS5(V)	SC5(V)	SS5(V)	SC3(H)	MC2(H)	MC3(H)	MC5(V)	MS2(H)	MS3(H)	MS5(V)	Narrow (H)	MC2(H)	MC5(V)	SC5(V)
400	HPS	176288	176289	N/A	176310	N/A	N/A	177349	179311	176312	N/A	N/A	N/A	178946 (MSIII)	177365	450454	450455
750	HPS	N/A	N/A	N/A	178132	178130	N/A	178345	179144	178131	C/F	N/A	178129	178947 (MSIII)	N/A	N/A	452710
1000	HPS	N/A	N/A	N/A	176318	N/A	177310	177302	N/A	N/A	N/A	N/A	178948 (SCI)	452981	N/A	N/A	453301*
400	EPMH	C/F	C/F	C/F	C/F	N/A	N/A	C/F	C/F	451185	C/F	N/A	451168	C/F	N/A	N/A	N/A
1000	MH	176294	176353	N/A	176323	N/A	N/A	177308	N/A	176354	7307	N/A	N/A	178949 (MSI)	N/A	N/A	N/A

* Must use Reduced Jacket ED37 Lamp **NOTE:** N/A = Not available C/F = Contact Manufacturer (V) = Vertical Lamp (H) = Horizontal Lamp For Hot Restrike Contact Manufacturer (Not available with HMAB) 400 PMH – Contact Manufacturer

Product Dimensions

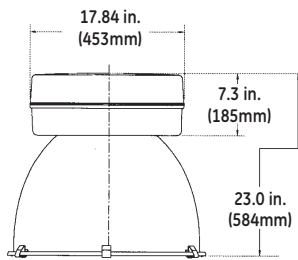

FRONT VIEW - FLAT GLASS

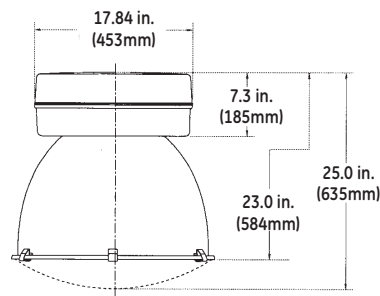

FRONT VIEW - SAG GLASS

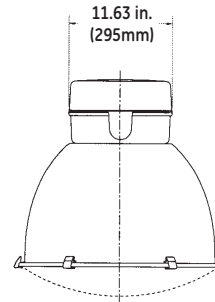

SIDE VIEW

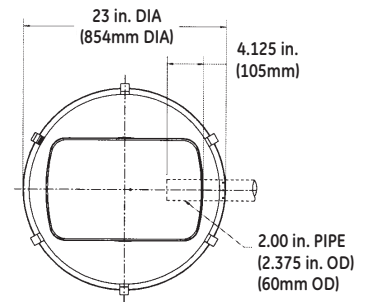

TOP VIEW

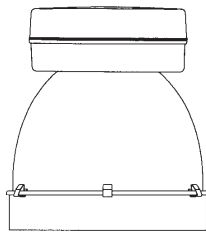

360 NUISANCE SHIELD
ELSHMAA360BL

Nuisance
Cutoff Shield

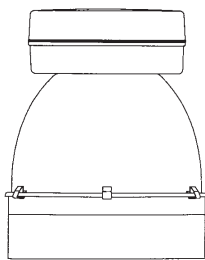

ELSHMAA062
(2) ELSHMAA063

9" Squared
Light Shield

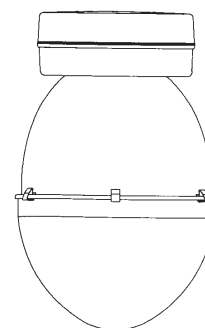

ELSHMAA060
(2) ELSHMAA061

15" Curved
Light Shield

Ballast and Optical

Ballast & Optical, and Glare Shield Effective Projected Area Shields values do not include optical EPA.

		Effective Area maximum		Weight	
		sq. ft.	sq. m.	lbs.	kgs
BALLAST & OPTICAL		2.5	0.23	55	25
ELSHMAA062	One 9" square	1.8	0.17	2.2	1.0
ELSHMAA060	One 15" curved	1.8	0.17	2.2	1.0
ELSHMAA063	Two 9" square	1.8	0.17	2.2	1.0
ELSHMAA061	Two 15" curved	1.8	0.17	2.2	1.0
ELSHMAA360BL	4.5 in 360 deg.	0.9	0.08	2.2	1.0

DATA

- Approximate Net Weight: 55 lbs (25 kgs)
- Effective Projected Area: 2.5 sq. ft. max. (0.23 sq. M max.)
- Suggested Mounting Height: Single Luminaire - 40-50 ft. (12-15 M) Multiple Luminaires - 80-150 ft. (24-46 M)

Photometric Selection Table (with Highmast Shielding)

LIGHT WATTAGE	BASE CURVES			HOUSE SIDE		BOTH SIDES		NUISANCE SHIELD ONLY 3.79" shield 360 deg
	SOURCE	DIST TYPE	CURVE #	Curved 15"	Square 9"	Curved 15"	Square 9"	
400	HPS	MC2	7349	452600	452604	452606	n/a	452610
400	HPS	MC3	9311	452601	452603	452607	n/a	452611
400	HPS	MC5	6312	452602	452605	452608	452609	453112
750	HPS	MC2	8345	452638	452640	452639	452641	452642
750	HPS	MC3	9144	452643	452646	452644	452647	452645
750	HPS	MC5	8131	452650	452651	452649	452652	452648
1000	HPS	SC5	6318	452616	452617	452619	452618	452615
1000	HPS	MC2	7310	452629	452630	452628	452631	452632
1000	HPS	MC3	7302	452635	452636	452634	452637	452633
1000	MH	SC5	6323	452655	452653	452656	452654	452657
1000	MH	MC2	7308	452666	452664	452667	452663	452665
1000	MH	MC5	6354	452658	452661	452659	452660	452662
1000	MH	MS2	7307	452672	452675	452673	452676	452674



GE Lighting Solutions • 1-888-MY-GE-LED • www.gelightingsolutions.com

1-888-69-43-533

GE Lighting Solutions, LLC is a subsidiary of the General Electric Company. The GE brand and logo are trademarks of the General Electric Company. © 2012 GE Lighting Solutions, LLC. Information provided is subject to change without notice. All values are design or typical values when measured under laboratory conditions.