

OLYMPIA ®
-your key to a wireless world

Bluetooth Headset



User Manual

CDP 24901

Copyright

© 2003, Wave Industries Ltd. All Rights Reserved.
Reproduction, adaptation, or translation without prior written permission is prohibited, except as allowed under the copyright laws.

First Edition: July 2003

Trademark Information

Olympia® is a registered trademark of Olympia International Holdings Ltd.

Warranty

The information contained in this document is subject to change without notice. Wave Industries makes no warranty of any kind with respect to this information. Wave Industries shall not be liable for any direct, indirect, incidental, consequential, or other damage alleged in connection with the furnishing or use of this information.

Table of Contents

WELCOME

Copyright	1
Trademark Information	1
Warranty	1

INTRODUCTION

Bluetooth Wireless Technology	3
Important Notes and Safety Information	3

GETTING STARTED

Package Contents and Key Layout	4
Headset Diagram	4
Features	5
Battery and Charging	6
Fitting the Headset	7-9
Pairing	10

USING THE HEADSET

Turning the Headset On and Off	11
Answering a Call	11
Making a Call	11
Ending a Call	11

DURING A CALL

Volume Control	12
Call Mute	12
Cancel Mute	12
Call Hold	12
Cancel Call Hold	12

TROUBLE SHOOTING

Trouble shooting	13
Remove Pairing	13

CONSUMER INFORMATION

FCC Notice	14
Helpline Numbers	14

Bluetooth Wireless Technology

The Olympia headset complies with Bluetooth Specification V1.1 and is designed for devices supporting Bluetooth wireless technology such as the Olympia Cordless Data phone, various mobile phones and any other device that supports the Headset profile.

The default PIN code is *2222* and is not user changeable.

In some countries there may be restrictions on using Bluetooth devices please check with the authorities.

Important Notes and Safety Information

Important Notes

THIS EQUIPMENT IS NOT DESIGNED FOR MAKING EMERGENCY TELEPHONE CALLS WHEN MAINS POWER FAILS. ALTERNATIVE ARRANGMENTS SHOULD BE MADE FOR ACCESS TO EMERGENCY SERVICES.

Safety Information

Only use the power supply included with the CDP. Using on unauthorized power supply will invalidate your guarantee and may damage the telephone.

Do not open the charger or headset. This could expose you to high voltages or other risks.

Package contents and Key Layout

1. Bluetooth Headset
2. Proprietary Headset Charger
3. Power Adaptor
4. Ear Grips
5. Lanyard
6. User Guide

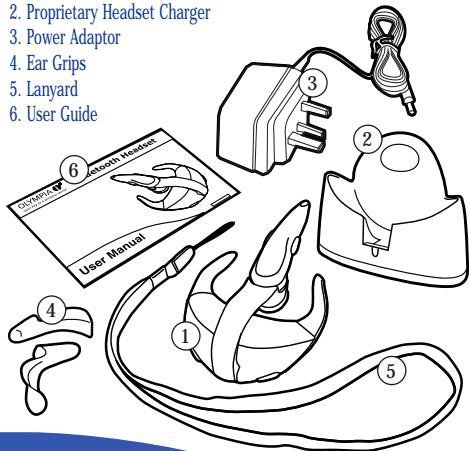

Headset Diagram

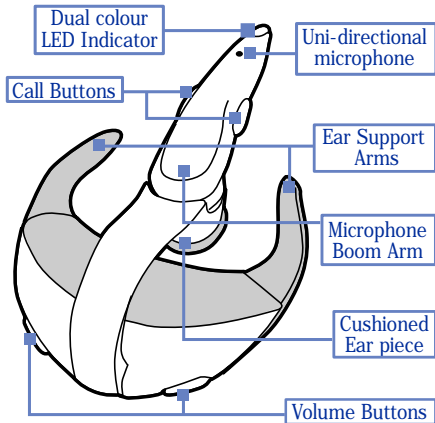

Features

- Uni-directional microphone and earpiece
- Movable boom arm for easy adjustment of microphone position
- Flexible ear support arms and detachable ear grips for different sized ears
- Dual colour LED status indication
- Volume Up/Down
- Internal Lithium Polymer rechargeable battery with 5 hours talk time and 3 days standby
- Low battery warning
- Call Mute
- Call Hold
- Operation range of 10m from mobile phone
- Proprietary headset charger

Features

- Can be worn on left or right ear
- Audio connection transfer from phone
- Audio connection transfer to phone (provided that it is supported by the mobile phone)
- Voice Dialing (provided that it is supported by the mobile phone)
- Lanyard

Battery and Charger

Before first use the battery is required to be charged for 2-3 hours. Once the headset is fully charged, it is ready to use.

Charge battery by placing headset in charger as shown in diagram:

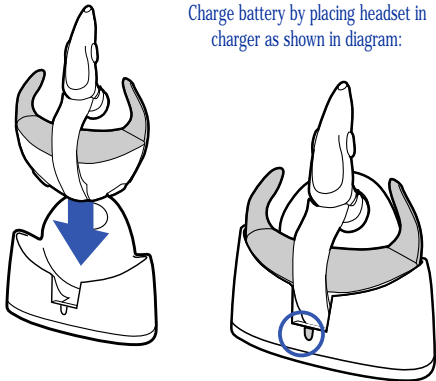

Battery and Charger

- The charger LED is red when the headset is being charged
- The charger LED turns green when the headset is fully charged.
- When the charger is on but no headset is mounted the LED is green.

A battery low warning tone will sound every 5 seconds signaling that the headset should be recharged. When this happens there are 5 minutes of talk time remaining before the headset turns off automatically.

The LED on the headset will be yellow when battery low.

Fitting the headset

The headset is designed to be worn on either ear. One or both of the ear grips may be used for better fit.

1. Lift boom arm and slide headset onto the ear from the back. Pivot cushioned earpiece into ear so that the headset arms wrap around top and bottom of ear.

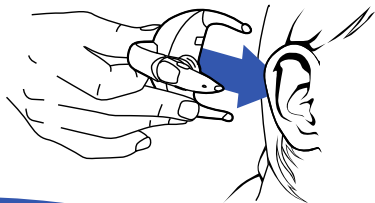
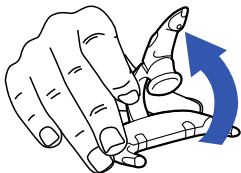

Fitting the headset

2. Tighten headset arms to hold device in place securely but comfortably around the ear.

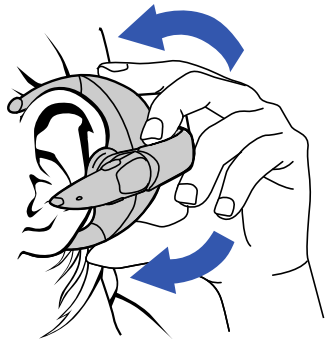

Fitting the headset

3. Angle of microphone boom can be adjusted to nearest position to mouth.

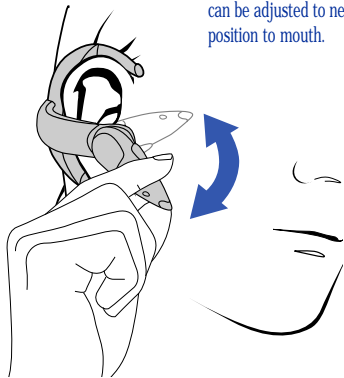

Fitting the headset

4. For a better fit, one or both of the ear grips may be placed on the headset arms. Reposition headset on ear as before.

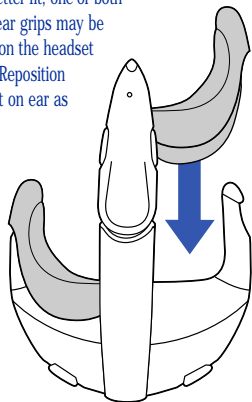

Fitting the headset

5. The headset, firmly in place, can be operated using just one hand.

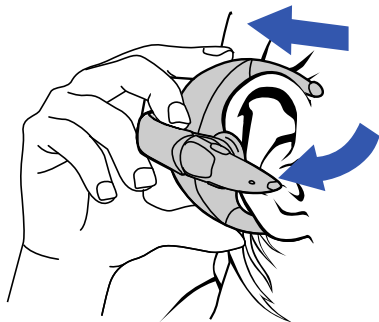

Fitting the headset

6. A lanyard is provided for easy mobility.

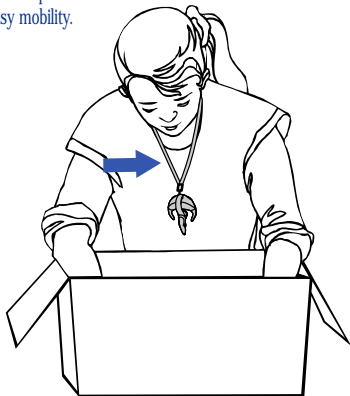

Pairing

The Bluetooth headset can be connected wirelessly to a Bluetooth enabled phone after going through a process called Pairing. Pairing enables the two devices to communicate with each other.

- Press the Call buttons for at least 8 seconds until the LED is on solid blue.
- Now go to your phone and enter Bluetooth pairing mode to add the Olympia Bluetooth headset. You will be prompted for the pass key during the process. The pass key for the Olympia Bluetooth headset is '2222'. Please refer to your phone manual for details since each phone model has a different pairing procedure.

Pairing

- Note:
1. The first time the headset is turned on it will automatically be ready for pairing.
 2. If you release the Call buttons before the LED is on solid, power off (by pressing the Call buttons until LED turns off completely) and then start again.

Turning the Headset ON and OFF

To Turn On

- Press and hold the Call button until blue LED blinks.
- Beeps will indicate the headset is going to power on.

To Turn Off

- Press the Call button for 10 seconds.
- 2 sets pf beeps between interals will indicate the headset is going to power off.

To Answer a Call

- When a call is received a ring tone is heard at the ear piece and the blue LED will flash quickly.
- Press the Call button to answer the call.
- Beeps will confirm acceptance.
- The blue LED will continue to flash quickly whilst on line

To make a Call

- Once the headset is paired to a phone, make the call by using the phone in the usual way.
- Beeps will be heard to confirm acceptance.

Note: Some phone models will prompt whether the call is to be taken at the headset or the phone itself. Please refer to phone manual for more details.

- Voice dialing can be performed if supported by the mobile phone. Press and hold the Call button for at least 3 seconds to initiate the phone voice dialing capabilities. Please refer to phone manual for more details.

To End a Call

- Press and hold the Call button once.
- Beeps will be heard to confirm.
- The call can also be ended at the phone in the normal way

Volume Control

- There are 7 volume levels. Press and release Vol. Up and Vol. down buttons to adjust volume. Each press will give a single beep. When the volume reaches a maximum/minimum level 4 beeps will sound.

Call Mute

- In mute mode the microphone is turned off.
- Press and hold either Vol. up or Vol. down buttons for at least 2 seconds.
- 3 beeps will confirm.
- In the mute state, a periodic beep tone will sound and the blue LED will flash slowly.

Cancel Mute

- Press and release the Vol. Up or Vol. down button twice.

Call Hold

- In Call hold mode both the microphone and earpiece are turned off.
- Press and hold either Vol. up or Vol. down buttons for at least 2 seconds. When 3 beeps are heard release button.
- Press button again and release.
- Beeps will sound to confirm.
- The blue LED will flash slowly

Cancel Hold

- Press and release either Vol. up or Vol. Down button once.
- Beeps will sound to confirm.

Trouble shooting

If the headset does not operate please ensure the following:

- The Bluetooth feature is activated on the phone
- The headset is on and it is paired with the phone
- The headset is with a distance of 10 metres from the phone

If the above fails you may reset the headset by pressing the Call, Vol. up and Vol. down buttons simultaneously.

Remove Pairing

To remove a paired device on the headset, for instance to change default user of the headset:

- Press and hold the Call button to enter pairing mode.
- In pairing mode press the Call and Vol. up button simultaneously for 5 seconds.
- The headset turns off. Next time it turns on it is ready for pairing.

FCC Notice

This device complies with Part 15 of the FCC Rules. Operation is subject to the following two conditions: (1) this device may not cause harmful interference, and (2) this device must accept any interference received, including interference that may cause undesired operation.

Changes or modifications not expressly approved by Olympia for compliance could void the user's authority to operate the equipment.

Helpline Numbers

If you have any questions about the product or its operation please contact us at one of the numbers below:

USA 1-866-537-0384

GERMANY 49 - (0)180-51-98-00-0

UK 44 (0)87 085 000 50

www.olympia-life.com

