



B8

# User manual



Register your product and get support at  
[www.philips.com/support](http://www.philips.com/support)







# Contents

<b>1 Important</b>	2	<b>7 Product specifications</b>	18
Important safety instructions	2		
Care for your product	3	<b>8 Troubleshooting</b>	19
Care of the environment	3		
Help and support	4	<b>9 Notice</b>	21
		Notice of compliance	21
<b>2 Your product</b>	4		
Main unit	4		
Remote control	5		
Connectors	6		
Wireless subwoofer	6		
<b>3 Connect</b>	7		
Placement	7		
Pair up with the subwoofer	8		
Connect audio from TV	8		
Connect audio from other devices	10		
Connect digital devices through HDMI	11		
<b>4 Use your product</b>	11		
Set clock	11		
Auto standby	12		
Adjust the volume	12		
Dolby Atmos®	12		
Choose your sound	13		
Play audio through Bluetooth	14		
Connect Bluetooth via NFC	15		
MP3 player	15		
USB storage devices	15		
Set display brightness	16		
Apply factory settings	16		
<b>5 Update software</b>	17		
Check software version	17		
Update software via USB	17		
<b>6 Wall mount</b>	18		





# 1 Important

Read and understand all instructions before you use your product. If damage is caused by failure to follow instructions, the warranty does not apply.

## Important safety instructions

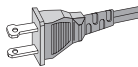
- Read these instructions.
- Keep these instructions.
- Heed all warnings.
- Follow all instructions.
- Do not use this apparatus near water.
- Clean only with dry cloth.
- Do not block any ventilation openings. Install in accordance with the manufacturer's instructions.
- Do not install near any heat sources such as radiators, heat registers, stoves, or other apparatus (including amplifiers) that produce heat.
- Do not defeat the safety purpose of the polarized or grounding-type plug. A polarized plug has two blades with one wider than the other. A grounding type plug has two blades and a third grounding prong. The wide blade or the third prong are provided for your safety. If the provided plug does not fit into your outlet, consult an electrician for replacement of the obsolete outlet.
- Protect the power cord from being walked on or pinched, particularly at plugs, convenience receptacles, and the point where they exit from the apparatus.



- Only use attachments/accessories specified by the manufacturer.
- Use only with the cart, stand, tripod, bracket or table specified by the manufacturer or sold with the apparatus. When a cart is used, use caution when moving the cart/apparatus combination to avoid injury from tip-over. 
- Unplug this apparatus during lightning storm or when unused for long periods of time.
- Refer all servicing to qualified service personnel. Servicing is required when the apparatus has been damaged in any way, such as power-supply cord or plug is damaged, liquid has been spilled or objects have fallen into the apparatus, the apparatus has been exposed to rain or moisture, does not operate normally, or has been dropped.
- Battery usage CAUTION – To prevent battery leakage which may result in bodily injury, property damage, or damage to the unit:
  - Install all batteries correctly, + and - as marked on the unit.
  - Do not mix batteries (old and new or carbon and alkaline, etc.).
  - Remove batteries when the unit is not used for a long time.
  - The batteries shall not be exposed to excessive heat such as sunshine, fire or the like.
  - Perchlorate Material - special handling may apply. See [www.dtsc.ca.gov/hazardouswaste/perchlorate](http://www.dtsc.ca.gov/hazardouswaste/perchlorate).
- The product/remote control may contain a coin/button type battery, which can be swallowed. Keep the battery out of reach of children at all times! If swallowed, the battery can cause serious injury or death.



Severe internal burns can occur within two hours of ingestion.

- If you suspect that a battery has been swallowed or placed inside any part of the body, seek immediate medical attention.
- When you change the batteries, always keep all new and used batteries out of reach of children. Ensure that the battery compartment is completely secure after you replace the battery.
- If the battery compartment cannot be completely secured, discontinue use of the product. Keep out of reach of children and contact the manufacturer.
- **Apparatus shall not be exposed to dripping or splashing.**
- **Do not place any sources of danger on the apparatus** (for example, liquid filled objects, lighted candles).
- This apparatus may contain lead and mercury. Dispose according to local, State or Federal laws. For disposal or recycling information, please contact your local authorities. For additional assistance on recycling options, please contact [www.mygreenelectronics.com](http://www.mygreenelectronics.com) or [www.eiae.org](http://www.eiae.org) or [www.recycle.philips.com](http://www.recycle.philips.com).
- Where the MAINS plug or an appliance coupler is used as the disconnect device, the disconnect device shall remain readily operable.
- Do not place this apparatus on the furniture that is capable of being tilted by a child and an adult leaning, pulling, standing or climbing on it. A falling apparatus can cause serious injury or even death.
- This apparatus should not be placed in a built-in installation such as a bookcase or rack unless proper ventilation is provided. Make sure to

leave a space of 7.8 inches (20cm) or more around this apparatus.

### Class II equipment symbol



This symbol indicates that the unit has a double insulation system.

### Know these safety symbols



This 'bolt of lightning' indicates uninsulated material within your unit may cause an electrical shock. For the safety of everyone in your household, please do not remove product covering.



The 'exclamation point' calls attention to features for which you should read the enclosed literature closely to prevent operating and maintenance problems.

**WARNING:** To reduce the risk of fire or electric shock, this apparatus should not be exposed to rain or moisture and objects filled with liquids, such as vases, should not be placed on this apparatus.

**CAUTION:** To prevent electric shock, match wide blade of plug to wide slot, fully insert.

---

## Care for your product

Use only microfiber cloth to clean the product.

---

## Care of the environment

### Disposal of your old product and battery



Your product is designed and manufactured with high quality





materials and components, which can be recycled and reused.

This product may contain lead and mercury. Disposal of these materials may be regulated due to environmental considerations. For disposal or recycling information, please contact your local authorities or visit [www.recycle.philips.com](http://www.recycle.philips.com).

This product contains batteries:

- Dispose of batteries properly. Do not incinerate. Batteries may explode if overheated.
- Do not wrap in metal or aluminum foil. Wrap in newspaper before discarding.
- It is suggested that you contact your local town or city to determine proper battery redemption site(s) in your area.
- Please visit [www.call2recycle.org](http://www.call2recycle.org) for additional information on a recycling center in your area for rechargeable batteries.

## Help and support

For extensive online support, visit [www.philips.com/support](http://www.philips.com/support) to:

- download the user manual and the quick start guide
- watch video tutorials (available only for selected models)
- find answers to frequently answered questions (FAQs)
- email us a question
- chat with our support representative.

Follow the instructions on the website to select your language, and then enter your product model number. Alternatively, you can contact Consumer Care in your country. Before you contact, note down the model number and serial number of your product. You can find this information on the back or bottom of your product.

## 2 Your product

Congratulations on your purchase, and welcome to Philips! To fully benefit from the support that Philips offers (e.g. notification of product software upgrade), register your product at [www.philips.com/welcome](http://www.philips.com/welcome).

### Main unit

This section includes an overview of the main unit.

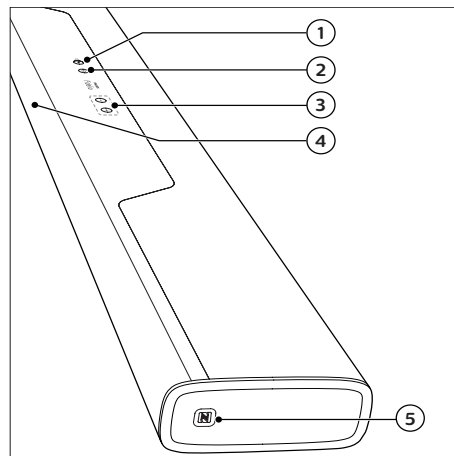

- ①
  - Switch this product on or to standby.
  - When this product is in standby, the standby indicator turns red.
- ② Select an input source for this product.
- ③ **+/- (Volume)** Increase or decrease volume.

#### ④ Display panel

#### ⑤ NFC tag

Tap the NFC-enabled device on the tag for Bluetooth connection.

## Remote control

This section includes an overview of the remote control.

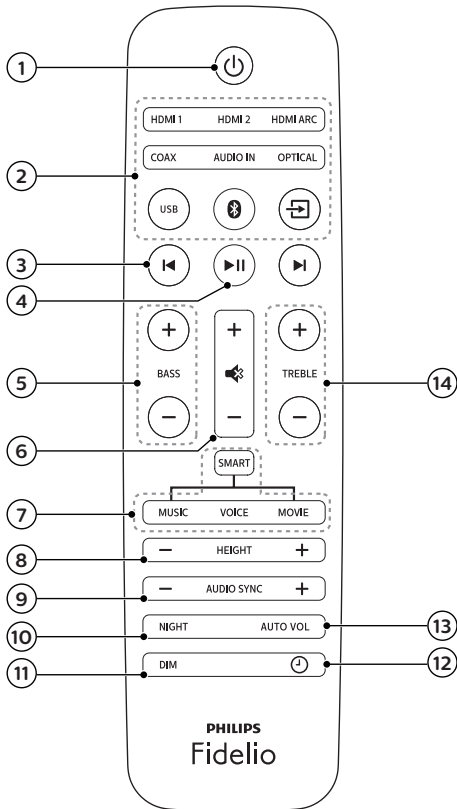

#### ①

Switch this product on or to standby.

#### ② Source buttons

- **HDMI ARC:** Switch your source to HDMI ARC connection.
- **HDMI 1:** Switch your source to the HDMI IN 1 connection.
- **HDMI 2:** Switch your source to the HDMI IN 2 connection.
- **COAX:** Switch your audio source to the coaxial connection.
- **OPTICAL:** Switch your audio source to the optical connection.
- **AUDIO IN:** Toggle audio source between AUX and AUDIO IN connection (3.5mm jack).
- **USB:** Switch to USB mode.
- : Switch to Bluetooth mode.
- : Select an input source for this product.

#### ③

Skip to the previous or next track in USB and Bluetooth mode.

#### ④

Start, pause or resume play in USB and Bluetooth mode.

#### ⑤ BASS +/-

Increase or decrease bass.

#### ⑥ Volume control

- +/-: Increase or decrease volume.
- : Mute or restore volume.

#### ⑦ Sound mode control

- **SMART:** Automatically select a predefined sound mode to suit your video or music.
- **MUSIC:** Select stereo sound mode.
- **VOICE:** Select voice clarity sound mode.
- **MOVIE:** Select surround sound mode.

#### ⑧ HEIGHT +/-

Select a height effect level for Dolby Atmos.

- ⑨ **AUDIO SYNC +/-**  
Increase or decrease audio delay.
- ⑩ **NIGHT**  
Turn night mode on or off.
- ⑪ **DIM**  
Set the brightness of the display panel for this product.
- ⑫ **⌚**  
Set clock or display clock.
- ⑬ **AUTO VOL.**  
Turn auto volume on or off.
- ⑭ **TREBLE +/-**  
Increase or decrease treble.

- ④ **DC IN**  
Connect to the power supply.
- ⑤ **AUDIO IN**  
Connect to an audio output on a device via AUDIO IN or AUX source (by pressing repeatedly **AUDIO IN** on the remote control).
- ⑥ **OPTICAL IN**  
Connect to an optical audio output on the TV or a digital device.
- ⑦ **COAXIAL IN**  
Connect to a coaxial audio output on the TV or a digital device.

## Connectors

This section includes an overview of the connectors available on this product.

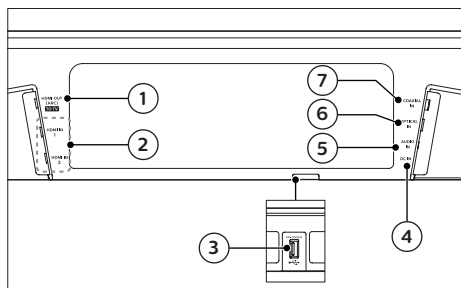

- ① **HDMI OUT (ARC) - TO TV**  
Connect to the HDMI input on the TV.
- ② **HDMI IN1 / HDMI IN2**  
Connect to the HDMI output on a digital device.
- ③ **USB**
  - Connect to a USB storage device for audio media play.
  - Upgrade software of this product.

## Wireless subwoofer

This product comes with a wireless subwoofer.

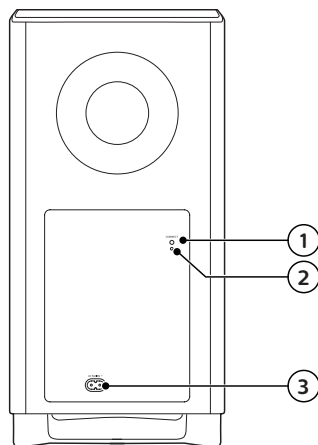

- ① **Connect (connect)**  
Press to enter the pairing mode for the subwoofer.
- ② **Subwoofer indicator**
  - When the power is turned on, the indicator lights up.





- During wireless pairing between the subwoofer and the main unit, the indicator blinks white quickly.
- When the pairing succeeds, the indicator lights up white.
- When the pairing fails, the indicator blinks white slowly.
- When wireless connection is disconnected for 1 minute, the indicator turns off.

③ **AC MAINS~**  
Connect to the power supply.

## 3 Connect

This section helps you connect this product to a TV and other devices. For information about the basic connections of this product and accessories, see the quick start guide.

### Note

- For identification and supply ratings, see the type plate at the back or bottom of the product.
- Before you make or change any connections, make sure that all devices are disconnected from the power outlet.

## Placement

Place the subwoofer at least 1 meter (3 feet) away from the main unit, and 10 centimeters (4 inches) away from the wall.

For best results, place your subwoofer as shown below.

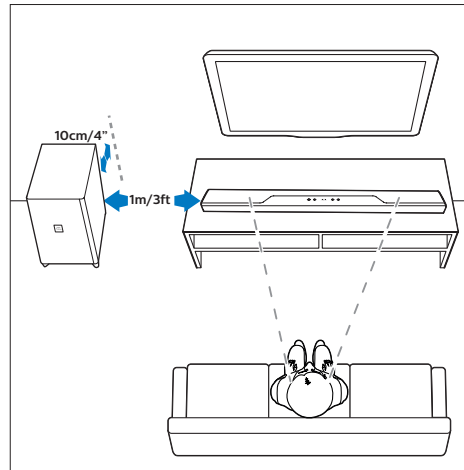



## Pair up with the subwoofer

The wireless subwoofer automatically pairs up with the main unit for wireless connection when you turn on the main unit and the subwoofer. If no audio from the wireless subwoofer can be heard, manually pair up the subwoofer.

- 1 Turn on the main unit and the subwoofer.
  - ↳ If the connection to the main unit is lost, the indicator on the subwoofer blinks white slowly.
- 2 Press the **CONNECT** (connect) button on the subwoofer to enter the pairing mode.
  - ↳ The indicator on the subwoofer blinks white quickly.
- 3 In HDMI ARC mode (press **HDMI ARC**), on the remote control, within six seconds, press **⏪** twice then **Volume +** once, and then hold down **BASS +**.
  - ↳ If the pairing succeeds, the indicator on the subwoofer lights up white.
  - ↳ If the pairing fails, the indicator on the subwoofer blinks white slowly.
- 4 If the pairing fails, repeat the steps above.

### Note

- If the wireless dis-connection or pairing up lasts 1 minute, the subwoofer automatically switches to standby and the LED on the subwoofer turns off.

## Connect audio from TV

Connect this product to a TV. You can listen to audio from TV programs through the speakers of this product.

### Option 1: Connect to TV through HDMI (ARC)

#### Best quality audio

This product supports HDMI with Audio Return Channel (ARC). With the ARC feature, you can hear the TV audio through this product by using a single HDMI cable.

#### What you need

- A High Speed HDMI Cable.
- Your TV supports both HDMI ARC and HDMI-CEC (see the TV user manual for details).
- For some TV models, enable the external speaker output from the TV setting menu (see the TV user manual for details).

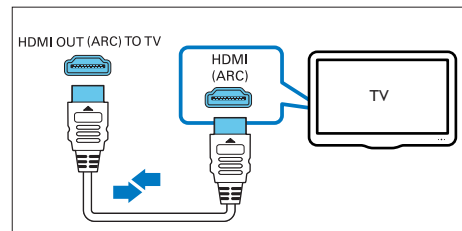

- 1 Using a High Speed HDMI cable, connect the **HDMI OUT (ARC) - TO TV** connector on this product to the **HDMI ARC** connector on the TV.
  - The **HDMI ARC** connector on the TV might be labeled differently. For details, see the TV user manual.
- 2 On your TV, turn on HDMI-CEC operations.





- For HDMI-CEC issues on your TV, see the TV user manual to make sure that the HDMI-CEC setup is correct, or contact the TV manufacturer if needed.

**3** Press **HDMI ARC** on the remote control of this product to enable the HDMI ARC connection.

#### Note

- 100% interoperability with all HDMI-CEC devices is not guaranteed.
- If your TV is not HDMI ARC compliant, connect an audio cable to hear the TV audio through this product.

### Option 2: Connect to TV through optical cable

Best quality audio

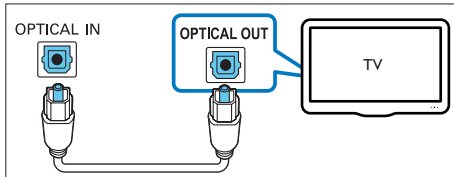

- 1 Using an optical cable, connect the **OPTICAL IN** connector on this product to the optical output on the TV.
  - The digital optical output on the TV might be labeled **OPTICAL OUT**, **SPDIF** or **SPDIF OUT**.
- 2 Press **OPTICAL** on the remote control of this product to enable the optical connection.

### Option 3: Connect to TV through coaxial cable

Best quality audio

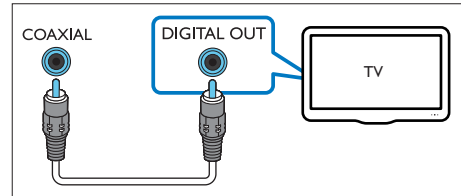

- 1 Using a coaxial cable, connect the **COAXIAL IN** connector on this product to the coaxial output on the TV.
  - The digital coaxial output on the TV might be labeled **COAXIAL/DIGITAL OUT** or **DIGITAL AUDIO OUT**.
- 2 Press **COAX** on the remote control of this product to enable the coaxial connection.

### Option 4: Connect to TV through analog audio cables

Basic quality audio

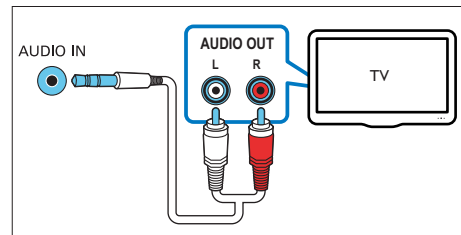

- 1 Using an analog cable, connect the **AUDIO IN** (3.5mm jack) on this product to the analog audio output (red and white) on the TV.
  - The analog audio output on the external device might be labeled **AUDIO OUT**.





- 2 Press repeatedly **AUDIO IN** on the remote control until **AUX** is displayed on the display panel.

## Connect audio from other devices

You may also play audio from other devices through the speakers of this product.

### Option 1: Connect to other device through optical cable

Best quality audio

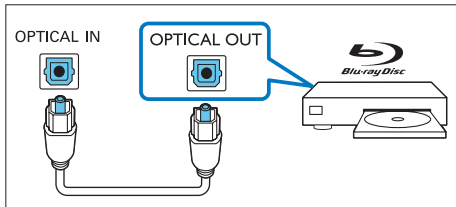

- 1 Using an optical cable, connect the **OPTICAL IN** connector on this product to the optical output on the external device.
  - The digital optical output on the external device might be labeled **OPTICAL OUT**, **SPDIF** or **SPDIF OUT**.
- 2 Press **OPTICAL** on the remote control of this product to enable the optical connection.

### Option 2: Connect to other device through coaxial cable

Best quality audio

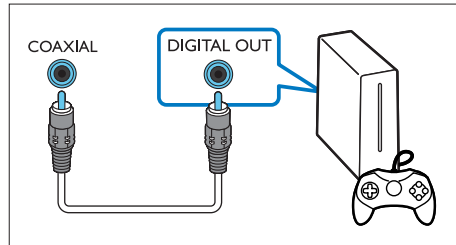

- 1 Using a coaxial cable, connect the **COAXIAL** connector on this product to the coaxial output on the external device.
  - The digital coaxial output on the external device might be labeled **COAXIAL/DIGITAL OUT** or **DIGITAL AUDIO OUT**.
- 2 Press **COAX** on the remote control of this product to enable the coaxial connection..

### Option 3: Connect to other device through analog audio cables

Basic quality audio

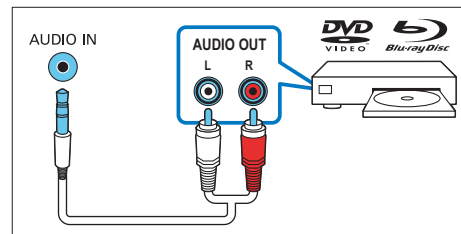

- 1 Using an analog cable, connect the **AUDIO IN** (3.5mm jack) on this product to the analog audio output (red and white) on the external device.





- The analog audio output on the external device might be labeled **AUDIO OUT**.

- 2 Press repeatedly **AUDIO IN** on the remote control until **AUX** is displayed on the display panel.

## Connect digital devices through HDMI

Connect a digital device such as a set-top box, DVD/Blu-ray player, or games console to this product through a single HDMI connection. When you connect the devices in this way and play a file or game, the

- video is automatically displayed on your TV, and
- audio is automatically played on this product.

- 1 Using a High Speed HDMI cable, connect the **HDMI OUT** connector on your digital device to the **HDMI IN 1/2** on this product.
- 2 Using a High Speed HDMI cable, connect the **HDMI OUT (ARC) - TO TV** connector on this product to the **HDMI** connector on the TV.
  - On your TV and the connected device, turn on HDMI-CEC controls (if available). For details, see the user manual of the TV and the device.
- 3 Press **HDMI 1/2** on the remote control of this product to enable the HDMI IN connection.
  - If the TV is not HDMI-CEC compliant, select the correct video input on your TV.

## 4 Use your product

This section helps you use this product to play media from a wide range of sources.

### Before you start

- Make the necessary connections described in Quick start guide and User manual.
- Switch this product to the correct source for the other devices.

## Set clock

Through clock setting, you may select a type of standby (ECO standby without clock display, or normal standby with clock display ).

- 1 Switch this product to standby (press  $\phi$ ).
  - ↳ --:-- (or clock) is displayed.
- 2 Press and hold  $\odot$  to activate the clock setting mode.
  - ↳ --:-- blinks.
- 3 Press **Volume +/-** to select 12 hour or 24 hour format, then press  $\odot$  to confirm.
  - If 12 hour format is selected, then select AM or PM for display.
    - ↳ The hour digits begin to blink.
- 4 Press **Volume +/-** to set the hour, then press  $\odot$  to confirm.
  - ↳ The minute digits begin to blink.
- 5 Press **Volume +/-** to set the minute, then press  $\odot$  to confirm.
  - ↳ ECO begins to blink.



- 6** Press **Volume +/-** to select “ECO” or “CLOCK”, then press **⏻** to confirm.
- ↳ If you select “ECO”, in standby, the clock is displayed for 1 minute then the display is switched off.
  - ↳ If you select “CLOCK”, in standby, the clock is always displayed.

- To restore the sound, press **🔊** again or press **Volume +/-**.

## View clock

- 1** In ECO standby or operation mode, press **⏻**.
- ↳ In ECO standby mode, the clock is displayed for 1 minute, then the display is switched off.
  - ↳ In operation mode, the clock is displayed 5 seconds, then the display is switched to the current source information.

### Note

- If AC power is disconnected, the clock time can only be retained for 24 hours.
- Extreme room temperature affects clock accuracy.

## Auto standby

When playing media from a connected device, this product automatically switches to standby after 15 minutes of button inactivity and no audio/video play from a connected device.

## Adjust the volume

- 1** Press **Volume +/-** to increase or decrease a volume level.
- To mute sound, press **🔊**.

## Dolby Atmos®

In addition to horizontal distribution of 5-channel audio, this product also has built-in Dolby Atmos enabled speakers as additional audio channels to generate overhead distribution of audio for powerful delivery of 3D sound immersion and greater reality.

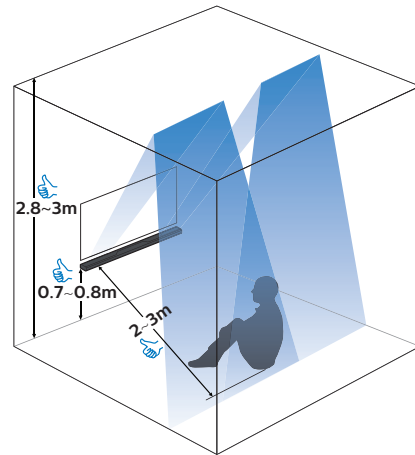

### Optimal setup for Dolby Atmos sound

- Place this product at a height of 0.7m - 0.8m.
- Ceiling height is 2.8m - 3m.
- Listening distance from this product is 2m - 3m.
- Ceiling is not made of sound absorbent material.
- Preferably no protrusive objects (such as lighting and decorations) are on the ceiling.

Best Dolby Atmos effects may achieve through the following two use cases.

#### From your Blu-ray disc player:

- Movie with Dolby Atmos.



- Your Blu-ray disc player is connected to this product via **HDMI IN 1/2** connector.
- On your Blu-ray disc player, enable bitstream/raw audio format for HDMI sound output.
- A high speed HDMI cable.

#### ***From your TV:***

- Movie with Dolby Atmos.
- Your TV supports Dolby Atmos bitstream/raw output.
- Your TV is connected to this product via **HDMI ARC** connector.
- A high speed HDMI cable.



#### **Note**

- For details on how to connect your Blu-ray disc player to this product via **HDMI IN 1/2** connector, see "Connect" > "Connect digital devices through HDMI" in the user manual.

## **Enjoy Dolby Atmos sound**

- 1 Press **HEIGHT +/-** to select a height surround effects level to best suit your personal taste according to your environment.
  - **OFF**: no height effect.
  - **HEIGHT LOW**: small height effect.
  - **HEIGHT MEDIUM**: medium height effect.
  - **HEIGHT HIGH**: big height effect.



#### **Note**

- For non-HDMI connections (such as use of USB, Bluetooth, OPTICAL and COAXIAL), only limited height surround effects are generated.

## **Choose your sound**

This section helps you choose the ideal sound for your video or music.

### **Sound mode**

Select predefined sound modes to suit your video or music.

- Press **MOVIE** to create a surround listening experience. Ideal for watching movie.
- Press **MUSIC** to create two-channel or multi-channel stereo. Ideal for listening to music.
- Press **VOICE** to create sound effect which makes human voice more clear and outstanding for listening.
- Press **SMART** to automatically select a predefined sound mode (**MOVIE**, **MUSIC** or **VOICE**) based on input audio content to optimize audio performance.

### **Equalizer**

Change the high frequency (treble) and low frequency (bass) settings of this product.

- 1 Press **TREBLE +/-** or **BASS +/-** to change the frequency.

### **Synchronize video and sound**

If the audio and video are not synchronized, delay the audio to match the video.

- 1 Press **AUDIO SYNC +/-** to synchronize the audio with the video.

### **Auto volume**

Turn the auto volume on to keep the volume constant when you switch to a different source.



It also compresses the sound dynamics, increasing the volume for quiet scenes and decreasing the volume for loud scenes.

- 1 Press **AUTO VOL.** to turn auto volume on or off.
  - ↳ When auto volume is turned on, **ON AUTO VOLUME** scrolls once on the display panel.
  - ↳ When auto volume is turned off, **OFF AUTO VOLUME** scrolls once on the display panel.

## Night mode

For quiet listening, night mode decreases the volume of loud sounds when audio is played. Night mode is only available for Dolby Digital soundtracks.

- 1 Press **NIGHT** to turn night mode on or off.
  - When night mode is turned on, **ON NIGHT** scrolls once on the display panel.
  - When night mode is turned off, **OFF NIGHT** scrolls once on the display panel.



### Note

- If you turn on auto volume, night mode (if activated) will be automatically turned off, and vice versa.

## Play audio through Bluetooth

Through Bluetooth, connect this product with your Bluetooth device (such as an iPad, iPhone, iPod touch, Android phone, or laptop), and then you can listen to the audio files stored

on the device through the speakers of this product.

### What you need

- A Bluetooth device which supports Bluetooth profile A2DP, AVRCP and with Bluetooth version as 3.0.
- The maximum operational range between this product and a Bluetooth device is approximately 10 meters (30 feet).

- 1 Press **0** on the remote control to switch this product to Bluetooth mode.
  - ↳ **BT** is displayed on the display panel, blinking.
- 2 On the Bluetooth device, switch on Bluetooth, search for and select **Fidelio B8** to start connection (see the user manual of the Bluetooth device on how to enable Bluetooth).
  - ↳ During connection, **BT** on the display panel blinks.
- 3 Wait until this product beeps.
  - ↳ When the Bluetooth connection succeeds, **BT** is displayed on the display panel.
  - ↳ If the connection fails, **BT** on the display panel blinks continuously.
- 4 Select and play audio files or music on your Bluetooth device.
  - During play, if a call is coming, music play is paused.
  - If your Bluetooth device supports AVRCP profile, on the remote control you can press **◀** / **▶** to skip to a track, or press **▶||** to pause/resume play.
- 5 To exit Bluetooth, select other source.





- When your switch back to Bluetooth mode, Bluetooth connection remains active.



#### Note

- The music streaming may be interrupted by obstacles between the device and this product, such as wall, metallic casing that covers the device, or other devices nearby that operate in the same frequency.
- If you want to connect this product with another Bluetooth device, press and hold **0** on the remote control to disconnect the currently connected Bluetooth device.

---

## Connect Bluetooth via NFC

NFC (Near Field Communication) is a technology that enables short-range wireless communication between NFC-enabled devices, such as mobile phones.

#### What you need

- A Bluetooth device with NFC function.
- For pairing, tap the NFC device on the **NFC** tag of this product.

- 1** Enable NFC on the Bluetooth device (see the device's user manual for details).
- 2** Tap the NFC device onto the **NFC** tag of this product until this product beeps.
  - ↳ When the Bluetooth connection succeeds, **BT** is displayed on the display panel.
  - ↳ If the connection fails, **BT** on the display panel blinks continuously.
- 3** Select and play audio files or music on your NFC device.

- To break the connection, tap again the NFC device onto the NFC tag on this product.

---

## MP3 player

Connect your MP3 player to play your audio files or music.

#### What you need

- An MP3 player.
- A 3.5mm stereo audio cable.

- 1** Using the 3.5mm stereo audio cable, connect the MP3 player to the **AUDIO IN** connector on this product.
- 2** Press repeatedly **AUDIO IN** on the remote control until **AUDIO IN** is displayed on the display panel.
- 3** Press the buttons on the MP3 player to select and play audio files or music.

---

## USB storage devices

Enjoy audio on a USB storage device, such as an MP3 player and USB flash memory, etc.

#### What you need

- A USB storage device that is formatted for FAT16 or FAT32 file systems, and complies with the Mass Storage Class.
- An MP3 file on a USB storage device.

- 1** Connect a USB storage device to this product.
- 2** Press **USB** on the remote control.
- 3** Use the remote control to control play.



- Press **▶||** to start, pause or resume play.
- Press **◀/▶** to skip to the previous or next track.
- During USB play, press **USB** to select one of the following play modes.
  - **ALL RPT**: repeat all the tracks in one folder.
  - **OFF RPT**: repeat mode is turned off.

### Note

- Support a USB storage device up to 32GB.
- This product may not be compatible with certain types of USB storage device.
- If you use a USB extension cable, USB HUB, or USB multi-reader, the USB storage device may not be recognized.
- Digital camera PTP and MTP protocols are not supported.
- Do not remove the USB storage device while it is being read.
- DRM-protected music files (MP3) are not supported.
- Support a USB port: 5V  $\overline{=}$ , 500mA.

- 1 In HDMI ARC mode (press **HDMI ARC**), on the remote control, within six seconds, press **⌘** twice then **Volume -** once, and then hold down **BASS -**.
  - ↳ When the factory settings restore is complete, the product automatically switches off and restarts.

---

## Set display brightness

You can press **DIM** repeatedly to select a different brightness level of the display panel on this product.  
If you select **AUTO OFF**, LED message is switched off after 10 seconds of button inactivity.

---

## Apply factory settings

In case of no response from this product, you can reset this product to the default settings programmed at the factory.





## 5 Update software

To get the best features and support, update your product with the latest software.

### Check software version

In HDMI ARC mode (press **HDMI ARC**), on the remote control, within six seconds, press  twice then **TREBLE -** once, and then hold down **BASS -**.

↳ The software version number is displayed on the display panel.

### Update software via USB



#### Caution

- Do not turn off the power or remove the USB flash drive when the software update is in progress because you might damage this product.

- 1 Check the latest software version on [www.philips.com/support](http://www.philips.com/support).
  - Search for your model and click on "Software and drivers".
- 2 Download the software into a USB flash drive.
  - ① Unzip the downloaded file, and make sure that the unzipped folder is named "UPG".
  - ② Put the "UPG" folder in the root directory.
- 3 Connect the USB flash drive to the **USB** connector on this product.

- 4 Switch this product to HDMI ARC source (press **HDMI ARC**).
- 5 On the remote control, within 6 seconds press  twice then **Volume +** once, and then hold down **MOVIE**.
  - ↳ "UPGRADE" (upgrade) is displayed briefly, then upgrade progress is indicated.
  - ↳ If a USB flash drive is not connected or invalid upgrade file is found, "ERROR" (error) is displayed on the display panel.
- 6 Wait until the upgrade is completed.
  - ↳ If the upgrade is complete, this product automatically turns off and on again.



#### Note

- The upgrade time may take around 8 minutes.

## 6 Wall mount

### Note

- Before wall mounting, make sure the wall can support the weight of this product.
- For wall mounting, this product must be securely attached to the wall in accordance with the installation instructions. Improper wall mounting may result in accident, injury or damage. If you have any query, contact Consumer Care in your country.

### Screw length/diameter

Depending on the type of wall mounting this product, make sure that you use screws of a suitable length and diameter.

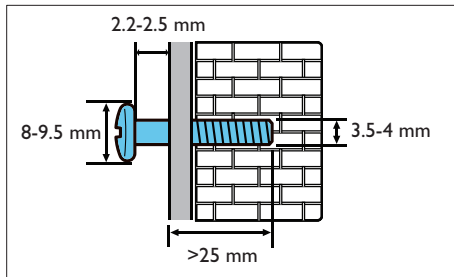

See the illustration in the quick start guide on how to wall mount this product.

- 1) Use the supplied paper template to mark two holes on the wall, then secure two suitable screws in the holes.
- 2) Fix the two supplied wall brackets on this product.
- 3) Hang this product on the wall.

## 7 Product specifications

### Note

- Specifications and design are subject to change without notice.

### Amplifier

- Total output power: 400W RMS (+/- 0.5 dB, 10% THD)
- Frequency response: 20 Hz-20 kHz / ±3 dB
- Signal-to-noise ratio: > 65 dB (CCIR) / (A-weighted)
- Input sensitivity:
  - AUX: 1900 mV
  - AUDIO IN: 900 mV

### Audio

- S/PDIF Digital audio input:
  - Coaxial: IEC 60958-3
  - Optical: TOSLINK

### USB

- Compatibility: Hi-Speed USB (2.0)
- Class support: USB Mass Storage Class (MSC)
- File system: FAT16, FAT32
- Supports MP3 file format

### Bluetooth

- Bluetooth profiles: A2DP, AVRCP
- Bluetooth version: 3.0



## Main unit

- Power supply:
  - Model (Philips branded AC power adapter): DYS902-190473W
  - Input: 100–240 V~, 50/60 Hz 1.5 A
  - Output: 19V  $\overline{=}$ , 4.73A
- Standby without clock display:  $\leq 0.5$  W
- Standby with clock display:  $\leq 1$  W
- Dimensions (W x H x D): 1058 x 52 x 120 mm
- Weight: 3.65 kg
- **Built-in speakers**
  - 6 x silk tweeter (1", 3 ohm)
  - 2 x silk tweeter (0.8", 8 ohm)
  - 4 x racetrack woofer speaker (3.5" x 1", 16 ohm)
  - Centre channel: 2 x racetrack full-range speaker (3.5" x 1", 16 ohm)
  - Front/surround channel: 4 x racetrack woofer speaker (3.5" x 1", 8 ohm)

## Subwoofer

- Power supply: 110–127V/220–240 V~, 50/60 Hz
- Power consumption: 60 W
- Standby power consumption:  $\leq 0.5$  W
- Impedance: 3 ohm
- Speaker drivers: 1 x 8" subwoofer
- Dimensions (W x H x D): 240 x 510 x 302 mm
- Weight: 8.9 kg

## Remote control batteries

- 2 x AAA-R03-1.5 V

# 8 Troubleshooting



## Warning

- Risk of electric shock. Never remove the casing of the product.

To keep the warranty valid, never try to repair the product yourself. If you have problems using this product, check the following points before you request service. If you still have a problem, get support at [www.philips.com/support](http://www.philips.com/support).

## Main unit

### The buttons on this product do not work.

- Disconnect this product from the power supply for a few minutes, then reconnect.

## Sound

### No sound from the speakers of this product.

- Connect the audio cable from this product to your TV or other devices. However, you do not need a separate audio connection when:
  - the product and TV are connected through **HDMI ARC** connection, or
  - a device is connected to the **HDMI IN** connector on this product.
- Reset this product to its factory settings.
- On the remote control, select the correct audio input.
- Make sure that this product is not muted.



### No sound from the wireless subwoofer.

- Wirelessly connect the subwoofer to the main unit.

### Distorted sound or echo.

- If you play audio from the TV through this product, make sure that the TV is muted.

### Audio and video are not synchronized.

- Press **AUDIO SYNC +/-** to synchronize the audio with the video.

### Error message is displayed on the display panel.

- When "ERROR" is displayed, it indicates that an input audio format is not supported.
- When "ARC" blinks, it indicates that the connected TV is not HDMI ARC compliant or an unsupported audio format is detected.

---

## Bluetooth

### A device cannot connect with this product.

- The device does not support the compatible profiles required for this product.
- You have not enabled the Bluetooth function of the device. See the user manual of the device on how to enable the function.
- The device is not correctly connected. Connect the device correctly.
- This product is already connected with another Bluetooth device. Disconnect the connected device, then try again.

### Quality of audio play from a connected Bluetooth device is poor.

- The Bluetooth reception is poor. Move the device closer to this product, or remove any obstacle between the device and this product.

### The connected Bluetooth device connects and disconnects constantly.

- The Bluetooth reception is poor. Move the device closer to this product, or remove any obstacle between the device and this product.
- Turn off Wi-Fi function on the Bluetooth device to avoid interference.
- For some Bluetooth, the Bluetooth connection can be deactivated automatically to save power. This does not indicate any malfunction of this product.

---

## NFC

### A device cannot connect with this product via NFC.

- Make sure that the device is supported by NFC.
- Make sure that NFC is enabled on the device (see the device's user manual for details).
- For pairing, tap the NFC device on the **NFC** tag of this product.

---

## Dolby Atmos

### Cannot achieve outstanding Dolby Atmos effects.

- For non-HDMI connections (such as use of USB, Bluetooth, OPTICAL and COAXIAL), limited height surround effects are generated. See the section of "Dolby Atmos" about how to achieve best Dolby Atmos effects.



# 9 Notice

This section contains the legal and trademark notices.

## Notice of compliance

The device complies with the FCC rules, Part 15. Operation is subject to the following two conditions:

- ① **This device may not cause harmful interference, and**
- ② **This device must accept any interference received, including interference that may cause undesired operation.**

### FCC rules

This equipment has been tested and found to comply with the limits for a Class B digital device, pursuant to part 15 of the FCC Rules. These limits are designed to provide reasonable protection against harmful interference in a residential installation. This equipment generates, uses and can radiate radio frequency energy and, if not installed and used in accordance with the instruction manual, may cause harmful interference to radio communications.

However, there is no guarantee that interference will not occur in a particular installation. If this equipment does cause harmful interference to radio or television reception, which can be determined by turning the equipment off and on, the user is encouraged to try to correct the interference by one or more of the following measures:

- Relocate the receiving antenna.
- Increase the separation between equipment and receiver.
- Connect the equipment into an outlet on a circuit different from that to which the receiver is connected.

- Consult the dealer or an experienced radio/TV technician for help.

### FCC Radiation Exposure

**Statement:** This equipment complies with FCC radiation exposure limits set forth for an uncontrolled environment. This equipment should be installed and operated with a minimum distance of 20cm between the radiator and your body. This transmitter must not be co-located or operated in conjunction with any other antenna or transmitter.

**Warning:** Any changes or modifications made to this device that are not expressly approved by Gibson Innovations may void the user's authority to operate the equipment.

Model number: B8/37

Trade Name: Philips

Responsible Party: Gibson Innovations USA Inc. PO BOX 100572, Nashville TN 37224

### Canada:

CAN ICES-3(B)/NMB-3(B)

This device complies with Industry Canada's licence-exempt RSSs.

Operation is subject to the following two conditions: (1) this device may not cause interference, and (2) this device must accept any interference, including interference that may cause undesired operation of the device.

The device meets the exemption from the routine evaluation limits in section 2.5 of RSS 102 and compliance with RSS-102 RF exposure, users can obtain Canadian information on RF exposure and compliance.

This transmitter must not be co-located or operating in conjunction with any other antenna or transmitter. This equipment should be installed and operated with a minimum distance of 20 centimeters between the radiator and your body.



Manufactured under license from Dolby Laboratories. Dolby, Dolby Atmos, and the double-D symbol are trademarks of Dolby Laboratories.



For DTS patents, see <http://patents.dts.com>. Manufactured under license from DTS Licensing Limited. DTS, the Symbol, & DTS and the Symbol together are registered trademarks, and DTS Digital Surround is a trademark of DTS, Inc. © DTS, Inc. All Rights Reserved.



The terms HDMI and HDMI High-Definition Multimedia Interface, and the HDMI Logo are trademarks or registered trademarks of HDMI Licensing LLC in the United States and other countries.



The Bluetooth® word mark and logos are registered trademarks owned by Bluetooth SIG, Inc. and any use of such marks by Gibson Innovations Limited is under license. Other trademarks and trade names are those of their respective owners.



The N Mark is a trademark or registered trademark of NFC Forum, Inc. in the United States and in other countries.



Qualcomm aptX is a product of Qualcomm Technologies International, Ltd. Qualcomm is a trademark of Qualcomm Incorporated, registered in the United States and other countries, used with permission. aptX is a trademark of Qualcomm Technologies International, Ltd., registered in the United States and other countries, used with permission.







## PHILIPS LIMITED WARRANTY ONE (1) YEAR

### WARRANTY COVERAGE:

PHILIPS warranty obligation is limited to the terms set forth below.

### WHO IS COVERED:

Philips warrants the product to the original purchaser or the person receiving the product as a gift against defects in materials and workmanship as based on the date of original purchase ("Warranty Period") from an Authorized Dealer. The original sales receipt showing the product name and the purchase date from an authorized retailer is considered such proof.

### WHAT IS COVERED:

The Philips warranty covers new products if a defect in material or workmanship occurs and a valid claim is received by Philips within the Warranty Period. At its option, Philips will either (1) repair the product at no charge, using new or refurbished replacement parts, or (2) exchange the product with a product that is new or which has been manufactured from new, or serviceable used parts and is at least functionally equivalent or most comparable to the original product in Philips current inventory, or (3) refund the original purchase price of the product.

Philips warrants replacement products or parts provided under this warranty against defects in materials and workmanship from the date of the replacement or repair for ninety (90) days or for the remaining portion of the original product's warranty, whichever provides longer coverage for you. When a product or part is exchanged, any replacement item becomes your property and the replaced item becomes Philips' property. When a refund is given, your product becomes Philips' property.

**Note:** Any product sold and identified as refurbished or renewed carries a ninety (90) day limited warranty.

Replacement product can only be sent if all warranty requirements are met. Failure to follow all requirements can result in delay.

### WHAT IS NOT COVERED - EXCLUSIONS AND LIMITATIONS:

This Limited Warranty applies only to the new products manufactured by or for Philips that can be identified by the trademark, trade name, or logo affixed to it. This Limited Warranty does not apply to any non-Philips hardware product or any software, even if packaged or sold with the product. Non-Philips manufacturers, suppliers, or publishers may provide a separate warranty for their own products packaged with the bundled product.

Philips is not liable for any damage to or loss of any programs, data, or other information stored on any media contained within the product, or any non-Philips product or part not covered by this warranty. Recovery or reinstallation of programs, data or other information is not covered under this Limited Warranty.

This warranty does not apply (a) to damage caused by accident, abuse, misuse, neglect, misapplication, or non-Philips product, (b) to damage caused by service performed by anyone other than Philips or Philips Authorized Service Location, (c) to a product or a part that has been modified without the written permission of

Philips, or (d) if any Philips serial number has been removed or defaced, or (e) product, accessories or consumables sold "AS IS" without warranty of any kind by including refurbished Philips product sold "AS IS" by some retailers.

### This Limited Warranty does not cover:

- Shipping charges to return defective product to Philips.
- Labor charges for installation or setup of the product, adjustment of customer controls on the product, and installation or repair of antenna/signal source systems outside of the product.
- Product repair and/or part replacement because of improper installation or maintenance, connections to improper voltage supply, power line surge, lightning damage, retained images or screen markings resulting from viewing fixed stationary content for extended periods, product cosmetic appearance items due to normal wear and tear, unauthorized repair or other cause not within the control of Philips.
- Damage or claims for products not being available for use, or for lost data or lost software.
- Damage from mishandled shipments or transit accidents when returning product to Philips.
- A product that requires modification or adaptation to enable it to operate in any country other than the country for which it was designed, manufactured, approved and/or authorized, or repair of products damaged by these modifications.
- A product used for commercial or institutional purposes (including but not limited to rental purposes).
- Product lost in shipment and no signature verification receipt can be provided.
- Failure to operate per Owner's Manual.

### TO OBTAIN ASSISTANCE IN THE U.S.A., CANADA, PUERTO RICO, OR U.S. VIRGIN ISLANDS...

Contact Philips Customer Care Center at:  
1-888-381-0749

REPAIR OR REPLACEMENT AS PROVIDED UNDER THIS WARRANTY IS THE EXCLUSIVE REMEDY FOR THE CONSUMER. PHILIPS SHALL NOT BE LIABLE FOR ANY INCIDENTAL OR CONSEQUENTIAL DAMAGES FOR BREACH OF ANY EXPRESS OR IMPLIED WARRANTY ON THIS PRODUCT. EXCEPT TO THE EXTENT PROHIBITED BY APPLICABLE LAW, ANY IMPLIED WARRANTY OF MERCHANTABILITY OR FITNESS FOR A PARTICULAR PURPOSE ON THIS PRODUCT IS LIMITED IN DURATION TO THE DURATION OF THIS WARRANTY.

Some states do not allow the exclusions or limitation of incidental or consequential damages, or allow limitations on how long an implied warranty lasts, so the above limitations or exclusions may not apply to you.

This warranty gives you specific legal rights. You may have other rights which vary from state/province to state/province.

Gibson Innovations USA Inc. PO BOX 100572 Nashville TN 37224

2016





Specifications are subject to change without notice

The Philips trademark and the Philips Shield Emblem are registered trademarks of Koninklijke Philips N.V. used under license.

2017 © Gibson Innovations Limited. All rights reserved.

This product has been manufactured by, and is sold under the responsibility of Gibson Innovations Ltd., and Gibson Innovations Ltd. is the warrantor in relation to this product.

B8\_37\_UM\_V1.0



## English

## SkyQuake

## B8 – Important

Read and understand all instructions before you use your product. If damage is caused by failure to follow instructions, the warranty does not apply.

### Important safety instructions



- Read these instructions.**
- Keep these instructions.**
- Heed all warnings.**
- Follow all instructions.**
- Do not use this apparatus near water.**
- Clean only with dry cloth.**
- Do not block any ventilation openings. Install in accordance with the manufacturer’s instructions.**
- Do not install near any heat sources** such as radiators, heat registers, stoves, or other apparatus (including amplifiers) that produce heat.
- Do not defeat the safety purpose** of the polarized or grounding–type plug. A polarized plug has two blades with one wider than the other. A grounding type plug has two blades and a third grounding prong. The wide blade or the third prong are provided for your safety. If the provided plug does not fit into your outlet, consult an electrician for replacement of the obsolete outlet.
- Protect the power cord** from being walked on or pinched, particularly at plugs, convenience receptacles, and the point where they exit from the apparatus.
- Only use attachments/accessories** specified by the manufacturer.
- Use only with the cart,** stand, tripod, bracket or table specified by the manufacturer or sold with the apparatus. When a cart is used, use caution when moving the cart/ apparatus combination to avoid injury from tip-over.
- Unplug this apparatus** during lightning storm or when unused for long periods of time.
- Refer all servicing** to qualified service personnel. Servicing is required when the apparatus has been damaged in any way, such as power-supply cord or plug is damaged, liquid has been spilled or objects have fallen into the apparatus, the apparatus has been exposed to rain or moisture, does not operate normally, or has been dropped.
- Battery usage CAUTION** - To prevent battery leakage which may result in bodily injury, property damage, or damage to the unit:
  - Install **all** batteries correctly, + and - as marked on the unit.
  - Do not mix batteries (**old and new** or **carbon** and **alkaline**, etc.).
  - Remove batteries when the unit is not used for a long time.
  - The batteries shall not be exposed to excessive heat such as sunshine, fire or the like.
  - Perchlorate Material - special handling may apply. See www.dtsc.ca.gov/hazardouswaste/perchlorate.
- The product/remote control may contain a coin/button type battery, which can be swallowed. Keep the battery out of reach of children at all times! If swallowed, the battery can cause serious injury or death. Severe internal burns can occur within two hours of ingestion.
- If you suspect that a battery has been swallowed or placed inside any part of the body, seek immediate medical attention.
- When you change the batteries, always keep all new and used batteries out of reach of children. Ensure that the battery compartment is completely secure after you replace the battery.
- If the battery compartment cannot be completely secured, discontinue use of the product. Keep out of reach of children and contact the manufacturer.
- Apparatus shall not be exposed to dripping or splashing.**
- Do not place any sources of danger on the apparatus** (for example, liquid filled objects, lighted candles).
- This apparatus may contain lead and mercury. Dispose according to local, State or Federal laws. For disposal or recycling information, please contact your local authorities. For additional assistance on recycling options, please contact www.mygreenelectronics.com or www.eiae.org or www.recycle.philips.com.
- Where the MAINS plug or an appliance coupler is used as the disconnect device, the disconnect device shall remain readily operable.
- Do not place this apparatus on the furniture that is capable of being tilted by a child and an adult leaning, pulling, standing or climbing on it. A falling apparatus can cause serious injury or even death.
- This apparatus should not be placed in a built-in installation such as a bookcase or rack unless proper ventilation is provided. Make sure to leave a space of 7.8 inches (20cm) or more around this apparatus.

Class II equipment symbol



This symbol indicates that the unit has a double insulation system.

Know these safety symbols

-  This ‘bolt of lightning’ indicates uninsulated material within your unit may cause an electrical shock. For the safety of everyone in your household, please do not remove product covering.
-  The ‘exclamation point’ calls attention to features for which you should read the enclosed literature closely to prevent operating and maintenance problems.

**WARNING:** To reduce the risk of fire or electric shock, this apparatus should not be exposed to rain or moisture and objects filled with liquids, such as vases, should not be placed on this apparatus.

**CAUTION:** To prevent electric shock, match wide blade of plug to wide slot, fully insert.

### Care for your product

Use only microfiber cloth to clean the product.

### Care of the environment

**Disposal of your old product and battery**

Your product is designed and manufactured with high quality materials and components, which can be recycled and reused. This product may contain lead and mercury. Disposal of these materials may be regulated due to environmental considerations. For disposal or recycling information, please contact your local authorities or visit www.recycle.philips.com.

This product contains batteries:

- Dispose of batteries properly. Do not incinerate. Batteries may explode if overheated.
- Do not wrap in metal or aluminum foil. Wrap in newspaper before discarding.
- It is suggested that you contact your local town or city to determine proper battery redemption site(s) in your area.
- Please visit www.call2recycle.org for additional information on a recycling center in your area for rechargeable batteries.

### Notice of compliance

The device complies with part 15 of the FCC Rules. Operation is subject to the following two conditions:

- This device may not cause harmful interference, and**
- This device must accept any interference received, including interference that may cause undesired operation.**

**FCC rules**

This equipment has been tested and found to comply with the limits for a Class B digital device, pursuant to part 15 of the FCC Rules. These limits are designed to provide reasonable protection against harmful interference in a residential installation. This equipment generates, uses and can radiate radio frequency energy and, if not installed and used in accordance with the instruction manual, may cause harmful interference to radio communications. However, there is no guarantee that interference will not occur in a particular installation. If this equipment does cause harmful interference to radio or television reception, which can be determined by turning the equipment off and on, the user is encouraged to try to correct the interference by one or more of the following measures:

- Relocate the receiving antenna.
- Increase the separation between equipment and receiver.
- Connect the equipment into an outlet on a circuit different from that to which the receiver is connected.
- Consult the dealer or an experienced radio/TV technician for help.

**FCC Radiation Exposure Statement:**This equipment complies with FCC radiation exposure limits set forth for an uncontrolled environment. This equipment should be installed and operated with a minimum distance of 20cm between the radiator and your body. This transmitter must not be co-located or operated in conjunction with any other antenna or transmitter.

**Warning:** Any changes or modifications made to this device that are not expressly approved by Gibson Innovations may void the user’s authority to operate the equipment.

Model number: B8/37

Trade Name: Philips

Responsible Party: Gibson Innovations USA Inc.

PO BOX 100572, Nashville TN 37224

**Canada:**

CAN ICES-3(B)/NMB-3(B)

This device complies with Industry Canada’s licence–exempt RSSs. Operation is subject to the following two conditions: (1) this device may not cause interference, and (2) this device must accept any interference, including interference that may cause undesired operation of the device.

The device meets the exemption from the routine evaluation limits in section 2.5 of RSS 102 and compliance with RSS–102 RF exposure, users can obtain Canadian information on RF exposure and compliance.

This transmitter must not be co-located or operating in conjunction with any other antenna or transmitter. This equipment should be installed and operated with a minimum distance of 20 centimeters between the radiator and your body.

### Help and support

For extensive online support, visit www.philips.com/support to:

- download the user manual and the quick start guide
- watch video tutorials (available only for selected models)
- find answers to frequently answered questions (FAQs)
- email us a question
- chat with our support representative.

Follow the instructions on the website to select your language, and then enter your product model number.

Alternatively, you can contact Consumer Care in your country. Before you contact, note down the model number and serial number of your product. You can find this information on the back or bottom of your product.

## Español

## Importante

Lea y asegúrese de comprender todas las instrucciones antes de usar el producto. La garantía no cubre los daños producidos por no haber seguido las instrucciones.

### Instrucciones de seguridad importantes

- Lea estas instrucciones.**
- Conserv e estas instrucciones.**
- Preste atención a todas las advertencias.**
- Siga todas las instrucciones.**
- No utilice este aparato cerca del agua.**
- Utilice únicamente un paño seco para la limpieza.**
- No bloquee las aperturas de ventilación. Realice la instalación de acuerdo con las indicaciones del fabricante.**
- No realice la instalación cerca de fuentes de calor** como radiadores, rejillas de calefacción, estufas u otros equipos que produzcan calor (incluso amplificadores).
- Utilice el conector polarizado o con conexión a tierra **de conformidad con las normas de seguridad**. Un enchufe polarizado cuenta con dos álabes, uno más ancho que el otro. Los conectores a tierra tienen dos conductores y una tercera terminal de contacto para la conexión a tierra. El conductor ancho o la tercera terminal de contacto con conexión a tierra se proveen para mayor seguridad. Si el enchufe suministrado no encaja correctamente en el tomacorriente, consulte a un electricista para reemplazar la toma.
- Proteja el cable de alimentación.** Evite pisar o doblar el cable, en particular a la altura del conector y las terminales de contacto del aparato.
- Utilice sólo los accesorios** que especifica el fabricante.
- Utilice sólo el carrito,** el soporte, el trípode y la mesa que indica el fabricante y los que incluye el equipo. Tenga cuidado cuando transporte el equipo en el carrito para evitar caídas y posibles lesiones.
- Desenchufe el equipo** durante tormentas eléctricas o cuando no se utilice por un período prolongado.
- Todos los trabajos de servicio técnico deben ser realizados** por personal de servicio calificado. Solicite el servicio de asistencia técnica cuando, por ejemplo, el cable de alimentación o el conector están dañados, si se derramó líquido o cayeron objetos dentro del aparato, si el equipo estuvo expuesto a la lluvia o humedad, si no funciona normalmente o si se cayó.
- PRECAUCIÓN:** para evitar que las baterías se sulfaten y puedan ocasionar lesiones, daños materiales o en la unidad:
  - Instale **todas** las baterías de forma correcta, de acuerdo con los signos + y - marcados en la unidad.
  - No utilice baterías de distintas clases (**nuevas y usadas** o de **carbón y alcalinas**, etc.).
  - Extraiga las pilas cuando no utilice la unidad durante un periodo prolongado.
  - No esponga las baterías a temperaturas altas como las que emiten la luz solar, el fuego u otros elementos similares.
  - Este producto contiene perclorato y puede requerir un método de manipulación especial. Visite www.dtsc.ca.gov/hazardouswaste/perchlorate.

- El producto/control remoto puede contener una batería tipo botón o moneda fácil de tragar. Siempre mantenga las baterías lejos del alcance de los niños. En caso de ingestión la batería podría causar lesiones graves o la muerte. Puede haber quemaduras internas graves en un plazo de dos horas tras la ingestión.
- Si sospecha que una batería se ha ingerido o introducido en cualquier parte del cuerpo, consulte inmediatamente a un médico.
- Al cambiar las baterías, mantenga siempre las baterías nuevas y usadas lejos del alcance de los niños. Verifique que el compartimiento de la batería esté bien cerrado luego de reemplazar la batería.
- Si el compartimiento de la batería no puede cerrarse, discontinúe el uso del producto. Manténgalo lejos del alcance de los niños y comuníquese con el fabricante.
- No esponga el equipo a goteos ni salpicaduras.**
- No coloque el aparato cerca de fuentes de peligr o** (por ejemplo, objetos que contengan líquidos o velas encendidas).
- Este aparato puede contener plomo y mercurio. Cumpla con la normativa local, estatal o nacional sobre eliminación de productos. Comuníquese con las autoridades locales para solicitar información sobre la eliminación o el reciclaje de productos. Para obtener más información sobre las opciones de reciclaje disponibles, ingrese en cualquiera de los siguientes sitios web: www.mygreenelectronics.com, www.eiae.org, www.recycle.philips.com.
- Si el conector de alimentación u otro conector se utilizan como dispositivos de desconexión, deben estar accesible y fáciles de operar.
- No coloque este aparato sobre muebles que adultos o niños puedan tirar, inclinar o utilizar para subirse sobre ellos. Si el aparato se cae, puede causar heridas graves o incluso la muerte.
- Este aparato no debe ubicarse en una instalación cerrada como una estantería o un rack, a menos que esté adecuadamente ventilada. Verifique que haya un espacio mínimo de 20 cm (7,8 pulg.) alrededor del aparato.

**Símbolo de equipo de Clase II**



Este símbolo indica que la unidad tiene un sistema de doble aislamiento.

**Conozca estos símbolos de seguridad**

-  El símbolo del rayo indica que los componentes sin aislamiento dentro de la unidad pueden generar descargas eléctricas. Para la seguridad de todas las personas de su hogar, no retire la cubierta del producto.

-  El signo de exclamación indica las características del producto que pueden provocar problemas de funcionamiento y mantenimiento. Por eso, se recomienda leer el manual de instrucciones.

**ADVERTENCIA:** Para reducir el riesgo de incendios o descargas eléctricas, no esponga el aparato a la lluvia ni a la humedad, ni coloque sobre él objetos que contengan líquidos (por ejemplo, jarrones).

**PRECAUCIÓN:** Para evitar descargas eléctricas, el conductor ancho debe introducirse por completo en la ranura adecuada.

### Protección del producto

Utilice únicamente un paño de microfibra para limpiar el producto.

### Cuidado del medio ambiente

**Eliminación del producto antiguo y las pilas**

Este producto ha sido diseñado y fabricado con materiales y componentes de alta calidad que pueden reciclarse y reutilizarse. Este producto puede contener plomo y mercurio. La eliminación de estos materiales puede estar sometida a regulaciones debido a consideraciones ambientales. Para obtener información sobre el desecho o reciclaje de estos materiales, comuníquese con las autoridades locales o visite www.recycle.philips.com.

Este producto contiene pilas:

- Deseche las baterías de forma adecuada. No las incinere. Las baterías pueden explotar si se sobrecalientan.
- No las envuelva en papel metálico ni de aluminio. Envuélvalas en papel de diario antes de desecharlas.
- Se recomienda comunicarse con los funcionarios locales pertinentes para obtener información acerca de centros de reciclaje autorizados.
- Visite www.call2recycle.org para obtener más información sobre centros de reciclaje para pilas recargables de su zona.

### Aviso de cumplimiento

El dispositivo cumple con los reglamentos de la FCC, apartado 15. El funcionamiento está sujeto a las siguientes condiciones:

- El dispositivo no debe causar interferencias nocivas y**
- debe recibir todo tipo de interferencias, incluso las que originan un funcionamiento indeseado.**

**Normas de la Comisión Federal de Comunicaciones (FCC)**

Este equipo se ha probado y se ha determinado que cumple con los límites para un dispositivo digital clase B, de acuerdo con el apartado 15 de las normativas de la FCC. Estos límites están destinados a ofrecer una protección razonable contra interferencias dañinas dentro de una instalación residencial. Este equipo genera, utiliza y puede emitir energía de radiofrecuencia. Si no se instala y utiliza de conformidad con el manual de instrucciones, puede ocasionar interferencias perjudiciales en las comunicaciones de radio. Sin embargo, no existe garantía de que no se producirá interferencia en una instalación en particular. Si este equipo provoca interferencias perjudiciales en la recepción de radio o televisión, lo que puede determinarse encendiendo y apagando el equipo, se recomienda al usuario intentar corregir la interferencia mediante una o varias de las siguientes medidas:

- Cambie la posición de la antena receptora.
- Aumente la distancia entre el equipo y el receptor.
- Conecte el equipo a un tomacorriente de un circuito diferente del que está conectado el receptor.
- Para obtener ayuda, comuníquese con el distribuidor o con un técnico de radio o televisión calificado.

**Normas sobre la exposición a campos de radiación de la FCC:** este equipo cumple con la normativa que regula los límites de exposición a la radiación de FCC para ambientes no controlados. Este equipo debe instalarse y utilizarse con una distancia mínima de 20 cm entre el radiador y el cuerpo. No coloque este aparato cerca de otros transmisores o antenas, ni lo utilice con este tipo de dispositivos.

**Advertencia:** Cualquier alteración o modificación a este dispositivo, que no cuente con la autorización expresa de Gibson Innovations, puede anular el derecho del usuario para utilizar el equipo.

Número de modelo: B8/37

Nombre comercial: Philips

Parte responsable: Gibson Innovations USA Inc.

PO BOX 100572, Nashville TN 37224

**Canadá:**

CAN ICES-3(B)/NMB-3(B)

Este dispositivo cumple con los RSSs exentos de licencia de Industry Canada. El funcionamiento queda sujeto a las siguientes dos condiciones: (1) este dispositivo no debe producir interferencias, y (2) debe recibir todo tipo de

interferencia, incluso aquellas que pueden causar un funcionamiento no deseado del dispositivo.

El dispositivo cumple con la exención de límites en la evaluación de rutina en la sección 2.5 de RSS 102 y cumple con la exposición RSS–102 RF, los usuarios pueden obtener información canadiense sobre la exposición y cumplimiento de RF.

No coloque este aparato cerca de otros transmisores o antenas, ni lo utilice junto a este tipo de dispositivos. Este equipo se debe instalar y manejar a una distancia mínima de 20 cm entre el radiador y su cuerpo.

**México:**

La operación de este equipo está sujeta a las siguientes dos condiciones: (1) es posible que este equipo o dispositivo no cause interferencia perjudicial y (2) este equipo o dispositivo debe aceptar cualquier interferencia, incluyendo la que pueda causar su operación no deseada.

### Ayuda y asistencia técnica

Para obtener una amplia asistencia en línea, visite www.philips.com/support para:

- descargar el manual de usuario y la guía de inicio rápido
- ver tutoriales de video (solo disponible para modelos seleccionados)
- buscar respuestas a preguntas frecuentes (FAQ)
- enviamos un correo electrónico con una pregunta
- chatear con nuestro representante de soporte.

Siga las instrucciones del sitio web para seleccionar su idioma e ingrese el número de modelo de su producto.

También puede ponerse en contacto con el servicio de atención al cliente de su país. Antes de ponerse en contacto, anote el modelo y número de serie del producto. Puede buscar esta información en la parte posterior o inferior del producto.

## Français

## Important

Lisez attentivement toutes les instructions avant d'utiliser le téléviseur. Si des dommages sont causés par le non-respect des instructions, la garantie ne sera pas applicable.

### Consignes de sécurité importantes

- Lisez ces instructions.**
- Conservez ces instructions.**
- Tenez compte de tous les avertissements.**
- Suivez toutes les instructions.**
- N'utilisez pas cet appareil près de l'eau.**
- Nettoyez l'appareil avec un chiffon sec seulement.**
- N'obstruez aucune prise de ventilation. Installez l'appareil en conformité avec les instructions du fabricant.**
- N'installez pas l'appareil près d'une source de chaleur** comme un radiateur, un registre de chaleur ou un autre appareil (incluant les amplificateurs) qui produit de la chaleur.
- Ne passez pas outre les instructions de sécurité** concernant la fiche polarisée ou la fiche de mise à la terre. Une fiche polarisée est composée de deux broches dont l'une est plus large que l'autre. Une fiche de mise à la terre est composée de deux broches et d'une broche de masse. La broche plus large et la broche de masse visent à assurer votre sécurité. Si la fiche fournie ne peut être insérée dans la prise, consultez un électricien pour qu'il remplace votre prise désuète.
- Protégez le cordon d'alimentation** de façon à ce qu'il ne puisse pas être écrasé ou pincé; vérifiez particulièrement les fiches, les prises et la sortie du fil dans l'appareil.
- Utilisez seulement les accessoires** spécifiés par le fabricant.
- Utilisez seulement le chariot,** le support, le trépied ou la table spécifiés par le fabricant ou vendu avec l'appareil. Si vous utilisez un chariot, faites attention lorsque vous le déplacez afin d'éviter de vous blesser en cas de renversement de l'appareil.
- Débranchez cet appareil** pendant les orages avec éclairs ou s'il n'est pas utilisé pendant de longues périodes.
- Toute réparation** doit être faite par un technicien qualifié. Une réparation est nécessaire quand l'appareil a été endommagé, par exemple, quand le cordon ou la fiche d'alimentation ont été endommagés, quand un objet a été introduit dans l'appareil ou quand l'appareil a été mouillé, exposé à la pluie ou à l'humidité, qu'il ne fonctionne pas correctement ou qu'il a été échappé.
- AVERTISSEMENT relatif à l'utilisation de piles** – Afin d'éviter une fuite des piles pouvant entraîner des blessures ou des dommages matériels :
  - Installez **toutes** les piles correctement en alignant les pôles + et - tel qu'indiqué sur l'appareil.
  - Ne combinez pas des piles différentes (**neuves** et **usagées**, au **carbón** et **alcalines**, etc.).
  - Retirez les piles lorsque l'appareil n'est pas utilisé pendant une longue période.
  - Les piles intégrées ne doivent pas être exposées à une chaleur excessive, comme les rayons du soleil ou le feu.
  - Produits contenant du perchlorate : une manipulation particulière peut être requise. Consultez www.dtsc.ca.gov/hazardouswaste/perchlorate.
- L'appareil ou sa télécommande peuvent contenir une pile bouton qu'un enfant pourrait avaler. Gardez ce type de pile hors de portée des enfants à tout moment! En cas d'ingestion, la pile peut provoquer des blessures sérieuses voire la mort. De graves brûlures internes peuvent survenir dans les deux heures suivant l'ingestion.
- Si vous croyez qu'une pile a été ingérée ou introduite dans le corps de quelqu'un, consultez immédiatement votre médecin.
- Lorsque vous changez les piles, assurez-vous que les piles neuves et usagées sont hors de portée des enfants. Une fois le changement de pile effectué, assurez-vous que son compartiment est bien fermé et sécurisé.
- Si vous ne parvenez pas à sécuriser le compartiment de la pile, cessez d'utiliser l'appareil. Gardez l'appareil hors de portée des enfants et communiquez avec le fabricant.
- N'exposez pas l'appareil aux éclaboussures, ni aux déversements.**
- Ne placez aucune source de danger sur l'appareil** (par exemple des objets remplis de liquide ou des bougies allumées).
- Cet appareil peut contenir du plomb et du mercure. Mettez l'appareil au rebut conformément aux lois municipales, provinciales ou fédérales. Pour en savoir plus sur la mise au rebut ou sur le recyclage, veuillez communiquer avec les autorités locales. Pour de plus amples renseignements sur les diverses possibilités de recyclage, visitez les sites www.mygreenelectronics.com, www.eiae.org ou www.recycle.philips.com.
- Si la fiche d'alimentation ou un coupleur d'appareil est utilisé comme dispositif de découplage, celui-ci doit rester facilement accessible.
- Ne placez pas cet appareil sur une pile ou un enfant pourrait faire basculer ou qu'un adulte pourrait renverser involontairement en s'appuyant ou en grimpant dessus ou encore en le tirant. La chute d'un appareil peut provoquer des blessures graves, voire la mort.
- Cet appareil ne doit pas être placé dans un meuble encastré comme une bibliothèque ou une étagère, à moins que l'emplacement offre une ventilation suffisante. Veillez à garder un espace dégagé d'au moins 20 cm (7,8») autour de cet appareil.





Ce symbole signifie que l'appareil sur lequel il est apposé est doté d'une double isolation.

#### Sachez reconnaître ces symboles de sécurité

Ce symbole «d'éclair» signale des matériaux non isolés présents dans votre appareil et pouvant causer un choc électrique. Pour assurer la sécurité des membres de votre famille, veuillez ne pas enlever le couvercle du produit.

Les «points d'exclamation» ont pour but d'attirer votre attention sur des caractéristiques à propos desquelles vous devez lire attentivement la documentation accompagnant l'appareil afin d'éviter tout problème de fonctionnement et d'entretien.

**AVERTISSEMENT** : afin de réduire les risques d'incendie ou de choc électrique, n'exposez pas cet appareil à la pluie ou à l'humidité. Ne posez pas dessus d'objets remplis de liquides, tels que des vases.

**ATTENTION** : pour éviter les chocs électriques, introduisez la broche à fond large de la fiche dans la borne correspondante de la prise et poussez à plus.

### Précautions d'utilisation de votre appareil

Utilisez seulement un chiffon en microfibre pour nettoyer l'appareil.

### Respect de l'environnement

#### Mise au rebut de votre ancien appareil et de la pile

Votre produit a été conçu et fabriqué avec des matériaux et des composants de grande qualité, qui peuvent être recyclés et réutilisés. Ce produit peut contenir du plomb et du mercure. La mise au rebut de ces matériaux peut être réglementée pour des raisons environnementales. Pour en savoir plus sur la mise au rebut ou sur le recyclage, veuillez communiquer avec les autorités locales ou visiter le site www.recycle.philips.com.

Ce produit contient des piles :

- Mettez les piles au rebut de façon responsable. Ne les incinérez pas. Les piles risquent d'exploser en cas de surchauffe.
- Ne les emballez pas dans du papier métallique ou d'aluminium. Emballez les piles dans du papier journal avant de les mettre au rebut.
- Nous vous suggérons de communiquer avec les responsables de votre ville pour connaître le ou les sites où vous pouvez laisser votre batterie.
- Visitez le site www.call2recycle.org pour obtenir des renseignements supplémentaires sur un centre de recyclage pour piles rechargeables dans votre région.

### Avis de conformité

Cet appareil est conforme aux règlements de la FCC, partie 15. Le fonctionnement est assujéti aux deux conditions suivantes :

- Cet appareil ne doit pas causer d'interférence préjudiciable et**
- doit accepter toute interférence reçue, y compris les interférences qui peuvent causer un fonctionnement non désiré.**

#### Règlement de la FCC

Cet équipement a été testé et jugé compatible avec les limites s'appliquant aux appareils numériques de la classe B, conformément à l'article 15 du règlement de la FCC. Ces limites ont été définies pour fournir une protection raisonnable contre les interférences nuisibles dans le cadre d'une installation résidentielle. Cet équipement génère, utilise et peut émettre de l'énergie radiofréquence et, s'il n'est pas installé ni utilisé conformément aux instructions, peut causer des interférences gênantes pour les communications radio.

Rien ne garantit toutefois que des interférences ne surviendront pas dans une installation particulière. Si cet équipement cause des interférences nuisibles à la réception de la radio ou de la télévision, ce qui peut être déterminé en mettant l'équipement hors tension puis sous tension, l'utilisateur devra essayer de corriger ces interférences en effectuant une ou plusieurs des opérations suivantes :

- Déplacez l'antenne de réception.
- Augmentez la distance entre l'équipement et le récepteur.
- Branchez l'équipement à une prise d'un circuit autre que celui sur lequel le récepteur est branché.
- Consultez le détaillant ou un technicien de radiotélévision expérimenté.

#### Énoncé de la FCC sur l'exposition aux rayonnements radioélectriques :

cet appareil est conforme aux limites d'exposition aux rayonnements radioélectriques de la FCC pour un environnement non contrôlé. Cet appareil doit être installé et utilisé en conservant une distance minimale de 20 centimètres entre le radiateur et votre corps. Cet émetteur ne doit pas être installé au même endroit qu'une autre antenne ou un autre émetteur ni utilisé avec un tel dispositif.

**Avertissement** : Tout changement ou toute modification apportés à cet appareil sans l'autorisation expresse de Gibson Innovations peut annuler le droit de l'utilisateur à utiliser l'équipement.

Numéro de modèle : B8/37

Marque : Philips

Partie responsable : Gibson Innovations USA Inc.

PO BOX 100572, Nashville TN 37224

#### Canada :

CAN ICES-3(B)/NMB-3(B)

Cet appareil est conforme aux CNR sans licence d'Industrie Canada. Son fonctionnement est assujéti aux deux conditions suivantes : (1) l'appareil ne doit pas causer d'interférences et (2) l'appareil doit accepter toute interférence, y compris les interférences qui peuvent nuire à son bon fonctionnement.

Cet appareil est conforme à l'exemption des limites d'évaluation courante de la section 2.5 et à l'exposition aux radiofréquences de la norme CNR-102, laquelle permet aux utilisateurs canadiens d'obtenir de l'information sur la conformité et l'exposition aux radiofréquences.

Cet émetteur ne doit pas être installé au même endroit que toute autre antenne ou tout autre émetteur ni utilisé avec un tel dispositif. Cet équipement doit être installé et utilisé à une distance minimale de 20 centimètres entre le radiateur et votre corps.

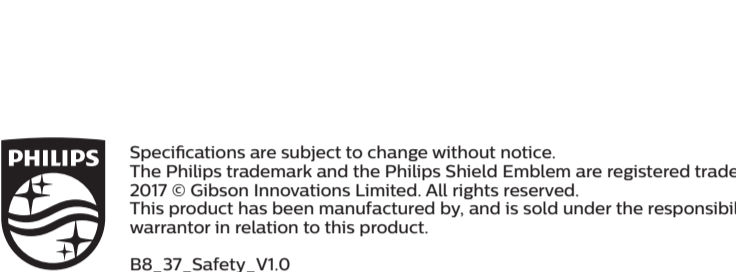

Specifications are subject to change without notice.

The Philips trademark and the Philips Shield Emblem are registered trademarks of Koninklijke Philips N.V. used under license.

© 2017 © Gibson Innovations Limited. All rights reserved.

This product has been manufactured by, and is sold under the responsibility of Gibson Innovations Ltd., and Gibson Innovations Ltd. is the warrantor in relation to this product.

B8\_37\_Safety\_V1.0

## GARANTÍA LIMITADA PHILIPS UN (1) AÑO

cualquier persona distinta de Philips o de un establecimiento de servicio autorizado de Philips; (c) productos o piezas que se hayan modificado sin la autorización por escrito de Philips; y lam- se ha retirado o dañado el número de serie de Philips; y lam- poco se aplica la garantía a (e) productos, accesorios o ítems vendidos TAL COMO ESTÁN sin garantía de ningún tipo, lo que incluye productos Philips vendidos TAL COMO ESTÁN por algunos distribuidores.

**Esta garantía limitada no cubre:**

- Los costos de envío al devolver el producto defectuoso a Philips.
- Riesgos de mano de obra por la instalación o configuración del producto, el ajuste de controles del cliente en el producto y la instalación o reparación de sistemas de antena o fuente de señal externos al producto.
- La reparación del producto o el reemplazo de piezas debido a un suministro de voltaje inadecuado, sobrevoltaje de la línea de alimentación, daño causado por rayos/luz, imágenes retendidas o marcas en la pantalla producto de la visualización de contenido fijo durante períodos prolongados, reparaciones cosméticas debidas al desgaste normal, reparaciones no autorizadas u otras causas que no se encuentran bajo el control de Philips.
- Daños o reclamos por productos que no están disponibles para su uso, por datos perdidos o por pérdida de software.
- Daños debido a mala manipulación en el transporte o a accidentes de envío al devolver el producto a Philips.
- Un producto que requiera modificación o adaptación para permitir su funcionamiento en algún país que no sea el país para el que se diseñó, fabricó, aprobó y/o autorizó o la reparación de productos dañados por estas modificaciones.
- Un producto que lo que incluye, entre otros, los de alquiler).
- La pérdida del producto en el envío y cuando no se pueda proporcionar una firma que verifique el recibio.
- No operar según el Manual del propietario.

**PARA OBTENER AYUDA EN LOS EE.UU., CANADA, PUERTO RICO O EN LAS ISLAS VIRGENES DE LOS EE.UU.,** Comuníquese con el Centro de Atención al Cliente al: 1-888-381-0749

LA REPARACION O EL REEMPLAZO, SEGUN LO DISPONE ESTA GARANTIA, ES LA SOLUCION EXCLUSIVA PARA EL CLIENTE. PHILIPS NO SERA RESPONSABLE DE LOS DAÑOS INCIDENTALES O INDIRECTOS QUE INFRINAN ALGUNO GARANTIA EXPRESA O IMPLICITA SOBRE ESTE PRODUCTO, CON EXCEPCION DE LO QUE PROHIBA LA LEY VIGENTE, TODA GARANTIA IMPLICITA DE COMERCIABILIDAD Y ADECUACION PARA UN PROPOSITO PARTICULAR EN ESTE PRODUCTO ESTA LIMITADA EN DURACION A LO QUE ESPECIFIQUE ESTA GARANTIA.

Algunos estados no permiten las exclusiones ni la limitación de los daños indirectos o indirectos, ni permiten limitaciones sobre la duración de la garantía implícita, de modo que las limitaciones o exclusiones anteriores pueden no aplicarse a usted.

Algunos estados no permiten las exclusiones ni las diferentes estados y provincias.

**Gibson Innovations USA Inc. PO BOX 100572 Nashville TN 37224**

2016

La obligación de la garantía PHILIPS se limita a los términos establecidos a continuación.

#### COBERTURA DE GARANTIA:

Philips le garantiza el producto al comprador original o a la persona que lo recibe como regalo contra defectos en los materiales y en la mano de obra, a partir de la fecha de la compra original (Período de garantía) en el distribuidor autorizado. El recibo de compra en un distribuidor autorizado de nuestro producto y la fecha de la compra en un distribuidor autorizado, se considerará aprobante de esta fecha.

#### LO QUE ESTA CUBIERTO:

La garantía Philips cubre productos nuevos si se produce algún defecto en el material o la mano de obra y Philips recibe un recibo válido dentro del período de garantía. A su propia discreción, Philips (1) reparará el producto sin costo, usando piezas de repuesto nuevas o recondicionadas, (2) cambiará el producto por uno nuevo o que se ha fabricado con piezas nuevas o usadas utilizables, y que sea al menos funcionalmente equivalente al original, o (3) reembolsará el precio de compra original del producto. Philips garantiza productos o piezas de repuesto o recondicionadas bajo esta garantía contra defectos en los materiales y en la mano de obra durante noventa (90) días o por el resto de la garantía del producto original, lo que le promocióne más cobertura. Cuando se cambia un producto o una pieza, el artículo que usted recibe pasa a ser de su propiedad y el que le entrega a Philips pasa a ser propiedad de este último. Cuando se proponiome un reembolso, su producto pasa a ser propiedad de Philips.

**Nota: Cualquier producto que se venda y que esté identificado como reacondicionado o renovado tiene una garantía limitada de noventa (90) días.**

**El producto de reemplazo sólo se puede emitir si se cumplen todos los requisitos de la garantía. El incumplimiento de tales requisitos puede ocasionar un retraso.**

**LO QUE NO SE CUBRE: EXCLUSIONES Y LIMITACIONES:** La garantía limitada se aplica sólo a los productos nuevos fabricados por Philips para Philips que se pueden identificar por la marca registrada, el nombre comercial o por tener el logotipo correspondiente. Esta garantía limitada no se aplica a ningún producto de hardware ni de software que no sea Philips, incluso si viene empaquetado con el producto o si se vende junto con éste. Pueden proporcionar una garantía por separado para sus propios productos empaquetados con el producto Philips.

Philips no es responsable por ningún daño o pérdida de programas, datos u otra información almacenados en algún medio contenido en el producto, ni por ningún producto o pieza que no sea Philips que no esté cubierto por esta garantía. La recuperación o la reinstalación de programas, datos u otra información no está cubierta por esta garantía limitada.

Esta garantía no se aplica (a) a daños causados por accidente, abuso, mal uso, negligencia, mala aplicación o a productos que no sean Philips; (b) a daño provocado por servicio realizado por sean Philips; (c) a daño provocado por servicio realizado por

Esta garantía le otorga derechos legales específicos. Usted puede tener otros derechos que varían entre los diferentes estados y provincias.

## PHILIPS LIMITED WARRANTY ONE (1) YEAR

Philips, or (d) if any Philips serial number has been removed or defaced, or (e) product, accessories, or consumables sold "AS IS" without warranty of any kind by including refurbished Philips product sold "AS IS" by some retailers.

#### WHO IS COVERED:

- Philips warrants the product to a gift against defects in materials and workmanship as based on the original purchaser or the person receiving the product as a gift against defects in materials and workmanship as based on the original purchaser ("Warranty Period") from an Authorized Dealer. The original sales receipt showing the product name and the purchase date from an authorized retailer is considered such proof.

#### WHAT IS COVERED:

The Philips warranty covers new products if a defect in material or workmanship occurs, and a valid claim is received by Philips within the Warranty Period. At its option, Philips will either (1) repair the product at no charge, using new or refurbished replacement parts, or (2) exchange the product with a product that is new or which has been manufactured from new, or serviceable used parts and is at least functionally equivalent or most comparable to the original product. Philips equivalent or most comparable to the original purchase price of the product, or (3) refund the original purchase price of the product. Philips warrants replacement products or parts provided under this warranty against defects in materials and workmanship from the date of the replacement or repair for ninety (90) days or for the remaining portion of the original product's warranty, whichever provides longer coverage for you. When a product or part is exchanged, any replacement item becomes your property and is replaced item becomes Philips property. When a refund is given, you will receive the original purchase price of the product.

**Note: Any product sold and identified as refurbished or renewed carries a ninety (90) day limited warranty.**

**Replacement products can only be sent if all warranty requirements are met. Failure to follow all requirements can result in delay.**

#### WHAT IS NOT COVERED - EXCLUSIONS AND LIMITATIONS:

This Limited Warranty applies only to the new products manufactured by or for Philips that can be identified by the trademark, trade name, or logo affixed to it. This Limited Warranty does not apply to any non-Philips hardware product or any software, even if packaged or sold with the product. Non-Philips manufacturers, suppliers, or publishers may provide a separate warranty for their own products packaged with the bundled product.

Philips is not liable for any damage to or loss of any programs, data, or other information stored on any media contained within the product, or any non-Philips product or part not covered by this warranty. Recovery or reinstalation of programs, data or other information is not covered under this Limited Warranty.

This warranty does not apply (a) to damage caused by accident, abuse, misuse, neglect, misapplication, or non-Philips product, (b) to damage caused by service performed by anyone other than Philips or Philips Authorized Service Location, (c) to a product or a part that has been modified without the written permission of Philips.

This warranty gives you specific legal rights. You may have other rights which vary from state/province to state/province.

**Gibson Innovations USA Inc. PO BOX 100572 Nashville TN 37224**

2016

## GARANTIE LIMITEE PHILIPS UN (1) AN

modifié sans la permission écrite de Philips, ou (d) si tout numéro de série de Philips a été supprimé ou défiguré, ou (e) à un produit, accessoire ou produit non destiné vendu « TEL QUEL » sans garantie de quelque description que ce soit par l'inclusion de produits remis à neuf Philips vendu « TEL QUEL » par certains détaillants.

**Cette garantie limitée ne couvre pas:**

- Les frais d'expédition pour le renvoi du produit défectueux à Philips.
- Les frais de main-d'œuvre pour l'installation ou la configuration du produit, le réglage des commandes sur le produit ou celui ainsi que l'installation ou la réparation du système d'antenne/source sonore externe au produit.
- La réparation du produit et/ou le remplacement des pièces à cause d'une mauvaise installation ou entretien, d'un raccordement à une alimentation électrique incorrecte, d'une surtension temporaire, de dommages occasionnés par la foudre, d'une remanence de l'image ou de marques à l'écran résultant de l'affichage d'un contenu stationnaire fixe pour une période de temps prolongée, de respect esthétique du produit causé par une usure normale, d'une réparation non autorisée ou de toute autre cause non contrôlable par Philips.
- Tout dommage ou réclamation pour des logiciels perdus.
- Tout dommage causé par un mauvais acheminement du produit ou utilisation ou pour des données perdues ou locales perdu.
- Tout dommage causé par un mauvais acheminement du produit ou par un accident encouru lors du renvoi du produit à Philips.
- Un produit nécessitant une modification ou adaptation afin de permettre l'utilisation dans tout pays autre que celui pour lequel il était désigné, fabriqué, approuvé et/ou autorisé ou toute réparation du produit endommagé par ces modifications.
- Un produit utilisé à des fins commerciales ou institutionnelles (y compris mais non de façon limitative les fins de location).
- Un produit perdu lors de l'expédition sans preuve signée de la réception.
- Tout manquement d'exploiter le produit selon le manuel de l'utilisateur.

**POUR OBTENIR DE L'AIDE AUX ETATS-UNIS, AU CANADA, A PUERTO RICO OU AUX ILES VIERGES AMERICAINES** ... Communiquez avec le centre de service à la clientèle de Philips au: 1-888-381-0749

LA REPARACION O LU REEMPLAZAMIENTO CONFORMEMENT A CETTE GARANTIA CONSTITUE LE SEUL REMEDE POSSIBLE CONSOMMATEUR. PHILIPS NEST AUCUNEMENT RESPONSABLE DE TOUT DOMMAGE ACCESSOIRE OU INDIRECT RESULTANT DE LA VIOLATION DE TOUTE GARANTIE EXPRESSE OU IMPLICITE SUR CE PRODUIT. SAUF DANS LA MESURE INTERDITE PAR LES LOIS APPLICABLES, TOUTE GARANTIE IMPLICITE DE QUALITE LOYALE ET MARCHANDE OU D'UTILITE PARTICULIERE DU PRODUIT EST LIMITEE DANS LE TEMPS A LA DUREE DE CETTE GARANTIE.

Certains états ne reconnaissent pas l'exclusion ou la limitation de la responsabilité pour dommages indirects ou accessoires, ou autorisent des limitations sur la durée d'une garantie implicite, il est donc possible que les limitations ou exclusions mentionnées ci-dessus soient sans effet dans votre cas.

Esta garantía le otorga derechos legales específicos. Usted puede tener otros derechos que varían entre los diferentes estados y provincias.

**Gibson Innovations USA Inc. PO BOX 100572 Nashville TN 37224**

2016

Philips, or (d) if any Philips serial number has been removed or defaced, or (e) product, accessories, or consumables sold "AS IS" without warranty of any kind by including refurbished Philips product sold "AS IS" by some retailers.

#### WHO IS COVERED:

- Philips warrants the product to a gift against defects in materials and workmanship as based on the original purchaser or the person receiving the product as a gift against defects in materials and workmanship as based on the original purchaser ("Warranty Period") from an Authorized Dealer. The original sales receipt showing the product name and the purchase date from an authorized retailer is considered such proof.

#### WHAT IS COVERED:

The Philips warranty covers new products if a defect in material or workmanship occurs, and a valid claim is received by Philips within the Warranty Period. At its option, Philips will either (1) repair the product at no charge, using new or refurbished replacement parts, or (2) exchange the product with a product that is new or which has been manufactured from new, or serviceable used parts and is at least functionally equivalent or most comparable to the original product. Philips equivalent or most comparable to the original purchase price of the product, or (3) refund the original purchase price of the product. Philips warrants replacement products or parts provided under this warranty against defects in materials and workmanship from the date of the replacement or repair for ninety (90) days or for the remaining portion of the original product's warranty, whichever provides longer coverage for you. When a product or part is exchanged, any replacement item becomes your property and is replaced item becomes Philips property. When a refund is given, you will receive the original purchase price of the product.

**Note: Any product sold and identified as refurbished or renewed carries a ninety (90) day limited warranty.**

**Replacement products can only be sent if all warranty requirements are met. Failure to follow all requirements can result in delay.**

#### WHAT IS NOT COVERED - EXCLUSIONS AND LIMITATIONS:

This Limited Warranty applies only to the new products manufactured by or for Philips that can be identified by the trademark, trade name, or logo affixed to it. This Limited Warranty does not apply to any non-Philips hardware product or any software, even if packaged or sold with the product. Non-Philips manufacturers, suppliers, or publishers may provide a separate warranty for their own products packaged with the bundled product.

Philips is not liable for any damage to or loss of any programs, data, or other information stored on any media contained within the product, or any non-Philips product or part not covered by this warranty. Recovery or reinstalation of programs, data or other information is not covered under this Limited Warranty.

This warranty does not apply (a) to damage caused by accident, abuse, misuse, neglect, misapplication, or non-Philips product, (b) to damage caused by service performed by anyone other than Philips or Philips Authorized Service Location, (c) to a product or a part that has been modified without the written permission of Philips.

This warranty gives you specific legal rights. You may have other rights which vary from state/province to state/province.

**Gibson Innovations USA Inc. PO BOX 100572 Nashville TN 37224**

2016

Philips warranty obligation is limited to the terms set forth below.

**WHO IS COVERED:** Philips warrants the product to a gift against defects in materials and workmanship as based on the original purchaser or the person receiving the product as a gift against defects in materials and workmanship as based on the original purchaser ("Warranty Period") from an Authorized Dealer. The original sales receipt showing the product name and the purchase date from an authorized retailer is considered such proof.

#### WHAT IS COVERED:

The Philips warranty covers new products if a defect in material or workmanship occurs, and a valid claim is received by Philips within the Warranty Period. At its option, Philips will either (1) repair the product at no charge, using new or refurbished replacement parts, or (2) exchange the product with a product that is new or which has been manufactured from new, or serviceable used parts and is at least functionally equivalent or most comparable to the original product. Philips equivalent or most comparable to the original purchase price of the product, or (3) refund the original purchase price of the product. Philips warrants replacement products or parts provided under this warranty against defects in materials and workmanship from the date of the replacement or repair for ninety (90) days or for the remaining portion of the original product's warranty, whichever provides longer coverage for you. When a product or part is exchanged, any replacement item becomes your property and is replaced item becomes Philips property. When a refund is given, you will receive the original purchase price of the product.

**Note: Any product sold and identified as refurbished or renewed carries a ninety (90) day limited warranty.**

**Replacement products can only be sent if all warranty requirements are met. Failure to follow all requirements can result in delay.**

#### WHAT IS NOT COVERED - EXCLUSIONS AND LIMITATIONS:

This Limited Warranty applies only to the new products manufactured by or for Philips that can be identified by the trademark, trade name, or logo affixed to it. This Limited Warranty does not apply to any non-Philips hardware product or any software, even if packaged or sold with the product. Non-Philips manufacturers, suppliers, or publishers may provide a separate warranty for their own products packaged with the bundled product.

Philips is not liable for any damage to or loss of any programs, data, or other information stored on any media contained within the product, or any non-Philips product or part not covered by this warranty. Recovery or reinstalation of programs, data or other information is not covered under this Limited Warranty.

This warranty does not apply (a) to damage caused by accident, abuse, misuse, neglect, misapplication, or non-Philips product, (b) to damage caused by service performed by anyone other than Philips or Philips Authorized Service Location, (c) to a product or a part that has been modified without the written permission of Philips.

This warranty gives you specific legal rights. You may have other rights which vary from state/province to state/province.

**Gibson Innovations USA Inc. PO BOX 100572 Nashville TN 37224**

2016

Philips warranty obligation is limited to the terms set forth below.

**WHO IS COVERED:** Philips warrants the product to a gift against defects in materials and workmanship as based on the original purchaser or the person receiving the product as a gift against defects in materials and workmanship as based on the original purchaser ("Warranty Period") from an Authorized Dealer. The original sales receipt showing the product name and the purchase date from an authorized retailer is considered such proof.

#### WHAT IS COVERED:

The Philips warranty covers new products if a defect in material or workmanship occurs, and a valid claim is received by Philips within the Warranty Period. At its option, Philips will either (1) repair the product at no charge, using new or refurbished replacement parts, or (2) exchange the product with a product that is new or which has been manufactured from new, or serviceable used parts and is at least functionally equivalent or most comparable to the original product. Philips equivalent or most comparable to the original purchase price of the product, or (3) refund the original purchase price of the product. Philips warrants replacement products or parts provided under this warranty against defects in materials and workmanship from the date of the replacement or repair for ninety (90) days or for the remaining portion of the original product's warranty, whichever provides longer coverage for you. When a product or part is exchanged, any replacement item becomes your property and is replaced item becomes Philips property. When a refund is given, you will receive the original purchase price of the product.

**Note: Any product sold and identified as refurbished or renewed carries a ninety (90) day limited warranty.**

**Replacement products can only be sent if all warranty requirements are met. Failure to follow all requirements can result in delay.**

#### WHAT IS NOT COVERED - EXCLUSIONS AND LIMITATIONS:

This Limited Warranty applies only to the new products manufactured by or for Philips that can be identified by the trademark, trade name, or logo affixed to it. This Limited Warranty does not apply to any non-Philips hardware product or any software, even if packaged or sold with the product. Non-Philips manufacturers, suppliers, or publishers may provide a separate warranty for their own products packaged with the bundled product.

Philips is not liable for any damage to or loss of any programs, data, or other information stored on any media contained within the product, or any non-Philips product or part not covered by this warranty. Recovery or reinstalation of programs, data or other information is not covered under this Limited Warranty.

This warranty does not apply (a) to damage caused by accident, abuse, misuse, neglect, misapplication, or non-Philips product, (b) to damage caused by service performed by anyone other than Philips or Philips Authorized Service Location, (c) to a product or a part that has been modified without the written permission of Philips.

This warranty gives you specific legal rights. You may have other rights which vary from state/province to state/province.

**Gibson Innovations USA Inc. PO BOX 100572 Nashville TN 37224**

2016

