

SHB4000/4000WT_QSG_English

19 Oct 2012

Page 1

- For your first time use:**
- 1 Make sure the headset is charged, your mobile phone is turned on and its Bluetooth feature enabled.
 - 2 Press **(+)** until the white and blue LED flashing alternately.
 - 3 Your mobile phone should start searching for Philips SHB4000.
 - 4 Pair the headset with your mobile phone below.
(Check your phone's user manual for details).

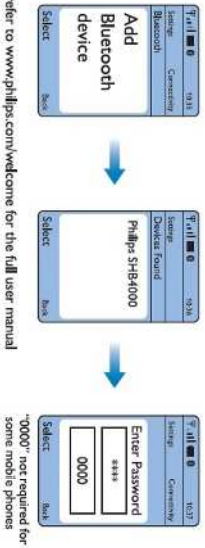

Please refer to www.philips.com/welcome for the full user manual

Back

Changes or modifications not expressly approved by the party responsible for compliance could void the user's authority to operate the equipment.



Notice for Canada:
This device complies with Industry Canada licence-exempt RSS standard(s). Operation is subject to the following two conditions:
(1) This device must not cause harmful interference, and
(2) This device must accept any interference, including interference that may cause undesired operation of the device.

(b) For a Class B signal device or peripheral, the instructions furnished the user and shall include the following or similar statement, placed in a prominent location in the form of the manual:
Note: This equipment has been tested and found to comply with the limits for a Class B signal device, pursuant to part 15 of the FCC Rules. These limits are designed to provide reasonable protection against harmful interference in a residential installation. This equipment generates, uses and can radiate radio frequency energy and if not used in accordance with the instructions, may cause harmful interference to radio or television reception, which can be determined by turning the equipment off and on. The user is encouraged to try to correct the interference by one or more of the following measures:
—Reorient or relocate the receiving antenna.
—Increase the separation between the equipment and receiver.
—Connect the equipment into an outlet on a circuit different from that to which the receiver is connected.
—Consult the dealer or an experienced radio/television technician for help.



86 mm

88 mm

Page 2

Volume/Track control

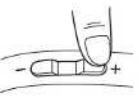

- Adjust volume: 1 press **(+)** or **(-)** / long press **(+)** / long press **(-)**
- Skip forward: long press **(+)**
- Skip backward: long press **(-)**

88 mm

Cover

Quick start guide

Philips Bluetooth stereo headset SHB4000/SHB4000WT



PHILIPS

88 mm

Page 3

[VOL +/-]
Volume/
Track control

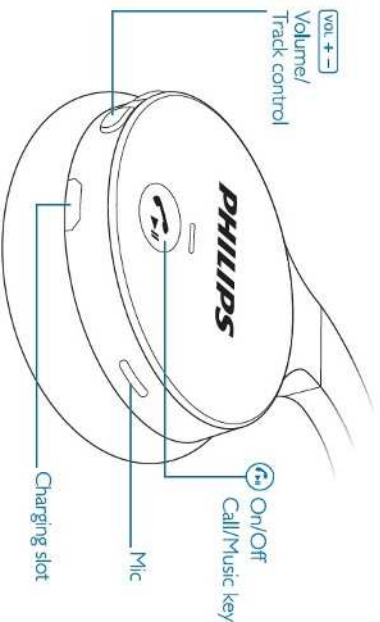

88 mm

Page 4

Call/Music key

- Turn headset on: Press **(+)** for 1 sec
- Turn headset off: Press **(+)** for 4 sec
- Play/Pause/Pick up call/Hang up: 1 press **(+)** / Long press **(+)** for 1 sec until "gr" sound
- Reject incoming call: 2 press **(+)** / Long press **(+)**
- Redial: Long press **(+)**
- Switch caller while in a call: Long press **(+)**
- In pairing mode: White and blue LED flashing alternately
- Paired and connected mode: Blue LED flashing at every 6 sec
- Fully charged: White LED goes out once it is fully charged when cable is connected
- Low battery: White LED flashing

86 mm