

PHILIPS

BASS+

SHB4385

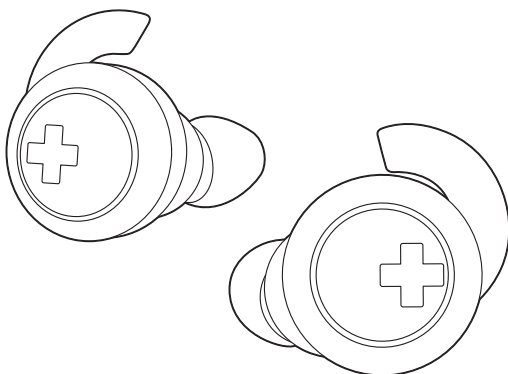

User manual

Register your product and get support at
www.philips.com/support

Contents

| | | |
|----------|--------------------------------------|----------|
| 1 | Important safety instructions | 2 |
| | Hearing Safety | 2 |
| | General information | 2 |

| | | |
|----------|---|----------|
| 2 | Your Bluetooth wireless headset | 3 |
| | What's in the box | 3 |
| | Other devices | 3 |
| | Overview of your Bluetooth wireless headset | 4 |

| | | |
|----------|---|----------|
| 3 | Get started | 5 |
| | Charge the battery | 5 |
| | Pair between both sides of the headset | 5 |
| | Pair your headset with the Bluetooth device | 6 |

| | | |
|----------|---|----------|
| 4 | Use your headset | 7 |
| | Connect the headset to a Bluetooth device | 7 |
| | Power on/off | 7 |
| | Manage your calls and music | 7 |
| | LED indicator status | 8 |
| | How to wear | 8 |

| | | |
|----------|-----------------------|----------|
| 5 | Technical data | 9 |
|----------|-----------------------|----------|

| | | |
|----------|--|-----------|
| 6 | Notice | 10 |
| | Declaration of conformity | 10 |
| | Disposal of your old product and battery | 10 |
| | Compliance with EMF | 11 |
| | Trademarks | 11 |

| | | |
|----------|-----------------------------------|-----------|
| 7 | Frequently asked questions | 12 |
|----------|-----------------------------------|-----------|

1 Important safety instructions

Hearing Safety



Danger

- To avoid hearing damage, limit the time you use headset at high volume and set the volume to a safe level. The louder the volume, the shorter the safe listening time is.

Be sure to observe the following guidelines when using your headset.

- Listen at reasonable volumes for reasonable periods of time.
- Be careful not to adjust the volume continuously upwards as your hearing adapts.
- Do not turn up the volume so high that you can't hear what's around you.
- You should use caution or temporarily discontinue use in potentially hazardous situations.
- Excessive sound pressure from earphones and headset can cause hearing loss.
- Using headset with both ears covered while driving is not recommended and may be illegal in some areas while driving.
- For your safety, avoid distractions from music or phone calls while in traffic or other potentially dangerous environments.

General information

To avoid damage or malfunction:

Caution

- Do not expose headset to excessive heat.
- Do not drop your headset.
- Headset shall not be exposed to dripping or splashing.
- Do not allow your headset to be submerged in water.
- Do not use any cleaning agents containing alcohol, ammonia, benzene, or abrasives.
- If cleaning is required use a soft cloth, if necessary dampened with a minimum amount of water or diluted mild soap, to clean the product.
- The integrated battery shall not be exposed to excessive heat such as sunshine, fire or the like.
- Danger of explosion if battery is incorrectly replaced. Replace only with the same or equivalent type.

About operating and storage temperatures and humidity

- The storage temperature is between -15°C to 55°C . The operation temperature is 45°C (max.) (up to 90% relative humidity).
- Battery life may be shorter in high or low temperature conditions.

2 Your Bluetooth wireless headset

Congratulations on your purchase, and welcome to Philips! To fully benefit from the support that Philips offers, register your product at www.philips.com/welcome.

With this Philips wireless headset, you can:

- enjoy convenient wireless handsfree calls;
- enjoy and control wireless music;
- switch between calls and music.

What's in the box

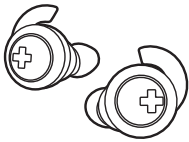

Philips True Wireless headset BASS+ SHB4385



Replaceable rubber ear caps x 2 pairs



Charging case

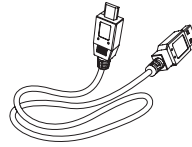

USB charging cable (for charging only)



Quick start guide

Other devices

A mobile phone or device (e.g. notebook, PDA, Bluetooth adapters, MP3 players etc) which supports Bluetooth and is compatible to the headset (see 'Technical data' on page 9).

Overview of your Bluetooth wireless headset

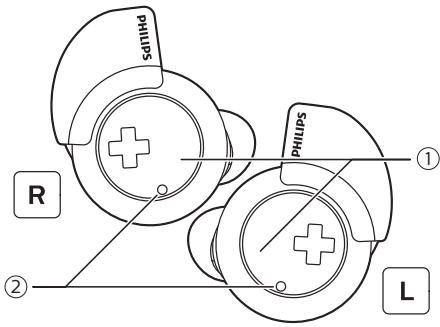

- ① Multi-function buttons
- ② LED indicator
- ③ Micro USB charging slot

3 Get started

Charge the battery

Note

- Before you use your headset/charging case for the first time, charge the battery for 5 hours for optimum battery capacity and lifetime.
- Use only the original USB charging cable to avoid any damage.
- Finish your call before charging the headset, as connecting the headset for charging will power the headset off.

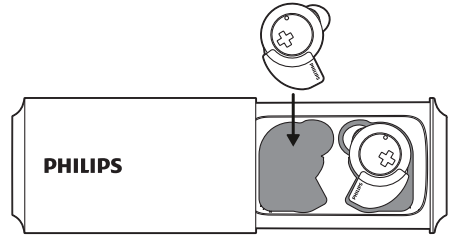

Tip

- Normally, a full charge takes 2 hours (for the headset or charging case).

Charging case

Connect one end of the USB cable into the charging case, and another end into the power source.

- ↳ The charging case starts charging.
- When the charging case is charging, a white LED light will be displayed.
- When the charging case is fully charged, the white light goes off.

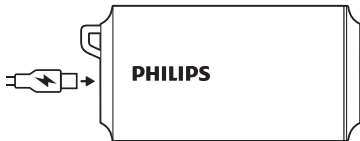

Pair between both sides of the headset

- 1 Make sure that the headset is fully charged.
- 2 Press and hold the multi-function buttons on both sides of the headset for 2 seconds.
 - ↳ The white LED lights on both side of the headset flash 3 times.
 - ↳ Both sides of the headset are connected automatically.
 - ↳ The headset is ready to pair with the Bluetooth device.

Headset

Place the headset on the charging case.

- ↳ The headset start charging.
- When the headset is charging, a white LED light will be displayed.
- When the headset is fully charged, the white light goes off.

Pair your headset with the Bluetooth device

- 1 Turn on the Bluetooth function of your mobile phone.
- 2 Pair the headset with the mobile phone. For detailed information, refer to the user manual of your mobile phone.



Tip

- The headset stores the last 2 devices in the memory. If you try to pair more than 2 devices, the earliest paired device is replaced by the new one.

The following example shows you how to pair the headset with your mobile phone.

- 1 Activate the Bluetooth feature of your mobile phone, select **Philips SHB4385**.
- 2 Enter the headset password "0000" (4 zeros) if prompted. For those mobile phones featuring Bluetooth 3.0 or higher, no need to enter a password.



Philips SHB4385

4 Use your headset

Connect the headset to a Bluetooth device

- 1 Turn on your mobile phone/Bluetooth device.
- 2 Press and hold the multi-function buttons on both sides of the headset for 2 seconds.
 - ↳ The white LED lights on both sides of the headset flash 3 times.
 - ↳ Both sides of the headset are connected automatically.
 - ↳ The headset is reconnected to the last connected mobile phone/Bluetooth device automatically. If the last one is not available, the headset tries to reconnect to the second last connected device.



Tip

- If you turn on the mobile phone/Bluetooth device or activate the Bluetooth feature after turning on the headset, you have to reconnect the headset and mobile phone/Bluetooth device manually.



Note

- If the headset fails to connect to any Bluetooth device within 5 minutes, it will switch off automatically to save the battery life.

Power on/off

| Task | Multi-function button | Operation |
|-----------------------|------------------------|---|
| Turn the headset on. | Right and left headset | Press and hold for 2 seconds. |
| Turn the headset off. | Right and left headset | Press and hold for 3 seconds. ↳ The white LED flashes for 3 times. |

Manage your calls and music

Music control

| Task | Multi-function button | Operation |
|----------------------|-----------------------|-----------------|
| Play or pause music. | Right headset | Press once. |
| Volume up | Left headset | Press twice. |
| Volume down | Left headset | Press once. |
| Skip forward. | Right headset | Press twice. |
| Skip backward. | Right headset | Press 3 times.. |

Call control

| Task | Multi-function button | Operation |
|------------------------------|-----------------------|---|
| Pick up/hang up a call. | Right headset | Press once. ↳ 1 beep. |
| Reject an incoming call. | Right headset | Press and hold for 1 second. ↳ 1 beep. |
| Switch caller during a call. | Right headset | Press twice. |

Voice control

| Task | Multi-function button | Operation |
|------------------|-----------------------|------------------------------------|
| Siri/Google Now. | Right headset | Press twice and hold for 1 second. |

| | |
|--|--|
| The headset is on but not connected to a Bluetooth device. | The blue LED flashes for every 5 seconds. If no connection can be made, the headset will turn itself off within 5 minutes. |
|--|--|

| | |
|------------------------------|---|
| Low battery level (headset). | You will hear "battery low" on the headset. |
|------------------------------|---|

| | |
|------------------------------------|--|
| Low battery level (charging case). | The red LED on the charging case flashes every 1 second. |
|------------------------------------|--|

| | |
|-------------------------------------|--------------------------------------|
| Battery is fully charged (headset). | The white LED on the headset is off. |
|-------------------------------------|--------------------------------------|

| | |
|---|--|
| Battery is fully charged (charging case). | The white LED on the charging case is off. |
|---|--|

LED indicator status

| Headset status | Indicator |
|---|---|
| The headset is connected to a Bluetooth device, while the headset is in standby mode or while you are listening to music. | The blue LED flashes for every 5 seconds. |
| The headset is ready for pairing. | The white LED flashes 3 times. |

How to wear

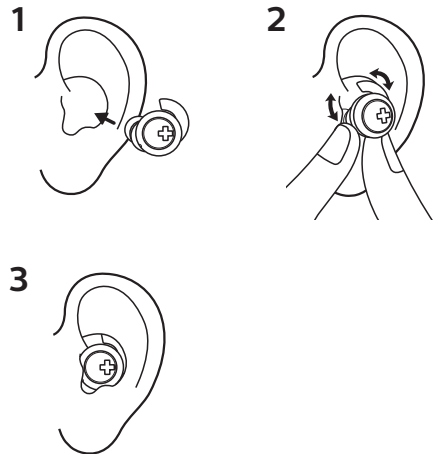

5 Technical data

Headset

- Music time: 6 hours (additional 6 hrs with charging case)
- Talk time: 6 hours (additional 6 hrs with charging case)
- Standby time: 200 hours
- Charging Time: 2 hours
- Normal time for a full charge: 2 hours
- Rechargeable lithium ion battery: (105mAh)
- Bluetooth 4.2, Bluetooth mono support (Headset Profile - HSP, Hands-Free Profile - HFP), Bluetooth stereo supported (Advanced Audio Distribution Profile - A2DP; Audio Video Remote Control Profile - AVRCP)
- Support audio codec (SBC)
- Frequency range: 2.402-2.480GHz
- Transmitter power: <20dBm
- Operating range: Up to 10 meters (33 feet)
- Digital echo & noise reduction
- Auto power off

Charging case

- Charging time: 2 hrs
- Rechargeable Li-ion battery : 350 mAh
- Number of recharges supported: 1



Note

- Specifications are subject to change without notice.

6 Notice

Declaration of conformity

Hereby, Gibson Innovations declares that this product is in compliance with the essential requirements and other relevant provisions of Directive 2014/53/EU. You can find the Declaration of Conformity on www.p4c.philips.com.

Disposal of your old product and battery



Your product is designed and manufactured with high quality materials and components, which can be recycled and reused.



This symbol on a product means that the product is covered by European Directive 2012/19/EU.



This symbol means that the product contains a built-in rechargeable battery covered by European Directive 2013/56/EU which cannot be disposed of with normal household waste. We strongly advise you to take your product to an official collection point or a Philips service centre to have a professional remove the rechargeable battery. Inform yourself about the local separate collection system for electrical and

electronic products and rechargeable batteries. Follow local rules and never dispose of the product and rechargeable batteries with normal household waste. Correct disposal of old products and rechargeable batteries helps prevent negative consequences for the environment and human health.

Remove the integrated battery

If there is no collection/recycling system for electronic products in your country, you can protect the environment by removing and recycling the battery before disposing of the headset.

- Make sure the headset is disconnected from the charging case before removing the battery.

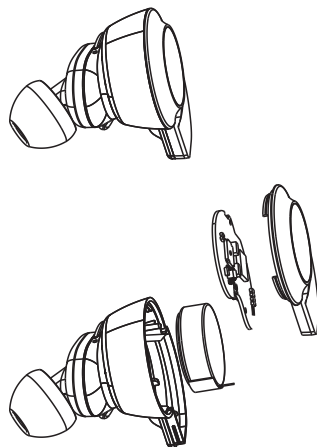

- Make sure the charging case is disconnected from the USB charging cable before removing the battery.

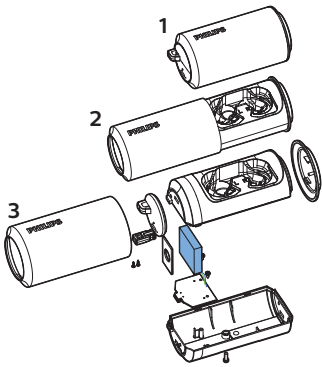

Trademarks

Bluetooth

The Bluetooth® word mark and logos are registered trademarks owned by Bluetooth SIG, Inc. and any use of such marks by Gibson Innovations Limited is under license.

Siri

Siri is a trademark of Apple Inc., registered in the U.S. and other countries.

Google

Google and the Google Logo are registered trademarks of Google Inc.

Compliance with EMF

This product complies with all applicable standards and regulations regarding exposure to electromagnetic fields.

Environmental information

All unnecessary packaging has been omitted. We have tried to make the packaging easy to separate into three materials: cardboard (box), polystyrene foam (buffer) and polyethylene (bags, protective foam sheet.)

Your system consists of materials which can be recycled and reused if disassembled by a specialized company. Please observe the local regulations regarding the disposal of packaging materials, exhausted batteries and old equipment.

7 Frequently asked questions

My Bluetooth headset does not switch on.

The battery level is low. Charge the headset.

I cannot pair my Bluetooth headset with a mobile phone.

The Bluetooth is disabled. Enable the Bluetooth feature on your mobile phone and turn on the mobile phone before you turn on the headset.

Pairing does not work.

Make sure the headset is in pairing mode.

- Follow the steps described in this user manual (see ‘Pair your headset with the Bluetooth device’ on page 6).

Make sure the left and right sides of the headset are successfully connected.

- Make sure that the white LED lights on both side of the headset flash 3 times.

If there is still pairing issue, power off the headset. Then power on the headset and repeat the pairing procedure.

The mobile phone cannot find the headset.

- The headset may be connected to a previously paired device. Turn off the connected device or move it out of range.
- Pairing may have been reset or the headset has been previously paired with another device. Pair the headset with the mobile phone again as described in the user manual (see ‘Pair your headset with the Bluetooth device’ on page 6).

My Bluetooth headset is connected to a Bluetooth stereo enabled mobile phone, but music only plays on the mobile phone speaker.

Refer to the user manual of your mobile phone. Select to listen to music through the headset.

The audio quality is poor and crackling noise can be heard.

The Bluetooth device is out of range. Reduce the distance between your headset and Bluetooth device, or remove obstacles between them.

The audio quality is poor when streaming from the mobile phone is very slow, or audio streaming does not work at all.

Make sure your mobile phone not only supports (mono) HSP/HFP but also supports A2DP (see ‘Technical data’ on page 9).

I hear but cannot control music on my Bluetooth device (e.g. play/pause/skip forward/backward).

Make sure the Bluetooth audio source supports AVRCP (see ‘Technical data’ on page 9).

The volume level of the headset is too low.

Some Bluetooth devices cannot link the volume level with the headset through volume sync. In this case, you have to adjust the volume on your Bluetooth device and headset independently to achieve an appropriate volume level.

How can I restore all original headset settings?

- 1 When the headset is powered off, press and hold the multifunction button for 10 seconds.
 - ↳ You will hear doo-doo sound.
The headset is off
- 2 Remove the old device name on the headset.
- 3 Power on the headset.
 - ↳ The headset will enter the pairing mode again.
- 4 Pair between both sides of the headset (see ‘Pair between both sides of the headset’ on page 5).
- 5 Pair your headset with the Bluetooth device (see ‘Pair your headset with the Bluetooth device’ on page 6).

For further support, visit www.philips.com/support.



Copyright © Gibson Innovations Limited 2017. All rights reserved
This product has been manufactured by, and is sold
under the responsibility of Gibson Innovations Ltd., and
Gibson Innovations Ltd. is the warrantor in relation to
this product.

Philips and the Philips Shield Emblem are registered trademarks of Koninklijke
Philips N.V. and are used under license



English:

Model: SHB4385

FCC ID: 2AANUSHB4385

ISED Certification Number: 11260A-SHB4385

Notice of compliance

The device complies with the FCC rules, Part 15. Operation is subject to the following two conditions:

1. This device may not cause harmful interference, and
2. This device must accept any interference received, including interference that may cause undesired operation.

FCC rules

This equipment has been tested and found to comply with the limits for a Class B digital device, pursuant to part 15 of the FCC Rules. These limits are designed to provide reasonable protection against harmful interference in a residential installation. This equipment generates, uses and can radiate radio frequency energy and, if not installed and used in accordance with the instruction manual, may cause harmful interference to radio communications.

However, there is no guarantee that interference will not occur in a particular installation. If this equipment does cause harmful interference to radio or television reception, which can be determined by turning the equipment off and on, the user is encouraged to try to correct the interference by one or more of the following measures:

- Relocate the receiving antenna.
- Increase the separation between equipment and receiver.
- Connect the equipment into an outlet on a circuit different from that to which the receiver is connected.
- Consult the dealer or an experienced radio/TV technician for help.

FCC Radiation Exposure Statement:

This equipment complies with FCC radiation exposure limits set forth for an uncontrolled environment.

This transmitter must not be co-located or operating in conjunction with any other antenna or transmitter.

The RF exposure compliance distance is 5 millimeters.

Canada:

This device complies with Industry Canada licence-exempt RSS standard(s). Operation is subject to the following

Two conditions: (1) this device may not cause harmful interference, and (2) this device must accept any interference received, including interference that may cause undesired operation.

CAN ICES-3(B)/NMB-3(B)

IC Radiation Exposure Statement:

This equipment complies with Canada radiation exposure limits set forth for uncontrolled environments.

This transmitter must not be co-located or operating in conjunction with any other antenna or transmitter.

This equipment should be installed and operated with a minimum distance of 5 millimeters between the radiator and your body.

Caution: The user is cautioned that changes or modifications not expressly approved by the party responsible for compliance could void the user's authority to operate the equipment.



French:

Avis de conformité

Cet appareil satisfait aux règlements de la FCC partie 15 du Code of Federal Regulations. Son fonctionnement est assujéti aux deux conditions suivantes :

1. Cet appareil ne doit pas causer d'interférence préjudiciable et
2. l'appareil doit accepter toute interférence reçue, y compris les interférences qui peuvent causer un fonctionnement non désiré.

Règlement de la FCC

Cet équipement a été testé et jugé compatible avec les limites s'appliquant aux appareils numériques de la classe B, conformément à l'article 15 du règlement de la FCC. Ces limites ont été définies pour fournir une protection raisonnable contre les interférences nuisibles dans le cadre d'une installation résidentielle. Cet équipement génère, utilise et peut émettre de l'énergie radiofréquence et, s'il n'est pas installé ni utilisé conformément aux instructions, peut causer des interférences gênantes pour les communications radio.

Rien ne garantit toutefois que des interférences ne surviendront pas dans une installation particulière. Si cet équipement cause des interférences nuisibles pour la réception de la radio ou de la télévision, ce qui peut être déterminé en mettant l'équipement hors tension puis sous tension, l'utilisateur devra essayer de corriger ces interférences en effectuant une ou plusieurs des opérations suivantes :

Déplacez l'antenne de réception.

Augmentez la distance entre l'équipement et le récepteur.

Branchez l'équipement à une prise d'un circuit autre que celui sur lequel le récepteur est branché.

Consultez le détaillant ou un technicien de radiotélévision expérimenté.

La distance de conformité à l'exposition RF est de 5 millimètres

Canada :

Le présent appareil est conforme aux CNR d'Industrie Canada applicables aux appareils radio exempts de licence. L'exploitation est autorisée aux deux conditions suivantes : (1) l'appareil ne doit pas produire de brouillage, et (2) l'utilisateur de l'appareil doit accepter tout brouillage radioélectrique subi, même si le brouillage est susceptible d'en compromettre le fonctionnement.

CAN ICES-3(B)/NMB-3(B)

Déclaration d'IC sur l'exposition aux radiations:

Cet équipement est conforme aux limites d'exposition aux radiations définies par le Canada pour des environnements non contrôlés.

Cet émetteur ne doit pas être installé au même endroit ni utilisé avec une autre antenne ou un autre émetteur.

Cet équipement devrait être installé et actionné avec une distance minimum de 5 millimètres entre le radiateur et votre corps.

