

Gigaset L410 – Freedom of movement while phoning

Using the practical handsfree clip you can speak on the telephone for hours in comfort – with outstanding sound quality. Your Gigaset L410 expands the possibilities of your cordless telephone:

Enjoy full freedom of movement while phoning

Attach the Gigaset L410 to your clothing and move around as you wish while phoning. You can then be reached anywhere at home or in the office and keep your hands free while phoning – without any annoying cables.

Operate the device at the touch of a button

Are you moving around the house and want to take an incoming call? Or do you want to transfer a call on a handset to your handsfree clip? All you need to do is press one button and you'll be connected with the caller.

Hold a three-way conference

A family member is making a call and you would like to participate. Simply join in on the existing call and talk on the telephone together.

Adjust the volume of the Gigaset L410 to your surroundings

Regulate the volume of the loudspeaker and ringtone by simply pressing a key – five volume levels are available. You can also switch off the ringtone completely.

Environment

Environmentally-aware telephone calls – Gigaset Green Home. You can find details on our ECO DECT products at www.gigaset.com/service

Further information is available online at

www.gigaset.com/gigasetl410.

Please register your Gigaset device immediately after purchase, at www.gigaset.com/service – this will enable us to help you more quickly if you have any questions or need to make a claim on the guarantee!

Have lots of fun with your new handsfree clip!

Overview



1 Loudspeaker

2 Volume keys /

Setting the volume of the loudspeaker and the ringtone. → page 11

3 Answer/End call key

Press briefly:

Accept call, take over call*, end call → page 7

Hold down:

Join in on a call → page 9

Hold for more than 3 seconds:

Switch device on/off → page 10

4 Light indicator (LED)

5 Microphone

6 Charging connection

*For example, this function is available on the following telephones: Gigaset C610/C610A, Gigaset S810/S810A and Gigaset SL400/SL400A (see also www.gigaset.com/compatibility).

Light indicator (LED)

Prior to registration

Green flashing 3 x per second Ready to register

After registration

Green flashing every 5 seconds Registered and on stand-by

Red flashing every 5 seconds Battery charge low

Red lit continuously Battery is charging

Green lit continuously Battery is fully charged (device in the charging cradle)

Operating mode display

Green flashing long, 1 x per second Incoming call

Green flashing long, every 5 seconds Ongoing call

Red flashing 1 x per second Registered, but outside the range of your base

Safety precautions

Warning

Read the safety precautions and the user guide before use.

Explain their content and the potential hazards associated with using the telephone to your children.



Use only **rechargeable batteries** that correspond to the **specification provided** on page 13, as this could otherwise result in significant health risks and personal injury.

At the end of the battery's life, the technology will cause the battery to thicken and it may develop a convex curve. In this case, the device will no longer function perfectly. If this occurs, please replace the battery with an original replacement battery (Gigaset V30145-K1310-X448) and dispose of the old battery. Always handle the battery with care, do not damage the casing with sharp objects and do not exert any great pressure on the battery.



Using your telephone may affect nearby medical equipment. Be aware of the technical conditions in your particular environment, e.g., doctor's surgery.

If you use a medical device (e.g. a pacemaker), please contact the device manufacturer. They will be able to advise you regarding the susceptibility of the device to external sources of high frequency energy. Please refer to the Appendix chapter for the specifications of this Gigaset product.



Do not hold the handset to your ear, as doing so could result in serious, lasting hearing damage. Your Gigaset is compatible with the majority of digital hearing aids on the market. However, we cannot guarantee that the device will function perfectly with every hearing aid.

The handset may cause disruptive noises (humming or whistling) in analogue hearing aids, or override these. Please contact your hearing aid technician in the event of problems.



Do not install the charger in bathrooms or shower rooms. The device is not splashproof.



Do not use the phone in environments with a potential explosion hazard, e.g., paint shops.



If you give your phone to a third party, make sure you also give them the user guide.



Remove faulty devices from use or have them repaired by our Service team, as they could interfere with other wireless services.

The Gigaset L410

Gigaset L410 is a handsfree clip for cordless telephones. You attach it to your clothing in order to enjoy complete freedom of movement while on the telephone. The Gigaset L410 is registered to a Gigaset base or a DECT base from another manufacturer. Depending on your base, you can register multiple Gigaset L410 and use them to make internal, external or conference calls.

Prerequisite: Any base from a different manufacturer must be GAP-compatible (see enclosed documentation). GAP (Generic Access Profile) is a standard for the interoperation of handsets and bases from different manufacturers. Information on the range of functions available on various telephones can be found in the section Compatibility (→ page 13).

Getting started

Check the contents of the package

- ◆ Gigaset L410
- ◆ Battery
- ◆ Battery cover with clip
- ◆ Charging cradle with mains plug
- ◆ These instructions for use

Setting up the Gigaset L410

Insert battery

- ▶ Plug the battery connector into the bottom right socket in the casing (see arrow).

The **red** cable on the connector is located on the side of the casing marked with +, the **black cable** on the side marked with -.



- ▶ Place the battery into the casing.

The foam cushion on the battery must face **upwards**. Please ensure that the cables lie between the battery and the casing and not under the battery.



Closing the battery cover

- ▶ Insert the cover at the bottom end of the casing.
- ▶ Close the cover and apply pressure until it locks into place.

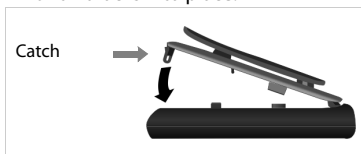

To open the cover again:

- ▶ Loosen the catch and lift the cover upwards.

Registering the device with the base

In order to telephone using your Gigaset L410, it must be registered with your telephone's base. If you purchased the device in a set with a Gigaset telephone, it is already registered.

Note

The Gigaset L410 uses 0000 as its PIN for registration. When you have set another PIN on your base, you must reset this to 0000 to enable registration of the L410. After registration you can change the PIN again.

As soon as you have **inserted the battery**, the device **becomes ready for registration for a 5 minute period**. The LED indicates readiness for registration by flashing (green, 3 x per second).

Following this, the device switches off. When you switch the device on again (by pressing the answer/end call key for at least 3 seconds) it is ready for registration again.

- ▶ For registration, stand close to your telephone's base.
- ▶ Start the registration process with the base as described in your base's operating instructions (on most DECT telephones by holding down the paging key); the base will take up to one minute to complete registration.

Device successfully registered

- ◆ The LED flashes (green, every 5 seconds) and one confirmation tone is emitted (sequence of tones rising in pitch).
- ◆ The device is shown in the internal list of handsets registered to the base.

On telephones that support the full range of functions (→ page 13): with the name **L410**. If more than one Gigaset L410 is registered, a number is appended to the name (**L410-2**, **L410-3**, etc.).

On other telephones: with the internal device name (e.g. **INT 1**, **INT 2**, etc.)

Registration failed

- ◆ A negative confirmation tone is emitted (sequence of tones falling in pitch).
- ◆ If the device cannot be registered within 5 minutes, it switches off.

If the registration was not successful, try again.

- ▶ If necessary, switch on the device again. It is immediately ready for registration.
- ▶ Check whether the registration PIN on the base is set to 0000.
- ▶ Move closer to the base with the Gigaset L410.
- ▶ If the device is already registered to another base, you must de-register it (→ page 10). Following this, it will be ready for registration again.

Securing the clip

- ▶ Attach the Gigaset L410 to your clothing using the clip.

Optimal distance from your mouth: 20 cm

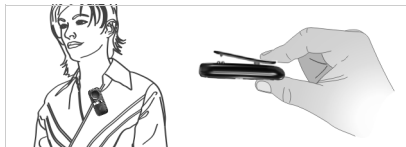

Charging the battery

When delivered, the battery is partly charged. When the device is registered and on stand-by, the charge status is shown as follows:

Device	Battery status	LED
In the charging cradle	Fully charged	Steady green light.
	Charging	Steady red light.
Not in the charging cradle	Sufficient charge	Flashes green, every 5 seconds
	Almost empty	Flashes red, every 5 seconds

In all other operating conditions, (→ page 2) the charge status is not displayed by means of the LED.

When the battery is almost empty, a signal tone is always emitted, 1 x per min.

To charge the battery:

- ▶ Connect the charging cradle to the mains power and place the device in the charging cradle.

It will be fully charged within **2.5 hours**. You can interrupt the charging procedure.

Note: If you place the device in the charging cradle during a call, this will not disconnect the call.

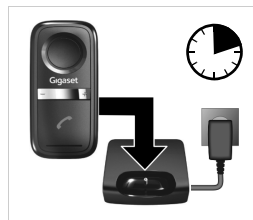

Phoning

With your Gigaset L410 you can accept calls, take over calls or join in on a call. You can call the Gigaset L410 internally from a handset, call back internally, or connect a call.

Accepting a call

An incoming call is indicated by a ringtone and an LED light.

- ▶ Press Answer/End call key.



Ending a call

- ▶ Press Answer/End call key.

Making a call/taking over a call

In order to start an external call, dial the telephone number on the handset.

You can take over the call on the Gigaset L410 as soon as you have started dialling or when the connection is established.

- ▶ Press Answer/End call key.



For example, this function is available on the following telephones: Gigaset C610/C610A, Gigaset S810/S810A and Gigaset SL400/SL400A (see also www.gigaset.com/compatibility).

Note

On other telephones, you must transfer the call from the handset to the Gigaset L410.

- | | |
|---------------|---|
| Handset: | <ul style="list-style-type: none"> ▶ Call the Gigaset L410 on an internal line (with Gigaset telephones, press the Int key to do so, where necessary, select the Gigaset L410 from the list of handsets registered, press Answer call key). ▶ End the external call by pressing the End call key. |
| Gigaset L410: | <ul style="list-style-type: none"> ▶ Press the Answer/End call key to take over the call. |

Transferring a call from the Gigaset L410

You are making a call using the Gigaset L410 and wish to continue the call on the handset.

- ▶ Press the display key **Yes** on the handset.

Note: If you select **No** and then do wish to transfer the call at a later point, use the **“Listening In”** function described below.



For example, this function is available on the following telephones:
Gigaset C610/C610A, Gigaset S810/S810A and Gigaset SL400/SL400A
(see also www.gigaset.com/compatibility).

Note

Alternatively, you can use the **“Listening In”** function if your telephone supports this and you have switched on the function:

- Handset: ▶ **Hold down** the Answer call key.
- Gigaset L410: ▶ End the call

Acoustic feedback (whistling noise) may occur when the handset and Gigaset L410 are connected to a call at the same time.

Telephones that do not support the **“Listening In”** function (e. g. ISDN or IP-telephones), or telephones on which this function is switched off, cannot transfer calls.

Conference calls

A call is being held on the **handset** or on the **Gigaset L410**. You would like to participate in the call with (another) Gigaset L410.

- ▶ **Hold down** the Answer/End call key on the Gigaset L410 (until you hear a short signal tone).

A call is being held on the **Gigaset L410**. You would like to participate in the call using the handset.

- ▶ **Hold down** the Answer call key on the handset.



This applies to telephones that support the "Listening In" function. If necessary, switch this function on.

Note

On telephones without the "Listening In" function (e. g. ISDN or IP telephones), or if the function is switched off:

- | | |
|---|--|
| Handset:
<small>(is in an external call)</small> | ▶ Call the Gigaset L410 on an internal line (with Gigaset telephones, press the Int key to do so, where necessary, select the Gigaset L410 from the list of handsets registered, press Answer call key). |
| Gigaset L410: | ▶ Accept the call. |
| Handset: | ▶ Start the conference call as described in the operating instructions for the handset. |

All participants hear a signal tone when a participant joins or leaves the conference call.

Note

Acoustic feedback (whistling noise) may occur when you are phoning in the same room with a Gigaset L410 and a handset in handsfree mode. In this case, end the handsfree mode on the handset or increase the distance between the devices.

Operating the device

Switching on

- ▶ Press the Answer/End call key for at least 3 seconds until you hear the start-up melody.

Note: When you place a device that is switched off into the charging cradle, it switches on automatically after a maximum of 1 minute.



Switching off

- ▶ Press the Answer/End call key for at least 3 seconds until you hear the shut-down melody.

Searching for the device

- ▶ Select the Gigaset L410 from the list of registered handsets and call it internally or
- ▶ Use your base's paging function.

Deregistering the device from the base

Using your telephone's handset

- ▶ Carry out the standard deregistration procedure for handsets, as described in the operating instructions for the handset.

Deregistering the device from the base and restoring factory settings

- ▶ Switch off the device (→ page 10).
- ▶ Press the Answer/End call key and one of the volume keys (**-** or **+**) simultaneously for at least 3 seconds.

In this case, the device remains in the list of handsets registered to the base until it is also deregistered there.

Note



Following deregistration, the device automatically switches to registration mode.

Changing ringtone and loudspeaker volume

There are two ringtones, one for external and one for internal calls.

5 volume levels are available for the ringtones and loudspeaker. When you reach the highest or lowest volume level you will hear a signal tone.

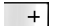
Setting the ringtone volume:

Ringtone quieter		Press briefly		Ringtone louder
Ringtone off		Hold down		Ringtone on

If you do not hear a ringtone when setting the volume, the ringtone is switched off.

Change loudspeaker volume (during a call);

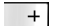
Loudspeaker quieter		Press briefly		Loudspeaker louder
---------------------	---	---------------	---	--------------------

Protecting our environment

Our environmental statement

We at Gigaset Communications GmbH are aware of our social responsibility. That's why we actively take steps to create a better world. In all areas of our business - from product planning and production to sales and waste disposal - following our environmental conscious in everything we do is of utmost importance to us.

Learn more about our earth-friendly products and processes online at gigaset.com
www.gigaset.com.



Gigaset Communications GmbH is certified pursuant to the international standards ISO 14001 and ISO 9001.

ISO 14001 (Environment): certified since September 2007 by TÜV SÜD Management Service GmbH.

ISO 9001 (Quality): certified since 17/02/1994 by TÜV SÜD Management Service GmbH.

ECO DECT

Make your contribution towards protecting the environment with your Gigaset.

Reducing electricity consumption

An electricity-saving plug connector means your device uses less electricity.

Reducing radiation (dependent on base)

It is only possible to reduce radiation when your Gigaset base also supports this function. The radiation from the Gigaset L410 is **automatically** reduced, depending on the distance from the base. In addition, the Gigaset L410 supports the **Eco Mode** functions on Gigaset bases. For more information, please read the instructions for your base.

Appendix

Care

Wipe the unit with a **damp cloth** or an **antistatic cloth**. Do not use solvents or microfibre cloths. **Never** use a dry cloth. This can cause static.

Contact with liquid



If the device comes into contact with liquid:

- 1 **Switch off the device and immediately remove the battery pack .**
- 2 Allow the liquid to drain from the device.
- 3 Pat all parts dry. Place the device in a dry, warm place **for at least 72 hours (not in a microwave, oven etc.)**.
- 4 Do not switch on the device again until it is completely dry.

When it has fully dried out, you will normally be able to use it again.

In rare cases, contact with chemical substances can cause changes to the telephone's exterior. Due to the wide variety of chemical products available on the market, it was not possible to test all substances.

General specifications

DECT-Standard	Is supported
GAP-Standard	Is supported
Radio frequency range	1920MHz - 1930MHz
Transmission power	10 mW, average power per channel 250 mW, pulse power
Repetition frequency of the transmission pulse	100 Hz
Duration of the transmission pulse	370 µs

Environmental conditions for operation	+5°C to +45°C, 20% to 75% relative humidity
Size and weight	79 x 36 x 20 mm (H x B x D), approx. 30 g (including battery)
Standby time	max. 120 hours
Talk time	max. 5 hours
Charging time	max. 2.5 hours
Range	up to 300 m outdoors, up to 50 m indoors
Power supply	110 V, ~60 Hz
Power consumption	1.3 W when charging, 0.05 W when charged

Approved batteries

Li-Polymer (re-chargeable), 240 mAh, part number: Gigaset V30145-K1310-X448

Compatibility

Depending on your cordless DECT telephone, the following functions may be supported:

Function	Telephone	Gigaset C610/C610A, S810/ S810A, SL400/SL400A *	Other Gigaset telephones/GAP telephones from other manufacturers	ISDN and IP-telephones
Accept call on Gigaset L410	yes	yes	yes	yes
Transfer call to Gigaset L410	yes	yes	yes	yes
One-click switch between handset and Gigaset L410	yes	yes	no	no
Join conference call/take over call	yes**	yes**	yes**	no
Include Gigaset L410 in a conference call	yes	yes	yes	yes
* see also www.gigaset.com/compatibility ** The "Listening In" function must be available on the telephone and switched on.				

For detailed information on this, please refer to Phoning → page 7.

Note

The list of compatible Gigaset telephones is continuously being expanded. Up-to-date information can be found at www.gigaset.com/compatibility.

Questions and answers

If you have any queries about the use of your telephone, visit our website at www.gigaset.com/customercare for assistance.

Industry Canada Certification

Operation is subject to the following two conditions (1) this device may not cause interference, and (2) this device must accept any interference, including interference that may cause undesired operation of the device.

NOTICE: The Industry Canada label identifies certified equipment. This certification means that the equipment meets certain, protective, operational and safety requirements as prescribed in the appropriate Terminal Equipment Technical Requirements document(s). The Department does not guarantee the equipment will operate to the user's satisfaction.

Repairs to certified equipment should be coordinated by a representative designated by the supplier. Any repairs or alterations made by the user to this equipment, or equipment malfunctions, may give the telecommunications company cause to request the user to disconnect the equipment.

Users should ensure for their own protection that the electrical ground connections of the power utility, telephone lines and internal metallic water pipe system, if present, are connected together.

This precaution may be particularly important in rural areas

NOTE: Users should not attempt to make such connections themselves, but should contact the appropriate electric inspection authority, or electrician, as appropriate.

This product meets the applicable Industry Canada technical specifications.

This Class B digital apparatus complies with Canadian ICES-003.

Cet appareil numérique de la classe B est conforme à la norme NMB-003 du Canada.

FCC / ACTA Information

Warning: Changes or modifications to this unit not expressly approved by Gigaset Communications Inc. could void the FCC authority to operate the equipment. This includes the addition of any external antenna device.

If this equipment causes harm to the telephone network, the telephone company will notify you in advance, that temporary discontinuance of service may be required. But if advance notice isn't practical, the telephone company will notify the customer as soon as possible. Also, you will be advised of your right to file a complaint with the FCC if you believe it is necessary. The telephone company may make changes in its facilities, equipment, operations or procedures that could affect the operation of the equipment. If this happens the telephone company will provide advance notice in order for you to make necessary modifications to maintain uninterrupted service. If you experience trouble with this equipment, disconnect it from the network until the problem has been corrected or until you are sure that the equipment is not malfunctioning.

If trouble is experienced with this equipment, for repair or warranty information, please contact Support at 1-866 247-8758. If the equipment is causing harm to the telephone network, the telephone company may request that you disconnect the equipment until the

problem is resolved. This equipment is of a type that is not intended to be repaired by the Customer (user).

Privacy of communications may not be ensured when using this phone.

This equipment has been tested and found to comply with the limits for Class B digital device, pursuant to Part 15 of the FCC Rules. Operation is subject to the following two conditions: (1) This device may not cause harmful interference, and (2) This device must accept any interference received, including interference that may cause undesired operation. These limits are designed to provide reasonable protection against harmful interference in a residential installation. Some cordless telephones operate at frequencies that may cause interference to nearby TV's and VCR's; to minimize or prevent such interference, the system base should not be placed near or on top of a TV or VCR; and, if interference is experienced, moving the base farther away from the TV or VCR will often reduce or eliminate the interference.

However, there is no guarantee that interference will not occur in a particular installation.

If this equipment does cause harmful interference to radio or television reception, which can be determined by turning the system off and on, the user is encouraged to try to correct the interference by one or more of the following measures:

1. Reorient or relocate the receiving antenna.
2. Increase the separation between the base station and receiver.
3. Connect the base station into an outlet on a circuit different from that to which the receiver is connected.
4. Consult the dealer or an experienced radio TV technician for help.

Power Outage:

In the event of a power outage, your cordless telephone will not operate. The cordless telephone requires electricity for operation. You should have a telephone that does not require electricity available for use during power outages.

For body worn operation, the equipment has been assessed and meets FCC RF exposure guidelines. Use with an accessory that contains metal parts may not ensure compliance with FCC RF exposure guidelines.

Safety precautions

Before using your telephone equipment, basic safety instructions should always be followed to reduce the risk of fire, electric shock and injury to persons.

1. Read and understand all instructions.
2. Follow all warnings and instructions marked on the product.
3. Unplug this product from the wall telephone jack and power outlet before cleaning. Do not use liquid cleaners or aerosol cleaners. Use damp cloth for cleaning.
4. Do not use this product near water, for example, near a bathtub, wash bowl, kitchen sink, or laundry tub, in a wet basement or near a swimming pool.
5. Place this product securely on a stable surface. Serious damage and/or injury may result if the unit falls.
6. Slots or openings in the cabinet and the back and bottom are provided for ventilation, to protect it from overheating. These openings must not be blocked or covered. This product should never be placed near or over a radiator or heat register, or in a place where proper ventilation is not provided.
7. This product should be operated only from the type of power source indicated on the marking label. If you are not sure of the type of AC line power to your home, consult your dealer or local power company.

8. Do not place objects on the power cord. Install the unit where no one can step or trip on the cord.
9. Do not overload wall outlets and extension cords as this can result in the risk of fire or electric shock.
10. Never push objects of any kind into this product through cabinet slots as they may touch dangerous voltage points or short out parts that could result in the risk of fire or electric shock. Never spill liquid of any kind on this product.
11. To reduce the risk of electric shock or burns, do not disassemble this product. Take it to a qualified service center when service is required. Opening or removing covers may expose you to dangerous voltages, dangerous electrical current or other risks. Incorrect reassembly can cause electric shock when the appliance is subsequently used. Disconnect TNV circuit connector before removing cover.
12. Unplug the product from the wall outlet and refer servicing to qualified service personnel under the following conditions:
 - a.) When the power cord is damaged or frayed.
 - b.) If liquid has been spilled into the product.
 - c.) If the product has been exposed to rain or water.
 - d.) If the product does not operate normally by following the operating instructions. Adjust only those controls that are covered by the operating instructions because improper adjustment of other controls may result in damage and may require extensive work by a qualified technician to restore the product to normal operation.
 - e.) If the product has been dropped or physically has been damaged.
 - f.) If the product exhibits a distinct change in performance.
13. Avoid using a telephone (other than a cordless type) during a thunderstorm. There may be a remote risk of electrical shock from lightning. Therefore we suggest a surge arrester.
14. Do not use the telephone to report a gas leak in the vicinity of the leak.
15. Emergency/911 numbers may not be dialed if the keypad is locked.
16. Minimum No. 26 AWG telecommunication line cord must be used with this phone.



ETL LISTED
CONFORMS TO
ANSI/UL STD 60950-1
CERTIFIED TO
CAN/CSA C22.2 No.60950-1

BATTERY SAFETY PRECAUTIONS

To reduce the risk of fire, injury or electric shock, and to properly dispose of batteries, please read and understand the following instructions.

CONTAINS NICKEL METAL HYDRIDE BATTERY. BATTERY MUST BE RECYCLED OR DISPOSED OF PROPERLY. DO NOT DISPOSE OF IN MUNICIPAL WASTE.

1. Only use the batteries specified for use with this product.
2. DO NOT USE NICKEL CADMIUM OR LITHIUM BATTERIES, or mix batteries of different sizes or from different manufacturers in this product. DO NOT USE NONRECHARGEABLE BATTERIES.
3. Do not dispose of the batteries in a fire; the cells may explode. Do not expose batteries to

water. Check with local codes for special disposal instructions.

4. Do not open or mutilate the batteries. Released electrolyte is corrosive and may cause damage to the eyes or skin. The electrolyte may be toxic if swallowed.

5. Exercise care in handling the batteries in order not to short the batteries with conducting materials such as rings, bracelets, and keys. The batteries or conducting material may overheat and cause burns or fire.

6. Charge the batteries provided with, or identified for use with, this product only in accordance with the instructions and limitations specified in the user's manual. Do not attempt to charge the batteries with any means other than that specified in the users manual.

7. Periodically clean the charge contacts on both the charger and handset.

Service (Customer Care)

Customer Care Warranty for Cordless Products

To obtain Customer Care Warranty service,
product operation information, or for problem resolution, call:
Toll Free: 1-866 247-8758

End-user limited warranty

This product is covered by a one year limited warranty. Any repair replacement or warranty service, and all questions about this product should be directed to: 1-866 247-8758.

This limited, non-transferable warranty is provided to the original buyer/end-consumer ("you") for systems, handsets and accessories (collectively, "Product") provided by Gigaset Communications Inc. (collectively "Gigaset NAM"). Gigaset NAM warrants to you that at the date of purchase, the Product is free of defects in workmanship and materials and the software included in the Product will perform in substantial compliance to its program specifications.

1. WARRANTY PERIOD

The Product warranty period is one (1) year from the original date of purchase by you. Proof of purchase (e.g., sales slip or invoice) must be provided with any Product returned during the warranty period. Batteries supplied with the Products are warranted to be free from defects at the time of purchase only.

2. EXCLUSIVE REMEDY

Gigaset NAM's entire liability and your exclusive remedy if the Product is defective in materials or workmanship during the warranty period and is returned shall be that the Product will be repaired or replaced as set forth in Section 4 below. Reconditioned replacement components, parts or materials may be used in the replacement or repair. Data in the memory of the Product may be lost during repair.

3. THIS LIMITED WARRANTY DOES NOT COVER AND IS VOID WITH RESPECT TO THE FOLLOWING:

Cosmetic damage, physical damage to the surface of the Product, including, without limitation, breakage, cracks, dents, scratches or adhesive marks on the LCD screen or outside casing of the Product.

Products which have been repaired, maintained or modified (including the antenna) by anyone other than Gigaset NAM or a Gigaset NAM-approved repair facility, or that have been improperly installed.

Cost of installation, removal or reinstallation.

Damage due to any telephone, electronic, hardware or software program, network, Internet or computer malfunctions, failures, or difficulties of any kind, including without limitation, server failure or incomplete, incorrect, garbled or delayed computer transmissions.

Equipment and components not manufactured, supplied or authorized by Gigaset NAM.

Modification of the Product's components, or operation of the Product in an unsuitable environment or in a manner for which it is not intended, including but not limited to failures or defects caused by misuse, abuse, accidents, physical damage, abnormal operation, improper handling or storage, neglect, alterations, unauthorized installation, removal or repairs, failure to follow instructions, problems caused by the carrier's network coverage, exposure to fire, water or excessive moisture or dampness, floods, or extreme changes in climate or temperature, acts of God, riots, acts of terrorism, spills of food or liquids, viruses or other software flaws introduced into the Product or other acts which are not the fault of Gigaset NAM and which the Product is not specified to tolerate, including damage caused by mishandling or blown fuses.

Products which have had warranty stickers, electronic serial number and/or serial number label removed, altered, rendered illegible or fraudulently applied to other equipment.

Signal reception problems (unless caused by defect in material or workmanship in the Product).

Products operated outside published maximum ratings.

Performance of the Products when used in combination with other products or equipment not manufactured, supplied or authorized by Gigaset NAM.

Consumables (such as batteries and fuses).

Payments for labor or service to representatives or service centers not authorized to perform product maintenance by Gigaset NAM.

Loss of data.

Testing and examination discloses that the alleged defect or malfunction in the Product does not exist.

This warranty does not cover customer education, instruction, installation or removal, set up adjustments, problems related to service(s) provided by a carrier or other service provider, and/or signal reception problems. Gigaset NAM shall not be responsible for software, firmware, information, or memory data contained in, stored on, or integrated with any Products returned for repair, whether under warranty or not. This warranty is valid only in the country in which it is purchased (*i.e.*, the United States of America or Canada respectively, but not both).

USE WITH ACCESSORIES NOT SUPPLIED BY GIGASET NAM OR NOT OTHERWISE EXPRESSLY AUTHORIZED BY GIGASET NAM MAY VOID WARRANTY.

4. WARRANTY CLAIM PROCEDURE

All warranty claims must be made by notifying Gigaset NAM prior to the expiration of the warranty period. Gigaset NAM's obligation to provide warranty support shall not extend past the end of the warranty period, except that any product repaired or replaced during the warranty period shall continue to be warranted for the balance of such warranty period or thirty (30) days, whichever is greater.

Support service will be provided for you by accessing the toll free customer service number:

1-866 247-8758

5. LIMITATION OF WARRANTY

Gigaset NAM makes no warranty or representation that the software in the Products will meet your requirements or will work in combination with any hardware or applications software products provided by third parties, that the operation of the software will be uninterrupted or error free, or that all defects in the software products will be corrected.

6. LIMITATION ON REMEDIES; NO CONSEQUENTIAL OR OTHER DAMAGES

Your exclusive remedy for any breach of this limited warranty is as set forth above. Except for any refund elected by Gigaset NAM, **YOU ARE NOT ENTITLED TO ANY DAMAGES, INCLUDING BUT NOT LIMITED TO CONSEQUENTIAL DAMAGES**, if the Product does not meet the limited warranty, and, to the maximum extent allowed by applicable law, even if any remedy fails of its essential purpose. The terms below ("Exclusion of Incidental, Consequential and Certain Other Damages") are also incorporated into this limited warranty. Some states/jurisdictions/provinces do not allow the exclusion or limitation of incidental or consequential damages, so the above limitation or exclusion may not apply to you. This limited warranty gives you specific legal rights. You may have others which vary from state/jurisdiction/province to state/jurisdiction/province.

7. DISCLAIMER OF WARRANTIES

GIGASET NAM AND ITS SUPPLIERS PROVIDE THE PRODUCT AND SUPPORT SERVICES (IF ANY) AS IS AND WITH ALL FAULTS. THE LIMITED WARRANTY IS IN LIEU OF ANY OTHER EXPRESS WARRANTIES (IF ANY) CREATED BY ANY DOCUMENTATION OR PACKAGING EXCEPT FOR THE LIMITED WARRANTY, AND TO THE MAXIMUM EXTENT PERMITTED BY APPLICABLE LAW IS IN LIEU OF ANY IMPLIED OR STATUTORY WARRANTIES, INCLUDING, BUT NOT LIMITED TO, THE IMPLIED WARRANTIES OF MERCHANTABILITY AND FITNESS FOR A PARTICULAR PURPOSE, OF ACCURACY OR COMPLETENESS OR RESPONSES, OF RESULTS, OF WORKMANLIKE EFFORT, OF LACK OF VIRUSES AND OF LACK OF NEGLIGENCE, ALL WITH REGARD TO THE PRODUCT, AND THE PROVISION OF OR FAILURE TO PROVIDE SUPPORT SERVICES. ALSO, THERE IS NO WARRANTY OR CONDITION OF TITLE, QUIET ENJOYMENT, QUIET POSSESSION, OR CORRESPONDENCE TO DESCRIPTION OR NONINFRINGEMENT WITH REGARD TO THE PRODUCT. Some states/jurisdictions/provinces do not allow limitations on how long an implied warranty lasts or the exclusion or limitation of incidental or consequential damages, so the above exclusions or limitations may not apply to you. If an implied warranty or condition is created by your state/province and federal or state/provincial law prohibits disclaimer of it, you also have an implied warranty or condition, **BUT ONLY AS TO DEFECTS DISCOVERED DURING THE PERIOD OF THIS LIMITED WARRANTY (ONE YEAR)**. AS TO ANY DEFECTS DISCOVERED AFTER THE ONE YEAR PERIOD, THERE IS NO WARRANTY OR CONDITION OF ANY KIND. This limited warranty gives you specific legal rights, and you may also have other rights which vary from state to state/province to province. In no event shall Gigaset NAM's liability exceed the cost of repairing or replacing defective Products as provided herein, and any such liabilities will terminate upon expiration of the warranty period. Any supplements or updates to the Product or the software in the Product, including without limitation, any (if any) software fixes or upgrades or bug fixes provided to you after the expiration of the one year limited warranty period are not covered by any warranty or condition, express, implied or statutory.

8. EXCLUSION OF INCIDENTAL, CONSEQUENTIAL AND CERTAIN OTHER DAMAGES

TO THE MAXIMUM EXTENT PERMITTED BY APPLICABLE LAW, IN NO EVENT SHALL GIGASET NAM, SELLER OR THEIR SUPPLIERS BE LIABLE FOR ANY SPECIAL, INCIDENTAL, INDIRECT, OR CONSEQUENTIAL DAMAGES WHATSOEVER (INCLUDING, BUT NOT LIMITED TO, DAMAGES FOR LOSS OF PROFITS OR CONFIDENTIAL OR OTHER INFORMATION, FOR BUSINESS INTERRUPTION, FOR PERSONAL INJURY, FOR LOSS OF PRIVACY, FOR FAILURE TO MEET ANY DUTY INCLUDING OF GOOD FAITH OR OF REASONABLE CARE, FOR NEGLIGENCE, AND FOR ANY OTHER PECUNIARY OR OTHER LOSS WHATSOEVER) ARISING OUT OF OR IN ANY WAY RELATED TO THE USE OF OR INABILITY TO USE THE PRODUCT, THE PROVISION OF OR FAILURE TO PROVIDE SUPPORT SERVICES, OR OTHERWISE UNDER OR IN CONNECTION WITH ANY PROVISION OF THIS LIMITED WARRANTY, EVEN IN THE EVENT OF THE FAULT, TORT (INCLUDING NEGLIGENCE), STRICT LIABILITY, BREACH OF CONTRACT OR BREACH OF WARRANTY OF GIGASET NAM OR SELLER OR ANY SUPPLIER, AND EVEN IF GIGASET NAM OR SELLER OR ANY SUPPLIER HAS BEEN ADVISED OF THE POSSIBILITY OF SUCH DAMAGES. REPAIR OR REPLACEMENT, AS PROVIDED UNDER THE WARRANTY, IS YOUR SOLE AND EXCLUSIVE REMEDY FOR BREACH OF THE LIMITED WARRANTY.

9. LIMITATION OF LIABILITY AND REMEDIES

NOTWITHSTANDING ANY DAMAGES THAT YOU MIGHT INCUR FOR ANY REASON WHATSOEVER (INCLUDING, WITHOUT LIMITATION, ALL DAMAGES REFERENCED ABOVE AND ALL DIRECT OR GENERAL DAMAGES), THE ENTIRE LIABILITY OF GIGASET NAM, SELLER AND ANY OF THEIR SUPPLIERS UNDER ANY PROVISION OF THIS LIMITED WARRANTY AND YOUR EXCLUSIVE REMEDY FOR ALL OF THE FOREGOING (EXCEPT FOR ANY REMEDY OF REPAIR OR REPLACEMENT ELECTED BY GIGASET NAM OR SELLER OR SUPPLIER WITH RESPECT TO ANY BREACH OF THE LIMITED WARRANTY) SHALL BE LIMITED TO THE GREATER OF THE AMOUNT ACTUALLY PAID BY YOU FOR THE PRODUCT OR FIVE DOLLARS (\$5.00 USD/CAN). THE FOREGOING LIMITATIONS, EXCLUSIONS AND DISCLAIMERS SHALL APPLY TO THE MAXIMUM EXTENT PERMITTED BY APPLICABLE LAW, EVEN IF ANY REMEDY FAILS ITS ESSENTIAL PURPOSE.

10. GOVERNING LAW

If this Product was purchased in the United States of America this limited warranty will be governed by the laws of Texas, and exclude the United Nations Convention on Contracts for the International Sale of Goods. If this Product was purchased in Canada this limited warranty will be governed by the laws of the Province of Ontario and the federal laws of Canada applicable therein, and exclude the United Nations Convention on Contracts for the International Sale of Goods.

If you want to learn more about Gigaset Service or for Support on your Gigaset phone, visit our web site at <http://www.gigaset.com> or please call 1-866 247-8758.

Issued by

Gigaset Communications GmbH

Frankenstr. 2a, D-46395 Bocholt

© Gigaset Communications GmbH 2011

All rights reserved.

Subject to availability. Rights of modifications reserved.

Product attributes subject to change.

We reserve the right, to make changes without notice in equipment design and/or components.

Part Number:

© Copyright 2011.