

SmartBox A4S

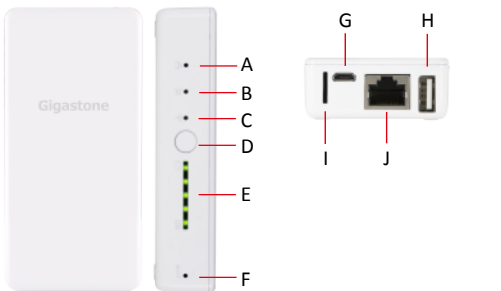

EN Smart Box Appearance and Introduction

- A. Internet Bridge Indicator (Red LED * 1)
 B. Micro SD Drive Indicator (Orange LED * 1)
 C. WiFi Indicator (Blue LED * 1)
 D. Power Button
 • Press 1 sec: Power Check
 • Press 5 sec: Power On/Off
 E. Power Level Indicator (Green LED * 5)
 F. Reset Button
 G. Micro USB Port: DC-IN 5V/1A
 Power Input
 H. USB Port: USB Data Transfer / 5V 2A Output for Charging
 I. MicroSD Slot
 J. RJ45 10/100 Mbps Ethernet Port

TC 外觀功能與介紹

- A. 網際網路橋接 狀態顯示 (LED紅燈 *1)
 B. Micro SD卡 狀態顯示 (LED橘燈 *1)
 C. WiFi 狀態顯示 (LED藍燈 * 1)
 D. 電源開關
 • 短按一秒: 電量顯示
 • 長按五秒: 開機 / 關機
 E. 電量顯示 (LED綠燈 * 5)
 F. 重置按鈕
 G. Micro USB 連接埠: DC-IN5V/1A 電源輸入
 H. USB連接埠: USB 資料傳輸 / 2A 放電輸出
 I. MicroSD 卡槽
 J. RJ45 10/100 Mbps 乙太網路連接埠

Limited Warranty 產品保證書		Gigastone	
Model 型號	_____		
Purchase Date 購買日期	_____ / _____ / _____		
Name 姓名	_____		
Address 聯絡地址	_____		
Phone 聯絡電話	_____		
e-mail 電子郵件	_____		

Return Merchandise & Quality Assurance
Gigastone America
 15770 Laguna Canyon Road, #100
 Irvine, California 92618

異常返修 品質保證
Gigastone Taiwan
 350 苗栗縣竹南鎮新義路 69 號
 Tel: +886-37-288-389 #321

website
www.gigastone.com
 e-mail
service@gigastone.com



EN I. Charge Your Smart Phone II. Read Micro SD/USB storage data

- I. Use Smart Box to charge your smart phone or tablet:**
 1. Connect smart phone to Smart Box USB port
 2. Press the power button and Smart Box will start charging
- II. Use Smart Box to access USB storage or MicroSD card:**
 1. Plug USB storage in Smart Box USB port or MicroSD card in card slot
 2. Press the power button for 5 seconds
 3. Smart Box is (now) able to share storage data via WiFi
- Note: When Smart Box is being charged through the Micro USB port, the USB port will not be available

TC I. 為您的智慧型手機充電 II. 讀取 MicroSD/USB 儲存裝置資料

- I. 使用 Smart Box 為您的智慧型手機或是平板充電:**
 1. 將智慧型手機連接至 Smart Box USB 連接埠
 2. 按開關後 Smart Box 開始為手機充電
- II. 使用 Smart Box 讀取 USB 或 MicroSD 卡 儲存裝置資料:**
 1. 將 USB 儲存裝置連接至 Smart Box USB 連接埠 · 或將 MicroSD 卡插入卡槽
 2. 長按開關 5 秒鐘
 3. Smart Box 開始透過 WiFi 分享 儲存裝置內的資料
- 注意事項: 當 Smart box 正透過 Micro USB 埠進行充電時 · USB port 將無法使用



EN Search Smart Box App in Apple Store or Google Play

1. Search for the key word: Gigastone
2. Select Gigastone Smart Box App
3. Tap "INSTALL" button to install App

TC 為您的智慧型手機充電/讀取 USB 儲存裝置資料

1. 搜尋 Gigastone
2. 點擊 Gigastone Smart Box 應用程式
3. 點擊 "安裝" 按鈕

* 應用程序下載點選:
 iPhone/iPad: 蘋果 App Store
 Android: Google Play 商店 · 安卓市場 · 機鋒網 · 豌豆莢 · 騰訊手機應用 · 360 手機應用...等 ·

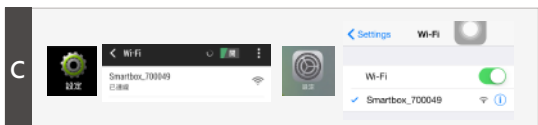

EN Connect to Smart Box over WiFi

1. Open WiFi network setting on iPhone or Android devices
2. Select SSID "Smartbox_xxxxxx" to use WiFi network

TC 建立 WiFi 連線至 Smart Box

1. 點選 iPhone 或 Android 裝置的 WiFi 網路設定
2. 選取 SSID "Smartbox_xxxxxx" 即可使用無線網路連線

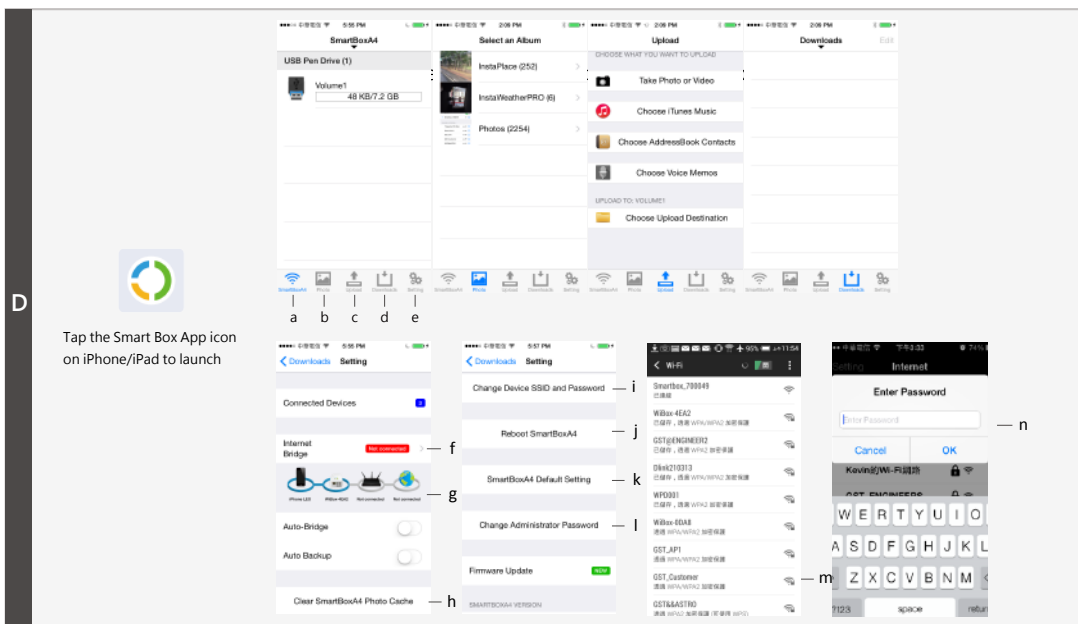

EN Launch Smart Box App (iPhone/iPad)

Main Menu

- a. Smart Box: Multimedia contents in Smart Box
- b. Photo: Upload photos
- c. Upload: Upload photos, video, music, contacts and documents
- d. Downloads: Downloaded documents
- e. Setting: Smart Box settings

Setting

- f. Internet bridge
- g. Internet connection status
- h. Clear Smart Box photo cache
- i. Customize Smart Box SSID & password
- j. Reboot Smart Box
- k. Reset Smart Box to default setting
- l. Administrator password setting (Default Password: 0000)

Internet Bridge Setting

- m. Select WiFi hotspot connecting to internet
- n. Enter hotspot password

TC Smart Box 應用程式功能選單 (iPhone/iPad)

主選單

- a. Smart Box: 多媒體檔案庫
- b. 照片: 上傳照片與圖像類型檔案
- c. 上傳: 影音、通訊錄、文件上傳
- d. 下載: 已下載的文件檔案
- e. 設定: Smart Box 設定選單

設定 Smart Box

- f. 網際網路橋接
- g. 網際網路連線狀態
- h. 清除 Smart Box 圖檔暫存
- i. 使用者設定 Smart Box 連線 SSID 與密碼
- j. 點選後可重開 Smart Box
- k. 點選後可恢復 Smart Box 原廠預設值
- l. 設定管理者密碼 (預設密碼: 0000)

網際網路連線設定

- m. 選擇網際網路連線熱點
- n. 輸入熱點密碼



FCC ID: PLEWD5203
 Brand name: Media Streamer
 Model name: A4S

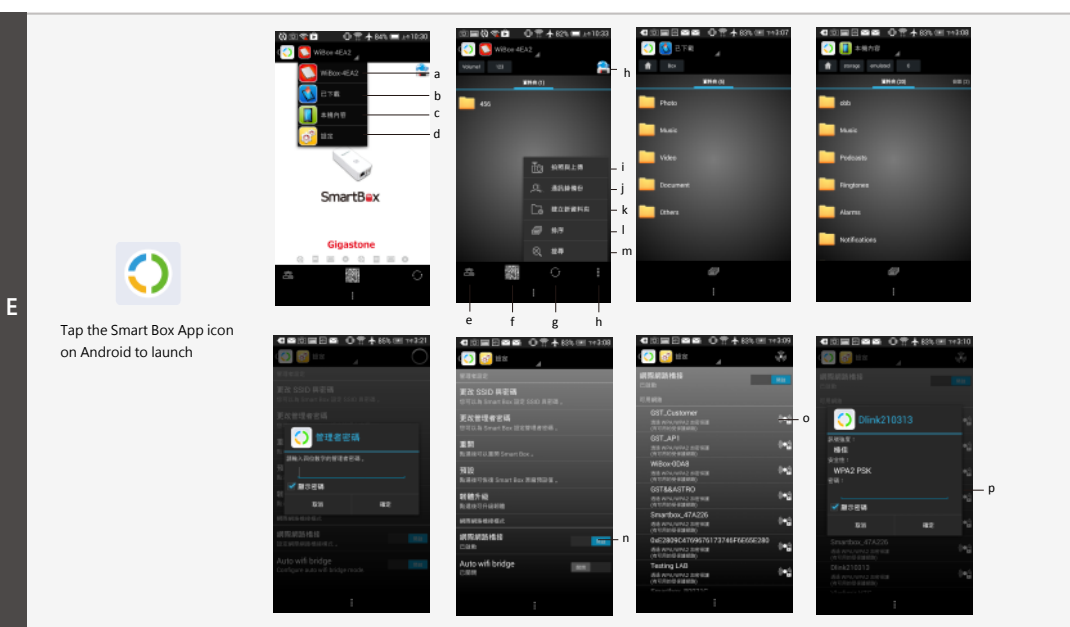

E Tap the Smart Box App icon on Android to launch

EN Launch Smart Box App (Android)

- Main Menu**
- a. Smart Box: Multimedia contents in Smart Box
 - b. Download: Downloaded contents
 - c. Local drive: Local contents on Android device
 - d. Setting: Configuring Smart Box & WiFi (Default Administrator Password: 0000)
- Smart Box**
- e. WiFi connection status and settings
 - f. QR code
 - g. Refresh
 - h. Power level and system information
 - i. Take a photo and upload
 - j. Contacts backup
 - k. Create new folder
 - l. Sort
 - m. Search
- Internet Bridge Setting**
- n. Internet bridge
 - o. Select WiFi hotspot connect to internet
 - p. Enter hotspot password

Warning: Changes or modifications to this unit not expressly approved by the party responsible for compliance could void the user's authority to operate the equipment.
NOTE: This equipment has been tested and found to comply with the limits for a Class B digital device, pursuant to Part 15 of the FCC Rules. These limits are designed to provide reasonable protection against harmful interference in a residential installation. This equipment generates, uses and can radiate radio frequency energy and, if not installed and used in accordance with the instructions, may cause harmful interference to radio communications. However, there is no guarantee that interference will not occur in a particular installation. If this equipment does cause harmful interference to radio or television reception, which can be determined by turning the equipment off and on, the user is encouraged to try to correct the interference by one or more of the following measures:
Reorient or relocate the receiving antenna.
Increase the separation between the equipment and receiver.
Connect the equipment into an outlet on a circuit different from that to which the receiver is connected.
Consult the dealer or an experienced radio/TV technician for help.

TC Smart Box 應用程式功能選單 (Android)

- 主選單**
- a. Smart Box: 多媒體檔案庫
 - b. 已下載: 已下載文件檔案
 - c. 本機內容: Android 裝置上的檔案內容
 - d. 設定: Smart Box 與無線網路功能選項 (預設管理者密碼: 0000)
- Smart Box**
- e. 無線網路連線狀態和設定
 - f. QR code
 - g. 重新整理
 - h. 電量顯示與系統資訊
 - i. 拍照與上傳
 - j. 通訊錄備份
 - k. 建立新資料夾
 - l. 排序
 - m. 搜尋
- 網際網路連線設定**
- n. 網際網路橋接
 - o. 選擇網際網路連線熱點
 - p. 輸入熱點密碼

This device complies with Part 15 of the FCC Rules. Operation is subject to the following two conditions:
(1) this device may not cause harmful interference, and
(2) this device must accept any interference received, including interference that may cause undesired operation.
This equipment complies with FCC radiation exposure limits set forth for an uncontrolled environment. End user must follow the specific operating instructions for satisfying RF exposure compliance. This transmitter must not be co-located or operating in conjunction with any other antenna or transmitter. The portable device is designed to meet the requirements for exposure to radio waves established by the Federal Communications Commission (USA). These requirements set a SAR limit of 1.6 W/kg averaged over one gram of tissue. The highest SAR value reported under this standard during product certification for use when properly worn on the body

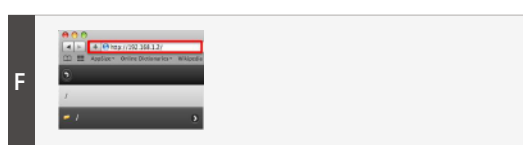

EN Access Smart Box Via Browsers

1. Connect to Smart Box over WiFi
 2. Open a web browser and type "192.168.1.2" or "gigastone.SmartBox"
 3. Open the Web page to access the contents in Smart Box (Default Password: none)
- * URL mode does not support "multi-select" function

TC 透過網頁瀏覽器連接 Smart Box

1. 透過 WiFi 無線網路與 Smart Box 進行連線
 2. 開啟網頁瀏覽器並於網址列輸入 "192.168.1.2" 或 "gigastone.SmartBox"
 3. 開啟頁面存取 Smart Box 內的檔案內容 (預設密碼: 無)
- * 網頁存取模式不支援多重選取功能

Product Specifications

Product Name	Gigastone Smart Box
Part Number	Smart Box A4S
Dimension	104 x 50 x 22.4 mm
Weight	150 g
Battery	5200mAh
Charge In	DC 5V/1000mA
Charge Out	DC 5V/2000mA
LAN Port	RJ45 10/100 Mbps
Operation Temp.	5°C ~ 40°C

Product Features

Wireless Portable Drive	Wireless file server
	Wireless video/audio playback
	Support up to 6 devices simultaneously
USB mass storage	Wireless MicroSD card reader
	MicroSD card reader
Portable Power Bank	USB pen drive
	MicroSD 卡讀卡器
	DC 5V/500mA or DC 5V/2000mA output

Support Media Type

Operating System	iOS	Android
Photo	JPG, JPEG, PNG, BMP	
Audio	MP3, WAV	
Video	MOV, M4V	MP4
Document	DOC, XLS, PPT, PDF, TXT	

Caution

- Observe the following cautions carefully to avoid damage, fire, or burst of the product:
- Do not attempt to disassemble, modify or repair the product by yourself.
 - Do not drop or hit this product. Doing so may damage the product.
 - Do not expose the product to any of the following:
 - Dust
 - Direct sunlight
 - High temperatures
 - Moisture
 - Magnetic fields

Quick Start References

- Please charge partially for testing purposes in the factory. It is recommended to charge battery completely before use.
- Powers off automatically after 10 minutes of inactivity to save energy.
- LED**

Charging Smart Box Battery	Flash Green
Smart Box charge complete	Solid Green
When Power Off	Solid Green
Access SD card	Flash Orange
WiFi Mode	Flash Blue

Package Contents

Smart Box A4S	1 pc
USB Cable	1 pc
User Manual	1 sheet

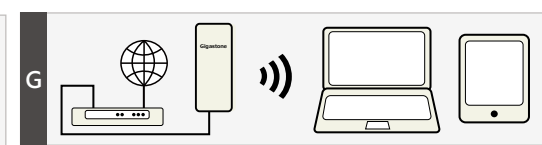

EN Router Mode

Convert modem to wireless network. Suited to connecting directly to a modem.

TC Router 模式

將數據機有線網路轉為無線網路。適用於直接連接數據機。

產品規格

產品名稱	無線儲存充電寶
產品型號	Smart Box A4S
外型尺寸	104 x 50 x 22.4 mm
產品重量	150 g
內建鋰電池	5200mAh
充電輸入	DC 5V/1000mA
充電輸出	DC 5V/2000mA
乙太網路介面	RJ45 10/100 Mbps
操作溫度	5°C ~ 40°C

產品功能

WiFi 無線行動存儲碟	無線檔案伺服器
	無線影音播放
	6 台裝置同時連線播放
USB 儲存裝置	無線 MicroSD 卡讀卡器
	USB 隨身碟
手機行動電源 (充電寶)	MicroSD 卡讀卡器
	DC 5V/500mA 或 DC 5V/2000mA 輸出

檔案格式支援

作業系統	iOS	Android
相片	JPG, JPEG, PNG, BMP	
音樂	MP3, WAV	
影片	MOV, M4V	MP4
文件	DOC, XLS, PPT, PDF, TXT	

注意事項

- 請遵守小心以下注意事項，避免造成傷害、火災或產品爆裂：
 - 請勿自行試圖拆卸、修改或維修產品。
 - 請勿摔落或撞擊本產品。這樣做可能會損壞產品。
 - 請不要將產品暴露在下列環境：
 - 多塵的地方
 - 陽光曝曬下的汽車內、陽光直射或高溫的環境
 - 潮濕或可能會出現冷凝的環境
 - 電磁波與高磁場產生的地方

快速入門參考

- 電池出廠前已部份充電，僅供出廠檢測使用，建議第一次使用前將電池充飽後再使用。
- 開置 10 分鐘後自動斷電，以節省能源。
- LED**

Smart Box 充電中	綠燈閃爍
充滿電	綠燈恆亮
讀取 / 存取記憶卡資料	橘燈閃爍
WiFi Mode	藍燈閃爍

包裝內容

無線儲存充電寶 A4S	1 個
USB 傳輸線	1 個
使用手冊	1 張