

*Installation wiring diagram for FM main unit (engine start type)

!You must re-connect the power wire or turn ignition to ON position, then press override button for 2secs to validate the setting.

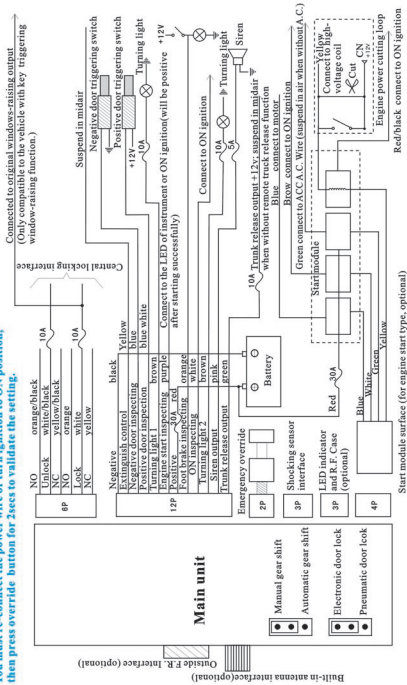

- (2) steps for pre-engage failure:
- If the any door remains open over 2 minutes, motor extinguishes automatically and pre-engage fails.
 - While pulling the key out, stepping on the brake will disable pre-engage.

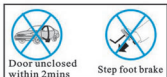

- (3) steps for none- pre-engage or canceling pre-engage:
- If there is no need for pre-engage or there is need to stop car (for example, stop car on slope), please step foot-brake and draw the key out. Motor stops without pre-engage engine start.
 - After managing to pre-engage, open the door once again or restart it, pre-engage cancelled.
 - Door-open warning or ignition warning can also disable pre-engage.

Without pre-engage engine start



Step foot brake

Draw out key

Without pre-engage engine start



Without pre-engage engine start



(4) remote engine start/disable

The operation can only be carried out under such conditions: the ignition is not at ON for manual gearshift vehicles, successful pre-engage engine start is needed. For automatic gearshift vehicles, the gear should be at P or N level.

Reaction: press B button for 2 secs, the engine starts after 3 secs, after starting successfully, the turning light flashes once, siren sounds once. Transmitter displays \Rightarrow on screen. If not start successfully, the turning light flashes twice and siren sounds twice.



Remote displays \Rightarrow sign



without \Rightarrow sign on remote

Please disarm the car before getting on the car, and then turn ignition key to ON position within 30 seconds; otherwise, the engine will be disabled automatically. (Note: don't step the footbrake before inserting the ignition key, otherwise the engine will be disabled automatically.)



Turn ignition key to ON position within 30secs

Notes on installation of the main unit

1. Carefully read the operation manual before installing, understanding the installation diagram. At first get an understanding of the circuit diagram and wiring method for the car on which the unit is to be installed. For any queries, please consult our agents.
2. Determine the installation location of the main unit first. The main unit shall be installed in a hidden location where is not subject to high temperature, moisture and away from other electronic equipment of the car. Insert the harness plug into the main unit, use tape to secure the front end of the harness, then locate the car control line to be connected, such as main power supply line, ignition ON line, lines for car lights and door opening signal, etc., for car models without such a signal, appropriate induction switch shall be added.
3. When performing wirings, the main power supply connection shall be made after other wirings are completed and verified to be error-free. All connections shall be tightened and use tape to wrap up and secure.
4. The antenna of the main anti-theft unit shall be as near to upper area of the window glass as possible. Adjust the position of the antenna to achieve the best receiving effect. Don't fold, cut short or ground the antenna.
5. Shock sensor is fixed close to car body. Adjust the induction sensitivity to the best effect. (The shock sensor shall be installed as closer to the car body or instrument panel as possible, so as to ensure that the shock sensor can function normally.)

Antenna installation

note: please install the antenna as per the picture on the left.



* Function description of windows raising system

Locking signals when arming the system after turning off ACC ignition, all the windows will automatically raise up one by one. If there are some trouble with the original windows raising system, the circuit will cut off while will keep working with other windows to fulfill a circle. In the process of raising windows, if turns ignition key to ACC position, the window-raising action will stop. Locking or unlocking cannot trigger the system.

Wiring diagram of windows-raising system

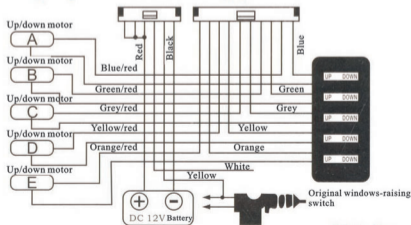

*Wiring diagram

One-hour, two-hour, three-hour periods will come to effect within 24 hours after enactment which starts from the time the car extinguishes. In driving, remote engine start, door opening warning and ignition will automatically call off time engine start. If necessary, it can be reset under extinguishing state. 24-hour time engine start remains valid until be cancelled all the time and start at fixed time everyday. (under successful pre-engage condition).

16. Remote trunk release

Under disarming state, press D button for 2 seconds.

* 17. Window-raising setting

- (1) Under pneumatic and disarming (unlocking) condition.
- (2) Open the door
- (3) Turn electric switch to ON position.
- (4) Step foot-brake six times within 10 seconds, main unit siren sounds twice, after flashing twice, turning light turns off, press D button for 0.5 seconds within the following 3 seconds, turning light extinguishes to indicate successful setting with  showed on screen.
- (5) Repeat the same procedure in step 4) to cancel the function.

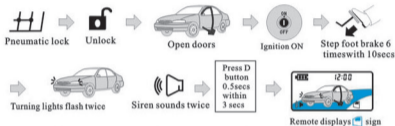

Note: this function can only be used for cars with key triggering window-raising function. (for example, AUDI A6, POLO, PASSAT).

18. Valet mode. (disarming)

- (1) Under disarming (unlocking) condition.
- (2) Open the door
- (3) Turn electric switch to ON position.
- (4) Step foot-brake six times within 10 seconds, main unit siren sounds twice, after flashing twice, turning light remains lit, press A button for 0.5 seconds within the following 3 seconds, turning light extinguishes and main unit siren sounds once to indicate successful setting. At this time, only locking, unlocking, remote trunk release and door opening warning functions are available. Repeat the same procedure above to cancel the function. Main unit sounds twice to release setting.

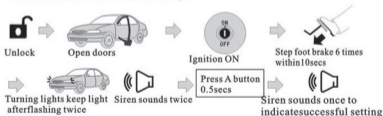

Warning functions

Shocking warning (automatic weather condition identification)

After arming the system for 3secs, main unit begins inspect shocking sensor, the siren will sound for 5 times when feels shocking. The main unit will send warning  to remote

Controller. If feeling another shocking within the following 10secs, then the main unit will send warning, to remote controller. The siren will sound and turning light will flash for 15secs. LED flashes, you can press D button to stop sounding and lighting, but the system remains arming. Screen of the remote displays warning and chirps. Then the remote will chirp every 8secs. You can press any button to stop this.

1. Methods of releasing/setting the shocking function of the main unit

- Under arming state, open the door;
- Step footbrake for 6 times with the following 10secs.
- After setting successfully, the siren sounds once, turning lights flash once, the shocking sign on the remote flashes once, remote sounds once.
- Repeat the above operation to restore this function, the siren sounds twice, turning lights flash twice, the shocking sign on the remote flashes twice, remote sounds twice.

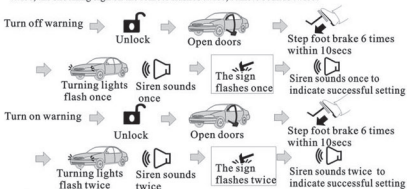

2. door opening warning

Under arming state, when the main unit detects that the door is opened, it will instantly send warning of door opening to the remote, the siren will simultaneously keep chirping, the turning light and LED will flash rapidly for 30secs. (Once every 5secs). Press any button to stop sounding and lighting, but the system will remain arming. The remote displays  and sounds for 4secs. Afterwards, the remote will sound every 8secs. Press any button to stop sounding and flashing.



Note: if the door remains unclosed, sounding and flashing alarm will keep working

3. Illegal ignition warning

Under arming state, when the main unit detects illegal ignition, it will instantly send warning of door opening to the remote, the siren will simultaneously keep chirping, the turning light and LED will flash rapidly for 30secs. (once every 5secs). Press any button to stop sounding and lighting, but the system will remain arming. The remote displays  and sounds for 3secs. Afterwards, the remote will sound every 8secs. Press any button to stop sounding and flashing.



Note: sounding and flashing alarm will keep working if illegal ignition action does not pause.

If the door of the car hasn't been opened after the engine starts, the engine will extinguish automatically when the ignition is not turned to **ON** position within 8 minutes. Then turning lights flash once and siren sounds once. The car will restore to the original state. ⇒ Sign on the remote will disappear. If the car has been successfully pre-engaged and the ignition key is not at **ON** position, you can remotely disable the engine within 8 minutes.



- Note:**
1. For your convenience, steps the foot brake after inserting ignition key and turn to **ON** position for 15secs.
 2. If the system has alarmed and the car's owner didn't release it by remote. The car cannot be started remotely. At this time, remote controller displays sign to remind car owner to check the car's present status.

(5) Programmable time engine start

Set main unit time engine start function by transmitter, there are one-hour, two-hour, three-hour and 24-hour time engine start periods. For manual-shift-gear, one-hour, two-hour, three-hour and 24-hour time engine start periods can only be set when pre-engage succeeds. Methods of time engine start setting by transmitter: press **A+B** for 2 seconds to enter time engine start setting, LCD displays **--:--** and present set number flashes, keep pressing **A+B** for 3 seconds, enactment will change among one-hour, two-hour, three-hour, 24-hour period and cancellation. Press **A** to exit system. Press **D** to send out enactment and exit and restore to original display. Pressing other buttons makes no effects. The main unit will store present enactment as soon as it has received orders and response to transmitter. After receiving response, transmitter displays and the enactment keep flashing for 3 seconds. Then restore to clock display and time engine start has been set. appears all the time.

Time engine start diagram

