



1400W
ELECTRIC
LAWN EDGER

EDG3
INSTRUCTION MANUAL

GMC®

GLOBAL MACHINERY COMPANY

Black	Magenta	Code: EDG3		
Cyan	Yellow	Date: 061010	Edition: 12	Op: PW

用本处所有显示的颜色打印包装资料。Print artwork using ALL inks shown here.

Contents

Warranty	2
Introduction	3
Specifications	3
Safety instructions	4
Additional safety rules for edgers	5
Accessories	6
Unpacking	6
Know your product	7
Setting Up	8
Operating	10
Maintenance	11

Warranty Powertools

Whilst every effort is made to ensure your complete satisfaction with this tool, occasionally, due to the mass manufacturing techniques, a tool may not live up to our required level of performance and you may need the assistance of our service department.

This product is warranted for a 2-year period for home domestic use from the date of the original purchase. If found to be defective in materials or workmanship, the tool or the offending faulty component will be repaired or replaced free of charge with another of the same item. A small freight charge may apply. Proof of purchase is essential. We reserve the right to reject any claim where the purchase cannot be verified.

This warranty does not include damage or defects to the tool caused by or resulting from abuse, accidents, alterations or commercial or business use. It also does not cover any bonus items or included accessories. Only the powertool is covered under this warranty.

With continuing product development, changes may have occurred which render the product received slightly different to that shown in this instruction manual.

Please ensure that you store your receipt in a safe place.

Conditions apply to the above warranty. For full details of the warranty terms and conditions please refer to our website – **www.gmcompany.com**

For prompt service we suggest you log your service request online - www.gmcservice.com.au, should you not have access to the internet, please contact our service department on 1300 880 001 (Australia) or 0800 445 721 (New Zealand).

Introduction

Your new GMC power tool will more than satisfy your expectations. It has been manufactured under stringent GMC Quality Standards to meet superior performance criteria.

You will find your new tool easy and safe to operate, and, with proper care, it will give you many years of dependable service.

CAUTION. Carefully read through this entire Instruction Manual before using your new GMC Power Tool. Take special care to heed the Cautions and Warnings.

Your GMC power tool has many features that will make your job faster and easier. Safety, performance, and dependability have been given top priority in the development of this tool, making it easy to maintain and operate.

Environmental protection



Recycle unwanted materials instead of disposing of them as waste. All tools, hoses and packaging should be sorted, taken to the local recycling centre and disposed of in an environmentally safe way.

Description of symbols

The rating plate on your tool may show symbols. These represent important information about the product or instructions on its use.



Wear hearing protection.
Wear eye protection.
Wear breathing protection.



Double insulated for additional protection.



Conforms to relevant standards for electromagnetic compatibility.



Keep bystanders at a safe distance



Thrown objects



Rotating cutting blade



Direction of edger blade rotation



Warning



Read instruction manual

Specifications

Voltage: 230-240V ~ 50Hz

Input power: 1400 W

No load speed: 3,600 RPM

Depth of cut: 15mm, 25mm, 38mm

Size of blade: 190mm

Bore size: 18mm

General safety rules

WARNING. Read all instructions. Failure to follow all instructions listed below may result in electric shock, fire and/or serious injury. The term “power tool” in all of the warnings listed below refers to your mains operated (corded) power tool or battery operated (cordless) power tool.

Save these instructions

1. Work area

- a. Keep work area clean and well lit.** Cluttered and dark areas invite accidents.
- b. Do not operate power tools in explosive atmospheres,** such as in the presence of flammable liquids, gases or dust. Power tools create sparks which may ignite the dust or fumes.
- c. Keep children and bystanders away while operating a power tool.** Distractions can cause you to lose control.

2. Electrical safety

- a. Power tool plugs must match the outlet. Never modify the plug in any way.** Do not use any adapter plugs with earthed (grounded) power tools. Unmodified plugs and matching outlets will reduce risk of electric shock.
- b. Avoid body contact with earthed or grounded surfaces such as pipes, radiators, ranges and refrigerators.** There is an increased risk of electric shock if your body is earthed or grounded.
- c. Do not expose power tools to rain or wet conditions.** Water entering a power tool will increase the risk of electric shock.
- d. Do not abuse the cord. Never use the cord for carrying, pulling or unplugging the power tool.** Keep cord away from heat, oil, sharp edges or moving parts. Damaged or entangled cords increase the risk of electric shock.

- e. When operating a power tool outdoors, use an extension cord suitable for outdoor use.** Use of a cord suitable for outdoor use reduces the risk of electric shock.

3. Personal safety

- a. Stay alert, watch what you are doing and use common sense when operating a power tool.** Do not use a power tool while you are tired or under the influence of drugs, alcohol or medication. A moment of inattention while operating power tools may result in serious personal injury.
- b. Use safety equipment. Always wear eye protection.** Safety equipment such as dust mask, non-skid safety shoes, hard hat, or hearing protection used for appropriate conditions will reduce personal injuries.
- c. Avoid accidental starting.** Ensure the switch is in the off position before plugging in. Carrying power tools with your finger on the switch or plugging in power tools that have the switch on invites accidents.
- d. Remove any adjusting key or wrench before turning the power tool on.** A wrench or a key left attached to a rotating part of the power tool may result in personal injury.
- e. Do not overreach.** Keep proper footing and balance at all times. This enables better control of the power tool in unexpected situations.
- f. Dress properly. Do not wear loose clothing or jewellery.** Keep your hair, clothing and gloves away from moving parts. Loose clothes, jewellery or long hair can be caught in moving parts.
- g. If devices are provided for the connection of dust extraction and collection facilities, ensure these are connected and properly used.** Use of these devices can reduce dust related hazards.

4. Power tool use and care

- a. **Do not force the power tool.** Use the correct power tool for your application. The correct power tool will do the job better and safer at the rate for which it was designed.
- b. **Do not use the power tool if the switch does not turn it on and off.** Any power tool that cannot be controlled with the switch is dangerous and must be repaired.
- c. **Disconnect the plug from the power source before making any adjustments, changing accessories, or storing power tools.** Such preventive safety measures reduce the risk of starting the power tool accidentally.
- d. **Store idle power tools out of the reach of children and do not allow persons unfamiliar with the power tool or these instructions to operate the power tool.** Power tools are dangerous in the hands of untrained users.
- e. **Maintain power tools. Check for misalignment or binding of moving parts, breakage of parts and any other condition that may affect the power tools operation.** If damaged, have the power tool repaired before use. Many accidents are caused by poorly maintained power tools.
- f. **Keep cutting tools sharp and clean.** Properly maintained cutting tools with sharp cutting edges are less likely to bind and are easier to control.
- g. **Use the power tool, accessories and tool bits etc., in accordance with these instructions and in the manner intended for the particular type of power tool, taking into account the working conditions and the work to be performed.** Use of the power tool for operations different from those intended could result in a hazardous situation.

5. Service

- a. **Have your power tool serviced by a qualified repair person using only identical replacement parts.** This will ensure that the safety of the power tool is maintained.

Additional safety rules for edgers.

- Remove loose bracelets or similar jewellery from your wrist whenever operating edgers or similar equipment.
- Before switching on always ensure that the blade and guard function correctly and that they are free of any damage. A cracked blade or guard must be replaced before operating the tool.
- Do not use edger in the rain, or trim edges when they are wet.
- The edger is a major appliance and should not be operated with other major appliances on the same household circuit.
- Keep extension cord clear of operator, unit and any obstacles at all times. Do not expose the cord to heat, oil, water, or sharp edges.
- Switch off and remove the plug from the 'socket-outlet' if the flexible cord becomes entangled or before adjusting or cleaning the edger.
- When making any adjustments to the tool always wait for the blade to come to a complete stop and unplug the tool.
- Never attempt to unclog the blade chamber by tapping the tool on the ground, this can damage the unit.
- Keep hands clear of edge guide and blade when cleaning as these wear to a very sharp point during edging.
- Before landscaping or trenching, inspect and ensure there are no exposed or buried cables or pipes or other objects that may create a hazard or interfere with operating the edger.
- Set depth to only that required for the job, do not overload. If tool slows, pull back slightly and wait until blade returns to normal speed.
- Never hang the edger by the power cord.
- Only use extension cords intended for outdoor use.

- Check damaged parts before further use of the appliance, a guard or other part that is damaged should be carefully checked to determine that it will operate properly and perform its intended function. Check for alignment of moving parts, binding of moving parts, mounting, and any other conditions that may affect its operation.
- Ensure guards are kept in place.
- Always keep blade area clean.
- When using the edger, stones, pieces of metal and other objects can be thrown out at high speed by the blade. The tool and guard are designed to reduce the danger. However, the following special precautions should be taken:
 - Wear safety glasses or other eye protection, gloves, long pants and suitable footwear.
 - Make sure that other people and pets are at least 5 metres away.
 - Always stand to left side of main handle.
 - Before landscaping or Trenching, check for buried electrical cables.
 - To reduce the risk of injury, work going away from nearby solid objects such as walls, steps, stones, trees etc. Use great care when working close to solid objects, and where necessary, do edging or trimming by hand.
- Use only blades as recommended.
- Do not attempt to free a jammed blade before first switching off the machine.
- Let the blade come to rest naturally.
- Periodically check that all fixings are properly tightened.

Unpacking

Due to modern mass production techniques, it is unlikely that your GMC Power Tool is faulty or that a part is missing. If you find anything wrong, do not operate the tool until the parts have been replaced or the fault has been rectified. Failure to do so could result in serious personal injury.



Know your product

You have purchased a powerful 1400-watt Landscape Edger, which is ideal for traditional hard surface edging along driveways, sidewalks as well as landscaping tasks around the lawn. By raising the edge guide, the edger can be used in the garden for such tasks as shaping borders, around trees and flowerbeds.

1. Handle
2. Power switch
3. Safety levers
4. Upper shaft
5. Shaft locking collar
6. Edge guide lever
7. Wheel
8. Lower shaft
9. Motor housing
10. Height adjustment knob
11. Guide wheel
12. Guard cleaner lever
13. Guard cleaner lock knob

Setting Up

Assembling the Shaft

The shaft must be assembled on removal from the carton. Remove the bag containing the two small screws from the shaft.

Note: Before assembling the upper and lower shafts, you will need to remove and discard the protector packaging.

1. Insert the upper shaft (5) into the lower shaft (8), taking care not to tangle the cable inside the shaft.



2. Slide the lower section of the shaft locking collar (5) onto the lower shaft and turn it anti-clockwise to lock it on to the lower shaft.
3. Align the holes in the collar with the holes in the shaft then fit the two small screws, to lock in the collar.



Shaft Adjustment

The shaft can be adjusted to suit the operator.

Loosen the locking collar (5) and slide the upper (4) and lower (8) shafts apart until the desired length is achieved. Re-tighten the collar.



Cord routing

Always make sure that you route the cord away from the work area to prevent it from coming near the blade of the edger. Lay your cable route before starting work.

Start your edger at the point nearest to the electrical socket, and then move away whilst working. This will mean that the cord will be pulled through the area that has already been cut, thereby keeping it out of danger of being cut through by the blade.

Cord Restraint

Your GMC EDG3 is fitted with a Cord restraint to prevent the power cable from both being disconnected and also to prevent excessive strain on the connecting plugs during use.

It is recommended the cord restraint is used as follows:

Approx 300mm from the end of the extension Cable, form a tight loop in the extension cable, and feed the loop through the square hole in the extension cable, and feed the loop through the square hole beneath the handle. Place the loop over the inner hook in the handle to prevent the cable pulling back through the square hole.

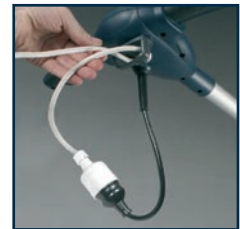

Switching on

Your GMC EDG3 is fitted with two safety levers to prevent accidental operation of the tool.

To turn on the edger pull in one or both Safety levers (3) and press the power switch (2) fully down.



Hold one or both of the levers in to maintain power to the unit. To stop the edger, release levers.

Take care when you turn the edger "On" that the cutter is in a safe position to operate.

Edge Guide

The edge guide is used when edging is required against a solid material like a paved surface. It is important to ensure the edge guide is used in these conditions as the edge guide will assist in preventing the blade from making direct contact with the paved surface.

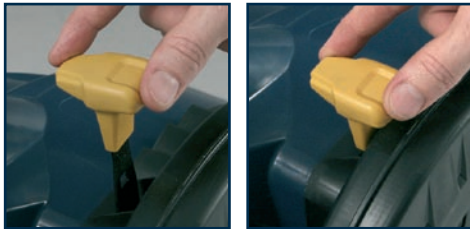

- To set the edge guide in the Down position, grasp the Edge Guide Lever (6) and move the knob sideways toward the centre of the edger and then push downwards.

Note: The Edge Guide Lever should be returned to the upright position to lock the Guide in the down position.

- To set the edge guide in the Up position, grasp the Edge Guide Lever and move the knob sideways toward the centre of the edger and then pull upwards to lift the guide.

Note. The Edge Guide Lever should be returned to the upright position to lock the Guide in the raised position.

Cutting Depth

The Cutting Depth of the edger can be altered to one of 3 settings to a Max of approx 38mm.

1. To adjust the cutting depth, loosen the Height adjustment knob (10) approx 5–6 full turns, but do not remove. Push the knob fully towards the body of the edger and at the same time move the guide wheel arm across to the opposite side of the housing.



2. Raise or lower the arm to the desired position, and then pull the height adjusting knob outwards. Tighten the knob until all of the slack is taken out of the assembly. Check to ensure the guide wheel arm has located into one of the pre allocated positions and the head of the bolt securing the front wheel arm is sitting flat on the surface of the wheel arm. Firmly tighten the height adjustment knob.



Operating

Edging

1. Set the cut depth at 25mm and set edge guide to the down position.

2. The guard incorporates a raised rib section which acts as a blade cut indicator. This rib will assist in guiding the operator where the blade will cut. During operation the operator can sight down the rib of the guard to where the edge is to be cut.



3. Before starting the edger, line up the tool so the edge guide rests against the edge of the paved surface, both rear wheels should be on the paved surface when edging.

HINT: When there is heavy overgrowth of grass over the paved surface it may drag on the guard. An initial cut may be required with the edger on the grass side. This will require lifting up the edger guide and may require reducing the depth of cut.

4. To avoid kickback of the edger, tilt the handle down so the blade is above the ground.



5. Turn the edger on and allow the blade to spin without moving the tool.

6. Slowly raise the handle to lower the blade, finding the edge of the paved surface and start edging. Then move forward slowly along the edge of the paved surface, keeping the edge guide pressed lightly against the pavement edge.

For the first edging each season, it is best to move forward slowly because grass is thickest then. Subsequent edging will be completed more rapidly. If the tool slows down, back it up slightly until the blade returns to normal speed.

During edging some sparks may be generated from hitting stones: this is normal. Do not attempt to edge when the grass or soil is wet or moist; both for electrical safety and to prevent clogging of the blade chamber.

Landscaping / Trenching

Before landscaping or trenching, inspect and ensure there are no exposed or buried cables or pipes or other objects that may create a hazard or interfere with operating the edger. Lift the edge guide lever (6) for all trenching. Set the depth to only that required for the job, do not overload, if tool slows, pull back slightly and wait until the blade returns to normal speed.

Cleaning the guard chamber

WARNING: Ensure the tool is switched off and is disconnected from mains power before cleaning the guard chamber.

After each use the blade chamber should be cleared of dirt and grass build-up, to maintain cutting efficiency.

1. Pull the Guard Cleaner Lock Knob (13) out and rotate it a quarter of a turn to lock it in the out position.
2. Use the Guard Cleaner Lever (12) to pivot the guard cleaner back and forth until the guard chamber is clean.



3. When finished retract the guard and release the locking knob so that the pin locates into the hole in the guard cleaner, as shown.

NOTE: Edging of heavily overgrown edges and damp soils can create greater build-up of difficult to remove waste. It may be necessary to remove the bulk of this material using a long thin implement (ie. screwdriver) before operating the guard cleaner.

Maintenance

Changing the Blade

WARNING: Before performing any maintenance or tool adjustments ensure the power supply cable has been totally disconnected from the mains power.

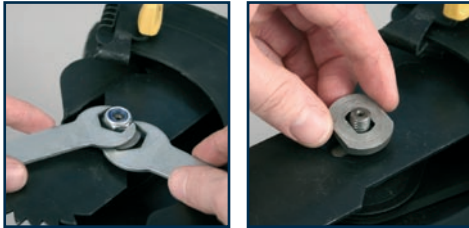

1. Lay the edger on its side with the blade facing up.
2. Place a 26mm spanner over the outer blade flange and use a 17mm spanner to remove the lock nut in an anti-clockwise direction.
Remove the lock nut, outer flange and the blade and ensure the shaft and inner flange are clean of any dirt, etc.
3. Fit the new blade and outer flange and ensure all is located correctly, as shown. Fit the lock nut and tighten firmly using both spanners.



4. After the blade is secure, rotate the blade by hand to ensure the blade is not making contact with any components of the edger.

Blade wear is expected whenever you use your edger. Blades wear quite quickly when edging along concrete paths. This does not effect the efficiency of the edger and is expected due to the aggressive abrasion of concrete on steel.

Edger Blades are not a warranty item! Edger Blades are available from your local Hardware store or can be purchased direct from GMC. See details on the back page of this manual.

Before performing any maintenance or tool adjustments ensure the power supply cable has been totally disconnected from the mains power.

Cleaning

CAUTION. Use only mild soap and a damp cloth to clean the tool.

Never allow any liquid to get inside the tool, never immerse any part of the tool into a liquid.

Preventing Corrosion

Fertilizers and other garden chemicals contain agents that greatly accelerate the corrosion of metals. If you use the tool in areas where fertilizers or chemicals have been used, the tool should be cleaned immediately afterwards. Wipe all exposed parts with a damp cloth. You may lubricate only metal parts with a light petroleum based oil. When cleaning, never immerse in water or squirt it with a hose.

General inspection

Regularly check that all the fixing screws are tight. They may vibrate loose over time.

Repairs

Only an authorised service centre should replace the cordset or effect other repairs. If the cordset is damaged or worn, have it repaired or replaced by an authorised service centre.

GMC customer assist

Attach Your
Receipt Here

If your product needs repairing, replacing, technical service or you simply need help or advice, please contact us on our Customer Assist Line 1300 880 001 (Australia) or 0800 445 721 (New Zealand).

For prompt service we suggest you log your service request online at www.gmcservice.com.au. Should you not have access to the Internet, please contact our service department on 1300 880 001 (Australia) or 0800 445 721 (New Zealand). 7am – 7pm, 7days a week (AEST).

Please note that if repair or replacement is required, you must provide a valid original purchase receipt.

You will need the following details at hand to log your service request;

Personal details: First & Last name, address, pick up address, contact phone numbers, email address

Product details: Product number, date of purchase, retailer bought from, State & postcode, receipt number, reason for the request, copy of official purchase receipt

Attach your purchase receipt and save with this Manual for future reference.

Please refer to our website www.gmcompany.com for full GMC warranty Terms and Conditions.

GMC[®]
GLOBAL MACHINERY COMPANY