

REMO (WATERPROOF VOICE ACTIVATED REMOTE)

CONTROL YOUR HERO5 CAMERA WITH YOUR
VOICE FROM UP TO 33FT (10M) AWAY

USER GUIDE



THE BASICS

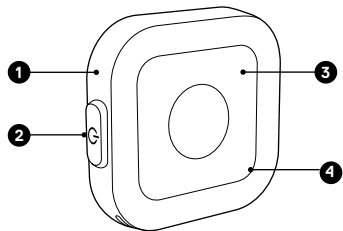

1. Battery Status Light
2. Power Button
3. Shutter Button
4. Wireless Status Light (blue) / Remo Status Light (red)

UPDATING REMO + CAMERA

To use all of the features described in this guide, update the software on both Remo **and** your GoPro.

STEP 1

Download GoPro for Desktop from gopro.com/getstarted.

STEP 2

With Remo powered off, connect it to your computer.

STEP 3

Press and hold the Shutter button for 8 seconds until the battery status light turns off.

STEP 4

Open GoPro for Desktop and follow the on-screen instructions to update Remo.

STEP 5

Update your camera software. For details, see the user manual for your camera.

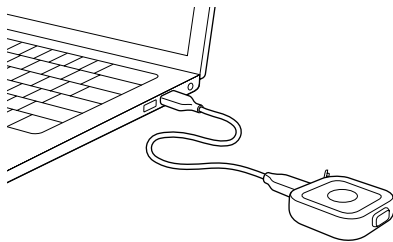

CHARGING

Battery status light turns red when Remo needs charging.

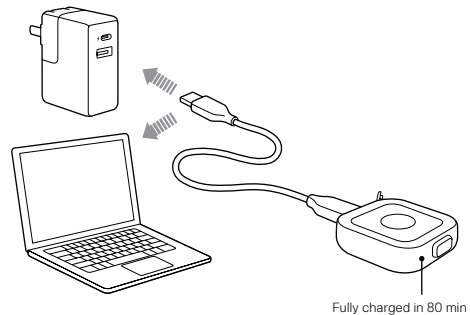

POWERING ON + OFF

POWERING ON

Press and hold the Power button.

Note: Beeps and lights mimic those on the camera.

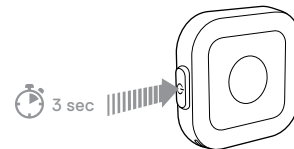

POWERING OFF

Press and hold the Power button.

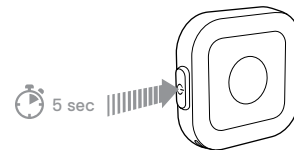

SETTING UP HERO5 BLACK + REMO

PAIRING

Step 1

On the camera, swipe down and then tap Connectivity > Connect New > Remo.

Step 2

With Remo powered off, press and hold the Power button until the blue light blinks. Remo vibrates once when pairing is complete.

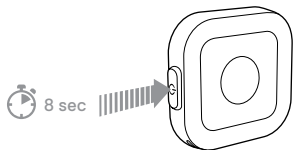

SELECTING A LANGUAGE

Step 1

Swipe down and then tap Preferences > Language (in the Voice Control section).

Step 2

Tap a language.

SETTING UP HERO5 SESSION + REMO

PAIRING + SELECTING A LANGUAGE

Step 1

Press the Mode button to get to Connection Settings, then select Connect New Device > Remo.

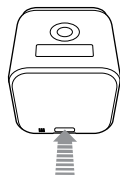

Step 2

With Remo powered off, press and hold the Power button until the blue light blinks. Remo vibrates once when pairing is complete.

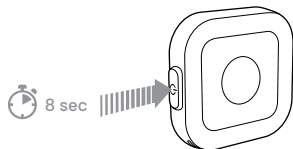

Step 3

If the language option appears on the camera, select the language that you want to use. Otherwise, Remo uses the language that you previously selected when using Voice Control on your camera.

Note: To change the Voice Control language, connect your camera to the Capture app. For details, see the HERO5 Session User Manual.

CONNECTING REMO + YOUR CAMERA

STEP 1

Turn on wireless on your camera. For details, see the user manual for your camera.

STEP 2

Power on both devices to connect them. The wireless status light on Remo blinks slowly (blue).

Note: You do not need to turn on your camera's Voice Control feature to use Remo.

If the connection to the camera is lost, Remo emits a disconnection beep and the wireless status light blinks quickly. For best results, be sure that your camera and Remo are not blocked by walls or other obstacles.

CONTROLLING YOUR CAMERA

To control your camera with your voice, use the commands listed on the next page. Remo has a range of 33ft / 10m and is waterproof to 16ft / 5m.

Note: Voice Control performance may be impacted by distance or significant wind and noisy conditions. Keep the product clean and clear of debris.

STEP 1

Power on Remo.

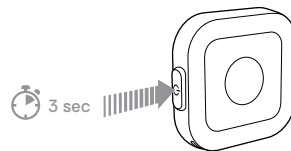

STEP 2

While facing Remo, say a command from the list on the next page. Remo vibrates, beeps, and blinks when the command is understood.

[show clip mounted to collar and person speaking in to Remo, or show Remo on wrist strap and user bringing wrist to mouth to speak]

PRO TIP: With Remo, you can say any command at any time. For example, if the camera is in Video mode and you want to capture burst photos, just say "GoPro shoot burst."

GREEN SHADING = DO NOT TRANSLATE!

LIST OF COMMANDS

For the most updated list of commands, visit gopro.com/help.

ACTION COMMANDS	DESCRIPTION	MODE COMMANDS	DESCRIPTION
GoPro start recording	Captures video	GoPro Video mode	Changes the camera mode to Video (does <i>not</i> capture video)
GoPro HiLight	Adds a HiLight Tag to video	GoPro Time Lapse mode	Changes the camera mode to Time Lapse (does <i>not</i> capture time lapse photos)
That was sick	Adds a HiLight Tag to video	GoPro Photo mode	Changes the camera mode to Photo mode (does <i>not</i> capture photos)
GoPro stop recording	Stops capturing video	GoPro Burst mode	Changes the camera mode to Burst mode (does <i>not</i> capture burst photos)
GoPro take a photo	Captures a single photo		
GoPro shoot burst	Captures burst photos		
GoPro start time lapse	Captures Time Lapse photos		
GoPro stop time lapse	Stops capturing time lapse photos		
GoPro turn off	Powers off the camera		

PRO TIP: When Remo and the camera are on, you can press the Shutter button on Remo to begin capturing in the camera's current mode.

QUIKCAPTURE

When your camera is off, you can quickly capture video and time lapse photos using the Shutter button on Remo.

STEP 1

On your camera, press the Mode button to power it on.

STEP 2

Say, "GoPro turn off" to power off your camera.

STEP 3

During your activity, use Remo for QuikCapture:

- For video, press the Shutter button on Remo.
- For time lapse photos, press and hold the Shutter button.

PRO TIP: Once you power on your camera with the Mode button, then power it off with the Remo command, just say "GoPro turn on" to power it on again.

RESETTING REMO

If Remo isn't responding as expected, press and hold both buttons at the same time to reset it.

Note: If you reset Remo, you need to re-pair it with your camera.

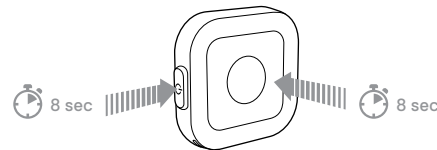

REGULATORY INFORMATION

To see additional information regarding country certifications, refer to the Important Product + Safety Instructions included with Remo.



Learn more about GoPro
products at **gopro.com**