

TECHNIQUES

Heading directly to the wind when climbing and landing. Use "PUSH" and "RELEASE" method to the control lever when turning left and right. Plane will be lost control if the left / right lever is pushed for a long time continuously. If it is windy when climbing, it is suggested to turn the plane slightly but still heading into the wind. The turning radius should not be less than 30m / 150 feet. When landing, the plane should be headed directly to the wind.

Special Attention:
Never try to catch the plane whenever the plane is in motion to avoid personal injury.

MAINTENANCE AFTER FLYING

- Unplug the rechargeable battery from the battery compartment of the plane after landing.
- Switch off the power of the transmitter.
- Check if the propeller is damaged or not. If yes, replace it with a new one. (2 extra propellers are provided)
- Check the fuselage, wings, vertical fin and horizontal stabilizer if there is any damages.
- Use a soft and clean cloth to clean your plane after each fly.
- If the wings, horizontal stabilizer and / or vertical fin is damaged slightly, use a transparent tape to repair. (Fig.25)

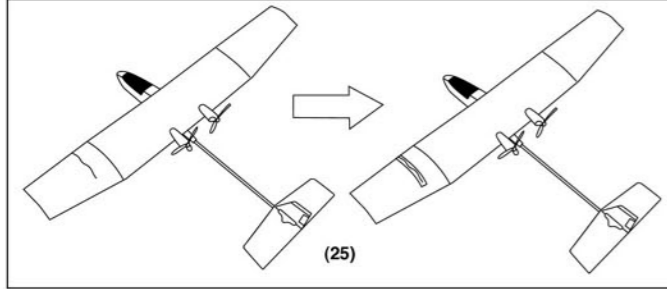

FCC NOTE:
THE MANUFACTURER IS NOT RESPONSIBLE FOR ANY RADIO OR TV INTERFERENCE CAUSED BY UNAUTHORIZED MODIFICATIONS TO THIS EQUIPMENT. SUCH MODIFICATIONS COULD VOID THE USER'S AUTHORITY TO OPERATE THE EQUIPMENT.



IMPORTANT NOTES

- Check the contents list and all parts.
- Study the instruction manual carefully before assembling.
- Ensure all required batteries are ready.
- Follow the instructions printed in manual when using the quick charger
- This product is intended for 8 years and up. (Adult supervision is required if user is below 8 years old)
- Do not fly over or near people, power pylon, buildings, highways, train rails, vehicles, trees, lake, and airport.
- Do not fly if wind speed is over 3 M/S(or over 5 mph)

CONTENT LIST

(A). Check the contents list and parts (Fig.1):

- | | |
|--|------------------------------|
| ① 1 Main wing | ⑨ 1 Landing gear |
| ② 1 Vertical fin | ⑩ 1 Antenna |
| ③ 1 Horizontal stabilizer | ⑪ 1 Wind ribbon |
| ④ 1 Fuselage | ⑫ 1 plastic screw driver |
| ⑤ 4 Propellers | ⑬ 1 Easy-Carry quick charger |
| ⑥ 1 4.8V 2/3 "AAA" rechargeable battery pack | ⑭ 8 Rubber bands |
| ⑦ 4 Screws | ⑮ 1 Transmitter |
| ⑧ 1 Cross-headed screw driver | |

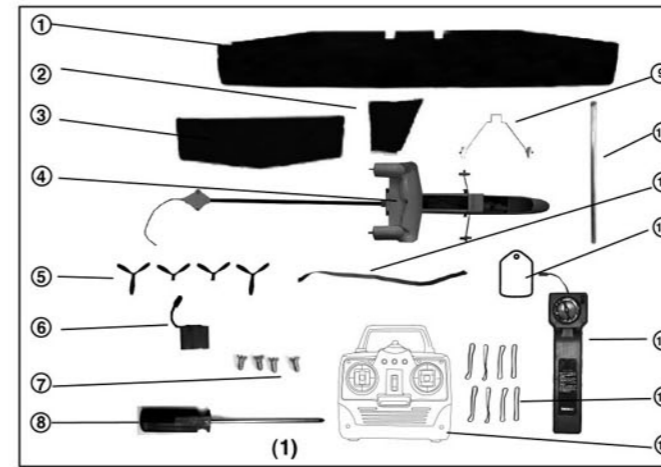

BATTERIES REQUIREMENT

- 6 x "AA" alkaline batteries (not included) for transmitter.(Fig.2)
- 8 x "C" alkaline batteries (not included) for Easy-Carry quick charger.(Fig.3)
- 4.8V 2/3 "AAA" Ni-Mh rechargeable battery pack (included).(Fig.4)

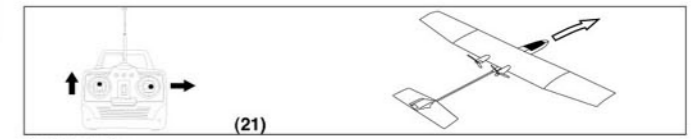
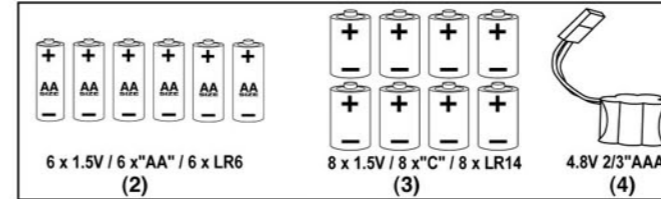

4. Right steering
Switch the right stick on the controller to the right and then let it back to the center. Repeat this action until the airplane fully turns. (Remarks:The left stick should be pulled to the top) (Fig.21)

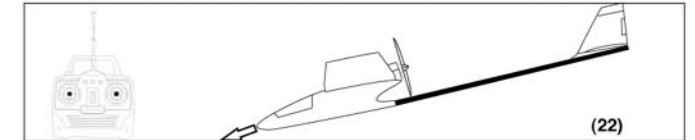

5. Descending
Keep the left and the right sticks on the controller at the center and let propellers stop rotating. The airplane will descend. (Fig.22)

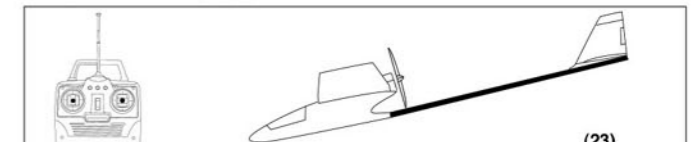

6. Landing
Before landing, let the airplane cruises by stop pulling the left stick on the controller and propellers stop rotating. Adjust the left and right turning lever for the desired landing spot. The airplane must fly directly head to the wind when landing. Normal flying time (including cruise): approximately 8 minutes. (Fig.23)

Flying Distance
Pay attention to the flying distance. The control range should not exceed 100 m / 333 feet. If you fly over this limit, airplane will automatically cut the power source and descend.

ALIGNMENT

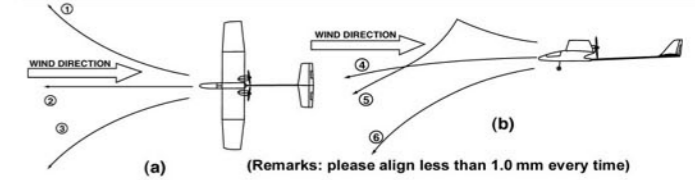

(Remarks: please align less than 1.0 mm every time)

No.	Flying Position	Alignment (Fig.24)
1	Right turn	Turn the vertical fin to the left (A)
2	Normal	
3	Left turn	Turn the vertical fin to the right (B)
4	Normal	
5	Upward	Turn down the horizontal stabilizer (D)
6	Downward	Turn up the horizontal stabilizer (C)

ASSEMBLY INSTRUCTIONS

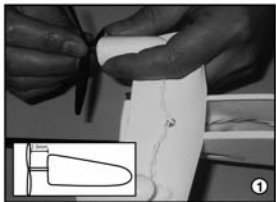

1. Fix the propeller to left motor (Remarks: distance between propeller and motor is around 2 mm)

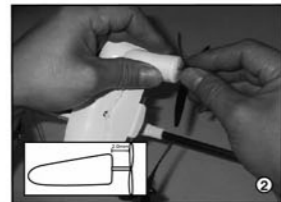

2. Fix the propeller to right motor (Remarks: distance between propeller and motor is around 2 mm)

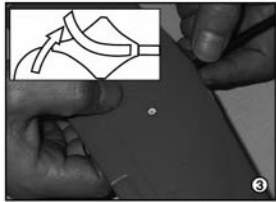

3. Fix the horizontal stabilizer onto the tail of airplane (Remove stickers from the tail before assembling)

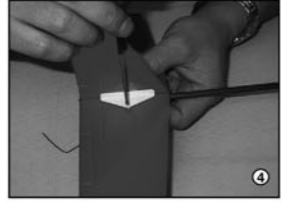

4. Fix the vertical fin onto the horizontal stabilizer by two provided screws as shown.

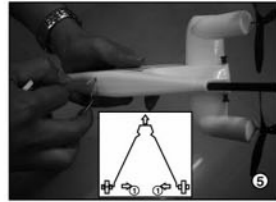

5. Pressing the landing gear and put it into the slot of the fuselage.

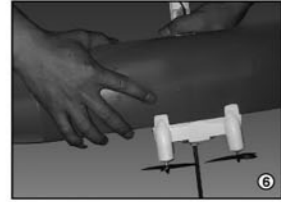

6. Put the main wing on the fuselage as shown.

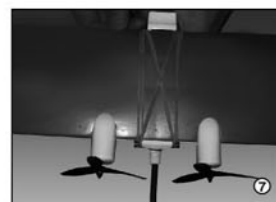

7. Use four rubber bands to fix the main wing as shown.

3

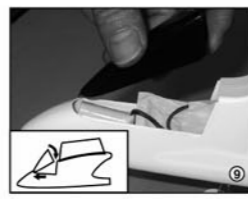

9. Put on the hatch cover as shown.

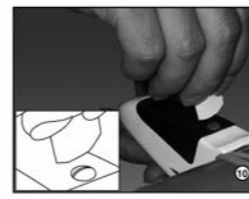

10. Fix the hatch cover by the provided plastic screw driver.

TEST THE WIND SPEED

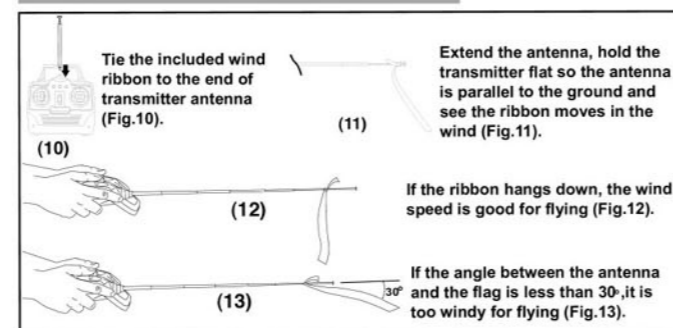

RANGE TEST

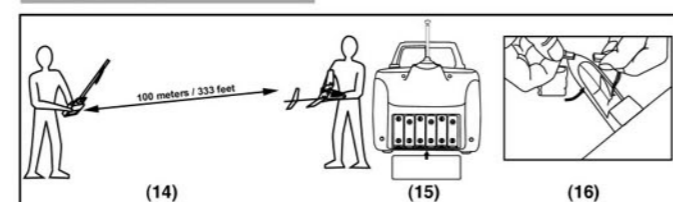

You need two people to do the range test - one to hold the transmitter and one to hold the airplane.(Fig.14) Distance between two people should be around 100 meters / 333 feet to test all functions of the airplane. Install 6 x "AA" alkaline batteries into the transmitter, extend the antenna and turn on the transmitter.(Fig.15) Plug in the 2/3 "AAA" rechargeable battery and close the hatch cover.(Fig.16)

4

CAUTIONS!

The person who holds the airplane should NOT touch the propeller with any part of his body to avoid injury. (Fig.17)

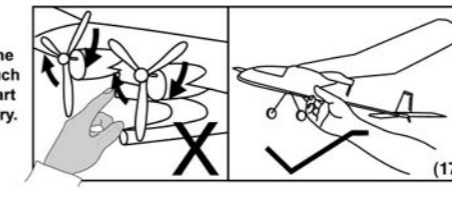

SELECT A FIELD

A large open grass field with soft ground is the best. Make sure NO interference from other instruments in your vicinity with the same frequency.

LET'S GO FLYING

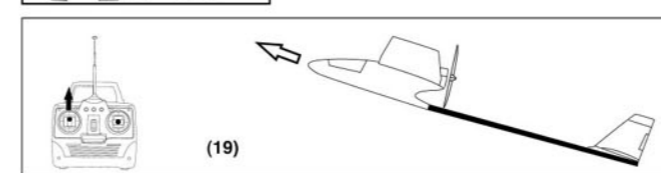
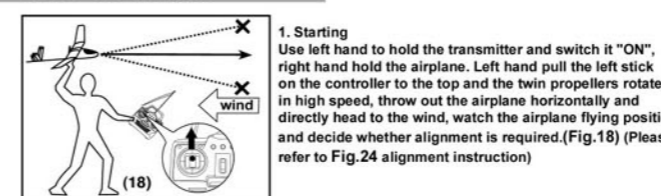

2. Climbing
Apply full power by pulling the left stick on the controller to the top and the airplane keeps on climbing. Do not try to turn around until the plane reaches a height of 20 meters / 60 feet from the ground. (Fig.19)

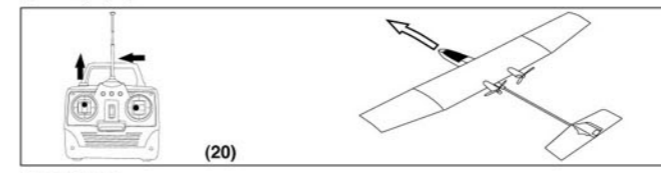

3. Left steering
Switch the right stick on the controller to the left and then let it back to the center. Repeat this action until the airplane fully turns. (Remarks: The left stick should be pulled to the top) (Fig.20)

5

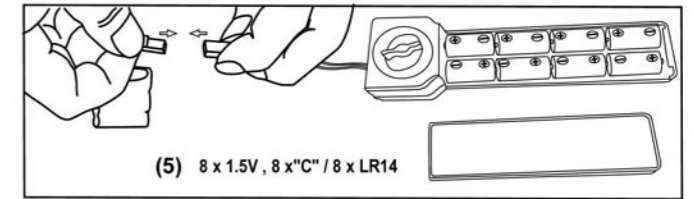

1) Plug the 4.8V 2/3 "AAA" rechargeable battery to the connecting plug of the portable charger. Turn the timer towards 12 minutes. The charging light will be on and the timer will count backwards. Take off the rechargeable battery when the charging light is "OFF". Important: The charging period cannot be longer than 12 minutes for the first 5 charging or else the battery life of the rechargeable battery will be shortened.

3) The charging period after the first 5 times will be 20 minutes.

4) When you notice that the flying time is shortened, you have to change the 8 "C"size alkaline batteries of your portable charger.

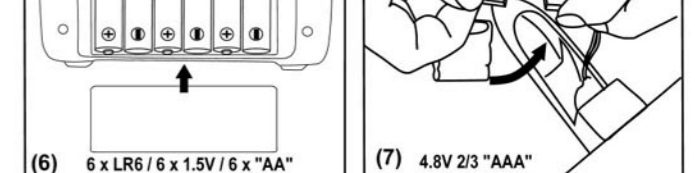

(6) 6 x LR6 / 6 x 1.5V / 6 x "AA" (7) 4.8V 2/3 "AAA"

LABELING INSTRUCTION

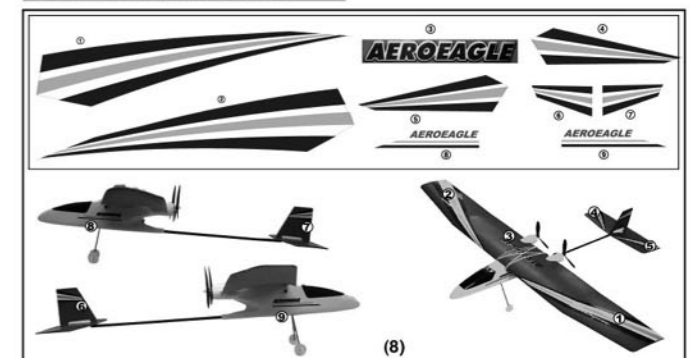

2