

Operation Guide

2.4GHz Wireless
Remote Control Camera Kit
Model: 860Q

The graphics included are subject to minor change without notice.

NOTE:

THE MANUFACTURER IS NOT RESPONSIBLE FOR ANY RADIO OR TV INTERFERENCE CAUSED BY UNAUTHORIZED MODIFICATIONS TO THIS EQUIPMENT. SUCH MODIFICATIONS COULD VOID THE USER'S AUTHORITY TO OPERATE THE EQUIPMENT.

PACKING LIST

- ① 2.4GHz wireless camera×1
- ② 2.4GHz wireless receiver×1
- ③ Adapter for camera×1
- ④ Adapter for receiver×1
- ⑤ AV cable×1
- ⑥ Earphone×1

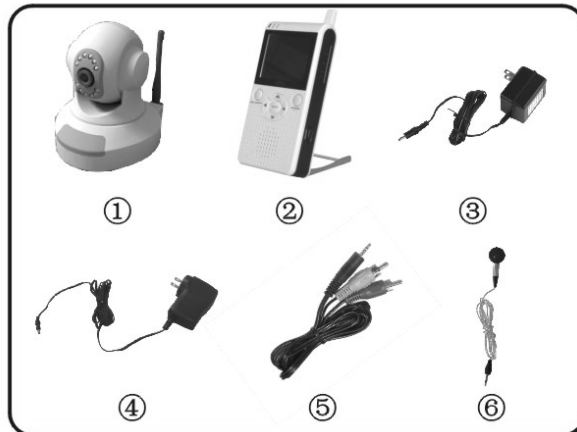

DIAGRAM

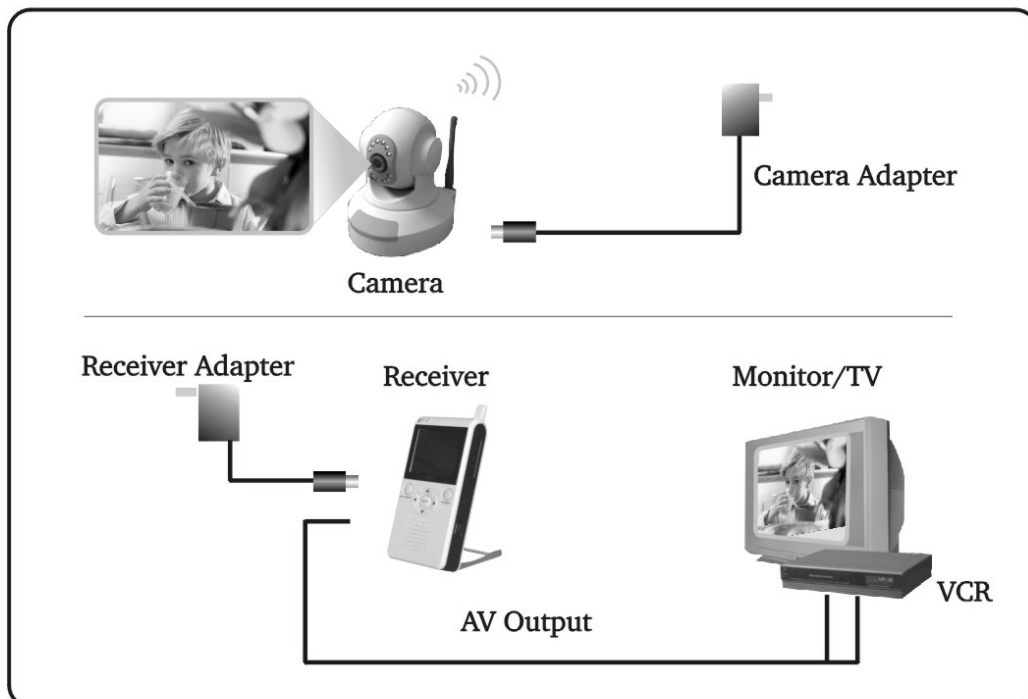

STRUCTURE

CAMERA

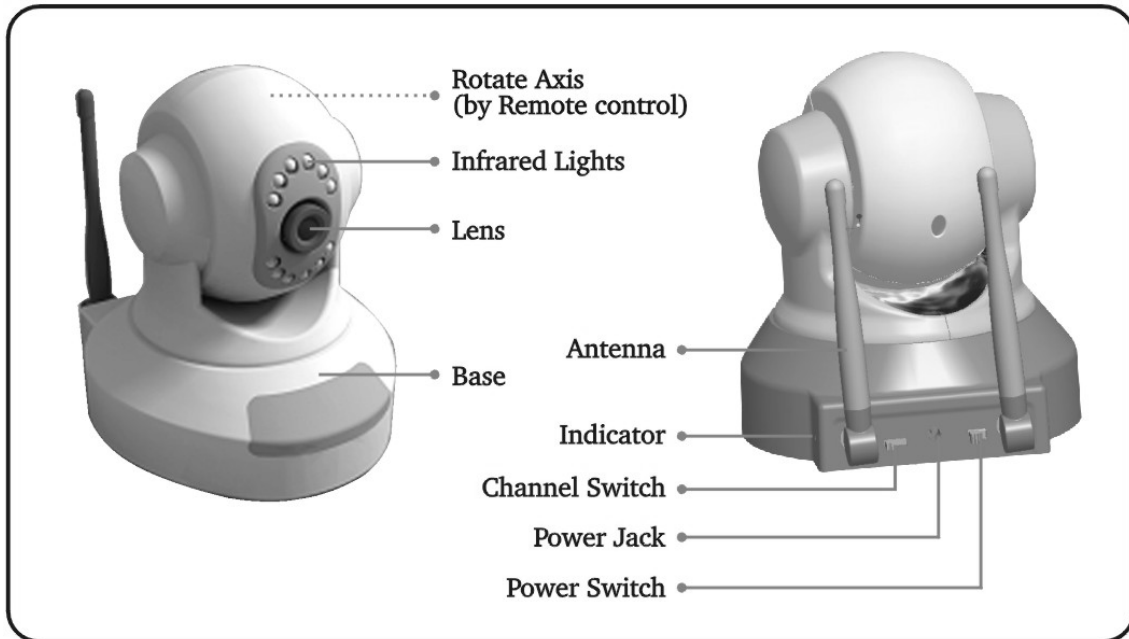

RECEIVER

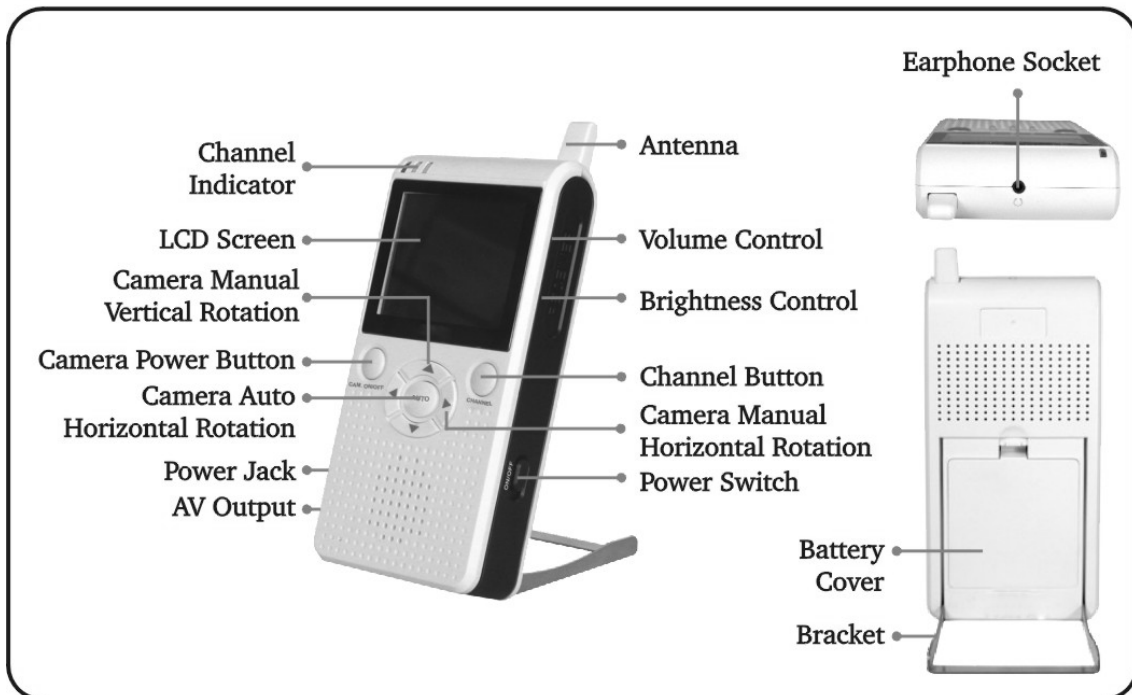

INSTALLATION

1. Locate the camera to a specific position.

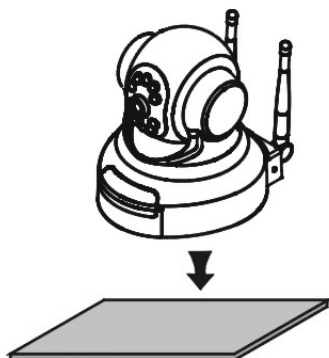

2. Connect the camera to the adapter (DC 9V 1.5A) and then slide the power switch to **ON** position. The power indicator lights up.

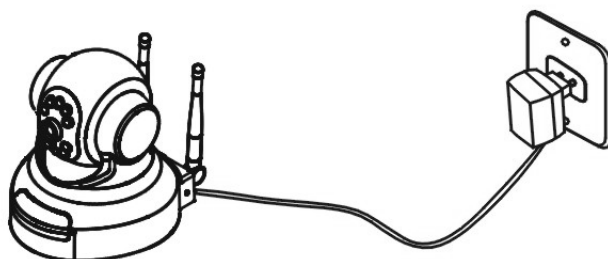

3. Connect the receiver to the adapter (DC 9V 1.5A) and slide the power switch to **ON** position.

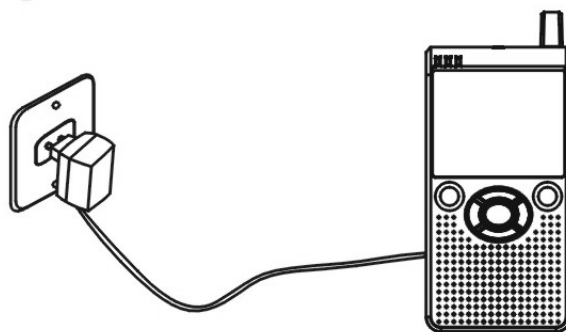

Notes:

- This receiver can also work on dry battery. Please load 4 AAA batteries to the battery compartment with their polarities matched.

- The AC adapter will work instead of batteries after it is plugged. If the receiver is left unused for a long time, please unplug the adapter and remove the batteries.

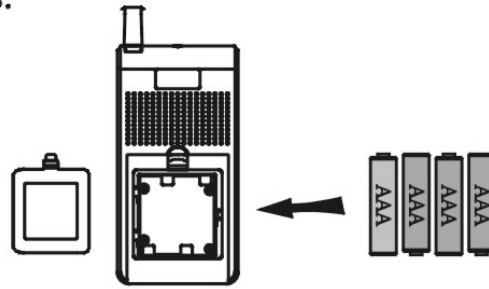

4. Set the channel of receiver same as that of camera by pressing the channel button continuously, and the pictures are displayed on the LCD screen.



Note: For more clear pictures, please connect the receiver to a monitor/TV with AV cable.

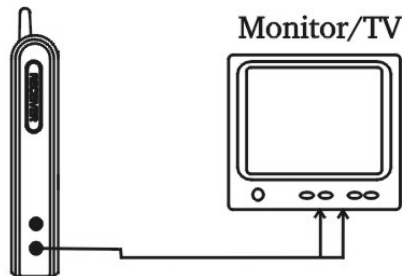

5. Adjust the brightness and volume of the receiver to a satisfied level.

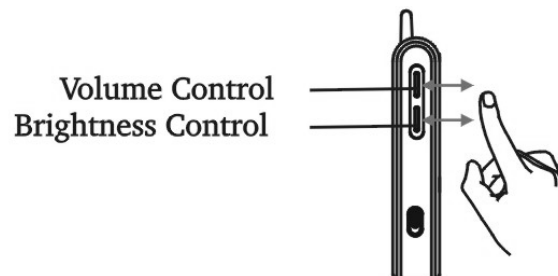

RECEIVER REMOTE CONTROL FUNCTION

The receiver can remote control the power and direction of the camera. The operation is as below.

Remote control the camera's power

Press the **CAM. ON/OFF** button on the receiver to power on the camera; press the button again to power off.



Note:

- If the channel indicator **CH1** on the receiver lights up, the camera at channel 1 can be remote controlled.

Remote control the camera's direction

1. Press the **AUTO** button on the receiver to activate the camera's auto horizontal rotation function. Press again to disable the function.
2. Press the ◀ / ▶ button on the receiver to rotate the camera at horizontal direction manually. The max. angle is 180 degree.
3. Press the ▲ / ▼ button on the receiver to rotate the camera at vertical direction manually. The max. angle is 60 degree.

CHANNEL LOOPING SETUP

The receiver supports up to 3 cameras working at the same time. You could press and hold the **CHANNEL** button on the receiver for 2 seconds to enable the automatic looping function. The channels are shown on the monitor/TV one by one every 5 seconds.

Press the **CHANNEL** button on the receiver again to exit the looping function.

You can press the **CHANNEL** button to manually select the channel.



CAUTIONS

- The apparatus shall not be exposed to dripping or splashing and that no objects filled with liquids, such as vases, shall be placed on the apparatus.
- Turn off the Camera/Receiver if the system is not in use.
- The adapter is used as the disconnect device from the mains. The adapter shall remain readily operable.
- The Camera/Receiver can only be completely disconnected from the mains by unplug the adapter.
- Do not cut the DC power cable of the apparatus to fit with another power source.
- Attention should be drawn to the environment aspects of battery disposal.