

Mini Cloud P/T Camera

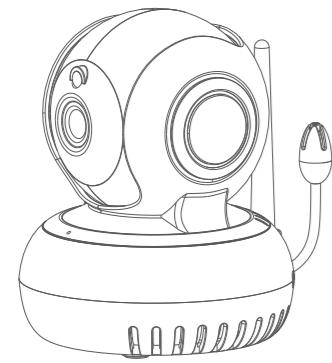

Product Quick Guide Model: U5886Y

Version No.: 1.3

Before using the product, please read the guide carefully to avoid any damages to the product in virtue of faulty operation or misuse.

I Appearance

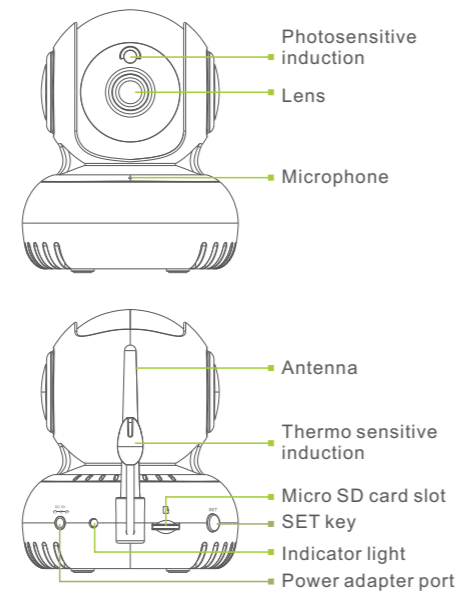

-1-

II Installation Instructions

Download and install client-end APP

1. For iPhone/iPad client-end: open App Store, search for "QQI", click Download Link for downloading and installation.



2. For Android client-end: enter "Google Play" Store, search for "QQI", click Download Link for downloading and installation.

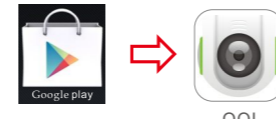

-2-

User registration

Please register a user after installing APP.

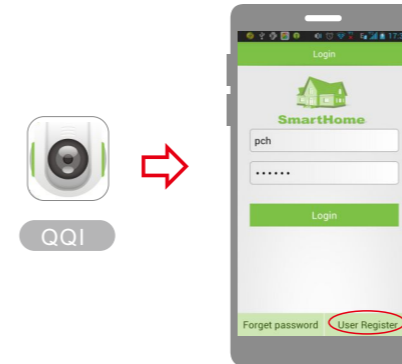

Connection with power

The standard DC5V power adapter is suitable for connecting with power, and the indicator light of camera is on and self inspection proceeds if the connection is successful.

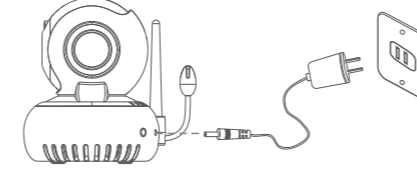

-3-

Camera Network Connecting Device

(Before connection: wireless router normally connects to the network and then connect the WiFi of cellphone to this router. When connecting to the camera, it should be within the scope of this wireless router.)

※ Take the operation of Android client-end for example, and refer to Android client-end for IOS client-end.

1. After logging in APP, add device and operate according to tips.

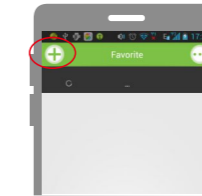

2. Shortly press "SET" key on the camera, "beep" sound can be heard.

3. Please input your WiFi name and password:



-4-

4. When the cell phone displays the two-dimension code, At this time, the camera shall be put next to the phone.

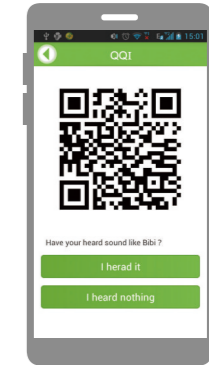

5. The beep means information reading is successful. Click "I heard" to establish connection.

-5-

III Watching Video and Operating

1. After successfully connected to, enter into the connected camera lens and check video etc.
2. Operation such as taking photos, picture recording, talking back, music, setting, viewing event list can be made on the intelligent client-end.

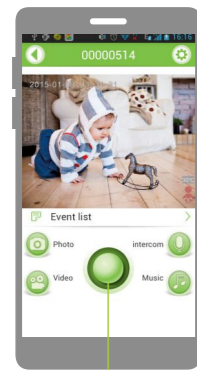

Regulation of camera lens viewing angle

Note: 1. Pictures taken manually with intelligent client-end are saved on the intelligent client-end.
2. Automatic photographing and video files of manual vide and motion detection are saved on the micro SD card of camera.

-6-

Setting

1. Click the icon on the real-time monitoring interface to enter the setting menu of camera. Users may change relevant parameters.

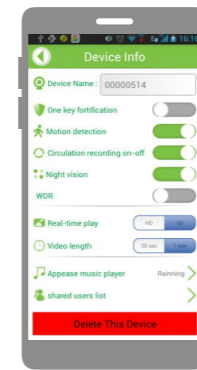

-7-

IV Function Features

- High definition, intelligent cloud, remote real-time caring.
- Support IOS system and Android system.
- Camera, recording, saving, playback.
- Two-way audio talkback.
- Smoothing music customizing and recoding.
- Motion detection and temperature alarm function.
- Maximally support the cyclic recording of 32GB micro SD card.

V Technical Parameters

- Image sensor: 1/4-inch CMOS
- Video image resolution: 720P high definition
- Perspective: 270°horizontal, 120°vertical
- Night visual range: < 5m
- Audio sensitivity: < -47db
- Receiving sensitivity: -80dbm (Min.)
- Operation voltage: DC+5V/1A
- Operation temperature: -10°C ~ + 50°C
- Operation humidity: 20% ~ 90% RH
- Size (LxWxH): 85 x85 x105mm
- Weight: 225g

※ Any small changes to all parameters will be done without prior notice.

-8-

VI Kindly Reminder

1. After camera network connection, the user account is bound to the camera.
2. After the registered user account is bound to the camera, other accounts are inapplicable to the camera, and can be added after unbinding.
3. After the registered user account is bound to the camera, the remote real-time view of monitor can be realized with this account through network on intelligent client-end.
4. Press "SET" key in power-on status of the camera until the indicator light is off. After the camera is reconnected with the network, the device is removed from the account. At this time, binding is successfully removed.

-9-

VII Packing List

After open the packages, please contrast with the figure below to verify whether the accessories are complete.

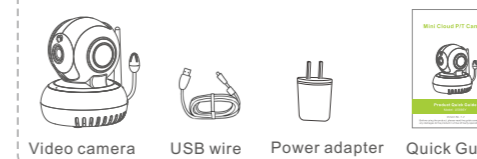

-10-

VIII FCC Certification Information:

The product conforms to the provisions prescribed in Article 15 of FCC. The operations of the product meet the following requirements:

- 1) No harmful interference will be produced by the instrument.
- 2) The instrument shall be able to receive the interference from the outside. Users have no rights to make any changes or modifications to the product without the permission of inspection body.

EU Environmental Provisions

E-waste cannot be mixed with household garbage; corresponding local government sector or recycling stations shall be responsible for circular process.



※ No further notice will be given for any tiny changes to the figures in this User's Manual.

-11-

NOTE: This equipment has been tested and found to comply with the limits for a Class B digital device, pursuant to part 15 of the FCC Rules. These limits are designed to provide reasonable protection against harmful interference in a residential installation. This equipment generates, uses and can radiate radio frequency energy and, if not installed and used in accordance with the instructions, may cause harmful interference to radio communications. However, there is no guarantee that interference will not occur in a particular installation. If this equipment does cause harmful interference to radio or television reception, which can be determined by turning the equipment off and on, the user is encouraged to try to correct the interference by one or more of the following measures:

- Reorient or relocate the receiving antenna.
- Increase the separation between the equipment and receiver.
- Connect the equipment into an outlet on a circuit different from that to which the receiver is connected.
- Consult the dealer or an experienced radio/TV technician for help.

This device complies with part 15 of the FCC rules. Operation is subject to the following two conditions:

- (1) this device may not cause harmful interference, and
- (2) this device must accept any interference received, including interference that may cause undesired operation.

Changes or modifications to this unit not expressly approved by the party responsible for compliance could void the user's authority to operate the equipment.