



www.gracobaby.com



imonitor
Digital Color Video Baby Monitor

OWNER'S MANUAL

Keep Instructions For Future Reference

WARNING

Failure to follow these warnings and the assembly instructions could result in serious injury or death.

This device is designed to aid in the monitoring of your child. When using the monitor, you must still provide the supervision necessary for the continued safety of your child. This product is not designed or intended for use as a medical monitor. Always be sure that both the transmitter and receiver are working properly and are within range of each other.

- **STRANGULATION HAZARD.** Keep the adapter cords out of the reach of children. Do not use with extension cords.
- **DO NOT** place the Nursery Unit or its cord within your child's reach. Do not put the Nursery Unit inside a crib or playard.
- **Use ONLY with 110-120 volt AC electrical outlets.**
- **Protect the AC adapter cords.** Place them so they are not walked on or pinched by furniture or other items.
- **Allow for proper ventilation when units are in use.** Do not cover the Nursery Unit or Parent Units with any object such as a blanket. Do not place it in a drawer or in any location which would muffle the sound or interfere with the normal flow of air.
- **DO NOT** immerse any part of the Nursery Unit, Parent Units, or docking station in water. Clean only with a dry cloth.

- **DO NOT** place unit near water and moisture. Do not use the Nursery Unit outdoors. Do not use the Nursery Unit near possible wet areas, such as a bathtub, shower, wash basin, sink, laundry tub, swimming pool, wet basement, etc.
- **Keep Nursery Unit away from heat sources**, such as fireplaces, radiators, stoves, and TVs or other appliances. Heat can damage the case or electrical parts.
- Do not use the Nursery Unit if:
 - The adapter cords or plugs have been damaged.
 - The unit has been exposed to liquids.
 - Unit has been dropped or is damaged.
- **DO NOT OPEN THE NURSERY UNIT, PARENT UNIT, NURSERY UNIT BASE OR ADAPTERS.** No user-serviceable parts inside. Risk of electrical shock, fire or death.
- The antenna used for this transmitter must be installed to provide a separation distance of at least 20 cm (7.9”) from all persons and must not be co-located or operating in conjunction with any other antenna or transmitter.

⚠ WARNING Modifications not authorized by the manufacturer may void users authority to operate this device.

NOTE: This equipment has been tested and found to comply with the limits for a Class B digital device, pursuant to Part 15 of the FCC Rules.

These limits are designed to provide reasonable protection against harmful interference in a residential installation. This equipment generates, uses and can radiate radio frequency energy and, if not installed and used in accordance with the instructions, may cause harmful interference to radio communications.

However, there is no guarantee that interference will not occur in a particular installation. If this equipment does cause harmful interference to radio or television reception, which can be determined by turning the equipment off and on, the user is encouraged to try to correct the interference by one or more of the following measures:

- Reorient or relocate the receiving antenna.
- Increase the separation between the equipment and receiver.
- Connect the equipment into an outlet on a circuit different from that to which the receiver is connected.
- Consult the dealer or an experienced radio/TV technician for help.

This device complies with part 15 of the FCC Rules. Operation is subject to the following two conditions:

- (1) This device may not cause harmful interference, and
- (2) This device must accept any interference received, including interference that may cause undesired operation.

Parts List

Adult assembly required.
Tool required: Phillips screwdriver

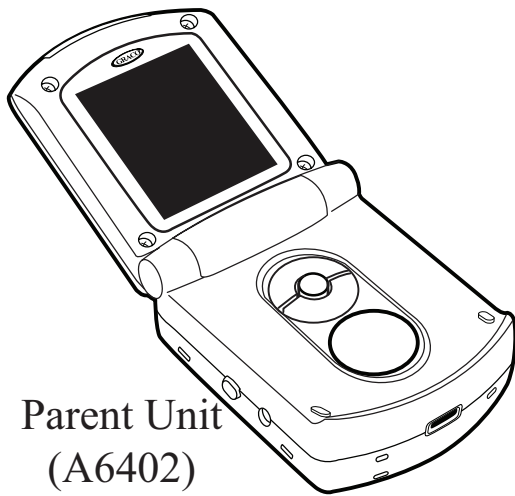

Parent Unit
(A6402)



Quick Start Manual

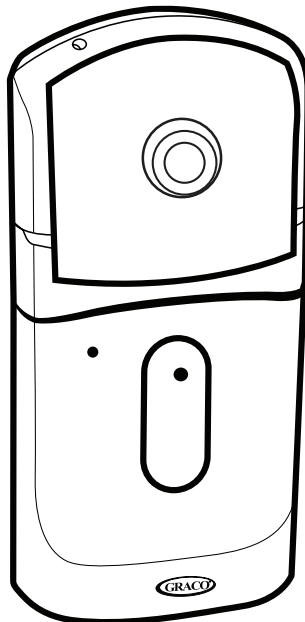

Nursery Unit
(A6403)

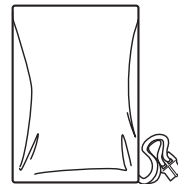

Parent Unit Battery

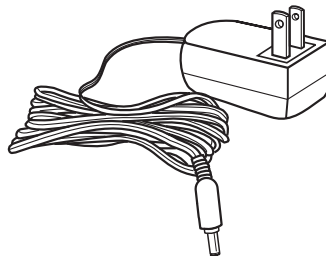

(1) AC Adapter

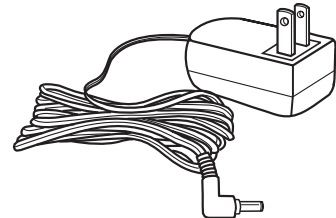

(1) AC Adapter

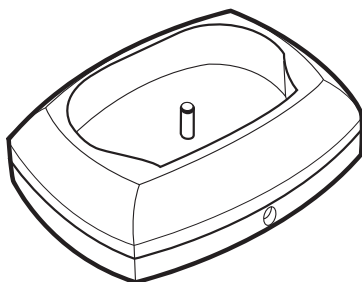

Nursery Unit Base
(A5195)

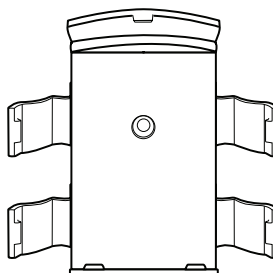

Wall Mount

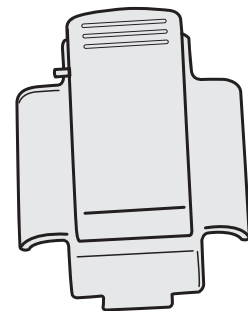

Belt Clip

Parent Unit

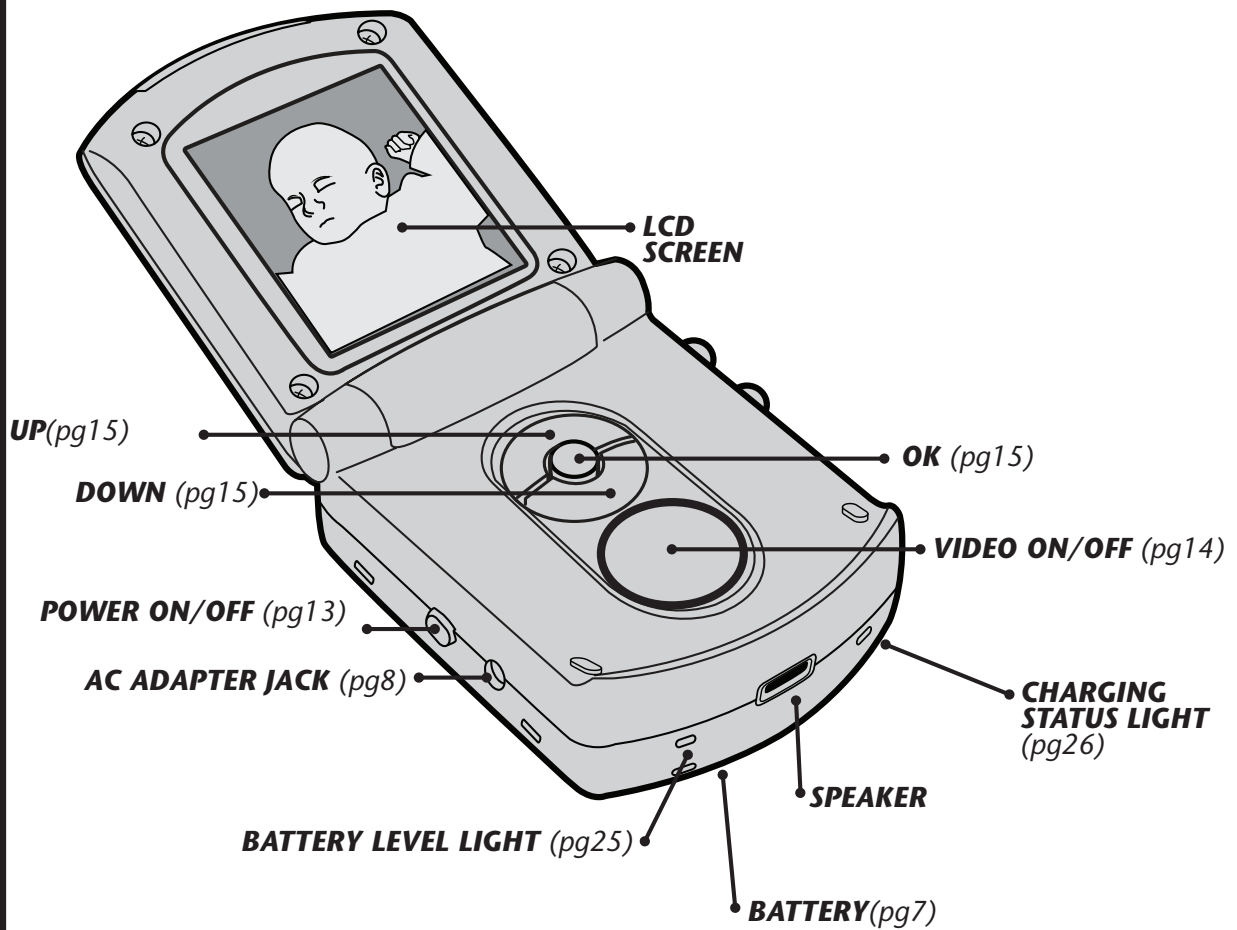
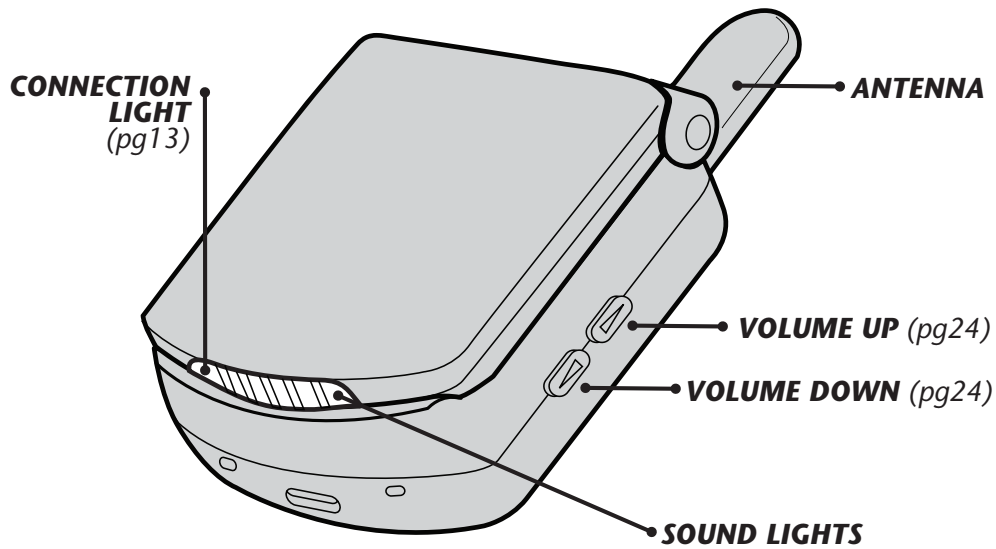

Installing Batteries

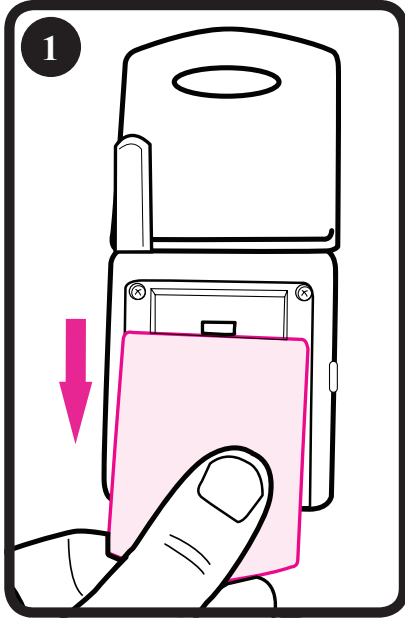

The battery must be plugged into the Parent Unit before the unit will be ready for use. Remove the battery door cover on the Parent Unit by sliding it down.

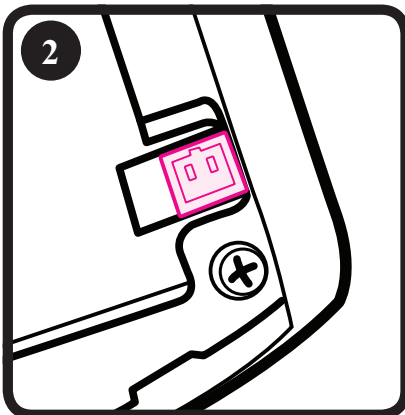

Plug battery into the slot shown in #2.

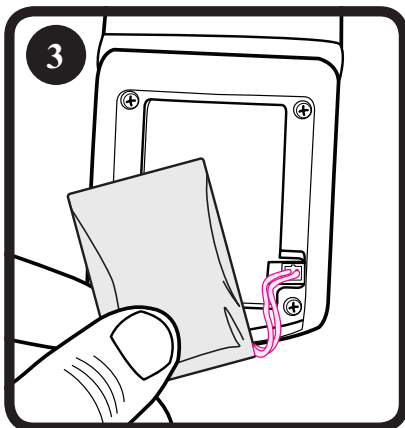

Place battery pack into recess and press wire into the slot.

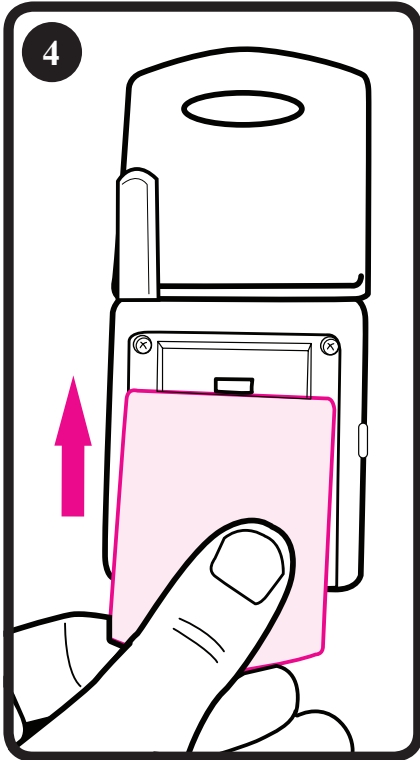

Replace the battery door.

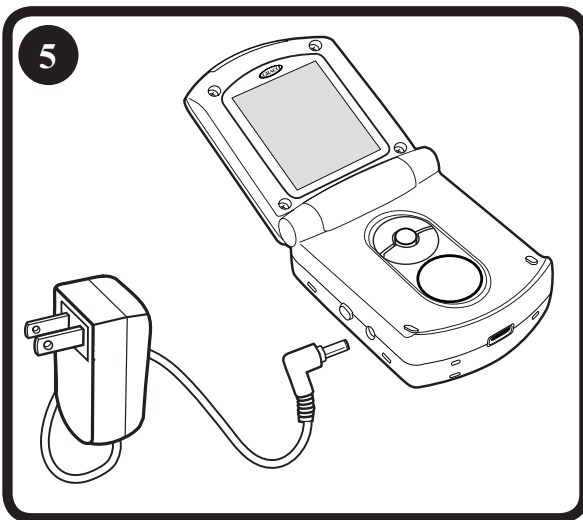

Attach the AC Adapter to the unit and plug into wall to charge the battery. Charge battery for 3 hours.

NOTE: Make sure to use the adapter with the “L” shaped end, as shown.



Nursery Unit

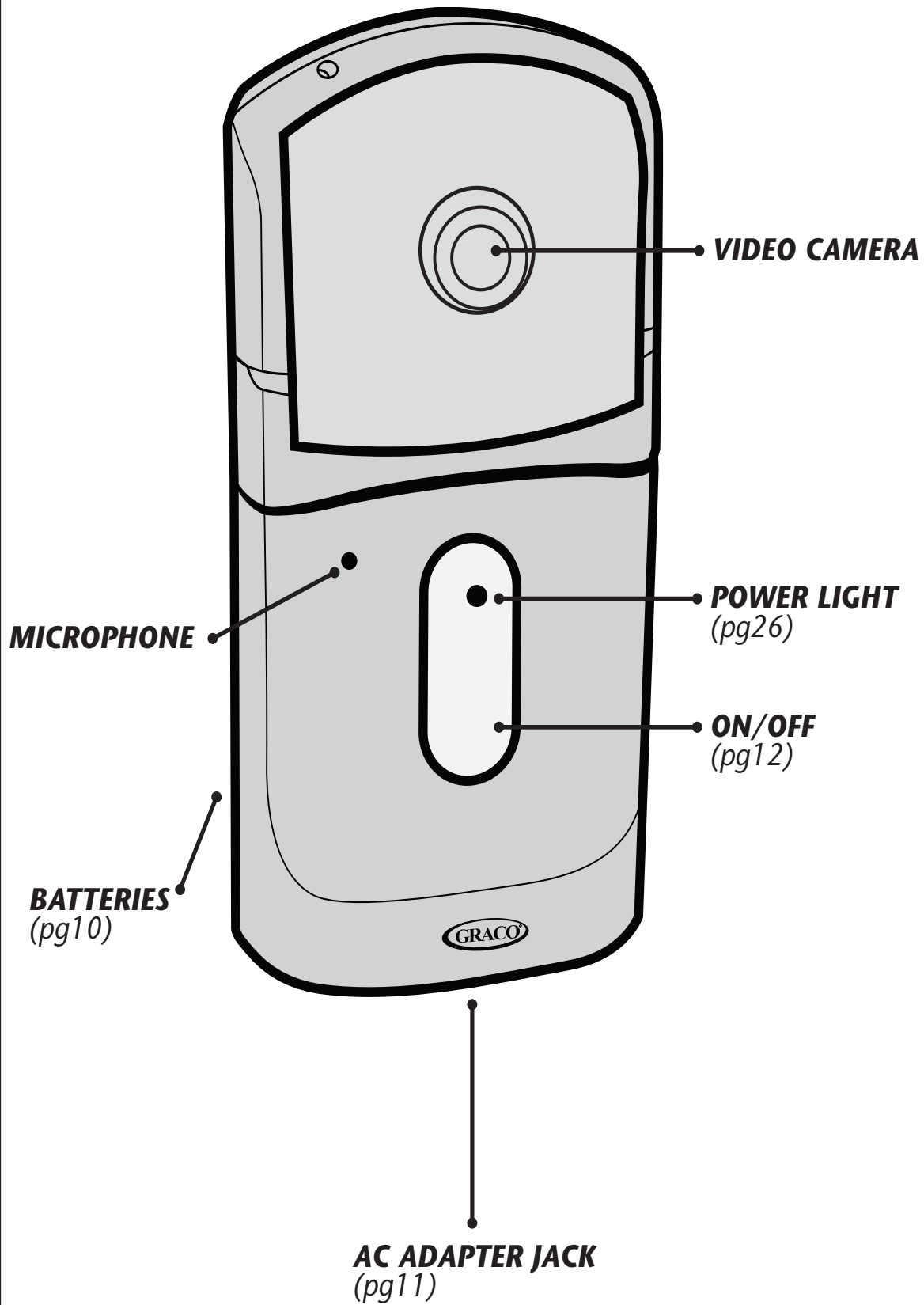

Installing Batteries

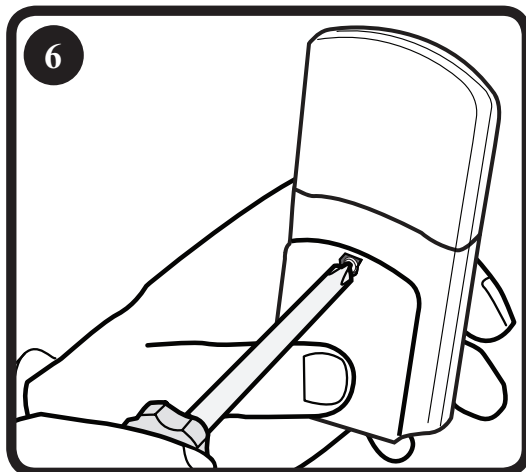

Use AC adapters for normal power usage – batteries intended as backup for power outage.

(Optional)

Use a Phillips head screwdriver to remove the battery door.

NOTE: Screw should be loosened but stay attached to battery door.



(Optional)

Insert 3 AAA (LR03) batteries.

Make sure they are inserted correctly.

- Batteries can be useful in the case of a power outage.
- Batteries should be replaced periodically.
- Batteries should only be used in case of emergency or for short periods of time.
- To save battery power, only audio functions are active while using batteries (NO VIDEO).

Attaching Nursery Unit Base

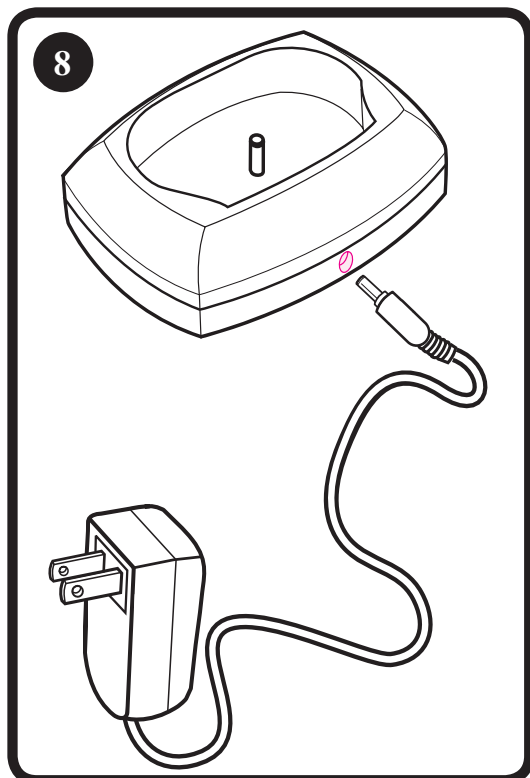

Attach the AC Adapter to the back of the nursery unit base and plug into wall.

NOTE: Make sure to use the adapter with the straight shaped end, as shown.

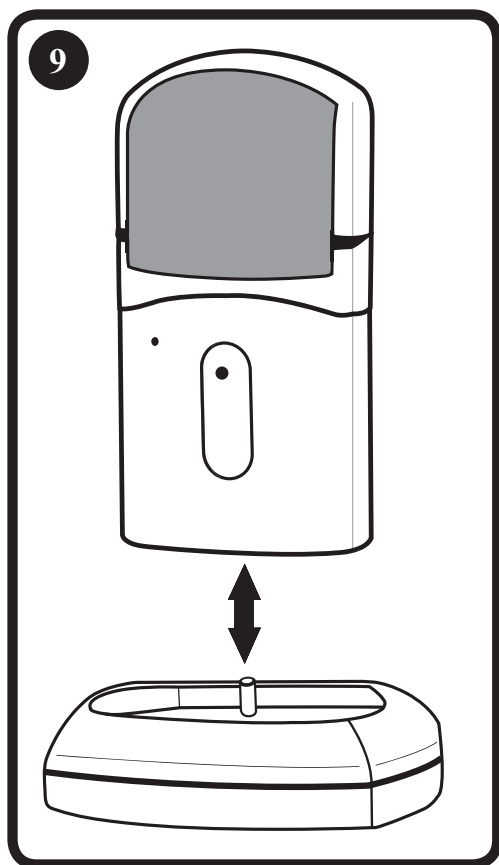

Mount nursery unit onto base to operate.

Nursery Unit Power On/Off

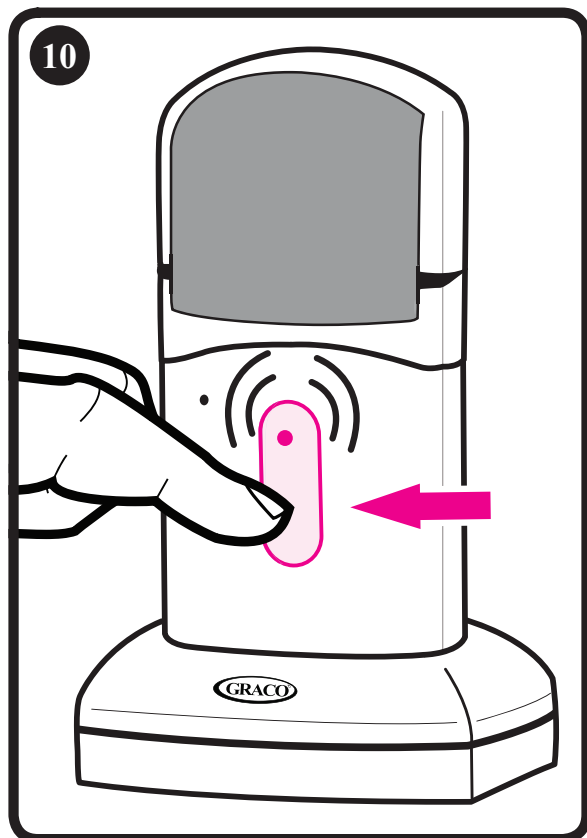

Depress button for 1 sec. to turn camera on.

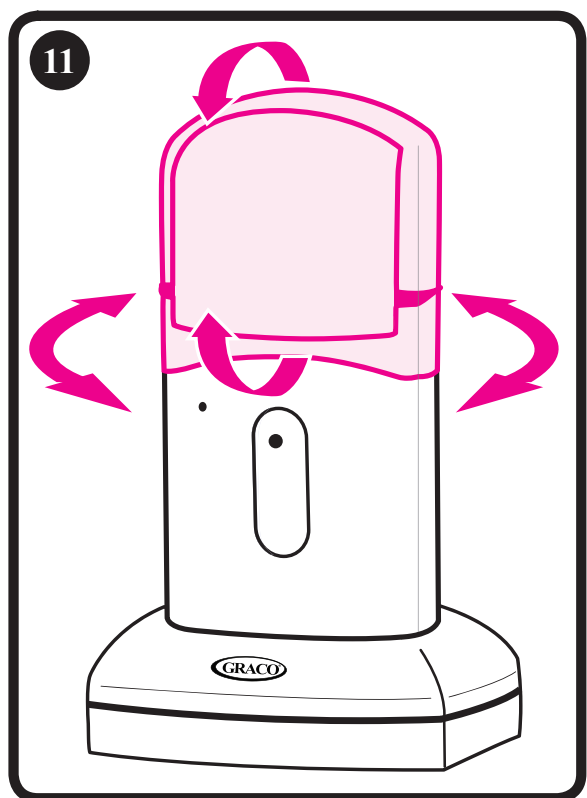

To change camera angle, swivel the nursery unit top in the desired direction. Please note that camera cannot swivel completely around.

Parent Unit Power On/Off

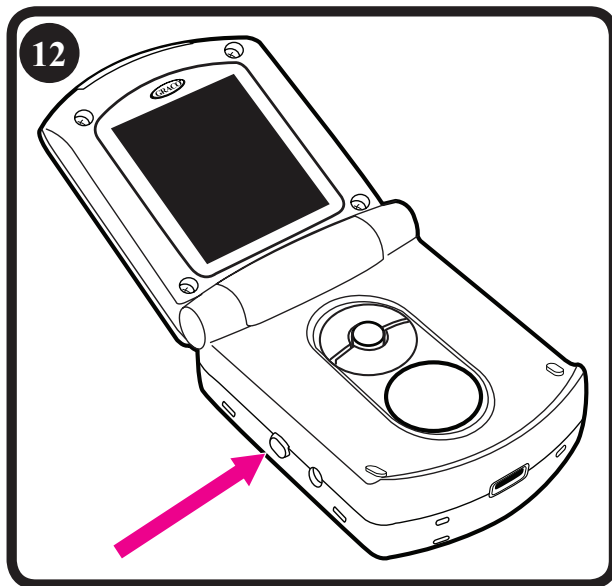

Press and hold **Power On/Off** button for 1 second. Unit will cycle through intro and begin searching for the Nursery Unit.

Connection Light

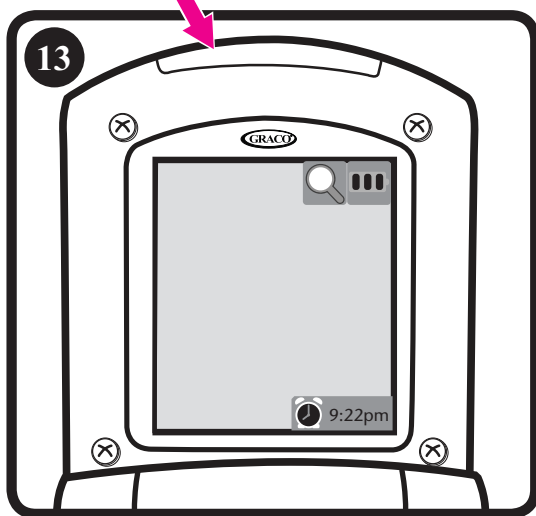

Make sure Nursery Unit is turned on. The live video feed will then be shown.

The Connection Light at the top of the unit, will turn from red to green.

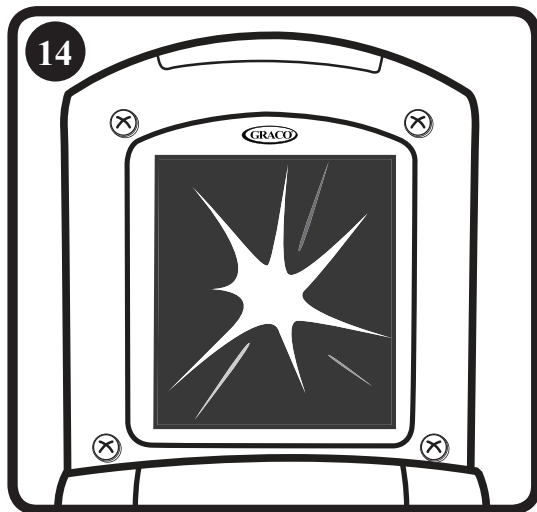

Press and hold **Power On/Off** button for 1 second to turn unit off.

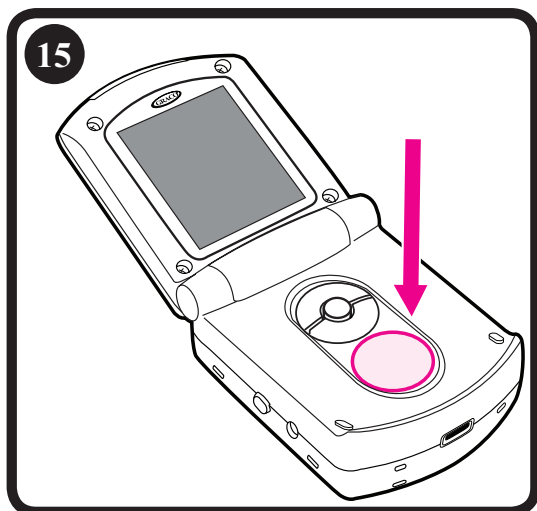

To activate or deactivate the live video feed, press the **Video** button.

Pressing the **Video** button will allow the user to view the image from the Nursery Unit.

16

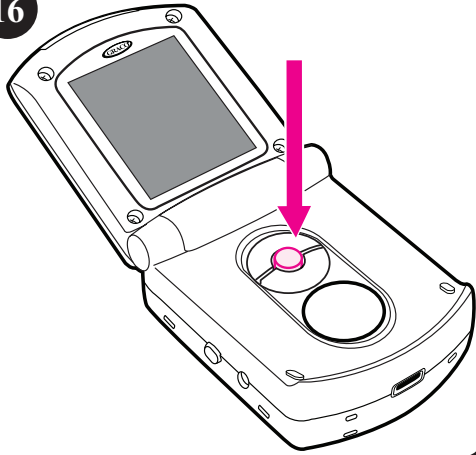

To set up preferences, press the “**OK**” button.

17

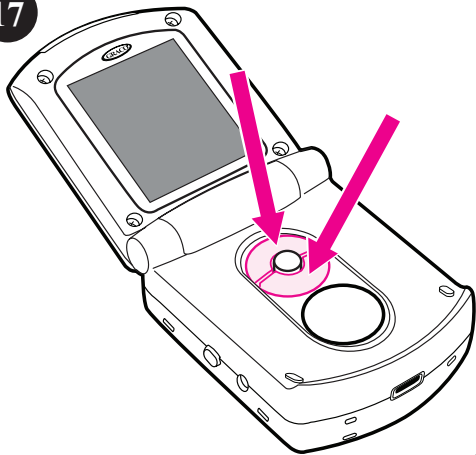

To cycle through the different choices, press up or down.

18

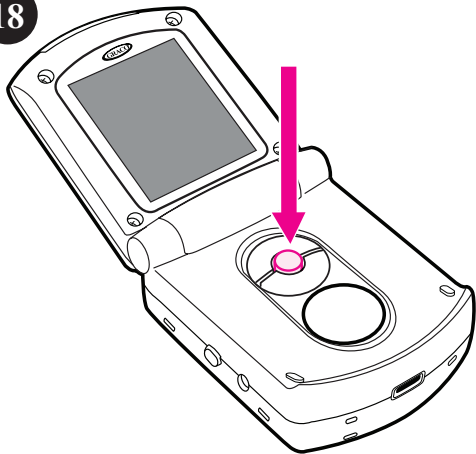

After choosing one of the options, press the “**OK**” button to make the selection.

NOTE: Once you make a selection (**OK**), the unit will automatically advance you to the next option/screen or return you to the live video feed (if applicable).

19

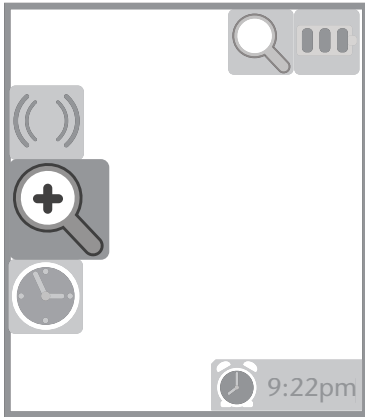

Press “**OK**” to open **Menu**. Press **Up/Down** to choose **Zoom** icon. Press “**OK**” to select it.

20

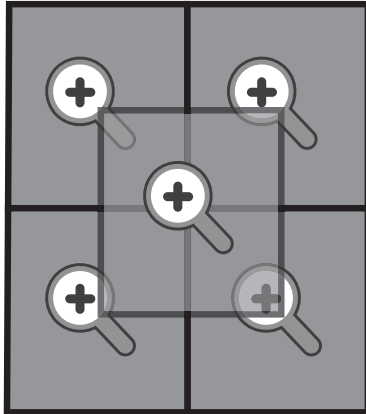

Use UP/DOWN to choose, OK to select

Press **Up/Down** to choose **Zoom** area. Press “**OK**” to select it.

Choose one of the **5 positions**

21

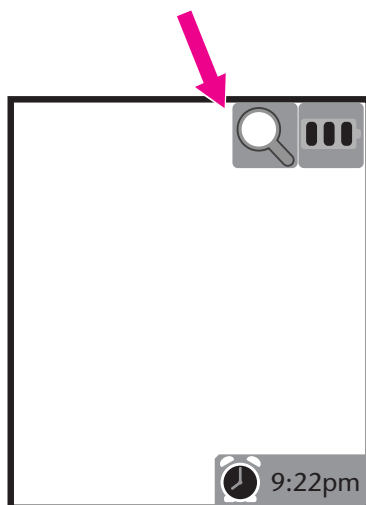

The **Zoom** icon will appear at the top the status screen.

Monitor will return to the live video feed if available.

Zoom Out

22

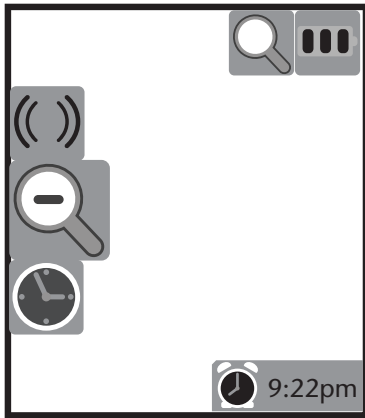

Press **OK** to open **Menu**.
Press **Up/Down** to choose **Zoom out** icon. Press **OK** to select it.

23

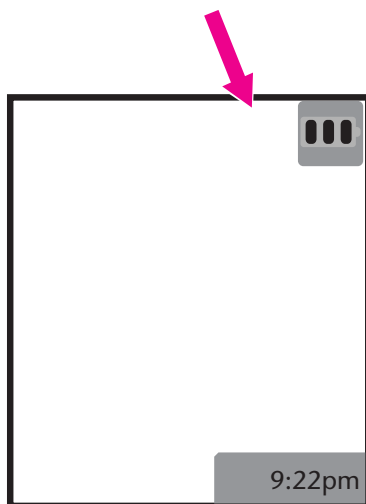

Monitor will return to live video screen if available.

Zoom icon will not be visible on the status screen.

Setting Time

24

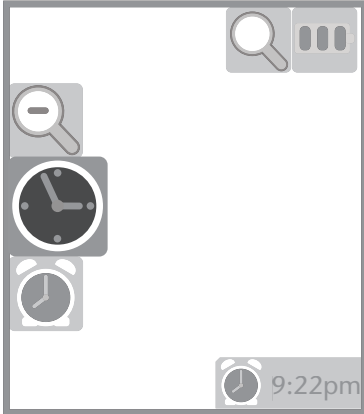

Press **“OK”** to open **Menu**. Press **Up/Down** to choose **Clock** icon. Press **“OK”** to select it.

25

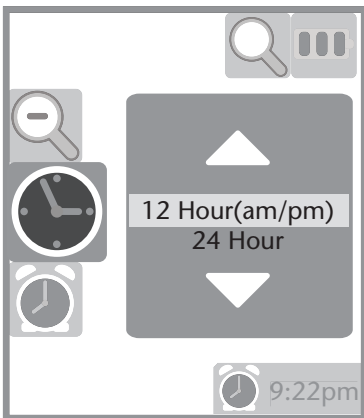

Press **Up/Down** to choose your preferred time display format and press **OK** to select.

26

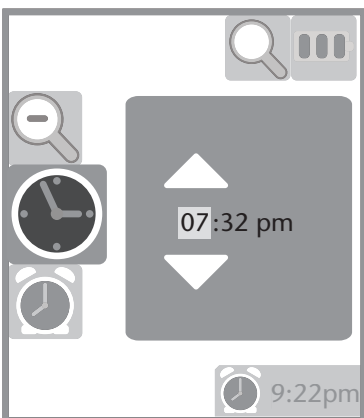

Press **Up/Down** to adjust the first digit. Press **OK** to move to the next digit. Monitor will return to the live feed after adjusting all digits.

Setting Alarm

27

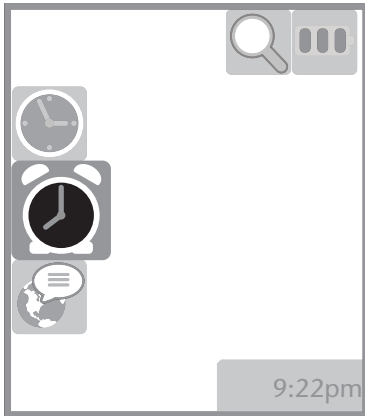

Press “**OK**” to open **Menu**.
Press **Up/Down** to choose **Alarm Clock** icon.
Press “**OK**” to select it.

28

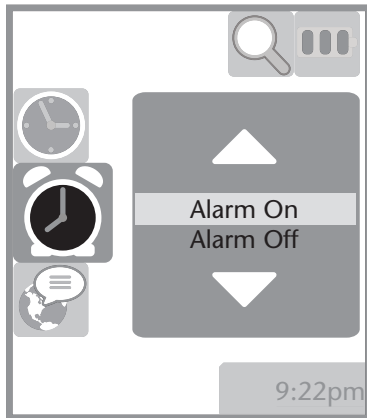

Press **Up/Down** to choose,
OK to select.

29

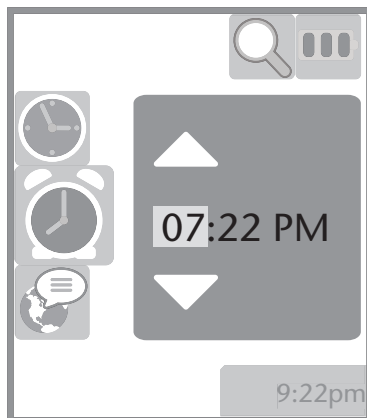

Press **Up/Down** to adjust the
first digit. Press **OK** to move
to the next digit. Monitor will
return to the live feed after
adjusting all digits.

30



Alarm Clock icon will appear on the bottom of the screen, next to the time.

NOTE: If Alarm Clock icon is not visible, it has not been activated.

31

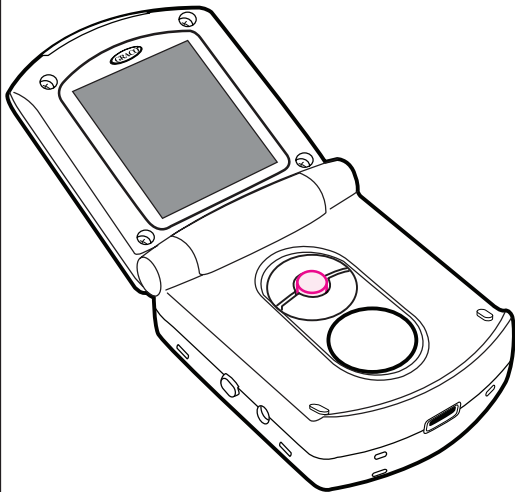

To silence **Alarm**, press any button.

NOTE: Alarm will chime every day at the pre-selected time until **Alarm** is deactivated, new time is selected. or if unit if powered off.

When Alarm sounds, press any button to deactivate it. Alarm will sound off every 2 seconds for 10 minutes, or until user stops it.

Brightness

32

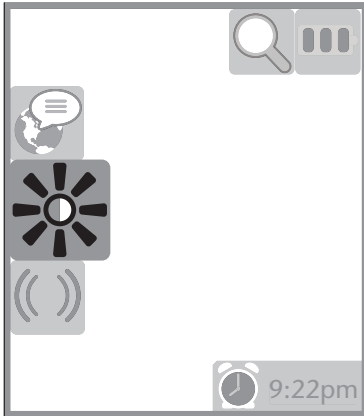

Press “**OK**” to open **Menu**.
Press **Up/Down** to choose **Brightness** icon.
Press “**OK**” to select it.

33

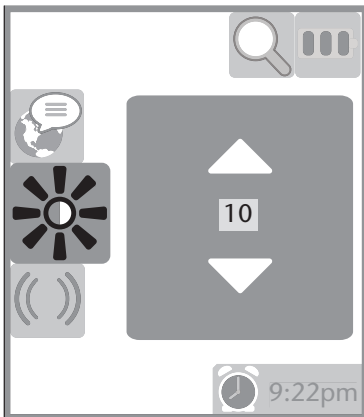

Press **Up/Down** to choose brightness value, **OK** to select. (10 levels in all)

Monitor will return to the live feed after adjusting all digits.

Language

34

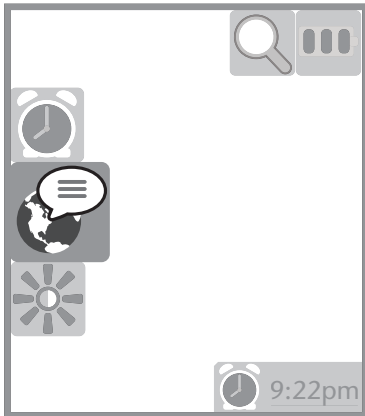

Press “**OK**” to open **Menu**.
Press **Up/Down** to choose **Language** icon.
Press “**OK**” to select it.

35

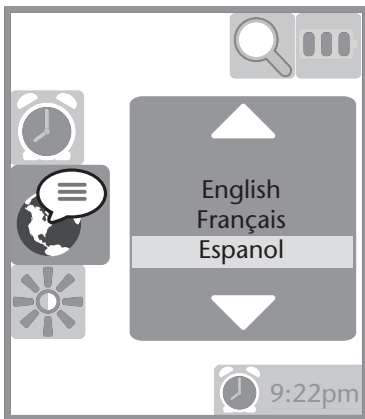

Press **Up/Down** to choose,
OK to select.

Monitor will return to the live
feed after selecting a language.

Vibration

36

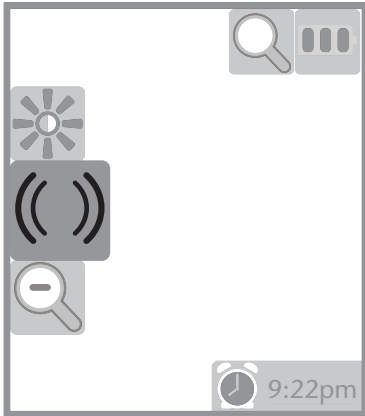

Press “**OK**” to open **Menu**.
Press **Up/Down** to choose **Vibration** icon.
Press “**OK**” to select it.

37

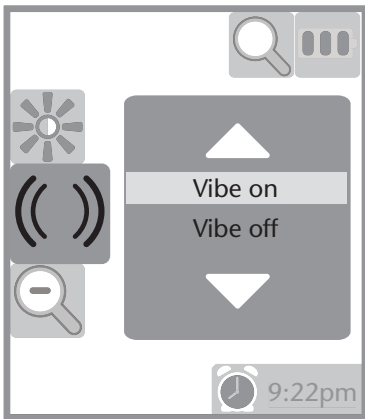

Press **Up/Down** to choose, **OK** to select.

When “**Vibe On**” is selected,
Parent Unit will vibrate when
it is activated with sounds from
the Child Unit.

38

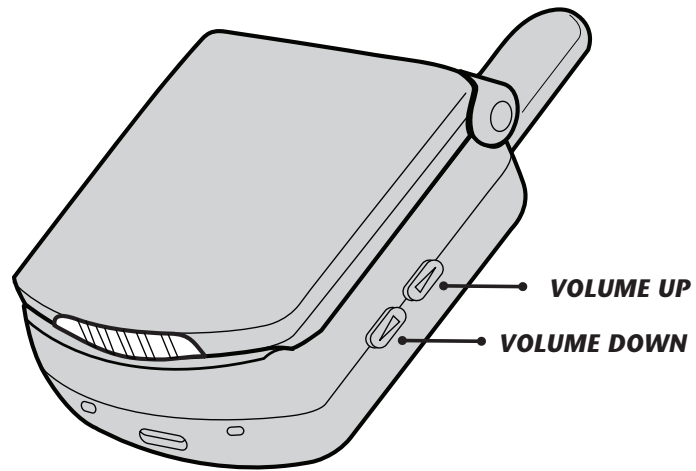

- Press the **Volume up** or **Down** button to change the **Volume**.

Battery Information

Parent Unit Battery Level

The Battery Icon shows how much power is left in the batteries:

39



The **Battery** icon will cycle while batteries are charging.

- When the batteries are low, the **Battery** Icon will blink and the monitor will beep once every minute.
- When the batteries are extremely low, the screen will display the warning ,“Batteries are very low. Turning off...” The unit will then turn off.
- The Battery Level Light will illuminate green when the batteries are OK, red when the batteries are low. The Battery Level Light can be seen easily when the Parent Unit is closed.

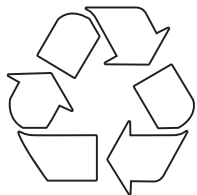

- Batteries should be disposed of properly by recycling.

Parent Unit Battery Charging

- Plug the AC Adapter into the Parent Unit to start charging the batteries.

- The Charging Status Light will illuminate red while the batteries are being charged, green when the batteries are fully charged. The Charging Status Light can be seen easily when the Parent Unit is closed.

Nursery Unit Backup Batteries

- Three AAA (LR03) batteries can be optionally installed in the Nursery Unit in case AC power is lost.
- When the Nursery Unit is on battery power, only the audio will be transmitted. This helps to extend the battery life.
- The Power Light is green when the batteries are good, red when the batteries are low.
- The Parent Unit will show “Nursery Unit AC Power Disconnected” when the Nursery Unit is on battery power.
- Remove the batteries from the unit if it is no longer being used or will be stored for an extended period of time.

Accessories/ Wall Mount & Belt Clip

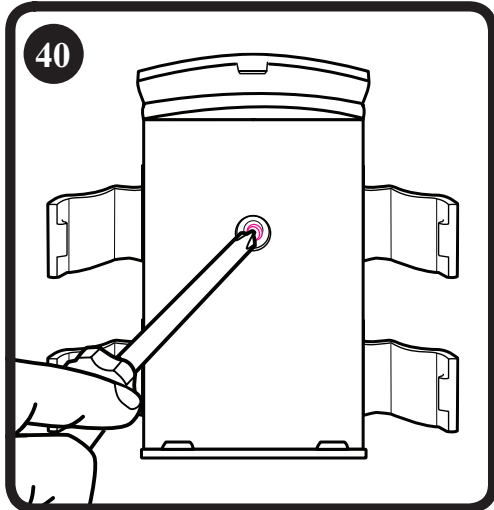

Attach wall mount to wall using a #6 screw and drywall anchor (not included). Make sure all cords are not within child's reach. Make sure there is an electrical outlet readily available to plug in the AC adapter. **DO NOT** use an extension cord.

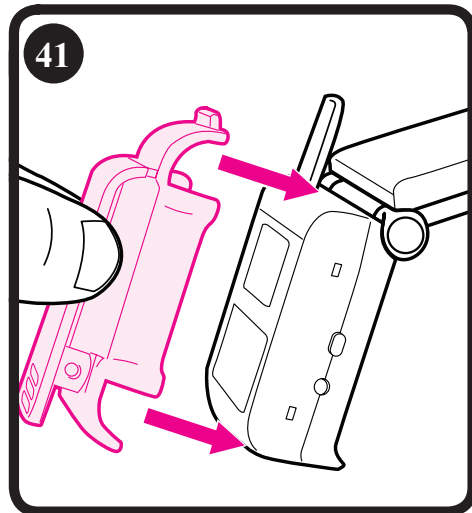

Attach the belt clip to the parent unit as shown.

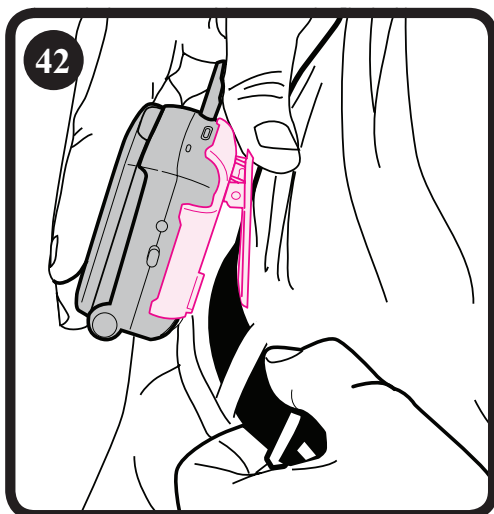

Using the belt clip, you can fasten the parent unit to your waist/belt for hands free use.

Trouble Shooting

Most problems have a simple solution.

First, check that:

- Power is turned ON for both units
- Both units are plugged in (or batteries are fresh in Nursery Unit and fully charged in Parent Unit)
- Electrical outlet works
- Volume is turned up on Parent Unit
- Parent Unit is in range of the Nursery Unit

Parent Unit Only Works With AC Adapter

- Check that the battery is properly installed and plugged into connector.

No Sound or No Video

- Batteries dead or weak — replace or use AC Adapter.
- AC Adapter not properly connected — check the connections.
- Nursery Unit covered or blocked — remove the obstruction.
- Press the **Video** Button to view the video.

Weak Sound, Static or Poor Video.

- Nursery Unit too far from baby — move closer.
- Parent Unit too far from Nursery Unit — move them closer.
- Large objects blocking the signal — try repositioning Nursery Unit.
- Volume setting too low — turn it up.
- Interference from other electrical equipment— eliminate cause of static (TVs, mixers, computers, fans, fluorescent lights, light dimmers, etc.)
- Significant amount of obstructions between Parent Unit and Nursery Unit such as walls, ceilings and buildings. Try moving the Nursery Unit to another part of the room.

Shrill Sound (Feedback)

- Nursery Unit and Parent Unit too close together— move them farther apart.
- Volume set too high — lower the volume.

Pairing the Parent Unit and Child Unit

To ensure privacy, your Parent Unit is paired with your Nursery Unit at the factory. Your Parent Unit will not work with any other Nursery Units.

If your Parent Unit won't lock onto your Nursery Unit, or you purchased a new Parent Unit or Nursery Unit, follow the procedure below to pair the Parent Unit and Nursery Unit. If you purchased a new Parent Unit, skip Step 1. The new Parent Unit is ready to pair with your Nursery Units.

1. Erase the Pairing from the Parent Unit

- Press **Volume Up**, **Volume Down**, and **Video** buttons simultaneously for 3 seconds.
- The screen will display “Are you sure you want to disconnect from the Nursery Unit?”
- Select “Yes” and press “**OK**”.
- The Parent Unit is ready to pair with the Nursery Unit.

2. Pair the Parent Unit with the Nursery Unit

- If the Parent Unit is not on, turn it on now.
- The Parent Unit will display “Looking for a Nursery Unit to pair with. Turn on your Nursery Unit now.”
- Place the Nursery Unit in the same room, as the Parent Unit.
- Turn the Nursery Unit Off then On again using the **On/Off** Button. The green power light should come on.
- Within a few seconds, the Parent Unit will find the Nursery Unit. The Parent Unit will display “Nursery Unit found. Pairing complete.”
- The Parent Unit will begin monitoring normally.

Nothing happened when I turned on the Nursery Unit. What do I do?

- With the Parent Unit on, turn the Nursery Unit off, and then on again.

- If there is still a problem, repeat steps 1 and 2.

Replacement Parts Warranty Information (USA)

To purchase parts or accessories or for warranty information in the United States, please contact us at the following:

Graco Children's Products
150 Oaklands Blvd.
Exton, PA 19341

www.gracobaby.com
or
1-800-345-4109

Product Registration (USA)

To register your Graco product from within the U.S.A. visit us online at

www.gracobaby.com/productregistration.

We currently do not accept product registrations from those living outside the United States of America.

