

Complete RPS 2900 Pump Kit for RoadLazer™ RoadPak™ Line Striping System

3A1304A

ENG



Model 24G766



Important Safety Instructions

For complete warnings and safety instructions see RoadLazer™ RoadPak™ Line Striper System manual. Save these instructions.

Pressure Relief Procedure

			
<p>The system pressure must be manually relieved to prevent the system from starting or spraying accidentally. Fluid under high pressure can be injected through the skin and cause serious injury. To reduce the risk of an injury from injection, splashing fluid, or moving parts, follow the Pressure Relief Procedure in RoadLazer RoadPak Line Striping System manual whenever you:</p> <ul style="list-style-type: none">• are instructed to relieve the pressure• stop spraying• check or service any of the system equipment• install or clean the spray tip			

1. Flush the system. See **Flush System** in RoadLazer RoadPak Line Striping System manual.
2. Relieve pressure. See **Pressure Relief Procedure** in RoadLazer RoadPak Line Striping System manual.

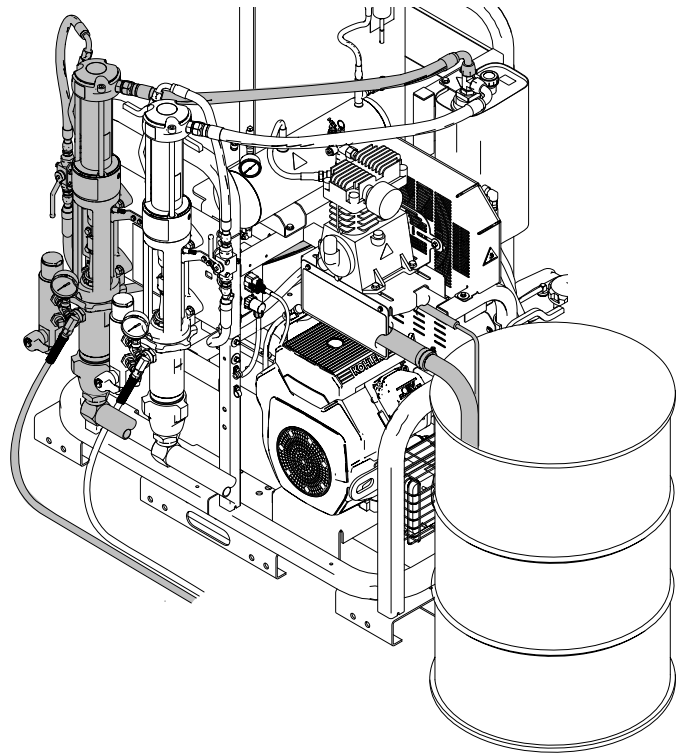

ti11724a

Hose Routing to Pumps and Tanks

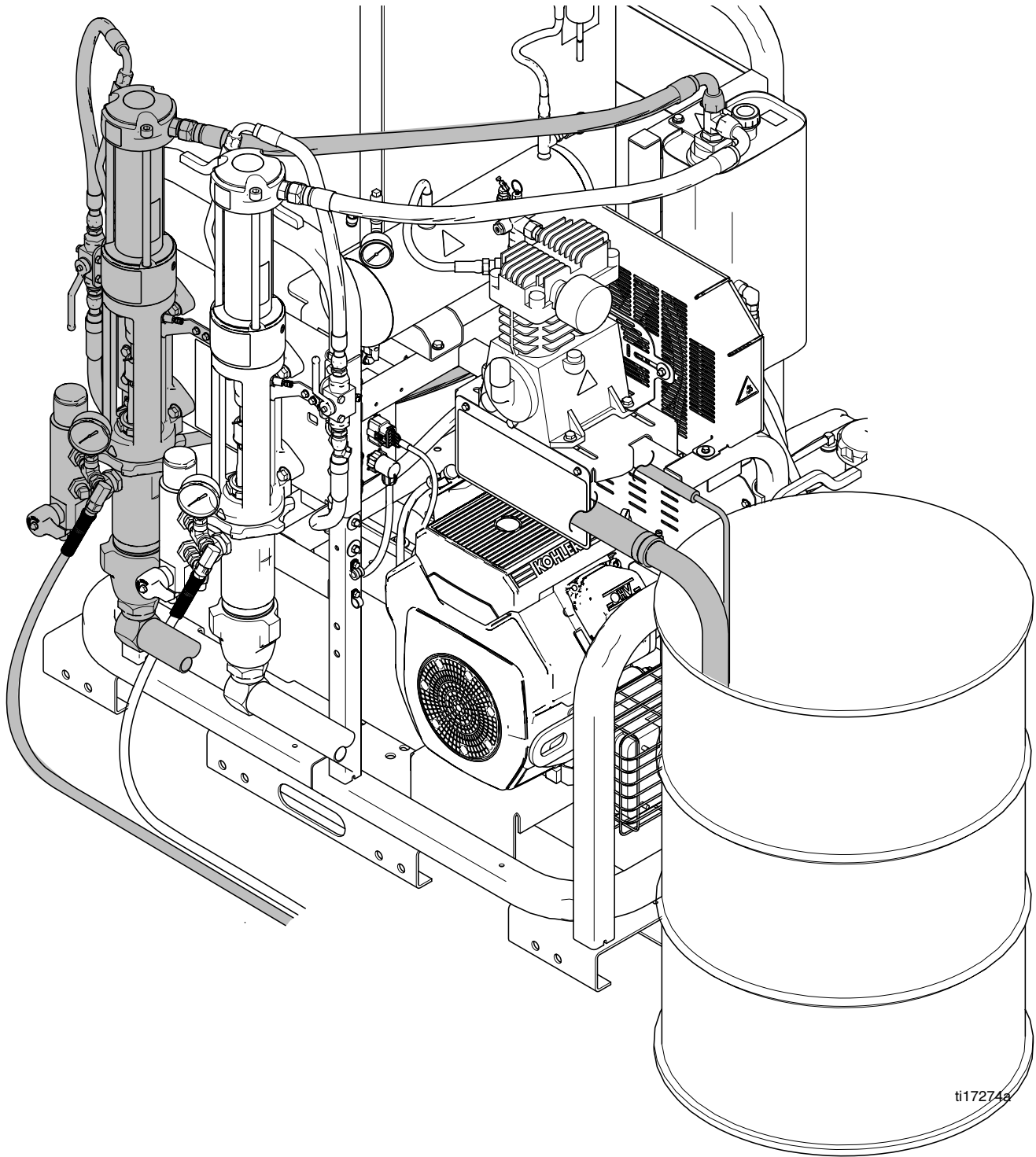

ti17274a

Second Pump Installation

1. Install four mounting bolts (6) to mounting plate.
2. Lift pump over mounting bolts (6) and slide down into position. Torque bolts to 33 ft-lb (45 N•m).
3. Remove two bolts (aa) from mounting plate. Hold hydraulic valve bracket (7) in place, then replace two bolts (aa) and tighten firmly.
4. Turn hydraulic ball valve to closed position. Install hydraulic valve and bracket. Make sure the handle is positioned away from the RPS2900 pump.
5. Remove cap from top of hydraulic tank tee fitting. Attach hydraulic line and route line (9) through the top of the pump. Attach hydraulic line fitting.

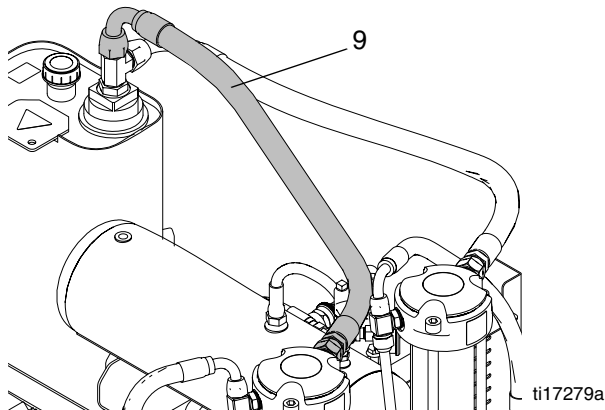

6. Remove cap from top of hydraulic pump tee fitting. Attach hydraulic line (10) and route line to inlet of ball valve. Install hose fitting adaptor (21) and attach hydraulic line fitting.

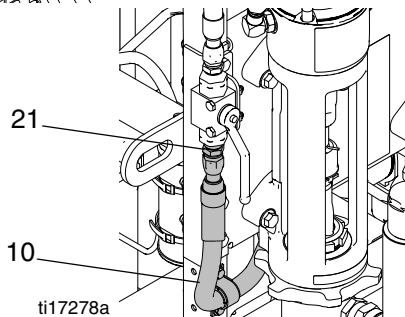
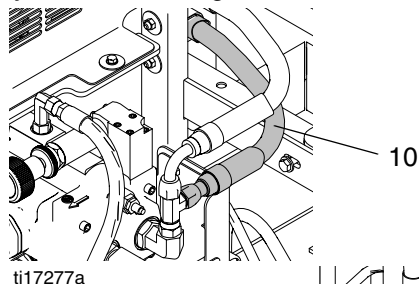

7. Install hose fitting adaptor (21) and attach hydraulic line (25) to outlet of ball valve. Route and secure hose to pump inlet.

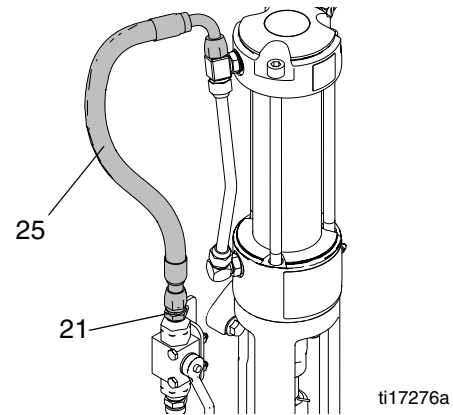

8. Secure hydraulic line with provided clamps and fasteners in locations shown below.

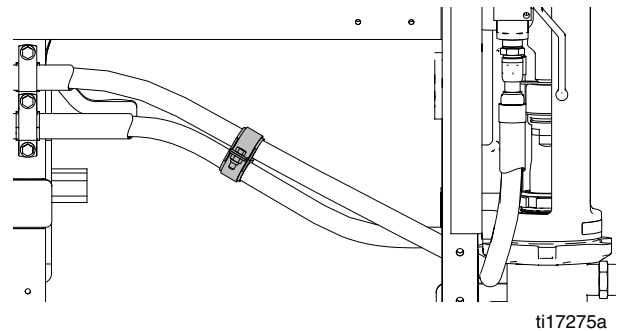

9. Start hydraulic pump, slowly turn the hydraulic ball in line with the hoses and stroke the pump 3-4 times. Check the hydraulic reservoir level and fill as necessary. Run the pump slowly for several cycles to purge any air from the hydraulic lines. Check the hydraulic reservoir level and fill as necessary.
10. Install pump filter (2) onto pump. **NOTE:** Filter (2) should be positioned similar to the factory-installed pump and filter.
11. Install gallon counter bracket (4) and tighten two bolts (5).
12. Thread gallon counter (3) into installed bracket (4) until flush against piston shaft and then unscrew one half turn. Use jam nuts to secure into position.
13. Attach drain line (29) to bottom of pump filter (2).
14. Attach suction tube (40) to bottom of pump (1).

Parts

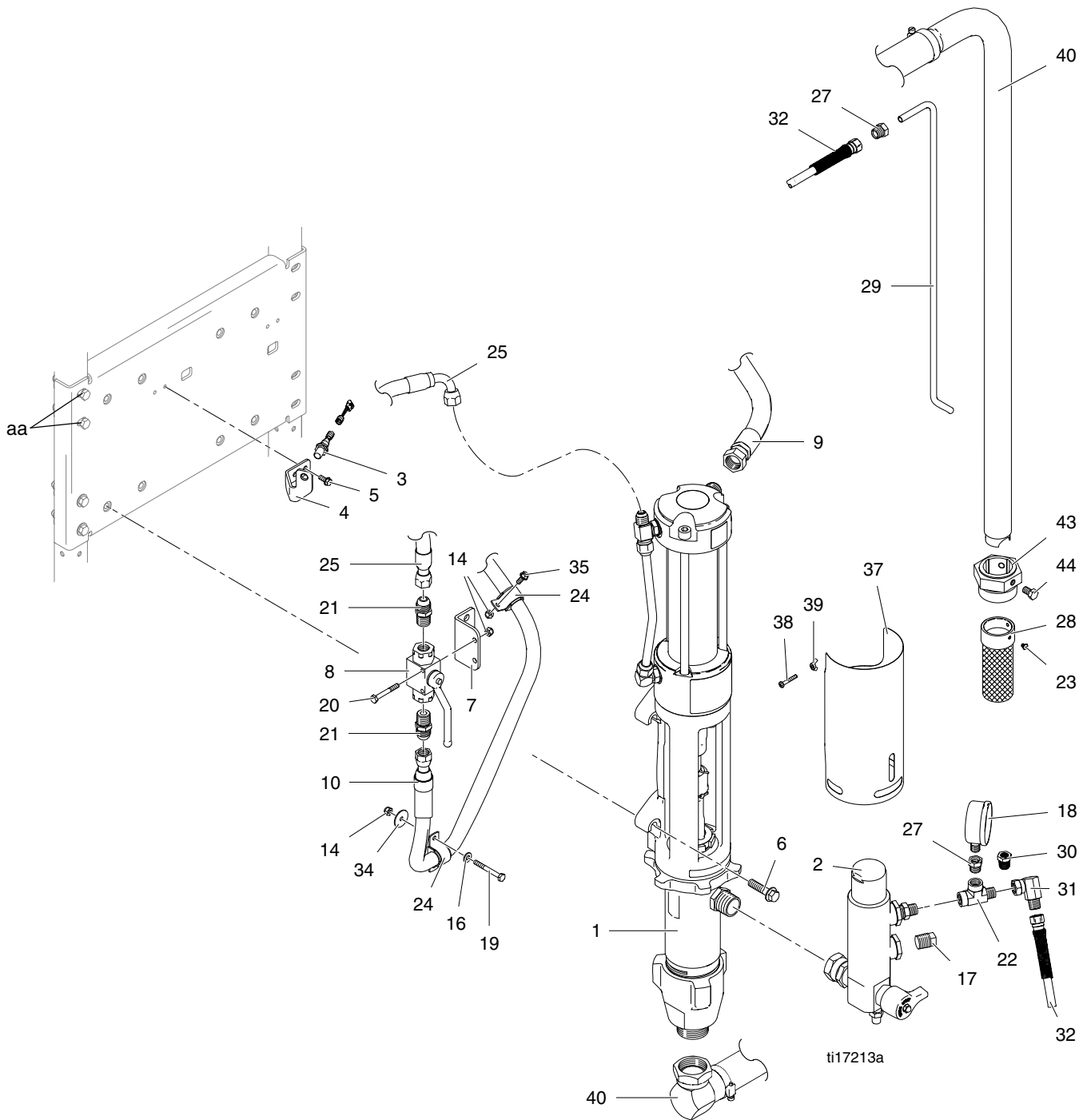

Parts List

Ref.	Part	Description	Qty.
1	24G767	PUMP, RPS 2900	1
2	24G986	FILTER, Assembly, RPS 2900	1
3	16J511	SENSOR, proximity, 12 mm	1
4	16G421	BRACKET, sensor	1
5	112774	SCREW, mach, sltd hex wash HD	2
6	120226	SCREW, hex HD, flange	4
7	16G414	BRACKET, ball valve	1
8	120140	VALVE, ball, assembly	1
9	16G037	HOSE, coupled	1
10	16G035	HOSE, coupled	1
11	222385	TAG, warning	1
14	102040	NUT, lock, hex	7
16	110755	WASHER, plain	3
17	124489	PLUG, pipe	1
18	102814	GAUGE, press, fluid	1
19	105171	SCREW, cap, hex, 1/4 x 2 1/4	3
20	110982	SCREW, cap, hex HD	2
21	120304	FITTING, nipple, straight	2
22	124490	FITTING, tee, street	1
23	125320	SCREW, mach., phillips rnd HD	2
24	125005	CLAMP, hose, cushion, 7/8 ID	4
25	15G783	HOSE, coupled	1
27	168160	BUSHING, pipe	1
28	16G692	STRAINER, inlet	1
29	16G707	TUBE, drain	1
30	196180	BUSHING	1
31	207123	UNION, swivel, 90 deg	1
32	245798	HOSE, cpld, 1/4 in. x 7 ft	1
34	159346	WASHER	3
35	108296	SCREW, mach, hex wash HD	2
37	16H585	SHIELD, pump	1
38	111235	SCREW, mach, pnh	1
39	120317	NUT, wing	1
40	24G726	HOSE, suction	1
41	110110	SEALANT, pipe, sst	2
43	260384	ADAPTER, bung, machining	1
44	15D008	BOLT, 3/8-16, 316 sst	2
45	16J716	PLUG, 3/4 drum, with hole	1

Graco Standard Warranty

Graco warrants all equipment referenced in this document which is manufactured by Graco and bearing its name to be free from defects in material and workmanship on the date of sale to the original purchaser for use. With the exception of any special, extended, or limited warranty published by Graco, Graco will, for a period of twelve months from the date of sale, repair or replace any part of the equipment determined by Graco to be defective. This warranty applies only when the equipment is installed, operated and maintained in accordance with Graco's written recommendations.

This warranty does not cover, and Graco shall not be liable for general wear and tear, or any malfunction, damage or wear caused by faulty installation, misapplication, abrasion, corrosion, inadequate or improper maintenance, negligence, accident, tampering, or substitution of non-Graco component parts. Nor shall Graco be liable for malfunction, damage or wear caused by the incompatibility of Graco equipment with structures, accessories, equipment or materials not supplied by Graco, or the improper design, manufacture, installation, operation or maintenance of structures, accessories, equipment or materials not supplied by Graco.

This warranty is conditioned upon the prepaid return of the equipment claimed to be defective to an authorized Graco distributor for verification of the claimed defect. If the claimed defect is verified, Graco will repair or replace free of charge any defective parts. The equipment will be returned to the original purchaser transportation prepaid. If inspection of the equipment does not disclose any defect in material or workmanship, repairs will be made at a reasonable charge, which charges may include the costs of parts, labor, and transportation.

THIS WARRANTY IS EXCLUSIVE, AND IS IN LIEU OF ANY OTHER WARRANTIES, EXPRESS OR IMPLIED, INCLUDING BUT NOT LIMITED TO WARRANTY OF MERCHANTABILITY OR WARRANTY OF FITNESS FOR A PARTICULAR PURPOSE.

Graco's sole obligation and buyer's sole remedy for any breach of warranty shall be as set forth above. The buyer agrees that no other remedy (including, but not limited to, incidental or consequential damages for lost profits, lost sales, injury to person or property, or any other incidental or consequential loss) shall be available. Any action for breach of warranty must be brought within two (2) years of the date of sale.

GRACO MAKES NO WARRANTY, AND DISCLAIMS ALL IMPLIED WARRANTIES OF MERCHANTABILITY AND FITNESS FOR A PARTICULAR PURPOSE, IN CONNECTION WITH ACCESSORIES, EQUIPMENT, MATERIALS OR COMPONENTS SOLD BUT NOT MANUFACTURED BY GRACO. These items sold, but not manufactured by Graco (such as electric motors, switches, hose, etc.), are subject to the warranty, if any, of their manufacturer. Graco will provide purchaser with reasonable assistance in making any claim for breach of these warranties.

In no event will Graco be liable for indirect, incidental, special or consequential damages resulting from Graco supplying equipment hereunder, or the furnishing, performance, or use of any products or other goods sold hereto, whether due to a breach of contract, breach of warranty, the negligence of Graco, or otherwise.

FOR GRACO CANADA CUSTOMERS

The Parties acknowledge that they have required that the present document, as well as all documents, notices and legal proceedings entered into, given or instituted pursuant hereto or relating directly or indirectly hereto, be drawn up in English. Les parties reconnaissent avoir convenu que la rédaction du présente document sera en Anglais, ainsi que tous documents, avis et procédures judiciaires exécutés, donnés ou intentés, à la suite de ou en rapport, directement ou indirectement, avec les procédures concernées.

Graco Information

For the latest information about Graco products, visit www.graco.com.

TO PLACE AN ORDER, contact your Graco distributor or call 1-800-690-2894 to identify the nearest distributor.

*All written and visual data contained in this document reflects the latest product information available at the time of publication.
Graco reserves the right to make changes at any time without notice.*

Original instructions. This manual contains English. MM 3A1304

Graco Headquarters: Minneapolis
International Offices: Belgium, China, Japan, Korea
GRACO INC. P.O. BOX 1441 MINNEAPOLIS, MN 55440-1441

Copyright 2010, Graco Inc. is registered to ISO 9001

www.graco.com
Revision A - 04/2011