

GUV3060

True Wireless Earbuds

Quick User Guide

Headset Components

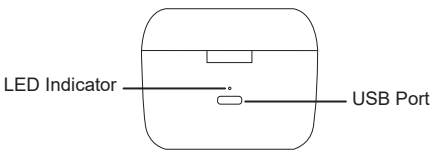
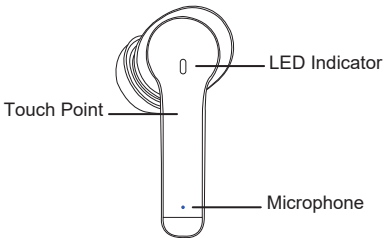

Package contents

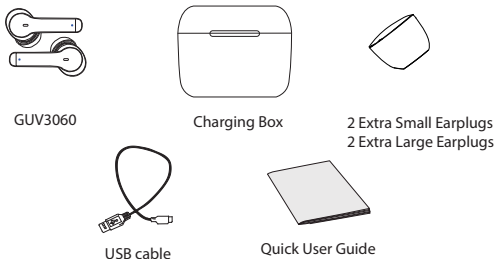

Pairing Procedure

Enter Pairing Mode

Opening the top cover of the charging box will trigger the automatic pairing mode with both indicator lights flashing.

Note: The pairing takes about 10s and the sound “connected” indicates its success.

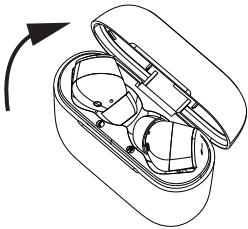

Start Pairing

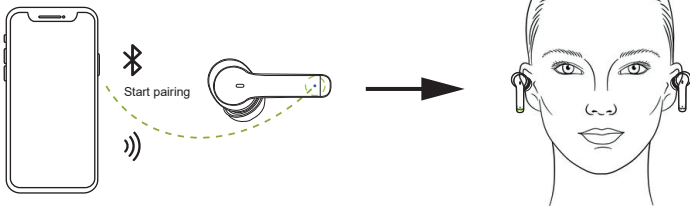

Enable “Bluetooth” function on the phone, search for “GUV3060”, click to connect and wait for the sound “connected’ indicating its success.

During this process, both indicator lights will turn off first and then the blue indicator light would turn to slow flashing.

Note: The earbuds would shut down for power saving when not connected to the Bluetooth device for 5 minutes.

Charging the Charging Box

Connect the Charging Box to a powered USB port using the USB Type-C cable.

Note: It takes about 2 hours to fully charge the charging box and the earbuds.

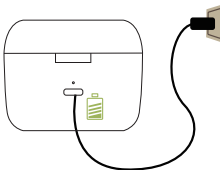

Charging the Earbuds

Place the earbuds inside the Charging Box. The magnet parts inside would adjust the earbuds to a fit condition.

Note: It takes about 2 hours to fully charge the earbuds.

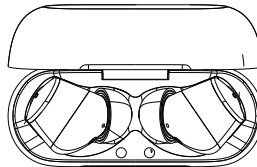

Wireless Charging

Place the charging box on the center of the wireless charger (not provided) as shown in the illustration.

Note: It takes about 4 hours to fully charge the earbuds and the charging box.

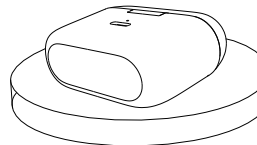

Charging Indicator Status

Item	Status	Indicator
Earbuds	Charging	Blue indicator light on
	Fully-charged	Blue indicator light off
Charging Box	Charging	Red indicator light on
	Fully-charged	Green indicator light on
	Low Battery Level	Blue indicator light flashing every 5 seconds

How to use the Earbuds

	FUNCTION	ACTION
Left/Right Ear	Single Tap	Pause media / Play media
Left Ear	Double Tap	Answer call / hang up call / previous Track
Right Ear	Double Tap	Answer call / hang up call / next Track
Left/Right Ear	Triple Tap	Activate voice assistant
Left/Right Ear	Press 2s	Reject Call / switch between ANC on/APT on/ANC off
Left/Right Ear	Press 12s	Factory reset
Left/Right Ear	Quadruple Tap	When connected to the phone,Press 4 times to enter the gaming mode and another 4 times to exit.

Certification information

Common part:

This equipment complies with FCC radiation exposure limits set forth for an uncontrolled environment. This transmitter must not be co-located or operating in conjunction with any other antenna or transmitter.

U.S. FCC Part 15 Regulatory Information

This device complies with part 15 of the FCC Rules. Operation is subject to the following two conditions: (1) this device may not cause harmful interference, and (2) this device must accept any interference received, including interference that may cause undesired operation. Any Changes or modifications not expressly approved by the party responsible for compliance could void the user's authority to operate the equipment.

Note: This equipment has been tested and found to comply with the limits for a Class B digital device, pursuant to part 15 of the FCC Rules. These limits are designed to provide reasonable protection against harmful interference in a residential installation. This equipment generates, uses and can radiate radio frequency energy and, if not installed and used in accordance with the instructions, may cause harmful interference to radio communications. However, there is no guarantee that interference will not occur in a particular installation. If this equipment does cause harmful interference to radio or television reception, which can be determined by turning the equipment off and on, the user is encouraged to try to correct the interference by one or more of the following measures:
—Reorient or relocate the receiving antenna.
—Increase the separation between the equipment and receiver.
—Connect the equipment into an outlet on a circuit different from that to which the receiver is connected.
—Consult the dealer or an experienced radio/TV technician for help.

Canada Regulatory Information

This device complies with Innovation, Science, and Economic Development Canada license-exempt RSS standard(s). Operation is subject to the following two conditions:
(1) this device may not cause interference, and
(2)this device must accept any interference, including interference that may cause undesired operation of the device.

Le présent appareil est conforme aux CNR d'Innovation, Sciences et Développement économique Canada applicables aux appareils radio exempts de licence. L'exploitation est autorisée aux deux conditions suivantes :
(1) l'appareil ne doit pas produire de brouillage, et
(2) l'appareil doit accepter tout brouillage radioélectrique subi, même si le brouillage est susceptible d'en compromettre le fonctionnement.

The device is compliance with RF exposure guidelines, users can obtain Canadian information on RF exposure and compliance.

Le présent appa reil est conforme aux directives d'exposition RF, les utilisateurs peuvent acquérir les informations correspondantes sur l'exposition aux radiofréquences et sur la conformité de l'appareil.

EU Regulatory Information

Support Frequency Bands and Power:

BT/BLE 2402-2480 MHz<1dBm

The simplified EU declaration of conformity referred to in Article 10(9) shall be provided as follows:
Hereby, [Grandstream Networks, Inc.] declares that the radio equipment type [GUV3060] is in compliance with Directive 2014/53/EU.
The full text of the EU declaration of conformity is available at the following internet address: www.grandstream.com

Grandstream Networks, Inc.

126 Brookline Ave, 3rd Floor

Boston, MA 02215 USA

Voice: (617) 566-9300

Fax: (617) 249-1987

www.grandstream.com

IC: 11964A-GUV3060

FCC ID: YZZGUV3060



For Certification, Warranty and RMA information, please visit

www.grandstream.com