



**iTrip** Auto  
Universal

Broadcast from your  
portable audio player  
to your car stereo

**GRIFFIN**



IC ID: 6384A-7255TRIP  
FCC ID: PAV9501

Operation is subject to the following two conditions: (1) This device may not cause interference, and (2) this device must accept any interference, including interference that may cause undesired operation of the device.

iTrip Auto Universal is a trademark of Griffin Technology, Inc.  
This device complies with part 15 of the FCC Rules

© 2006 Griffin Technology  
www.griffintechnology.com  
Patent Pending - Made in China - Invented in Tennessee

**GRIFFIN**

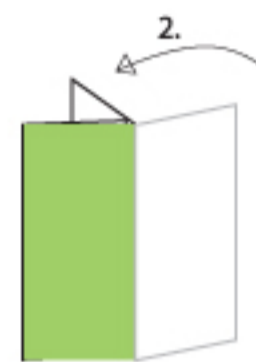
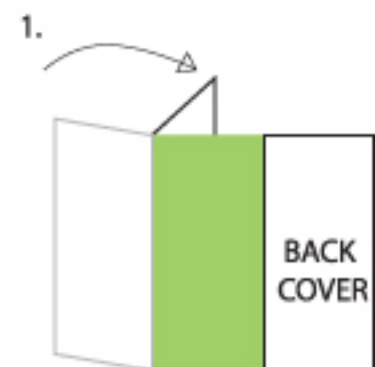

FRONT  
COVER

FRONT  
COVER

BACK  
COVER

**iTrip** Auto  
Universal

**GRIFFIN**

### Quick Start Guide

Thank you for purchasing Griffin iTrip Auto Universal. Now you can use your FM tuner to listen to your portable audio player through your stereo speakers. We call it iTrip Auto because it gets its power from the standard automobile 12V accessory port; and "Universal" because it works with any portable device with a standard 1/8" (3.5mm) headphone port.

iTrip works by transmitting the music wirelessly to your FM receiver. The controls are easy to use, and setup is a breeze:

#### Getting Started

1. Select an FM frequency on your stereo receiver at which you hear nothing but silence or static, with no music or talking in the background. The ideal choice would be a silent frequency with nothing playing on any neighboring frequencies.
2. Plug iTrip's "cigarette lighter" plug into your 12 Volt power outlet. Set your portable player's volume about halfway up, and begin playing some music. Plug iTrip's audio plug into your portable player's headphone jack. iTrip will power up and begin transmitting.
3. Press iTrip's + and - buttons so that the frequency in iTrip's display matches the one you chose on your FM receiver, then press iTrip's Select button once to lock in the setting. You should now hear your portable player on your car stereo.

#### Changing the Frequency

Near large cities, where there are lots of radio stations crowding the dial, you may need to switch your iTrip to a different frequency for a clearer signal. Choose an empty frequency on your FM receiver, and change your iTrip's broadcast frequency to match it, by pressing iTrip's + and - buttons. When the frequency shown on iTrip's display matches the frequency shown on your receiver, press iTrip's Select button to lock it in.

#### Choosing Stereo or Mono Mode for Best Sound

iTrip lets you play audio in either stereo (LX) or monaural (DX) mode. Some audio sounds almost identical in either stereo or mono. Since mono, or DX, mode produces a stronger signal, you may want to switch to DX mode for these.

To switch between modes, press and hold iTrip's Select button for 3 seconds. The current mode indicator (LX or DX) will flash in iTrip's display. Press the + or - buttons to switch to the desired mode, then press the Select button one more time to confirm the change.

NOTE: THE MANUFACTURER IS NOT RESPONSIBLE FOR ANY RADIO OR TV INTERFERENCE CAUSED BY UNAUTHORIZED MODIFICATIONS TO THIS EQUIPMENT. SUCH MODIFICATIONS COULD VOID THE USER'S AUTHORITY TO OPERATE THE EQUIPMENT.

#### Automatic Shutoff

iTrip features an automatic shutoff function: after 50 seconds of silence, iTrip will turn itself off. If the volume on your portable player is too low, iTrip may interpret this weak signal as silence, and shut itself off. To turn iTrip back on, turn up your audio player's volume a little bit and play some music, or disconnect and reconnect iTrip to the power port.

#### Technical Specifications

**Dimensions:**  
h=12.5mm w=26mm l=72mm, total length = 85cm

**Weight:** 0.6 oz.

**Antenna:** Built-in

**Power:**  
Provided by 12 Volt cigarette lighter/power outlet  
(no batteries required)

**Modulation:** FM Stereo

**Frequencies:**  
87.9-107.9MHz in 0.1 MHz increments

**Oscillator:**  
High stability crystal, phase-lock loop control

**Frequency response:** 50Hz to 15KHz

**Operating range:** 10-30 ft

**FCC compliance:** PAV9501

Visit Griffin's online support:  
<http://www.griffintechnology.com/support/>

INSIDE  
BOTTOM