

## Follow Mode (APP operation)

There are two modes: **Lock Mode & Follow Mode**

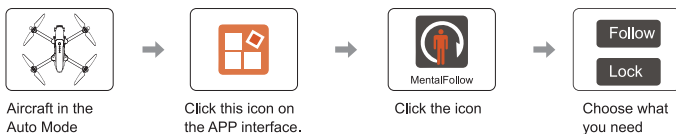

**Lock Mode:** aircraft position unchanged, heading lock the target to be followed.

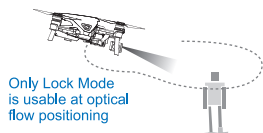

**Follow Mode:** aircraft position & heading lock the target to be followed.

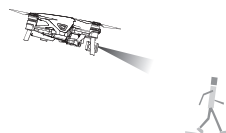

Attention:

In the Follow mode, the aircraft is kept at a constant altitude, care must be taken to the flight surrounding and assure you or others of personal and property security.

## Gesture Shot (APP operation)

Please follow these steps to use the **Gesture Shot** function.

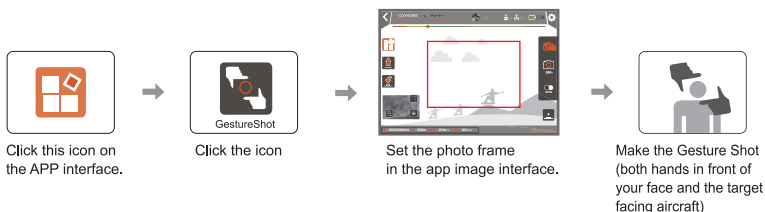

Attention: Gesture Shot is valid only in the shot mode. The UAV should be 2m away to recognize you.

## Aerial Mode (APP operation)

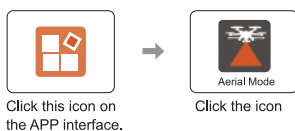

## Circle Flight (APP operation)

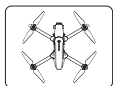

Aircraft in the Auto Mode

Click the icon on the APP map interface, the aircraft enters the circle flight mode.

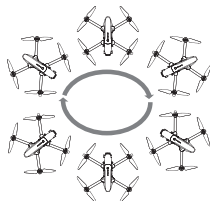

Attention:

- 1) The aircraft is at a quiescent state when it enters auto-circling, the circling function can only work after you set circle speed and direction by **toggleing aileron stick left or right** (-5m/s to +5m/s speed changeable, 0m/s at default).
- 2) **Dial elevator stick up or down** to change circle radius (5-50m radius changeable, 5m at default)

Dial to the left  
Clockwise circles



Dial to the right,  
Counterclockwise circles.

Speed: the larger volatility toggling and longer holding time, the faster circling. The slower on the contrary.

Dial up, Circle radius turns small



Dial down, Circle radius turns large

## Waypoint Flight (APP map interface operation)

Click the icon  to enter the Waypoint Flight interface.

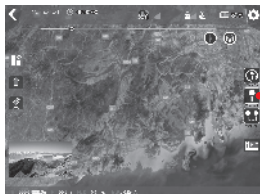

-  Add
-  Start
-  Exit

## Waypoints (APP map interface operation)

Click the icon  to enter the Waypoints Flight interface.



-  Add
-  Clear
-  Start
-  Exit

## Photo & Video ( remote controller or APP operation)

### Remote Controller Operation:

Take photo by short pressing the button of Remote Controller

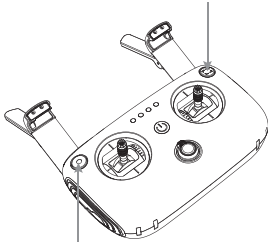

Video by short pressing the button of Remote Controller

### APP Operation:

- 1) Choose working mode: photo or video
- 2) Touch the Photo or video icon to take photo or video

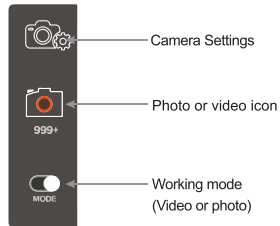

## Gimbal Control (APP operating)

The integrated gimbal provides camera with a stable platform, making the camera capable of obtaining stable pictures even under the condition of aircraft flying at a high speed.

You can use the APP software to control the gimbal pitching.



Angle of Pitch

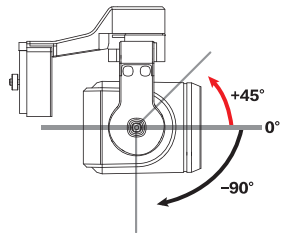

Slide upward or downward on the APP image interface.

## 13.0 End flight

- ① Manual landing or return to home function landing.
- ② Power off the aircraft, then turn off remote controller.
- ③ Finally, remove the battery from the aircraft.

## 14.0 Additional Instruction

### 14.1 Compass Calibration

**⚠ Attention:**

- Calibrate compass when circle flight or skewing occurs during flight (motor locked, light red LED remains on).
- Please conduct calibration in an open outdoor area away from electromagnetic interference.

The compass calibration steps are as follows:

- ① Place right/left sticks at lowest location, toggle them inward and keep for 5 seconds the aircraft Left red LED light extinguishes, Right red LED light flashes.

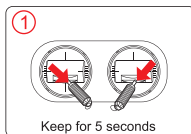

- ② Horizontal 360° rotation of aircraft until left red LED light steady on, right red LED light flashes.

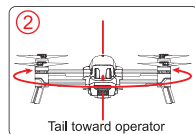

- ③ Vertical 360° rotation of aircraft (heading down) until right/left red light ready on, indicating successful calibration, and place aircraft at a horizontal location. In case of failure to calibrate, please follow above procedure to repeat calibration.

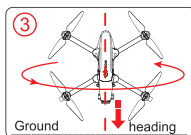

### 14.2 Brushless ESC and Brushless Motor connection diagram

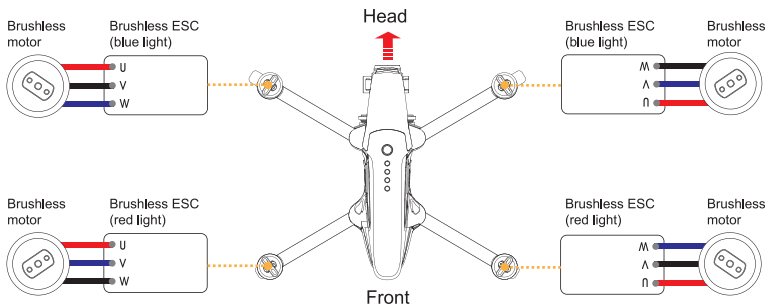

**⚠ Attention:**

- The red, blue and black wires of the brushless motors must be soldering to the brushless ESC according to the illustration.

### 14.3 Stick Mode Switch, Stick Calibration & Fixed ID



Tip:

- Factory setting of DEVO F8S stick mode & stick calibration has been determined; please refer to the following operation method for switching and calibration.
- Be sure to switch off the aircraft power or lock motor before operation.

#### Stick Mode Switch:

<b>Enter stick Mode switch</b>	1. Left stick at the lowest position  + Long  press 3~5 sec.....> When beeps, enter the stick mode switch
	2. Release left stick (back middle)  + Short press .....> Choose MODE 1, MODE 2, MODE 3, MODE 4
<b>Exit stick Mode switch</b>	1. Left stick at the highest position  + Long  press 3~5 sec.....> When beeps, confirm and exit the stick mode switch.

MODE 2 & MODE 4 are left-hand throttle

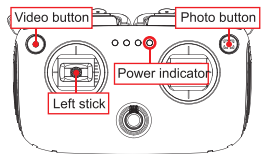
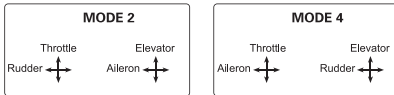

MODE 1 & MODE 3 are right-hand throttle

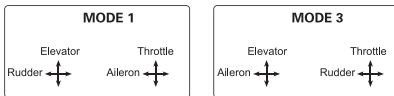

Indicators react according to the stick mode

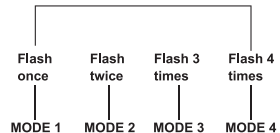

※ Customization also supported in Walkera Drone APP.

#### Stick Calibration:

Long press " " for 3~5 sec, you will hear a beep. Enter stick calibration, repeatedly move sticks from minimum to maximum mechanical range for several times, and then back to the middle.  
 Long press " " for 3~5 sec, when beeps, confirm and exit the stick calibration.



Attention:

- Beeping when you exit, indicating calibration fails, please recalibrate.

#### Customized Fixed ID of DEVO F8S:

Long press " " for 3~5 sec., when beeps, Fixed ID is set.  
 Short press " " , when beeps, Fixed ID is cleared.

## 15.0 Instruction of Intelligent flight battery Safety



Attention:

- Intelligent flight battery must be placed at a well-ventilated place.
- Improper use, charging or storage of battery may lead to fire accident, property loss or personal injury. The following safety guideline for use of battery must be followed.

### 15.1 Use of Battery

- 1) Battery is prevented from contacting with any liquid, and battery being moisturized or immersed into water is also inhibited. Never use it in rain or a wet condition. When internally contacting with water, battery may decompose, auto-ignite or explode.
- 2) Only batteries supplied by Walkera can be used. In case of replacement, please go to Walkera official website for the purchase information. Walkera will not be responsible for any flight failure or other accidents, which are resulted from use of other batteries than supplied by Walkera.
- 3) Use of any bulged, leaked batteries or those with damaged package is inhibited. In case of any happening, contact Walkera or one of its authorized dealers for professional treatment.
- 4) Please switch power off before batteries are inserted into or removed from the aircraft. Never insert or remove batteries when their power are switched on, otherwise power port may be damaged.
- 5) Its working temperature between  $-10^{\circ}\text{C}$ ~ $40^{\circ}\text{C}$  must be kept; excessive high temperature (above  $50^{\circ}\text{C}$ ) may cause fire or explosion, while excessive low temperature (under  $-10^{\circ}\text{C}$ ) may shorten its service life.
- 6) Never use battery in an electrostatic or magnetic field, otherwise battery pack may malfunction and lead to severe aircraft failure.
- 7) It is not permitted to decompose by any means or puncture battery using any sharp object, otherwise fire accident or explosion may be caused.
- 8) Be sure to keep away from any battery where leaks the highly corrosive liquid. Please use clear water to rinse skin or eyes contacting with corrosive liquid for at least 15 minutes, and seek for medical service when necessary.
- 9) The battery which has been fallen off from aircraft or impacted by external force must be not reused.
- 10) When any battery drops into water by accident during aircraft flying or in other situation, battery must be immediately removed and placed in an open field, operator shall keep away from battery until it is aired dry. However, those air-dry batteries cannot be reused, and must be disposed of properly.
- 11) Never place battery into a microwave oven or pressure cooker.
- 12) Never place battery cell onto any conductor surface.
- 13) Never short circuit battery using a wire or other metal object.
- 14) Never hit against battery, and never place any heavy object onto battery or its charger.
- 15) Use a dry cloth to remove any dirt on battery connector, otherwise any improper contact may result in loss of energy or charging failure.

### 15.2 Battery Maintenance

- 1) Never overcharge battery, otherwise battery cell may be damaged.
- 2) Never use charger in an excessive high or low temperature.
- 3) Keeping battery idle for a long time may undermine its performance.

## 16.0 In the Box / List of Articles

Check all the following items in your package. If any of them is missing, please contact walkera or your local dealer.

Aircraft Body x1



Remote Controller x1



Propellers (Pair) x2

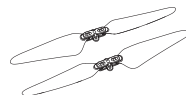

Aircraft Battery x1



Charger x1

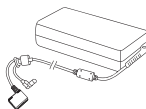

Power Cable x1

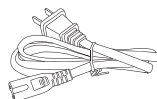

Micro-USB Cable x1

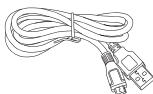

Stand cushion A/B x2



Tool Kit x1

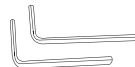

Manuals x2

- «QUICK START GUIDE»
- «In the Box / List of Articles»





Manufacturer: Guangzhou Walkera Technology Co.,Ltd.

Add: No.48 Wantai Rd, Taishi Industrial Park, Dongchong Town,  
Nansha Dist, Guangzhou, China.511453

Hotline: 400-931-8878

User manual is subject to change  
without prior notice.  
Please go to Walkera official website  
to get the latest version.





## **FCC WARNING**

This device complies with Part 15 of the FCC Rules. Operation is subject to the following two conditions:

- (1) This device may not cause harmful interference, and
- (2) this device must accept any interference received, including interference that may cause undesired operation.

NOTE 1: This equipment has been tested and found to comply with the limits for a Class B digital device, pursuant to part 15 of the FCC Rules. These limits are designed to provide reasonable protection against harmful interference in a residential installation. This equipment generates, uses and can radiate radio frequency energy and, if not installed and used in accordance with the instructions, may cause harmful interference to radio communications. However, there is no guarantee that interference will not occur in a particular installation. If this equipment does cause harmful interference to radio or television reception, which can be determined by turning the equipment off and on, the user is encouraged to try to correct the interference by one or more of the following measures:

- Reorient or relocate the receiving antenna.
- Increase the separation between the equipment and receiver.
- Connect the equipment into an outlet on a circuit different from that to which the receiver is connected.
- Consult the dealer or an experienced radio/TV technician for help.

NOTE 2: Any changes or modifications to this unit not expressly approved by the party responsible for compliance could void the user's authority to operate the equipment.

The distance between user and products should be no less than 20cm