



Model no. : FX7121

Quick Start Guide

X7 – Portable High Resolution Music Player

Before First Use

A. Charge the X7

Recommended USB power adapter specifications:

DC 5V, 2A or above; full charge takes approx. 4 hours.

B. Storage (micro SD card)

1. Recommend using genuine (Sandisk, Kingston, etc.) micro SD cards of Class 10 speed or above
2. Maximum supported size: 128GB
3. Recommend inserting into X7 and formatting the micro SD card using the X7
4. Inserting / Removing Micro SD card:
 - a) Press card gently into slot to secure the card (as shown);
 - b) Press card gently into slot again to remove card.

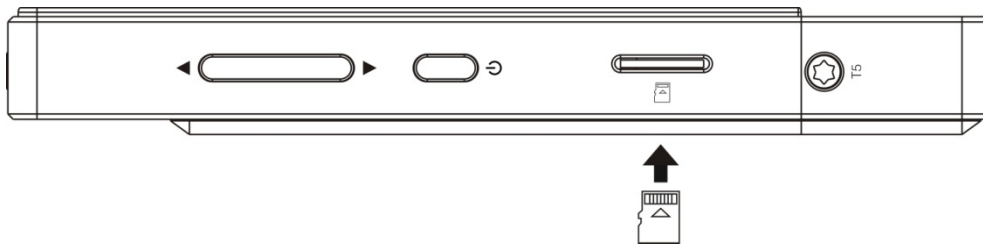

C. Buttons and Ports labelled / Operation explained

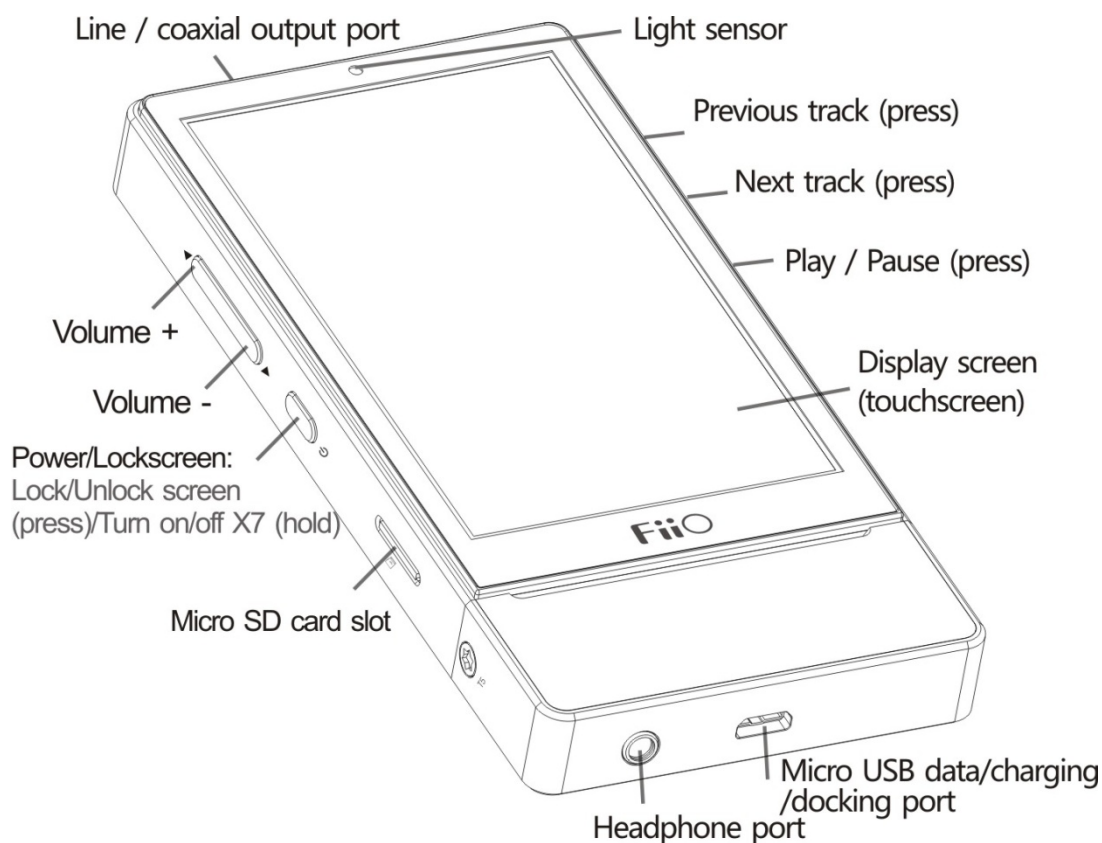

Power on: Hold  button for 2s to turn on X7 with startup animation onscreen; on first startup, language selection screen shows; click the preferred language onscreen and then the confirm button on upper right to enter main UI.

Data transfer: 1. Set "USB mode" to "Storage" in settings; 2. Connect the X7 to the computer using the supplied Micro USB cable, the X7 shows "USB connected" in the status bar; 3. Click on "Turn on USB storage" at the bottom to mount the micro SD card in the X7 as USB Mass Storage to copy files from the PC to the X7.

Button mapping: Volume +/- and prev/next track button positions

Changing amp modules: (although the X7 is protected, it is still advised to change only when X7 is powered off)

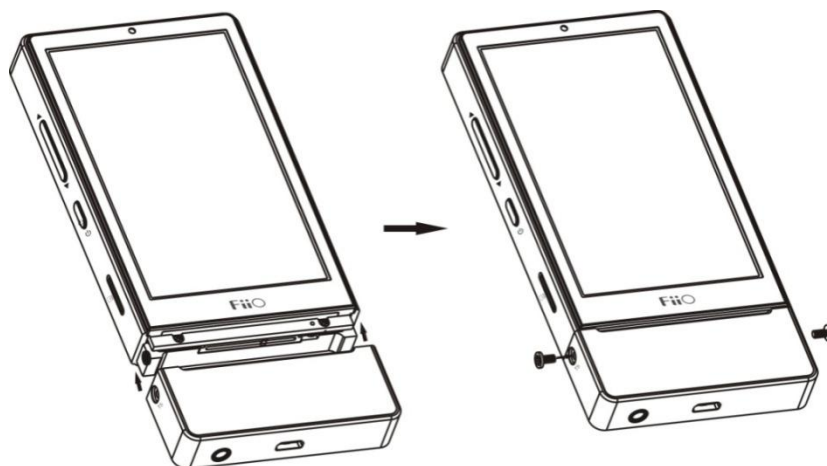

Align corners and insert / remove

Tighten / remove T5 screws

Wi-Fi and Bluetooth: Press “  ” on the menu, then you can see the Wi-Fi and Bluetooth button. Press “Wi-Fi” button, we can search and connect the Network around. And in Bluetooth button, we can search and connect another Bluetooth device to transmitter file or amplifier audio single.

D. Pure Music / Android Mode switch

1. While in Android Mode, pull down the status menu from the right and click on the "Pure Music Mode" icon; **the icon will change to "Pure Music Mode"** and the player will enter Pure Music Mode when you reboot the X7, allowing uninterrupted music enjoyment with the built in music app.

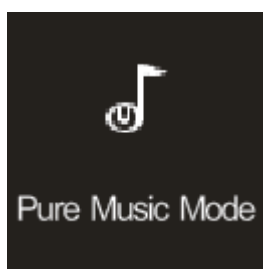

2. While in Pure Music Mode, pull down the status menu from the right and click on the "Android Mode" icon; **the icon will change to "Android Mode"** and the player will enter Android Mode when you reboot the X7, allowing a rich music experience with 3rd party Android app compatibility.

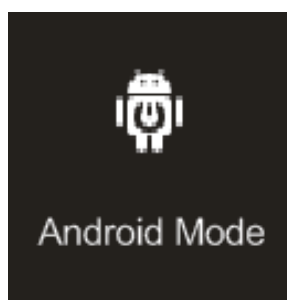

E. Firmware upgrade

Firmware upgrades may enhance functionality of the player but improper operation while upgrading may render the player unusable! Please read the following instructions carefully to upgrade the firmware:

1. Ensure that the X7 is adequately (preferably fully) charged before attempting to upgrade.
2. Copy the update file "X7 update.zip" provided by FiiO into the root directory of a FAT32-formatted micro SD card in the X7 (or root directory of the X7's internal storage)
3. With the SD card in the X7, turn on the X7 in Android mode and select "Support"->Upgrade->external_SD (or internal_SD if you put the file in internal storage) and select X7 update.zip.

The following dialog appears:

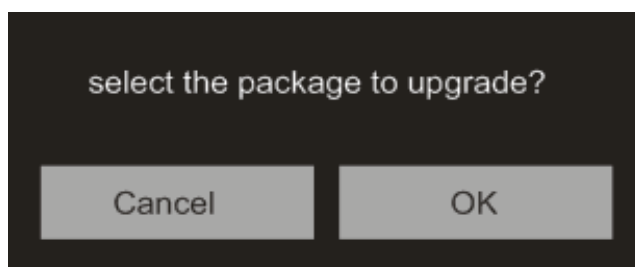

After clicking "OK", wait patiently and do not operate the X7. The X7 will automatically restart and enter firmware update mode.

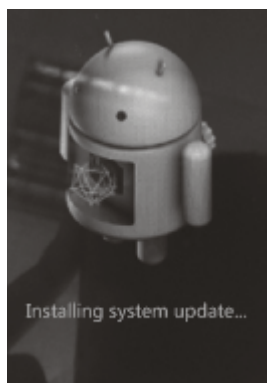

Firmware update screen

After the firmware upgrade is complete, the X7 will restart again in normal android mode for use.

Notes and precautions:

- 1.If attempting upgrade using SD card, the SD card should be formatted in FAT32; if upgrade fails, try using a card of 32GB capacity or under, format it using the X7 (back up data on the card first), copy X7 update.zip inside again and attempt upgrade again.
- 2.If attempting upgrade using internal memory, there needs to be adequate free space (preferably over 1GB); copy X7 update.zip to the internal storage and select "internal_SD" for the upgrade.
- 3.Do not push the X7's buttons while the upgrade is in progress.

F. Notes and Precautions

- ★The X7 will automatically skip songs that it cannot play; please refer to product package / full manual regarding supported formats.
- ★Recommended USB power adapter spec is 5V 2A. Out-of-spec USB charger with voltage over 5V may damage the X7 (charging current higher than 2A is OK).
- ★In the unlikely event that the X7 hangs up, you may hold the power button for 10 seconds to force a shutdown.
- ★Supplied USB cable (or quality aftermarket cable) is recommended for USB DAC use; when connecting to a desktop computer, using a USB port at the back is recommended.
- ★On first use, the X7 music app will prompt for scanning connected storage for music.
- ★To preserve system stability under the open Android architecture, FiiO maintains a whitelist of apps approved for use with the X7. In Android mode, we recommend that you click on the "Apps whitelist" icon to select and install 3rd party apps for which we have rigorously tested compatibility with the X7.
- ★The amplifier modules require different machining times and techniques and hence some color variation from the main body is normal.

★Note:

This device complies with part 15 of the FCC Rules. Operation is subject to the following two conditions: (1) This device may not cause harmful interference, and (2) this device must accept any interference received, including interference that may cause undesired operation.

Note: This equipment has been tested and found to comply with the limits for a Class B digital device, pursuant to Part 15 of the FCC Rules.

These limits are designed to provide reasonable protection against harmful interference in a residential installation. This equipment generates uses and can radiate radio frequency energy and, if not installed and used in accordance with the instructions, may cause harmful interference to radio communications.

However, there is no guarantee that interference will not occur in a particular installation. If this equipment does cause harmful interference to radio or television reception, which can be determined by turning the equipment off and on, the user is encouraged to try to correct the interference by one or more of the following measures:

Reorient or relocate the receiving antenna.

Increase the separation between the equipment and receiver.

Connect the equipment into an outlet on a circuit different from that to which the receiver is connected.

Consult the dealer or an experienced radio/TV technician for help.

Warning: Changes or modifications to this unit not expressly approved by the part responsible for compliance could void the user's authority to operate the equipment.

FCC Radiation Exposure Statement

The device has been evaluated to meet general RF exposure requirement. The device can be used in portable exposure condition without restriction.