

User's Manual  
G1 True Wireless Sports Headphones

HAKII

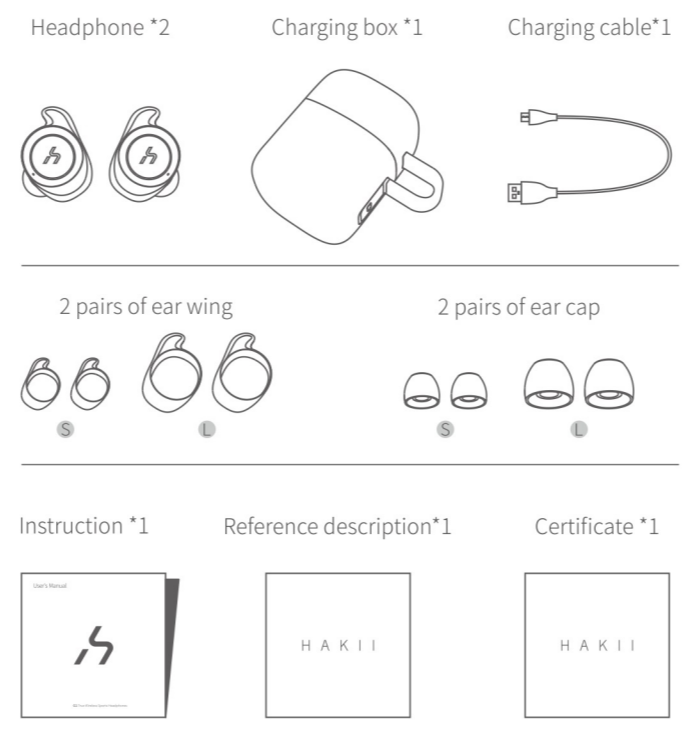

### Accessories list



### The product structure (with figures)

- 1.Multi-function button (MFB)
- 2.Microphone
- 3.LED indicator lamp
- 4.Charging box
- 5.USB charging port
- 6.Storage bag

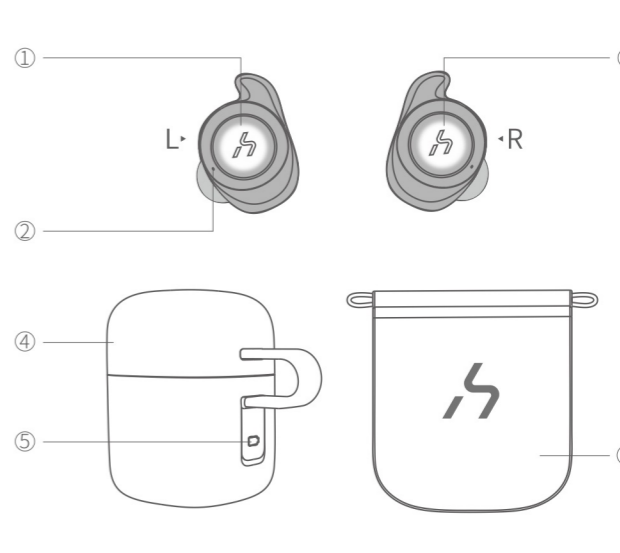

### Wear method

1.Choose the suitable ear caps and wings.

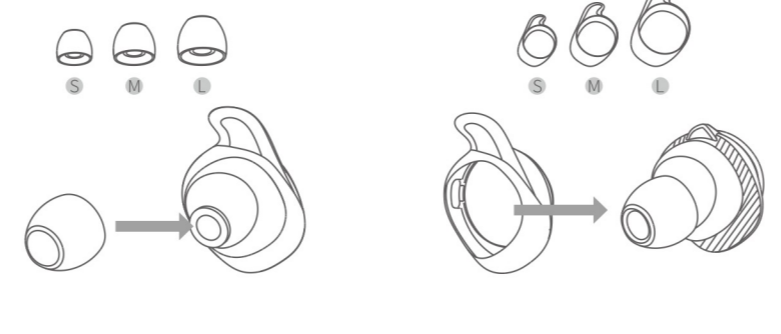

2.Plug

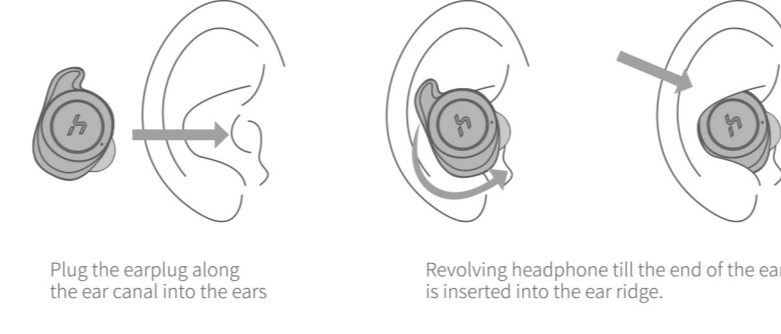

### Binaural mode

Boot Method 1:

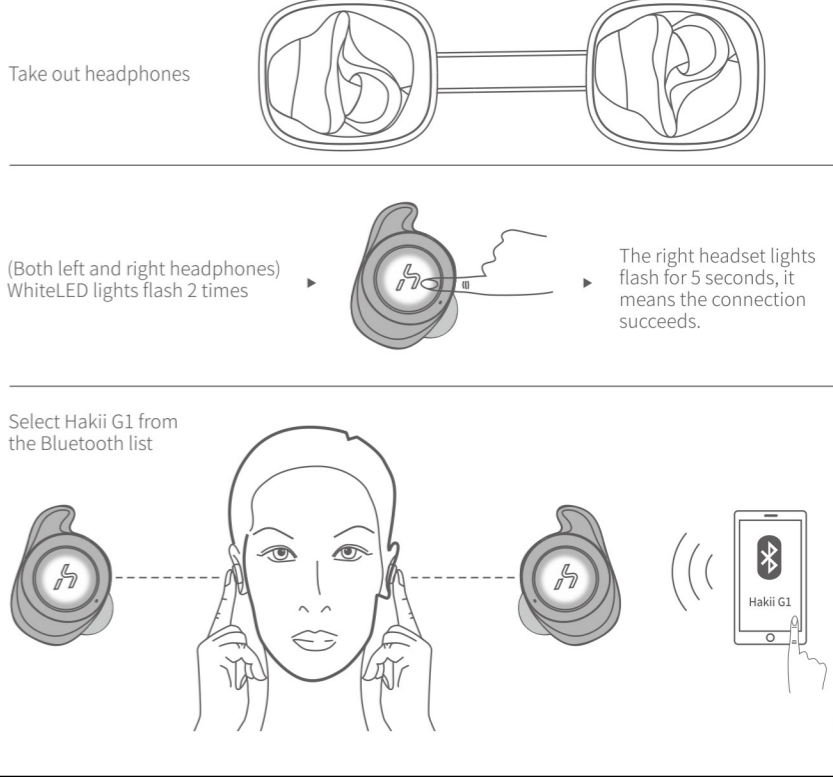

Boot Method 2:

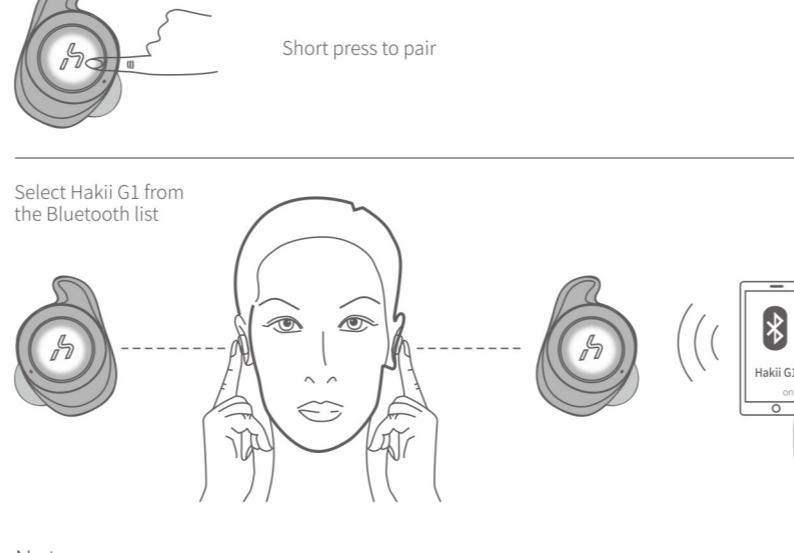

3.If the headphone does not reconnect after disconnection, then the headphone will turn off automatically after 3 minutes.  
4.If the search device name is "G1 Mono", it shows that there is no successful link between the left and right headset. Please restart the headphones according to the boot method.

### Power off

Method 1:

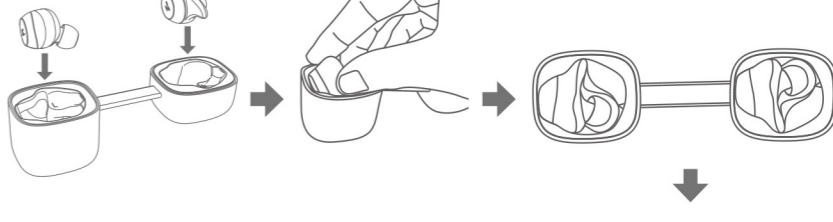

Method 2: Long press headphone for 5 seconds



Notes:  
1.The maximum duration of the pairing mode is 180 seconds. LED of the right headphone keeps flashing. If you miss this period, LED of both headphones flicker 3 times and go out. If needing to reconnect, please repeat the procedural steps mentioned above.  
2.The headphone and mobile phone acquiesce to the last pairing automatically (Mobile Bluetooth is in ON). The headphone TWS connects within 4S, and the connection time between headphone and mobile phone is about 8s.



### Icons

1.Just press the left / right headset (only use the right headset for communication).



Note:  
Because part of the mobile phone receives calls by default through the phone receiver, Please set up the telephone answering equipment according to the headset instructions.

2.The phone is on the phone, the other call enters:  
A.Click the left / right headset to keep the current phone call and answer the call;  
B.Press the left / right headset button for 1 second, refusing to answer the call;  
C.In three party calls, two phone calls can be switched by pressing the left / right headset button for 1 second.  
D.One phone answers, the other keeps in a phone call.  
a.Press the left / right headset button for 1 second to keep the current call and connect the kept call;  
b.Press the button of the left / right headset, hang up the current call, and connect the kept call.



### Reject a call

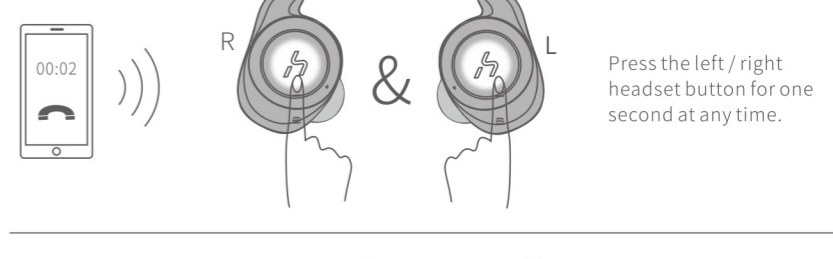

### Play / pause at any time (L, R icons)

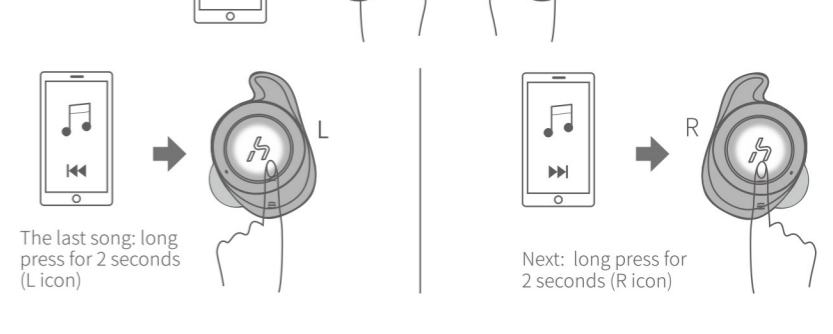

One key Siri  
Arbitrarily double click to activate / shut off Siri (only applicable to the IOS system) (L, R icons).



### Charging box charging

When the charging box is less than 10%, the charging box white LED will flash three times to indicate low power.

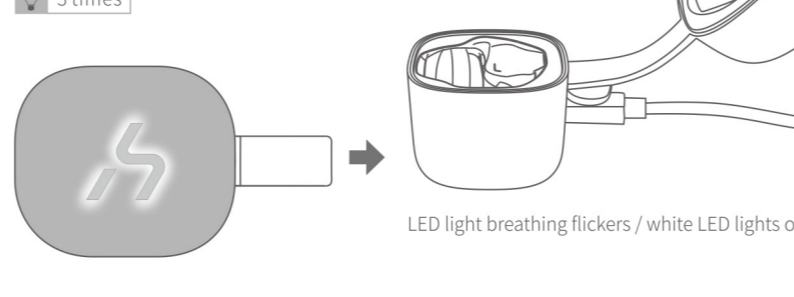

### Headphone charging

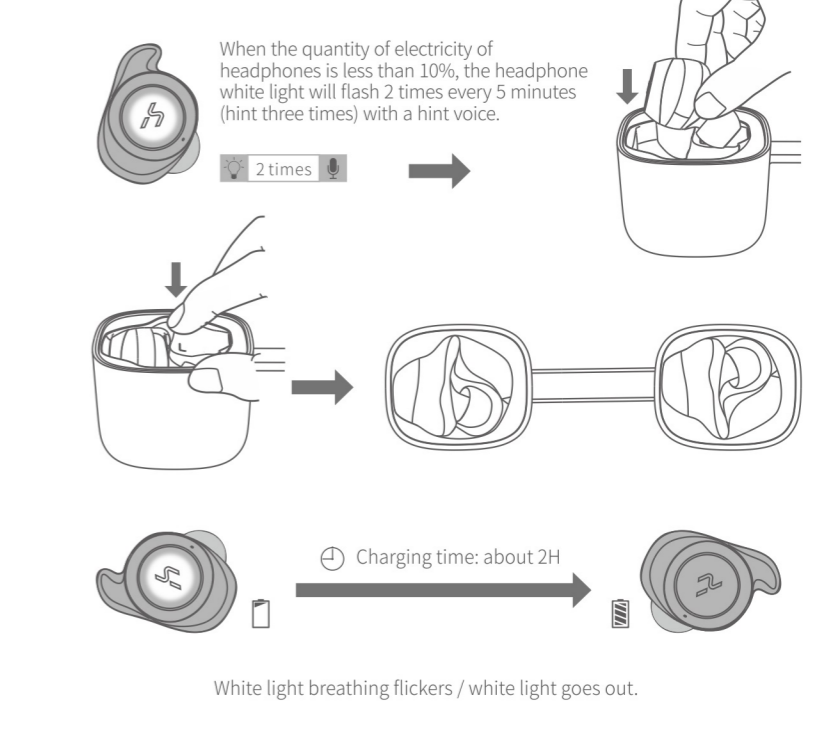

### Single channel mode (take out any headset as a single side Bluetooth headset)

(Note: Single channel mode only needs to remove any headphone from the charging box. If used as a single headphone, two headsets have been removed before being connected. The headphones will be used as TWS mode by default and automatically realize TWS connection.)  
1.Turn on the headset, the headset will automatically enter the Bluetooth pairing state, the white light flashes once every 0.5 seconds.  
2.Turn on the mobile Bluetooth function to search the device. When the device name is "G1 Mono", click "G1 Mono" to pair. Then the white indicator light will shine for 5 seconds, that is, the Bluetooth pairing is successful.  
3.For more functional operations, please refer to the TWS mode.

### Specification parameters

Bluetooth version: V5.0	Loudspeaker frequency: 20Hz to 20KHz
Charge box size: 38*60*60mm	Input voltage / current: DC 5V/1A
Headphone size: 22*28*29mm*2	Headphone battery: 60mAh*2 (full of electricity in 1.5H)
Product weight: 6g*2 (earphone) / 59g (charging box)	Charge box battery: 720mAh
Wireless connection distance: 10M (barrier free)	Playback time: 3.5H(50% volume)
Loudspeaker: 5.8MM, titanium film	Call time: 4.5H
Loudspeaker sensitivity: 95+ 3dB 1kHz/1mW	Standby time: 80H
Support protocols: HSP, HFP, A2DP, AVRCP, TWS, AAC	Charging time: about 2H
Impedance: 16 + 15% 1kHz	

### Charging and battery information:

- 1.This product has a built-in non-removable and rechargeable battery. Please use the equipped micro USB cable to charge the battery.
- 2.The charging current voltage is 5V/1A, and the product cannot be charged with a charger of more than 5V 1A.
- 3.Please charge full electricity before the first use. The follow-up charge will take about 1.5 hours each time. The charging box will take about 2 hours to fill up.
- 4.Do not use the charger that passes the regular manufacturer's safety certification.
- 5.Repeated charging on the headset will cause battery performance degradation over time, which is a normal phenomenon for all rechargeable batteries.



### Warning:

- 1.Please follow the instructions in this manual.
- 2.Do not use a charger exceeding the rated current and voltage of the headset (5V/1A) to charge the headset, otherwise it will cause damage to the headset battery.
- 3.Please use and store this product in the ambient temperature environment.
- 4.Do not use this product near the heat source, such as a radiator, a hot air conditioner, a stove, or other instruments that produce heat.
- 5.Don't block the ports of the headset, such as charging indicator lights and microphone etc..
- 6.Please don't adjust the volume to the maximum level for a long time to avoid causing dizziness or damage to hearing.
- 7.No matter the product is damaged for any reason, it must be dealt with in time with the after-sale personnel of us. Any unauthorized demolition and modification will make the warranty invalid.

### FCC STATEMENT :

This device complies with Part 15 of the FCC Rules. Operation is subject to the following two conditions:  
(1) This device may not cause harmful interference, and  
(2) This device must accept any interference received, including interference that may cause undesired operation.  
Warning: Changes or modifications not expressly approved by the party responsible for compliance could void the user's authority to operate the equipment.

Increase the separation between the equipment and receiver.  
Connect the equipment into an outlet on a circuit different from that to which the receiver is connected.  
Consult the dealer or an experienced radio/TV technician for help.

### RF warning statement:

The device has been evaluated to meet general RF exposure requirement. The device can be used in portable exposure condition without restriction.

### NOTE:

This equipment has been tested and found to comply with the limits for a Class B digital device, pursuant to Part 15 of the FCC Rules. These limits are designed to provide reasonable protection against harmful interference in a residential installation. This equipment generates uses and can radiate radio frequency energy and, if not installed and used in accordance with the instructions, may cause harmful interference to radio communications. However, there is no guarantee that interference will not occur in a particular installation. If this equipment does cause harmful interference to radio or television reception, which can be determined by turning the equipment off and on, the user is encouraged to try to correct the interference by one or more of the following measures:  
Reorient or relocate the receiving antenna.