

havít

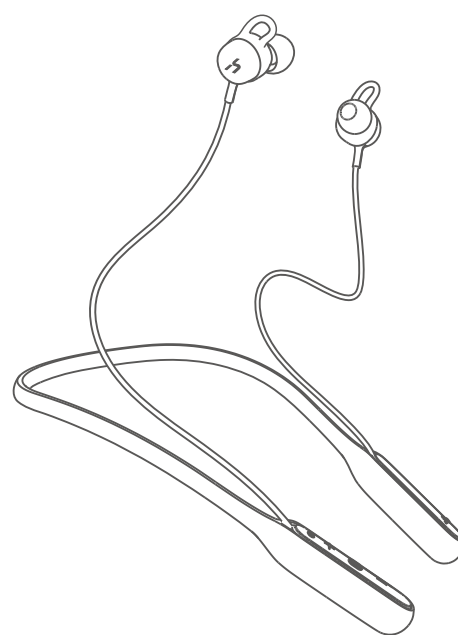

User's Manual
U2 Wireless Noise Cancelling headphones



WWW.HAVIT.HK

Thanks for choosing havít

Accessories list

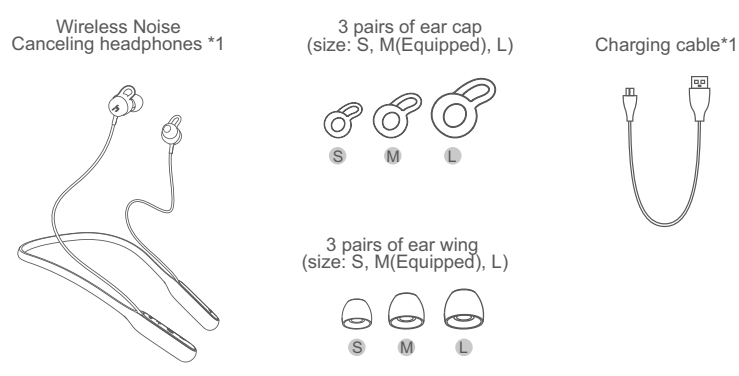

English

1

The product structure (with figures)

- 1.ANC button
- 2.Multi-function button (MFB)
- 3.LED indicator
- 4.VOLUME UP
- 5.VOLUME down
- 6.Microphone
- 7.USB charging port

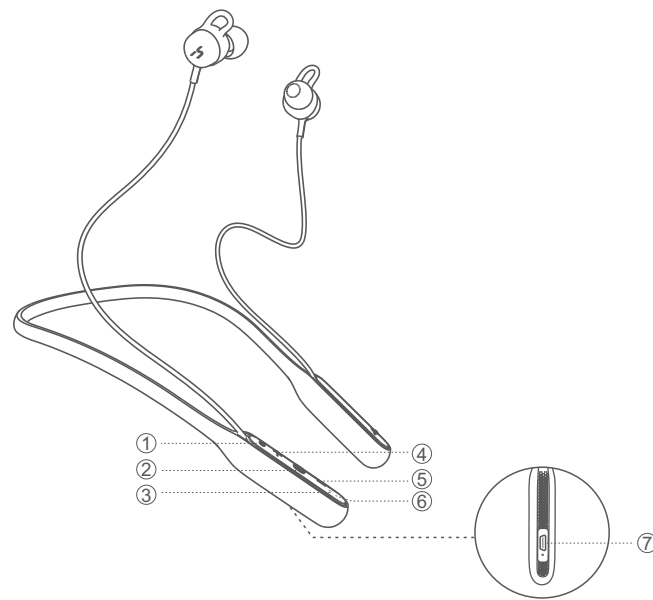

English

2

Wear method

1. Choose the correct tip

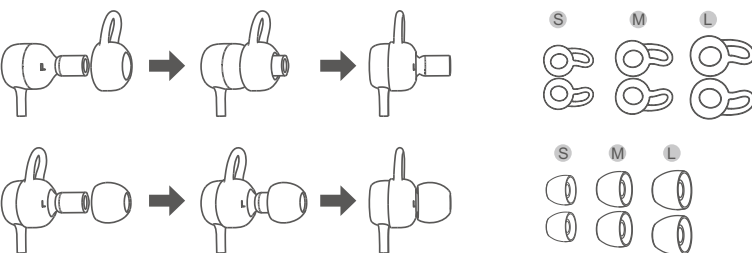

Select the size that gives you the best comfort and fit in each ear. To determine the best fit, you may need to try all three sizes.

2. Fit the earbuds to your ear

a. Wear the neckband correctly depends on an L or an R marked on each earbud.

b. Insert the earbud so the tip gently rests in the opening of the ear canal.

c. Tilt the earbud back and tuck the tip wing under the ear ridge until it is secure.

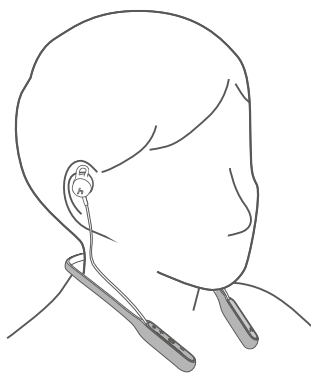

English

3

Bluetooth pairing

1. Press and hold MFB for two seconds until the LED indicator grows white and blinks with a voice prompt.

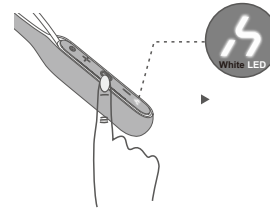

2. On your device, turn on the Bluetooth feature.

3. Select your headphones (Havit U2) from the device list. Once paired, you hear prompt and the indicator turns off in five seconds.

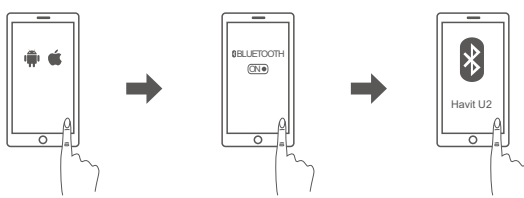

4. The maximum duration of the pairing mode is 180 seconds. If you miss this period, please repeat the procedural steps mentioned above.
5. The headphones and mobile phone acquiesce to the last pairing automatically (Mobile Bluetooth is in ON) without any operations.
6. If the headphones does not reconnect after disconnection, then the headphones will turn off automatically after 3 minutes.

English

4

Power off

Press and hold the Power/Bluetooth button until the LED indicator blinks three times and you hear the voice prompt.

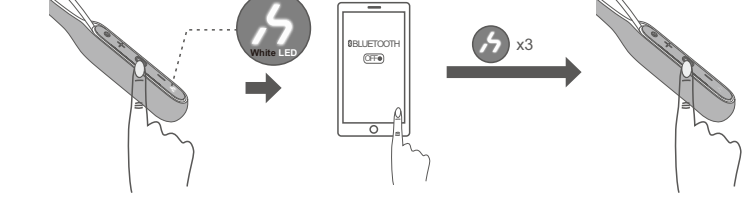

1. Answer a call

Press the MFB – Answer a call

Note: Some mobile phones answer calls through built-in speaker by default. Please reference the related documents to change the answering device.

2. Decline an incoming call

Press and hold MFB for two second – Decline and in coming call

English

5

3. Second incoming call

a. Press MFB once – Answer a second incoming call and put the current call on hold

b. Press and hold MFB for one second – Decline the current call and answer a second incoming call

c. With two active calls, press and hold MFB for one second – Switch between two calls

d. With two active calls, press MFB once - Decline the current call and stay on the second incoming call

Headphone playback function

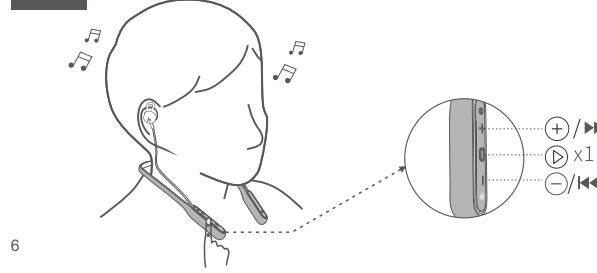

English

7

⏮ x1	Play/Pause	Press MFB once
+	Volume Up	Press +
-	Volume Down	Press -
⏭	Skip Forward/Backward	Press and hold +/-
☎	Call Siri / Access Voice Assistant	Press MFB twice
⏮ x2		

ANC Digital Noise Cancellation

- Press ANC button to turn on the noise cancellation (indicator grows blue), which reduces unwanted outside noise.
- Press ANC button again to turn off the noise cancellation.

Note: You can use noise cancellation while listening to audio, or you can use noise cancellation only. Noise cancellation just reduces unwanted outside noise, which cannot be totally isolated.

Charge the headphones

This product has a built-in non-removable and rechargeable battery. Please use the equipped micro USB cable to charge the battery. The charging current voltage is 5V, and the product cannot be recharged with a charger of more than 5V. Please charge full electricity before the first use. The follow-up charge will take about 2 hours each time. Please choose the charger that passes the regular manufacturer's safety certification. Repeated charging on the headphones will cause battery performance degradation over time, which is a normal phenomenon for all rechargeable batteries.

Warning:

Broad compatibility: Compatible with most smartphones on the market(Android/iOS system).
Please follow the instructions in this manual.
Do not use a charger exceeding the rated voltage of the headphones (5V) to charge the headphones, otherwise it will cause damage to the headphones battery.
Please use and store this product in the ambient temperature environment.
Do not use this product near the heat source, such as a radiator, a hot air conditioner, a stove, or other instruments that produce heat.
Don't block the ports of the headphones, such as charging indicator and microphone etc..
Please don't adjust the volume to the maximum level for a long time to avoid causing dizziness or damage to hearing.
No matter the product is damaged for any reason, it must be dealt with in time with the after-sale personnel of us. Any unauthorized demolition and modification will make the warranty invalid.

English

9

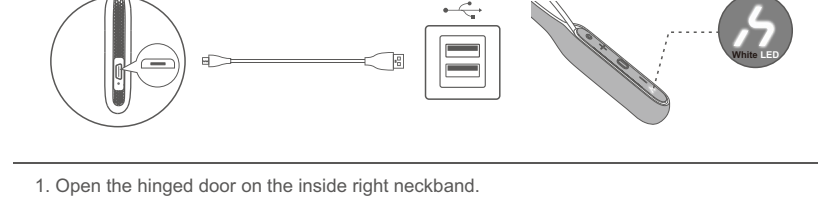

- Open the hinged door on the inside right neckband.
- Plug the small end of the USB cable into the charging port.
- Plug the other end of the USB cable into a wall charger or computer that is powered on. While charging, the indicator blinks white. When the battery is fully charged, the battery indicator will turn off.

Note: Before charging, be sure the headphones are at room temperature, between 50° F (10° C) – 104° F (40° C).

Specifications

Bluetooth version: v4.0	Impedance: 32Ω±15% 1kHz
Headphone size: 171mm*161mm*38mm	Loudspeaker frequency: 20Hz to 20KHz
Product weight: about 37g	Input voltage / current: DC 5V/200MA
Wireless connection distance: 10M (barrier free)	Playback time: 10H (70% volume)
Support protocols: HSP, HFP, A2DP, AVRCP	Charging time: about 2H

SPP aptX

English

8

FCC STATEMENT :

This device complies with Part 15 of the FCC Rules. Operation is subject to the following two conditions:
(1) This device may not cause harmful interference, and
(2) This device must accept any interference received, including interference that may cause undesired operation.
Warning: Changes or modifications not expressly approved by the party responsible for compliance could void the user's authority to operate the equipment.

NOTE:

This equipment has been tested and found to comply with the limits for a Class B digital device, pursuant to Part 15 of the FCC Rules. These limits are designed to provide reasonable protection against harmful interference in a residential installation. This equipment generates uses and can radiate radio frequency energy and, if no installed and used in accordance with the instructions, may cause harmful interference to radio communications. However, there is no guarantee that interference will not occur in a particular installation. If this equipment does cause harmful interference to radio or television reception, which can be determined by turning the equipment off and on, the user is encouraged to try to correct the interference by one or more of the following measures:
Reorient or relocate the receiving antenna.
Increase the separation between the equipment and receiver.
Connect the equipment into an outlet on a circuit different from that to which the receiver is connected.
Consult the dealer or an experienced radio/TV technician for help.

RF warning statement:

The device has been evaluated to meet general RF exposure requirement. The device can be used in portable exposure condition without restriction.

English

10