

Hardware description

1 Statement

Sincerely thanks for purchasing our products, pls contact us if any problem or requirement. This manual is for network video recorder. This user manual may contain incorrect place in technology, place not matching with product function or operation, or printing mistake.

We will update our user manual according to our updating in product, and will periodically improve or updating the product and programming. The updating content will add in the new user manual, we won't inform. If the product's description in user manual is inconsistent with the real products, pls based on the real products.

2 Safety cautions

1. Pls don't put a container with liquid on DVR (like Vase) .
2. DVR should put at a ventilation place, and prevent clogged the ventilation hole.
3. Check the power voltage, in case of damage by wrong voltage.
4. DVR should work at the technical standard range of temperature and humidity.
5. Place DVR on level, pls avoid installing at a sharp pounding place.
6. Moisture dust in PCB will cause short circuit, for long-term use of the DVR, you can periodically remove dust in PCB by brush.
7. It will cause burst if replace battery in wrong way, we don't suggest user to replace by himself; if need replace, only use the same type or equivalent type battery, pls don't try to open or maintain the battery.
8. DVR installation need according to specification, you can take the national or local standard as reference.

3 Open-package inspection

After receive product, pls open giftbox, remove NVR and put it on suitable place, check accessories. If any damage or lack, kindly pls contact to the distributor.

01

Network Video Recorder Quick installation guide



9 NVR, IPC parameter list

NVR parameter	
Operating System	Embedded linux OS
AV(audio/video)input	Network Video 4CH 8CH
AV(audio/video)output	Network video input broadband 20Mbps
	HDMI input 1ch, resolution: 1024x768, 1366x768, 1440x900,1920x1080p
AV CODEC Specification	VGA output 1ch, resolution: 1024x768, 1366x768, 1440x900,1920x1080p
	Video Resolution synch-playback 4CH 8CH
Video Control	Video Capture mode Manual、Time- Motion- Alarm
	Play/back mode Real time、Routine、Event
HDD	Backup USB backup
	Type 1*SATA interface
External Interface	Max Capacity 4 TB at most for each
	Network Interface 1 adaptable RJ45 10M/100M, 2 WIFI interface
USB interface 2 USB 2.0	
Network Control	Protocol UPnP (play&plug) 、SMTP (email service) 、 PPPoE (dial-up) 、 DHCP (Automatically obtain an IP address) , etc...
	Power Consumption(excluding HDD) ≤5W
Others	Working Temperature -10C ~+55 C
	Working Humidity 10%~90%
	Size 257*210*45mm
Weight (excluding HDD) ≤1Kg	

04

4 Installation diagram

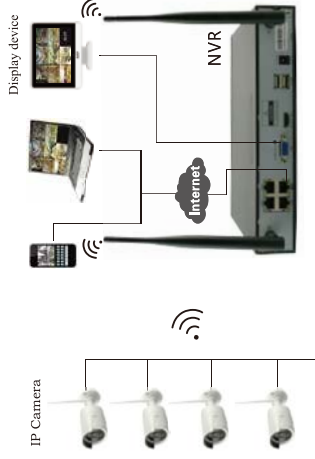

5 Antenna location

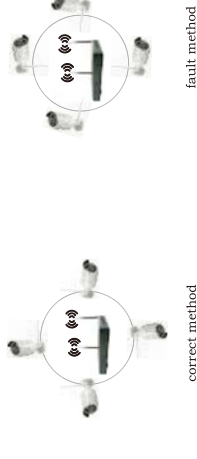

correct method

fault method

02

Software operation

1 Add camera by matching code

Steps: right click the blank of main interface -> click "System Setup" -> "Channel Setup". Click "quick adding", then Pop up "video manage". Two ways for Wireless NVR to add IPC, "Code Add" and "Auto Add". Adding camera by matching code, the camera transmits video images through wireless and NVR, IP is 172.20.14.X; Auto adding the camera, the camera transmits video images through the cable and NVR, IP is 172.25.123.X; Note: The camera has been matched by factory, no need to add other cameras. If you need to match one code, Firstly, take one network cable and connect to any NVR lan port and power on the device to make sure there is still have any channel can add one camera.

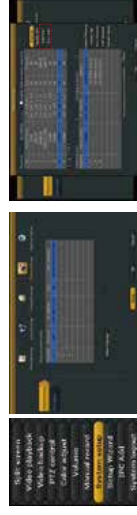

2 Video playback

Step: Right click mouse in main menu — Video playback — choose channel No. — choose record mode — in Search time, input beginning time and end time — click search, recording will come out. drag time bar — click playback to start
Tips: Playback icon introduction: playback 1 frame previous playback 1 frame next play pause fast forward x2, x4, x8

06

The signal coverage of Antenna is similar to a round circle. Antenna located in center of the round circle, signal of surrounding is much stronger, but much weaker if antenna endpoints backoff direction, according to the signal divergency characteristics of antenna, and in order to guarantee the video quality, IPC antenna should try to keep in parallel or tangent with NVR antenna.

6 HD Install Notice that the HDD had been used need supplier recommend, and need make sure already cut off the power.

Install Steps:

1. Remove the screw of the dvr
2. Connect the HDD cable and power line
3. Assemble the screw, and fix the HDD in the bottom of NVR
4. Close the cover and fix it



7 Rear Panel Description

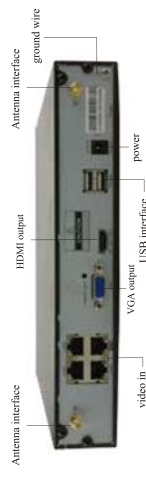

8 Turn on/off

Confirm that AC voltage accessible matches with DVR. Ensure that the DVR power outlet connect with a good middle ground grounding. After switching power, the device started, [POWER] light is on. Turn into system, if the panel status light flashing, it's normal conditions.

03

3 Video backup

Step: Right click mouse in main menu — Video backup — choose channel No. — choose record mode — in Search time, input beginning time and end time — click search, recording will come out — choose the video which need to backup — click video backup

Tips: Support 32G U disk backup max, recording will be packed every one hour



4 Video detection

Step 1: Right click mouse in main menu — System setup — Record setup — choose motion — choose all — click Copy to — click OK to save setting.

Step 2: Choose Video detection — set sensitivity as required — choose motion — set Alarm, Buzz or Email as required — click Copy to — click OK to save setting.



07

5 Generate Esee ID

Precondition to generate Esee ID is that make sure video recorder is connected with network and IP address is available. Right click mouse in main menu — System setup — Network setup

If user is familiar with LAN, then no need to choose DHCP which help to get IP address automatically. Manually input IP address and DNS address, video recorder will generate ID by network, once generate, it will appear in menu



If user is not familiar with LAN, or video recorder is in independent network, can choose DHCP to get available IP address

After video recorder get IP address, it will generate Esee ID automatically



6 Access in LAN

Step 1: Right click mouse in main menu — System setup — Network setup — check video recorder IP address

Step 2: Access by computer in same LAN; input video recorder IP address and port (if port is 80, no need to input) in IE browser or any other browser. Then it will access LAN log in webpage.

Step 3: Once access successfully, can get video

Tips: Please make sure video recorder and computer in same network segment

08

11 Esee mobile application(Eseenet) — Function introduction

Step 1: It will connect channel 1 video by default, click “+” to add more channel

Step 2: Click this icon to edit video recorder log in information

Step 3: Add device group

Step 4: Play/Pause Snapshot/Record

Step 5: File management and more settings

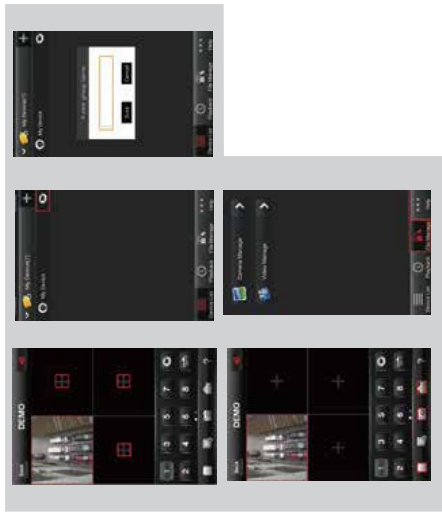

12



7 Access in WAN

Step 1: Right click mouse in main menu — System setup — Network setup — check video recorder IP address

Step 2: Access by computer in WAN; input www.e-seenet.com in IE browser or any other browser. Then it will access log in webpage; input ID, user name and password, click log in

Step 3: Once access successfully, can get video

Tips: Video quality and fluency depend on video recorder side upload speed and computer side download speed; each channel need above 30Kb



8 Android mobile application download and installation

Two ways to download

09

Packing list

S/N	Item	Quantity
1	NVR	1 pcs
2	Screw bag (4 screws for HDD)	1 pcs
3	USB mouse	1 pcs
4	1 meter network cable (for IPC code match)	1 pcs
5	DC 12V/3A power supply (for NVR)	1 pcs
6	NVR user manual - Installation Instruction	1 pcs
7	PE40 (0.5W) IP Camera	4/8 pcs
8	DC 12V/2A power supply (for IPC)	4/8 pcs
9	Screw bag (for IPC)	4/8 pcs

Notes:

1. Device will not in guarantee if caused by below reason:

- A. Accident negligence; disaster; mis-operation.
- B. Do not conform to the environment and conditions, such as power, improper, working temperature too high or too low, lightning stroke, etc.
- C. Ever be maintained by other center which not belong to the real factory.
- D. Goods already sold more than 12 months.

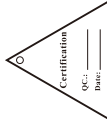

13

No. 1: Go to www.e-seenet.com in computer, click help — software download — find Android mobile application, click download to save in computer — copy to mobile to install

No. 2: Scan two-dimension code by mobile directly, enter download page, click download to mobile. If mobile do not support two-dimension scan, can input www.e-seenet.com/help/download.php in mobile browser, enter download page, click download to mobile

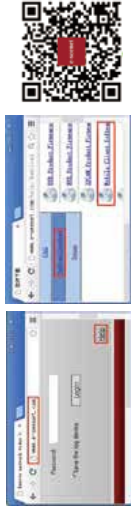

9 Iphone application download and installation

Step 1: Go to APP store

Step 2: Search EseeNet

Step 3: Input APP ID password

Step 4: Click download



10

FCC Statement

This equipment has been tested and found to comply with the limits for a Class B digital device, pursuant to part 15 of the FCC Rules. These limits are designed to provide reasonable protection against harmful interference in a residential installation. This equipment generates, uses and can radiate radio frequency energy and, if not installed and used in accordance with the instructions, may cause harmful interference to radio communications. However, there is no guarantee that interference will not occur in a particular installation. If this equipment does cause harmful interference to radio or television reception, which can be determined by turning the equipment off and on, the user is encouraged to try to correct the interference by one or more of the following measures:

- Reorient or relocate the receiving antenna.
- Increase the separation between the equipment and receiver.
- Connect the equipment into an outlet on a circuit different from that to which the receiver is connected.
- Consult the dealer or an experienced radio/TV technician for help.

FCC Radiation Exposure Statement

This device complies with FCC radiation exposure limits set forth for an uncontrolled environment and it also complies with Part 15 of the FCC RF Rules. This equipment must be installed and operated in accordance with provided instructions and the antenna(s) used for this transmitter must be installed to provide a separation distance of at least 20 cm from all persons and must not be co-located or operating in conjunction with any other antenna or transmitter. End-users and installers must be provided with antenna installation instructions and consider removing the no-co-location statement.

This device complies with Part 15 of the FCC Rules. Operation is subject to the following two conditions:

- (1) this device may not cause harmful interference, and
- (2) this device must accept any interference received, including interference that may cause undesired operation.

Caution!

Any changes or modifications not expressly approved by the party responsible for compliance could void the user's authority to operate the equipment.

14

10 Esee mobile application(Eseenet) -Add device

Step 1: Log in EseeNet application, click “+” icon

Step 2: Enter device edit page

Step 3: Input video recorder log in information

Step 4: Added successfully, it will show below page

Step 5: Click channel No. to get video



11



APP download scan here

15