

AUVIO

THE PERFORMANCE YOU NEED™

Portable Bluetooth® Speaker

Please read this user's guide before using your new speaker.

User's Guide 4000449



Package Contents

- Bluetooth Speaker
- USB Charging Cable
- User's Guide

Features

- Play your music wirelessly up to 30 feet (9.14m) away
- Make and receive hands-free calls
- Play a non-Bluetooth device through the speaker

Specifications

Battery Charge Time approx. 2 hours
Operation Time 6 hours
Frequency Response 150Hz - 15kHz
Output Power 1.5W
Impedance 4Ω
S/N ratio > 65dB
Battery charging voltage 5V
Driver 1.5 in. (38mm)
Bluetooth protocol V2.0+EDR

Specifications are subject to change and improvement without notice. Actual product may vary from the images found in this document.



Pairing/Charging Indicator

- Flashes blue when searching for a Bluetooth device.
- Flashes blue every 2 seconds when the speaker is paired with a Bluetooth device.
- Lights red when charging; indicator turns off when fully charged.

Charge Your Speaker

Charge your speaker when the speaker sleeps.

1. Connect the USB plug of the supplied charging cable to the USB port of your computer or any USB charger.
2. Connect the cable's micro USB plug to the speaker's **DC 5V** jack. The indicator lights red when charging and turns off when fully charged.
3. Unplug the charging cable when the speaker is fully charged.

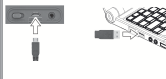

Note: You can play music and charge the speaker at the same time.

Use Your Speaker

Pairing Bluetooth devices

1. Turn on the speaker, the indicator flashes blue. Your speaker searches for Bluetooth devices.
2. Follow the instructions for your Bluetooth device to pair it with the speaker. After successful pairing, the indicator flashes blue every 2 seconds.
3. Use the playback controls on the speaker or your audio device.
4. Turn off the speaker after using.

Note: You can download Auvio EQ App for free from the App Store™ and Google Play to customize your calls and music. Enter password 0000 for Bluetooth connector if your device uses Android™ 2.1 or below.

Connect with AUX IN

1. Connect an audio cable (not included) to your audio device, then connect to your speaker's **AUX IN** jack.
2. The speaker will play your audio source and disconnect the Bluetooth connection automatically.
3. Use the playback controls on your audio device.
4. Unplug your audio device, the speaker will return to the previous Bluetooth connection.

FCC Information

This equipment has been tested and found to comply with the limits for a Class B digital device, pursuant to Part 15 of the FCC Rules. These limits are designed to provide reasonable protection against harmful interference in a residential installation. This equipment generates, uses and can radiate radio frequency energy and, if not installed and used in accordance with the instructions, may cause harmful interference to radio communications. However, there is no guarantee that interference will not occur in a particular installation. If the equipment does cause harmful interference to radio or television reception, which can be determined by turning the equipment off and on, the user is encouraged

- to try to correct the interference by one or more of the following measures:
- Reorient or relocate the receiving antenna.
- Increase the separation between the equipment and receiver.
- Connect the equipment into an outlet on a circuit different from that to which the receiver is connected.
- Consult the dealer or an experienced radio/TV technician for help.

Warning: Changes or modifications to this unit **not expressly approved by the party responsible for compliance** could void the user's authority to operate the equipment.

Limited Warranty

Ignition LP warrants this product against defects in materials and workmanship under normal use by the original purchaser for **ninety (90) days** after the date of purchase. IGNITION LP MAKES NO OTHER EXPRESS WARRANTY. This warranty does not cover: (a) damage or failure caused by or attributable to misuse, misuse, failure to follow instructions, improper installation or maintenance, alteration, accident, Act of God (such as flood or lightning), or excess voltage or current; (b) improper or unauthorized performance by persons who are not a part of Ignition LP Authorized Service Facility; (c) consumer items such as tapes or batteries; (d) ordinary wear and tear or cosmetic damage; (e) transportation, shipping or

insurance costs; (f) costs of product removal, installation, and/or service; (g) replacement or reinstallation, and (h) claims by persons other than the original purchaser. Should a problem occur that is covered by this warranty, please contact the party responsible for the purchase data to the date of purchase. Ignition LP will, at its option, unless otherwise provided by law, (a) repair the product without charge for parts and labor, (b) replace the product with the same or a comparable product, or (c) refund the purchase price. All replacement parts and products, and products to which a refund is made, become the property of Ignition LP. Ignition LP and its authorized parts and products may be used in the performance of warranty service. Transport or replacement of the product makes after the separation of the warranty period. IGNITION LP EXPRESSLY DISCLAIMS ALL WARRANTIES AND CONDITIONS NOT STATED IN THIS LIMITED WARRANTY. ANY IMPLIED WARRANTIES THAT MAY BE IMPOSED BY LAW, INCLUDING THE IMPLIED WARRANTY OF MERCHANTABILITY AND FITNESS FOR A PARTICULAR PURPOSE, ARE HEREBY DISCLAIMED. THE IMPLIED WARRANTY OF FITNESS FOR A PARTICULAR PURPOSE DOES NOT APPLY TO THE PURCHASER OF THE PRODUCT OR ANY OTHER PERSON OR ENTITY WITH RESPECT TO ANY LIABILITY, LOSSES OR DAMAGES CAUSED DIRECTLY OR INDIRECTLY BY USE OF THE PRODUCT. THIS PRODUCT IS PROVIDED AS IS. IGNITION LP MAKES NO WARRANTY, INCLUDING, BUT NOT LIMITED TO, ANY DAMAGES RESULTING FROM INCONVENIENCE AND

ANY LOSS OF TIME, DATA, PROPERTY, REVENUE, OR PROFITS AND ANY DIRECT, SPECIAL, INCIDENTAL, OR CONSEQUENTIAL DAMAGES, EVEN IF IGNITION LP HAS BEEN ADVISED OF THE POSSIBILITY OF SUCH DAMAGES. Some states do not allow limitations on how long an implied warranty lasts or the exclusion or limitation of incidental or consequential damages, so the above limitations or exclusions may not apply to you. This warranty gives you specific legal rights, and you may also have other rights which vary from state to state. You may contact Ignition LP at: Ignition LP, 2102 Maple Ave., Suite 450, Dallas, TX 75201 0209

For product support, call **1-866-315-0426**

RoHS

Complies with the European Union "Restriction of Hazardous Substances Directive" and complies with the environment by searching specific hazardous materials and products.

App Store is a service mark of Apple Inc.
 Android is a trademark of Google Inc.
 Bluetooth is a registered trademark of Bluetooth SIG, Inc.
 © 2013 Ignition LP. All rights reserved.
 Ignition LP is a registered trademark of Ignition LP. All other trademarks, trade names, logos and product names are the property of their respective owners.

Printed in China 4000449