

# 2D Barcode Scanner

## Quick Start Guide



- Contents:
- Barcode Scanner
  - Quick Start Guide
  - warranty card
  - Certificate
  - USB / RS232 Cable
  - Power Adapter (RS232)

## 1 Scanner Overview

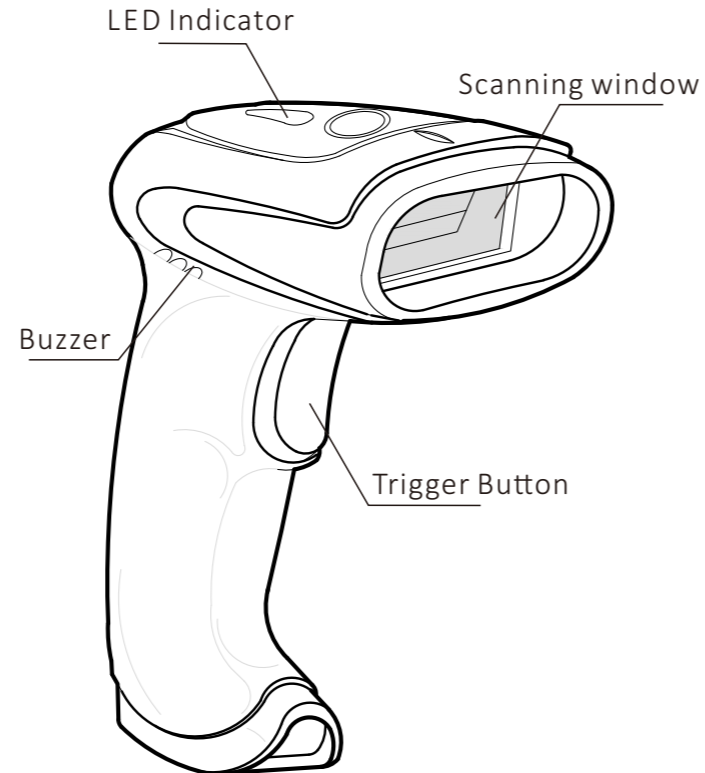

**Barcode scanner**

Note: Product appearance depends on goods

## 2 Cable plug&Unplug

(1).USB Cable

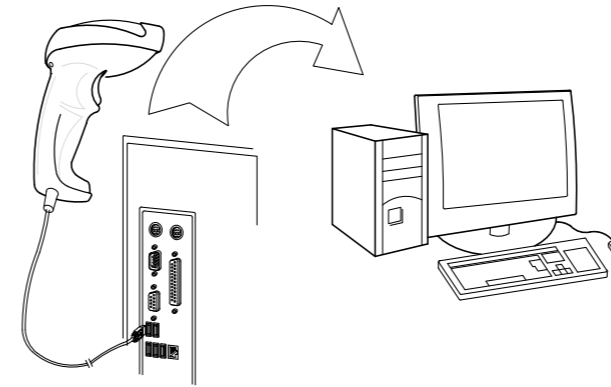

(2).RS232 Cable

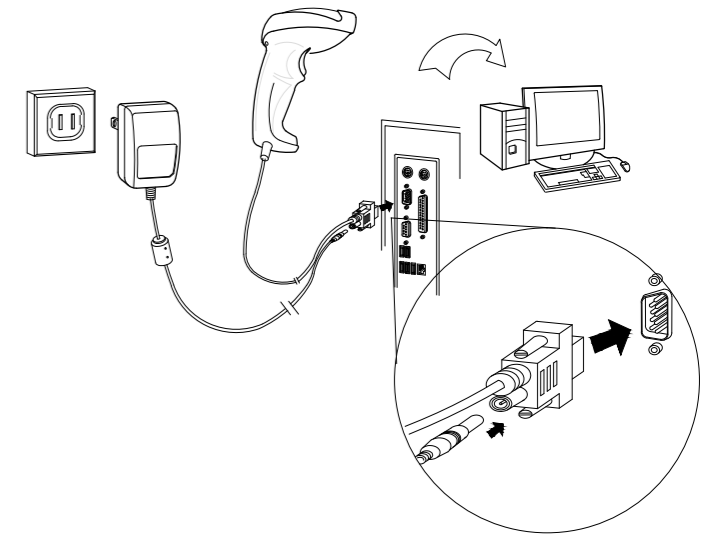

## 3 Scanning Angle

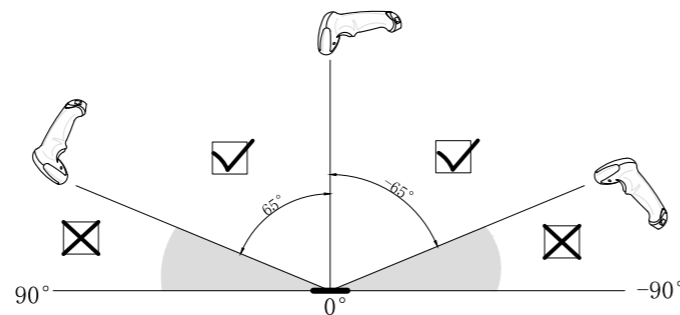

## 4 Methods and distance

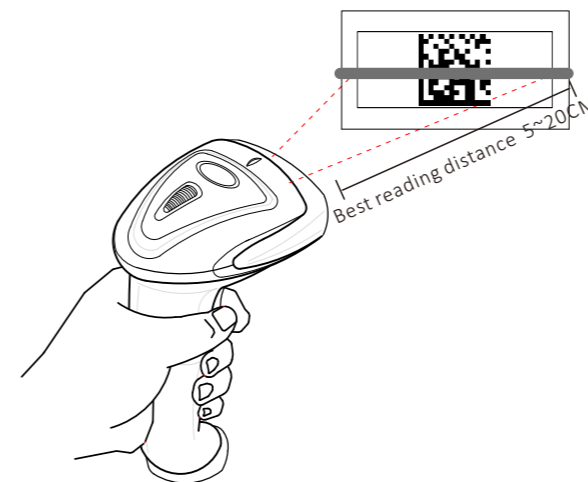

### LED Indicator

LED Indication	Explanation
Blue lights blinking	Decoding Successfully

### Buzzer

Beep Indication	Explanation
One Beep	Decoding Successfully
Continuous Beep	Successfully parameter setting

# Decode Settings

Configuration method: Scan the function bar code directly.

## Setting Step

### ① Defaults Parameter



0D0100.

Restore All Factory Defaults

### ② Firmware Version



0D1302?.

Version

### ③ Trigger Mode



091A00.

Manual Trigger Mode – Normal (Default)



091B00.

Manual Trigger Mode – Cellphone

### ④ Auto Trigger



090901.

Presentation Mode – Normal



090902.

Presentation Mode- Cellphone



091A00.

\*Disable auto trigger

### ⑤ Suffix Values



090200.

\*0x0D ( CR )



090202.

0x0A ( LF )



090300.

0x0D 0x0A ( CR LF )



090201.

TAB

### ⑥ Illumination



0401004.

High Level Illumination



0401003.

Middle Level Illumination



0401002.

Low Level Illumination



0401001.

Illumination OFF

### ⑦ Code39 Setting



0203021.

Enable Full ASCII Code39



0203020.

\*Disable Full ASCII Code39

### ⑧ Symbologies



090101.

Restore Symbology Default



091832.

Only Enable Retail Barcode



0201001.

Enable All Symbologies

## **FCC STATEMENT :**

This device complies with Part 15 of the FCC Rules. Operation is subject to the following two conditions:

- (1) This device may not cause harmful interference, and
- (2) This device must accept any interference received, including interference that may cause undesired operation.

**Warning:** Changes or modifications not expressly approved by the party responsible for compliance could void the user's authority to operate the equipment.

NOTE: This equipment has been tested and found to comply with the limits for a Class B digital device, pursuant to Part 15 of the FCC Rules. These limits are designed to provide reasonable protection against harmful interference in a residential installation.

This equipment generates uses and can radiate radio frequency energy and, if not installed and used in accordance with the instructions, may cause harmful interference to radio communications. However, there is no guarantee that interference will not occur in a particular installation. If this equipment does cause harmful interference to radio or television reception, which can be determined by turning the equipment off and on, the user is encouraged to try to correct the interference by one or more of the following measures:

- Reorient or relocate the receiving antenna.

- Increase the separation between the equipment and receiver.

- Connect the equipment into an outlet on a circuit different from that to which the receiver is connected.

- Consult the dealer or an experienced radio/TV technician for help.

## **RF warning statement:**

The device has been evaluated to meet general RF exposure requirement. The device can be used in portable exposure condition without restriction.