



 **Bluetooth®**



**User's Manual
for UZ-S012B-101**

Included:
Speaker
Microphone with Cable
Charger, User Manual



BOOMIN'

PA WIRELESS SPEAKER SYSTEM

IMPORTANT Please read before using this product

Detailed Product Diagram

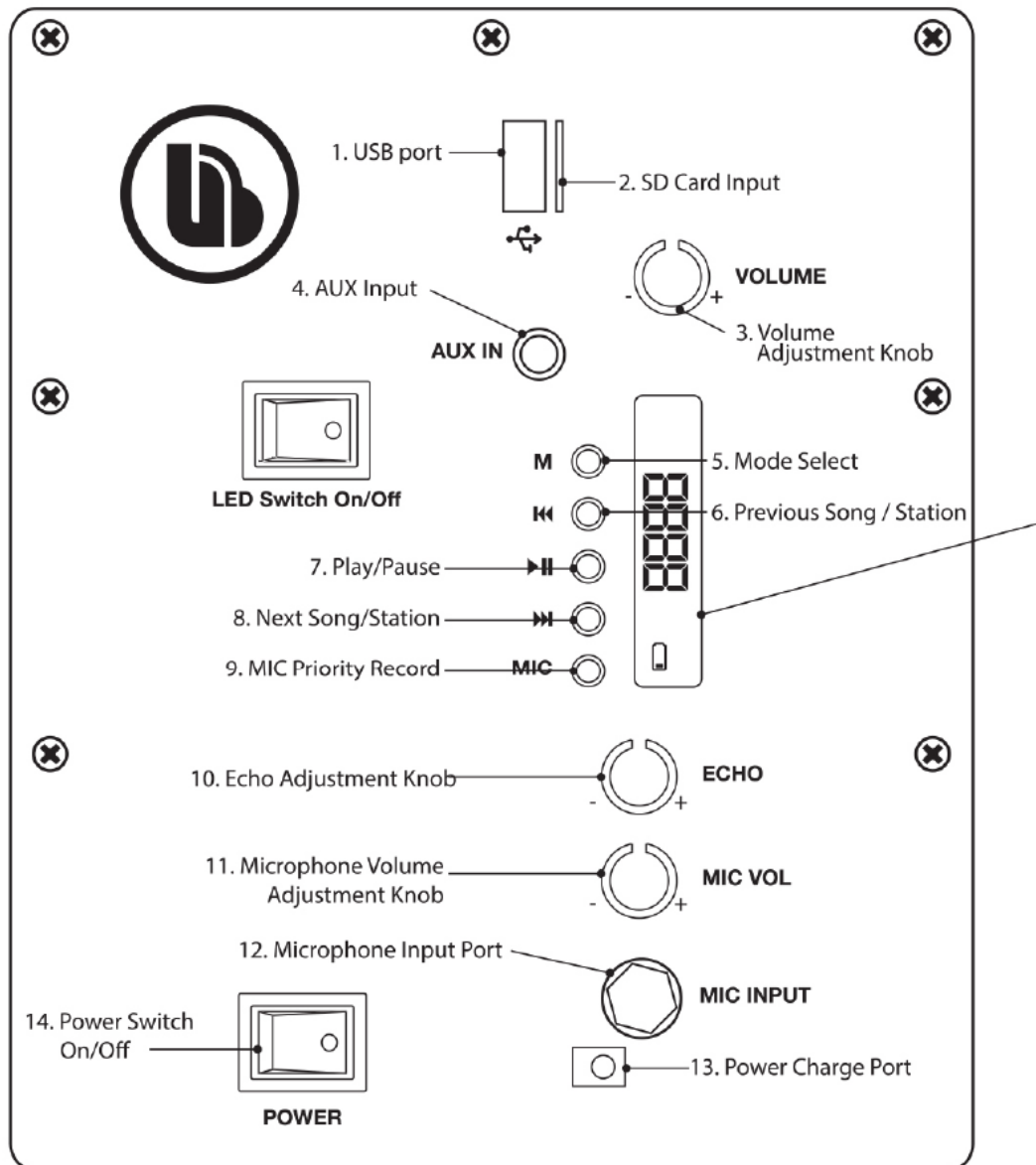

Charge It

- Plug the power cable into the charging port on the back panel. Plug the power adapter into a standard 110V wall outlet.
- When charging, indicator light will flash. Once fully charged, indicator light will remain lit.
- The speaker will take approximately 4-5 hours to charge.
- **Warning: Only use the included charger to charge the speaker.**

Selecting Play Mode

- The Boomin' Wireless Speaker System comes with 3 play modes: Line/Aux, Bluetooth and FM
- Press the Mode button to switch between modes.
- The LCD screen will display the mode you are in.

Pair & Connect with a New Bluetooth Device

- Press the power switch to turn the speaker on.
- If needed press the Mode button until the speaker is in Bluetooth mode.
- On your Bluetooth enabled device, navigate to the Bluetooth setting menu, and search for new devices.
- Wait a few seconds and select "UZ-S012B".
- You will hear a tone to indicate you are connected.

LCD Screen



LINE: operating in Aux in mode
FM: operating FM mode
Blue: operating Bluetooth mode



Flashing when the power is low, charging is needed with adapter, or it will turn into standby mode and turn off; The volume will drop to 70% when power is low.



Bluetooth Mode: Short Press: Play/Pause
Long Press: Disconnect current device
FM Mode: Short Press: Mute
Long Press: Scan local stations and store



Bluetooth Mode: Previous and next track
FM Mode: Select previous or next station stored in memory.

Remote Control

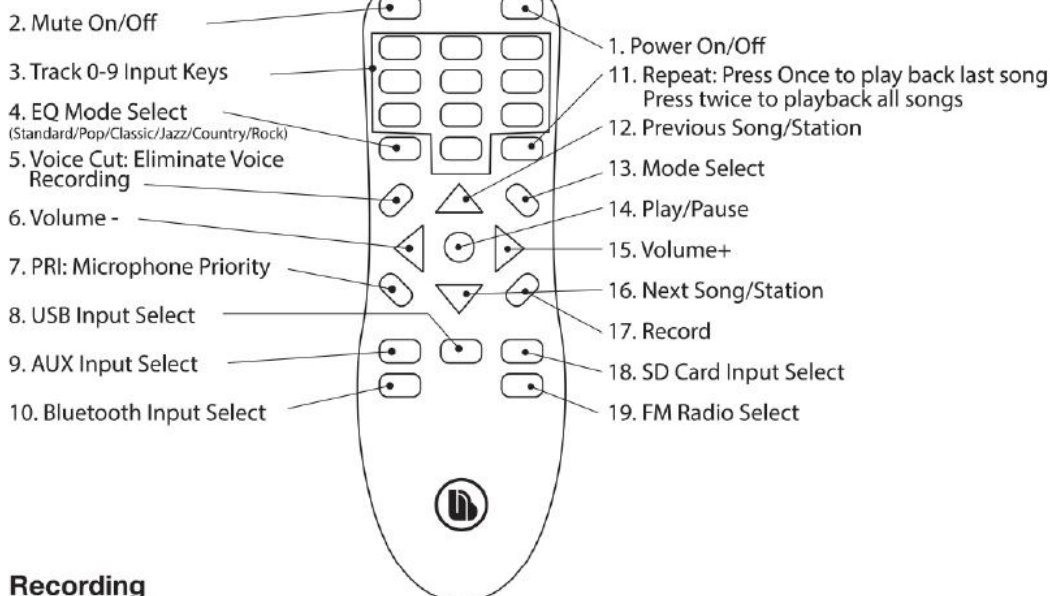

Recording

1. Insert USB Drive or SD Card
 2. Press and hold "Rec" button on remote or back panel until display flashes.
 3. When Finished, press "Rec" button to play recorded clip.
- Tip: To find previous recordings, press and hold the play button while USB Drive/SD Card is inserted.
-

Using the Microphone

- Plug microphone in MIC Port. LED screen will read MIC.
- Turn microphone on.
- Adjust MIC VOL and ECHO to your desired level.
- The Mic Priority feature fades out music in reaction to your voice. Music fades in automatically when you are done.

Karaoke App Support

- The Boomin' Wireless speaker supports many apps found in the Apple and Android App store.
- Try out some of these popular apps: Smule, The Voice: On Stage, Karaoke Sing and Record, Yokee: Sing Like A Star!, and StarMaker
- The speaker also supports using Youtube for your karaoke music and lyrical needs. Just search for karaoke songs and press play!



Troubleshooting

No power

Recharge your speaker using the included adapter.

Music is not playing over Bluetooth

Make sure your Bluetooth device has A2DP profile. Check if both devices are paired and connected over Bluetooth. Restart the speaker to reconnect your Bluetooth device.

Bluetooth device will not reconnect with the speaker

Navigate to your Bluetooth settings menu on your Bluetooth device, tap "UZ-S012B," and select "Forget." Now follow the steps to pair your device again.

Specifications

Bluetooth Version 4.2
Charging Voltage: 5V
Freq. Response: 60HZ~20KHZ
Product size (mm): 265 x 210 x 400

Battery Capacity: 3.7V 2200MAH
Charging Time: 4-5 Hours
Playback Time: 2-3 Hours*
*Depends on individual use

Technical Support:

Please do not attempt to fix the product by yourself. If you are experiencing any problems with the product, please do not return it to the store you bought it from. You can contact our technical support representatives and they will assist you with any questions you might have. For assistance operating your product, please consult the User's Manual first, then feel free to contact Merkury Innovations technical support:

Merkury Innovations
45 Broadway 3rd Fl. New York, NY 10006
www.merkuryinnovations.com
E-mail: support@merkuryinnovations.com

© 2019 Merkury Innovations LLC

To explore our full selection of products, visit us at: www.merkuryinnovations.com

The Bluetooth word mark and logo are registered trademarks owned by Bluetooth SIG, Inc.

The illustrated product and specifications may differ slightly from those supplied. All other trademarks and trade names are those of their respective owners.

Made in China

FCC Statement

This equipment has been tested and found to comply with the limits for a Class B digital device,

pursuant to Part 15 of the FCC Rules. These limits are designed to provide reasonable protection against harmful interference in a residential installation. This equipment generates uses and can radiate radio frequency energy and, if not installed and used in accordance with the instructions, may cause harmful interference to radio communications. However, there is no guarantee that interference will not occur in a particular installation. If this equipment does cause harmful interference to radio or television reception, which can be determined by turning the equipment off and on, the user is encouraged to try to correct the interference by one or more of the following measures:

- Reorient or relocate the receiving antenna.
- Increase the separation between the equipment and receiver.
- Connect the equipment into an outlet on a circuit different from that to which the receiver is connected.
- Consult the dealer or an experienced radio/TV technician for help.

This device complies with part 15 of the FCC Rules. Operation is subject to the following two conditions: (1) This device may not cause harmful interference, and (2) this device must accept any interference received, including interference that may cause undesired operation.

Changes or modifications not expressly approved by the party responsible for compliance could void the user's authority to operate the equipment.