

CONTENTS

1.	YOUR TUNES EXPLORER WIRELESS	2
1.1.	Recommended use	2
1.2.	Specifications	2
1.3.	Minimum system requirements (PC)	3
1.4.	Minimum system requirements (Mac)	3
1.5.	Box contents	3
2.	SETTING UP TUNES EXPLORER WIRELESS	4
2.1.	Installing the software (Windows XP)	4
2.2.	Installing the software (Mac OS X)	4
2.3.	Installing the USB dongle	5
2.4.	Installing batteries in Tunes Wireless Explorer	5
2.5.	Connecting Tunes Explorer Wireless to your computer	5
2.6.	Speakers	5
3.	OVERVIEW	6
3.1.	Button functions	7
4.	THE MAIN MENU	8
4.1.	Library	8
4.2.	Playlists	9
4.3.	Party Shuffle	9
4.4.	Podcasts	10
4.5.	Radio	10
4.6.	Play Screen	11
4.7.	Settings	11
4.7.1.	<i>Play Mode</i>	11
4.7.2.	<i>Video Mode</i>	11
4.7.3.	<i>Equalizer</i>	11
4.7.4.	<i>RF freq. state</i>	12
4.7.5.	<i>Set LCD backlight</i>	12
4.8.	Resync with iTunes	12
5.	FAQ	13
6.	TECHNICAL SUPPORT	15
7.	WARRANTY	16

1. YOUR TUNES EXPLORER WIRELESS

Congratulations on your purchase! Tunes Explorer Wireless gives you the freedom to access the entire music collection on your computer remotely. Browse through and enjoy your iTunes library, playlists, podcasts and Internet radio stations from another room: it's never been so easy to navigate through your music and enjoy your collection without being chained to your computer.

Using Tunes Explorer Wireless is safe: there's no danger of your songs being deleted or altered accidentally. Imagine the fun you'll have at parties when all of your friends can take turns looking through your music collection, selecting their favorites and playing DJ for a while! The music plays over your computer's sound card and speakers for everyone to enjoy.

Share your music and listen to the songs you want, when you want, where you want: it's all possible with Tunes Explorer Wireless.

1.1. Recommended use

- Never open up Tunes Explorer Wireless, as you risk damaging its internal components.
- To ensure optimal use of Tunes Explorer Wireless, keep it away from:
 - rain or humidity, as well as all fluids (water, chemical products or any other liquids),
 - heat sources such as radiators, stoves or any other heat-producing appliances (including amplifiers),
 - direct sunlight.
- Clean Tunes Explorer Wireless with a damp cloth and avoid the use of aerosol cleaners.

1.2. Specifications

- Pocket-size remote control for iTunes: 4"17 x 2"4 x 0"68 (10.6 x 6 x 1.7cm)
- Powered by 2 AAA batteries (not included)
- Radio Frequency transmission (up to 90 feet range, non-directional use)
- Embedded LCD screen to display menus and music titles
- Blue backlight for LCD screen (useable anywhere)
- Lateral scroll + click wheel (for quick browsing through large audio libraries)
- USB full-speed receiver (PC and Mac compatible)
- Controls all music supported by iTunes (audio files, podcasts and Internet radio stations), including DRM-protected files

1.3. Minimum system requirements (PC)

- Microsoft Windows XP Home Edition/Professional Edition
- Intel Pentium III or AMD Athlon 500MHz processor
- 256MB RAM (512MB recommended)
- Sound card
- CD-ROM drive
- USB2.0 or USB1.1 port

1.4. Minimum system requirements (Mac)

- Mac OS X 10.4
- 400MHz G3 / G4 / G5 / Intel processor
- 256MB RAM (512MB recommended)
- CD-ROM drive
- USB2.0 or USB1.1 port

1.5. Box contents

- Hercules Tunes Explorer Wireless remote control
- USB dongle Radio Frequency transmitter
- Semi-rigid USB directional cable
- Installation CD-ROM containing Hercules software, Apple iTunes and QuickTime software and user manual in PDF format

2. SETTING UP TUNES EXPLORER WIRELESS

2.1. Installing the software (Windows XP)

- Insert the CD-ROM provided into your CD-ROM drive.

The installation assistant appears automatically.



If the installation menu does not launch automatically:

- Double-click **My Computer**.
- Double-click the CD-ROM icon.
- Double-click **Setup.exe**, if necessary.

- Follow the on-screen instructions to launch installation of the Tunes Explorer Wireless software as well as Apple iTunes and QuickTime, if recent versions these last two applications are not already installed on your system.

Once installation is complete, the  icon appears in the system tray in the bottom right-hand corner of your screen.

2.2. Installing the software (Mac OS X)

- Insert the CD-ROM provided into your CD-ROM drive.

The installation CD-ROM appears on your desktop.

- Double click the CD-ROM icon and navigate to the installer package.
- Double-click the installer package and follow the on-screen instructions to launch installation of the Tunes Explorer Wireless software as well as Apple iTunes and QuickTime, if recent versions these last two applications are not already installed on your system.

You may be prompted to restart your computer once installation is complete.

2.3. Installing the USB dongle

- Connect the USB dongle to a USB port on your PC or Mac. You can attach it to the semi-rigid directional cable (included) if that makes it easier to connect to your computer.

*Windows XP displays a **Found New Hardware** message in the system tray in the bottom right-hand corner of your screen. Windows automatically installs the required Windows drivers and then displays a message indicating that the hardware is ready to use.*

2.4. Installing batteries in Tunes Wireless Explorer

Open up the battery compartment at the back of your Tunes Wireless Explorer and insert 2 AAA batteries (not included). Close the battery compartment again when you're done.

2.5. Connecting Tunes Explorer Wireless to your computer



When establishing a connection between the Tunes Explorer Wireless remote and your computer for the first time (or after having replaced the batteries), you must keep the remote very close to the USB dongle (no more than a few inches away) when connecting it to your computer.

- Press and hold the **Select** button on the remote for 2 seconds.

The screen on the remote lights up and displays the message: "Loading iTunes... Please wait..."

- Wait while iTunes is launched and minimized on your computer.

2.6. Speakers

In order to hear the music being played on your computer's sound card, you need to have speakers connected or integrated speakers in your laptop or monitor, for example. Make sure that your speakers are properly connected and adjust the volume to a comfortable listening level. Finally, ensure that the volume at the top of your iTunes screen is set to an appropriate level.

3. OVERVIEW

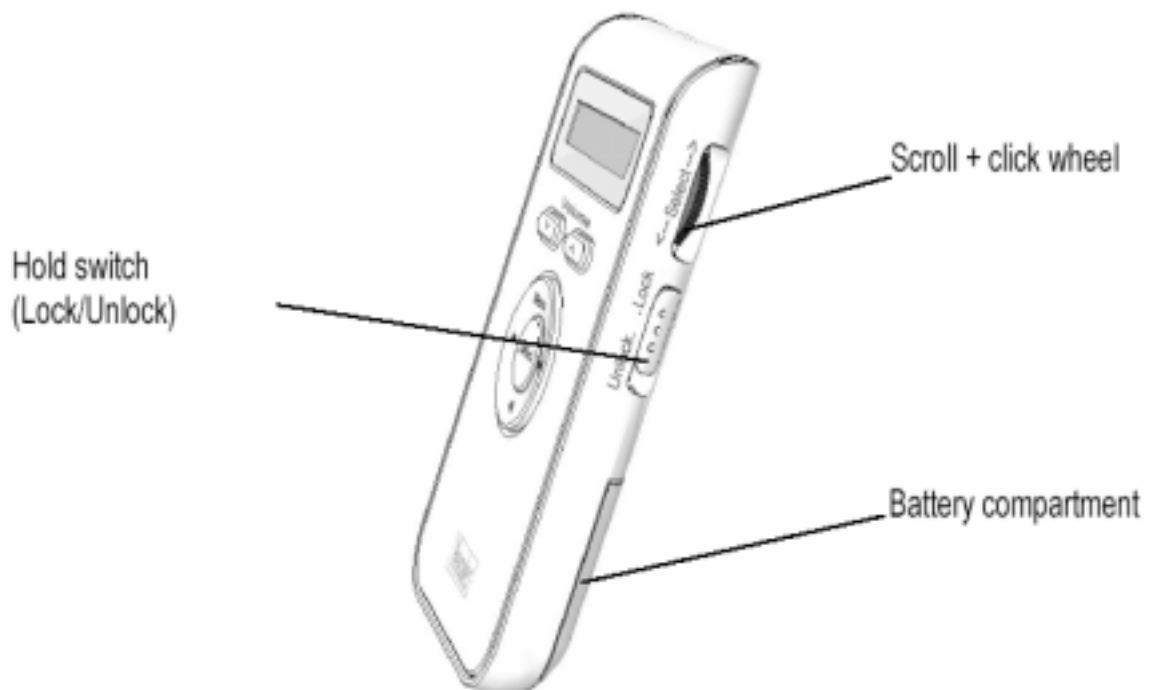
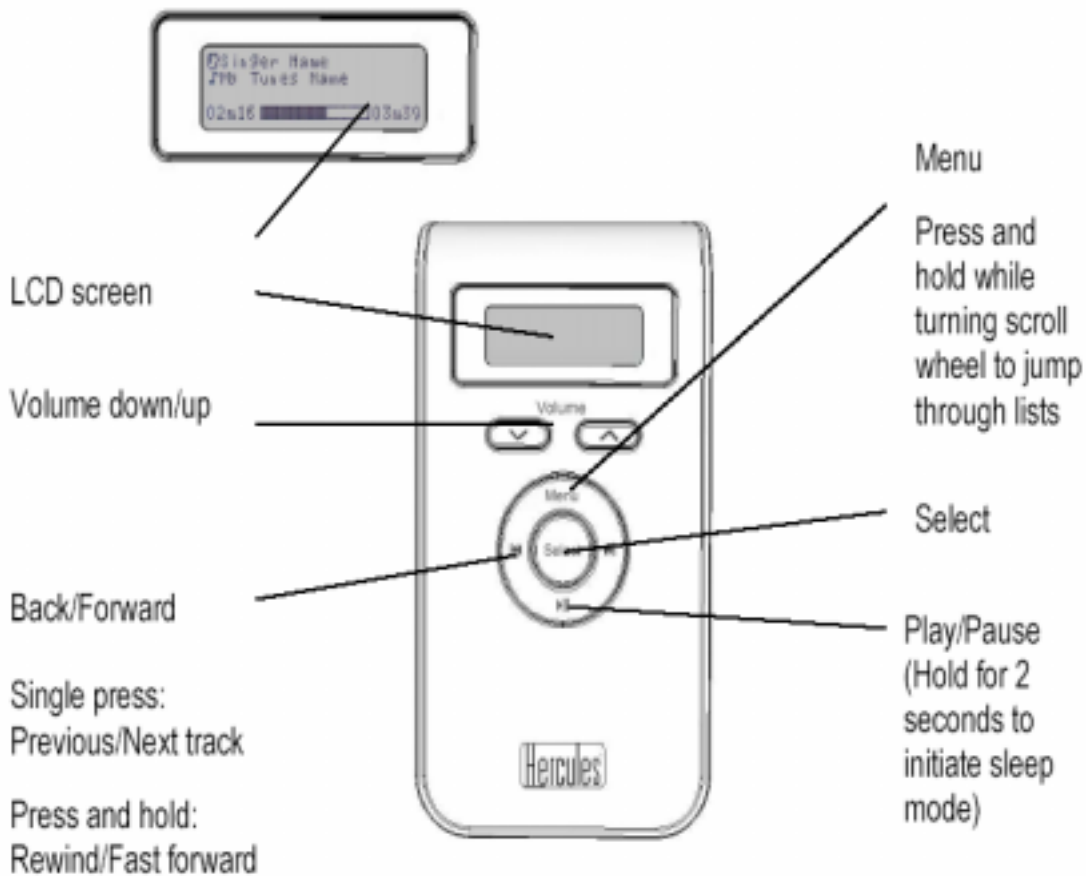

3.1. Button functions

Volume down/up: Press or hold down either of these buttons to decrease or increase the volume, respectively.

Press both the volume up and down buttons simultaneously to mute/un-mute.

Menu: Press to return to the previous menu.

Back/Forward: Press once to skip to the previous or next track. Press and hold to rewind or fast forward within a song. These buttons are always active.

Select: In play screen mode, press **Select** to move back and forth to the Rating screen (use the scroll wheel for your rating and click the wheel or press Select to apply the rating).

In list mode, press **Select** to select an object in the list (clicking the scroll wheel has the same function).

Play/Pause: Press to play or pause a track. This button is always active.

Press and hold the **Play/Pause** button for a few seconds to put the remote into sleep mode. Press any button to wake it up.

Navigation

Standard navigation

Scroll + click wheel: Use the wheel to scroll up and down through lists and click the wheel to select.

Use the scroll wheel to assign ratings to your songs in the Rating screen and click the wheel or press Select to apply the rating.

Fast navigation

Press and hold the **Menu** button while turning the scroll wheel to “jump” through any list. The bigger the list, the further you will jump at a time, allowing you to move through even large lists very quickly.

Hold switch: Set the hold switch to **Lock** to immobilize all buttons (including the scroll wheel) on the remote. Set the switch to **Unlock** to restore button functions.



If the remote is off with the hold switch set to lock, you must unlock the hold switch to turn the remote back on again.

4. THE MAIN MENU

Scrolling through the main menu on your Tunes Explorer Wireless displays the following headings: **Library**, **Playlists**, **Party Shuffle**, **Podcasts**, **Radio**, **Play Screen**, **Settings** and **Resync with iTunes**.

This manual assumes that you have a working knowledge of the iTunes software. If you are new to iTunes, it would be helpful to have a look through the extensive iTunes help file (the **Help** menu at the top of your iTunes screen) for all the information you need on how the software works.

We will now go through each of these headings on the main screen, as well as their sub-headings, to give you an idea of how to use your Tunes Explorer Wireless remote to control and listen to the music in your iTunes music library.



When you make changes to items in your iTunes library (new songs added, new playlists created, etc.), you must resynchronize Tunes Explorer Wireless with iTunes in order for those changes to be reflected on your Tunes Explorer Wireless screen.

4.1. Library

This heading allows you to access all of the music in your iTunes library. Clicking **Library** in the main menu screen brings you to a sub-menu with the following categories:

- **Artists:** Click to access a list of all the artists in your iTunes music library in alphabetical order.
- **Albums:** Click to access a list of all the albums in your iTunes music library in alphabetical order.
- **Genres:** Click to access a list of all the genres in your iTunes music library in alphabetical order. Genres are categories used to classify your music: Rock, Pop or Classical, for example. Selecting **All** in the genres category will bring you to a list of all artists in all genres in your music library. Selecting a single genre in the list (Rock, for example) will bring you to a list of artists in that genre.
- **Rating:** Click to access a list of all rated songs in your library: **Rating: 5**, **Rating: 4**, etc. Selecting **Rating: 5**, for example, will then display all songs with a rating of 5, and so on. Selecting **All** will display all songs with ratings assigned.
- **Songs:** Click to access a list of all the songs in your iTunes music library in alphabetical order.

4.2. Playlists

Playlists are lists of songs or other items in your iTunes music library (podcasts, for example).

Some playlists are dynamic or “smart” playlists, represented by the purple  icon to the left of the playlist in iTunes. Dynamic playlists are referred to as smart playlists because they update automatically according to criteria that have been defined for them. Default smart playlists in iTunes include **Recently Added**, **Recently Played** and **Top 25 Most Played**: these include songs recently added to your iTunes library, songs you have recently played and songs you have played the most, respectively.

You can right-click a smart playlist in the **Source** list on the left-hand side of your screen in iTunes and select **Edit Smart Playlist** to view the rules that have been defined for that playlist and edit them, if you wish; in your **Recently Added** smart playlist, you may decide to change the default value of songs added to your library within the last 2 weeks to within the last 4 weeks, for example.

To create a new smart playlist in iTunes, click the **File** menu at the top of your iTunes screen and then **New Smart Playlist...** You can then define the settings for that smart playlist in the dialog box that appears. When you’re done, name your playlist.

Other playlists are standard playlists, represented by the light blue  icon to the left of the playlist in iTunes. Standard playlists are playlists that you add to manually by dragging and dropping songs or podcasts from your iTunes library onto the playlist in the **Source** list on the left-hand side of your iTunes screen. You might want to choose some songs from a few of your favorite rock bands, for example, or select a bunch of mellow songs to set the mood at a dinner party.

To create a new playlist in iTunes, click the **File** menu at the top of your iTunes screen and then **New Playlist...** You can then drag and drop songs or podcasts from your library onto the playlist on the left-hand side of your iTunes screen to create the perfect tailor-made mix. When you’re done, name your playlist.

4.3. Party Shuffle

Party Shuffle creates a dynamic playlist made up of a random selection of songs from your library or any playlist you choose, a sort of “live mix”. To view and make changes to the Party Shuffle list:

- Click **Party Shuffle** in the list on the left-hand side of your iTunes screen.
- Select a source from which to create the mix in the **Source:** pop-up list at the bottom of the screen (your entire library or a playlist of your choice).

- Select the number of played or upcoming songs to be displayed in the playlist.

To change the list of upcoming tracks, click the **Refresh** button in the top right corner of the iTunes window. If you've added any songs manually, they will remain in the list.

4.4. Podcasts

Podcasts are shows – either audio or video – that you can download to your computer using iTunes. You can either download podcast episodes individually or subscribe to a podcast so that you receive the latest installments automatically.

Podcasts are not the same as Internet radio stations: Internet radio stations are streamed over the Internet, whereas podcasts are actually downloaded to your computer before they can be played.

To download or subscribe to podcasts, click **Podcasts** in the **Source** list on the left-hand side of your screen in iTunes, then click **Podcast Directory** at the bottom of your screen.



You must drag and drop podcasts into your music library in iTunes for them to be accessible via your Tunes Explorer Wireless. You should also remember to resync Tunes Explorer Wireless with iTunes after adding new elements to your library so that you can view them on your remote.

4.5. Radio

Internet radio stations are streamed over the Internet to your computer, meaning that you don't have to download them before listening. There are a huge number of Internet radio stations available to cater to every listening taste, with more added every day.

To browse through Internet radio stations, click **Radio** in the **Source** list on the left-hand side of your screen in iTunes. You can then select a radio category and look through all of the various stations available.



You must drag and drop radio stations into your music library in iTunes for them to be accessible via your Tunes Explorer Wireless. You should also remember to resync Tunes Explorer Wireless with iTunes after adding new elements to your library so that you can view them on your remote.

4.6. Play Screen

The Play Screen is the screen that is displayed on your remote when something is playing in iTunes. Information about the song and the elapsed time are displayed on your Tunes Explorer Wireless screen.

In play screen mode, press the **Select** button to move back and forth to the Rating screen (use the scroll wheel for your rating and click the wheel or press Select to apply the rating).

If a song is paused and the remote goes to sleep, it will not display the play screen when it wakes up again.

4.7. Settings

Via the Settings menu you can access a variety of parameters relating to playback, EQ controls and performance of your Tunes Explorer Wireless.

4.7.1. Play Mode

- Select how tracks are played: **Repeat Once**, **Play All Once**, **Shuffle**, **Repeat** or **Shuffle Repeat**.



As these options relate to playlists or your library, any changes you wish to apply must be made before selecting the playlist or library in question.

4.7.2. Video Mode

- iTunes offers a Visualizer window which displays visual effects to go along with music you are listening to. There are two options here, **Hidden** and **Visualizer**: the first hides the iTunes visualizer, while the second displays it.

4.7.3. Equalizer

- The equalizer setting is set to **Flat** by default. Use this option to select from a list of available EQ settings to change the way your music sounds, including **Disable**, **Manual**, **Acoustic**, **Bass Booster** and more. Please note that there is no display of graphics equalizer on the remote.

4.7.4. *RF freq. state*

- This setting displays information about the status of RF frequency transmission for your Tunes Explorer Wireless.

4.7.5. *Set LCD backlight*

- This setting allows you to adjust the intensity of the blue backlight on your Tunes Explorer Wireless screen: **Off**, **Low intensity**, **High intensity** or **Medium intensity** (the default setting).

4.8. **Resync with iTunes**

Use this option to resynchronize Tunes Explorer Wireless with your iTunes library.



Remember to resync Tunes Explorer Wireless with iTunes after adding new elements to your library so that you can view them on your remote.

5. FAQ

- The remote can't seem to make a connection with the USB dongle.

When first using the Tunes Explorer Wireless remote (or after having replaced the batteries), it is important for the remote to be very close to the USB dongle connected to your computer (no more than a few inches away) in order for it to be initialized and identified correctly.

- I get the message "No Host Available" when trying to connect.

This message indicates that the remote cannot communicate with the computer because the Tunes Explorer Wireless application is not running. Make sure that that Tunes Explorer Wireless application is running on your computer and then try again.

In Windows XP, the Tunes Explorer Wireless icon  should be present in the Windows system tray in the bottom right-hand corner of your screen.

- How can I find out which track is currently playing?

To display the track currently playing, select **Play Screen** from the main menu.

- None of the buttons on the remote seem to be active / I can't bring the remote out of sleep mode.

Make sure that the batteries are inserted correctly and fully charged. Also verify that the hold switch is not set to the **LOCK** position.

- Can I add items to playlists or create new playlists using the Tunes Explorer Wireless remote?

No, you can't add items to playlists or create new playlists using the remote. These changes must be made on your computer in iTunes.

- How long does the blue backlight stay on for?

20 seconds after last button press, the backlight turns off. 5 minutes after last button press, the remote goes into sleep mode. Press any button to wake it up.

- Strange colors and patterns are appearing on my computer's monitor and I don't know why.

Make sure that the **Video Mode** setting is set to **Hidden** so as not to display the iTunes Visualizer.

- I have a video podcast in my playlist. How can I view it?

Videos should normally be displayed within the main iTunes window, unless you have opened up another window in which to view them. However, if the iTunes Visualizer is on, only audio will be heard, so turn off the Visualizer if you want to see the video.

- How can I reach fast a music track located far in the list from the currently loaded track?

Use the accelerated navigation, by pressing and holding the Menu button while turning the scroll wheel to "jump fast" through the playlist.

- How can I open another playlist when I have started with one playlist?

By pressing the Menu button, comme backward to the first menu on the remote, select the heading "Playlists" and chose the new playlist."

- Can I use rechargeable AAA batteries to power Tunes Explorer Wireless?

Yes, but the operating time can vary depending on the rechargeable batteries used. For rechargeable batteries, we recommend Nickel Metal Hydride (Ni-MH).

Copyright

Hercules® is a registered trademark of Guillemot Corporation S.A. Intel® and Pentium® are registered trademarks of Intel Corporation. AMD Athlon is a trademark of AMD. Microsoft® Windows® XP is a registered trademark of Microsoft Corporation in the United States and/or other countries. Apple®, Mac OS®, iPod®, iTunes® and QuickTime® are registered trademarks of Apple Computer, Inc. All other trademarks and brand names are hereby acknowledged and are property of their respective owners. Illustrations not binding.

FCC Warning

Changes or modifications not expressly approved by the party responsible for compliance could void the user's authority to operate the equipment or modifications not expressly approved by the party responsible for compliance could void the user's authority to operate the equipment

Note: This equipment has been tested and found to comply with the limits for a Class B digital device, pursuant to part 15 of the FCC Rules. These limits are designed to provide reasonable protection against harmful interference in a residential installation. This equipment generates, uses and can radiate radio frequency energy and, if not installed and used in accordance with the instructions, may cause harmful interference to radio communications. However, there is no guarantee that interference will not occur in a particular installation. If this equipment does cause harmful interference to radio or television reception, which can be determined by turning the equipment off and on, the user is encouraged to try to correct the interference by one or more of the following measures:

- Reorient or relocate the receiving antenna.
- Increase the separation between the equipment and receiver.
- Connect the equipment into an outlet on a circuit different from that to which the receiver is connected.
- Consult the dealer or an experienced radio/TV technician for help.

This device complies with part 15 of the FCC Rules. Operation is subject to the following two conditions: (1) This device may not cause harmful interference, and (2) this device must accept any interference received, including interference that may cause undesired operation.

6. TECHNICAL SUPPORT

If you encounter a problem with your product, please go to <http://ts.hercules.com> and select your language. From there you will be able to access various utilities (Frequently Asked Questions (FAQ), the latest versions of drivers and software) that may help to resolve your problem. If the problem persists, you can contact the Hercules products technical support service ("Technical Support"):

By email:

In order to take advantage of technical support by email, you must first register online. The information you provide will help the agents to resolve your problem more quickly.

Click **Registration** on the left-hand side of the Technical Support page and follow the on-screen instructions.

If you have already registered, fill in the **Username** and **Password** fields and then click **Login**.

By telephone:

United Kingdom	08450800942 Charges at local rate	Monday to Friday from Noon to 4pm and 5pm to 10pm Saturday from 9am to Noon and 1pm to 7pm Sunday from 9am to Noon and 1pm to 4pm
United States	1-866-889-5036 Free	Monday to Friday from 7am to 11am and from Noon to 5pm Saturday and Sunday from 7am to Noon (Eastern Standard Time)
Canada	1-866-889-2181 Free	Monday to Friday from 7am to 11am and from Noon to 5pm Saturday and Sunday from 7am to Noon (Eastern Standard Time)
Denmark	80887690 Free	Monday to Friday from 1pm to 5pm and 6pm to 11pm (English) Saturday from 9am to 1pm and 2pm to 8pm Sunday from 10am to 1pm and 2pm to 5pm
Sweden	0200884567 Free	Monday to Friday from 1pm to 5pm and 6pm to 11pm (English) Saturday from 9am to 1pm and 2pm to 8pm Sunday from 10am to 1pm and 2pm to 5pm
Finland	0800 913060 Free	Monday to Friday from 2pm to 6pm and 7pm to Midnight (English) Saturday from 10am to 2pm and 3pm to 9pm Sunday from 11am to 2pm and 3pm to 6pm

7. WARRANTY

Worldwide, Guillemot Corporation S.A. ("Guillemot") warrants to the consumer that this Hercules product will be free from material defects and manufacturing flaws for a period of two (2) years from the original date of purchase. Should the product appear to be defective during the warranty period, immediately contact Technical Support, who will indicate the procedure to follow. If the defect is confirmed, the product must be returned to its place of purchase (or any other location indicated by Technical Support).

Within the context of this warranty, the consumer's defective product will, at Technical Support's option, be either repaired or replaced. Where authorized by applicable law, the full liability of Guillemot and its subsidiaries (including for indirect damages) is limited to the repair or replacement of the Hercules product. The consumer's legal rights with respect to legislation applicable to the sale of consumer goods are not affected by this warranty.

This warranty shall not apply: (1) if the product has been modified, opened, altered, or has suffered damage as a result of inappropriate or abusive use, negligence, an accident, normal wear, or any other cause not related to a material defect or manufacturing flaw; (2) in the event of failure to comply with the instructions provided by Technical Support; (3) to software not published by Guillemot, said software being subject to a specific warranty provided by its publisher.

ENVIRONMENTAL PROTECTION RECOMMENDATION



At the end of its working life, this product should not be disposed of with standard household waste, but rather dropped off at a collection point for the disposal of Waste Electrical and Electronic Equipment (WEEE) for recycling.

This is confirmed by the symbol found on the product, user manual or packaging.

Depending on their characteristics, the materials may be recycled. Through recycling and other forms of processing Waste Electrical and Electronic Equipment, you can make a significant contribution towards helping to protect the environment.

Please contact your local authorities for information on the collection point nearest you.