

## INSTRUCTIONS

### BATTERY WARNINGS:

- Do not mix old and new batteries.
- Do not mix alkaline, standard (carbon-zinc), or rechargeable (nickel-cadmium) batteries.
- Batteries must be inserted with the correct polarity.
- The supply terminals are not to be short-circuited.
- Remove batteries if the item will not be used for an extended period of time.
- Non-rechargeable batteries are not to be recharged.
- Rechargeable batteries are to be removed from the item before being charged.
- Rechargeable batteries are only to be charged under adult supervision.
- Only batteries of the same or equivalent type as recommended are to be used.
- Exhausted batteries should be removed from the item.

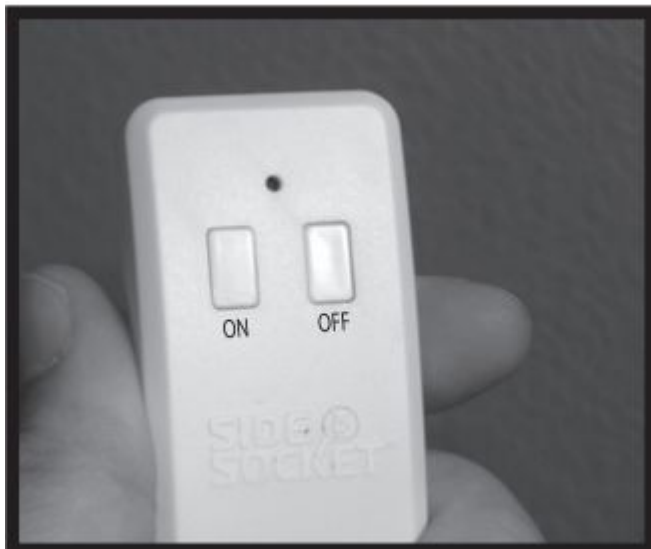

**The remote controls the 3 stationary outlets.** First, make sure the top switch is turned ON (the top LED will be lit). Remove the Pull Tab from the back of the remote to activate the remote. Press the remote ON/OFF buttons to turn the 3 stationary outlets ON and OFF. If you lose the remote, you can just use the Top Switch to turn the 3 stationary outlets ON and OFF.

### CHANGING THE REMOTE BATTERIES

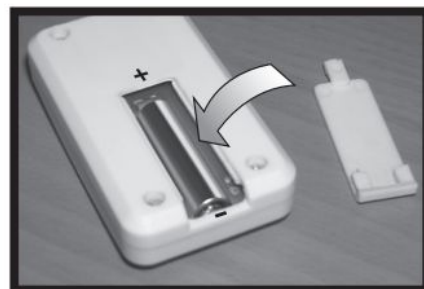
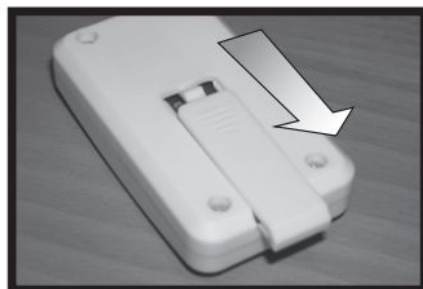

When the remote stops working, it's time to change the batteries. Slide the bottom battery door down and remove it. Replace the battery with a new Model 27A 12V battery. Slide the battery door back on.

**FCC ID: 2ACXG60003**

This device complies with Part 15 of the FCC Rules. Operation is subject to the following two conditions: (1) this device may not cause harmful interference, and (2) this device must accept any interference received, including interference that may cause undesired operation.

Changes or modifications not expressly approved by the party responsible for compliance could void the user's authority to operate the equipment.

Note: This equipment has been tested and found to comply with the limits for a Class B digital device, pursuant to part 15 of the FCC Rules. These limits are designed to provide reasonable protection against harmful interference in a residential installation. This equipment generates, uses and can radiate radio frequency energy and, if not installed and used in accordance with the instructions, may cause harmful interference to radio communications. However, there is no guarantee that interference will not occur in a particular installation. If this equipment does cause harmful interference to radio or television reception, which can be determined by turning the equipment off and on, the user is encouraged to try to correct the interference by one or more of the following measures:

- Reorient or relocate the receiving antenna.
- Increase the separation between the equipment and receiver.
- Connect the equipment into an outlet on a circuit different from that to which the receiver is connected.
- Consult the dealer or an experienced radio/TV technician for help.