

This device complies with part 15 of the FCC Rules. Operation is subject to the following two conditions: (1) This device may not cause harmful interference, and (2) this device must accept any interference received, including interference that may cause undesired operation.

Note: This equipment has been tested and found to comply with the limits for a Class B digital device, pursuant to part 15 of the FCC Rules. These limits are designed to provide reasonable protection against harmful interference in a residential installation. This equipment generates, uses and can radiate radio frequency energy and, if not installed and used in accordance with the instructions, may cause harmful interference to radio communications. However, there is no guarantee that interference will not occur in a particular installation. If this equipment does cause harmful interference to radio or television reception, which can be determined by turning the equipment off and on, the user is encouraged to try to correct the interference by one or more of the following measures:

- Reorient or relocate the receiving antenna.
- Increase the separation between the equipment and receiver.
- Connect the equipment into an outlet on a circuit different from that to which the receiver is connected.
- Consult the dealer or an experienced radio/TV technician for help.

Caution: Any changes or modifications not expressly approved by the party responsible for compliance to this equipment would void the user's authority to operate this device.

This device complies with Industry Canada licence-exempt RSS standard(s). Operation is subject to the following two conditions: (1) this device may not cause interference, and (2) this device must accept any interference, including interference that may cause undesired operation of the device.

Le présent appareil est conforme aux CNR d'Industrie Canada applicables aux appareils radio exempts de licence. L'exploitation est autorisée aux deux conditions suivantes : (1) l'appareil ne doit pas produire de brouillage, et (2) l'appareil doit accepter tout brouillage radioélectrique subi, même si le brouillage est susceptible d'en compromettre le fonctionnement.

pronto

peel

Quick Start Guide/ Prise en Main / Para Empezar

Insert the 4 AA alkaline batteries (included) in the Pronto.
The red LED on the Pronto will start blinking.

Inserta las 4 pilas alcalinas AA (incluidas) en tu Pronto.
El LED rojo en el Pronto empezará a parpadear.

Insérez les 4 piles alcalines AA (inclus) dans votre Pronto.
La LED rouge sur le Pronto se met à clignoter.

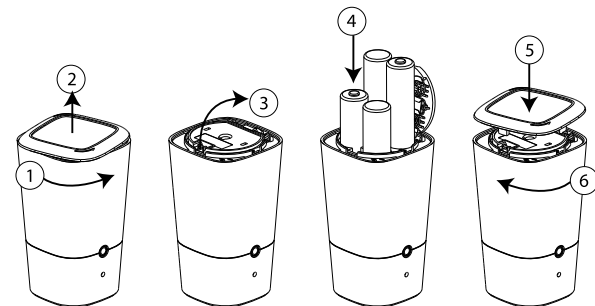

1

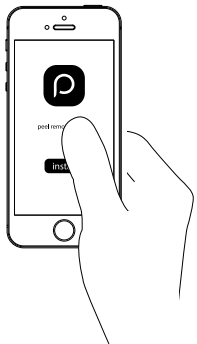

Download free Peel Smart Remote App to your iPad or iPhone from Apple App Store and open the app

Téléchargez gratuitement l'app Peel Smart Remote sur votre iPad ou iPhone depuis la boutique app d'Apple et ouvrez l'app

Descarga la Aplicación Peel Smart Remote en tu iPad o tu iPhone desde Apple App Store (Tienda de Aplicaciones de Apple) y abre la aplicación

2

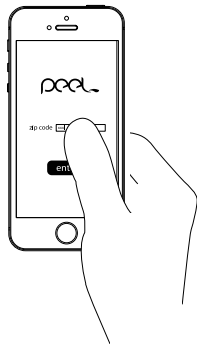

Set up the interactive TV Guide (available in USA/Canada, other countries coming soon)

Installez le guide TV interactif (disponible aux États-Unis/Canada, bientôt dans d'autres pays)

Configura la Guía de TV interactiva (disponible en EE. UU. y Canadá, y en breve en otros países)

3

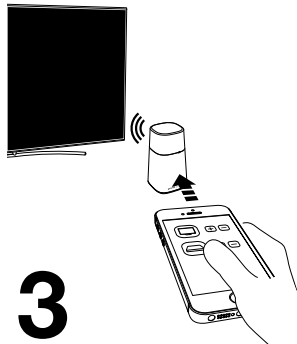

Place Pronto within 32ft (10m) of your devices (line of sight required). Use the Peel Smart Remote App to select your devices.

Positionnez le Pronto Air à 32ft (10 m) de vos appareils (ligne de visée requise). Utilisez l'app Peel Smart Remote pour sélectionner vos appareils.

Coloca Pronto a menos de 32ft (10 m) de tus dispositivos (línea de visión necesaria). Utiliza la aplicación de Peel Smart Remote para seleccionar tus dispositivos.

For more information, safety instructions and limited warranty please visit: www.getpronto.com/support

Pour plus d'information, des consignes de sécurité et garantie limitée, visitez: www.getpronto.com/support

Para obtener más información, instrucciones de seguridad y garantía limitada, visite: www.getpronto.com/support